

Massey Ferguson®

1560 Compact Tractor

WORKSHOP SERVICE MANUAL 4283360M2

CONTENTS

GENERAL INFORMATION	01
ENGINE	02
MAJOR COMPONENTS	03
CLUTCH	04
TRANSMISSION	05
REAR AXLE AND BRAKES	06
FRONT AXLE	07
HYDRAULIC SYSTEM	08
ELECTRICAL	09
HYDROSTATIC STEERING.....	10
CAB AND AIR CONDITIONING.....	11

INPUT GEARS

INPUT GEAR

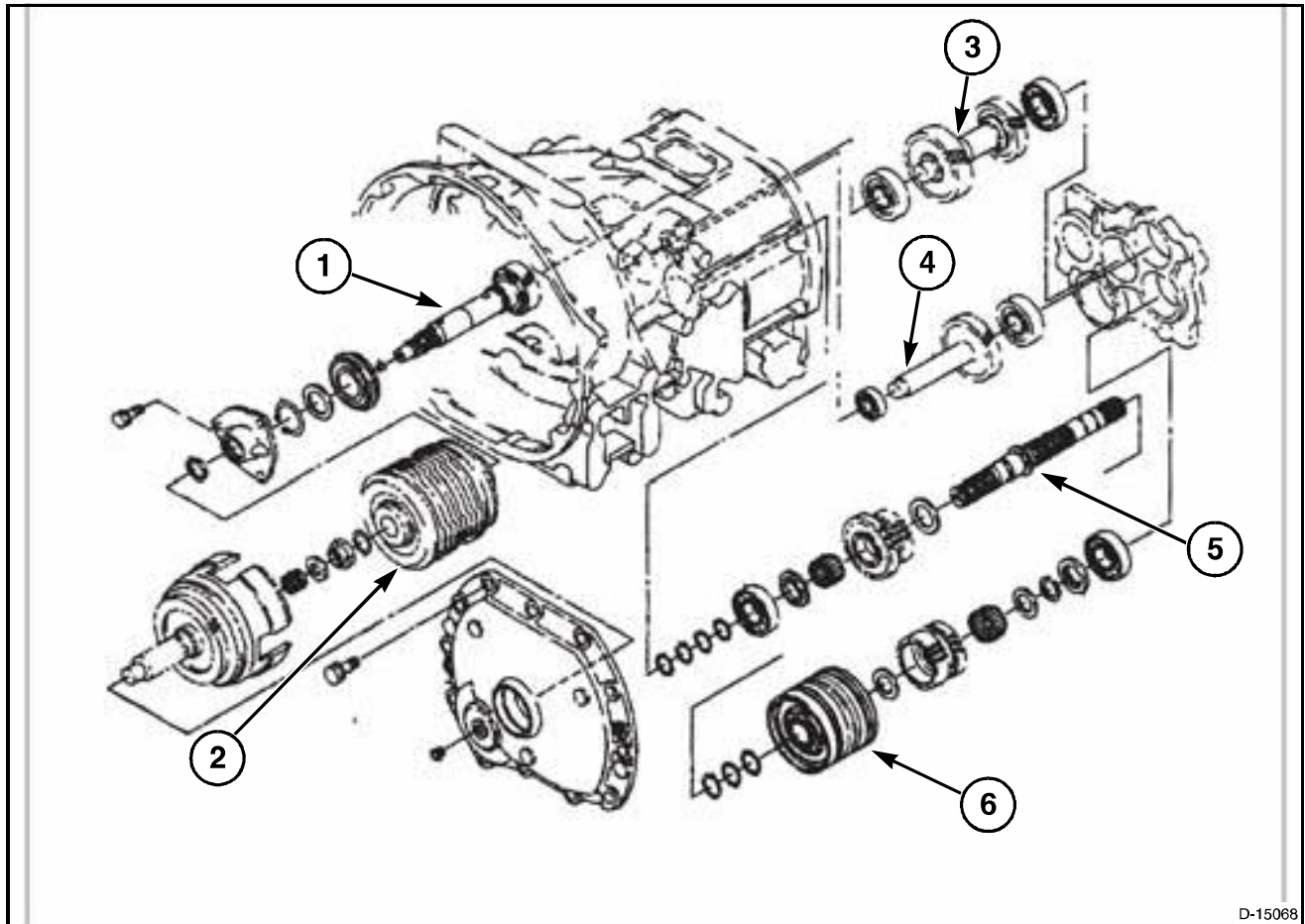
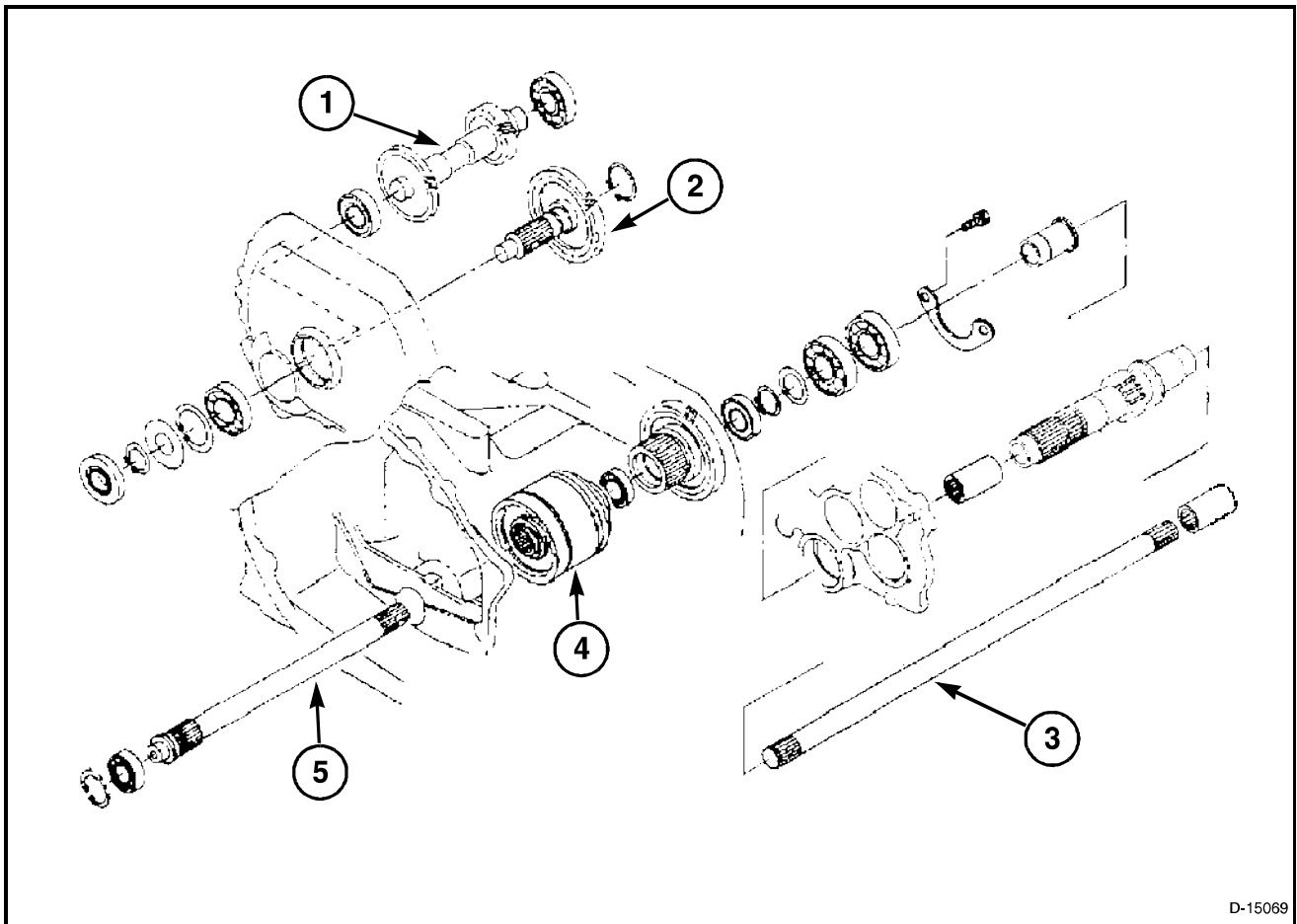

FIG. 10

FIG. 10: Input Gear Components

- (1) Input Shaft
- (2) Ground Clutch
- (3) Idler Gear
- (4) Reverse Idler Gear
- (5) Shuttle Shaft
- (6) Shuttle Clutch

Input Gears



D-15069

FIG. 11

FIG. 11: Input Gear Components

- (1) PTO Gear
- (2) Reverse Idler Gear
- (3) PTO Shaft
- (4) PTO Clutch
- (5) PTO Shaft

FIG. 12: Separate the tractor between the engine and clutch housing to access the PTO clutch and PTO gear.



FIG. 12

FIG. 13: Remove the PTO gear and ground clutch to access the PTO clutch.



FIG. 13

FIG. 14: Separate the tractor between the clutch housing and the front transmission housing.



FIG. 14

FIG. 15: Access the shuttle clutch, reverse idler and idler gear.

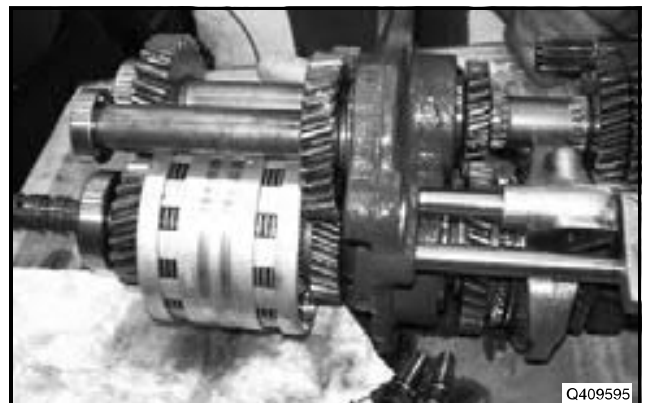

FIG. 15

Input Gears

FIG. 16: When installing the PTO clutch, the brake tabs (1) on the PTO brake must line up with the notch (2) cast into the clutch housing.

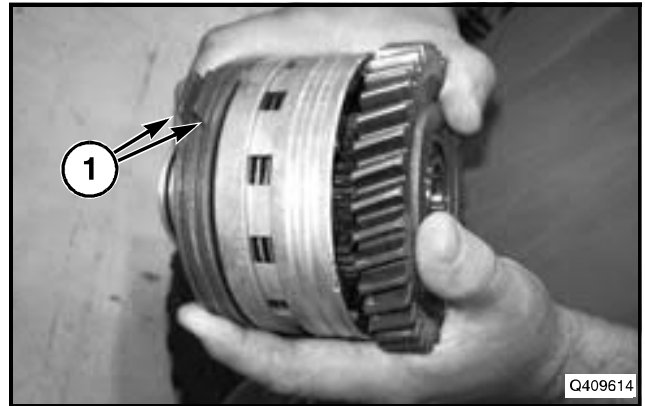

FIG. 16

FIG. 17: When installing the PTO clutch, the brake tabs (1) on the PTO brake must line up with the notch (2) cast into the clutch housing.

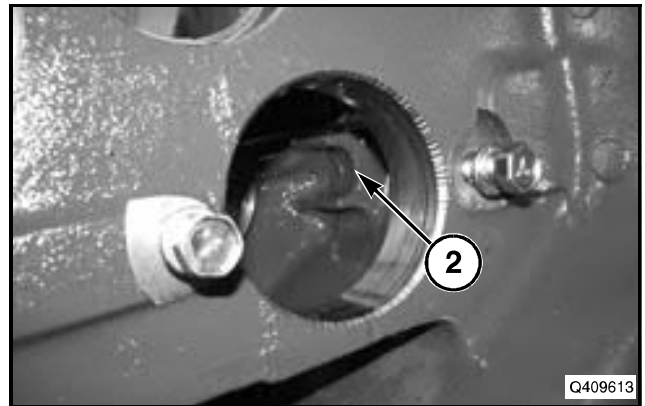

FIG. 17

TRANSMISSION MAIN CHANGE GEARS

MAIN SHIFT

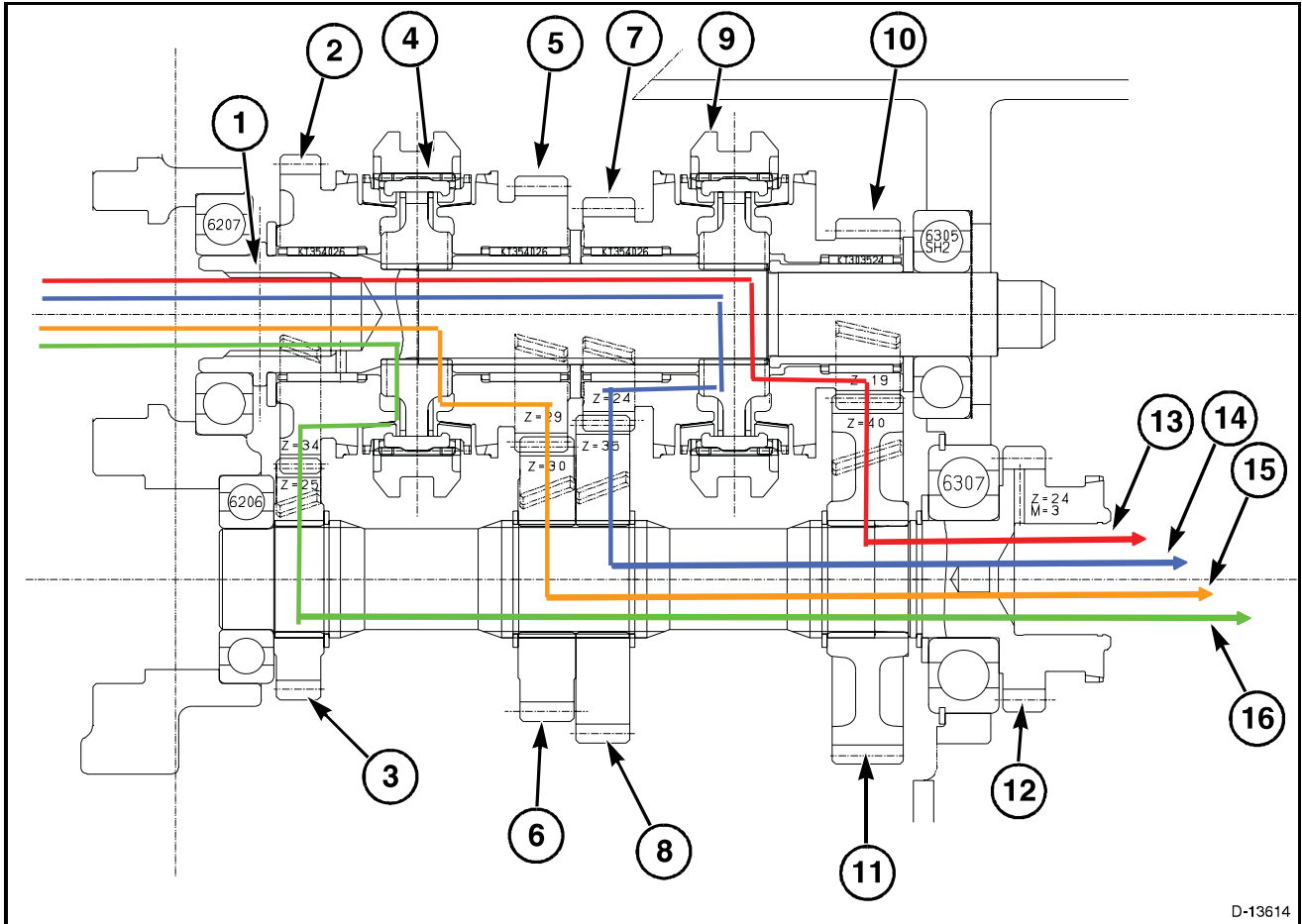

FIG. 18

FIG. 18: Type P/Q Power Shuttle

- (1) Main Shaft
- (2) 4th Change Gear (34T)
- (3) 4th Counter Gear (25T)
- (4) Synchromesh
- (5) 3rd Change Gear (29T)
- (6) 3rd Counter Gear (35T)
- (7) 2nd Change Gear (24T)
- (8) 2nd Change Gear (37T)
- (9) Synchromesh
- (10) 1st Change Gear (19T)
- (11) 1st Counter Gear (40T)
- (12) Counter Shaft (24T)

(13) 1st Gear

(14) 2nd Gear

(15) 3rd Gear

(16) 4th Gear

NOTE: The main gear shift uses a synchromesh type transmission.

Transmission Main Change Gears

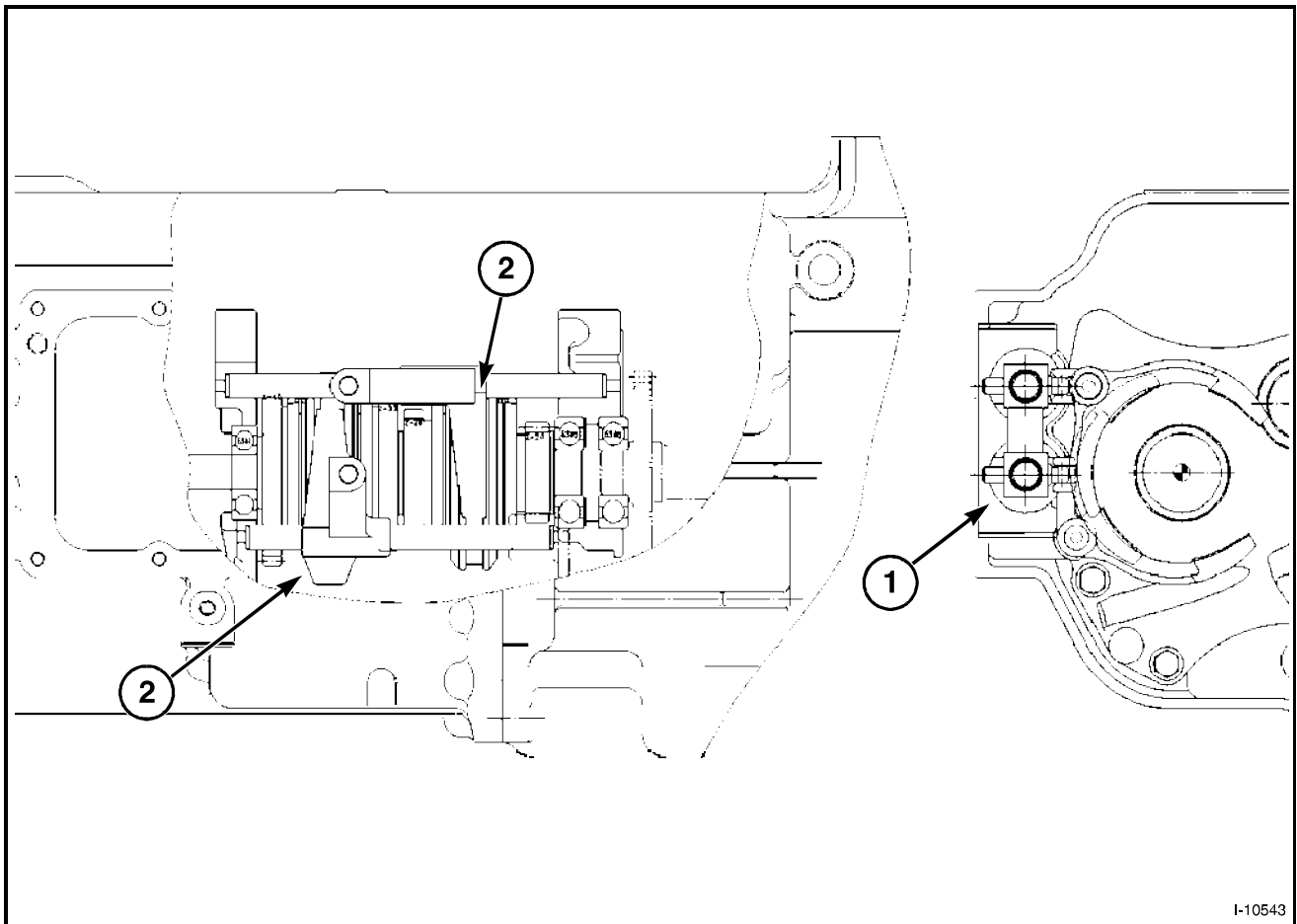

FIG. 19

FIG. 19: Precautions for assembly - Power Shift shift linkage

When installing shift valve cover assembly in transmission, make sure the shift fork is in neutral.

- (1) Shift Cylinders
- (2) Shift Fork

Shift Fork Assembly

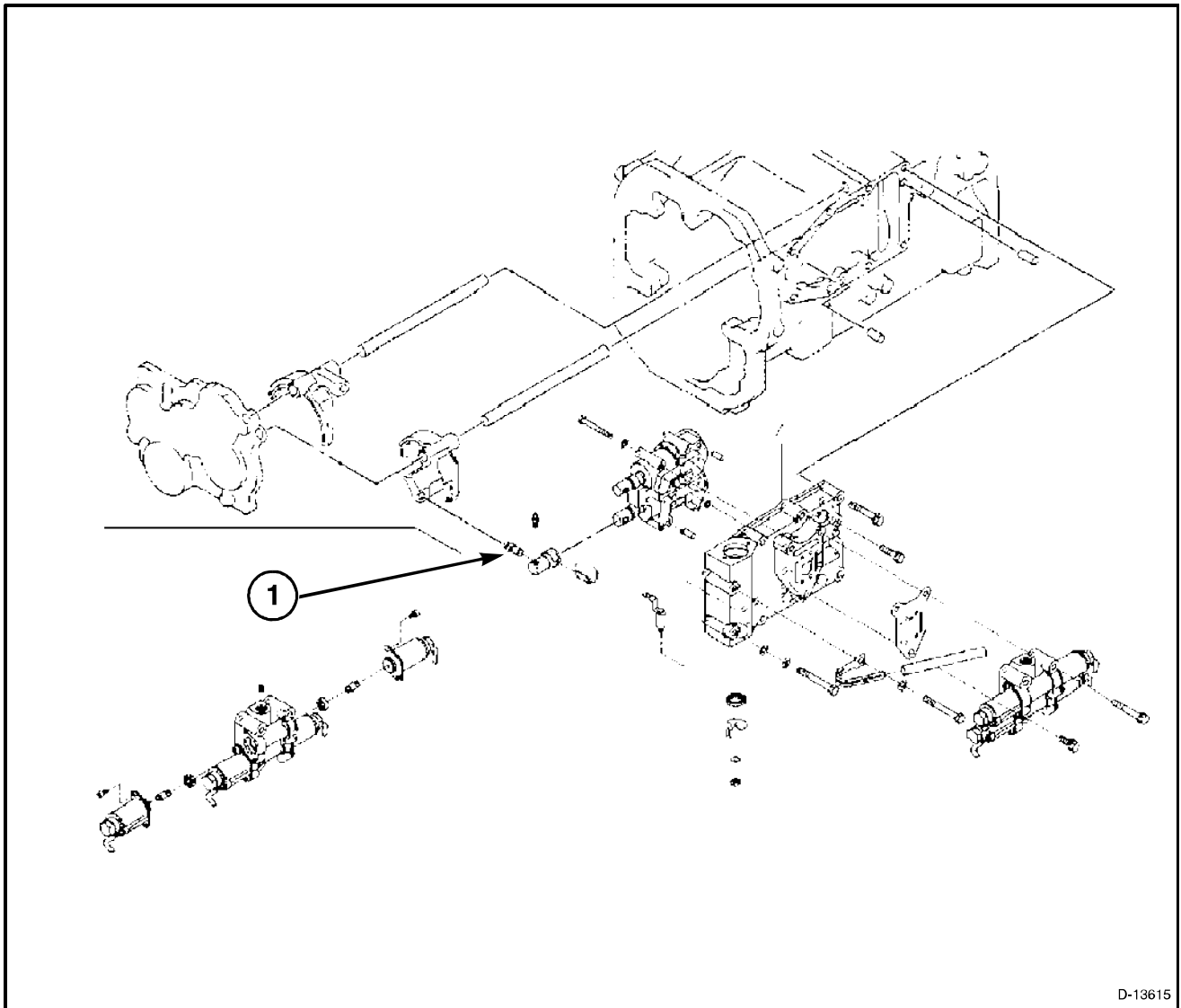

D-13615

FIG. 20

FIG. 20: Precaution for assembly: Power Shift - shift linkage

(1) Put pin into shift fork

Transmission Main Change Gears

PRECAUTIONS FOR ASSEMBLY

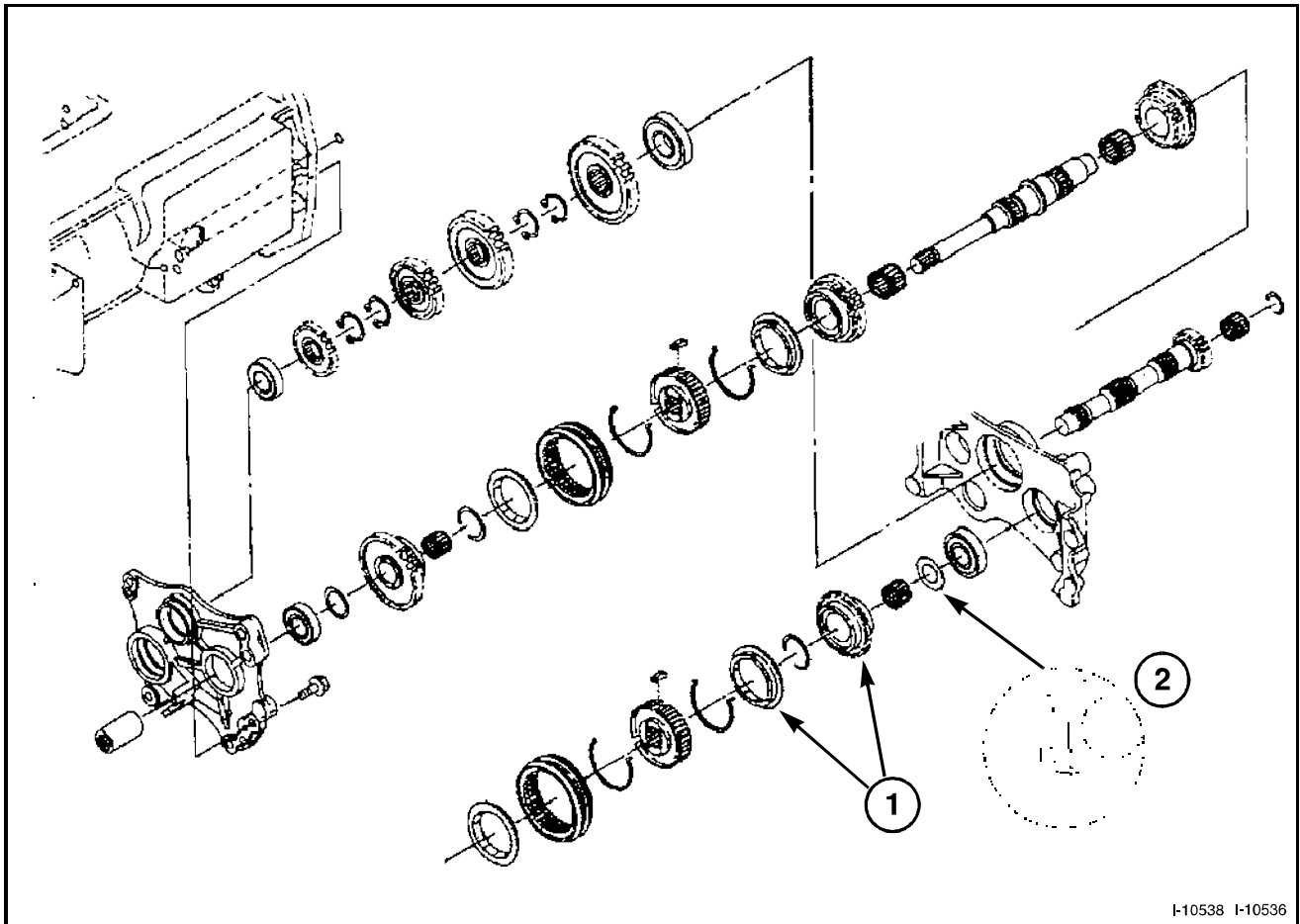
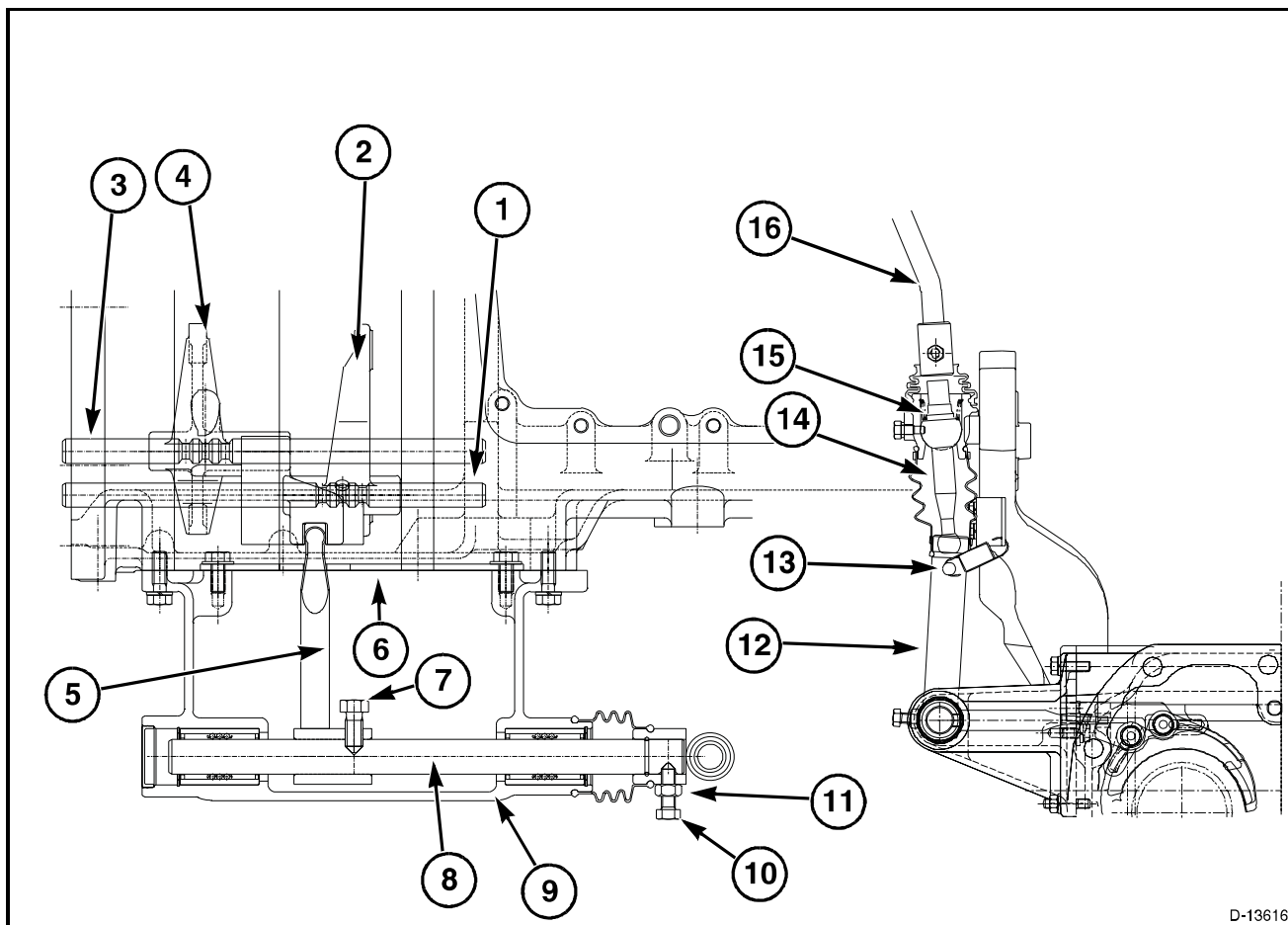

FIG. 21

FIG. 21: Precautions for assembly

- (1) Apply Oil to Synchro Mesh
- (2) Installed Direction of Washer

MAIN SHIFT LEVER



D-13616

FIG. 22

FIG. 22: Power Shuttle Shift Lever

- (1) Shift Rod (1-2)
- (2) Shift Fork (1-2)
- (3) Shift Rod (3-4)
- (4) Shift Fork (3-4)
- (5) Shift Arm
- (6) Guide
- (7) Bolt
- (8) Bar
- (9) Metal
- (10) Bolt
- (11) Nut
- (12) Arm
- (13) Spring
- (14) Shift Arm
- (15) Spring
- (16) Lever

Transmission Main Change Gears

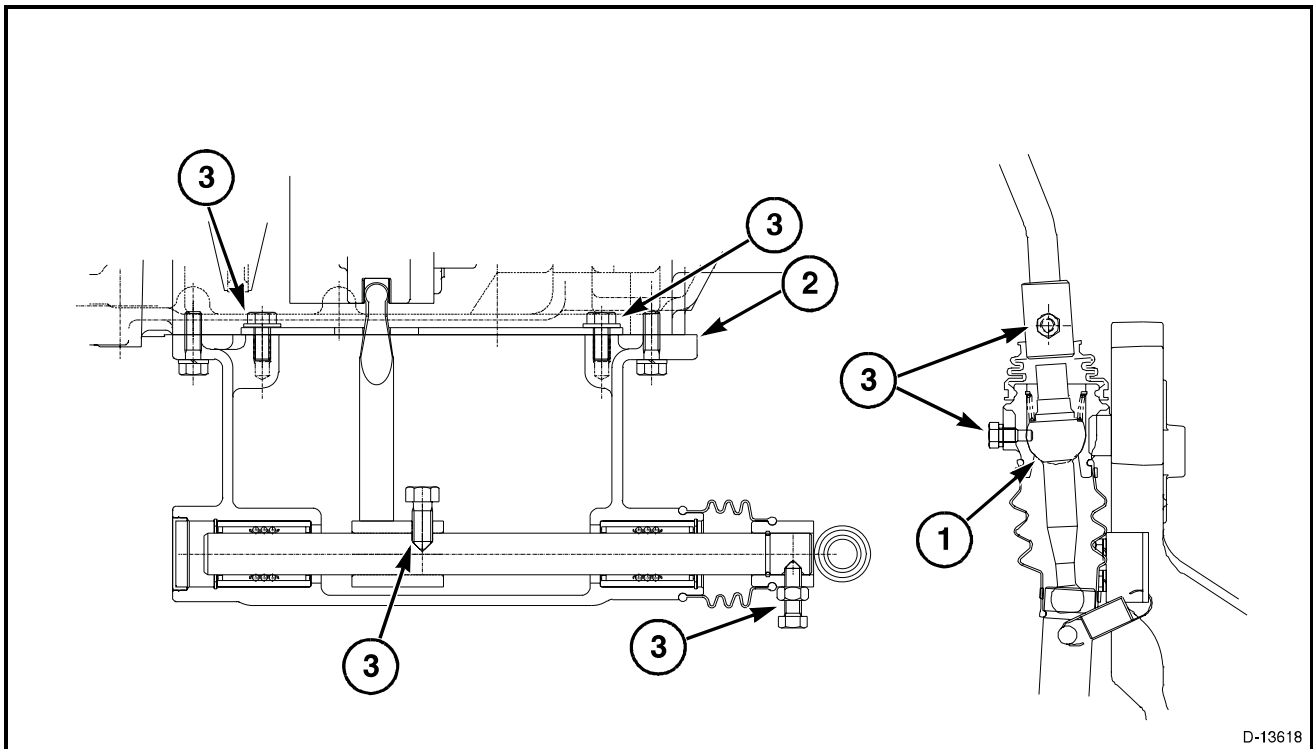

FIG. 23

FIG. 23: Precautions for assembly of main shift lever.

Wire rubber cover

(1) Apply grease.

(2) Apply gasket to the shift housing.

(3) Apply loctite (chemiseal L324) to the bolt.

Thank you so much for reading.
Please click the “Buy Now!”
button below to download the
complete manual.



After you pay.

You can download the most
perfect and complete manual in
the world immediately.

Our support email:

ebooklibonline@outlook.com