

Workshop Service Manual

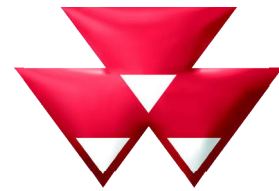

MASSEY FERGUSON

1700M Series Compact Tractors

1735M

1740M

1750M

1755M

1760M



North America
4205 River Green Parkway, Duluth GA 30096 USA
© AGCO 2018

May 2018
4283619M1
NA
English

TABLE OF CONTENT

General.....	1
Engine, Fuel And Exhaust System.....	2
Drive Train System.....	3
Chassis.....	4
Cab.....	5
Air Conditioning And Heating System.....	6
Axles.....	7
Brake System.....	8
Steering System.....	9
Hydraulic System.....	10
Electrical System.....	11
Diagrams.....	12

3.1 Transmission

3.1.1 Separate the engine from the front transmission

Procedure

1. Remove the bolt (1) from the four-wheel drive (4WD) shaft cover.
2. Loosen the clamp (2) holding the drive shaft covers.
3. Slide the covers together to show the couplers and the retainer rings.
4. Move the retainer rings and the couplers to the center of the shaft.
5. Remove the 4WD shaft.
6. Disconnect the battery and the light harness.
7. Disconnect the support rod assembly (1) from the engine cover.
8. Remove the cotter pins from the hinges and slide the engine cover to the left.
9. Remove the engine cover.

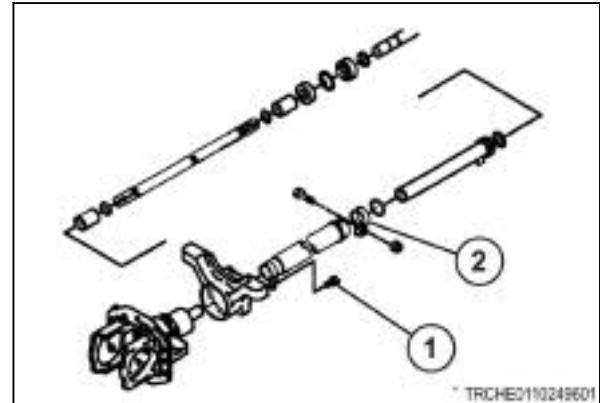

Fig. 1



Fig. 2



Fig. 3

3. Drive Train System



10. Disconnect the wire harness connectors at the engine and on the right side of the fire wall.
11. Remove and cap the fuel supply and the fuel return lines from the injection pump.
12. Remove the fuel tank.



Fig. 4

13. Remove the fuel filter bracket (1).

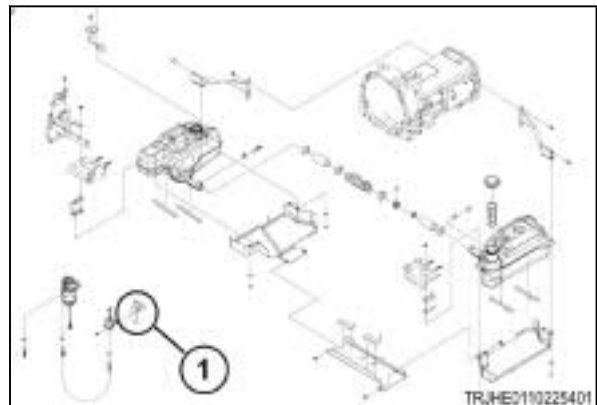
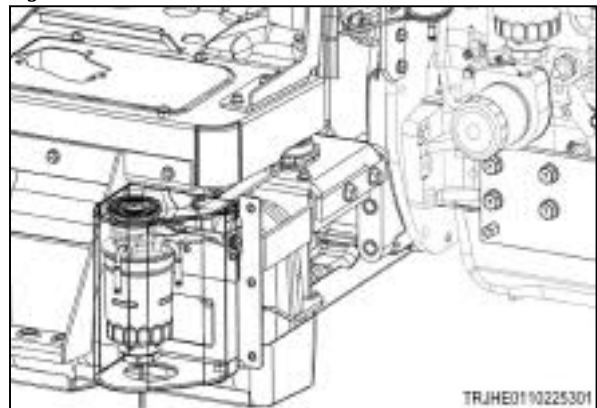

Fig. 5

14. Remove the drain plug (1).
15. Drain the transmission oil into a correct container.

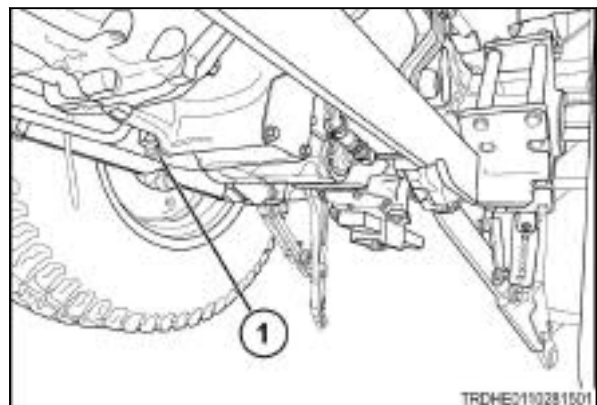
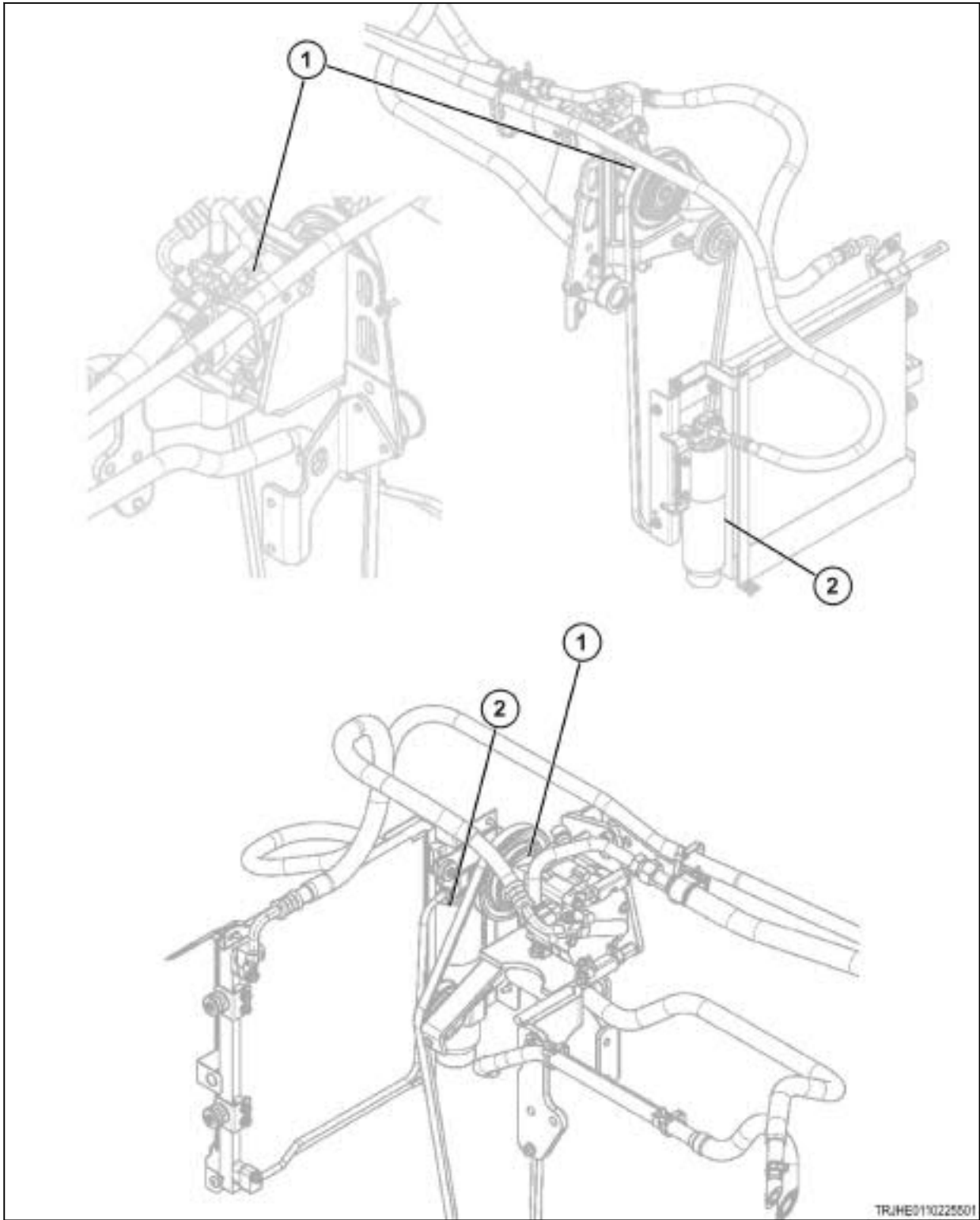

Fig. 6

16. Disconnect the hydraulic suction line and the pressure line (1) below the main pump.



Fig. 7



TRJHE0110225501

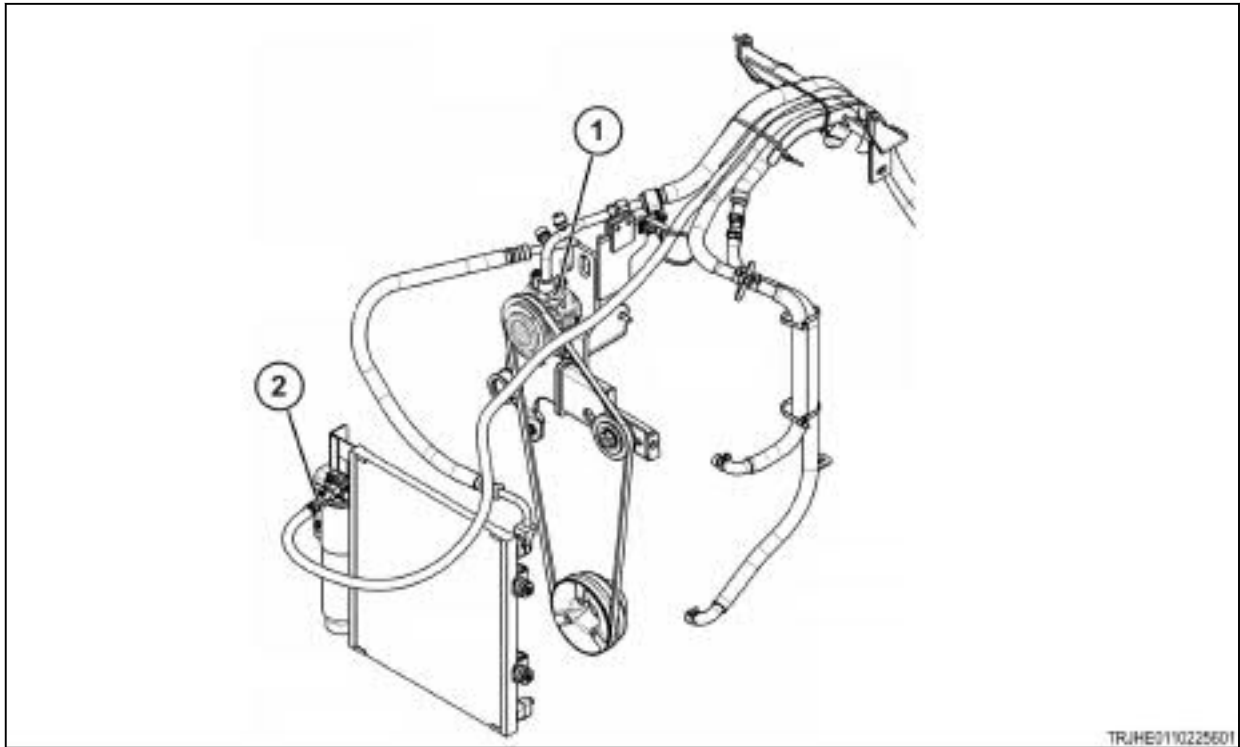

Fig. 8 Cab only

17. Evacuate the air conditioning system with an approved recovery system.
18. Disconnect the air conditioning lines at the compressor (1) and the receiver drier (2).
19. Insert wooden wedges between the front axle and the front frame to keep the tractor from tipping.



Fig. 10

3. Drive Train System

20. Put dividing stands under the tractor.
21. Support the transmission housing with an applicable floor jack and the engine with an applicable overhead hoist.
22. Remove all the bolts attaching the engine to the front transmission.

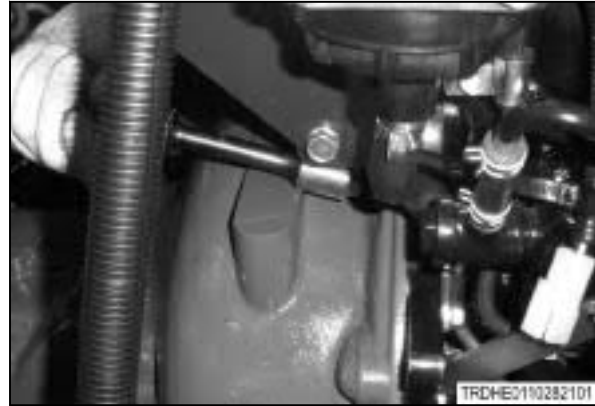

Fig. 11

23. Disconnect the engine from the front transmission housing carefully.



Fig. 12

3.1.2 Separate the front and rear transmission housings

Removing the cab or platform is not necessary to divide the machine between the front and rear transmission housings.

Procedure

1. Disconnect the battery and drain the transmission oil before disassembly.

2. Remove the bolt (1) from the four-wheel drive (4WD) shaft cover.
3. Loosen the clamp (2) holding the drive shaft covers.
4. Slide the covers together to show the couplers and the retainer rings.

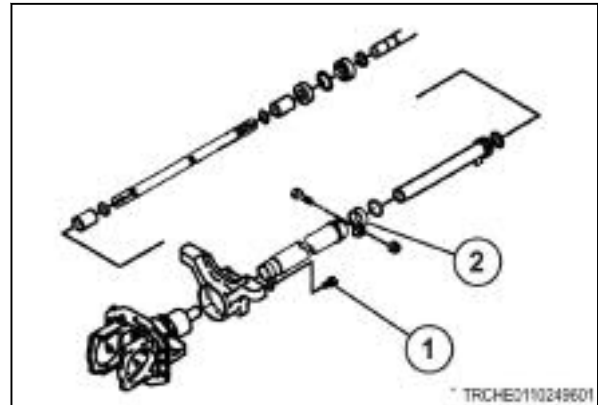

Fig. 13

5. Move the retainer rings and the couplers to the center of the shaft.



Fig. 14

6. Remove the bolts holding the seat pan (1). Remove the seat pan and seat suspension as an assembly.

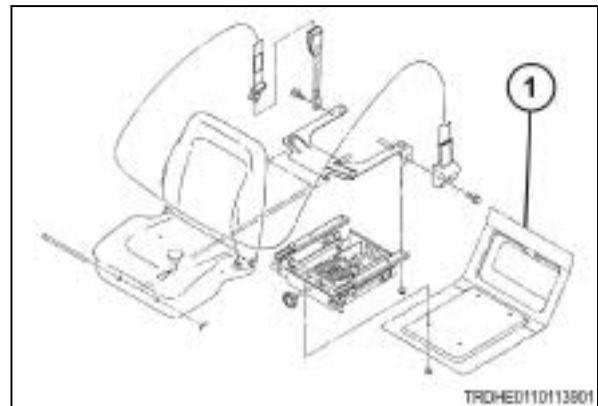

Fig. 15

7. Remove the slow return knob (1).



Fig. 16

3. Drive Train System



8. Remove the slow return tube (1).



Fig. 17

9. Jack up the rear of the tractor. Put both the rear axles on correct jack stands. Remove the left and right rear tires. Remove the inner fender panels.



Fig. 18

10. Remove the lower end of the three point control rod or cable.



Fig. 19

11. Remove the upper end of the optional rear remote levers (if equipped) and draft control lever (if equipped).



Fig. 20

12. Disconnect the joystick linkage (if equipped).



Fig. 21

13. Disconnect the hoses (1) from the rear remote valves (if equipped).

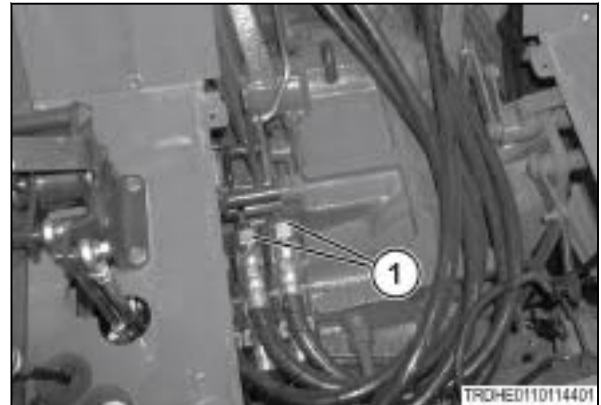

Fig. 22

14. Remove the hydraulic suction line behind the hydraulic filter head assembly. Remove the middle hydraulic coupler lines (1) from the joystick valve and the middle coupler bracket (if equipped).

NOTE: Identify the lines before disassembly to help in assembly.



Fig. 23

15. Disconnect the spring from the three point linkage.

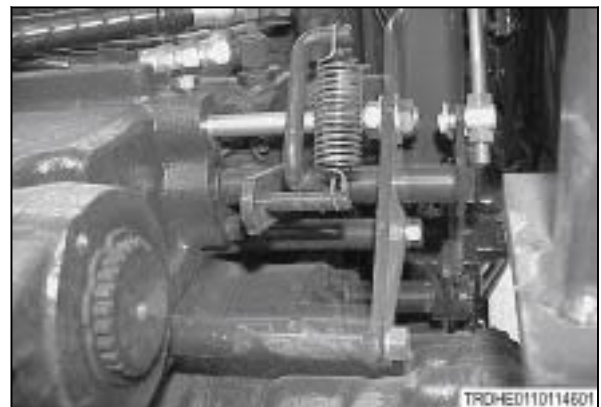

Fig. 24

16. Remove the nut (1) and the two bolts (2) from the three point linkage bracket.

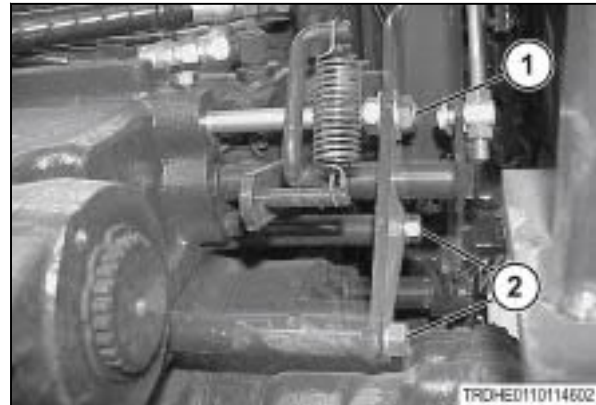

Fig. 25

17. Remove the three point linkage bracket (1) as an assembly.

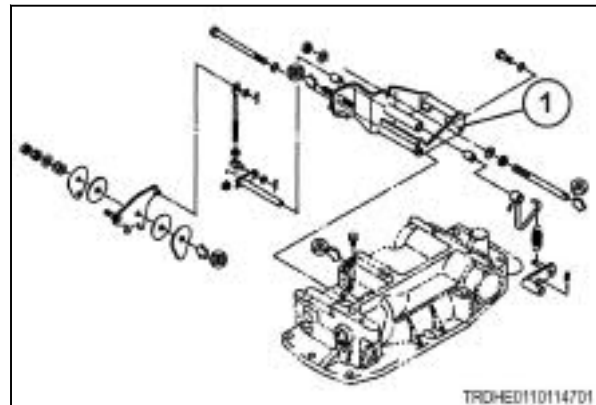

Fig. 26

18. Disconnect all the wire harness connections to the switches and sensors located on the rear transmission housing.

NOTE: Identify all wire harness connections requiring separation before disassembly. This procedure will help during assembly.



Fig. 27

19. Remove the upper part of the power take-off (PTO) shift lever. Remove the upper part of the range shift lever and the four-wheel drive shift lever (if equipped).



Fig. 28

20. Remove the lower range shift lever (1) connected to the range shift arm.

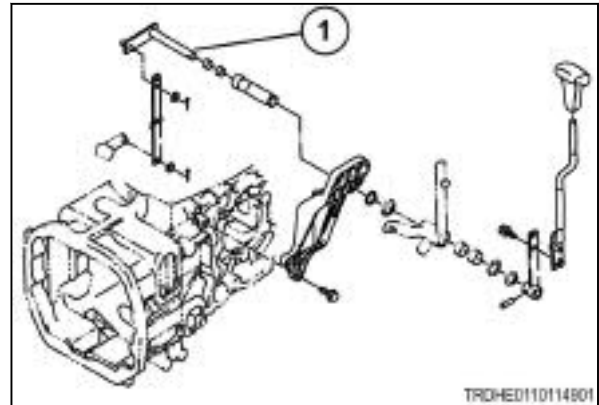

Fig. 29

21. Remove the lower PTO lever (1) connected to the PTO shift arm.

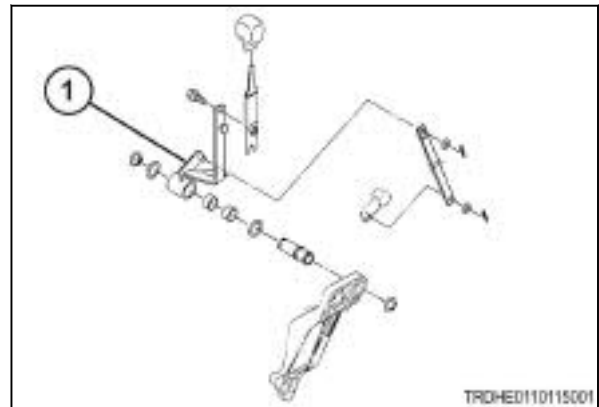

Fig. 30

22. Remove the lower four-wheel drive shift lever (1) connected to the four-wheel drive (4WD) shift arm (if equipped).

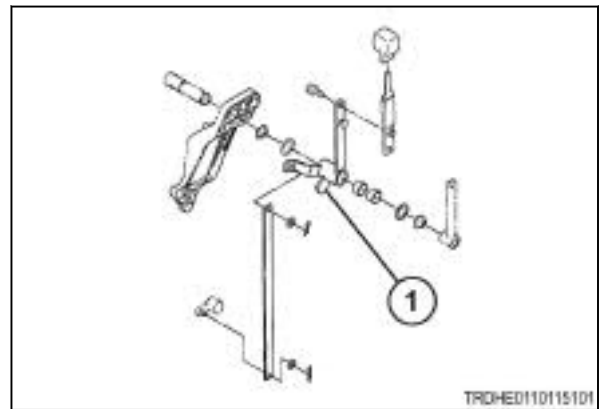

Fig. 31

23. Remove the range lever, PTO lever, and the 4WD lever support bracket (1) and remaining shift linkage as an assembly.

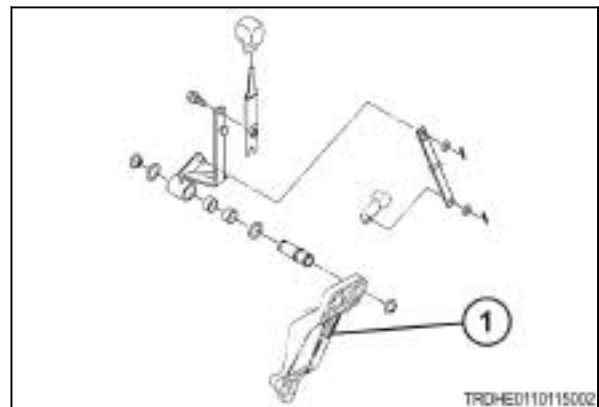

Fig. 32

3. Drive Train System



24. Remove the bolts fastening the main transmission lever housing to the rear transmission. Remove the lever and the housing as an assembly.

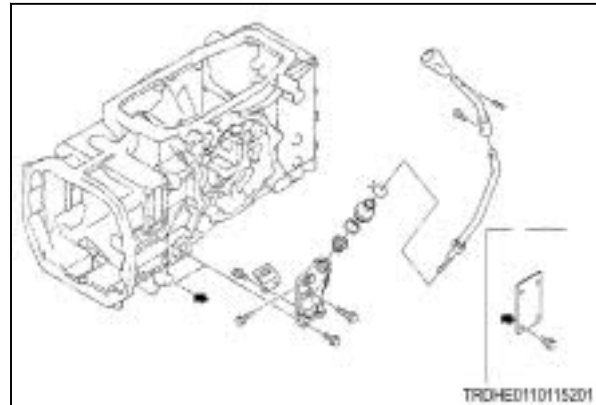

Fig. 33

25. Disconnect the left and right brake rods at the rear brake arms.



Fig. 34

26. Disconnect the linkage (1) to the differential lock engage arm.

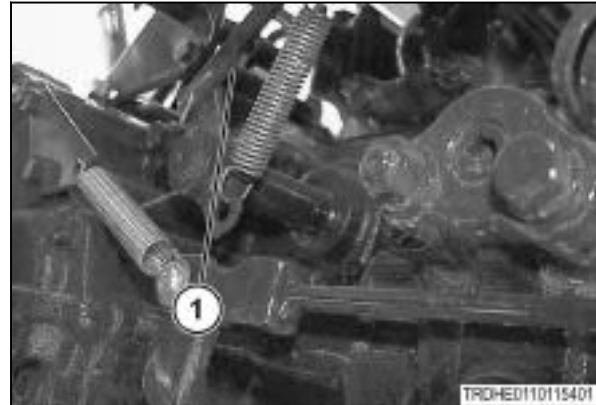

Fig. 35

27. Loosen the bolt (1) in the center of the front cab mount or platform mount bolts. Loosen until only some threads are engaging the nut.

NOTE: Cab models - Lift up the floor mat to show the front cab mount bolts.



Fig. 36

- 28.** Remove the bolt (1) in the center of the rear cab mounts or platform mounts. On platform machines, insert lifting straps through the handrails located on the fenders. On the cab machines, insert the lifting strap through the hooks at the rear upper corners of the cab. Use an overhead hoist to support the rear of the platform or cab.



Fig. 37

- 29.** Insert wooden wedges between the front axle and the front frame to keep the machine from tipping. Use splitting stands to support the front and rear transmission housings. Remove all the bolts attaching the front transmission housing to the rear transmission housing and carefully disconnect the housings.

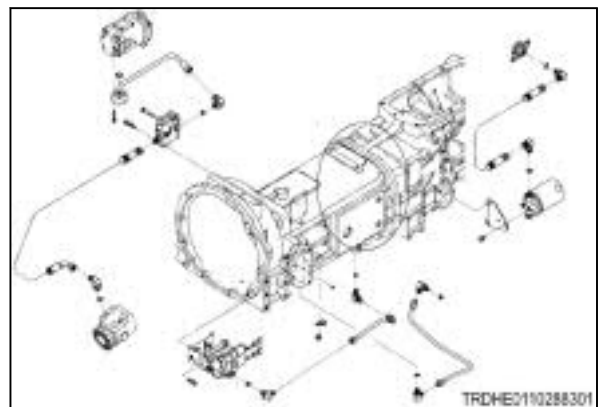

Fig. 38

- 30.** After separating the rear transmission, remove the seal, retainer ring and the bearing (1) from the front transmission housing. This will help in assembly. Connect the transmission together, and install the components.

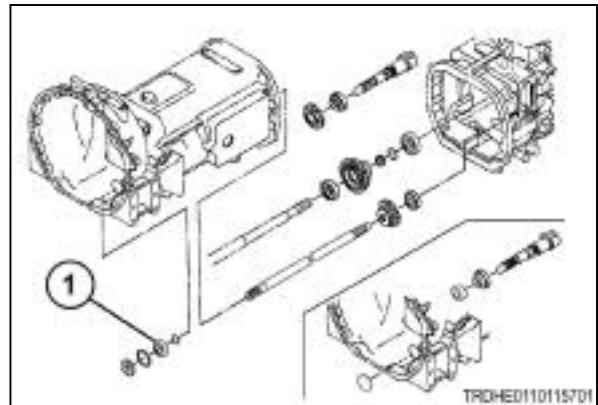

Fig. 39

3.1.3 Install the front transmission housing

Assemble with the following precautions:

1. Replace any seals that have been removed with the new parts.
2. Apply sealant between all the cast housings.
3. **Shuttle transmissions only** - Make sure the main transmission shift lever engages the shift forks.
4. Do not crimp any wires. Make sure the wires will not chaff against other objects.
5. Align the hydraulic control levers and all other shift linkage while lowering the cab.

Procedure

1. Install a new seal, retainer ring and bearing (1) into the front transmission housing and connect the transmission together.

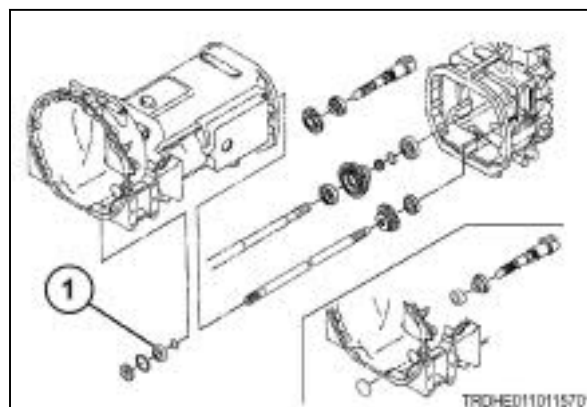

Fig. 40

2. Connect the front transmission housing to the rear transmission housing and install all the bolts attaching the housings.

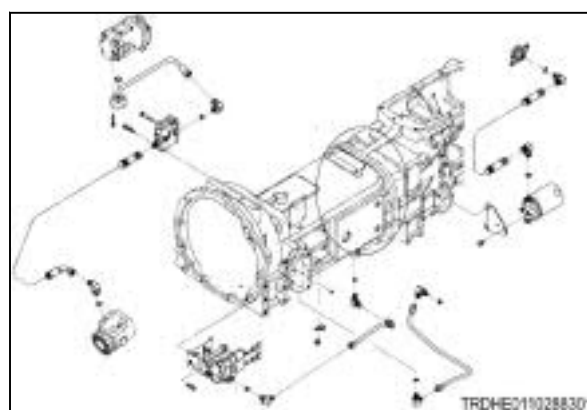

Fig. 41

3. Put the cab or platform onto the machine with an overhead hoist.
4. Install the bolts (1) for the cab mounts or platform mounts. Tighten the bolts to 97 Nm (72 lbf ft).



Fig. 42

5. Connect the linkage (1) to the differential lock engage arm.

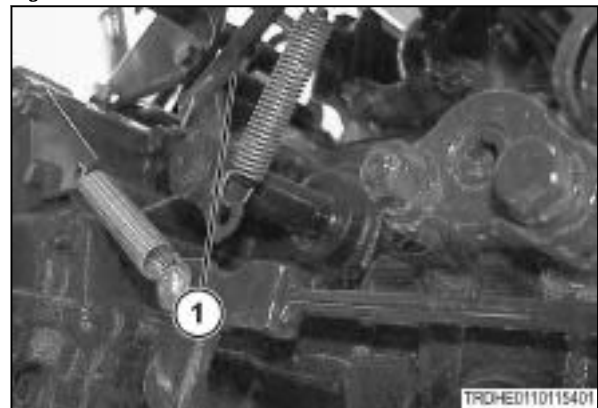

Fig. 43

6. Connect the left and right brake rods at the rear brake arms.



Fig. 44

7. Install the lever and the housing as an assembly.
8. Install the bolts attaching the main transmission lever housing to the rear transmission.

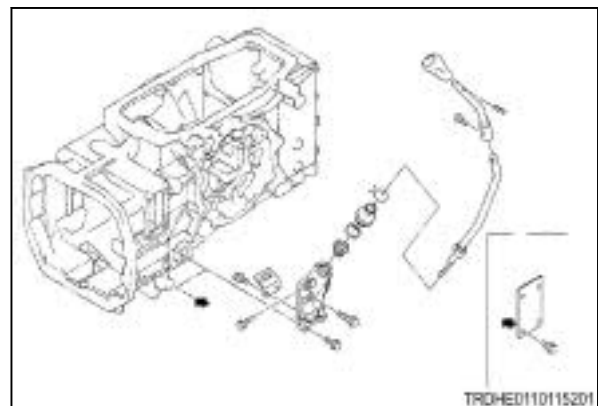

Fig. 45

3. Drive Train System



9. Install the range lever, PTO lever, and the 4WD lever support bracket (1) and remaining shift linkage as an assembly.

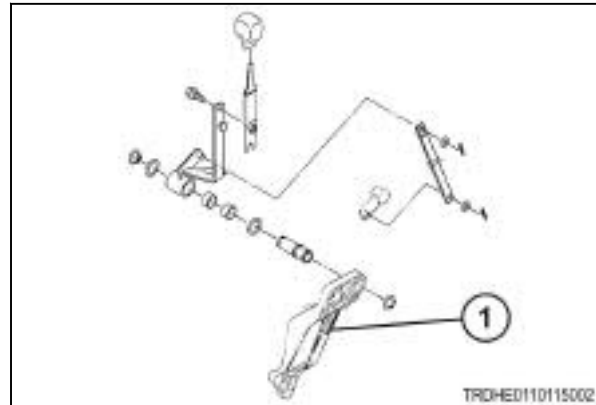

Fig. 46

10. Install the lower four-wheel drive shift lever (1) connected to the four-wheel drive (4WD) shift arm (if equipped).

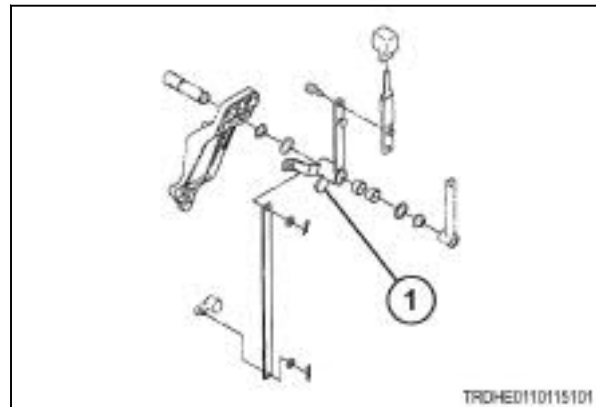

Fig. 47

11. Install the lower PTO lever (1) connected to the PTO shift arm.

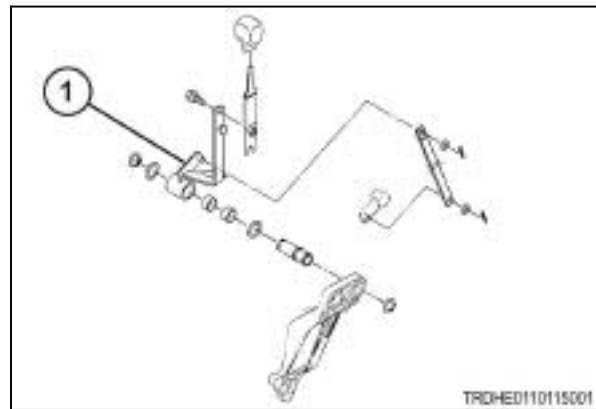

Fig. 48

12. Install the lower range shift lever (1) connected to the range shift arm.

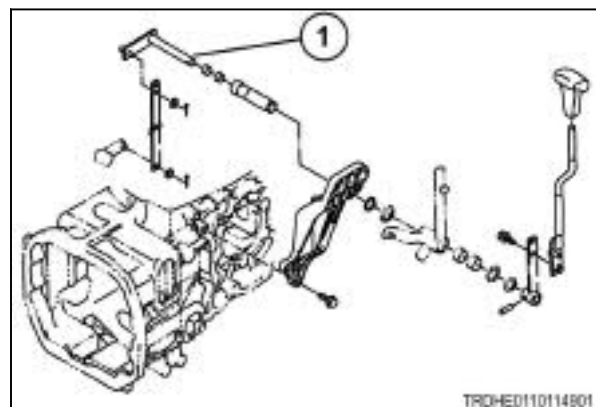

Fig. 49

13. Install the upper part of the range shift lever and the four-wheel drive shift lever (if equipped).
14. Install the upper part of the power take-off (PTO) shift lever.



Fig. 50

15. Connect all the wire harness connections to the switches and sensors located on the rear transmission housing.



Fig. 51

16. Install the three point linkage bracket (1) as an assembly.

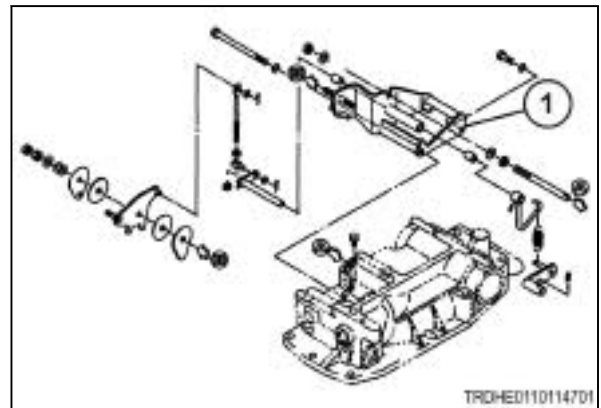

Fig. 52

17. Install the nut (1) the two bolts (2) and the three point linkage bracket.

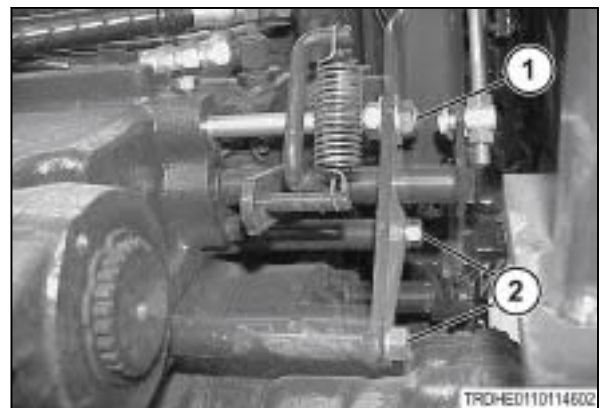

Fig. 53

Thank you so much for reading.
Please click the “Buy Now!”
button below to download the
complete manual.



After you pay.

You can download the most
perfect and complete manual in
the world immediately.

Our support email:

ebooklibonline@outlook.com