

OPERATOR'S MANUAL

SNOWBLOWERS

SB1148

SB1154

SB1164

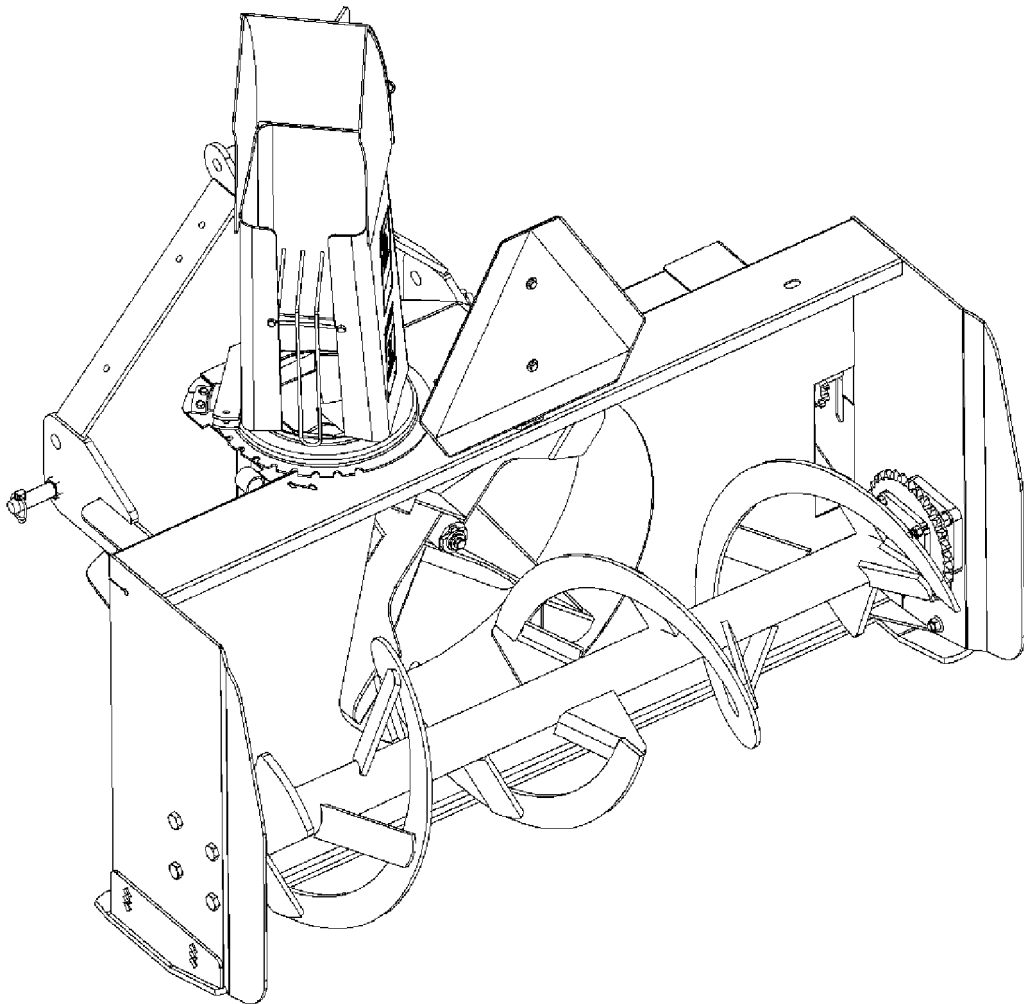

FRONTIER
EQUIPMENT

OM0369SB1148-A
12/09

TABLE OF CONTENT

SPECIFICATIONS.....	3
INTRODUCTION – TO THE PURCHASER.....	4
SAFETY PRECAUTIONS	5
General Information.....	5
Before Operation	6
Notice.....	6
The Snowblower.....	6
Before Operation.....	6
Snowblower Operation	7
The Tractor	7
General Information	7
Maintenance	8
Transporting.....	9
Storage	9
SAFETY DECALS	10
ASSEMBLY.....	11
Tractor Preparation	11
Snowblower Assembly	11
Installation of SMV Sign.....	11
Installation of Chute and Manual Rotation Kit 5RDF0016.....	12
Installation of Chute and Hydraulic Rotation Kit 5RDF0017.....	14
Installation of Electric Deflector Kit 5RDF0020 – For SB1154 & SB1164 Only.....	16
Installation of Hydraulic Deflector Kit 5RDF0019.....	18
Installation of Snowblower with Three Point Hitch.....	19
Installation of Snowblower with Quick Hitch.....	20
How to Determine Driveline Angles	21
Angles at Each End of Driveline.....	22
Determining Driveline Length.....	22
Driveline Installation.....	24
Removing Snowblower from Tractor	25

TABLE OF CONTENT

OPERATION	27
General Preparation	27
Operating Controls	27
Work and Travel Speed	27
Raising and Lowering the Snowblower.....	27
Adjustments	27
Reduction Chain Tension Adjustment	27
Skid Shoe Adjustment.....	27
Manual Deflector Adjustment	27
Snow Removal Methods	28
MAINTENANCE.....	29
Maintenance	29
Shearbolts	29
Drive shaft.....	29
Driveline.....	29
Lubrication.....	30
Driveline – Troubleshooting.....	31
PARTS	34
Introduction	34
Manual Holder	34
Snowblower – SB1148	35
Snowblower – SB1154 & SB1164.....	38
Gearboxes	41
Driveline 5RD4700100 for SB1148	42
Driveline 5RD4700159 for SB1154 & SB1164.....	43
5RDF0016 - Manual Rotation for SB1148 – SB1154 – SB1164.....	44
5RDF0017 - Hydraulic Rotation for SB1148 – SB1154 – SB1164	45
5RDF0009 - Hydraulic Deflector for SB1148 – SB1154 – SB1164	46
5RDF0020- Electric Deflector for SB1154 – SB1164 Only.....	47
TORQUE SPECIFICATION TABLE	48

SPECIFICATIONS

Features and Specifications	SB1148	SB1154	SB1164
Function	Snow Removal	Snow Removal	Snow Removal
Working Width	48"	54"	64"
Transport Width	48"	54"	64"
Working Height	24 5/8"	26"	26"
Length	39"	39"	39"
Single/Dual Auger	Single	Single	Single
Auger Diameter	15"	15"	15"
Auger Flighting Thickness	1/4"	5/16"	5/16"
Impeller Diameter	20"	24"	24"
Impeller Width	6"	7"	7"
Impeller Shaft Diameter	1"	1 3/8"	1 3/8"
Number of Impeller blades	4	4	4
Roller Chain	50	60	60
Drive sprocket (# of teeth)	17	10	10
Driven sprocket (# of teeth)	36	32	32
Chain idler	Manual adjustment	Manual adjustment	Manual adjustment
Gearbox Manufacturer	Comer	Comer	Comer
Gearbox Description	Model L-25J	Model T-281A	Model T-281A
Tractor RPM	540	540	540
Impeller RPM	540	540	540
Auger RPM	170	170	170
PTO Manufacturer	Comer	Comer	Comer
PTO Description	20	40	40
Skid Shoe	Adjustable	Adjustable	Adjustable
Skid Shoe Material	Steel	Steel	Steel
End Plate Thickness	3/16"	3/16"	3/16"
Back Plate Thickness	12ga	12ga	12ga
Impeller Housing Thickness	12ga	12ga	12ga
Impeller Blade Thickness	3/16"	3/16"	3/16"
Side Panel Bottom Thickness	3/16"	3/16"	3/16"
Cutting Edge	Welded	Welded	Welded
Cutting Edge Dimension	3/8" x 2"	3/8" x 2"	3/8" x 2"
Chute Base	Standard	Standard	Standard
Parking Stand	Standard	Standard	Standard
Hitch Category	Cat. 1	Cat. 1	Cat. 1
Quick Hitch Compatibility	ASABE Compatible	ASABE Compatible	ASABE Compatible
HP Requirements - min-max (hp)	16-35	16-35	20-50
Operating Weight (lbs)-hyd. rot. & defl.	437	455	479
Shipping Weight (lbs)	379	464	494
Approx. Set-up Time (min.)*	40	35	35
Chute Deflector Adjustment (standard)	Manual	Manual	Manual
Chute Deflector Adjustment (option)	Hydraulic cylinder (2"x6") - including hoses, and tips	Hydraulic - cylinder (2"x6") - including hoses, and tips Electric - 4" actuator - 1000 lbs. including hardware, switch, and electric cable.	Hydraulic - cylinder (2"x6") - including hoses, and tips Electric - 4" actuator - 1000 lbs. including hardware, switch, and electric cable.
Chute Rotation	Manual - worm gear w/ crank. Hydraulic - cylinder (2"x6") - including bracket, hoses, and tips	Manual - worm gear w/ crank. Hydraulic - cylinder (2"x6") - including bracket, hoses, and tips	Manual - worm gear w/ crank. Hydraulic - cylinder (2"x6") - including bracket, hoses, and tips
Chute	Two-part	Two-part	Two-part

* With manual chute rotation

Thank you so much for reading.
Please click the “Buy Now!”
button below to download the
complete manual.



After you pay.

You can download the most
perfect and complete manual in
the world immediately.

Our support email:

ebooklibonline@outlook.com