

OPERATOR'S MANUAL

SNOWBLOWERS

SB1392

SB1308

Serial #: 1XFSB13X_E0140001 & up

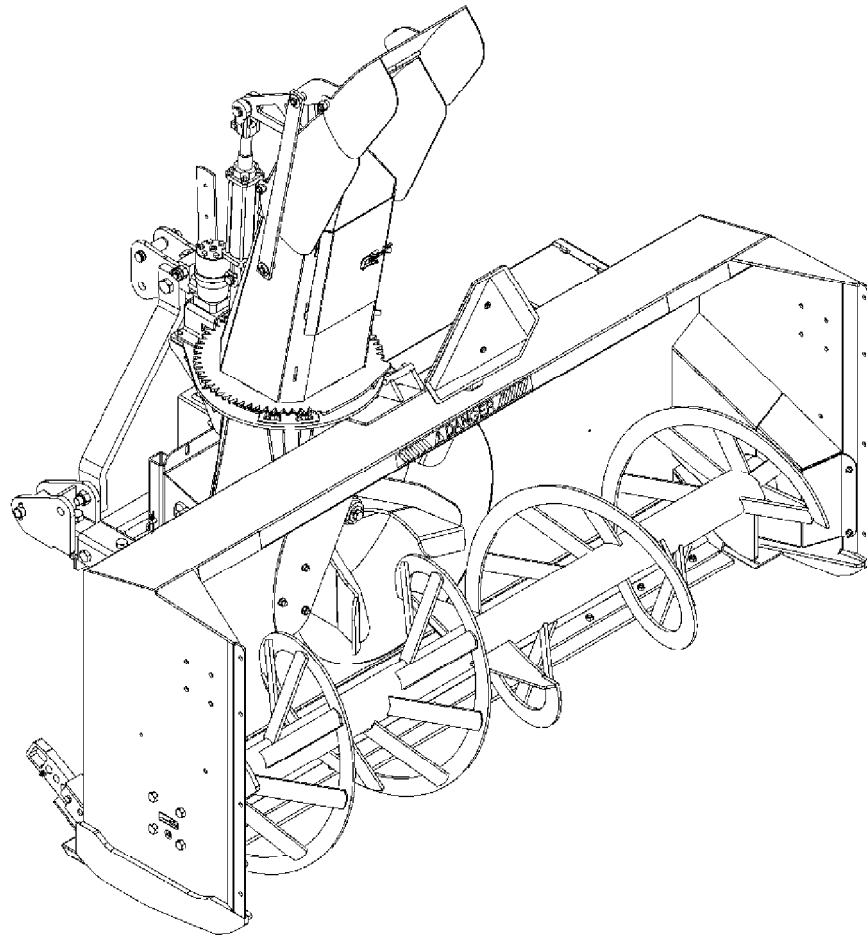

FRONTIER.

TABLE OF CONTENT

SPECIFICATIONS.....	3
INTRODUCTION – TO THE PURCHASER.....	4
SAFETY PRECAUTIONS	5-10
General Information.....	5
Before Operation	6
Notice.....	6
The Snowblower.....	6
Before Operation.....	6
Snowblower Operation	7
Stay Clear of Rotating Drivelines	8
The Tractor	9
General Information	9
Operating the Tractor.....	9
During operation	9
Maintenance	10
Transportation	10
Storage	10
SAFETY DECALS	11-12
ASSEMBLY.....	13-27
Tractor Preparation	13
Snowblower Assembly	13
Installation of SMV Sign	13
Installation of Three Point Hitch.....	14
Installation of the 5RDF0072 or 5RDF0073 Chute, and the Hydraulic Rotation	15
Installation of the 5RDF0071 Hydraulic Deflector– for 2 part Chute	16
Installation of the Hydraulic Hoses	17
A- Hoses of the chute rotation.....	17
B- Hoses of the chute deflector (if not installed)	17
Installation of Second Auger - 5RDF0064 (92") - 5RDF0065 (98")	19
Installation of Serrated Auger - 5RDF0068 (92") - 5RDF0069 (98").....	20
Installation of Drift Cutters - 5RDF0074	21
Installation of Stainless Skid Shoes - 5RDF0062	21
Installation of Lower Hitches for Quick Hitch - 5RDF0075	22
Installation of Snowblower with Three Point Hitch.....	23
Installation of Snowblower with Quick Hitch.....	24
Preparation of the Driveline	25
Recommendations for driveline angles	25
Angles at Each End of Driveline	25
Determining Driveline Length	26
Driveline Installation	28
Removing Snowblower from Tractor.....	28

TABLE OF CONTENT

OPERATION	29-31
General Preparation	29
Operating Controls	29
Raising and Lowering the Snowblower.....	29
Work and Travel Speed	29
PTO Operation.....	29
Chute Rotation Orientation.....	29
Hydraulic Chute Deflector Orientation	29
Adjustments	30
Manual Deflector Adjustment.....	30
Skid Shoe Adjustment.....	30
Chute Door Adjustment.....	30
Snow Removal Methods	31
MAINTENANCE	32-37
Maintenance.....	32
Driveline.....	32
Shearbolts	32
Driveshaft	32
Driveline	32
Chain Idler Adjustment	33
Lubrication.....	34
Driveline – Troubleshooting.....	35-37
PARTS	38-55
Introduction	38
Manual Holder	38
Chain Idler	39
Snowblower Assembly – Front Part	40
Snowblower Assembly – Rear Part.....	42
Three Point Hitch.....	44
Hydraulic rotation	46
Gearbox	47
Driveline	48
5RDF0072 - Two Part Chute	49
5RDF0073 - Three Part Chute	50
5RDF0071 - Hydraulic Deflector.....	51
5RDF0075 - Lower hitches for quick hitch	52
Second Auger - 5RDF0064 (92") - 5RDF0065 (98")	53
<u>Other Options: Drift Cutters - Stainless Skid Shoes -</u> Cutting Edges CHT400, Tivar, Stainless – Serrated Auger	54
TORQUE SPECIFICATION TABLE	55

SPECIFICATIONS

Specifications	SB1392	SB1308
General		
Type	2 phases	2 phases
Direction of impeller rotation	CCW	CCW
PTO power requirements	75 - 125 Hp	100 - 150 Hp
Shipping weight (without chute)	2045 Lbs	2083 Lbs
Operating weight, incl. chute & hyd. deflect.	2131 Lbs	2169 Lbs
Set-up time	90 min	90 min
Working width	92 1/2"	98 1/2"
Working height	41"	41"
Overall width	92 1/2"	98 1/2"
Overall height (without chute)	42 1/2"	42 1/2"
Overall height (with three part chute closed)	81"	81"
Overall length	61"	61"
Impeller		
Impeller diameter	30"	30"
Impeller width	12"	12"
Number of impeller blade	5	5
Impeller shaft diameter	2"	2"
Impeller RPM	540 RPM	540 RPM
Auger		
Auger - Single / dual	Single (dual in option)	Single (dual in option)
Main auger diameter	23"	23"
Auger driven system	Chain No.80	Chain No.80
Second auger diameter	14"	14"
Second auger driven system	Chain No.60	Chain No.60
Auger RPM	205 RPM	205 RPM
Drum		
Rotating drum	No	No
Rotation of drum	N/A	N/A
Flow restrictor	N/A	N/A
Housing		
Housing thickness	10 Ga.	10 Ga.
Side panel thickness	1/4"	1/4"
Impeller housing thickness	1/4"	1/4"
Chute		
Chute position	Right	Right
Rotation of the chute	Hydraulic by motor	Hydraulic by motor
Flow restrictor (rotation)	Yes	Yes
Flow restrictor (deflector)	Yes	Yes
Hoses support	Yes	Yes
Deflector adjustment (2 part chute)	Manual (hydraulic in option)	Manual (hydraulic in option)
Deflector adjustment (3 part chute)	Hydraulic	Hydraulic
Cutting edge		
Replaceable and reversible cutting edge	Yes	Yes
Cutting edge material	Carb.steel (other mater.available)	Carb.steel (other mater.available)
Cutting edge dimension	1/2" x 5"	1/2" x 5"
Skid shoe		
Replaceable and reversible skid shoe	Yes, 8 positions	Yes, 8 positions
Skid shoe material	Stand.steel (other mater.available)	Stand.steel (other mater.available)
Drive and hitch		
Main driving system	Driveline series 80	Driveline series 80
Chain idler	Twin sprokets w/compress.spring	Twin sprokets w/compress.spring
Parking stand	Yes	Yes
Number of auger shear bolt	2 (on the driving shaft)	2 (on the driving shaft)
Number of impeller shear bolt	1 (on the driveline)	1 (on the driveline)
Type of hitch	3 pts, cat. 2 & 3	3 pts, cat. 2 & 3
Compatibility with quick hitch	Requires kit 5RDF0075	Requires kit 5RDF0075

Thank you so much for reading.
Please click the “Buy Now!”
button below to download the
complete manual.



After you pay.

You can download the most
perfect and complete manual in
the world immediately.

Our support email:

ebooklibonline@outlook.com