



Combine
***CT5050, CT5060, CT5070
and CT5080***

REPAIR MANUAL

CE

9 - 43611

84099130

REPAIR MANUAL

Combine

CT5050

CT5060

CT5070

CT5080



CASE IH

CONTENS

	Section
Introduction	01
Traction and Steering Axle	02
Grain Header	03
Straw Elevator	05
Threshing	06
Separation	07
Cleaning	08
Grain Storage	09
Engine	12
Airconditioning	13
Hydraulic System	14
Hydrostatic System	15
Electrical System	16

INTRODUCTION

	Page
Explanation of machine and header serial numbers	3
Notes for Service Parts Catalogue consulting	4
Conversion chart	6
Tightening torques	7
Speed ranges	8
Oil application guide	11

EXPLANATION OF MACHINE AND HEADER SERIAL NUMBERS

Machine serial number

PRODUCT IDENTIFICATION

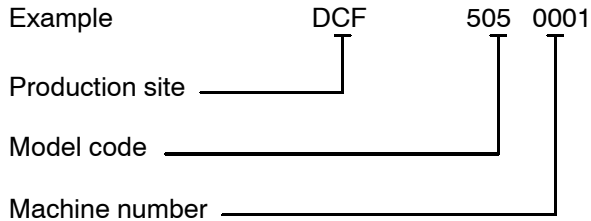

DCF 505 = CT 5050
 DCF 506 = CT 5060
 DCF 507 = CT 5070
 DCF 508 = CT 5080

Header number

PRODUCT IDENTIFICATION

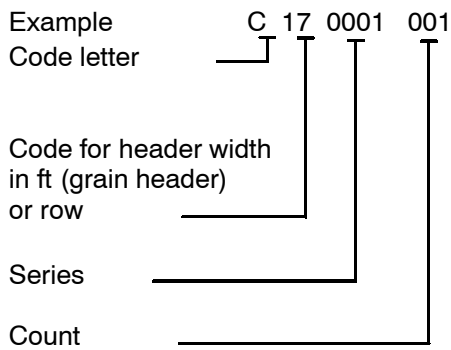

AVAILABLE HEADERS

- 12: 12 ft width grain header
- 13: 13 ft width grain header
- 15: 15 ft width grain header
- 17: 17 ft width grain header
- 20: 20 ft width grain header
- 24: 24 ft width grain header
- 56: 5-row maize header
- 6-row maize header
- 57: 7-row maize header
- 8-row maize header

NOTES FOR SERVICE PARTS CATALOGUE CONSULTING

NOTES FOR CATALOGUE CONSULTING

R	N	P.N.	MOD	Q	Description	Denominacion	Descrizione	Description	Bezeichnung	L.C.
1		8020804		1	TURBOCHARGER	TURBOCOMPRESOR	TURBOCOMPRESSORE	TURBOCOMPRESSEUR	TURBOLADER	210T
2		13517224		6	STUD	PRISIONERO	PERNO	STUDBOLT	STIFTSCHRAUBE	210P
3		61317796		1	GASKET	JUNTA HERMETICA	GUARNIZIONE	PAKING	DICHTUNG	1233
4		61317798		1	KIT REPAIR (3.8/10)	JUEGO DE REPARACION	KIT RIPARAZIONE	KIT DE REPARATION	REPARATURSATZ	003K
5		500382135		4	SCREW	SCHROEF	VITE	REPARATIONSSET	HERSTELIKIT	040V
6		13880121		4	WASHER	WASHER	ROSETTA PIANA	ROSETTE	FLACHSCHIVE	010D
7		14499521		1	WASHER	WASHER	ROSETTA PIANA	ROSETTE	FLACHSCHIVE	131R
8		4772331		1	GASKET	JUNTA HERMETICA	GUARNIZIONE	PAKING	DICHTUNG	123G
9	A	61318303	C 0202	1	GASKET	JUNTA HERMETICA	GUARNIZIONE	PAKING	DICHTUNG	123G
10		98412509	D 0300	1	GASKET	JUNTA HERMETICA	GUARNIZIONE	PAKING	DICHTUNG	123G

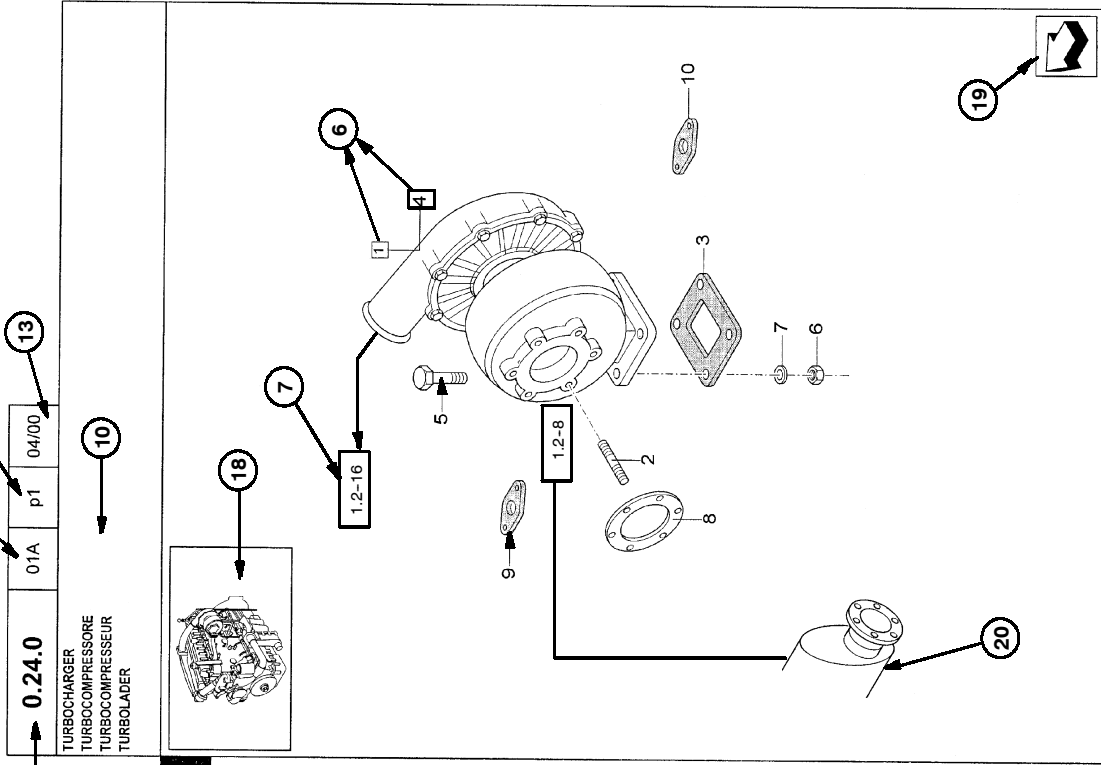

NIA = FOR FRANCE ONLY

CT 5080

ENGLISH

- 1 **R** - **Reference** - Code of **Part Number**
- 2 **PN** - **Part Number**.
- 3 **N** - **Note** - relating to the Part Number. There is a key to symbols and abbreviations at the bottom of the text page.
- 4 **Q** - Total **Quantity** of the Part referred to in page. The quantity can be replaced by the following indications:
M = supplied in metres.
AR = quantity as requested
- 5 **MOD** - Modification
C 0202 = **Part valid UNTIL 0202**.
D 0300 = **Part valid FROM 0300**.
 See Code Table in Spare Parts Catalogue.
- 6 - **1** is a subassembly and includes one or more additional parts,
 e.g. 1 = turbocharger includes part 4 - repair kit.
- 7 - Reference to the part or the subassembly associated with the part in question.
- 8 Model Trademark
- 9 "**Section**" code.
- 10 "**Group**" name.
- 11 "**Group**" code.
- 12 Sequential code within the subassembly
- 13 Date of printing or updating of page (month-year).
- 14 Page number within the sequential code
- 15 Part Description.
- 16 **L.C.-Lexicon code** for the identification of Part names in German and Spanish (see page 33).
- 17 Specific Notes to the **Illustrations** or to the text.
- 18 Position of the "**Section**" on the machine.
- 19 Running direction
- 20 Parts illustrated without item number are shown in the following group.

CONVERSION CHART

	Foot	Yard	Mile	Inch	Metre
1 Foot	1	0,333	-	12	0,3048
1 Yard	3	1	-	36	0,9144
1 Mile	5280	1760	1	63360	1609,35
1 Inch	0,833	0,277	-	1	0,0254
1 Meter	3,281	1,0936	-	39,37	1

1 US bushel	=	35,2391 l	1 l	=	0,0028 US bushel
1 US quart	=	0,9464 l	1 l	=	1,056 US quart
1 UK bushel	=	36,3687 l	1 l	=	0,027 UK bushel
1 UK quart	=	1,1365 l	1 l	=	0,879 UK quart
1 US gallon	=	37,85 l	1 l	=	0,264 US gallon
1 UK gallon	=	4,5461 l	1 l	=	0,22 UK gallon
1 barrel	=	158,987 l	1 l	=	0,0063 barrel

1 acre	=	0,4047 ha	1 ha	=	2,471 acre
1 pound	=	0,4536 kg	1 kg	=	2,204 pound
1 hp	=	0,736 kW	1 kw	=	1,358 hp
1 lb/in ²	=	0,0689 bar	1 bar	=	14,5 lbs/in ²
	=	6,894 kPa	1 kPa	=	0,145 lbs/in ²

1 pa	=	10 ⁻⁵ bar	1 bar	=	100 kPa
	=	1,450 x 10 ⁻⁴ bs/sq in	1 lb/in ²	=	6,896 kPa
1 kgf.m	=	9,806 Nm	1 Nm	=	0,1019 kgf.m
1 lbf.ft	=	0,1385 kgm	1 kgf.m	=	7,22 lbs.ft

TIGHTENING TORQUES

Metric hardware

Nominal size	Property class 5-8 Torque Nm		Property class 8-8 Torque Nm			Property class 10-9 Torque Nm	
	plain	plated	lock nut	plain	plated	plain	plated
M4	1,7	2,2	2,3	2,6	3,4	3,7	4,8
M6	5,8	7,1	7,9	8,9	12	3	17
M8	14	18	19	22	28	31	40
M10	28	36	38	43	56	61	79
M12	49	63	66	75	97	107	138
M16	121	158	164	186	240	266	344
M20	237	307	331	375	485	519	671
M24	411	531	573	648	839	897	1160

Imperial hardware

Diameter	SAE GR 2	SAE GR 5		SAE GR 8	
	TORQUE				
	Nm	Nm		Nm	
		A	B	A	B
1/4"	7	11	10	16	14
5/16"	14	24	20	35	29
3/8"	24	42	34	65	53
7/16"	42	72	58	102	81
1/2"	61	111	90	156	125
5/8"	111	231	190	319	258
3/4"	210	393	312	563	448
7/8"	224	583	461	814	651
1"	339	868	692	1220	976

A. Bolts not oiled

No identification

SAE - Grade 2

B. Bolts oiled

Identification

Specification



SAE - Grade 5



SAE - Grade 1



SAE - Grade 8

SPEED RANGES (maximum idle)

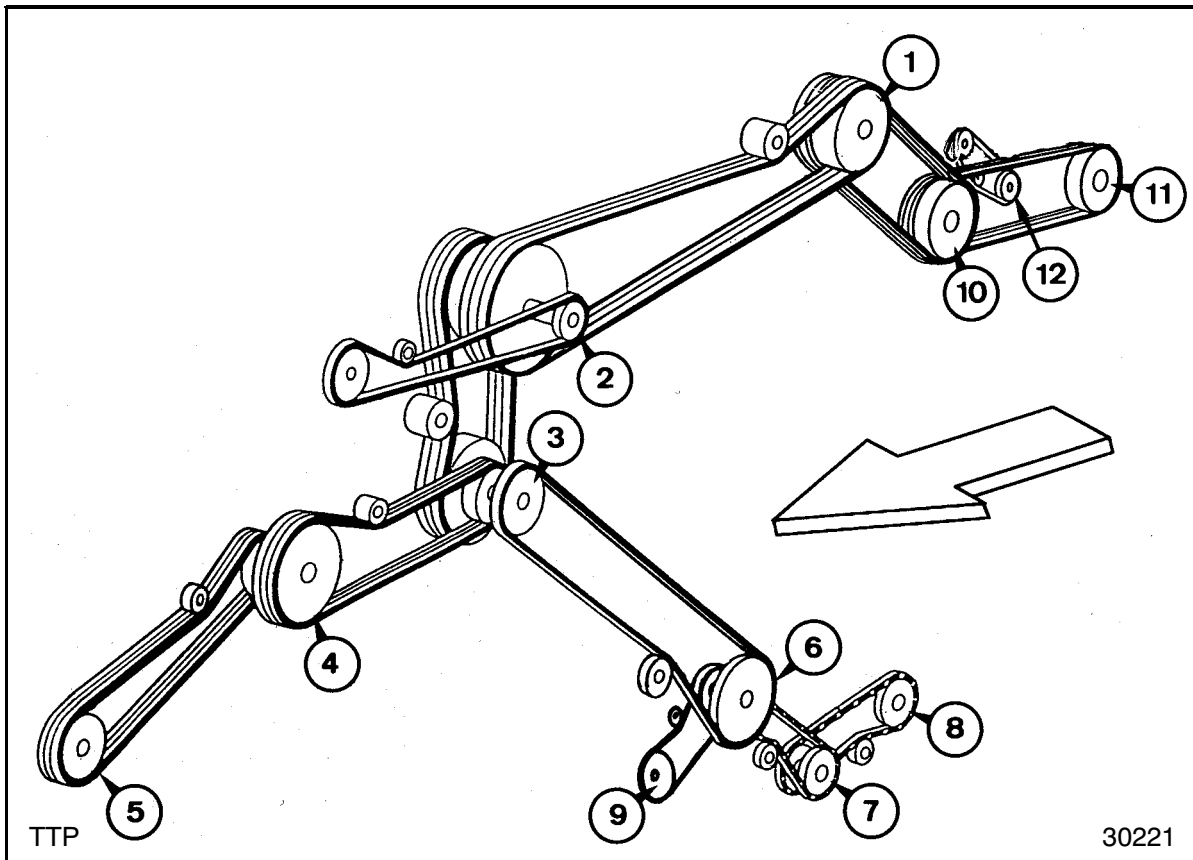

1

Combine left-hand side (Fig. 1)

CT5050 bis CT5070
rpm

CT5080
rpm

*

1 Engine	2200	2100	
2 Loose pulley on beater shaft	1340	1340	
3 Intermediate shaft	810	810	
4 Straw elevator top shaft	374	374	
5 Header drive	433	433	
6 Cleaning shoe drive	600	600	540*
7 Returns cross auger and roto-thresher, left-hand side (CT5070-CT5080)	800	800	720*
8 Returns auger and thrower, left-hand side (CT5070-CT5080)	600	600	540*
9 Eccentric shaft	320		320288*
10 Chopper drive	2805**	2805**	
11 Chopper	3500	3500	
12 Chaff spreader (input shaft)	330	330	

* When using small diameter drive pulley 3

** When engine speed 2100 rpm

Combine right-hand side (Fig. 2)

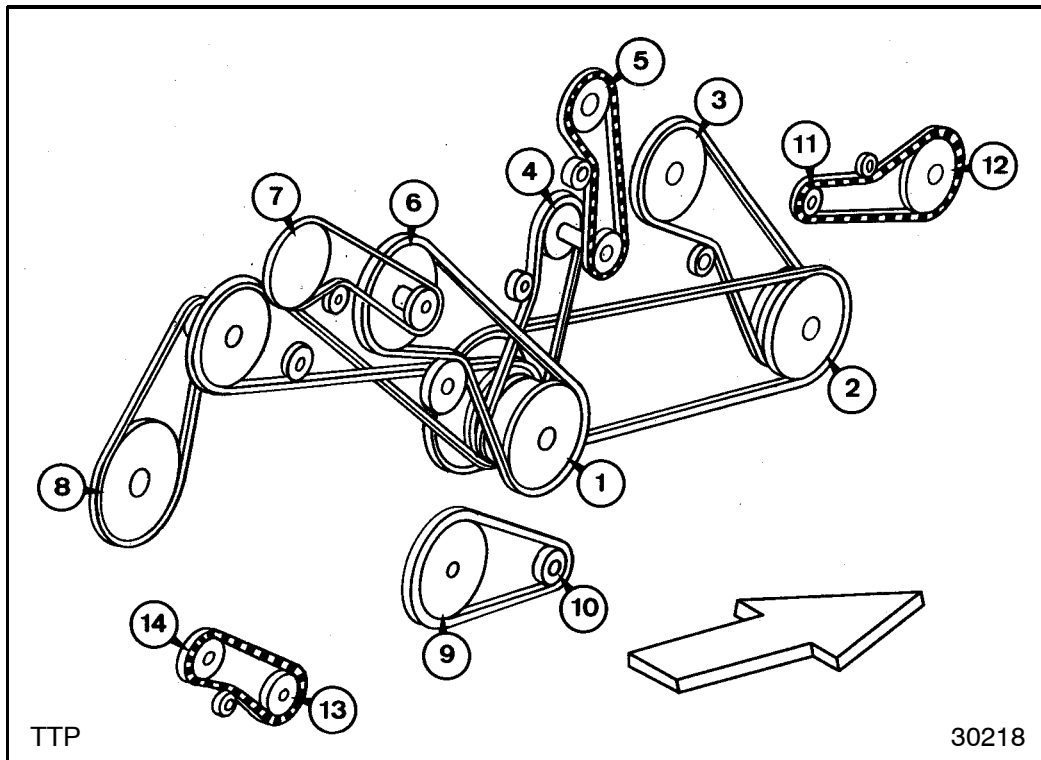

2

	rpm	*
1 Intermediate shaft	810	
2 Threshing drum	385 to 1140	
3 Beater	256 to 760	
4 Bubble-up auger speed (bearbox)		
standard:	370	
option:	441	
5 Gran elevator top shaft		
standard:	382	
option:	452	
6 Rotary separator	760 or 400	
7 Straw flow beater	760 or 400	
8 Straw walker	220	
9 Eccentric shaft	320	288*
10 Cleaning fan	500 to 920	450 to 838*
11 Graitank unloading intermediate shaft	1340	
12 Graitank unloading auger	604	
13 Returns cross auger and rotothresher	800	720*
14 Returns auger and thrower	600	540*

* When using small diameter drive pulley 3 on left-hand side

Combine engine compartment (Fig. 3)

	rpm
1 Engine	2100
2 Hydraulic pump	2121
3 Alternator	5426
4 Intermediate shaft	1527
5 Airconditioning compressor	3616
6 Rotary screen	225
7 Engine fan	1546

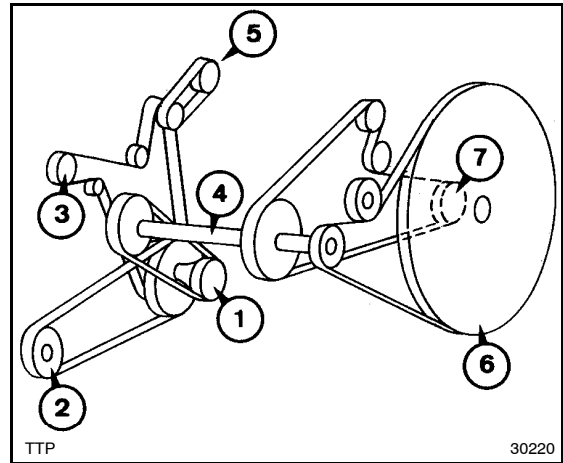

3

Grain header (Fig. 4)

1 Knife speed	575 rpm (1150 cuts/min)
2 Reel speed with 23-tooth sprocket 13-tooth sprocket	22 to 60 rpm 12,5 to 34 rpm
2 Auger speed with 58-tooth sprocket 68-tooth sprocket	178 rpm 152 rpm

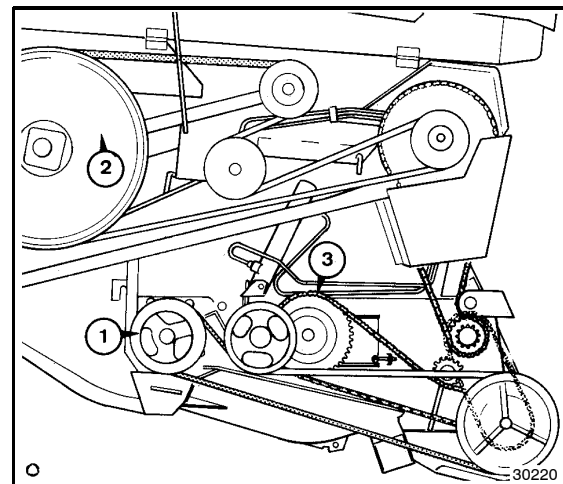

4

Maize header (Fig. 5)

1 Feed chains	
- for Z30 -	1,62 m/sec (5,81 km/h)
- for Z33 -	1,76 m/sec (6,33 km/h)
2 Tearing rollers	
- for Z30 -	956 rpm
- for Z33 -	1052 rpm
3 Feed auger	
- for Z30 -	119 rpm
- for Z33 -	131 rpm

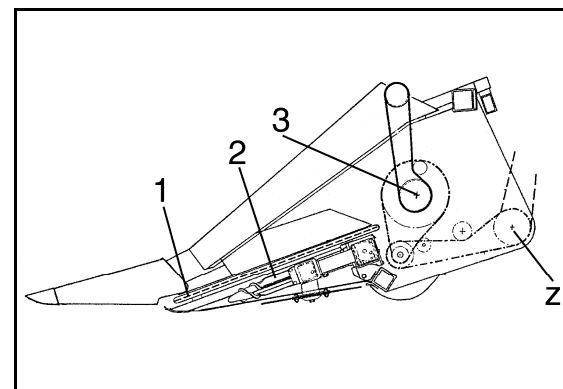

5

OIL APPLICATION GUIDE

Element	Quantity/unit (litres)	Designation	Lubricant class	International specification
Lubricating nipple	- - -	CASE multipurpose grease MZF/2	NLGI2	DIN51825
Gear box	15	CASE Gear Oil	SAE 80W90	API GL5,
Rear axle gear	CT5050: 5 Litres CT5060-CT5070 CT5080: 6 Litres	CASE Gear OIL	SAE 80W90	API GL5,
Engine (without filter)	CT5050-CT5060 CT5070: 21-23 Litres CT5080: 15-20 Litres	CASE Nr. 1 PLUS	SAE 15W40 SAE 15W40	APICG - 4SJ
Chains, threaded rods, hinge points	-	CASE Gear OIL	SAE 80W90	API GL5,
Brake system	0,5 (tank) 2 (System)	LS Additive for Brake	-	SAE J 1703, DOT 4, ISO 4925
Hydraulics (oil + filter)	20	CASE Hydraulik-Fluid 46	HPL	DIN 51524 Section 2, ISO VG 46
Hydrostatics (oil + filter)	18	CASE Hydraulik-Fluid 46	HPL	DIN 51524 Section 2, ISO VG 46
Treshing drum step-down gear	0,15 0,8	CASE multipurpose grease MZF/2 CASE Gear OIL	NLGI2 SAE 80W90	DIN 51825 API GL5,
Antifreezing agent	47,5 %	ANTIVRIES	-	-

TRACTION AND STEERING AXLE

	Page
Traction gearbox	2
- Removal	4
- Installation	5
- Disassembly	6
- Assembly	12
Brakes	
- Replacement of the brake linings	17
- Brake cylinders	18
- Bleeding the brakes	20
- Parking brake adjustment	22
- Disassembly and assembly of brake shoes and discs	23
- Hydraulic parking brake	25
- Hydraulic parking brake linings	27
- Replacement of the brake linings	28
- Bleeding the hydraulic handbrake	28
Final drives	
- General data	28
- Removal and installation of final drives	29
- Gear ratio 10/75 with standard seals	30
- Gear ratio 10/75 with mud seals	33
- Gear ratio 11/111 with standard seals	35
- Gear ratio 11/111 with mud seals	39
Steering axles	41
- Standard steering axles	41
- Fixed steering axle on models CT5050-CT5060	41
- Fixed steering axle on models CT5070-CT5080	43
- Heavy-duty adjustable steering axle	44

TRACTION GEARBOX

Oil change

- After the first 100 operating hours
- After 200 operating hours
- Thereafter, every 400 operating hours or annually

Oil quantity

15 litres

Oil specification

Use oil, meeting the following specification:

- CASE Gear Oil
- API-GL-5 or MIL-L-2105 D
- Viscosity grade: SAE 80W-90

Gear shifting diagram – Figure 1

Shaft A: half-shafts from differential

Shaft B: transmission main shaft

Shaft C: countershaft

Shaft D: drive shaft

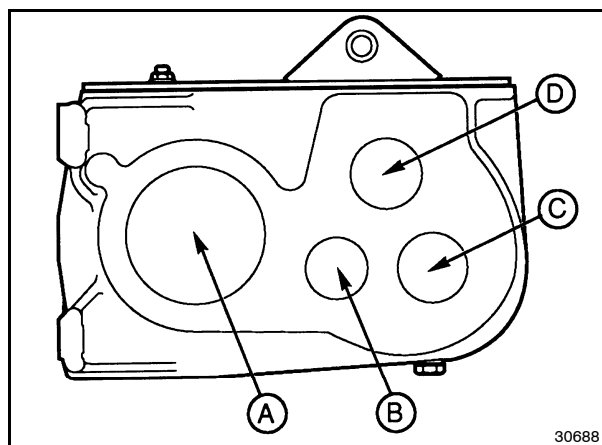

Shifting diagram – Figure 2

First gear: 1 - 2 - 3 - 4 - differential

Second gear: 1 - 2 - 5 - 6 - differential

Third gear: 1 - 2 - 7 - 8 - differential

Fourth gear: 1 - 2 - 9 - differential

Thank you so much for reading.
Please click the “Buy Now!”
button below to download the
complete manual.



After you pay.

You can download the most
perfect and complete manual in
the world immediately.

Our support email:

ebooklibonline@outlook.com