

---

# REPAIR MANUAL FOR ENGINES

## F4GE0484E - F4GE0684F - F4HE0684J

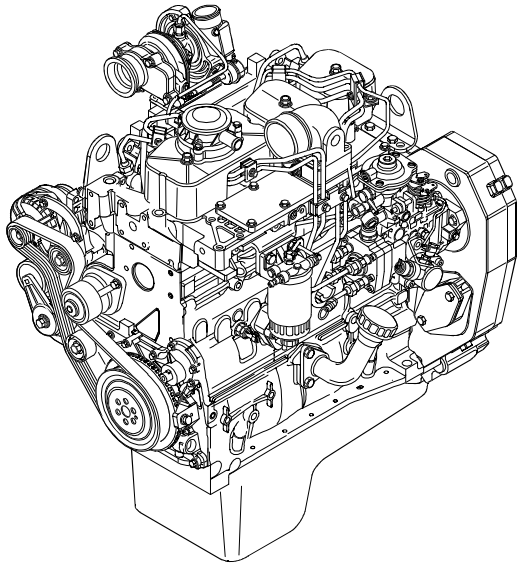

**F4GE0484E**

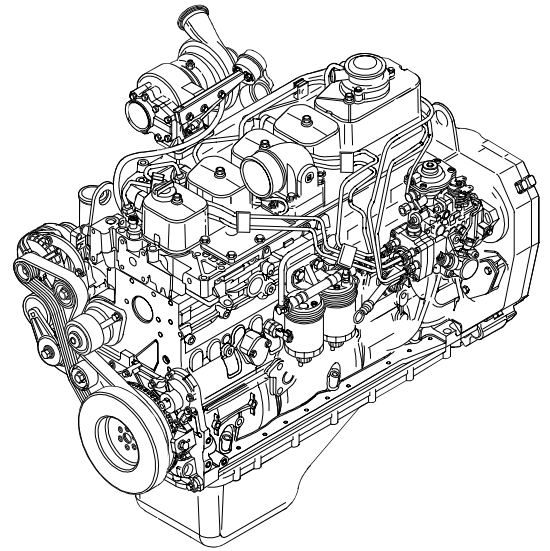

**F4GE0684F**

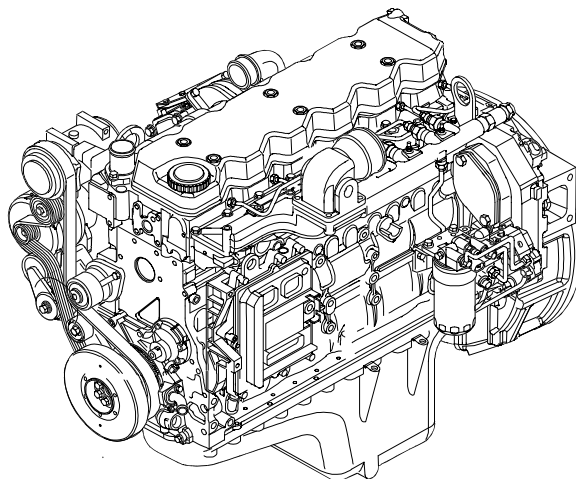

**F4HE0684J**

*Every information, illustration and specification contained in the present manual is based on the most recent information available at the time of printing.*

*CNH France S.A. reserves the right, to modify the text at any time without prior communication.*

# ENGINES

## INDEX OF SECTIONS



**Section 1** - Diagnostics

EW-1-1

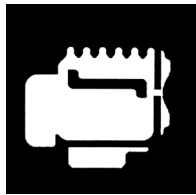

**Section 2** - Engine F4GE0484E overhaul

EW-2-1

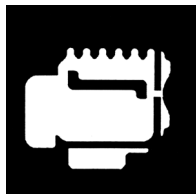

**Section 3** - Engine F4GE0684F - F4HE0684J overhaul

EW-3-1

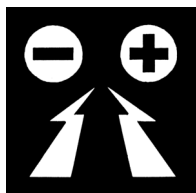

**Section 4** - Recharging and start-up

EW-4-1

## ENGINE F4GE0484E OVERHAUL

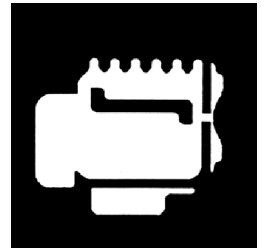

## INDEX

<b>Engine F4GE0484E</b> .....	EW-2-3	<b>Bushing</b> .....	EW-2-50
<b>Coding of source engines</b> .....	EW-2-4	Replacing the bushings .....	EW-2-51
<b>Main engine features</b> .....	EW-2-5	Tappets .....	EW-2-51
<b>General engine features</b> .....	EW-2-6	Mounting the tappets – Distributing shaft	EW-2-51
<b>Assembling play - specifications</b> ...	EW-2-8	<b>Drive shaft</b> .....	EW-2-52
<b>Tightening torque</b> .....	EW-2-14	Measuring the journals and crankpins .	EW-2-52
<b>Tools</b> .....	EW-2-15	Replacing the oil pump drive gears ....	EW-2-55
<b>Graphic indications and symbols</b> ...	EW-2-16	Mounting the main bearings .....	EW-2-55
<b>General remarks</b> .....	EW-2-17	Measuring the journal assembling play	EW-2-55
<b>Description of main mechanic</b>		Checking the drive shaft shoulder play .	EW-2-56
<b>engine components</b> .....	EW-2-18	<b>Connecting rod-piston assembly</b> ...	EW-2-57
Crankcase .....	EW-2-18	Pistons .....	EW-2-58
Drive shaft .....	EW-2-19	Measuring the piston diameter .....	EW-2-58
Drive shaft seal rings .....	EW-2-19	Gudgeon pins .....	EW-2-59
Connecting rods .....	EW-2-20	Conditions for correct pin/piston	
Pistons .....	EW-2-21	matching .....	EW-2-59
Distributing shaft .....	EW-2-22	Piston rings .....	EW-2-59
Valve control .....	EW-2-23	Connecting rods .....	EW-2-60
Cylinder head .....	EW-2-24	Bushings .....	EW-2-61
Valves and valve seats .....	EW-2-25	Checking the connecting rods .....	EW-2-61
Valve guides .....	EW-2-26	Checking the torsion .....	EW-2-61
Engine flywheel .....	EW-2-27	Checking the flexion .....	EW-2-61
Auxiliary component drive .....	EW-2-28	Mounting the connecting rod-piston	
<b>Lubrication</b> .....	EW-2-29	assembly .....	EW-2-62
Heat exchanger .....	EW-2-30	Connecting rod-piston match .....	EW-2-62
Oil pump .....	EW-2-31	Mounting the piston rings .....	EW-2-62
Oil sump .....	EW-2-32	Mounting the connecting rod/piston	
Oil vapour recirculation .....	EW-2-33	assemblies in the cylinder liners .....	EW-2-63
<b>Cooling</b> .....	EW-2-34	Measuring the crankpin assembling play	EW-2-63
Water pump .....	EW-2-35	Checking piston protrusion .....	EW-2-64
<b>Mechanic injection feeding system</b> .	EW-2-36	Valve gear .....	EW-2-64
Fuel prefilter .....	EW-2-36	Distribution gearbox case .....	EW-2-64
Fuel filter .....	EW-2-36	Valve timing .....	EW-2-65
Mechanic fuel pump .....	EW-2-37	Injection pump – 1 <sup>st</sup> phase .....	EW-2-66
<b>Injection assembly</b> .....	EW-2-38	Timing .....	EW-2-66
<b>Engine bench-overhaul</b> .....	EW-2-39	Flywheel cover case .....	EW-2-66
Disassembling the engine .....	EW-2-39	<b>Engine flywheel</b> .....	EW-2-67
Replacing the seal ring .....	EW-2-41	Replacing the engine flywheel ring gear	EW-2-67
Removing the injection pump .....	EW-2-42	Injection pump – 2 <sup>nd</sup> phase .....	EW-2-68
Removing the rocker arm assembly ...	EW-2-44	Mounting the injection pump –	
<b>Repair work on cylinder cluster</b> .....	EW-2-47	2 <sup>nd</sup> phase .....	EW-2-68
Checks and measurements .....	EW-2-47	Mounting the oil and water pumps ....	EW-2-69
Checking the surface supporting the		Mounting the water / oil heat exchanger	EW-2-71
head on the cylinder cluster .....	EW-2-48	Cylinder head .....	EW-2-71
Checking the eccentric lift and the pin		Removing the valves .....	EW-2-71
alignment .....	EW-2-49		
<b>Valve gear</b> .....	EW-2-49		
Distributing shaft .....	EW-2-49		

# INDEX

Checking the cylinder head supporting surface .....	EW-2-72	Rocker arm assembly .....	EW-2-77
Checking the cylinder head water seal .	EW-2-73	Mounting the injectors .....	EW-2-78
<b>Valves</b> .....	EW-2-73	<b>Replacing the injectors</b> .....	EW-2-81
Valve descaling, check and grinding ...	EW-2-73	Removal .....	EW-2-81
Checking the play between the valve stem, valve guide and valve centring ..	EW-2-74	Reassembling .....	EW-2-81
<b>Valve guide</b> .....	EW-2-74	<b>Rocker arm removal/reassembling</b> .	EW-2-82
<b>Valve seats</b> .....	EW-2-74	Removal .....	EW-2-82
Valve seat reconditioning - replacement	EW-2-74	Reassembling .....	EW-2-82
<b>Valve springs</b> .....	EW-2-76	<b>Adjusting the tappets</b> .....	EW-2-82
<b>Mounting the cylinder head</b> .....	EW-2-76	<b>Valve timing</b> .....	EW-2-83
Reattaching the cylinder head .....	EW-2-77		

---

**ENGINE F4GE0484E OVERHAUL**

---

**ENGINE F4GE0484E**

Figure 1

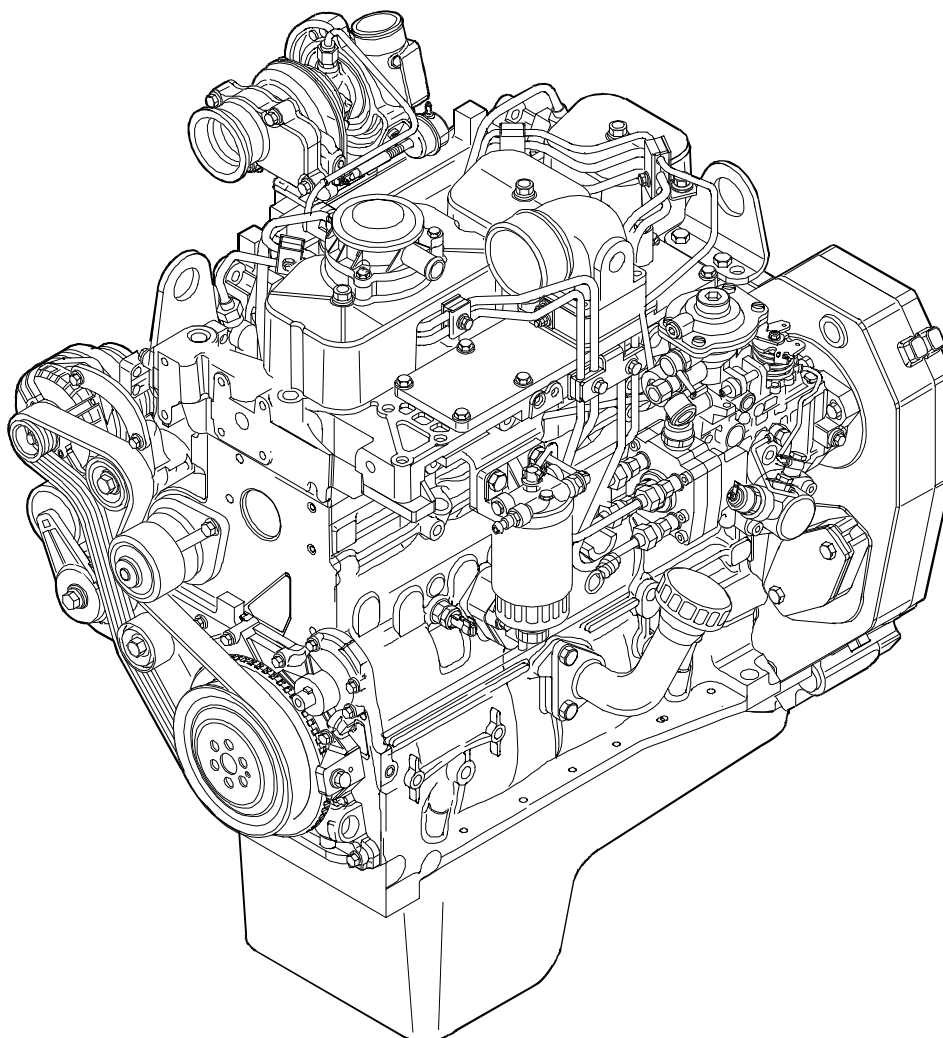

## DESCRIPTION OF MAIN MECHANIC ENGINE COMPONENTS

### Crankcase

It consists of a cast-iron structure in which the following items are realized: cylinder liners (1); bed supports (5) and seats for: distributing shaft bushings (3), tappets, water/oil heat exchanger (7), water pump (2) and oil pump (4).

It also incorporates the coolant circulation chambers and the engine member lubricating circuit ducts.

Plate (6) is fitted to the lower part of the crankcase and ensures greater resistance to forces and stress.

Figure 3

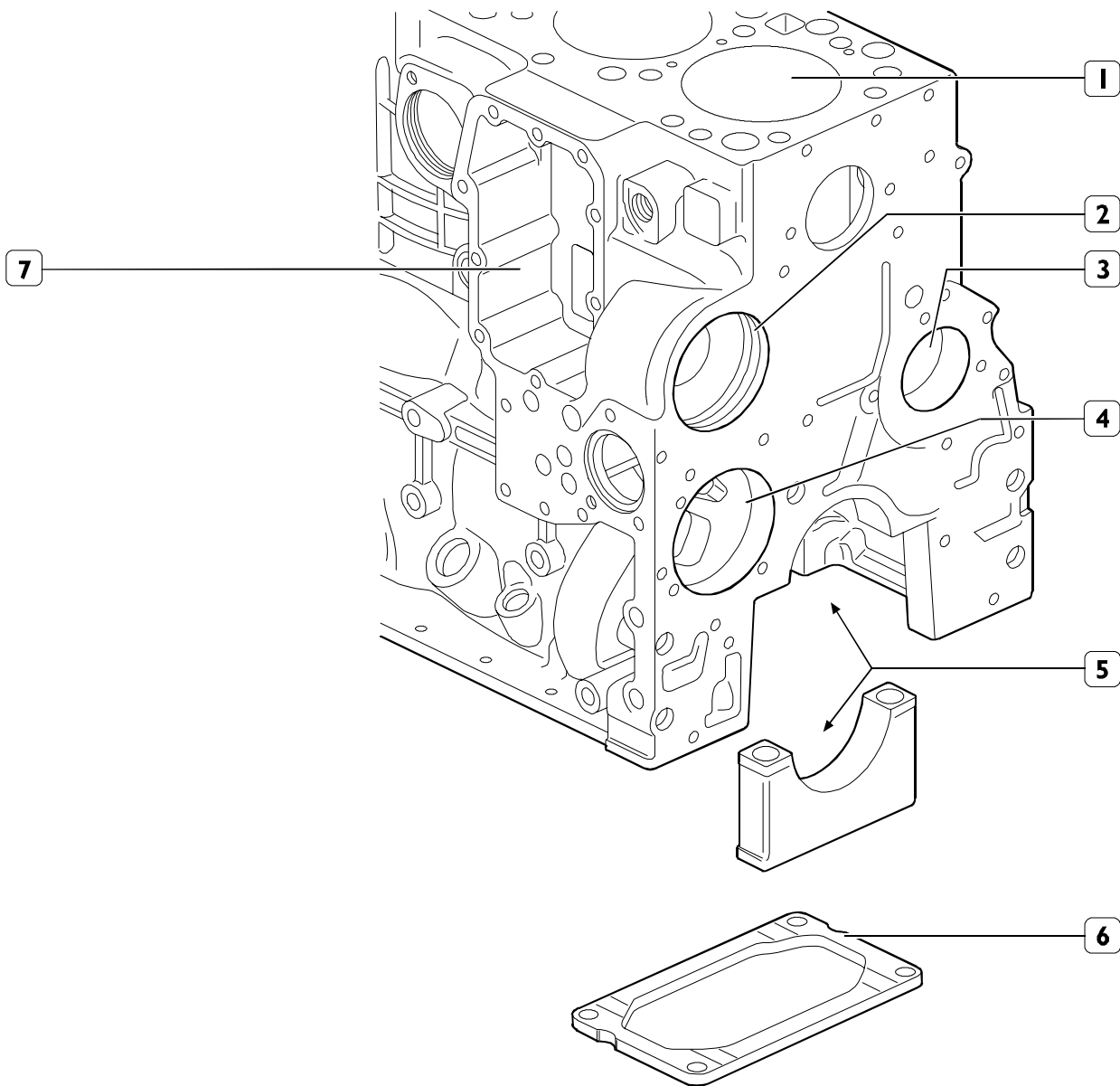

---

**ENGINE F4GE0484E OVERHAUL**

---

**Drive shaft**

It is made of steel and rests on five induction-hardened supports.

Inside the drive shaft are the lubricating oil ducts.

The following items are force-fitted on the front shank: oil pump drive gear, phonic wheel, damper flywheel and auxiliary component drive pulley.

The following items are force-fitted on the rear shank: distributing shaft drive gear and engine flywheel mounting hub.

The main half bearings are made of steel with anti-friction alloy coating.

The second main half bearing is equipped with a shoulder to restrain the drive shaft end play.

Parts (1) and (3) are mounted in an interfering manner on the rear shank and cannot be replaced.

Figure 4

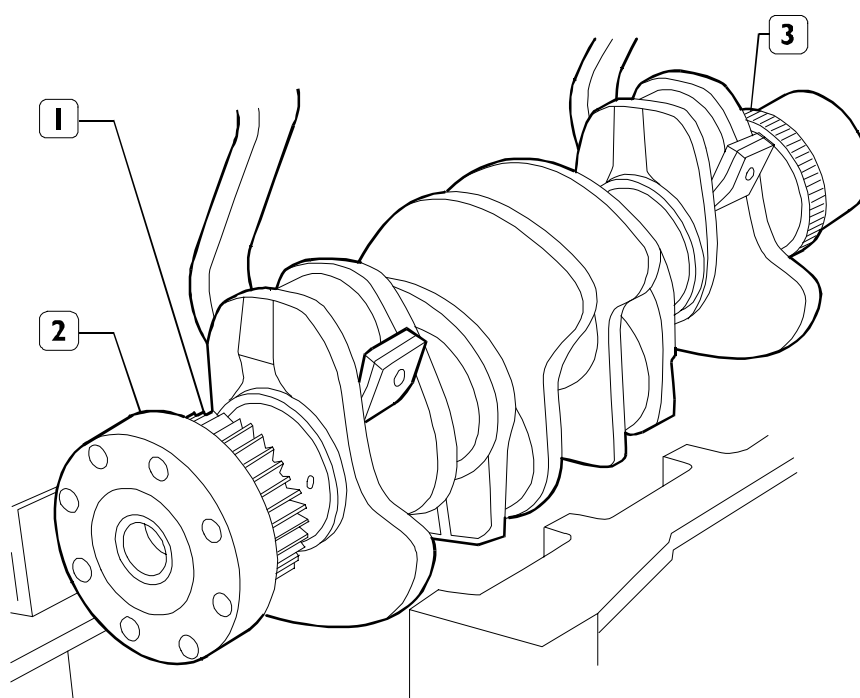

1. Valve gear drive gear - 2. Flywheel attachment hub - 3. Oil pump drive gear

**Drive shaft seal rings**

The front and rear seal rings are of the "box" type, with radial seal. They can be removed by means of tools 380000980 and 380000981, and mounted by means of tools 380000983 and 380000984.

**Connecting rods**

They are steel-stamped, of the oblique cut type, with separation of the cap obtained by an advanced technology (fracture split) instead of mechanic machining.

The connecting rod half bearings are made of steel, with anti-friction alloy coating.

Each connecting rod is marked:

- By a number (on the connecting rod body and cap) indicating its respective match and the cylinder in which it is mounted.
- By a letter (on the connecting rod body) indicating the weight class of the factory-assembled connecting rod.

Figure 5

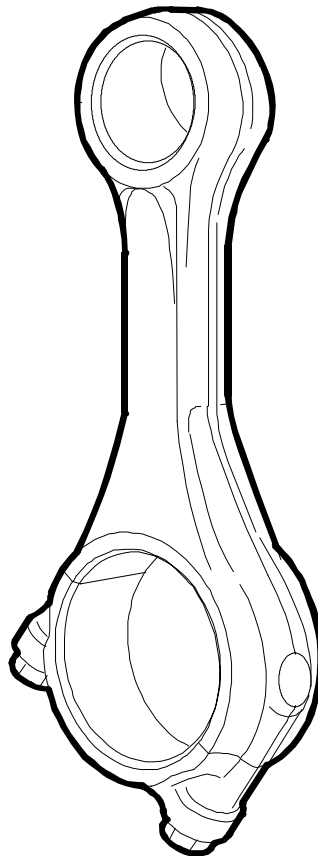



---

**ENGINE F4GE0484E OVERHAUL**

---

**Pistons**

The combustion chamber is machined in the piston crown. The crown of the piston is cooled by the engine oil supplied by the sprayer.

There are three grooves that house the compression rings; the 1st of which is V shaped and is obtained using a cast iron insert.

The following references are engraved on the crown of the piston:

1. Spare part number and design change number.
2. Arrow indicating the assembly sign of the piston in the cylindrical liner; this must be facing towards the front side of the engine block.
3. Date of manufacture.
4. Stamp indicating testing of the 1st groove insert

Figure 6

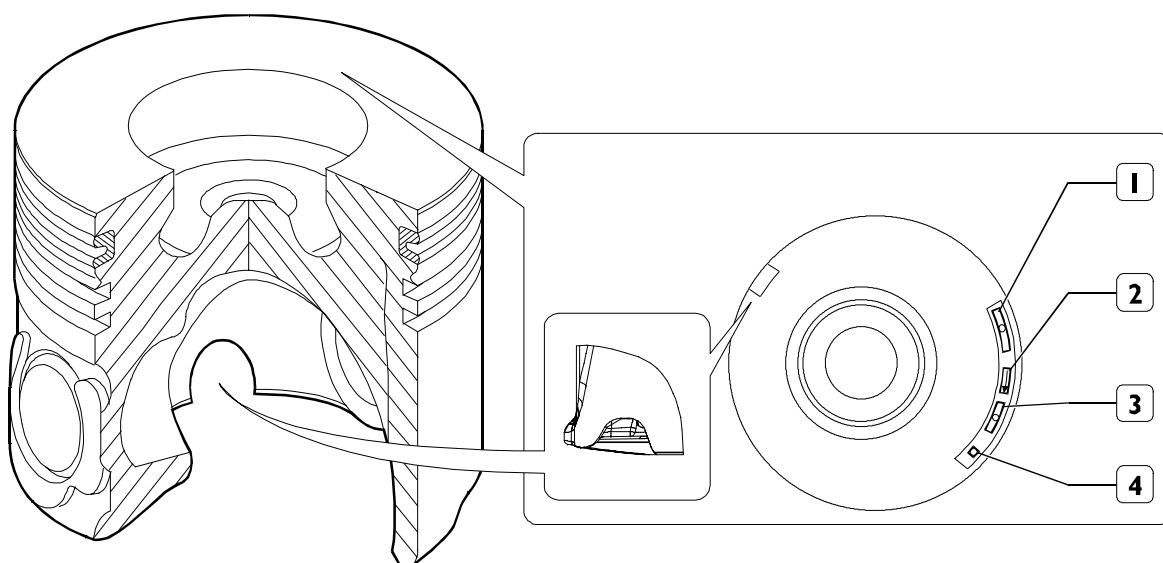

**Distributing shaft**

The distributing shaft rests on five supports in the crankcase.

The supports (front and rear) are equipped with steel bushings mounted in an interfering manner and coated with anti-friction material; two control eccentrics are provided for each cylinder.

**A.** Intake valve control

**B.** Exhaust valve control

The distributing shaft is controlled directly by the drive shaft by means of straight-tooth gears.

Figure 7

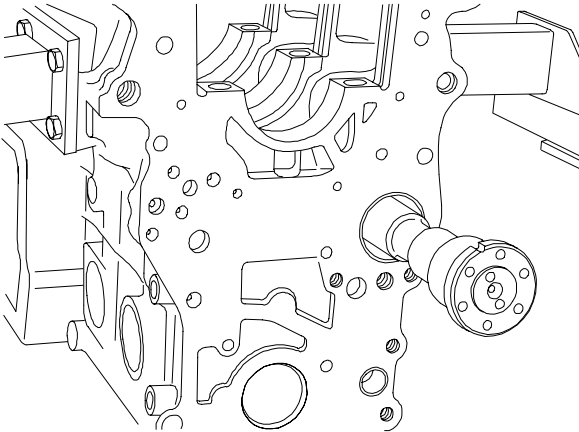

70164

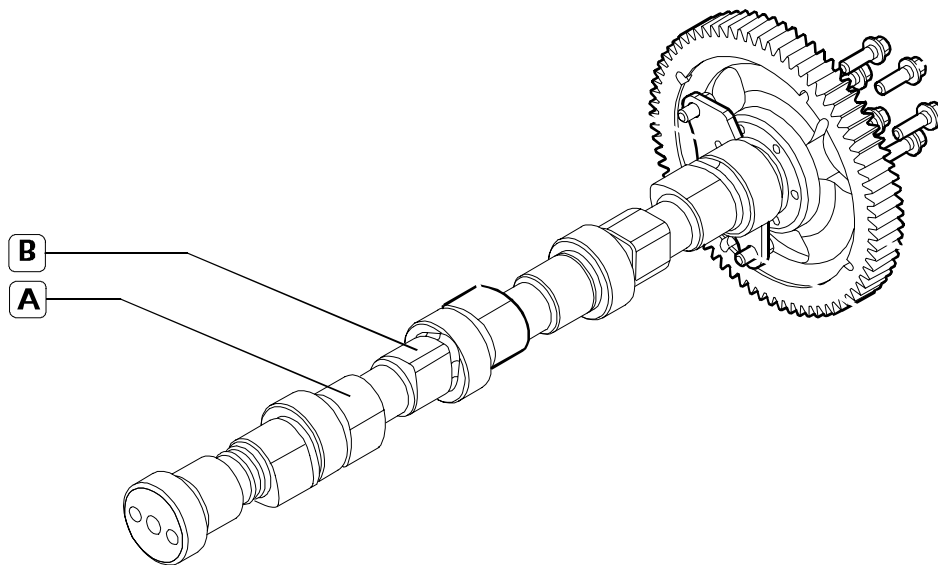

## ENGINE F4GE0484E OVERHAUL

## Valve control

Figure 8

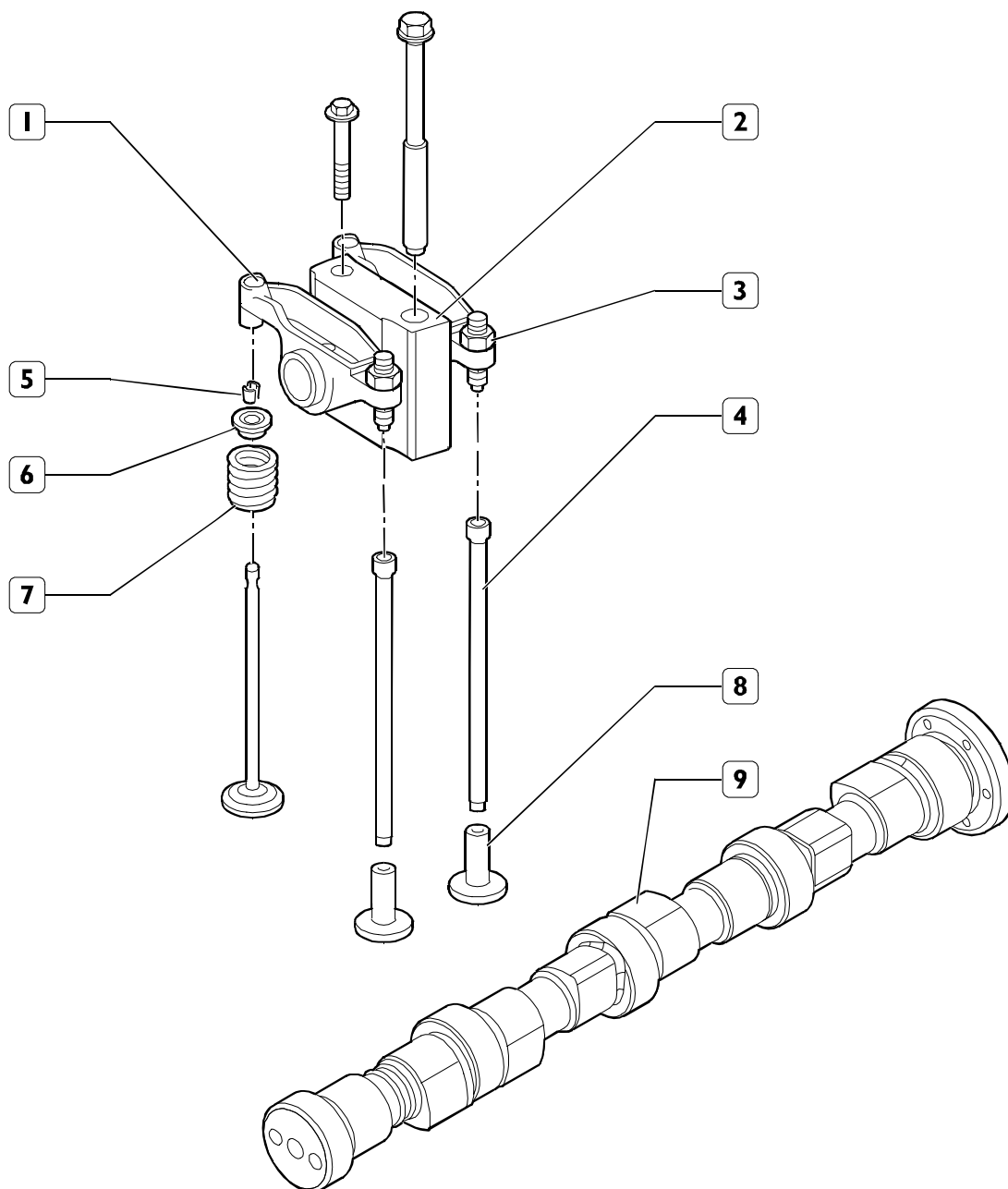

1. Rocker arm – 2. Arbour support – 3. Adjusting screw – 4. Rod – 5. Lock cones – 6. Cup – 7. Spring –  
8. Tappet – 9. Distributing shaft

**Cylinder head**

The seats of the following parts are obtained from the cast-iron cylinder head:

- inserted valve seats (4);
- injector (6);
- thermostat (5);

Moreover, the following components are inserted on the heads:

- single-block exhaust manifold (1);
- intake manifold (2) with seat for cold start air heater (3).

Figure 9

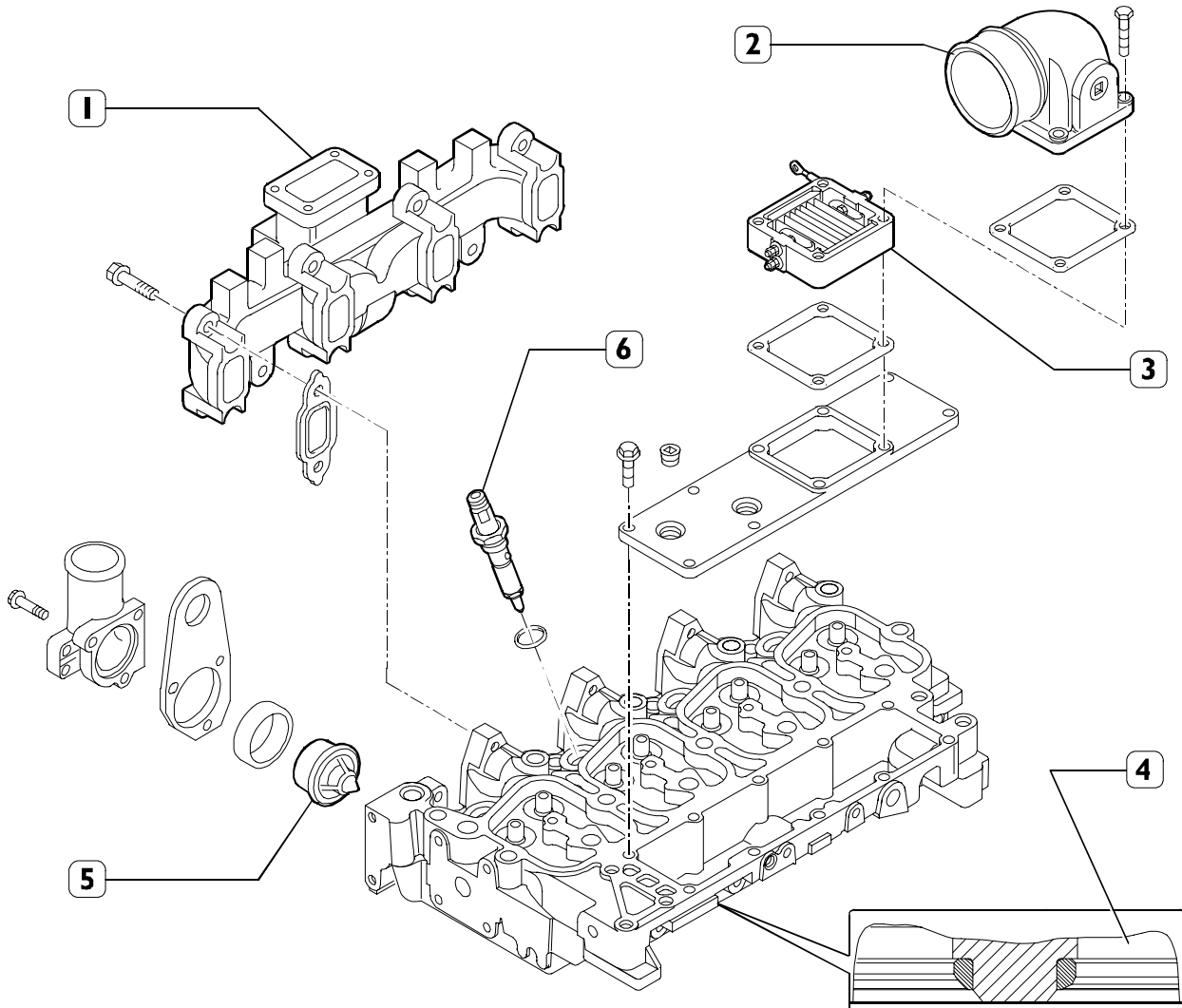

84240

DETAIL OF CYLINDER HEAD WITH INSERTED VALVE SEATS

## ENGINE F4GE0484E OVERHAUL

## Valves and valve seats

Figure 10

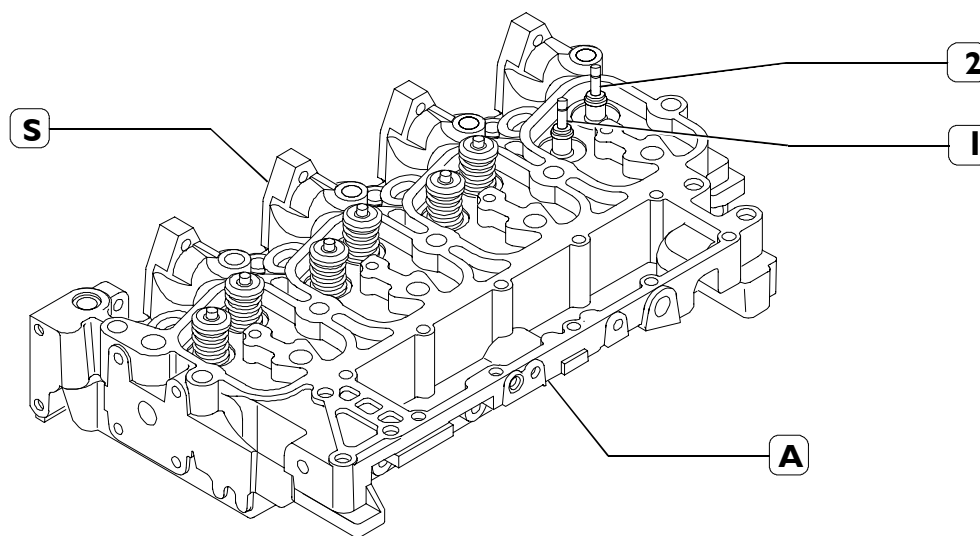

1. Intake valve - 2. Exhaust valve - A. Intake side - S. Exhaust side.

84241

The valve seats inserted on the cylinder head have the following inclination:

- 45° (exhaust valves)
- 60° (intake valves).

The exhaust valves (2) differ from intake valves in that they have only one notch at the stem end.

Figure 11

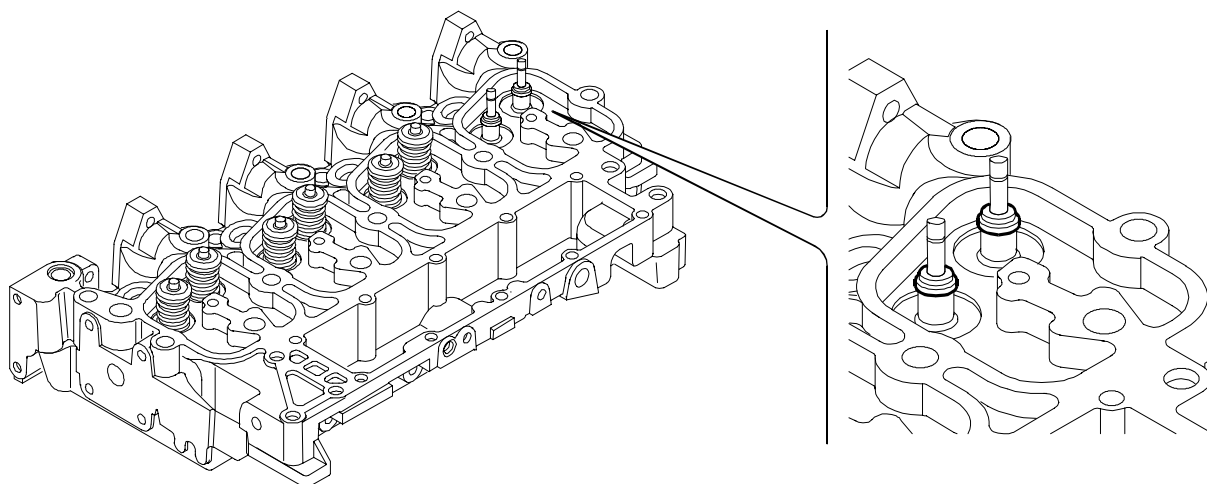

84242

Figure 11 shows the oil seals mounted on valve stems.

Valve guides

Figure 12

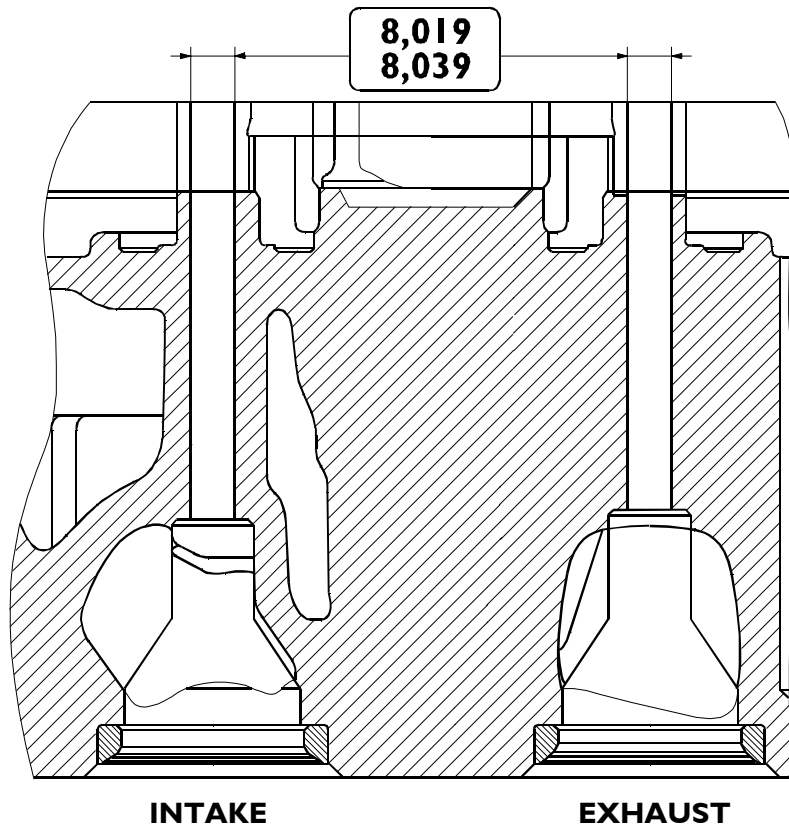

84046

DETAIL OF VALVE GUIDES AND SEATS

---

**ENGINE F4GE0484E OVERHAUL**

---

**Engine flywheel**

The flywheel (1) does not need being positioned in a fixed manner on the drive shaft, since it does not bear any stamping, notch or reference hole for sen-

sors or timing. The equidistance of fastening screw holes (2) allows it to be mounted in any position.

Figure 13

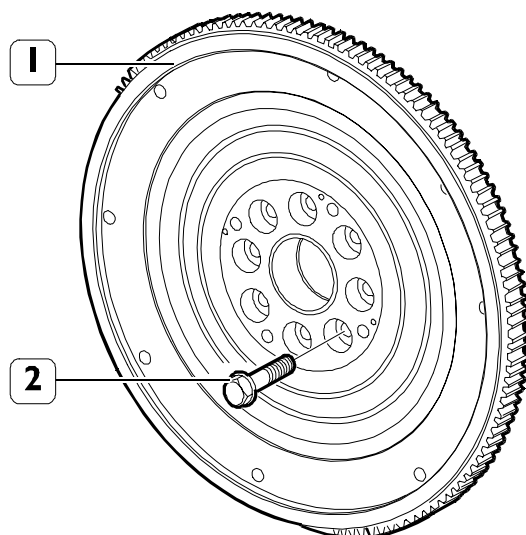

**Auxiliary component drive**

A Poly-V belt (4) transmits the movement of the crankshaft (5) to the water pump (1) and to the alternator (2).

The belt is stretched by means of automatic belt stretcher (3).

Figure 14

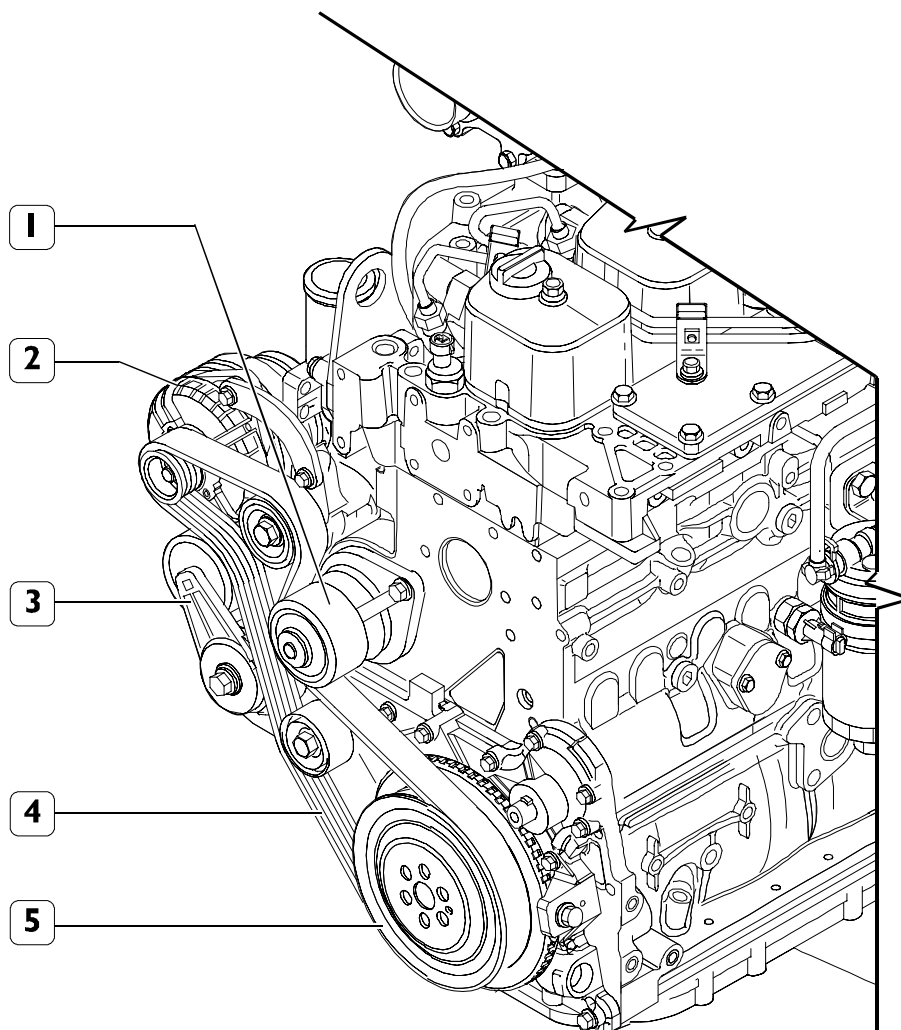

1. Water pump - 2. Alternator - 3. Belt stretcher - 4. Poly-V belt - 5. Drive shaft



## ENGINE F4GE0484E OVERHAUL

**LUBRICATION**

Forced circulation lubrication is performed by the following components:

- rotor-equipped oil pump housed in the crank-case front part, controlled by the straight-tooth gear force-fitted on the drive shaft shank;
- water / oil heat exchanger housed in the crank-case;
- oil pressure control valve;
- by-pass valve for clogged oil filter cut-off, built into the oil filter adapter;
- cartridge-type oil filter.

Figure 15

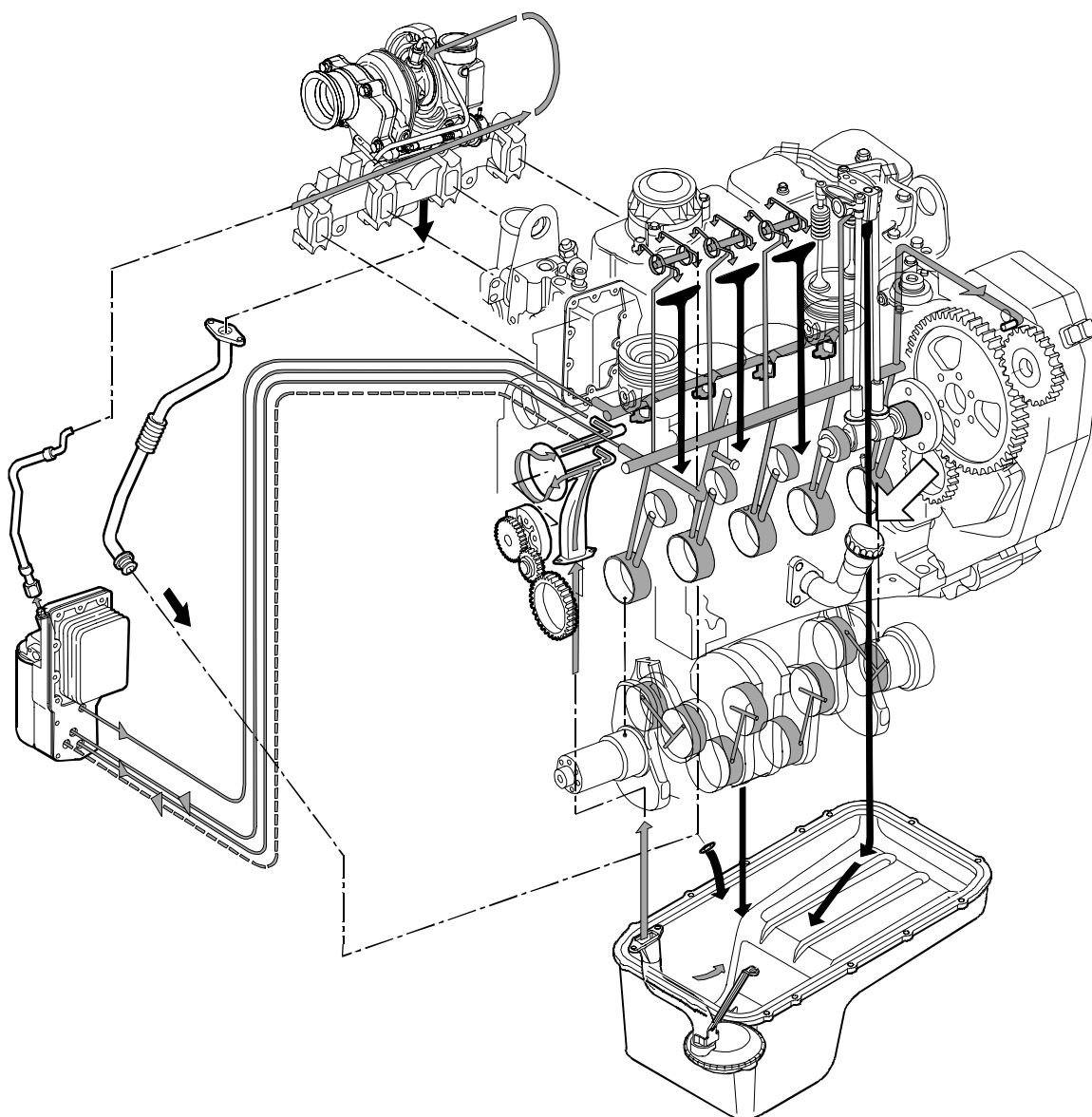

 Oil return drop-type path

 Pressure oil path

 Oil supply

Heat exchanger

Figure 16

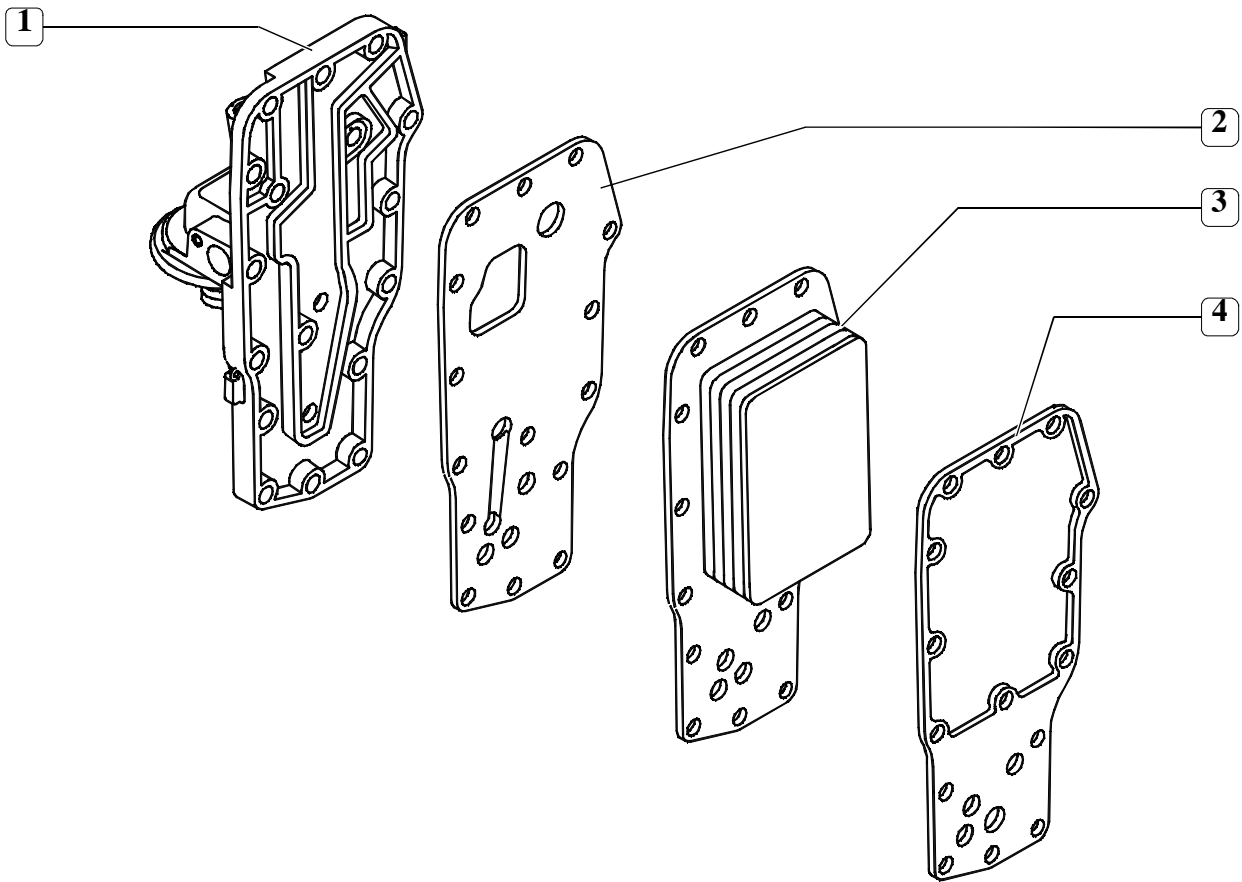

- 1. Heat exchanger body – 2. Inner gasket – 3. Water / oil heat exchanger – 4. Gasket between exchanger unit and engine block

## Oil pump

Figure 17

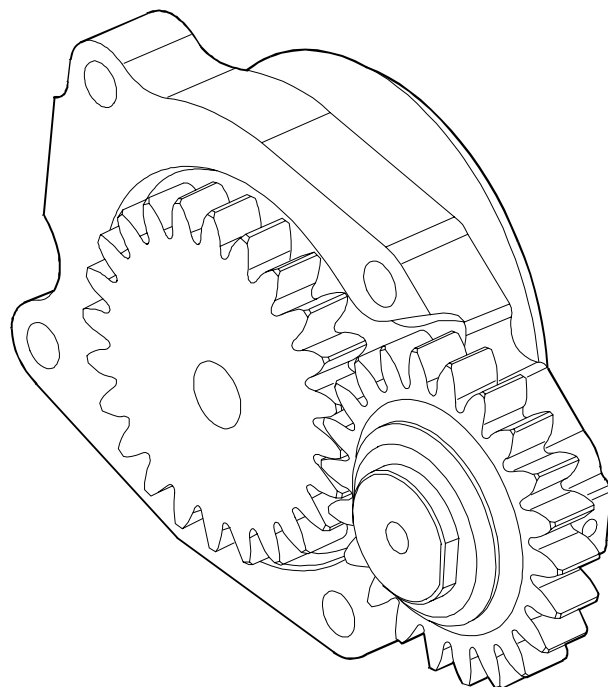

84052

Figure 18

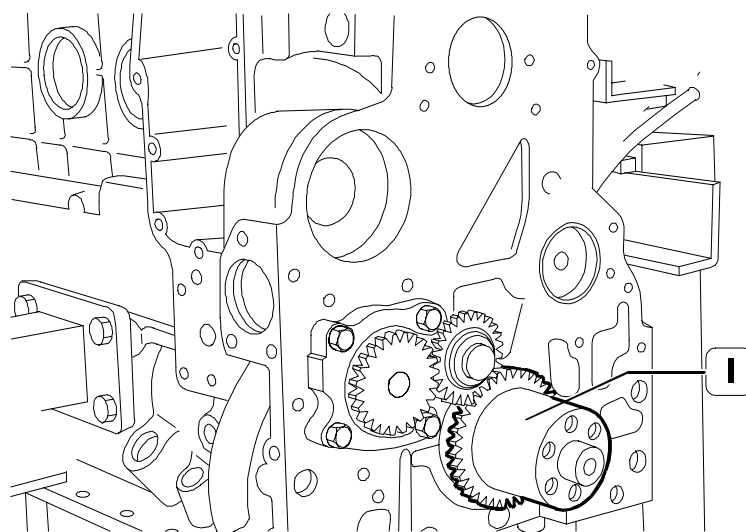

70150

1. Drive shaft with oil pump drive gear

**Oil sump**

The oil sump (1) is secured elastically to the crankcase by means of an aluminium plate (3), Figure 19.

The C-section rubber gasket (2) (fitted onto the oil sump leading profile) enhances sealing properties and also deaden noise.

This type of gasket can only be replaced in case of deterioration or break, and not necessarily at every single disassembling operation.

Figure 19

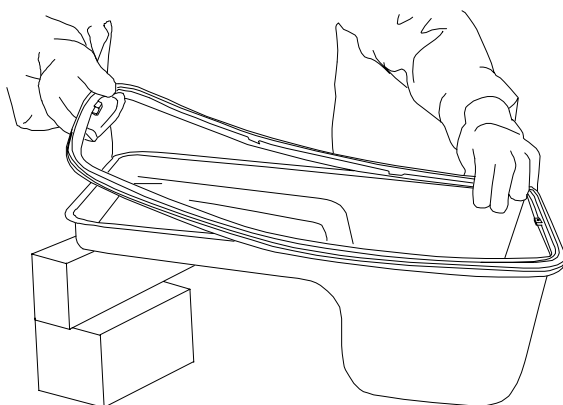

84245

Figure 20

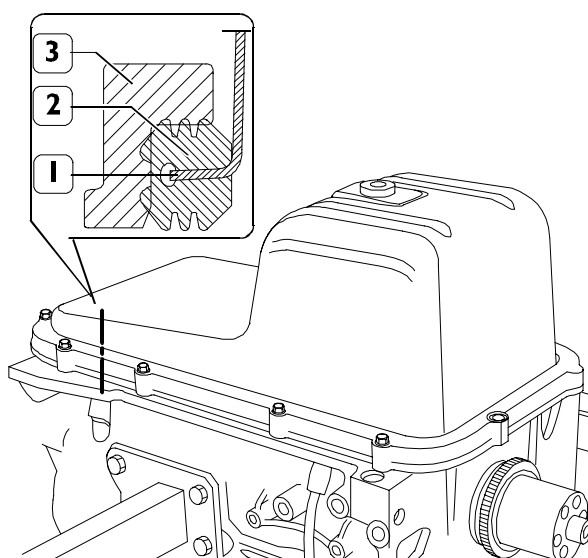

84246

Thank you so much for reading.  
Please click the “Buy Now!”  
button below to download the  
complete manual.



After you pay.

You can download the most  
perfect and complete manual in  
the world immediately.

Our support email:

[ebooklibonline@outlook.com](mailto:ebooklibonline@outlook.com)