

KEY	PART NO.	PART NAME	QTY	Engine Serial No.	REMARKS	
1	CYLINDER BLOCK	NA	____-129992	(MARKEDR502568) (USE WITH RE515352)	
1	CYLINDER BLOCK	NA	129993-____	(MARKEDR522220) (USE WITH RE529912)	
2	R528188	PIN	4			
3	R502725	PLUG	1		(Dipstick Tube)	
4	RE71255	PIPE PLUG	25		1/8"-27NPT	
5	34M7247	SPRING PIN	2		11 X 16 mm	
6	R504965	PLUG	1			
7	15H685	PIPE PLUG	1		1/4"	
8	R48685	DOWEL PIN	2		(SUB FOR A120R)	
9	R116466	PLUG	6			
10	R515003	SCREW	8			
11	R515004	SCREW	2			
12	R505135	ORIFICE	4			
13	R503315	BUSHING	4			
14	T18891	PLUG	1		OD=16MM	
15	R504808	BUSHING	4			
16	34M7094	SPRING PIN	1		4 X 16 mm	
17	L157372	SCREW	2			
18	CAMSHAFT	1		(MARKEDR528140) (ORDER RE524771)	
18	RE524771	CAM KIT	1			
18	SE501618	CAMSHAFT REMAN	1		(REMAN FOR RE524771)	
19	RE518215	BALL BEARING	1			
..	COMPLETE BLOCK ASSEMBLY	1		(9901)	
..	OIL PUMP INTAKE	1		(1900)	

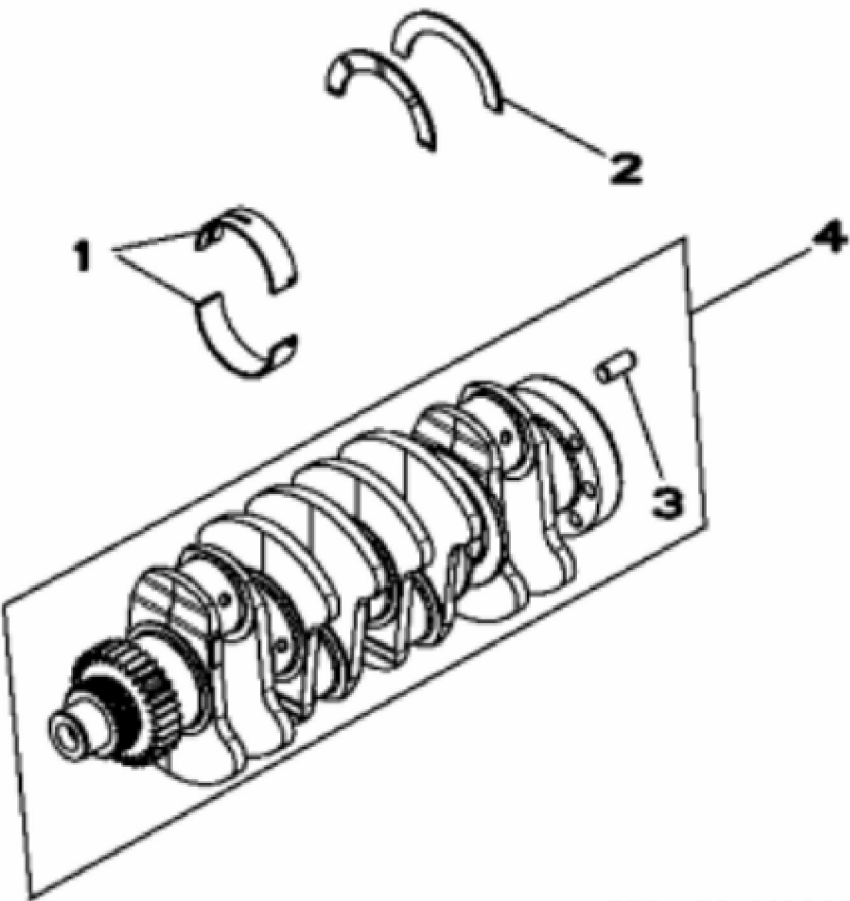

RE504881PCDD06

John Deere > Turf And Utility>TRACTOR, COMPACT UTILITY >4320 - TRACTOR, COMPACT UTILITY >4320 Compact Utility Tractor >20 ENGINE 4024TLV01-RE516053 >ST293065 - 4701 CRANKSHAFT / BEARINGS

KEY	PART NO.	PART NAME	QTY	REMARKS	
1	BEARING KIT	5	STD (9901) (ORDER RE520626)	
2	R502796	THRUST WASHER	2	(1 PC)	
2	KIT	1	(2 PC), (9901)	
3	R48685	DOWEL PIN	1		
4	RE504879	CRANKSHAFT	1		
4	SE501642	CRANKSHAFT REMAN	1	(REMAN FOR RE504879)	

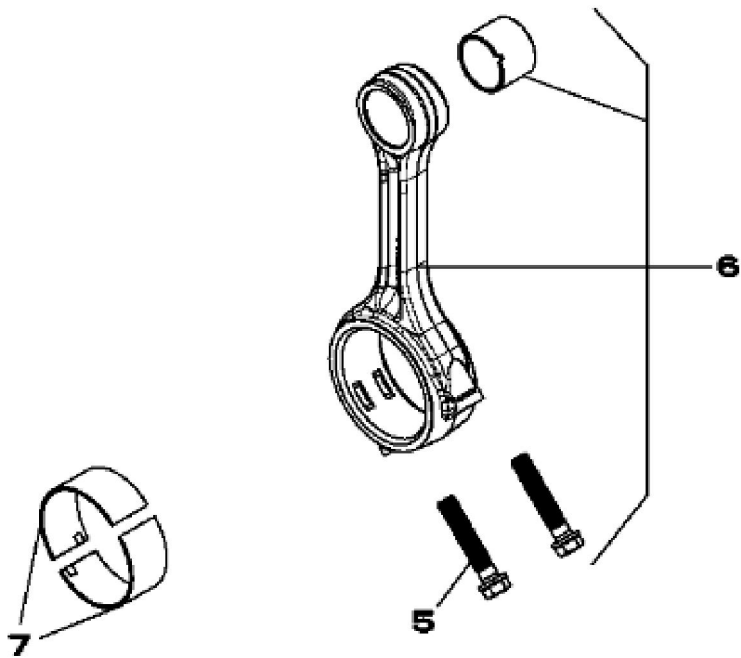
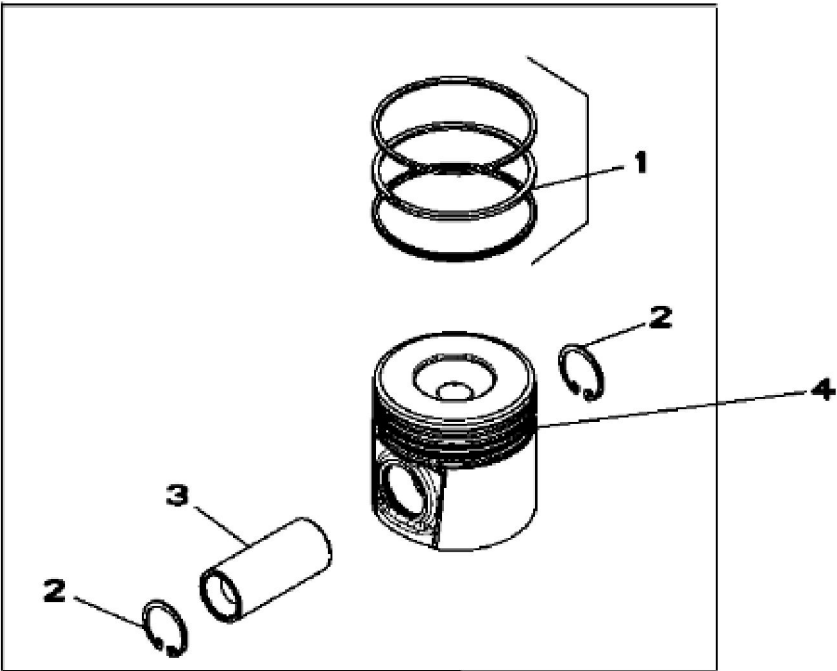

RE522989PCDA03

KEY	PART NO.	PART NAME	QTY	REMARKS	
1	RE520935	PISTON RING KIT	4		
2	40M1855	SNAP RING	8		
3	R503480	PISTON PIN	4	OD=30MM	
4	RE522308	PISTON REPLACEMENT KIT	4	STD (MARKED RE522094)	
5	R502503	SCREW	8	M10 X 49	
6	RE504544	CONNECTING ROD	4		
6	SE501898	CONNECTING ROD REMAN	4	(REMAN FOR RE504544)	
7	RE520937	BEARING KIT	4		

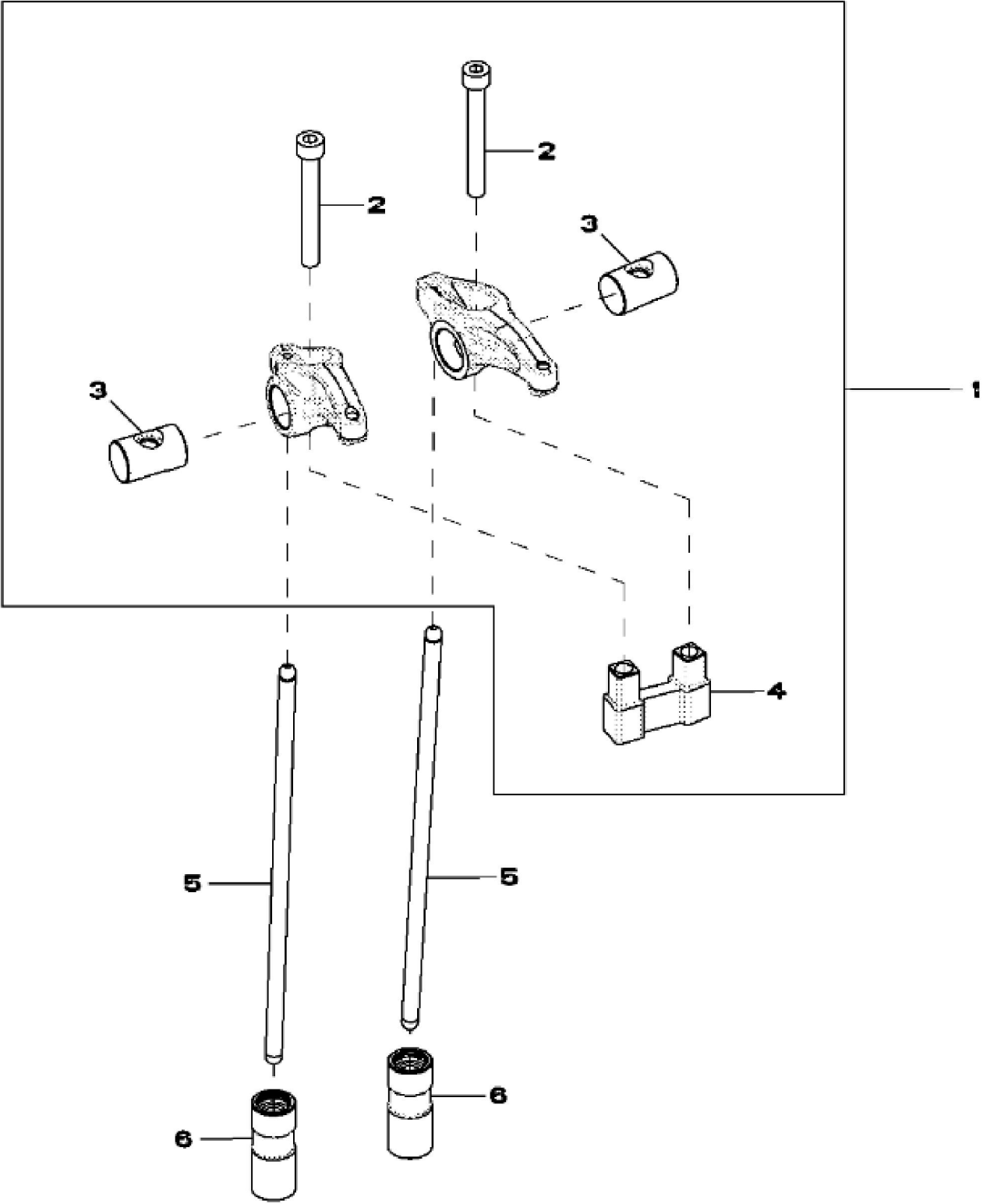

Thank you so much for reading.
Please click the “Buy Now!”
button below to download the
complete manual.



After you pay.
You can download the most
perfect and complete manual in
the world immediately.

Our support email:
ebooklibonline@outlook.com