

Section: ENGINE  
CRANKCASE

Fig.	P/n	QTY	Name
------	-----	-----	------

Notes:

[Trident 130 Export]

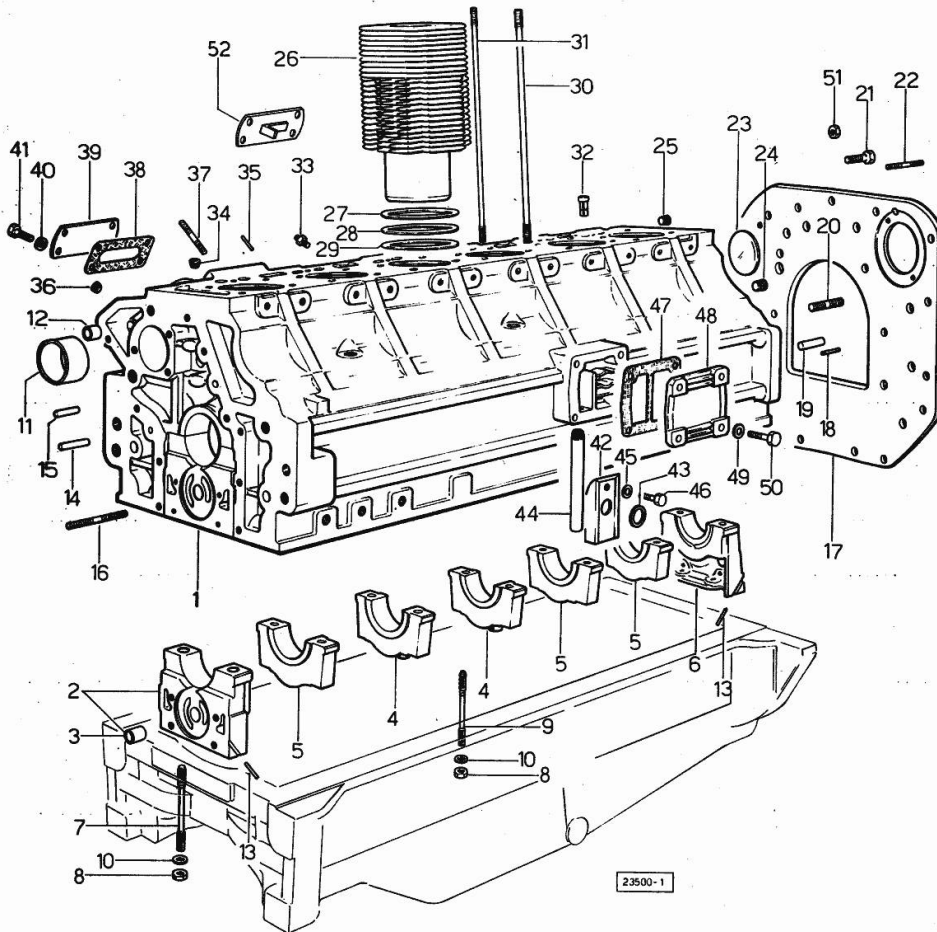

0	0.046.0050.6	1	gasket set FOR ENGINE ASSEMBLY
1	0.047.1110.4/50	1	crankcase
2	0.004.8774.3	1	support
3	2.1559.090.0/10	1	bushing 14.24x19.06x27
4	0.037.1114.0	2	support
5	0.029.1113.0	3	support
6	0.029.1116.0	1	support
7	0.021.1157.0	4	stud bolt
8	2.1019.026.1	14	special nut m 12 p.1.5
9	0.029.1117.0	10	stud bolt
10	2.1599.144.0	14	shoulder
11	0.037.1155.0	1	bushing
12	2.1559.111.0	2	bushing 12x14x10
13	0.029.1154.0	4	gasket
14	2.1699.114.0	1	pin 8x55
15	2.1653.711.0	1	pin
16	2.0432.025.1	2	stud bolt m 8 p 1.25-1x100
17	0.044.1159.0	1	flange
18	2.1653.708.0	2	pin 8x18
19	2.1652.911.0	2	cylindrical plug 12x25
20	2.0432.153.1	2	stud bolt m 10 p.1.5 / p.1.25 x 20
21	2.0112.513.1	11	screw m 14 p.2 x 35
22	2.0432.257.1	2	stud bolt m 12 p.1.75 - 1.25 x 30
23	2.3170.022.1	1	expansion plug 60
24	2.3130.003.1	2	plug 3/8" gas
25	2.3130.002.1	1	plug 1/4" gas
26	0.044.1120.0/10	6	engine cylinder
27	2.1589.052.0	12	shoulder ring 115x123x0.2
28	2.1589.051.0	6	shoulder ring 116x123x0.1
29	2.1569.076.0	6	gasket 116x123x0.5
30	0.039.1122.0	24	stud bolt m 12 p.1.5x310
31	0.041.1123.0	6	stud bolt m 10
32	0.044.1156.0	12	special bushing
33	0.071.1151.3	6	valve
34	2.3130.001.1	5	plug 1/8" gas
35	2.1653.306.0	2	pin
36	2.3139.001.1	6	plug
37	2.0432.003.1	8	stud bolt m 8 p.1.25 / p.1 x 20
38	0.044.1151.0	2	gasket
39	0.044.1150.0	1	cover

Section: ENGINE  
CRANKCASE

Fig.	P/n	QTY	Name
40	2.1310.004.2	8	flat washer 8.4x17
41	2.0112.204.2	4	screw m 8 p.1.25x14
41	2.0112.207.2	2	screw m 8 p 1.25 x 20
41	2.0119.116.2	2	screw m 8 p.1.25x14
42	0.044.1155.2/20	1	cover
43	0.045.1150.0	1	oil seal
44	0.044.1152.0	1	tube
45	2.1480.014.1	1	washer 8
46	2.0312.206.2	1	screw m 8 p 1.25 x 20
47	0.044.1153.0/10	1	gasket
48	0.044.1154.0	1	cover
49	2.1480.014.1	4	washer 8
50	2.0112.209.2	4	screw m 8 p 1.25 x 25
51	2.1011.207.2	2	nut m 12 p.1.5
52	0.044.1164.2/10	1	small cover

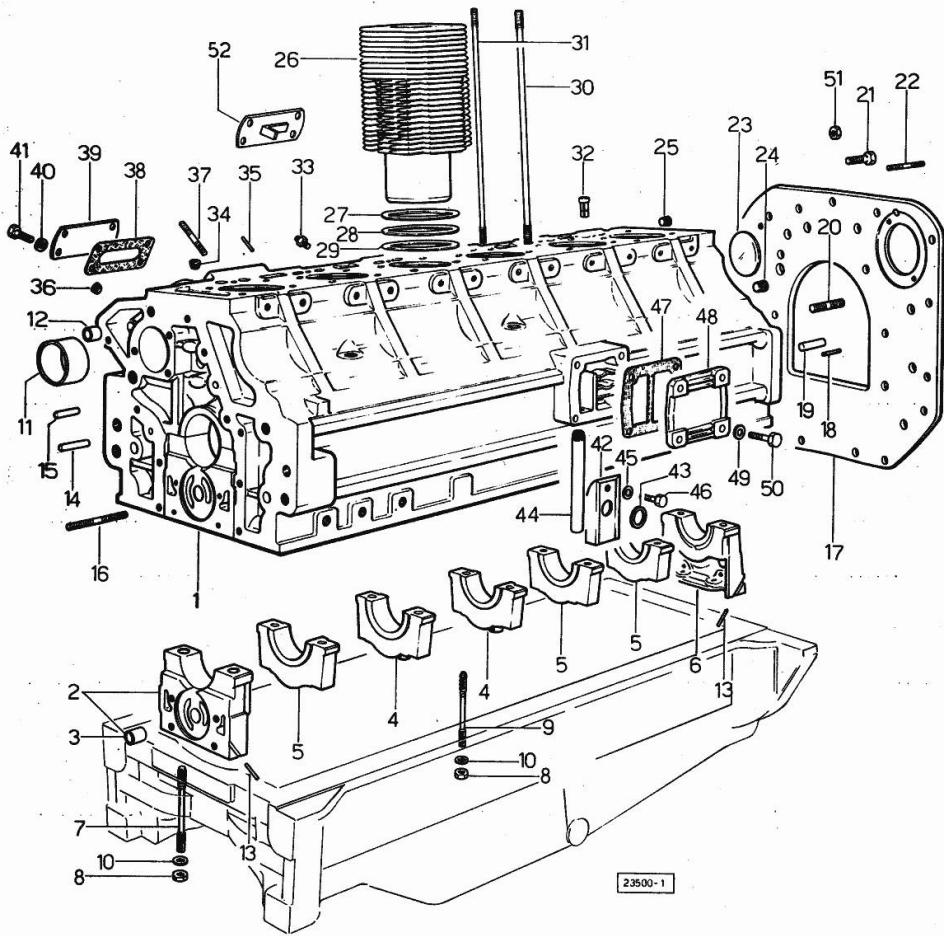

Section: ENGINE  
TIMING CASE

Fig.	P/n	QTY	Name
------	-----	-----	------

Notes:

[Trident 130 Export]

1	0.048.1131.0	1	flange
2	0.041.1153.0	1	gasket
3	2.0112.209.2	5	screw m 8 p 1.25 x 25
4	2.1480.014.1	5	washer 8
5	2.0119.034.1	1	screw m 14 p.2x20
6	2.1560.010.0	1	gasket 14.2 x 20
7	2.0112.207.2	1	screw m 8 p 1.25 x 20
8	2.1480.014.1	1	washer 8
9	0.041.1152.0	1	gasket
10	2.1519.010.0	1	special oil seal 58x80x10
11	0.048.1132.0/30	1	guard
12	2.0112.217.2	5	screw m 8 p.1.25 x 45
13	2.1480.014.1	5	washer 8
14	2.1560.003.0	1	copper gasket 8.2 x 12
15	2.1011.405.2	2	nut m 8 p.1
16	2.1480.014.1	2	washer 8
17	2.0112.211.2	2	screw m 8 p.1.25 x 30
18	2.0112.222.2	4	screw m 8 p.1.25x65
19	2.1480.014.1	4	washer 8
20	0.041.1158.0	1	index
21	2.1310.004.2	1	flat washer 8.4x17
22	2.0112.204.2	1	screw m 8 p.1.25x14
23	0.048.1151.0/10	1	gasket
24	0.048.1150.0/20	1	cover
25	2.1560.006.0	4	gasket 10.2 x 16
26	2.0112.315.2	4	screw m 10 p.1.5 x 40
27	0.041.1154.0	1	gasket
28	2.0432.015.1	1	stud bolt m 8 p 1.25 - m 8 p. 1x50
29	2.0432.028.1	3	stud bolt m 8 p.1.25-1x130
30	2.1653.717.0	1	pin 8 x 40
31	0.041.1159.0/10	1	filter
32	2.1411.012.1	1	circlip 30
33	0.041.1135.3	1	plug
34	2.1569.072.0	1	gasket 32 x 39.5 x 2
35	2.0119.081.2	2	screw
36	0.037.1151.0	1	cover
37	2.1579.191.0	4	spacer 8.5 x 18 x 20
38	2.1011.505.2	4	nut m 8 p.1
39	2.1310.004.2	4	flat washer 8.4x17

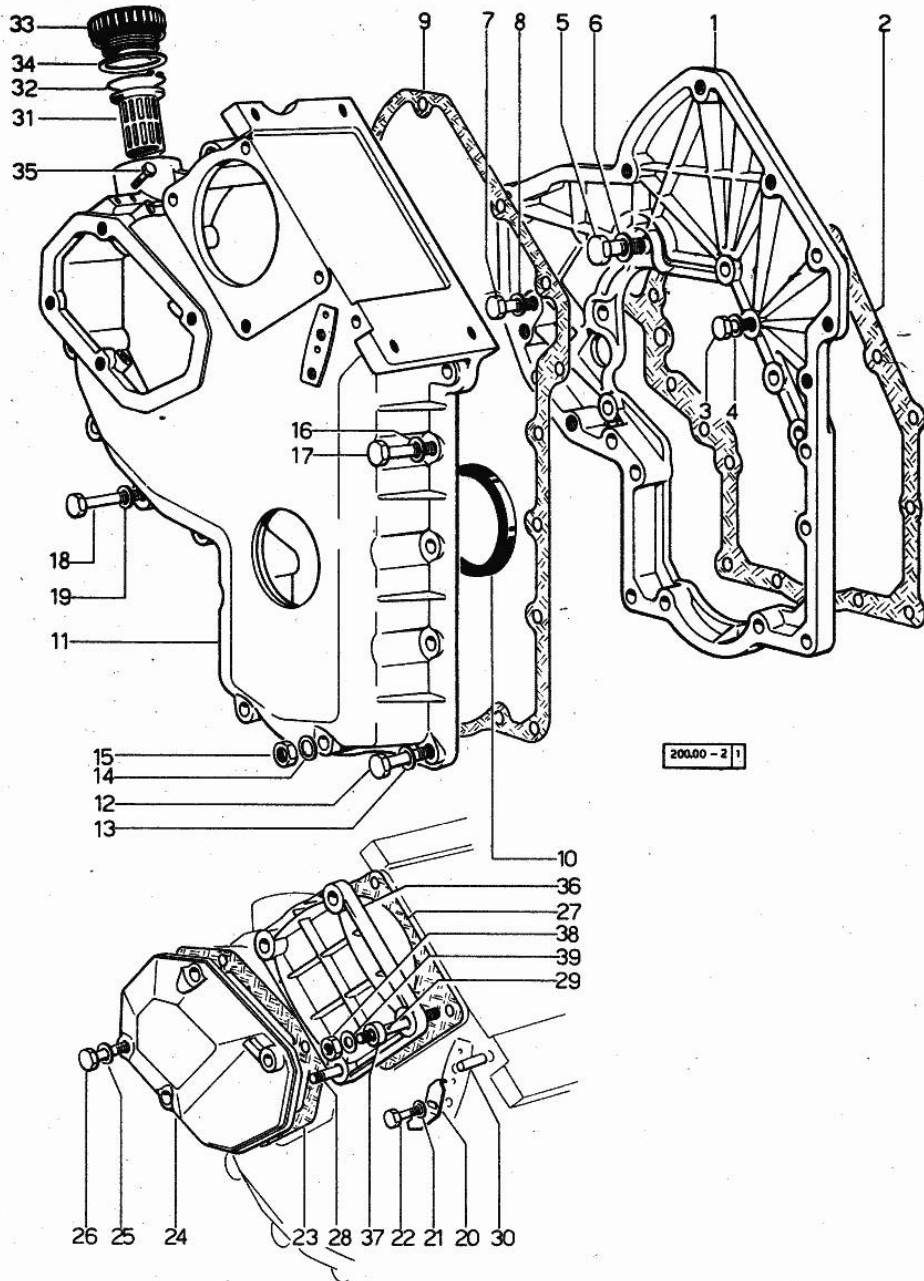

Section: ENGINE  
CRANKSHAFT

Fig.	P/n	QTY	Name
------	-----	-----	------

Notes:  
[Trident 130 Export]

1	0.047.1210.4	1	crankshaft
2	2.1799.002.0	1	stick 10x13
3	0.037.1250.0/10	1	hub
4	2.1651.909.0	1	cylindrical plug 12 x 20
5	0.046.1246.3	1	antivibration pulley
8	0.001.6020.0	1	shoulder
9	2.0129.032.2	1	screw m 24 p.2x45
10	0.029.0066.0		main half bushing - mm 1.00
10	0.029.1215.0/10	14	main half bushing
10	0.029.1215.7		main half bushing - mm 0.25
10	0.029.1215.8		main half bushing - mm 0.50
10	0.029.1215.9		main half bushing - mm 0.75
11	0.039.0068.0		con.rod half bushing - mm 1.016
11	0.039.1225.0	12	con.rod half bushing
11	0.039.1225.7		con.rod half bushing -mm 0.254
11	0.039.1225.8		con.rod half bushing -mm 0.508
11	0.039.1225.9		con.rod half bushing -mm 0.762
12	0.001.4547.0		shoulder ring + mm 0.05
12	0.001.4548.0		shoulder ring + mm 0.10
12	0.001.4549.0		shoulder ring + mm 0.15
12	0.042.1219.0	2	shoulder ring STANDARD
13	0.001.4544.0		shoulder ring + mm 0.05
13	0.001.4545.0		shoulder ring + mm 0.10
13	0.001.4546.0		shoulder ring + mm 0.15
13	0.042.1218.0	2	shoulder ring STANDARD
14	2.1652.915.0	2	cylindrical plug 12x35
15	0.029.1250.0	1	gasket
16	0.029.1240.0	1	flange
17	2.1011.421.2	2	nut m 10 p.1.25
18	2.0112.309.2	7	screw m 10 p.1.5 x 25
19	2.1480.015.1	7	washer 10
20	2.1519.009.0/10	1	special oil seal
21	0.046.1256.3	1	flywheel
22	0.047.1242.0	1	crown wheel z=128
23	2.1379.006.0	3	lock-tab 15x15x36,5
24	2.0122.515.7	6	screw
25	0.052.1220.3/10	6	engine connecting rod
27	0.039.1250.0	12	screw m 14 p.1.5x63
28	0.002.4168.0	6	bearing
29	0.046.0060.6/10	6	complete piston
29	0.046.0061.6/10		complete piston + mm 0.5

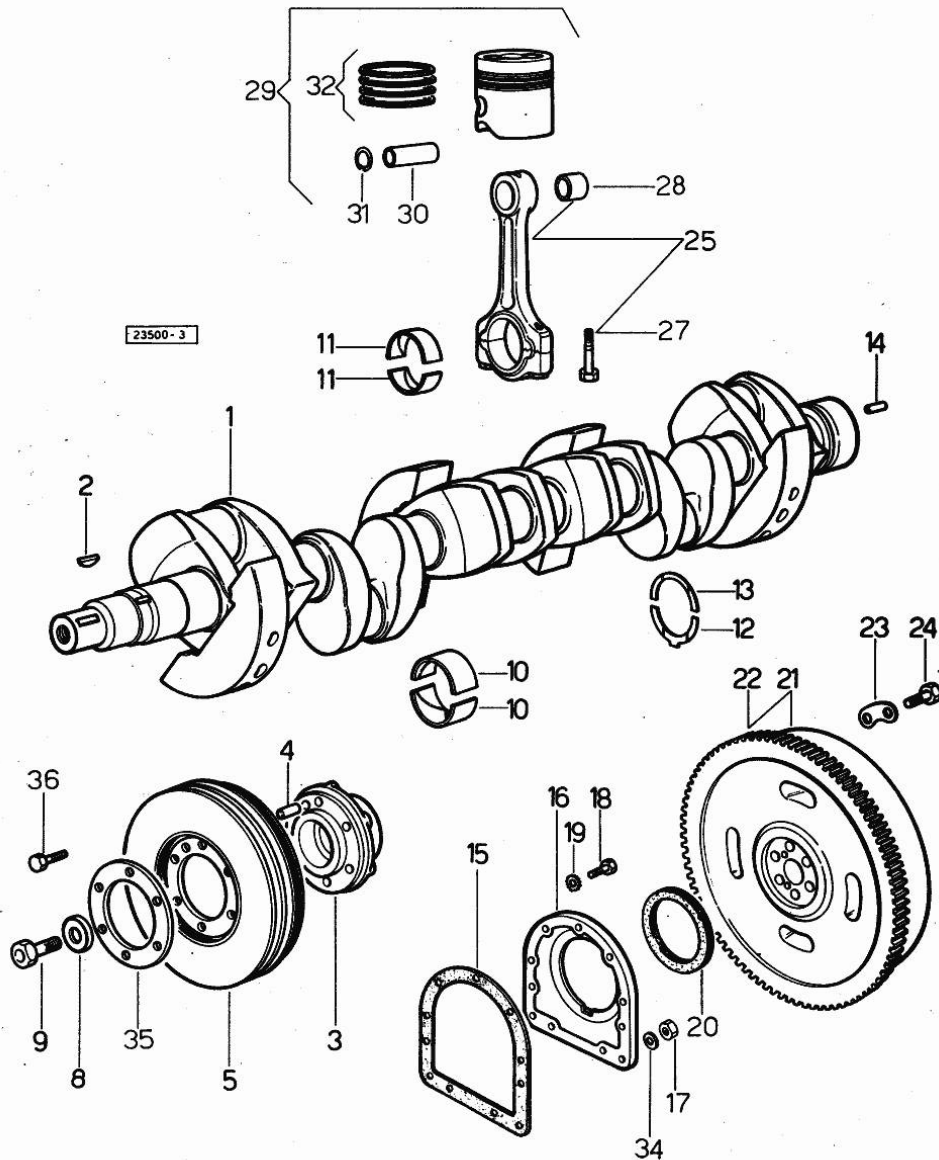

Section: ENGINE  
**CRANKSHAFT**

Fig.	P/n	QTY	Name
29	0.046.0062.6/10		complete piston + mm 1
30	0.038.1236.0/10	6	piston pin Ø 18 / Ø 35 / L = mm 90
31	2.1411.014.1	12	circlip 35
32	0.073.0052.6	6	piston ring set
32	0.073.0053.6		piston ring set + mm 0.5
32	0.073.0054.6		piston ring set + mm 1.0
34	2.1560.006.0	2	gasket 10.2 x 16
35	0.037.1255.0	1	flange
36	2.0122.461.1	6	screw m 12 p.1.25x30

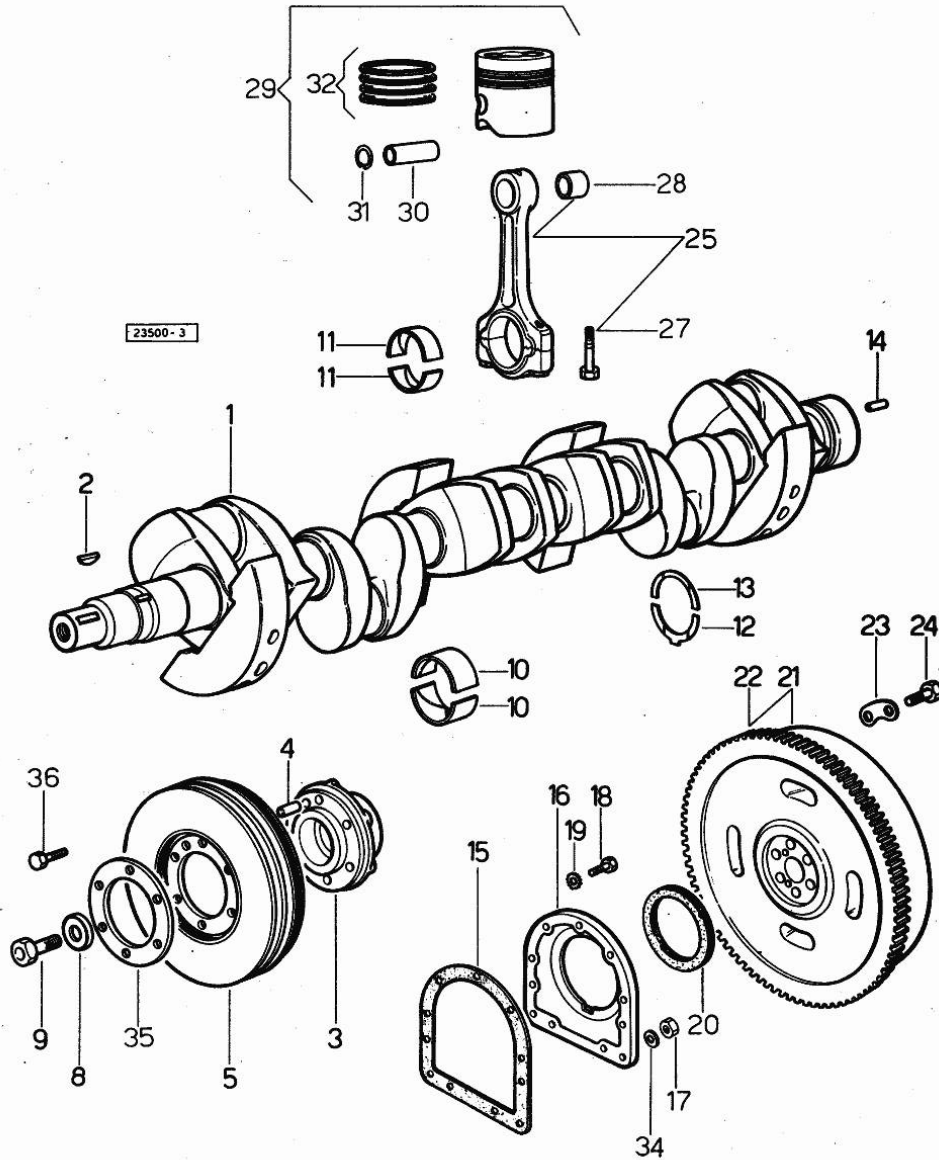

Section: ENGINE

**CAMSHAFT**

Fig.	P/n	QTY	Name
------	-----	-----	------

**Notes:**

[Trident 130 Export]

1	0.046.1310.0/10	1	camshaft EXP USA
1	0.047.1310.0/40	1	camshaft
2	2.3130.001.1	1	plug 1/8" gas
3	0.027.1314.0	1	flange
4	2.1470.004.2	2	lock washer 8
5	2.0112.207.2	2	screw m 8 p 1.25 x 20
6	0.062.1321.0	1	gear z=66
7	2.0139.005.1	4	screw m 10 p.1 x 25
8	0.040.1320.0	1	gear z = 33
9	2.1720.010.0	1	key 5x9
10	0.040.1323.0/10	1	gear Z = 38
11	0.052.1330.0/20	12	tappets
12	0.041.1331.3	12	rod
13	0.041.1332.0	12	sleeve
14	2.1539.020.0	12	special oil seal 13.95x2.62
15	2.1539.022.0	12	special oil seal 12.37x2.62
16	2.4019.162.1/20	12	spring 17.2x46x1.8
17	0.041.1355.3	1	transmission
18	2.1560.013.0	1	gasket 18.2x22

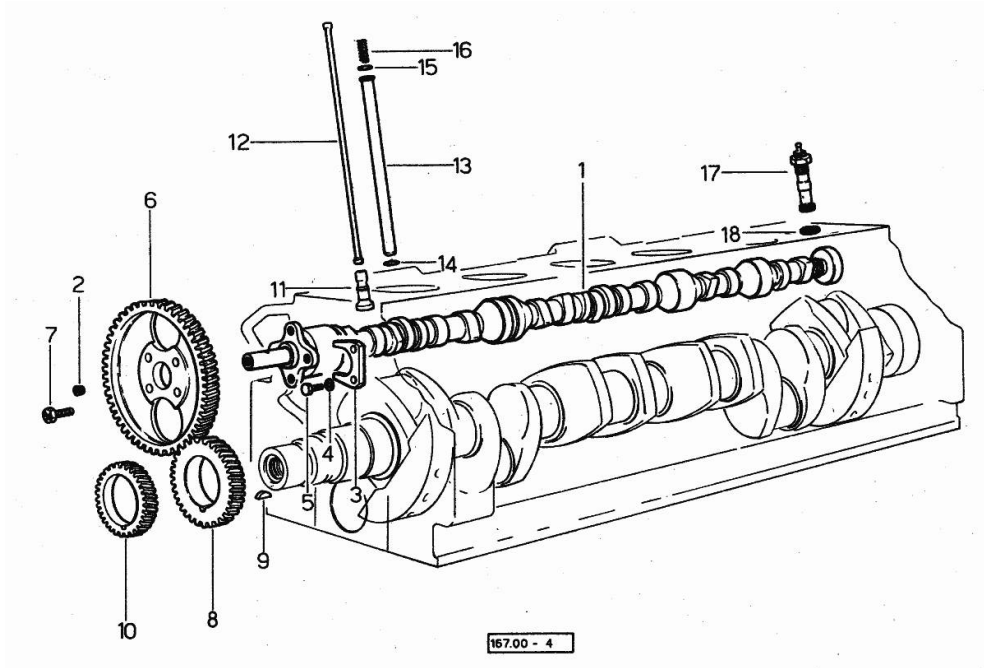

Section: ENGINE  
CYLINDER HEAD

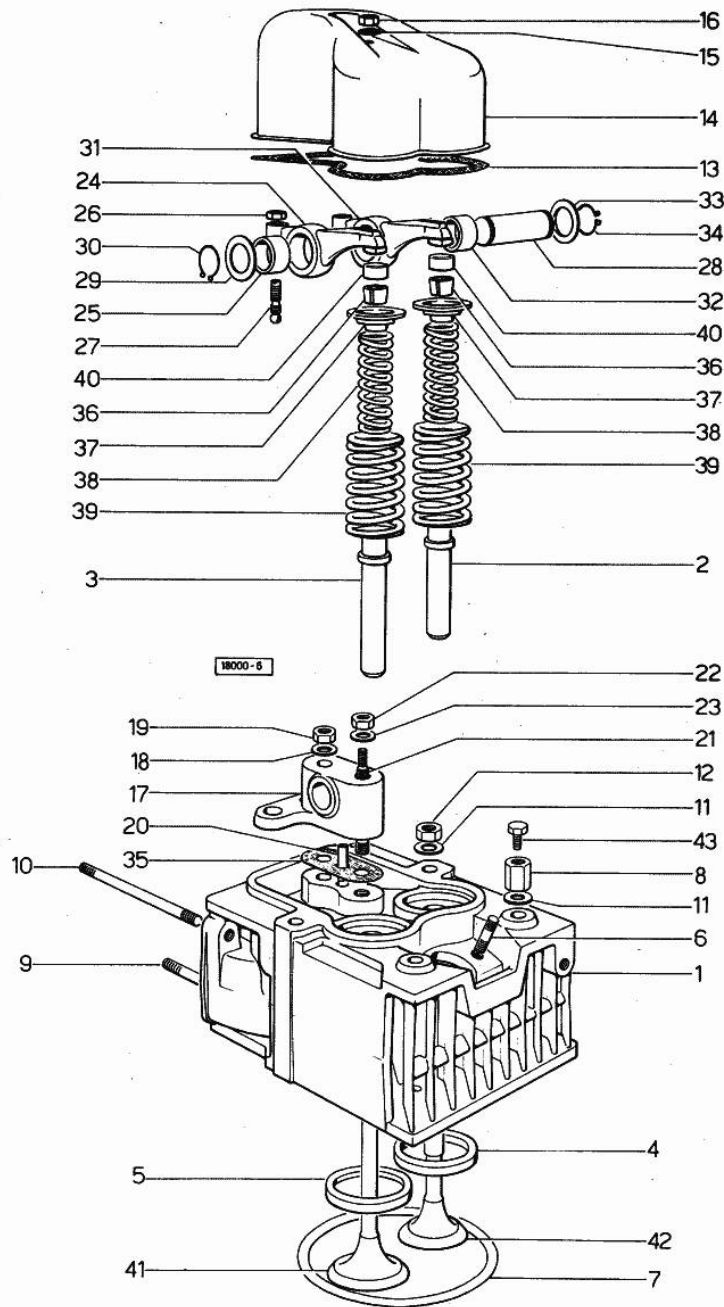

Fig.	P/n	QTY	Name
------	-----	-----	------

Notes:  
[Trident 130 Export]

0	0.042.0057.6	1	gasket set FOR GRINDING VALVES OF ONE CYLINDER AND PISTON RING RENEWAL
1	0.044.1450.3/50	6	engine head 13929 <= => 13930
1	0.062.1410.3/10	6	engine head => 13930
2	0.045.1417.0	6	valve guide 13929 <= => 13930
2	0.062.1417.0/10	6	valve guide => 13930
3	0.037.1416.0	6	valve guide 13929 <= => 13930
3	0.062.1416.0/10	6	valve guide => 13930
4	0.037.1452.0/10	6	valve seat 13929 <= => 13930
4	0.062.1450.0/10	6	valve seat => 13930
5	0.037.1451.0/10	6	valve seat 13929 <= => 13930
5	0.062.1451.0/10	6	valve seat => 13930
6	2.0439.087.1	12	stud bolt
7	2.1569.078.0/10	6	gasket 106x118x0.5
8	2.1019.069.0	8	special nut
9	2.0432.007.1	11	stud bolt m 8 p.1.25 / p.1 x 30
10	2.0432.026.1	6	stud bolt m 8 p.1.25 - 1.00 x 110
11	2.1599.144.0	24	shoulder
12	2.1019.068.0	16	special nut
13	0.029.1450.0	6	gasket
14	0.039.1440.0	6	cap
15	2.1560.004.0	6	copper gasket 8.2 x 14
16	2.1099.056.1	6	special nut m8 p.1
17	0.041.1430.0	6	support
18	2.1310.007.2	6	flat washer 13 x 24
19	2.1099.082.0	6	special nut
20	0.029.1452.0	6	tube
21	0.039.1451.0	6	stud bolt
22	2.1011.421.2	6	nut m 10 p.1.25
23	2.1310.006.2	6	flat washer 10.5x21

Section: ENGINE  
CYLINDER HEAD

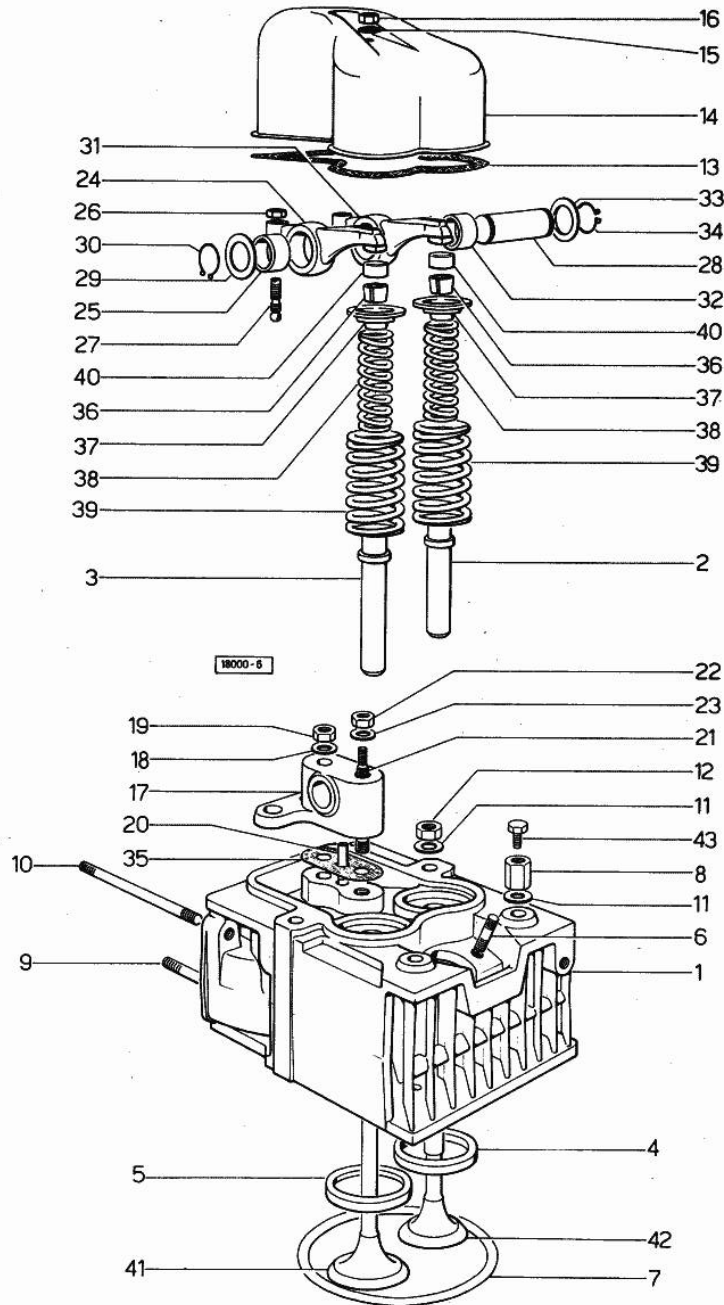

Fig.	P/n	QTY	Name
24	002.5937.3/30	6	rocker arm
25	2.1559.021.0/40	6	bushing 15x19x22
26	2.1011.405.2	12	nut m 8 p.1
27	0.021.1434.0	12	screw
28	0.041.1431.0	6	pin
29	2.1599.019.0	6	shoulder ring 19.5x31x2
30	2.1410.055.1	6	circlip 19
31	0.002.5936.3/40	6	rocker arm
32	2.1559.021.0/40	6	bushing 15x19x22
33	2.1599.019.0	6	shoulder ring 19.5x31x2
34	2.1410.055.1	6	circlip 19
35	0.034.1450.0	6	tappet gasket
36	0.002.9193.0/10	12	conical valve cotter 13929 <= => 13930
36	0.062.1423.0	12	conical valve cotter => 13930
37	0.002.9215.0/10	12	cup 13929 <= => 13930
37	0.062.1425.0	12	cup => 13930
38	2.4019.194.0	12	spring 22.70x50.7x2.1
39	2.4019.193.0	12	spring 36.15x55.2x3.2
40	0.021.1453.0/20	12	small cover 13929 <= => 13930
40	0.062.1452.0	12	small cover => 13930
41	0.052.1420.0	6	inlet valve Ø mm 9 13929 <= => 13930
41	0.062.1420.0/10	6	inlet valve Ø mm 8 => 13930
42	0.039.1421.0	6	exhaust valve Ø mm 9 13929 <= => 13930
42	0.071.1420.2	6	exhaust valve Ø mm 8 => 13930
43	2.0119.053.1	4	screw



Section: ENGINE  
LUBRICATION

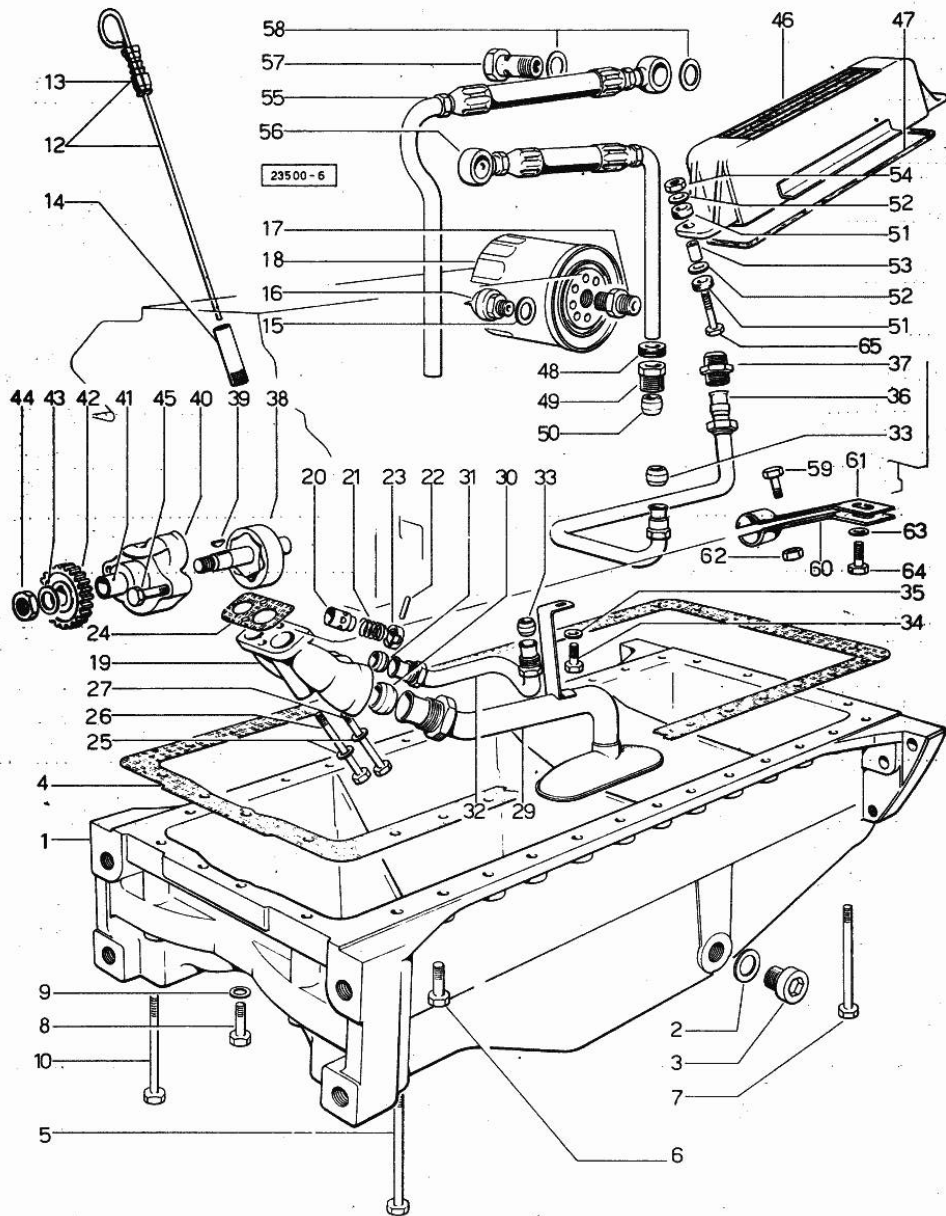

Fig.	P/n	QTY	Name
------	-----	-----	------

Notes:  
[Trident 130 Export]

1	0.047.1510.0	1	oil sump
2	2.1560.054.0	1	gasket 21 x 26
3	2.3199.001.2	1	plug 1/2" gas
4	0.037.1512.0	1	gasket
5	2.0112.244.2	2	screw m 8 p.1.25 x 180
6	2.0112.215.2	30	screw m 8 p.1.25 x 40
7	2.0112.237.2	4	screw m 8 p.1.25x140
8	2.0112.217.2	2	screw m 8 p.1.25 x 45
9	2.1560.004.0	4	copper gasket 8.2 x 14
10	2.0112.231.1	2	screw m 8 p 1.25x110
12	0.041.1513.3	1	dipstick
13	0.034.1551.0	1	gasket
14	0.044.1555.0	1	spacer
15	2.1560.008.0	1	gasket 12.2 x 18
16	2.7099.040.0/10	1	pressure switch
17	2.3339.094.1/10	1	pipe fitting m 20 p.1.5-3/4 gas
18	0.041.1556.0	1	oil filter element
19	0.040.1530.0/20	1	tip 13929 <=
19	0.052.1530.0	1	tip => 13930
20	0.040.1550.0	1	small piston 13929 <=
20	0.052.1571.0	1	small piston => 13930
21	2.4019.241.1	1	spring 13929 <=
21	2.4019.270.1	1	spring 9.7x54x2 => 13930
22	2.1630.213.0	1	roll pin 3x32
23	0.040.1551.0	1	stop 13929 <=
23	0.054.1558.0/10	1	stop => 13930
24	0.037.1557.0/20	1	gasket
25	2.1480.014.1	2	washer 8
26	2.0112.225.2	1	screw m 8 p.1.25 x 80
27	2.0112.231.1	1	screw m 8 p 1.25x110
29	0.046.1531.3	1	tube
30	2.3359.017.1	1	nosepiece
31	2.3359.016.1	1	nosepiece

Section: ENGINE  
LUBRICATION

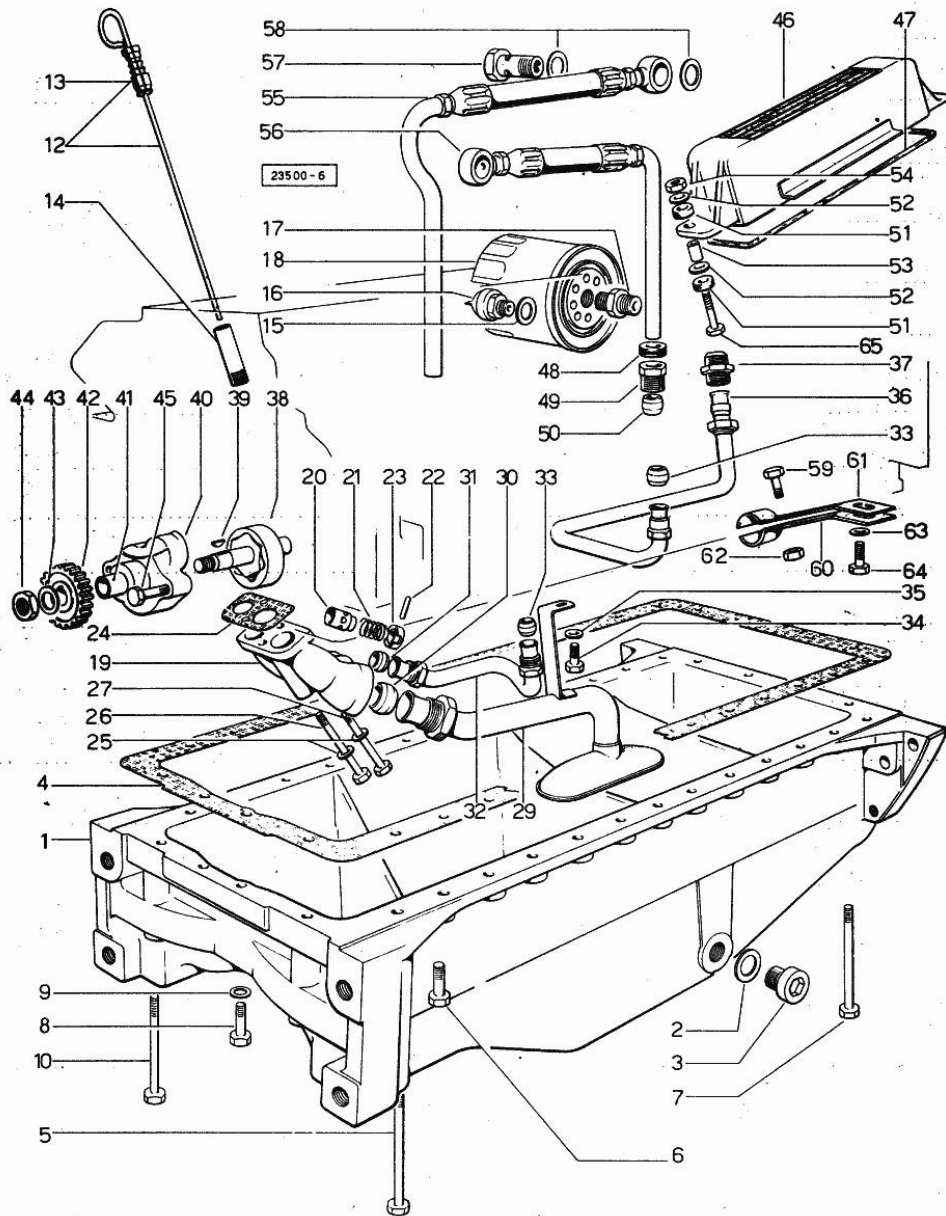

Fig.	P/n	QTY	Name
32	0.044.1560.2	1	tube
33	2.3359.015.1	2	nosepiece
34	2.0112.204.2	1	screw m 8 p.1.25x14
35	2.1310.004.2	1	flat washer 8.4x17
36	0.046.1543.2/10	1	tube
37	2.3339.159.1/10	1	pipe fitting
38	0.040.1524.3/30	1	rotor
39	2.1720.005.0	1	key 4x5
40	0.047.1520.3	1	pump casing
41	2.1559.086.0	1	bushing 18.07x22.06x30
42	0.040.1521.0/10	1	gear z = 27
43	2.1310.007.2	1	flat washer 13 x 24
44	2.1121.109.2	1	self-locking nut m 12 p.1.25
45	2.0112.219.2	2	screw m 8 p.1.25x55
46	0.042.1540.3	1	old part number
47	0.047.1552.0	1	gasket
48	2.6560.013.0	2	wire guide 18x1.5
49	2.3339.167.1	2	pipe fitting
50	2.3359.012.0	2	nosepiece 10x16.8
51	0.021.1560.0	4	rubber plug
52	2.1599.006.0	4	shoulder ring 8.4x25x2
53	2.1579.159.0	2	spacer 8.8x12x16
54	2.1011.405.2	2	nut m 8 p.1
55	0.047.1550.2/30	1	tube
56	0.047.1551.2/20	1	tube
57	2.3339.107.1	2	pipe union m 22
58	2.1560.018.0	6	gasket 22.2 x 29
59	2.0112.207.2	1	screw m 8 p 1.25 x 20
60	0.046.1551.0	1	bracket
61	0.046.1550.0	1	bracket
62	2.1011.105.2	1	nut m 8 p.1.25
63	2.1310.004.2	1	flat washer 8.4x17
64	2.0112.207.2	1	screw m 8 p 1.25 x 20
65	2.0122.213.2	2	screw m 8 p.1x35

Thank you so much for reading.  
Please click the “Buy Now!”  
button below to download the  
complete manual.



After you pay.

You can download the most  
perfect and complete manual in  
the world immediately.

Our support email:

[ebooklibonline@outlook.com](mailto:ebooklibonline@outlook.com)