

AUSTAUSCHMOTOR

Fig.	P/n	QTY	Name
------	-----	-----	------

Notes:

[XL150 HI-LEVEL]

1	12215999	1	new engine >100 kw VOR DER ERSATZTEILBESTELLUNG VON ZYLINDERROHREN,KOLBEN, KOLBENRINGEN U. KURBELWELLEN- LAGERN (HAUPT-, PLEUEL- UND PASSLAGER) IST DURCH AUSMESSEN DIE SCHLEIFSTUFE ZU ERMITTELN. AUSTAUSCHMOTOREN WERDEN OHNE ANBAUTEILE GELIEFERT.
950	12215999	1	new engine >100 kw
951	12215999	1	new engine >100 kw
952	12215999	1	new engine >100 kw

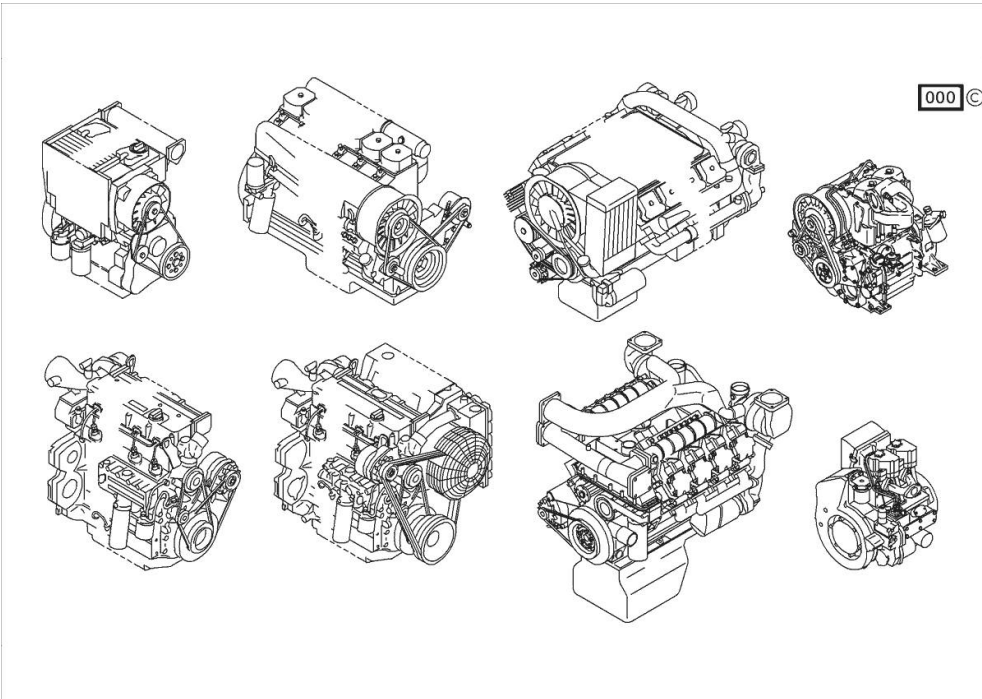

FILLER CAP

Fig.	P/n	QTY	Name
------	-----	-----	------

Notes:
[XL150 HI-LEVEL]

1	01180341	1	plug H 2875 -B2-OL40-166X4X145X15
---	----------	---	--------------------------------------

000

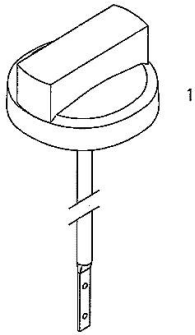

0507 1179

Section: B0 - ENGINE
KURBELGEHAEUSE

Fig.	P/n	QTY	Name
------	-----	-----	------

Notes:
 [XL150 HI-LEVEL]

185	01319910	1	guard
1	04506847	1	crankcase MIT POS.... (2-17)
2	04254240	14	screw 50 Nm , 90° , 90°
3	04160764	14	bushing
4	01110423	1	screw 35 Nm DIN 908 -M14X1,5-ST-ZNPHRF
5	01118693	3	gasket 14x20 DIN 7603 -A14X20-CU
6	01180890	1	screw 95 Nm H 2812 -906-M30X1,5-ST-A4C-PRE80
7	04292706	1	plug 80 Nm
8	01182031	2	screw 35 Nm H 2812 -906-M14X1,5-ST-A3C-LOCTITE506
9	01101342	1	oil seal DIN 7603 -D22X27-CU
10	04251884	6	plug
11	04250086	1	ring
12	01148032	9	cover DIN 443 -A45-ZNPHR
13	01148031	6	plug DIN 443 -A36-ZNPHR
14	01100940	2	screw 35 Nm DIN 7604 -AM14X1,5-ST-A4C
15	04202518	1	sleeve
16	04226536	1	bottom 30 Nm
17	04202517	1	sleeve

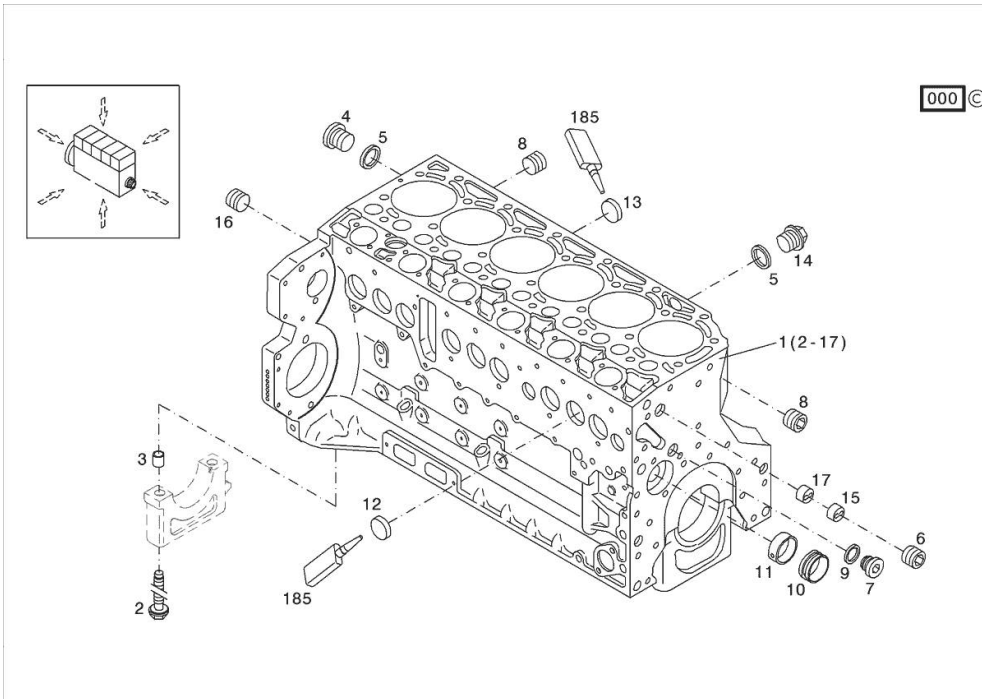

Section: B0 - ENGINE

BLEEDING TUBE

Fig.	P/n	QTY	Name
------	-----	-----	------

Notes:

[XL150 HI-LEVEL]

2	04198572	1	tube
3	01178750	2	clamp DIN 3021 -A-29X15
4	01167329	1	bottom H 2873 -A24,6X21,5X25-PEWEICH

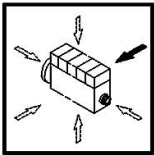

000 ©

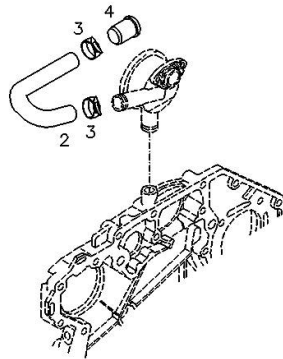

FLANGE

Fig.	P/n	QTY	Name
------	-----	-----	------

Notes:

[XL150 HI-LEVEL]

1	04502445	1	oil pump WITH POS.... (2,3)
2	04502202	1	special oil seal
3	01133718	8	screw 8.5 Nm DIN 7991 -M6X16-8.8-A4C

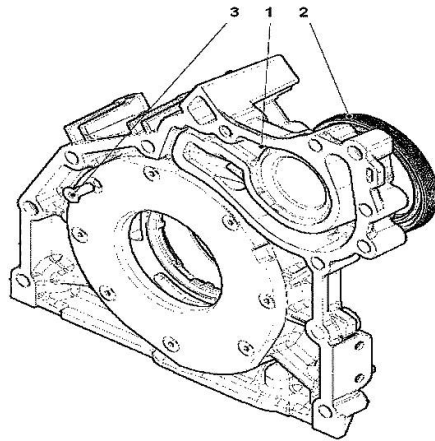

000

FLANGE

Fig.	P/n	QTY	Name
------	-----	-----	------

Notes:
[XL150 HI-LEVEL]

1	04258382	1	oil pump kpl. WITH POS.... (2,3)
2	04253372	1	oil seal
3	01133718	1	screw DIN 7991 -M6X16-8.8-A4C

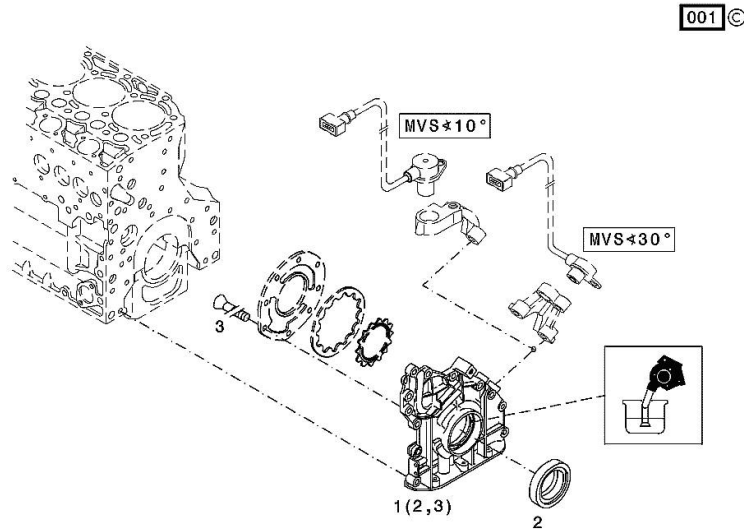
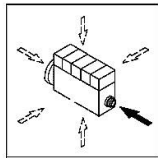

CRANKCASE

Fig.	P/n	QTY	Name
------	-----	-----	------

Notes:

[XL150 HI-LEVEL]

1	04282838	1	crankcase WITH POS.... (2-8,10-15,17,18)
2	04254240	14	screw
3	04160764	14	bushing
4	01110423	1	screw DIN 908 -M14X1,5-ST-ZNPHRF
5	01118693	3	gasket 14x20 DIN 7603 -A14X20-CU
6	01182033	1	screw H 2812 -906-M30X1,5-ST-A3C-LOCTITE506
7	01182032	1	screw H 2812 -906-M22X1,5-ST-A3C-LOCTITE506
8	01182031	2	screw H 2812 -906-M14X1,5-ST-A3C-LOCTITE506
10	04251884	6	plug
11	04250086	1	ring
12	01148032	9	cover DIN 443 -A45-ZNPHR
13	01148031	6	plug DIN 443 -A36-ZNPHR
14	01100940	2	screw DIN 7604 -AM14X1,5-ST-A4C
15	04202518	1	sleeve
17	04202517	1	sleeve
18	04226536	1	bottom
185	01016127	1	sealing compound ml. 50 H 0699 -DEUTZDW72-50ML

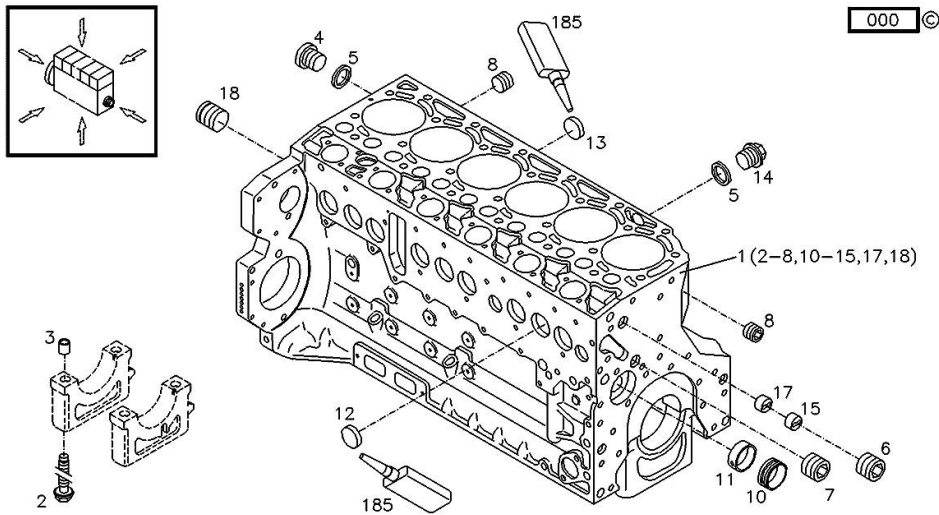

CRANKCASE

Fig.	P/n	QTY	Name
------	-----	-----	------

Notes:

[XL150 HI-LEVEL]

1	04289953	1	crankcase WITH POS.... (2-8,10-17)
2	04254240	14	screw
3	04160764	14	bushing
4	01110423	1	screw DIN 908 -M14X1,5-ST-ZNPHRF
5	01118693	3	gasket 14x20 DIN 7603 -A14X20-CU
6	01180890	1	screw H 2812 -906-M30X1,5-ST-A4C-PRE80
7	01180906	1	screw H 2812 -906-M22X1,5-ST-A4C-PRE80
8	01182031	2	screw H 2812 -906-M14X1,5-ST-A3C-LOCTITE506
10	04251884	6	plug
11	04250086	1	ring
12	01148032	9	cover DIN 443 -A45-ZNPHR
13	01179634	6	plug H 2860 -A36-ST-FE/ZNPHR
14	01100940	2	screw DIN 7604 -AM14X1,5-ST-A4C
15	04202518	1	sleeve
16	04226536	1	bottom
17	04202517	1	sleeve
185	01016125	1	guard H 0699 -DEUTZDW72-250ML

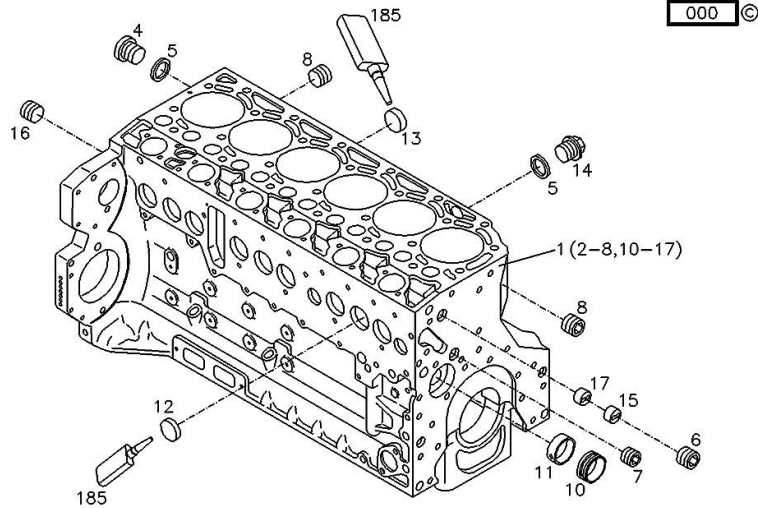
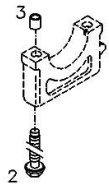
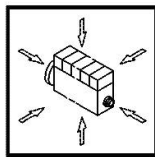

CRANKCASE

Fig.	P/n	QTY	Name
------	-----	-----	------

Notes:

[XL150 HI-LEVEL]

1	04296583	1	crankcase WITH POS.... (2-17)
2	04254240	14	screw
3	04160764	14	bushing
4	01110423	1	screw DIN 908 -M14X1,5-ST-ZNPHRF
5	01118693	3	gasket 14x20 DIN 7603 -A14X20-CU
6	01180890	1	screw H 2812 -906-M30X1,5-ST-A4C-PRE80
7	04292706	1	plug
8	01182031	2	screw H 2812 -906-M14X1,5-ST-A3C-LOCTITE506
9	01101342	1	oil seal DIN 7603 -D22X27-CU
10	04251884	6	plug
11	04250086	1	ring
12	01148032	9	cover DIN 443 -A45-ZNPHR
13	01148031	6	plug DIN 443 -A36-ZNPHR
14	01100940	2	screw DIN 7604 -AM14X1,5-ST-A4C
15	04202518	1	sleeve
16	04226536	1	bottom
17	04202517	1	sleeve
185	01016125	1	guard H 0699 -DEUTZDW72-250ML

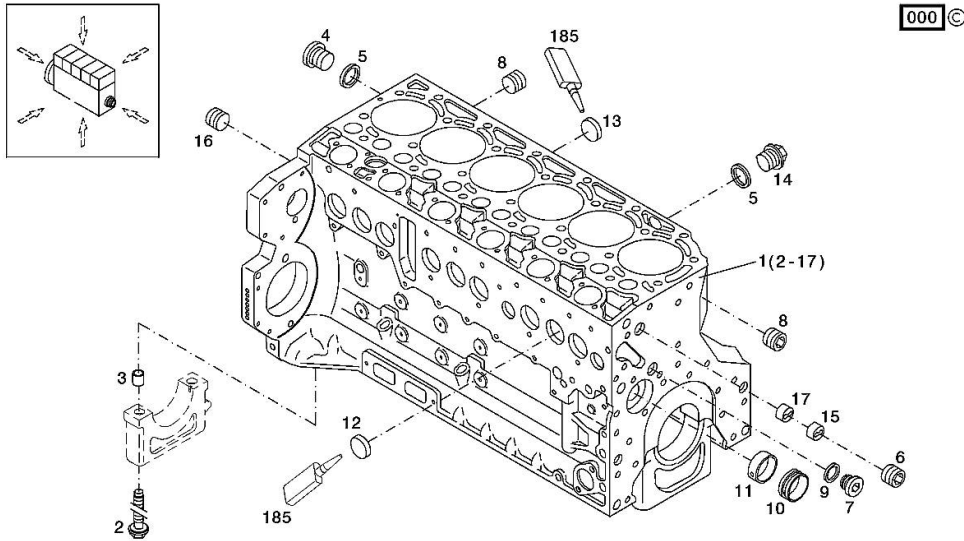

V-BELT - FOR TRACTORS WITH AIR CONDITIONING

Fig.	P/n	QTY	Name
------	-----	-----	------

Notes:
[XL150 HI-LEVEL]

53	04452801	1	belt AV 13x1000 mm
----	----------	---	--------------------

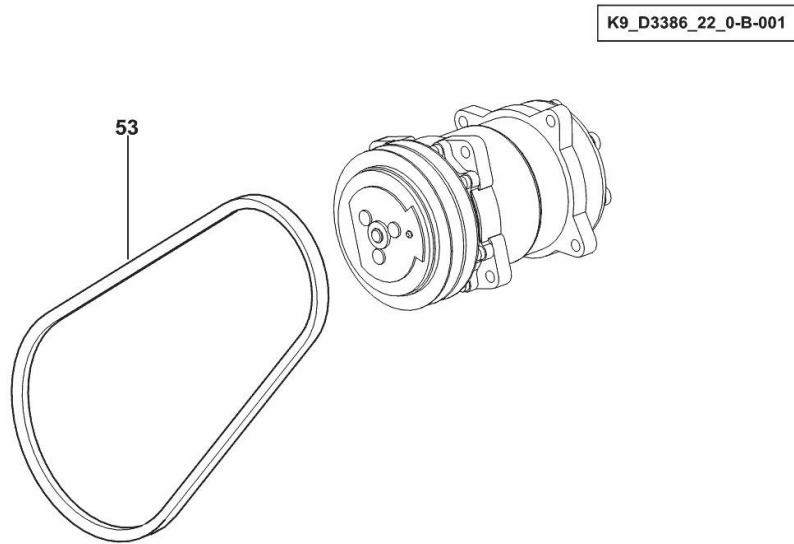

FASTENINGS

Fig.	P/n	QTY	Name
------	-----	-----	------

Notes:

[XL150 HI-LEVEL]

1	04204128	10	screw m 10 p.1x35 M10X1X35
---	----------	----	-------------------------------

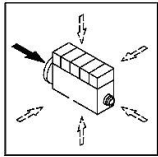

001 ©

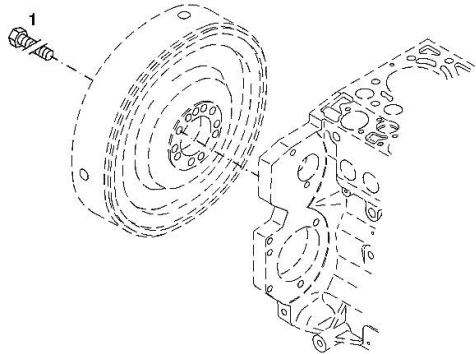

PLUG

Fig.	P/n	QTY	Name
------	-----	-----	------

Notes:

[XL150 HI-LEVEL]

1	01175750	5	plug - UP TO MONTH OF ASSEMBLY (A) - FROM MONTH OF ASSEMBLY SEE POS. (B) 11/2006
950	01167313	5	plug - FROM MONTH OF ASSEMBLY SEE POS. (B) - UP TO MONTH OF ASSEMBLY (A) FROM MONTH OF ASSEMBLY 12/2006

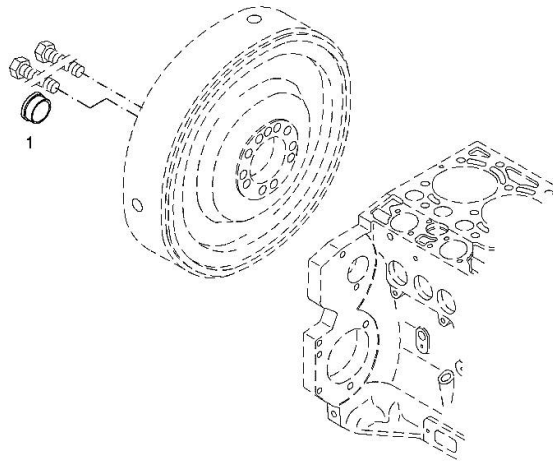
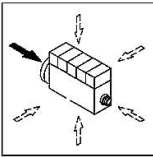

000 ©

ACCESSORIES

Fig.	P/n	QTY	Name
------	-----	-----	------

Notes:
[XL150 HI-LEVEL]

1	01136432	1	ball bearing DIN 625 -6304-2RS1
---	----------	---	------------------------------------

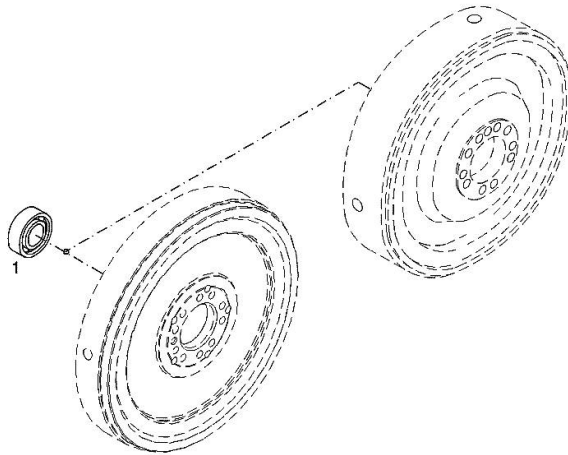
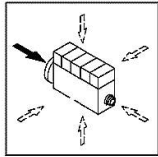

001 ©

FLYWHEEL

Fig.	P/n	QTY	Name
------	-----	-----	------

Notes:
[XL150 HI-LEVEL]

1	04208193	1	flywheel WITH POS.... (2)
2	04900286	1	crown wheel

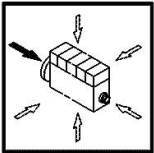

001

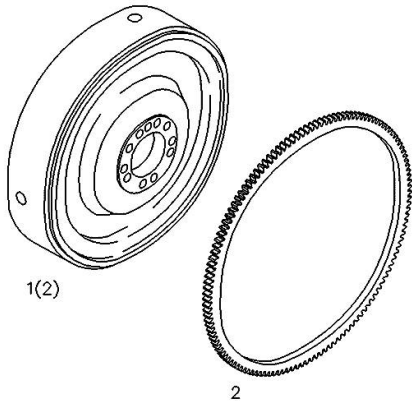

CRANKSHAFT

Fig.	P/n	QTY	Name
------	-----	-----	------

Notes:
[XL150 HI-LEVEL]

1	04289039	1	crankshaft
2	02931062	7	main bearing STANDARD STANDARD (A) MM RD, UNDERSIZE SEE POS. (B) A = 84,00 B = 952
3	02931331	2	shoulder ring STANDARD STANDARD (A) MM, OVERSIZE SEE POS. (B) POS. (B) A = 2.00 B = 953
5	01172066	1	insert H 2358 -AM10X1X20
6	02931063	1	shoulder ring STANDARD STANDARD (A) MM, OVERSIZE SEE POS. (B) POS. (B) A = 2.0 MM B = 963
952	02931071	1	main bearing - mm 0.25 1° MINORAZIONE 1ST UNDERSIZE 1A MEDIDA DE DESGASTE 1ERE COTE EN SOUS-DIMENSION 83,75 MM RD
953	02931332	1	shoulder ring 1st OVERSIZE 2.20 MM
963	02931074	1	shoulder ring 1° MAGGIORANZIONE 1ST OVERSIZE 1A SOBREMEDIDA 1ERE COTE EN SURDIMENSION 2.20 MM

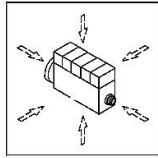

2 = diam. 84,00 mm
952 = diam. 83,75 mm

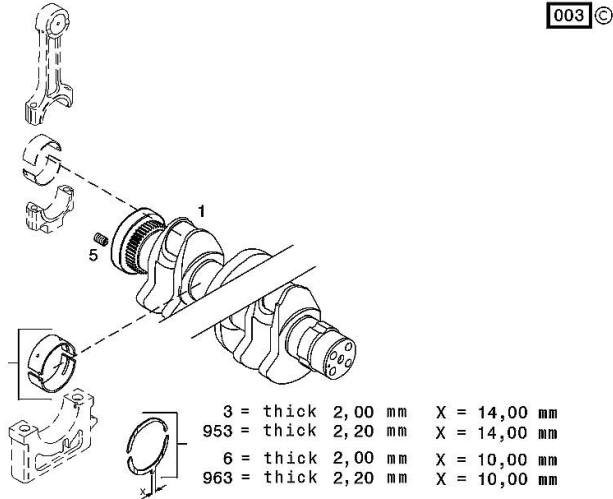

Thank you so much for reading.
Please click the “Buy Now!”
button below to download the
complete manual.



After you pay.

You can download the most
perfect and complete manual in
the world immediately.

Our support email:

ebooklibonline@outlook.com