

**ENGINE**

<b>Fig.</b>	<b>P/n</b>	<b>QTY</b>	<b>Name</b>
-------------	------------	------------	-------------

**Notes:**

- EXPORT U.S.A. [XM 110]

1	25006914	1	engine ON ORDERING PLEASE ENGINE NO. REQUIRED
---	----------	---	---

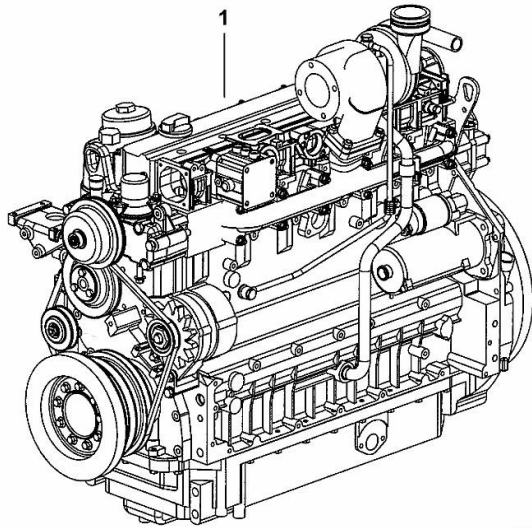

K9\_N7219\_02\_0-A-001

**FASTENINGS**

Fig.	P/n	QTY	Name
------	-----	-----	------

**Notes:**

[XM 110]

**Engine serial number:**

10209473 10209497 10218034 10218038 10218043 10218044 10218614 10225342 10264765 10270604 10285220  
 10288829 10293457 10294719 10295878 10299359 10553407 10613637 10725656 10725659

1	01183645	12	screw EN 1662 -F-M8X35-10.9-ZNAL-A
2	04504325	1	gasket
3	01181406	1	bushing H 2341 -B11X8-FE/ZN12C*



**CRANKCASE BREATHER**

Fig.	P/n	QTY	Name
------	-----	-----	------

Notes:  
[XM 110]

**Engine serial number:**

10209473 10209497 10218034 10218038 10218043 10218044 10218614 10225342 10264765 10270604 10285220  
10288829 10293457 10294719 10295878 10299359 10553407 10613637 10725656 10725659

1	04203321	1	valve WITH POS.... (2)
2	04206233	1	gasket
3	01148431	2	screw - FROM THE MONTH OF ASSEMBLY SEE POS. ( B ) - UP TO THE MONTH OF ASSEMBLY ( A ) FROM THE MONTH OF ASSEMBLY A = 09.1995 B = POS. 950 ISO 4762 -M6X20-8.8-ZNAL-A
4	04207290	1	pipng
5	01124654	2	washer 6,4 d433 ISO 7092 -6-140HV-A4C*
950	01181965	2	screw - UP TO MONTH OF ASSEMBLY ( A ) - FROM MONTH OF ASSEMBLY SEE POS. ( B ) A = 08.1995 B = POS. 3 EN 1662 -F-M6X20-10.9-ZNAL-A

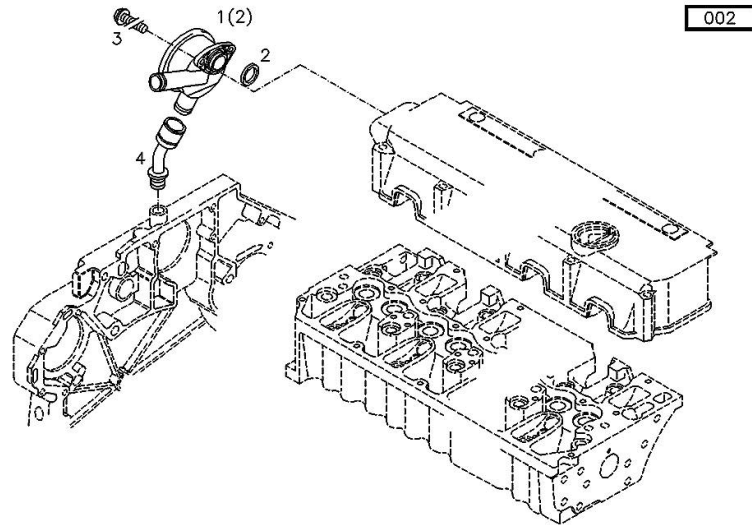
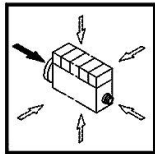

**BLEEDING TUBE**

Fig.	P/n	QTY	Name
------	-----	-----	------

Notes:  
[XM 110]

1	04198572	1	tube
2	01178750	3	clamp DIN 3021 -A-29X15

001

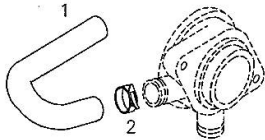

**ACCESSORIES**

Fig.	P/n	QTY	Name
------	-----	-----	------

**Notes:**

[XM 110]

**Engine serial number:**

10209473 10209497 10218034 10218038 10218043 10218044 10218614 10225342 10264765 10270604 10285220  
 10288829 10293457 10294719 10295878 10299359 10553407 10613637 10725656 10725659

3	04288659	1	support
4	01148261	2	screw ISO 4017 -M16X40-10.9-ZNAL-A
5	01181400	2	washer H 2308 -18X25X1,5-A4C

006 ©

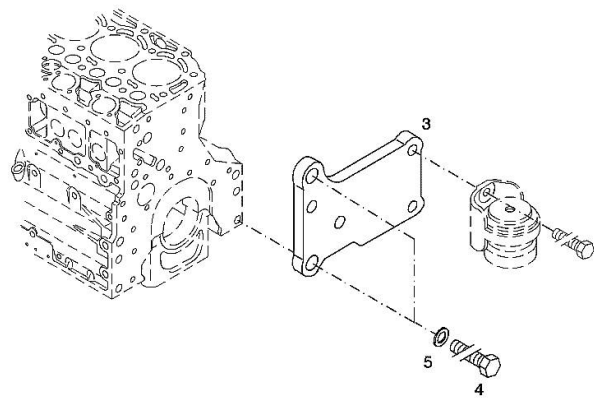
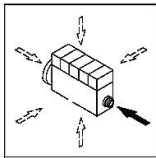

Fig.	P/n	QTY	Name
------	-----	-----	------

Notes:  
 [XM 110]

**Engine serial number:**

10209473 10209497 10218034 10218038 10218043 10218044 10218614 10225342 10264765 10270604 10285220  
 10288829 10293457 10294719 10295878 10299359 10553407 10613637 10725656 10725659

1	02937586	1	gasket set THE KIT DOES NOT CONTAIN ALL THE GASKETS: SEE SM 0199-99-9449
---	----------	---	--

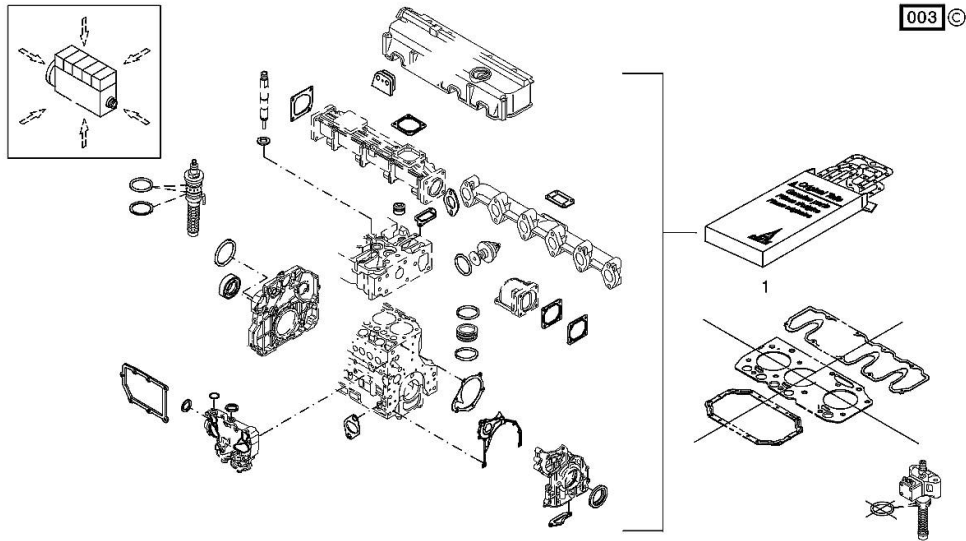

**OIL FILLER NECK**

Fig.	P/n	QTY	Name
------	-----	-----	------

Notes:  
[XM 110]

**Engine serial number:**

10209473 10209497 10218034 10218038 10218043 10218044 10218614 10225342 10264765 10270604 10285220  
10288829 10293457 10294719 10295878 10299359 10553407 10613637 10725656 10725659

1	04207099	1	tube
2	01178421	1	gasket
3	01181433	2	screw
			30 Nm

001 ©

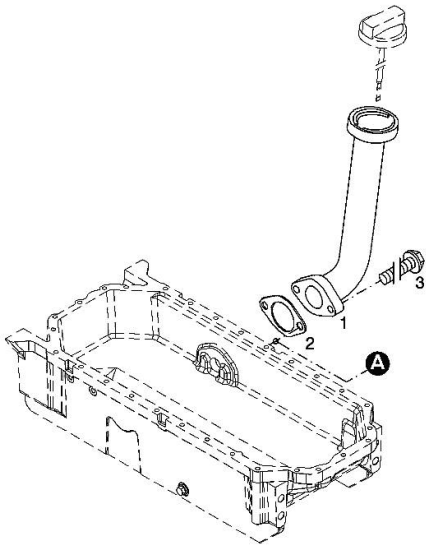
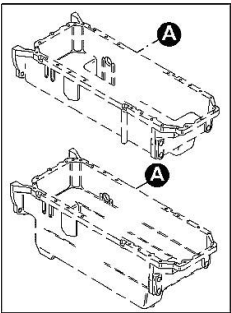
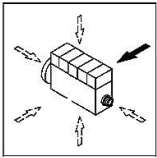

**ACCESSORIES**

Fig.	P/n	QTY	Name
------	-----	-----	------

Notes:  
[XM 110]

**Engine serial number:**

10209473 10209497 10218034 10218038 10218043 10218044 10218614 10225342 10264765 10270604 10285220  
10288829 10293457 10294719 10295878 10299359 10553407 10613637 10725656 10725659

3	01182016	2	disc H 2308 -13X24X3-ZNAL-A
4	01181400	2	washer H 2308 -18X25X1,5-A4C
5	04206926	1	plate dx/rh/re
6	04206927	1	plate sx/lh/li
7	01148137	2	screw - UP TO MONTH OF ASSEMBLY ( A ) - FROM MONTH OF ASSEMBLY SEE POS. ( B ) A = 06.2009 B = POS. 950 DIN 931 -M12X75-10.9-ZNAL-A
8	01148037	2	screw UP TO MONTH OF ASSEMBLY ( A ) - FROM MONTH OF ASSEMBLY SEE POS. ( B ) A = 06.2009 B = POS. 951 ISO 4014 -M16X75-10.9-OELGESCHW
950	01149017	2	screw - FROM MONTH OF ASSEMBLY SEE POS. ( B ) - UP TO MONTH OF ASSEMBLY (A) FROM MONTH OF ASSEMBLY A = 07.2009 B = 7 DIN 34800 -BM12X75-10.9-ZNAL-A
951	01180235	2	screw - FROM MONTH OF ASSEMBLY SEE POS. ( B ) - UP TO MONTH OF ASSEMBLY ( A ) FROM MONTH OF ASSEMBLY A = 07.2009 B= Pos.8 H 2032 -HBM16X75-10.9-GESCHW

003 ©

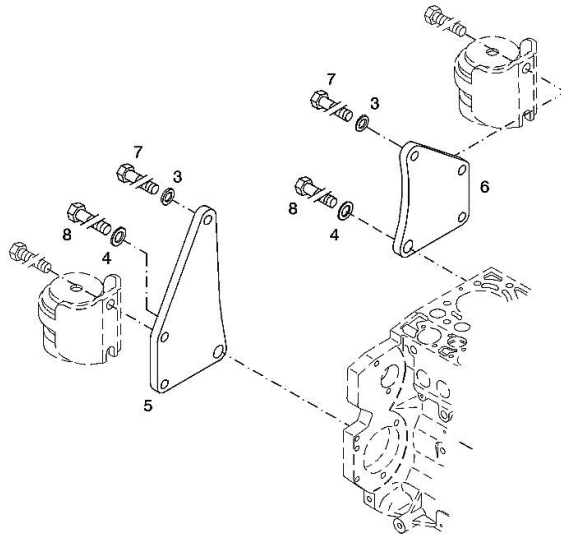
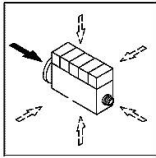



**ACCESSORIES**

Fig.	P/n	QTY	Name
------	-----	-----	------

**Notes:**

[XM 110]

**Engine serial number:**

10209473 10209497 10218034 10218038 10218043 10218044 10218614 10225342 10264765 10270604 10285220  
 10288829 10293457 10294719 10295878 10299359 10553407 10613637 10725656 10725659

3	04288660	1	support
4	01148261	2	screw ISO 4017 -M16X40-10.9-ZNAL-A
5	01181400	2	washer H 2308 -18X25X1,5-A4C

003 ©

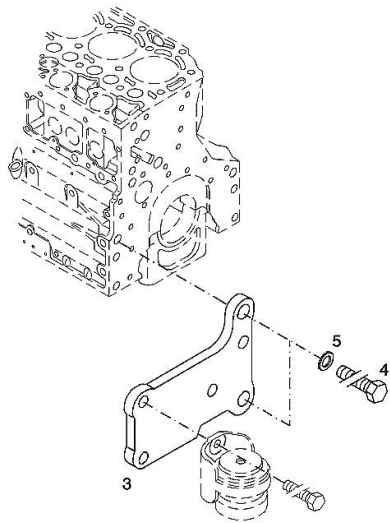
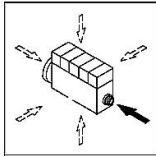

**FILLER CAP**

Fig.	P/n	QTY	Name
------	-----	-----	------

**Notes:**

[XM 110]

**Engine serial number:**

10209473 10209497 10218034 10218038 10218043 10218044 10218614 10225342 10264765 10270604 10285220  
10288829 10293457 10294719 10295878 10299359 10553407 10613637 10725656 10725659

1	01180286	1	plug H 2875 -B2-OL40-166X4-130X12
---	----------	---	--------------------------------------

000

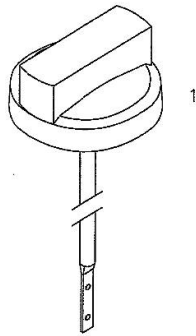

**PISTON COOL.NOZZLE**

Fig.	P/n	QTY	Name
------	-----	-----	------

**Notes:**  
[XM 110]

**Engine serial number:**  
10209473 10209497 10218034 10218038 10218043 10218044 10218614 10225342 10264765 10270604 10285220  
10288829 10293457 10294719 10295878 10299359 10553407 10613637 10725656 10725659

1	04207521	1	sprayers
---	----------	---	----------

001 ©

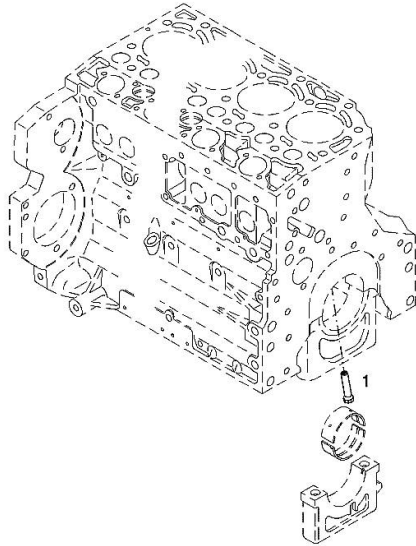
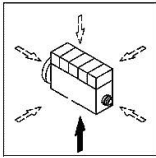

**BLEEDING TUBE**

Fig.	P/n	QTY	Name
------	-----	-----	------

Notes:  
[XM 110]

2	04198572	1	tube
3	01178750	2	clamp DIN 3021 -A-29X15
4	01167329	1	bottom H 2873 -A24,6X21,5X25-PEWEICH

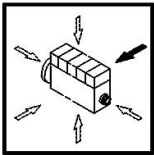

000 ©

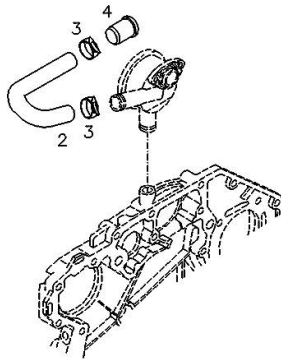

**FLANGE**

Fig.	P/n	QTY	Name
------	-----	-----	------

Notes:  
[XM 110]

1	04502445	1	oil pump WITH POS.... (2,3)
2	04502202	1	special oil seal
3	01133718	8	screw 8.5 Nm DIN 7991 -M6X16-8.8-A4C

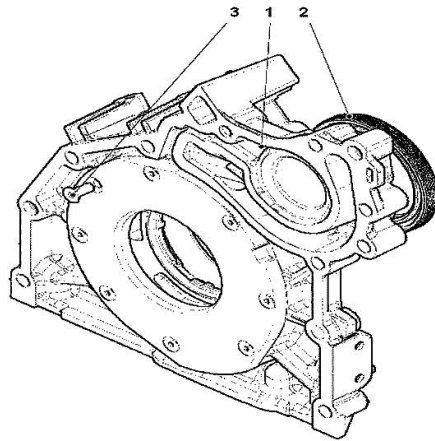

000

**FLANGE**

Fig.	P/n	QTY	Name
------	-----	-----	------

Notes:  
[XM 110]

**Engine serial number:**

10209473 10209497 10218034 10218038 10218043 10218044 10218614 10225342 10264765 10270604 10285220  
10288829 10293457 10294719 10295878 10299359 10553407 10613637 10725656 10725659

1	04258382	1	oil pump kpl. WITH POS.... (2,3)
2	04253372	1	oil seal
3	01133718	1	screw DIN 7991 -M6X16-8.8-A4C

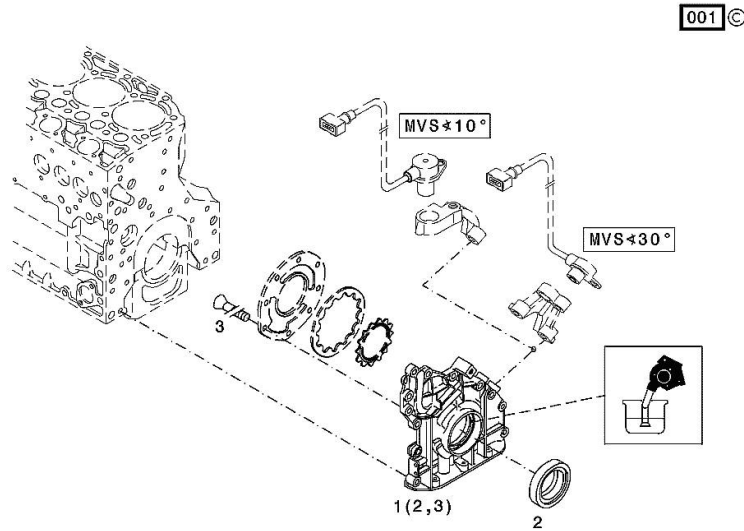
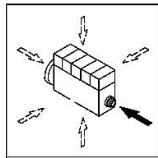

**CRANKCASE**

Fig.	P/n	QTY	Name
------	-----	-----	------

Notes:  
[XM 110]

**Engine serial number:**

10209473 10209497 10218034 10218038 10218043 10218044 10218614 10225342 10264765 10270604 10285220  
10288829 10293457 10294719 10295878 10299359

1	04289953	1	crankcase WITH POS.... (2-8.10-17)
2	04254240	14	screw
3	04160764	14	bushing
4	01110423	1	screw DIN 908 -M14X1,5-ST-ZNPHRF
5	01118693	3	gasket 14x20 DIN 7603 -A14X20-CU
6	01180890	1	screw H 2812 -906-M30X1,5-ST-A4C-PRE80
7	01180906	1	screw H 2812 -906-M22X1,5-ST-A4C-PRE80
8	01182031	2	screw H 2812 -906-M14X1,5-ST-A3C-LOCTITE506
10	04251884	6	plug
11	04250086	1	ring
12	01148032	9	cover DIN 443 -A45-ZNPHR
13	01179634	6	plug H 2860 -A36-ST-FE/ZNPHR
14	01100940	2	screw DIN 7604 -AM14X1,5-ST-A4C
15	04202518	1	sleeve
16	04226536	1	bottom
17	04202517	1	sleeve
185	01016125	1	guard H 0699 -DEUTZDW72-250ML

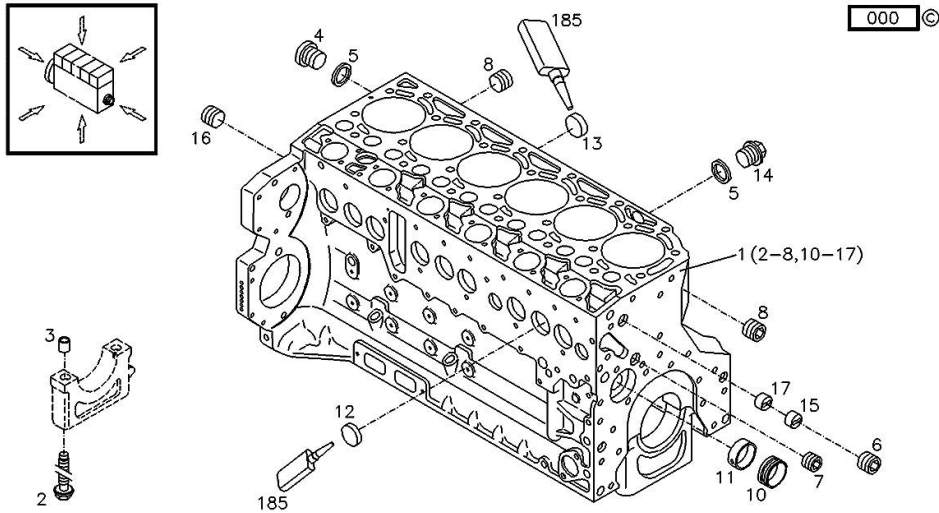

0507 8938

Thank you so much for reading.  
Please click the “Buy Now!”  
button below to download the  
complete manual.



After you pay.

You can download the most  
perfect and complete manual in  
the world immediately.

Our support email:

[ebooklibonline@outlook.com](mailto:ebooklibonline@outlook.com)