

# **SCORPION**

**6030 (K20 / 415-11)**

**6035 (K21 / 415-11)**

**7030 (K22 / 415-13)**

**7035 (K23 / 415-15)**

**Repair manual**

## Validity of manual

Machine	Type	Sub-type	Vehicle identification number	
			from	to
SCORPION 6030	K20 (415-11)	250	415-110001	415-119999
SCORPION 6030	K20 (415-11)	260	415-110001	415-119999
SCORPION 6030	K20 (415-11)	350	415-110001	415-119999
SCORPION 6030	K20 (415-11)	360	415-110001	415-119999
SCORPION 6035	K21 (415-11)	250	415-110001	415-119999
SCORPION 6035	K21 (415-11)	260	415-110001	415-119999
SCORPION 6035	K21 (415-11)	350	415-110001	415-119999
SCORPION 6035	K21 (415-11)	360	415-110001	415-119999
SCORPION 7030	K22 (415-13)	250	415-130001	415-139999
SCORPION 7030	K22 (415-13)	260	415-130001	415-139999
SCORPION 7030	K22 (415-13)	350	415-130001	415-139999
SCORPION 7030	K22 (415-13)	360	415-130001	415-139999
SCORPION 7035	K23 (415-15)	250	415-150001	415-159999
SCORPION 7035	K23 (415-15)	260	415-150001	415-159999
SCORPION 7035	K23 (415-15)	350	415-150001	415-159999
SCORPION 7035	K23 (415-15)	360	415-150001	415-159999

# Fuel tank

## Work preparation

Utilities:

- ▶ Sealing agents and glue:  
LOCTITE 243 - 60 0571 153 1

## Technical specifications

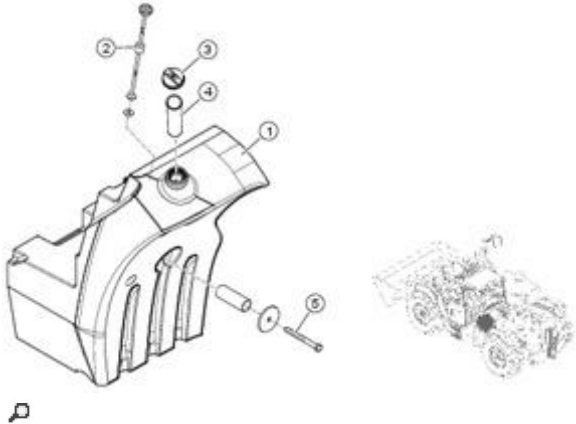

	Value	CCN	Remark / designation	
1	20 kg		Fuel tank Capacity: approx. 100 litres	
2		B001-KRA	Fuel measuring device	
3			Fuel filler cap	
4			Filling screen	
5	195 Nm		Fuel tank mounting bolt  - Insert bolt with LOCTITE 243.	
Tightening torques not specified, see "Introduction / Tightening torques" chapter				

## Draining the fuel

### CAUTION

Swallowing of fuels.

Poisoning hazard.

- ▶ When swallowing fuel, consult a doctor immediately.
- ▶ Keep fuels outside of the reach of children.

---

### NOTICE

Lubricants and fuels end up in the environment.

Environmental pollution

- ▶ Collect and store lubricants and fuels in suitable containers and dispose of them properly.

- ▶ Park the machine on level ground.
- ▶ Switch off and secure the machine.
- ▶ Open the fuel filler cap and remove the filling screen.
  - ▶ Clean the filler opening area before opening the fuel filler cap.
- ▶ Pump off the fuel with a pump and collect the fuel in a sufficiently large container.

Capacity of fuel tank:

Fuel tank

### Removing the fuel level sensor

- ▶ Disconnect the battery isolating relay.  
Battery isolation relayK141-KRA Battery isolating relay

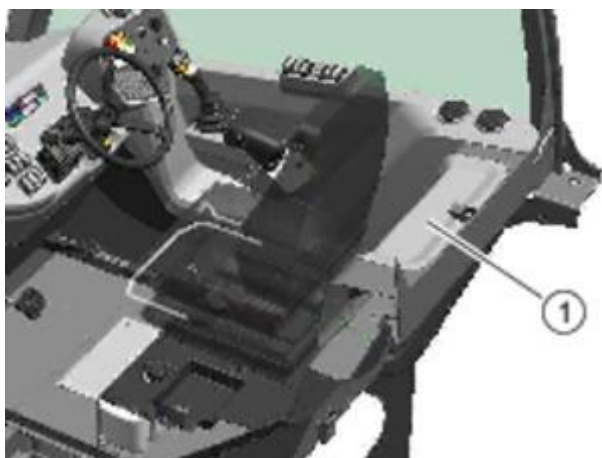

▶

- ▶ Open cover (1).



▶

- ▶ Remove cover (1).

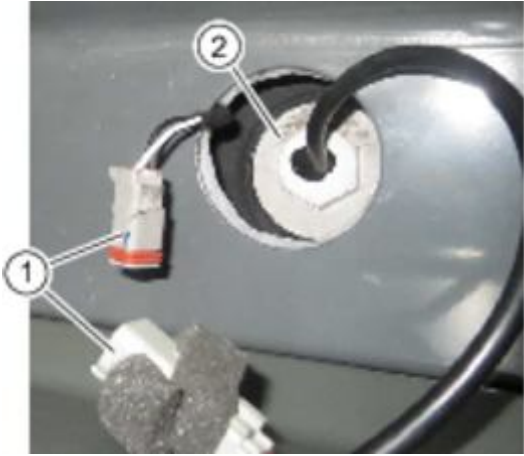

⤵

- ▶ Disconnect cable plug (1).
- ▶ Unscrew and remove fuel level sensor (2).

### Installing the fuel level sensor

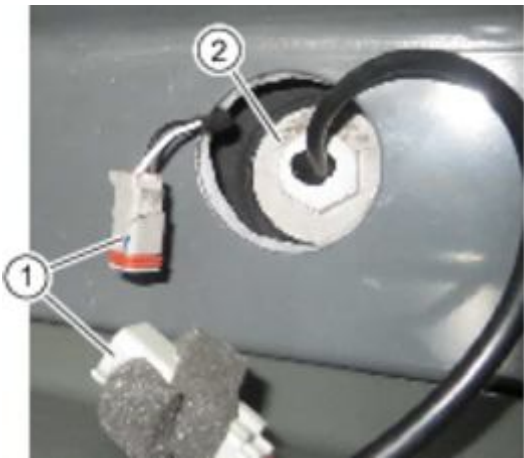

⤵

- ▶ Insert and screw on fuel level sensor (2).
- ▶ Connect cable plugs (1).



⤵

- ▶ Insert cover (1).

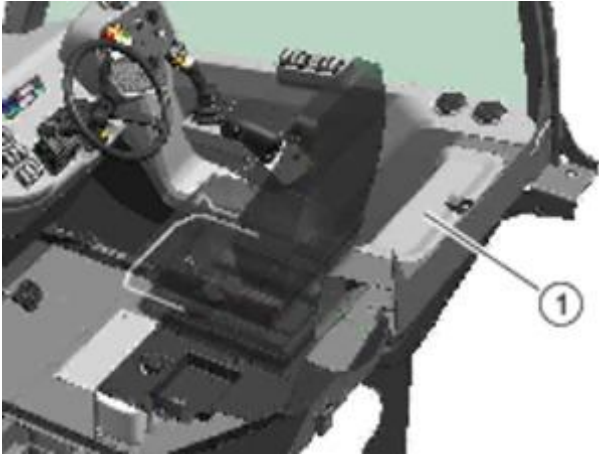

- ▶ Close flap (1).
- ▶ Connect the battery isolating relay.  
Battery isolation relayK141-KRA Battery isolating relay.

## Removal

- ▶ Disconnect the battery isolating relay.  
Battery isolation relayK141-KRA Battery isolating relay.
- ▶ Remove the rear left wheel.
- ▶ Remove the rear left mud guard.  
Mud guard
- ▶ Drain fuel.  
Fuel tank

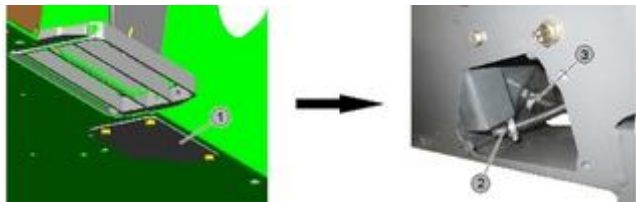

- ▶ Remove plate (1).
- ▶ Mark position of suction line (2) and unscrew it.
- ▶ Mark position of return line (3) and unscrew it.

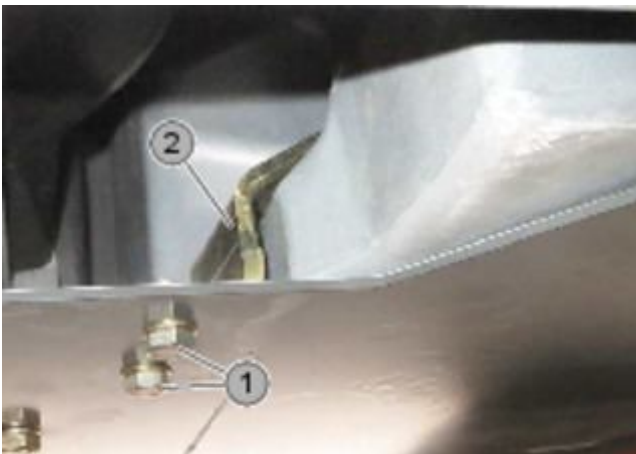

- ▶ Unscrew bolts (1).
- ▶ Remove brackets (2).

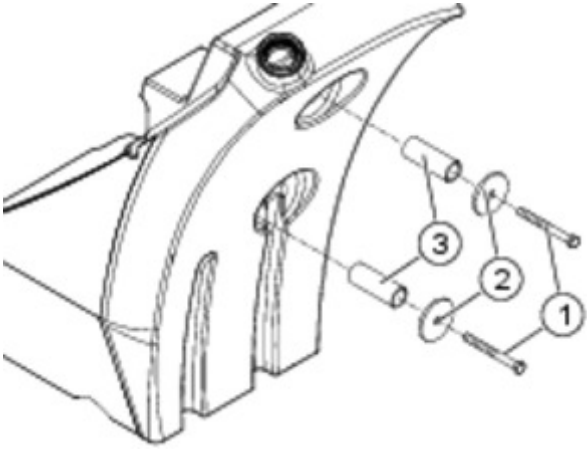

⌞

- ▶ Unscrew bolts (1).
- ▶ Remove the washers (2) and sleeves (3).

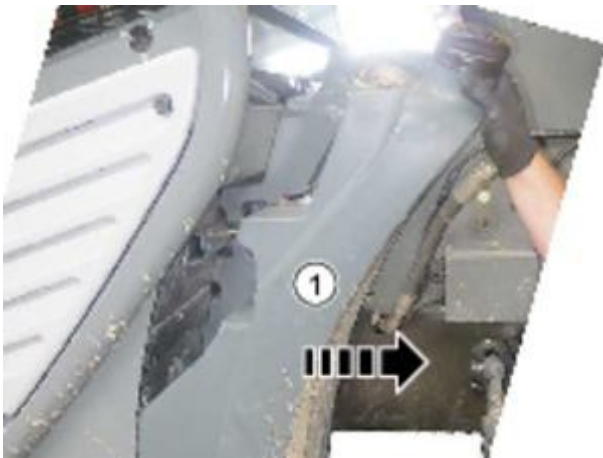

⌞



⌞

- ▶ Remove fuel tank (1).
- ▶ Connect connector (1) of fuel level sensor (B001-KRA).

## Installation



▫



▫

- ▶ Insert fuel tank (1).
- ▶ Disconnect connector (1) of fuel level sensor (B001-KRA).

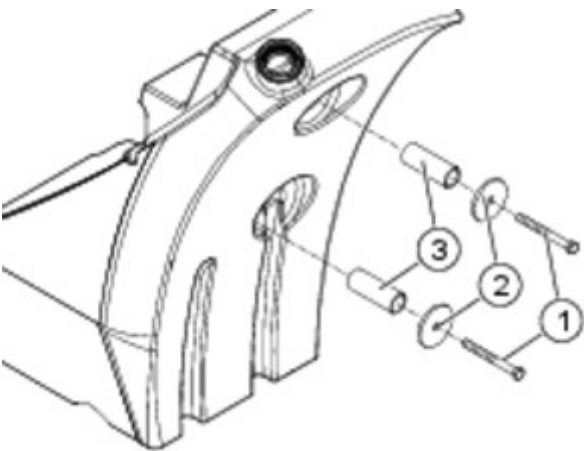

▫

- ▶ Insert the sleeves (3) and washers (2).
  - ▶ Bolt down bolts (1).
- Tightening torque:  
Fuel tank

Insert bolts with LOCTITE 243.



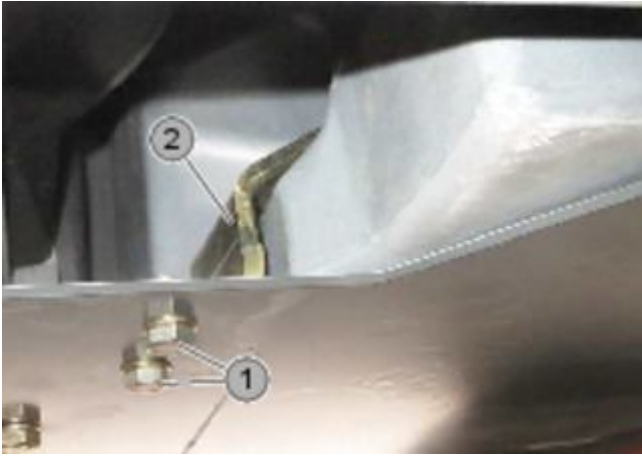

Ⓟ

- ▶ Bolt down bracket (2) with bolts (1).

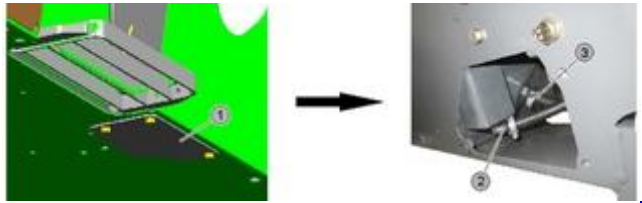

Ⓟ

- ▶ Screw on suction line (2), using the mark.
- ▶ Screw on return line (3), using the mark.
- ▶ Install plate (1).
  
- ▶ Install the rear left mud guard.  
Mud guard
- ▶ Install the rear left wheel.
- ▶ Connect the battery isolating relay.  
Battery isolation relayK141-KRA Battery isolating relay.

# Fuel filter

Applies to:

Deutz TCD 3.6 L4 diesel engine

## Technical specifications

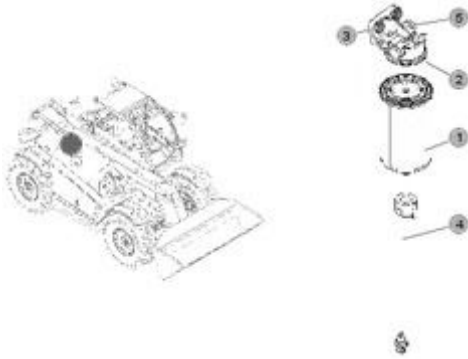

Ⓜ

	Value	CCN	Remark / designation	
1	10 Nm		Fuel filter	
2			Filter head	
3			Mounting bolts	
4	1.6 Nm		Sensor cable	
5	6.5 Nm		Vent plug	
Tightening torques not specified, see "Introduction / Tightening torques" chapter				

## Removal



Ⓜ

### Without fuel pre-heater:

- ▶ Unscrew fuel lines (1) and (2).

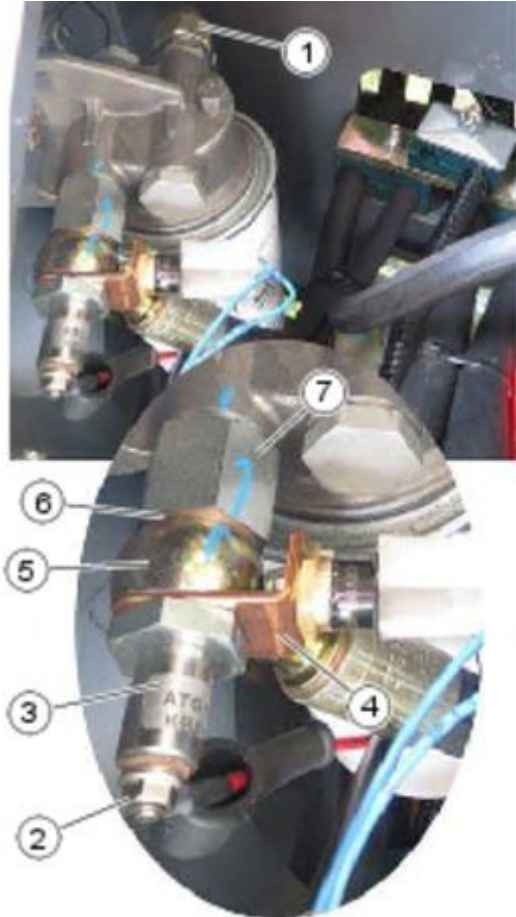

⤵

#### With fuel pre-heater:

- ▶ Unscrew fuel line (1).
- ▶ Unscrew nut (2) and remove cable.
- ▶ Unscrew fuel pre-heater (3).
- ▶ Remove cable (4).
- ▶ Remove fuel line (5) and seal (6).
- ▶ Unscrew extension (7).



⤵

- ▶ Disconnect cable plug (1).

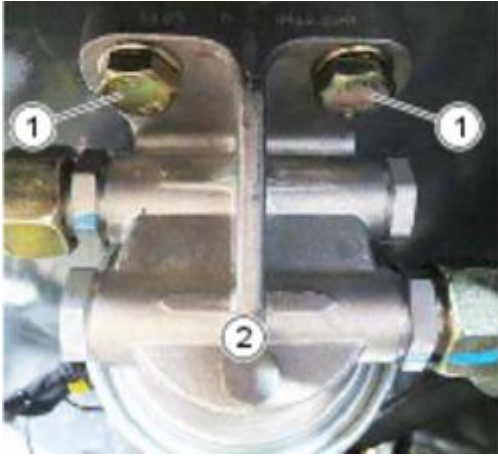

▫

- ▶ Unscrew bolts (1) and remove fuel filter (2).

### Installation

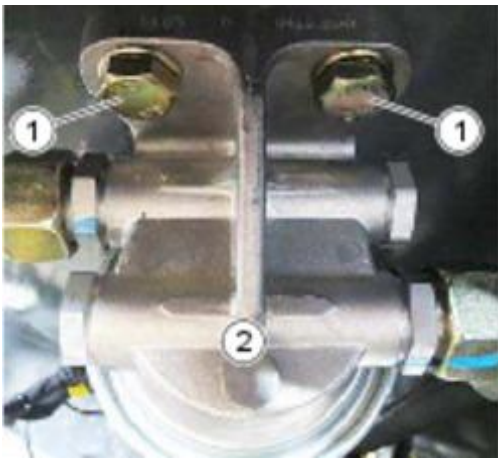

▫

- ▶ Bolt down fuel filter (2) with bolts (1).



▫

- ▶ Connect cable plug (1).

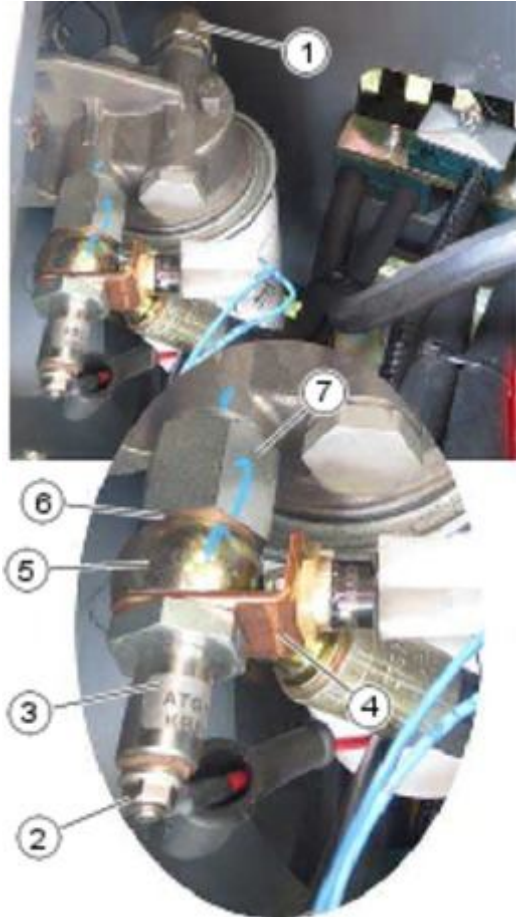

⤵

**With fuel pre-heater:**

- ▶ Screw on extension (7).
- ▶ Install fuel line (5) and seal (6).
- ▶ Install cable (4).
- ▶ Screw on fuel pre-heater (3).
- ▶ Screw on cable with nut (2).
- ▶ Screw on fuel line (1).

Tightening torque:

Fuel lines



⤵

**Without fuel pre-heater:**

- ▶ Screw on fuel lines (1) and (2).

Tightening torque:



***Buy Now***



Our support email:

[ebooklibonline@outlook.com](mailto:ebooklibonline@outlook.com)