

JAGUAR 980-930

Repair Manual

Validity of manual

This manual applies to the following machine / front attachment:

Designation	Type	Serial no.	
		From	To
JAGUAR 980-930	498	498 00011	–

Engine output clutch

Applies to:

Transfer gearbox 00 0774 792 X

Transfer gearbox 00 0774 711 X

Technical specifications

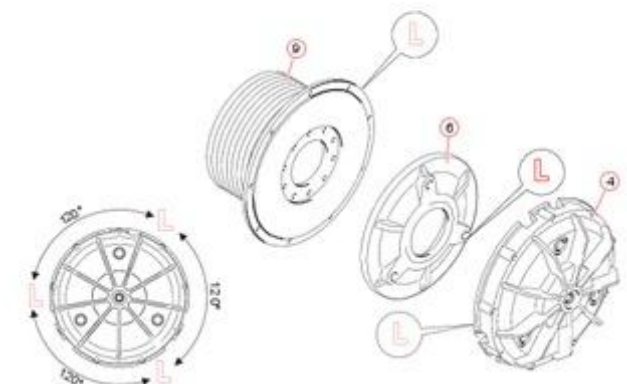
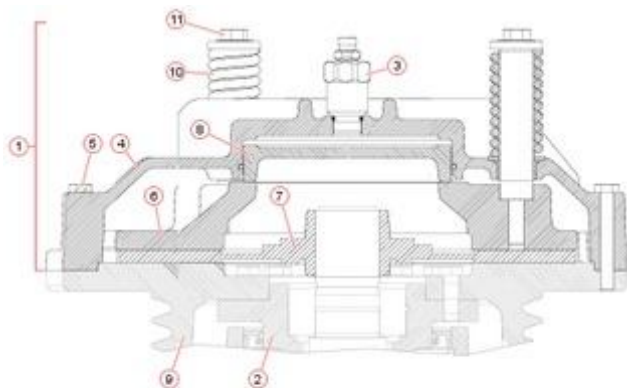

D

	Value	CCN	Remark / designation	
Tightening torque values not specified, see "Introduction / Tightening torques" chapter				
1			Engine output clutch	
2			Transfer gearbox	Identifying the engine output transfer gearbox
3		4041	Rotary transmission leadthrough	Rotary transmission leadthrough4041 Rotary transmission leadthrough
4			Clutch housing - The clutch housing is marked with the letter "L" near the residual unbalance.	
5	83,5 Nm		Clutch housing mounting bolts	
6			Thrust plate - The thrust plate is marked with the letter "L" near the residual unbalance.	

	Value	CCN	Remark / designation	
7			Clutch plate - Friction linings must be free of oil and grease. - Coat external spline with Anti-Seize. - Observe the installation position.	
8		3017	Engine output clutch hydraulic cylinder	
9			Drive pulley of belt (R01) - The pulley is marked with the letter "L" near the residual unbalance.	
10			Compression spring Colour marking green / red / yellow - Ensure that only springs of the same colour marking are installed.	
11	123 Nm		Mounting bolts - Only use genuine CLAAS bolts!	

Work preparation

Utilities:

- ▶ Assembly pastes:
Anti-Seize

Removing

- ▶ Remove the rear left mud guard.

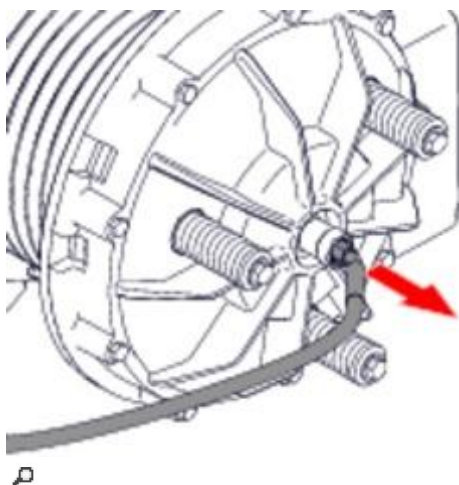

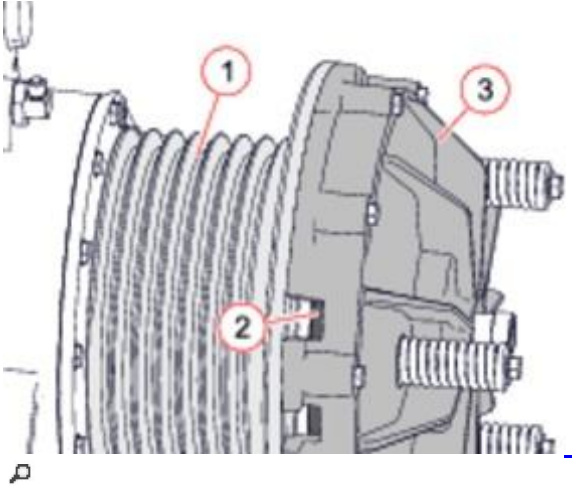

- ▶ Mark the installation position of pulley (1), thrust plate (2) and clutch housing (3) with respect to one another.

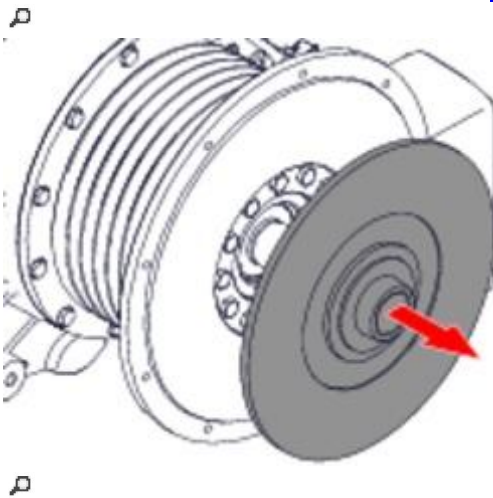
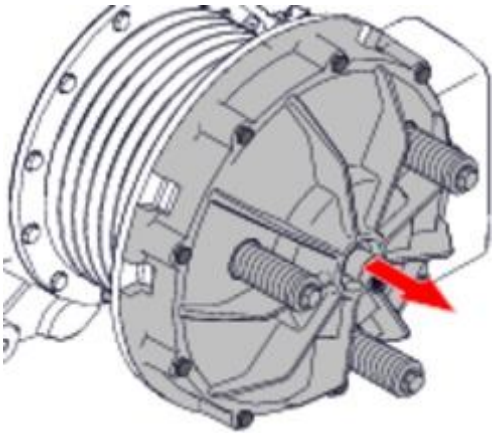

- ▶ Remove the clutch plate.
 - ▶ Ensure that the friction linings will not get in contact with oil or grease.

Disassembling

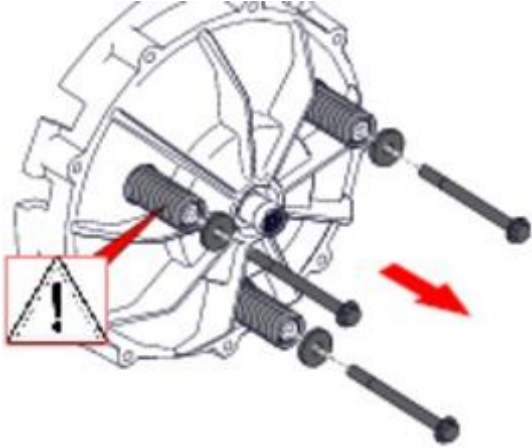

⌘

⚠ WARNING!

Careless assembly.

Danger of injury from spring tension.

- ▶ Secure components against flying out due to the spring tension.
- ▶ Relieve the spring tension slowly.

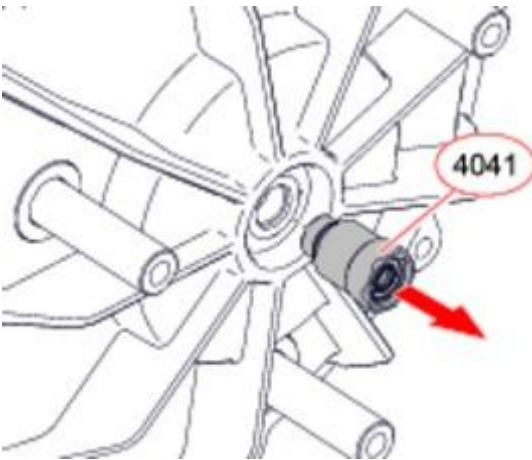

⌘

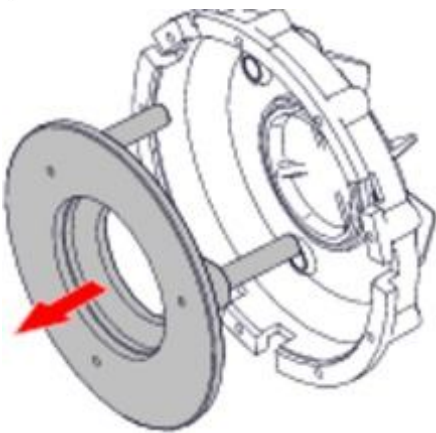

⌘

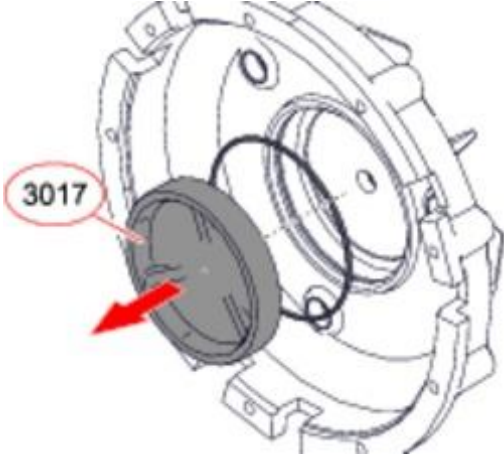

p

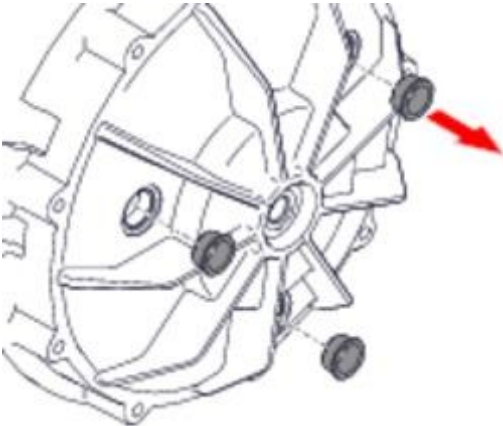

p

Assembly

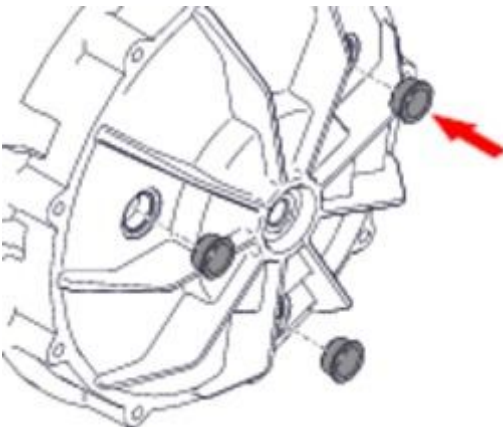

p



p

► Apply a little hydraulic oil to the sealing ring and the piston (3017).

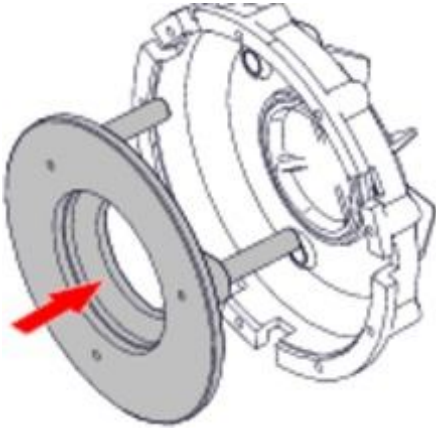

⌘

- ▶ Insert thrust plate.
 - ▶ Ensure that the friction faces will not get in contact with oil or grease.

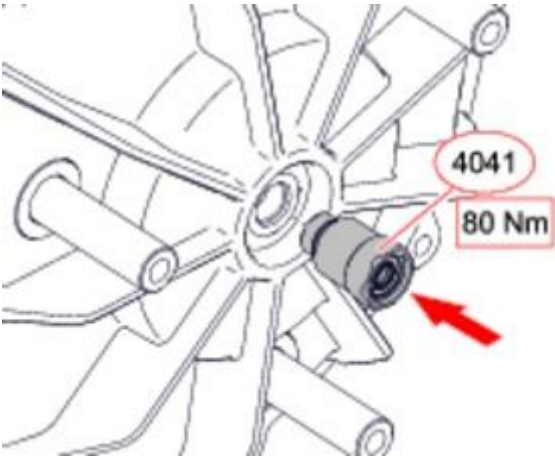

⌘

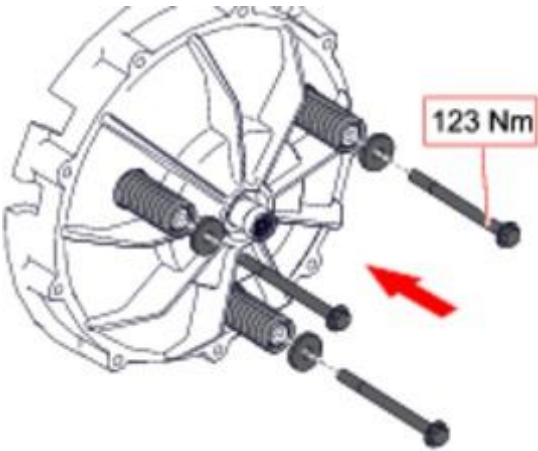

⌘

Installing

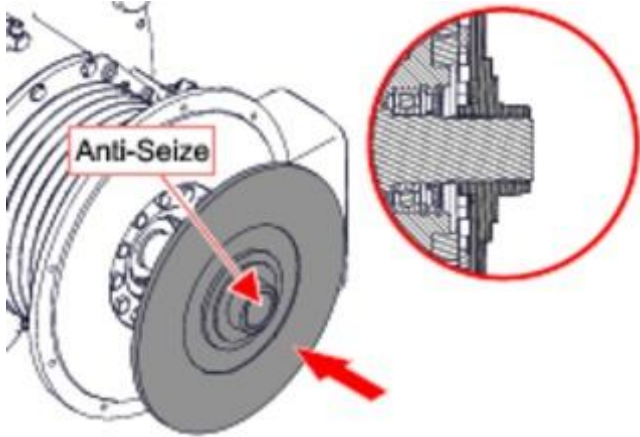

⌘

- ▶ Clean the thrust place friction face to be free of grease and rust.
- ▶ Apply a thin coat of Anti-Seize to external spline.
- ▶ Slide on the clutch plate.
 - ▶ Observe the direction of installation.
 - ▶ Ensure that the friction linings will not get in contact with oil or grease.

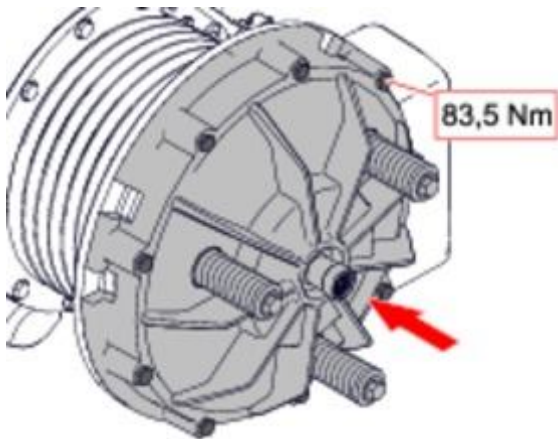

⌘

- ▶ Bolt down the clutch, using the marks.

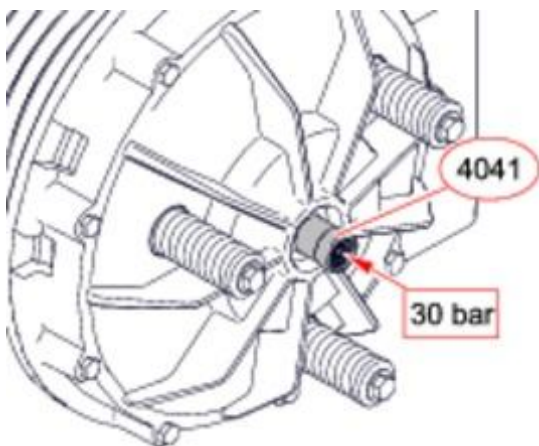

⌘

- ▶ To check the seal of piston (3017), apply a pressure of 30 bar to rotary coupling (4041).

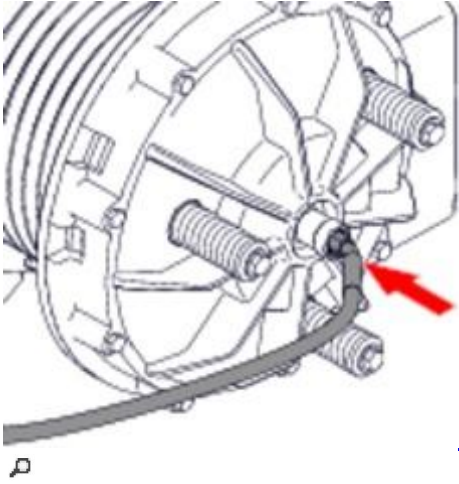

- ▶ Install the rear left mud guard.
- ▶ Check the hydraulic oil level as specified in the Operator's Manual.

Identifying the engine output transfer gearbox

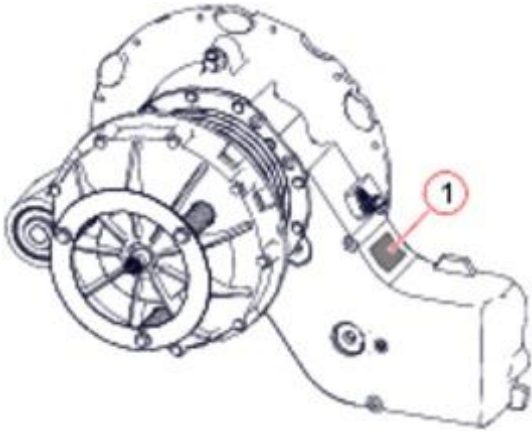

▢

- Identify the transfer gearbox by its part number on the identification plate at (1).

Transfer gearbox	Engine variant	
00 0774 710.X	Mercedes-Benz OM 47x LA	<u>Engine output transfer gearbox</u>
00 0774 715.X	Mercedes-Benz OM 502 LA	<u>Engine output transfer gearbox</u>
00 0774 792.X	MAN D2868	<u>Engine output transfer gearbox</u>
00 0774 711.X	MAN D2862	<u>Engine output transfer gearbox</u>

Engine output transfer gearbox

Applies to:

Transfer gearbox 00 0774 715 X

Technical specifications

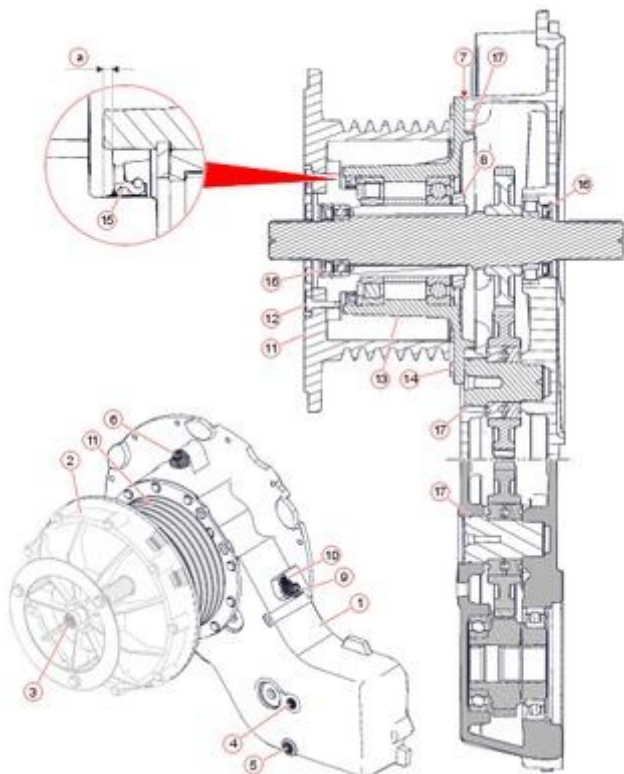

⚠

	Value	CCN	Remark / designation	
Tightening torque values not specified, see "Introduction / Tightening torques" chapter				
1	220 kg		Transfer gearbox	
2			Engine output clutch	Engine output clutch
3		4041	Rotary transmission leadthrough	Rotary transmission leadthrough4041 Rotary transmission leadthrough
4	50 Nm		Oil level check plug - Insert bolt with teflon tape.	
5	50 Nm		Drain plug - Insert bolt with teflon tape.	
6			Vent plug - Insert bolt with teflon tape.	
7			Apply Omnifit FD 10 to the flange faces.	

	Value	CCN	Remark / designation	
8			Slotted nut Installation instructions: <ul style="list-style-type: none"> - Coat the axle thread and the nut and tab washer contact faces with Anti-Seize. - Bolt down slotted nut with 800 Nm . - Turn slotted nut until the next slot is reached. - Secure slotted nut with a tab washer. 	
9		B010	Diesel engine speed sensor	
10	10 Nm		Mounting bolts of sensor (B010)	
11	45 kg		Drive pulley of belt (R01)	
12	123 Nm		Belt (R01) drive pulley mounting bolts <ul style="list-style-type: none"> - Replace the bolts every time when installing. - Only use genuine CLAAS bolts! 	
13	20 kg		Bearing cover	
14	71 Nm		Bearing cap mounting bolts <ul style="list-style-type: none"> - Replace the bolts every time when installing. - Only use genuine CLAAS bolts! 	
15			Radial shaft seal Installation instructions: <ul style="list-style-type: none"> - Insert seal with grease. - Apply a little transmission oil to the sealing ring track. - Install seal with the hole marking facing diagonally upwards (towards the fixed calliper joint). - Observe dimension (a). 	
16			Radial shaft seals <ul style="list-style-type: none"> - Insert seals with grease. - Apply a little transmission oil to the sealing ring track. 	
17			O-rings <ul style="list-style-type: none"> - Lightly coat the O-rings with transmission oil. 	
a	3.0 mm		Adjusting dimension of radial shaft seal (15)	

Work preparation

Utilities:

- ▶ Lubricants:
Grease as specified in the Operator's Manual
Transmission oil as specified in the Operator's Manual
- ▶ Sealing agents and glue:
Omnifit FD 10
Teflon tape
- ▶ Assembly pastes:
Optimol

Special tool



⤷

-

	Special tool (I)	Pcs.
1	Keys 00 0146 091 0	1

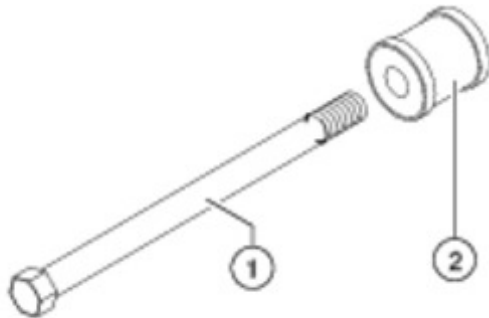

⤷

-

	Special tool (II)	Pcs.
1	Connecting rod 225 mm 00 0181 606 0	1
2	Striking tool 00 0181 604 0	1

Removing

- ▶ Remove the rear left mud guard.
- ▶ Drain the transfer gearbox oil as described in the Operator's Manual.

Buy Now



Our support email:

ebooklibonline@outlook.com