

VARIO 1380

VARIO 1230

VARIO 1080

Repair manual

Validity of manual

Front attachment	Type	Identification number	
		from	to
VARIO 1380	536	53600011	–
VARIO 1380	540	54000011	–
VARIO 1230	536	53600011	–
VARIO 1230	540	54000011	–
VARIO 1080	536	53600011	–
VARIO 1080	540	54000011	–

Using the manual

This repair manual should help you to ensure that the machine is permanently available for use. This repair manual compiles the experience gained by our service technicians and factory staff.

- The image sequence illustrates the steps in a repair procedure. The text provides you with the information required for making adjustments, using special tools and further similar information.
- Essential repairs are listed in such a way that even individual and small repairs can be easily found and followed.
- Supplements are added to reflect the ongoing technical development of the machines.
- Always compare the setting values and fill quantities with the most recent operator's manual or system documentation for the respective machine.

The high value of the machine is ensured through careful maintenance and technical monitoring by customer service.

Text and figures

Photos and graphics have been kept neutral. Notes beneath the figure will draw your attention to any differences.

Text is kept as short and neutral as possible. Subheadings will draw your attention to any differences.

Text types can be easily distinguished from each other by corresponding formatting. There are the following format types:

Formatting	Meaning	Description
Description	Descriptive text	More information on the subject.
- Procedure instructions	Process	Processes to be carried out one after the other.
<i>Result</i>	Result	Result of processes carried out.

Layout with assembly group structure

The chapters of this manual are structured into assembly groups to the extent that the content allows this. The structure of these assembly groups is the same in all chapters.

Different product groups have different assembly group structures. CLAAS always endeavours to keep these assembly group structures the same in all documents.

Search and find

Thanks to the recurring assembly group structure, it is easy to find the corresponding topic via the table of contents or the header of this manual.

In addition, the index of this manual is a useful tool for locating a specific subject. The index is at the end of the manual.

Directional indicators

Textual information such as front, rear, right and left apply in the direction of travel. In diagrams, the direction of travel is indicated by a direction of travel arrow, where required.

Abbreviations

Abbreviation	Description
bar	bar (unit of pressure)

Cylindrical angle gear

Technical specifications

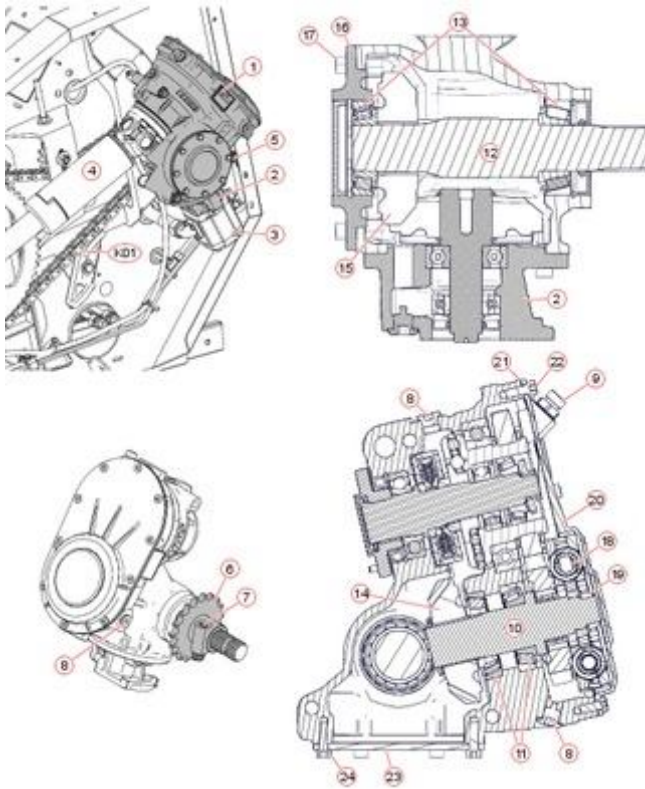

D

	Value	CCN	Remark / designation	
1	30 kg		Cylindrical angle gear	
2			Pump flange	Pump flange
3		2022	Rape cutter drive hydraulic pump	Rape cutter drive hydraulic pump (2022)
4			Knife drive universal drive shaft	Knife drive universal drive shaft
5			Cylindrical angle gear mounting bolts	
6			Drive sprocket of chain (K01) - Changing the speed: See the Operator's Manual of the machine in question.	
7	120 Nm		Drive sprocket mounting bolt	
8	29.5 Nm		Screw plugs - Insert bolts with Loctite 243.	
9	29.5 Nm		Vent plug	
10			Shaft 1	

	Value	CCN	Remark / designation	
11			Bearing of shaft 1 - Adjust the bearing pre-load (a) with spacer washers.	
12			Shaft 2 - Coat external spline with Anti-Seize.	
13			Bearing of shaft 2 - Adjust the bearing pre-load (b) with spacer washers.	
14			Gear 1	
15			Gear 2	
16			Flange cover - Coat sealing faces with Omnifit FD 10.	
17	24.5 to 29.5 Nm		Flange cover fastening bolts	
18			Spring element	
19	147 to 196 Nm		Spring element nut - Insert nut with Loctite 243.	
20			Lid	
21			Seal - Coat seal with grease from both sides.	
22	19.5 to 24.5 Nm		Cover fastening bolts - Insert bolts with Loctite 270.	
23			Lower cover - Coat sealing faces with Omnifit FD 10.	
24	24.5 to 29.5 Nm		Lower cover fastening bolts	
a	0.5 to 0.9 Nm		Bearing pre-load of bearing (11)	
b	0 to 0.3 Nm		Bearing pre-load of bearing (13)	
c	0.18 to 0.49 mm		Backlash	
Tightening torques not specified, see "Introduction / Tightening torques" chapter				

Work preparation

Utilities:

- ▶ Lubricants:
Grease as specified in the Operator's Manual
Transmission oil as specified in the Operator's Manual
- ▶ Sealing agents and glue:
omniFIT FD 10- 00 0219 027 0
Loctite 243 - 60 0571 153 1
Loctite 270 - 00 1994 260 0
- ▶ Assembly pastes:
Anti-Seize - 00 0136 571 0

Special tool



Ⓟ

	Special tool (I)	Pcs.
1	Socket spanner M25 x 1,5 00 1890 608 X	1

Removal



Drain the oil from the cylindrical angle gear.

Operator's Manual



Remove the knife drive universal drive shaft.

[Knife drive universal drive shaft](#)



Remove the rape cutter drive hydraulic pump if necessary.

[Rape cutter drive hydraulic pump \(2022\)](#)

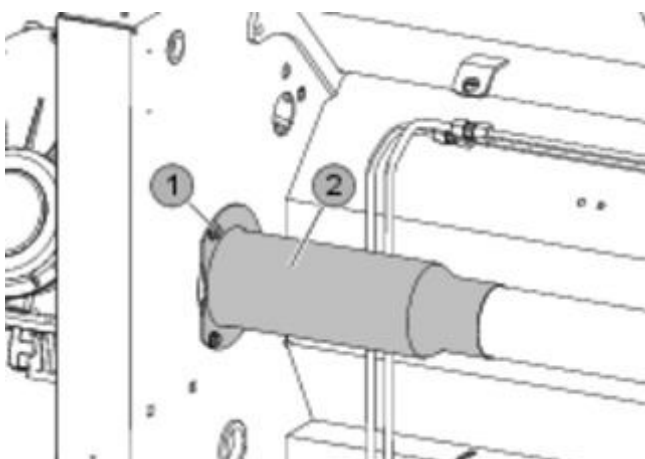

Ⓟ

- ▶ Unscrew bolts (1).
- ▶ Push back protective sleeve (2).

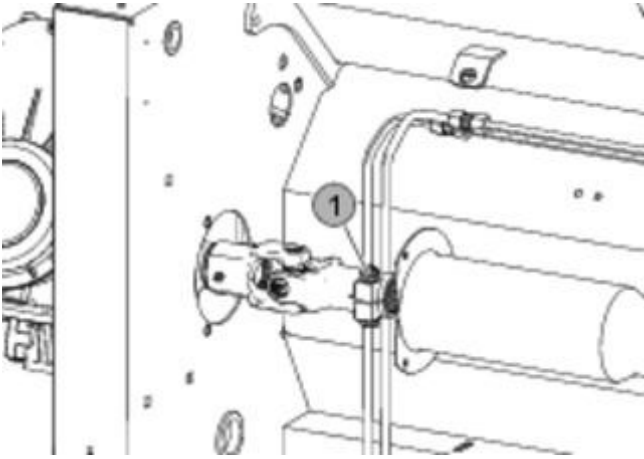

- ▶ Unscrew bolt (1).

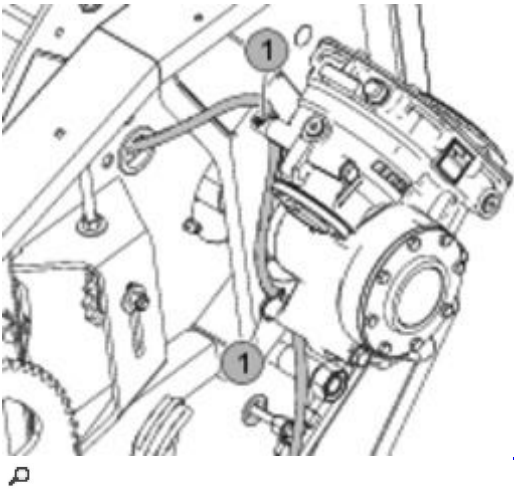

- ▶ Loosen cable bands (1).

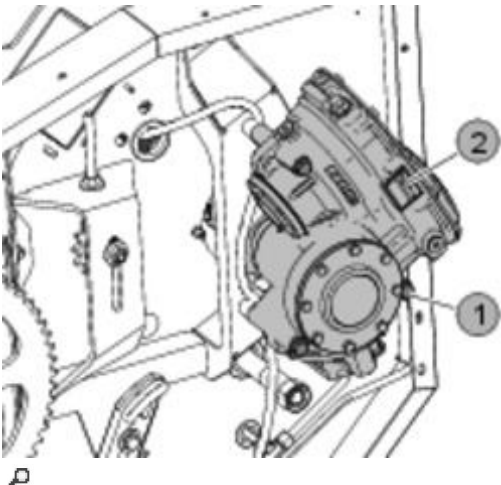

- ▶ Unscrew bolts (1) and carefully pull off gearbox (2).
Weight of gearbox:
Cylindrical angle gear

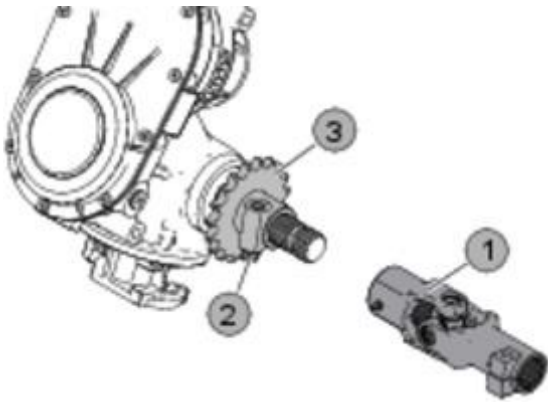

▢

- ▶ Pull off universal joint (1).
- ▶ Unscrew bolt (1).
- ▶ Pull off drive sprocket (3).

Disassembly



Remove the pump flange.

Pump flange

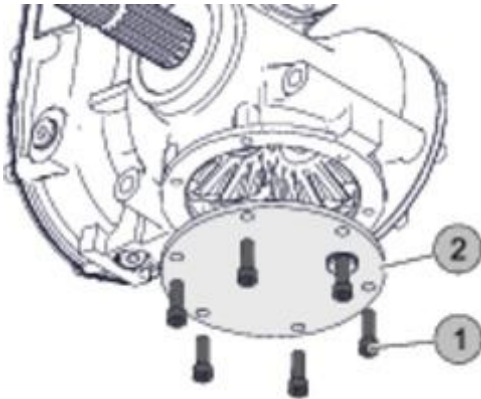

- ▶ Unscrew bolts (1).
- ▶ Remove cover (2).

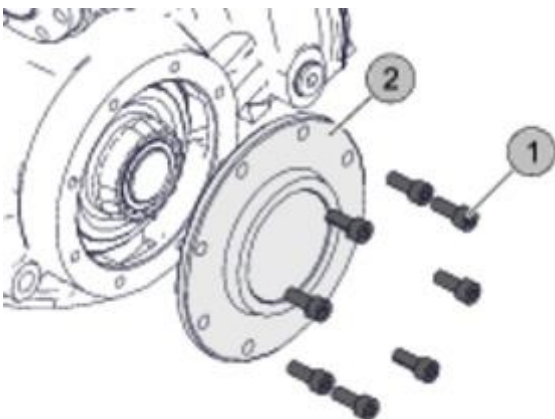

- ▶ Unscrew bolts (1).
- ▶ Remove cover (2).

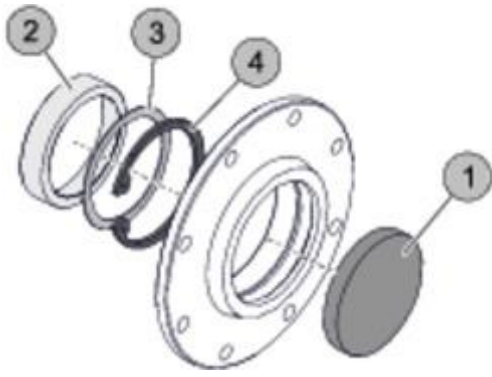

- ▶ Remove lid (1).
- ▶ Remove circlip (4).
- ▶ Remove spacer washer (3).
- ▶ Remove outer bearing race (2).

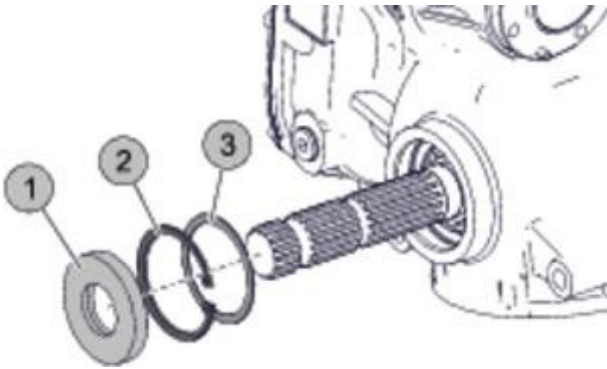

- ▶ Remove radial shaft seal (1).
- ▶ Remove circlip (2).
- ▶ Remove spacer washer (3).

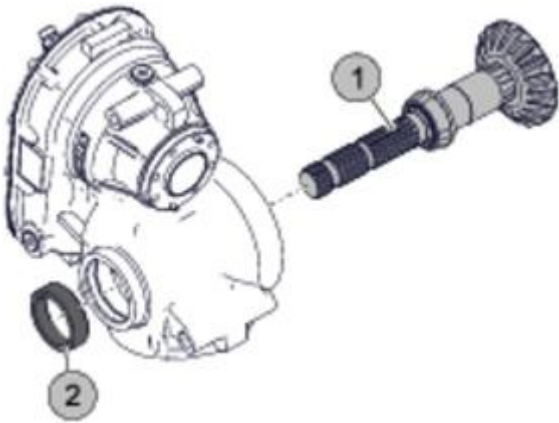

- ▶ Drive out shaft (1).
- ▶ Remove outer bearing race (2).

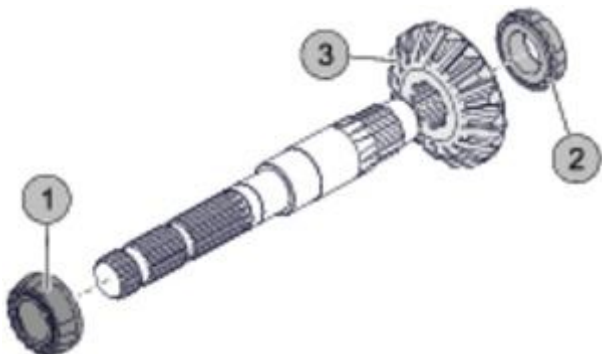

- ▶ Pull off bearing inner rings (1) and (2).

- ▶ Remove gear (3).

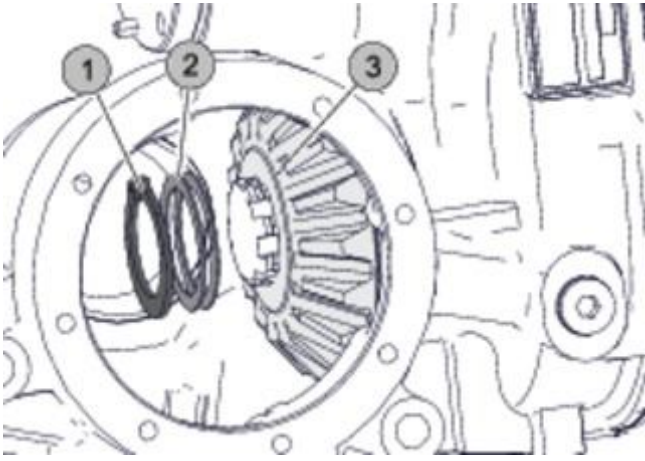

- ▶ Remove circlip (1).
- ▶ Remove spacer washers (2).
- ▶ Remove gear (3).

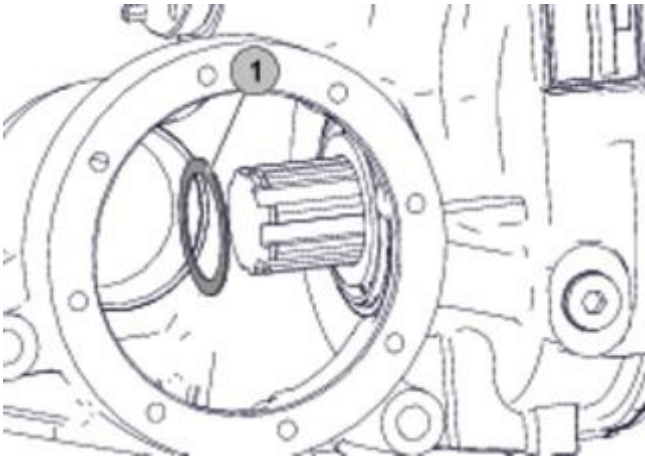

- ▶ Remove spacer washer (1).

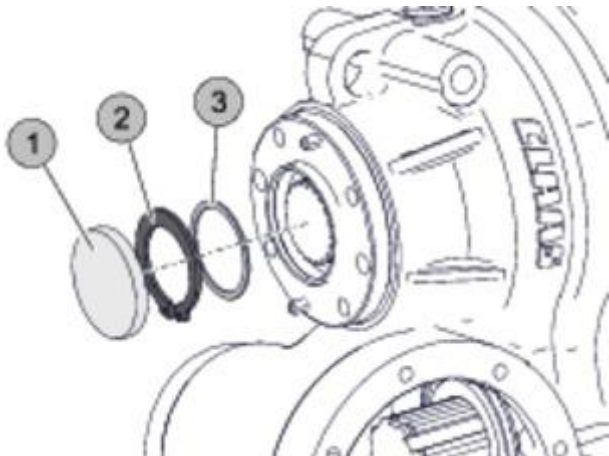

- ▶ Remove lid (1).
- ▶ Remove circlip (2).
- ▶ Remove spacer washer (3).

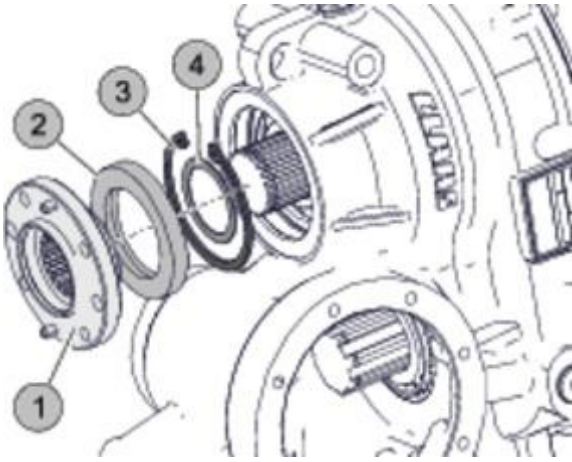

- ▶ Pull off flange (1).
- ▶ Remove rotary shaft lip type seal (2).
- ▶ Remove circlip (3).
- ▶ Remove spacer washer (4).

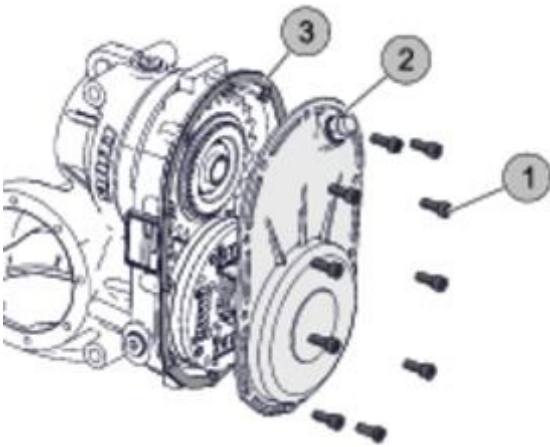

- ▶ Unscrew bolts (1).
- ▶ Remove cover (2).
- ▶ Remove seal (3).

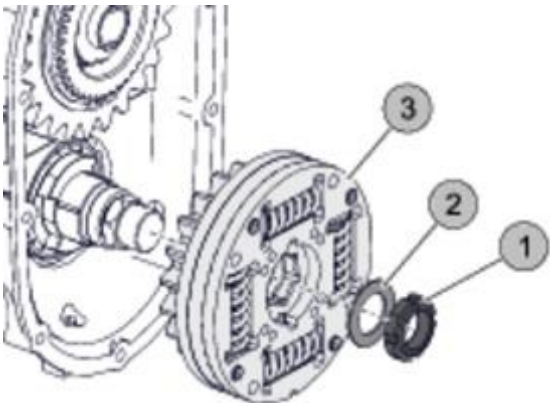

- ▶ Remove the split pin that secures slotted nut (1) and unscrew it with special tool (I).
Cylindrical angle gear
- ▶ Remove spacer washer (2).
- ▶ Remove spring element (3).

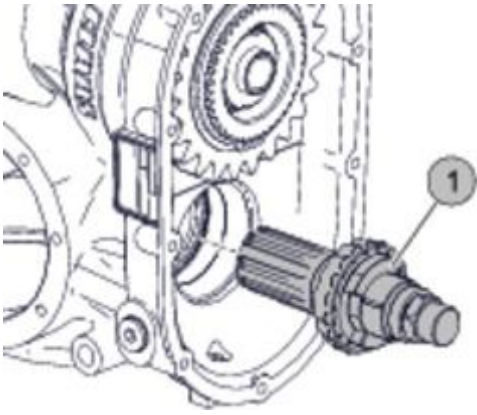

- ▶ Drive out shaft (1).

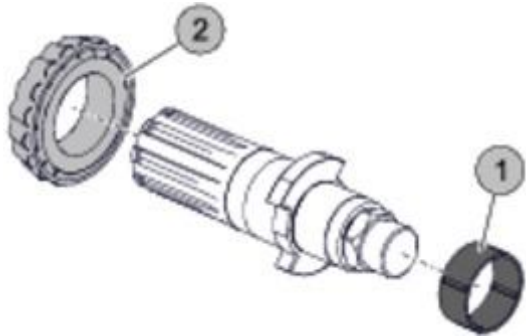

- ▶ Remove needle bearing (1).
- ▶ Pull off inner bearing race (2).



- ▶ Remove outer bearing race (1).

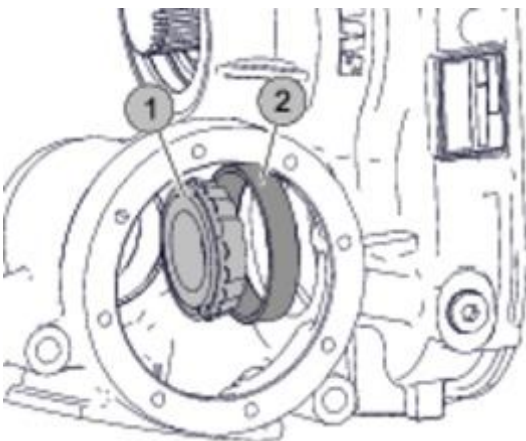

- ▶ Remove bearing inner race (1).
- ▶ Remove outer bearing race (2).

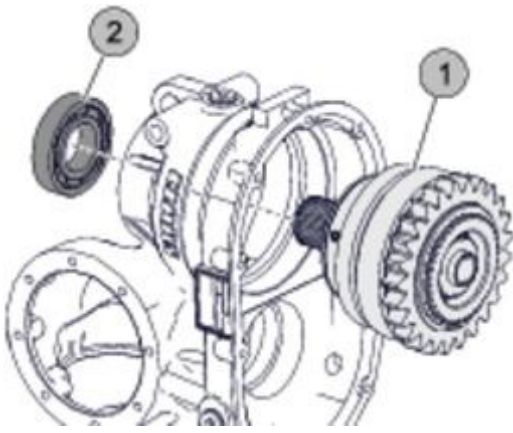

- ▶ Drive out clutch (1).
- ▶ Remove bearing (2).

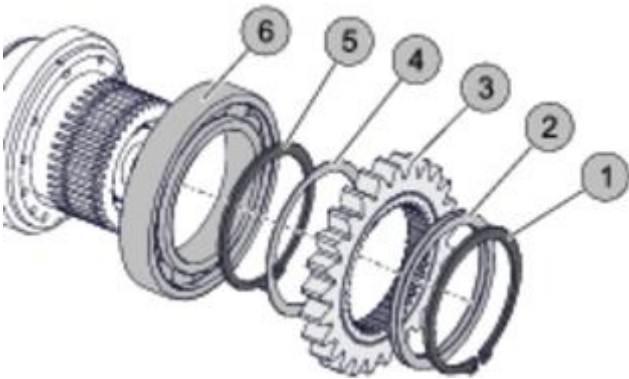

- ▶ Remove circlip (1).
- ▶ Remove spacer washers (2).
- ▶ Remove gear (3).
- ▶ Remove spacer washer (4).
- ▶ Remove circlip (5).
- ▶ Pull off bearing (6).

Assembly

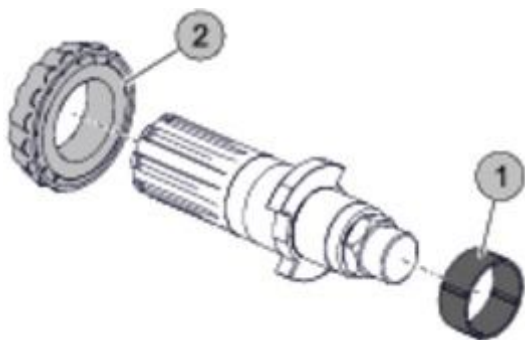

- ▶ Press on the inner bearing race (2).
- ▶ Slide on needle bearing (1).

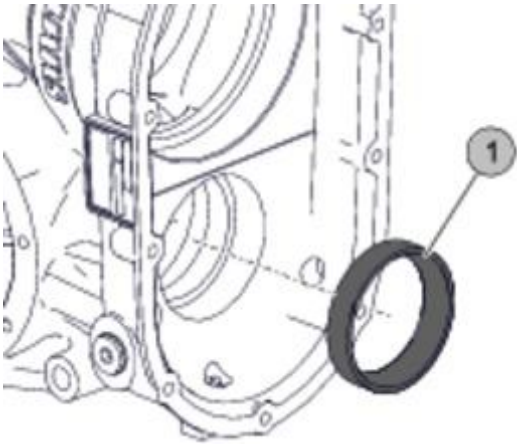

- ▶ Install the bearing outer race (1).

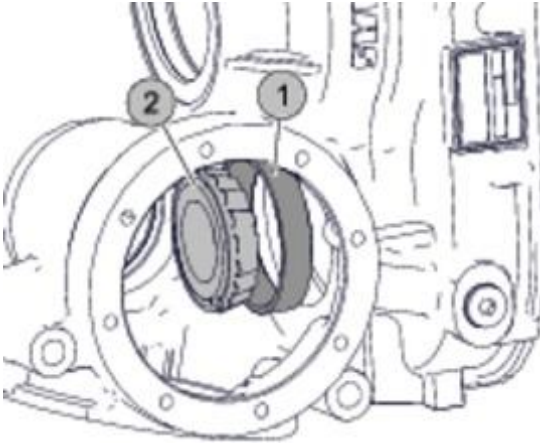

- ▶ Install the bearing outer race (1).
- ▶ Insert bearing inner race (2).

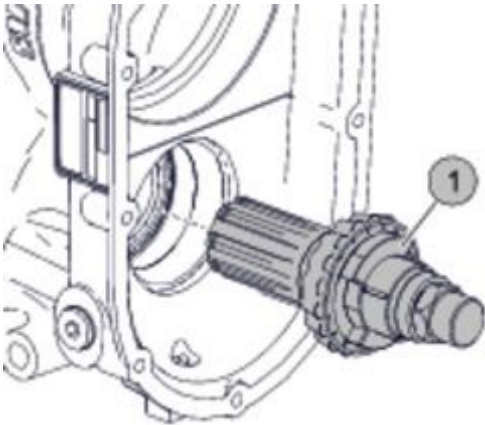

- ▶ Install shaft (1).

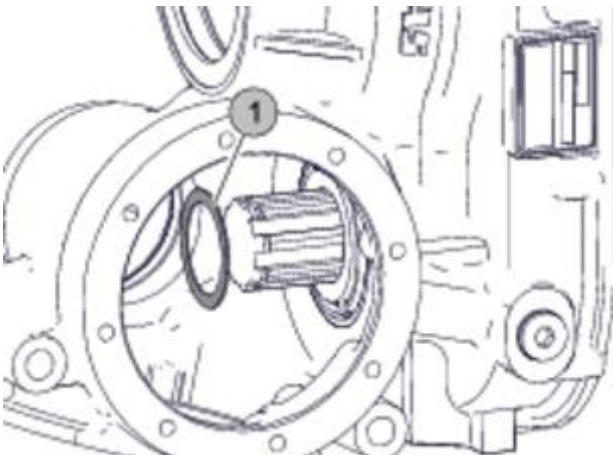

Buy Now



Our support email:

ebooklibonline@outlook.com