

**350**  
**Utility Tractor**  
**Operators Manual**

1004494R3

Reprinted

**CASE III**



*This symbol means **ATTENTION! BECOME ALERT! YOUR SAFETY IS INVOLVED.** The message that follows the symbol contains important information about your safety. Carefully read the message. Make sure you fully understand the causes of possible injury or death.*

SB001

IF THIS MACHINE IS USED BY AN EMPLOYEE, IS LOANED, OR IS RENTED, MAKE SURE THAT THE OPERATOR UNDERSTANDS THE TWO INSTRUCTIONS BELOW.

BEFORE THE OPERATOR STARTS THE ENGINE:

1. GIVE INSTRUCTIONS TO THE OPERATOR ON SAFE AND CORRECT USE OF THE MACHINE.
2. MAKE SURE THE OPERATOR READS AND UNDERSTANDS THE OPERATOR'S MANUAL FOR THIS MACHINE.



**IMPROPER OPERATION OF THIS MACHINE CAN CAUSE INJURY OR DEATH.**

BEFORE STARTING THE ENGINE, DO THE FOLLOWING:

1. READ THE OPERATOR'S MANUAL.
2. READ ALL SAFETY DECALS ON THE MACHINE.
3. CLEAR THE AREA OF OTHER PERSONS.

LEARN AND PRACTICE SAFE USE OF MACHINE CONTROLS IN A SAFE, CLEAR AREA BEFORE YOU OPERATE THIS MACHINE ON A JOB SITE.

It is your responsibility to observe pertinent laws and regulations and to follow manufacturer's instructions on machine operation and maintenance.

See your Authorized Case dealer for additional operator's manuals, parts catalogs, and service manuals.

## TO THE OWNER

The purpose of this manual is to assist you in realizing the benefits you anticipated when you purchased this International Harvester product. Literally thousands of people have contributed to the design and production of this product and its delivery to you. They have an interest in its successful performance and have provided this manual to give you the benefit of the experience they have gained through years of field testing and normal usage of this and similar products.

The way you operate and the care you give this product will have much to do with its successful performance. This manual has been carefully prepared and the information arranged and illustrated to make it as easy as possible for you to find the information you wish. It will pay you to read the entire manual carefully before operating and keep it handy for future reference. Your International Harvester Dealer will be glad to answer any further questions you may have on the operation or care of this product.

---

It is the policy of International Harvester Company to improve its products whenever it is possible and practical to do so. We reserve the right to make changes or add improvements at any time without incurring any obligation to make such changes on products sold previously.

---

All illustrations and descriptive matter in this publication apply to International Harvester products sold under the International, McCormick, McCormick-International, McCormick-Deering, or McCormick-Deering International trade name.

---

*Supplement to  
Operator's Manuals*



**INTERNATIONAL<sup>®</sup>**  
**350**  
**Wheatland Special**  
**Tractors**

**INTERNATIONAL HARVESTER COMPANY**

180 North Michigan Ave.

Chicago 1, Illinois, U.S.A.

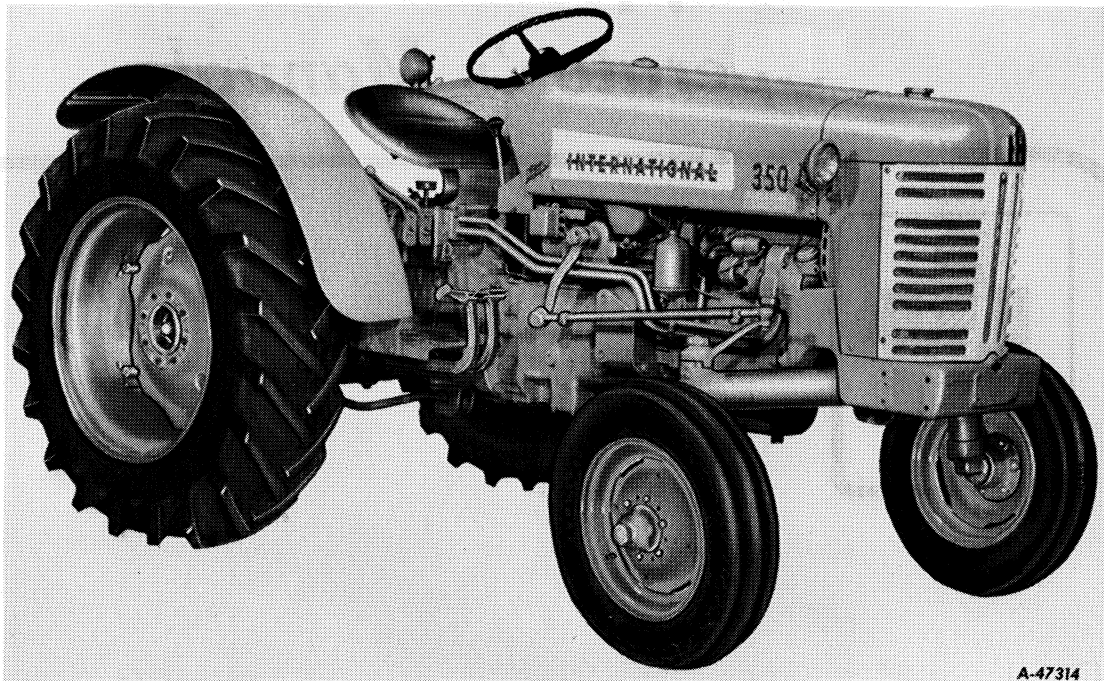

Illust. 1

Right side view of International 350 Wheatland Special Tractor.

## GENERAL INFORMATION

The International 350, 350 L.P. Gas, and 350 Diesel Wheatland Special Tractors are specifically designed for wheat farming operations. Some of the features of these tractors are listed below.

Increased ground clearance heavy duty fixed tread front axle.

A new high platform provides a large flat area which can be used as a convenient conveying space when necessary.

Special fenders provide the operator with greater protection from dust and mud splatter.

The fixed quick-attachable drawbar is available for pull behind implements.

**NOTE:** It is recommended that 13-28 rear tires with W-12 rim and 6.00-16 front tires with 4.25 KA rim be used with the Wheatland Special Tractor.

These tractors are adaptable to many other uses and most of the extra equipment and parts accessories listed in the International 350 Series Utility Tractor Operator's Manuals are available for the Wheatland Special Tractor.

Use the tractor Operator's Manual for operating and maintenance instructions except as noted in this Supplement.

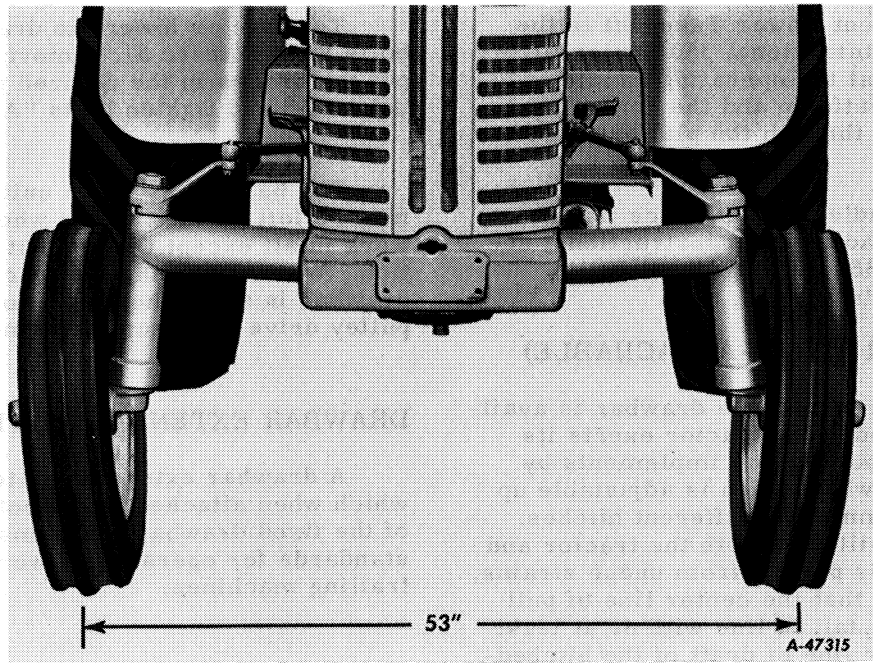

Illust. 2  
 Front view of tractor showing wheel tread.

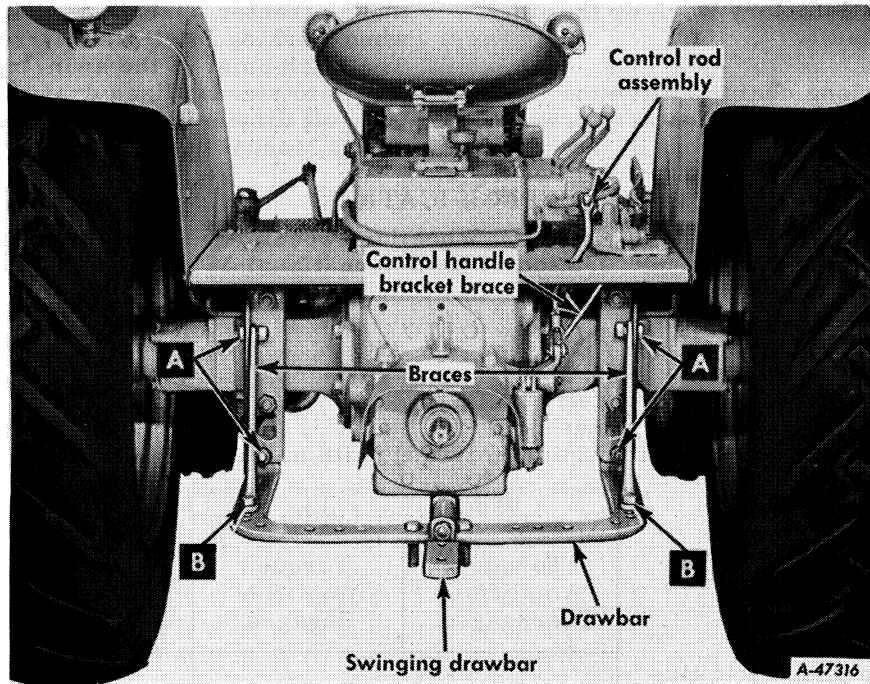

Illust. 3  
 Rear view of tractor equipped with drawbar and swinging drawbar.

## INDEPENDENT POWER TAKE-OFF

The Independent Power Take-Off is the same as on the International 350 Series Utility Tractor except that the operating handle is located above the platform and the control rod assembly extends through the platform. See *Illust. 3*.

A control handle bracket brace is also added. For band adjustment instructions, see the International 350 or 350 Diesel Utility Tractor Operator's Manual.

## FIXED DRAWBAR (QUICK-ATTACHABLE)

A fixed, quick-attachable drawbar is available when required. The tractor exerts its pulling power on pull behind implements by means of this drawbar which is adjustable up and down to accommodate different hitches. Proper hitching will save both the tractor and the implement it is pulling from undue strains. Make the hitch so that the center line of pull of the tractor will fall in line with or at least be near the center line of draft of the hitched-on implement. Hitching to one side or the other of the line of draft will cause stresses and strains on the tractor and the implement being pulled, frequently great enough to do permanent damage. Incorrect hitching also tends to make the tractor difficult to steer and will result in unsatisfactory work by the implement being pulled.

When using a long chain to hitch the tractor to the load, drive the tractor forward slowly until all slack is taken out of the chain.

## DRAWBAR ADJUSTMENT

To raise or lower the drawbar, loosen bolts "A" (*Illust. 3*), remove bolts "B," and put the braces in the desired position. Replace bolts "B" and tighten bolts "A" and "B."

The belt pulley drive unit (if so equipped) may be left on the tractor when doing drawbar work in all except the highest drawbar position. When operating the tractor with the drawbar in the highest position, the entire belt pulley drive unit must be removed.

## DRAWBAR EXTENSION PLATE

A drawbar extension plate is available which when attached to the bottom and center of the fixed drawbar conforms to A.S.A.E. standards for operating power take-off driven trailing machines.

## SWINGING DRAWBAR

A swinging drawbar is available for tractors equipped with a fixed drawbar (*Illust. 3*). This type of drawbar permits shorter turns when pulling trailing implements and makes tractor operation easier, especially when working in small or irregular fields. The hitch point of the swinging drawbar conforms to standardized drawbar and power take-off dimensions. See your tractor Operator's Manual for lubrication instructions.

## SPECIFICATIONS

The following specifications apply to the Wheatland Special tractors, displacing portions of those listed in the "Specifications" section of the International 350 and 350 Diesel Utility Tractor Operator's Manuals.

Tread, front . . . . .	53 in.
Wheelbase . . . . .	74 in.
Height overall (to top of steering wheel) . . . . .	60 in.
Ground clearance for crops under front axle . . . . .	24 in.
Minimum turning radius (wheels in minimum tread) (with brake applied) . . . . .	9.3 ft.

	1,750 Engine r.p.m.		2,000 Engine r.p.m.	
	Torque Amplifier Disengaged	Torque Amplifier Engaged	Torque Amplifier Disengaged	Torque Amplifier Engaged
Transmission (Five-Speed)	13-28		13-28	
Speed based on pneumatic tire sizes . . . . .				
Speeds (miles per hour) . . 1st	2.3	1.6	2.7	1.8
2nd	3.6	2.4	4.1	2.8
3rd	4.8	3.3	5.5	3.7
4th	6.2	4.2	7.1	4.8
5th	15.1	10.2	17.2	11.6
Reverse	2.9	2.0	3.3	2.3

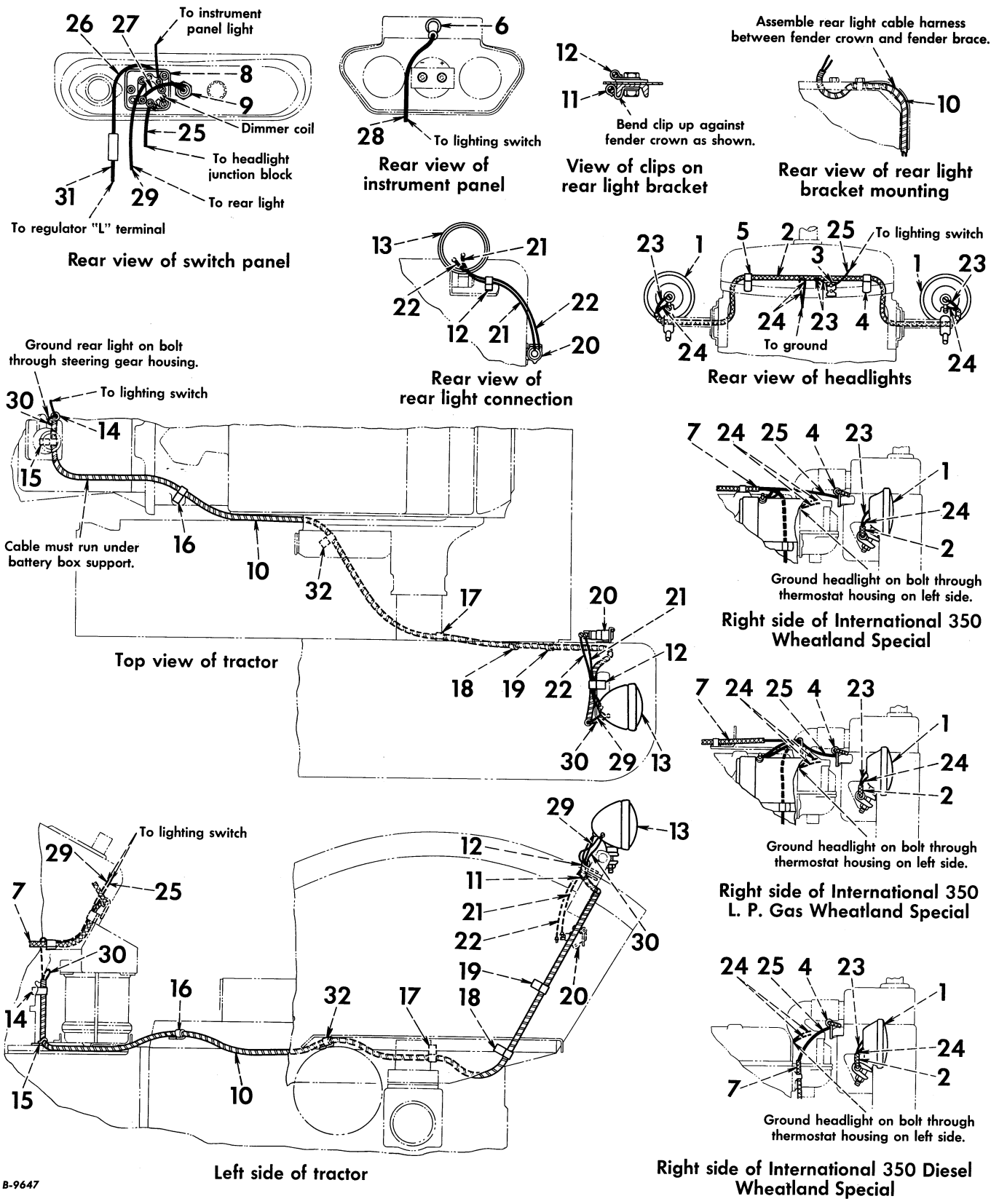

B-9647

Illust. 4

Wiring diagram for electric lighting on tractors with electric starting and battery ignition.



**Buy Now**



Our support email:

[ebooklibonline@outlook.com](mailto:ebooklibonline@outlook.com)