

Page Title	Page Number
ENGINE AND ACCESSORIES	3
ELECTRICAL EQUIPMENT - BOARD BATTERY	4
ALTERNATOR	7
GENERATOR - C40A - 22780 LUCAS, 897104M92	8
STARTER - LUCAS 4 CV 1860092M2	11
STARTER	12
	15
RADIATOR	16
TANK WITH DOOR	19
FEEDING	20
FUEL FILTERS	23
DRY AIR CLEANER - LAUTRETTE	24
EXHAUST SYSTEM	27
THROTTLE CONTROLS	28
FOOT-THROTTLE CONTROL - STANDARD	31
FOOT-THROTTLE CONTROL - NARROW	32
CLUTCH - 12	35
CLUTCH - 12	36
CLUTCH	39
CLUTCH - 10/12	40
DUAL CLUTCH - SMALL SPLINES	43
TRANSMISSION HOUSING	44
CONTROLS	47
TRANSMISSION - CONTINUED	48
HOUSING - SYNCHROMESH TRANSMISSION	52
SELECTOR MECHANISM - SYNCHRO-MESH TRANSMISSION	55
BOITE DE VITESSES - CONTINUED	56
MULTI-POWER SHIFT CONTROL	60
SELECTOR MECHANISM - MULTI-POWER	63
TRANSMISSION - MULTI-POWER	64
EPICYCLIC UNIT	68
SPACER	71
	72
	75
INDEPENDENT P.T.O. HYDRAULIC	76
P.T.O. SHIFTER MECHANISM HYDRAULIC	79
CLUTCH AND VALVE, INDEPENDENT P.T.O.	80
IPTO CLUTCH - HYBRID	83
IPTO CLUTCH - BELLEVILLE WASHER	84
DIFFERENTIAL HOUSING	88
DIFFERENTIAL	92
DIFFERENTIAL LOCK - STANDARD	96
DIFFERENTIAL LOCK - NARROW	99
FINAL DRIVES - NORMAL WIDTH	100
FINAL DRIVES - NARROW	103
BRAKES	104
BRAKEASSEMBLIES 1300 GALCON TANK ONLY - GERMANY	107
DRIVE - STANDARD	108
- NARROW	112
HANDBRAKE	115
WHEELS	116
POWER ASSISTED VARIABLE TREADWHEELS - (A)	119
FRONT AXLE	120

STEERING GEAR	124
STEERING GEAR	128
SHIFT TOWER ARRANGEMENT	132
	135
SINGLE PUMP - DUAL PUMP DRIVE	136
SINGLE PUMP AND SLIDE VALVE - MULTI-POWER	139
AUXILIARY HYDRAULIC PUMP-PLESSEY	140
	143
	144
AUXILIARY HYDRAULIC PUMP - AIR EQUIPMENT	147
HYDRAULIC PIPE	148
INDEPENDENT PTO PIPE	151
INDEPENDENT PTO PIPE	152
INDEPENDENT P.T.O., PIPES WITH AUXILIARY HYDRAULIC	155
INDEPENDENT P.T.O., PIPES WITH AUXILIARY HYDRAULIC	156
AUXILIARY HYDRAULICS INTERNAL LINES	159
MICRONIKFILTER	160
HYDRAULIC PIPE, TRAILER BRAKING	163
BRAKE HYDRAULIC CONTROL VALVE	164
CONTROL CYLINDER	167
HYDRAULIC LIFT PUMP	168
HYDRAULIC LIFT PUMP - (A)	175
MODULATION VALVE	179
REPAIR KIT - CONTROL VALVE	180
	183
DRAFT CONTROL - STANDARD	184
DRAFT CONTROL - NARROW	188
RESPONSE CONTROLS - PRESSURE CONTROL	191
LIFT ARMS	195
LINKAGE - STANDARD	199
LINKAGE - NARROW	203
HITCH - GERMANY	207
HITCH - GERMANY	208
HITCH - CRAMER	211
STABILIZERS	212
GRILL	215
HOOD	219
INSTRUMENT PANEL AND INSTRUMENTS	220
FOOTSTEP	223
- STANDARD	224
	227
	231
SAFETY FRAME GERMANY	232
	235
SEAT - SABLE	236
SEAT - SABLE	239
SEAT - STD.	240
LIGHTING EQUIPMENT - STANDARD	244
	248
HEAD LAMP - TAIL LAMP - STANDARD	252
HEAD LAMP - TAIL LAMP - NARROW	259

MOTEUR ET ACCESSOIRES  
 MOTOR UND ZUBEHOER  
 MOTOR E ACCESSORI

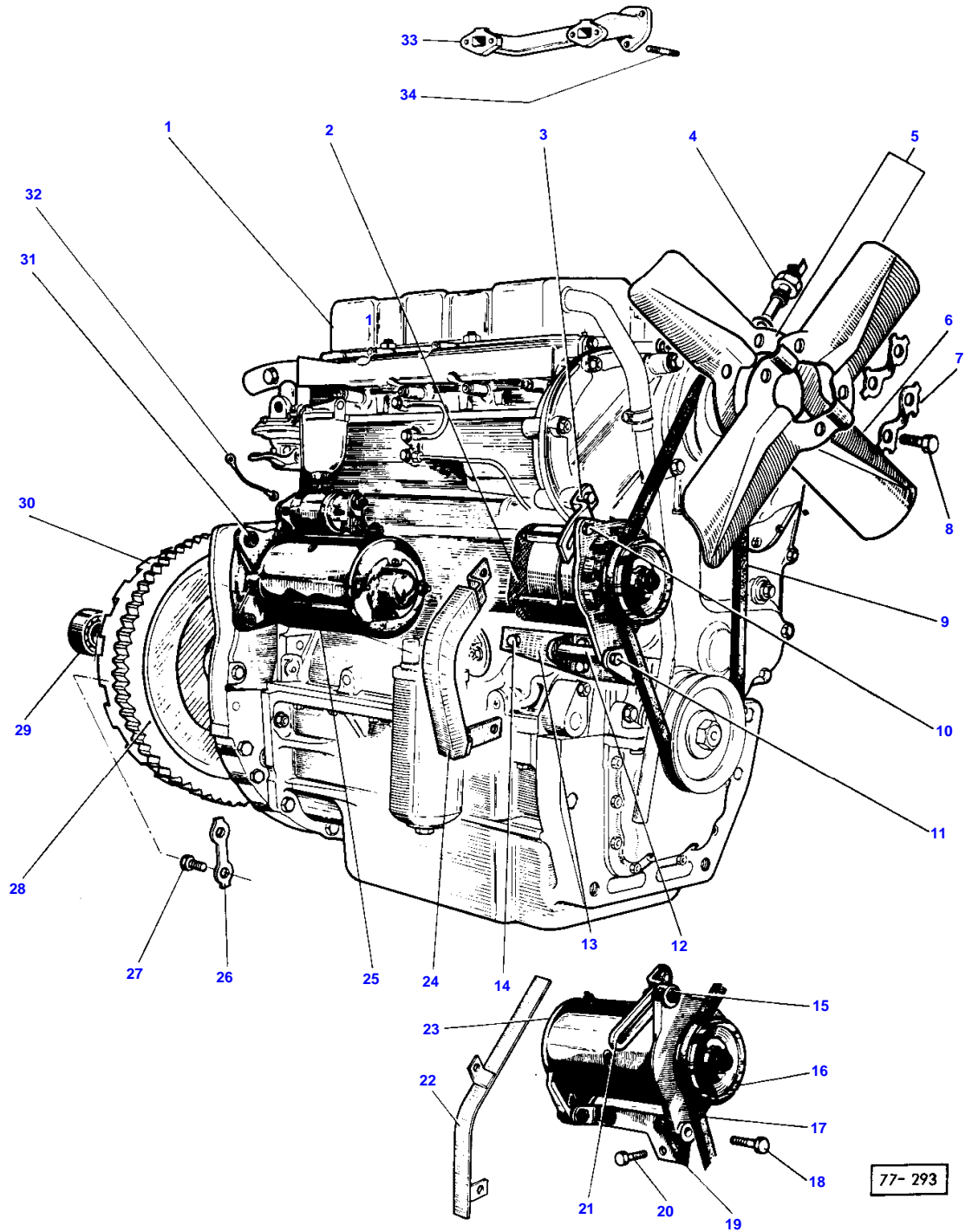

Imprimé en FRANCE

155-158

1646 073 M2 (1) 7/77

ENGINE AND ACCESSORIES

Item	Part Number	Qty	Description	Comments
1	1808128M3	1	Engine	
	1869374M1	1	Engine	(J)
2	906055M3	1	Alternator	(D-L)
3	906316M1	1	Draglink	
	354619X1	1	Bolt Unc	
	353755X1	1	Washer	
	909591M1		Spacer	
4	963418M1	1	Thermometer	
	1650480M1	1	Washer	
5	963929M1	1	Blade Fan	(M)
	963930M1	1	Blade Fan	(M)
6	963929M1	1	Blade Fan	(N)
7	897057M1	2	Brake	
8	361444M1	4	Screw	
9	909319M3	1	Belt	
10	353521X1	1	Bolt Unf	
	353755X1	1	Washer	
	353446X1	1	Lock Washer	
	353916X1	1	Nut Unf	
11	359582X1	1	Screw	
	339376X1	1	Lock Washer	
	339402X1	1	Nut Metric	
12	906513M1	1	Spacer	
13	906640M91	1	Bearer	
14	353521X1	1	Bolt Unf	
	353683X1	2	Bolt Unc	
	353446X1	3	Lock Washer	
15	353681X1	1	Bolt Unc	(A-B)
	353755X1	1	Washer	(B)
	353446X1	1	Lock Washer	(B)
	355565X1	1	Nut Unc	(B)
16	960028M1	1	Pulley	(B)
17	962184M1	1	Belt	(B)
18	353521X1	2	Bolt Unf	(B)
	353916X1	2	Nut Unf	(B)
	353446X1	2	Lock Washer	(B)
19	962182M1	1	Bearer	(B)
20	353679X1	2	Screw Unc	(B)
	353518X1	1	Screw Unf	(B)
	375703X1	3	Washer	(B)
	353446X1	3	Lock Washer	(B)
21	962183M1	1	Lever	(B)
22	907500M91	1	Cowl	(A-B)
23	897104M92	1	Dynamo	(B-E)
24	909394M91	1	Cowl	
25	1808449M1	1	Startermotor	(K-L)
	1860092M2	1	Startermotor	(B-G)
26	731192M1	3	Tab Washer	
27	375763X1	6	Screw	
28	731008M1	1	Annular Gear	
29	828123M1	1	Bearing Assy	
30	740681M91	1	Flywheel	COMP. NO. 28
31	361773X1	1	Screw	
	363625X1	1	Nut	
	353432X1	3	Lock Washer	
	362501X1	2	Screw	
32	969112M1	1	Cable	(B)
33	736218M1	1	Manifold	(H)
	732813M1	1	Manifold	(I)
34	1809008M1	3	Stud	(H)
	731656M1	3	Stud	(I)

(A)  
 WITH SPEED LIMITATION  
 (B)  
 LUCAS  
 (D)  
 See Page - Reference Number 7  
 (E)  
 See Page - Reference Number 8  
 (G)

MASSEY FERGUSON

MF 155/158 TRACTOR, |-> - 1646073

1646073

ENGINE AND ACCESSORIES

3

Item	Part Number	Qty	Description	Comments
				See Page - Reference Number 11
				(H)
				(I)
				(J)
				GERMANY
				(K)
				13
				(L)
				(M)
				4 BLADES FAN
				(N)

4

EQUIPEMENT ELECTRIQUE SUPPORT DE BATTERIE  
ELEKTRISCHE ANLAGE BATTERIETRAEGER  
IMPIANTO ELETTRICO SUPPORTO PER BATTERIA

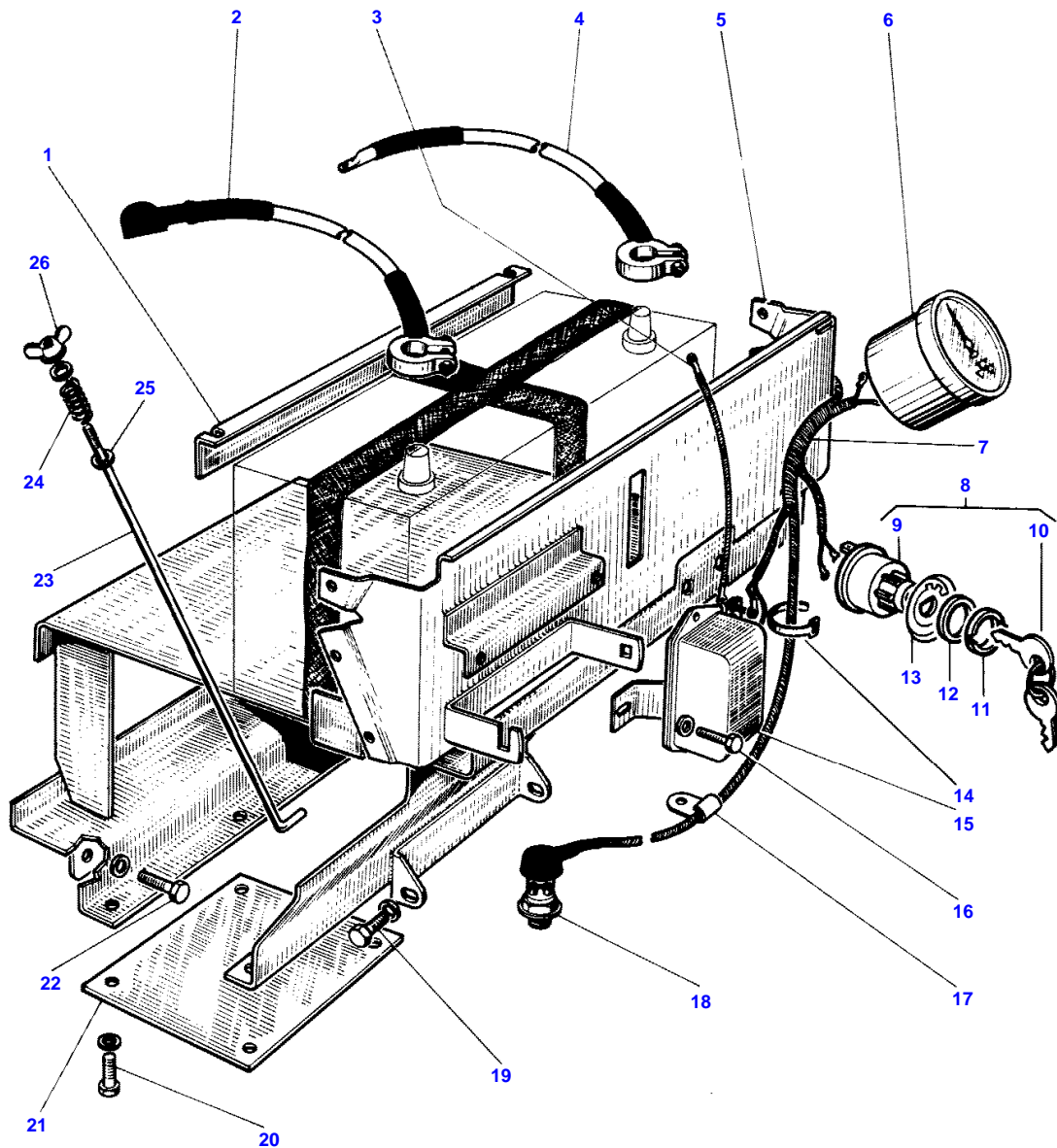

77-294

ELECTRICAL EQUIPMENT - BOARD BATTERY

Item	Part Number	Qty	Description	Comments
1	967605M1	1	Anglepiece	
2		1	Cable	(J)
3	903078M1	1	Earth Strap	(A)
4		1	Cable	(A-K)
5	906565M93	1	Bearer	
6	908430M1	1	Gauge	
7	1867831M1	1	Harness	
	1867832M1	1	Harness	(A)
	969112M1	1	Cable	(A)
	860513	1	Helmet	(A)
8	1874120M93	1	Switch, Ignition	COMP. NO. 9, 10
9		1	Switch, Indirect	(H)
10	883930M1	2	Ignition Key	
11	1662420M1	1	Nut	
12	1443606X1	1	Washer	
13	1660754M1	1	Plate	
	1660755M1	1	Plate	(B)
	1660756M1	1	Plate	(C)
14	969188M1	2	Clip	
	656447M1	1	Collar	
	656447M1	2	Collar	(A)
	950295M1	1	Strap	(A)
15	906056M1	1	Regulator	(G)
	894835M1	1	Control Box	(A)
16	353501X1	2	Screw Unf	
	353754X1	2	Washer	
17	963498M1	1	Strap	
18	963417M1	1	Switch	(D)
	963417M2	1	Switch	(E)
	894858M1	1	Cover	
19	362471X1	2	Screw	
	353432X1	2	Lock Washer	
20	341446X1	4	Screw	
	353446X1	4	Lock Washer	
21	906578M1	1	Plate	
22	362431X1	2	Screw Unc	
	353434X1	2	Lock Washer	
23	969561M2	2	Draglink	
24	969562X1	2	Spring	
25	354754X1	4	Washer	
26	355582X1	2	Nut Unf	

- (A)
- LUCAS
- (B)
- IN ENGLISH
- (C)
- IN GERMAN
- (D)
- Alternative GABRIEL
- (E)
- Alternative TORRIX
- (F)
- NOT REQUIRED
- (G)
- (H)
- Not serviced, order 1874120M93
- (J)
- Not serviced, order 2191023K1
- (K)
- Not serviced, order 2191022K1

ALTERNATEUR }  
DREHSTROMGENERATOR } 75 973 PARIS-RHONE 906 055 M3  
ALTERNATORE }

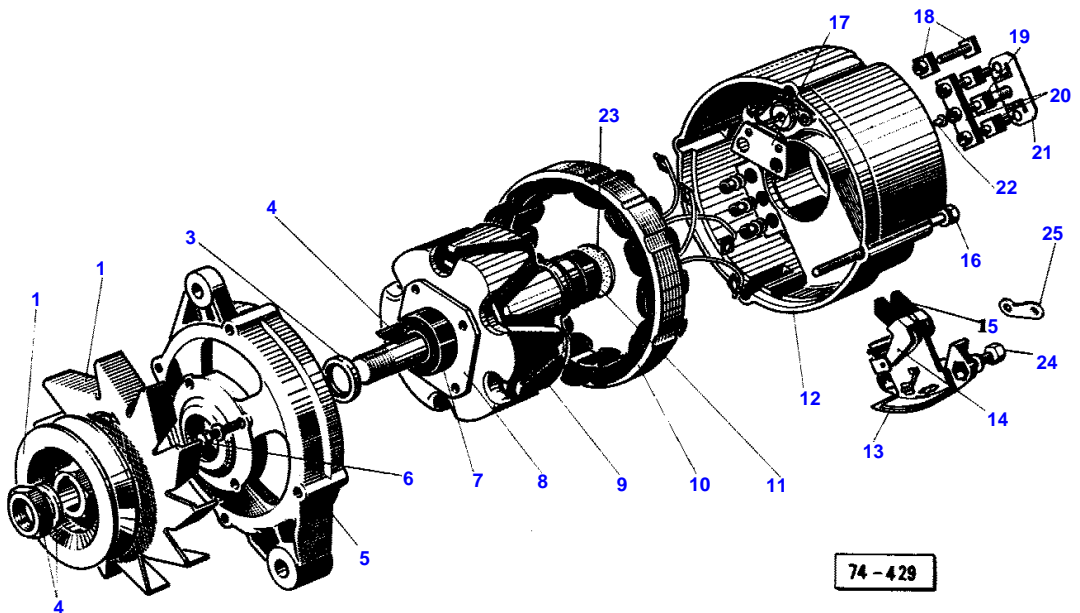



**MASSEY FERGUSON****MF 155/158 TRACTOR, |-> - 1646073****1646073****ALTERNATOR****7**

Item	Part Number	Qty	Description	Comments
1	1805502M1	1	Pulley	
2	1805503M1	1	Fan	
3	1805504M1	1	Spacer	
4	1805505M1	1	Pulley	
5	1805506M1	1	Bearing Carrier	COMP. NO. 6, 7, 8
	1805507M1	1	Bearing Carrier	
6	1805509M1	1	Screw	
7	29963X	1	Bearing	
8	1805508M2	1	Washer	
9	1805511M1	1	Rotor	
10	1807462M1	1	Stator	
11	1805525M1	1	Bearing Assy	
12	1630978M91	1	Bearing Carrier	COMP. NO. 13, 14, 15, 17-21
13	1805514M1	1	Bearing Carrier	COMP. NO. 1806747M1
	1806747M1	1	Joint	
14	1805516M1	1	Holder	
15	1805518M1	1	Brush	
16	1805510M1	1	Screw	
17	1805519M1	1	Condenser	
18	1805520M1	2	Connection	Diameter 5
19	1805521M1	1	Connection	Diameter 6
20	1630979M1	1	Fuse	
21	1805523M1	1	Fuse	
22	1805524M92	X	Plug	
	1645920M1	1	Flap	(A)
	1635843M91	1	Parts Pack	
23	1630980M1	1	Gasket	
24	1630982M91	1	Screw	
25	1630981M1	1	Union	

(A)  
NOT ILLUSTRATED

8

DYNAMO }  
LICHTMASCHINE } C 40 A - 22 780 "LUCAS"  
DINAMO } 897 104 M92

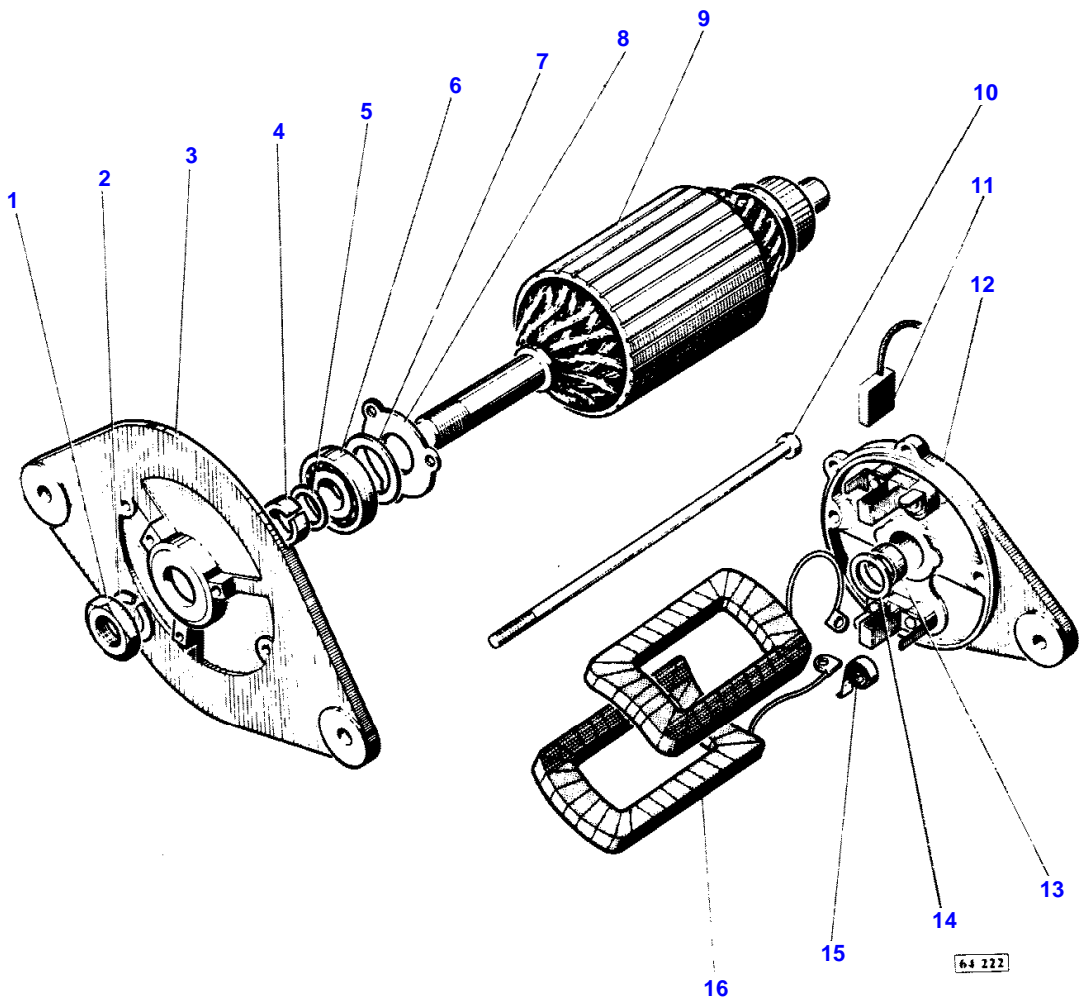

**MASSEY FERGUSON****MF 155/158 TRACTOR, |-> - 1646073****1646073****GENERATOR - C40A - 22780 "LUCAS", 897104M92****8**

Item	Part Number	Qty	Description	Comments
				C40A - 22780 "LUCAS", 897104M92
1	1802033M1	1	Nut	
2	1805203M1	1	Washer	
3	1805197M91	1	Bearing Carrier	COMP. NO. 3, 7, 8
	1805199M1	1	Clip	
	1805202M1	1	Gasket	
4	1802035M1	1	Bush	
5	1802032M1	1	Washer	
6	1802027M1	1	Bearing Assy	
7	1805201M1	1	Washer	
8	1805200M1	1	SIDE PLATE	
9	1802967M1	1	Armature	
10	1802037M1	2	Screw	
11	1802961M1	2	Brush	
12	1805196M91	1	Bearing Carrier	COMP. 1802963M1, NO. 13
	1802963M1	1	Greaser	
13	1802020M1	1	Bush	
14	1802036M1	1	Washer	
15	1802964M1	2	Spring	
16	1802968M1	2	Inductor	
				NOT ILLUSTRATED
	1804249M1	1	Kit	

DEMARREUR  
ANLASSER  
MOTORINO D'AVVIAMENTO } LUCAS 4 CV  
1 860 092 M2

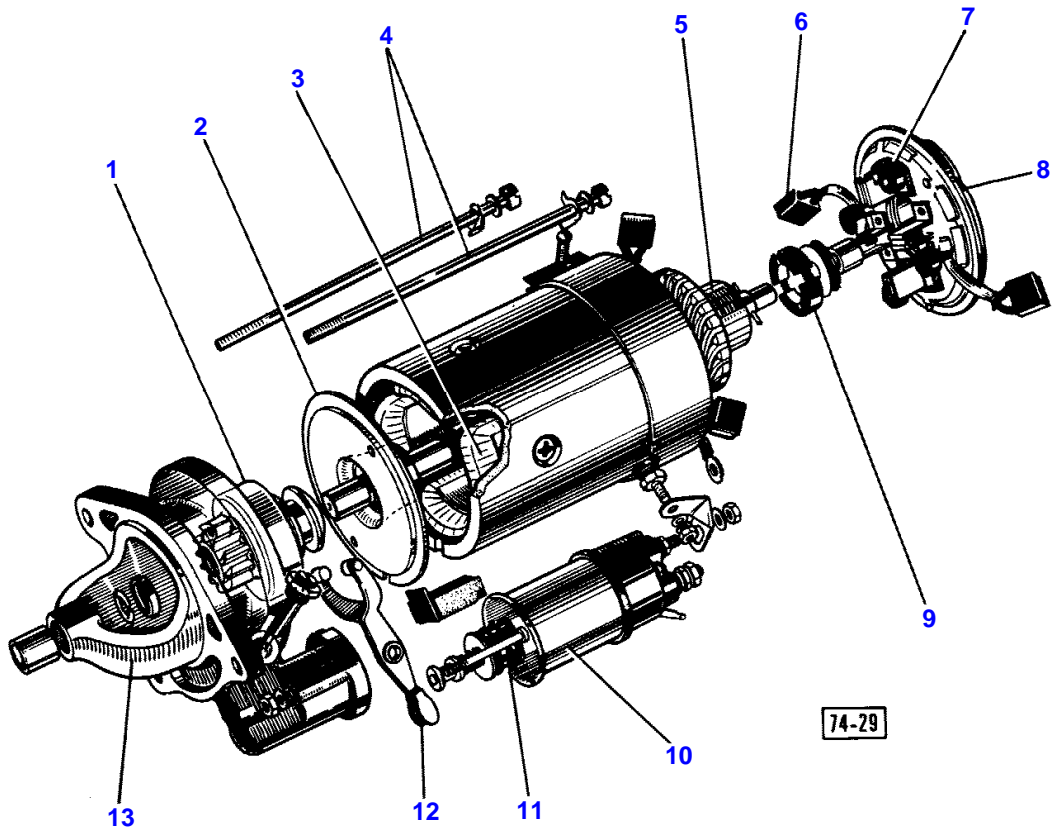

MASSEY FERGUSON

MF 155/158 TRACTOR, |-> - 1646073

1646073

STARTER - LUCAS 4 CV 1860092M2

11

Item	Part Number	Qty	Description	Comments
				LUCAS 4 CV 1860092M2
1	1888292M91	1	Driving	
2	1805998M1	1	Bracket	
3	1887953M91	1	Coil	
4	1887962M91	2	Kit, Bolt	
5	1887964M91	1	Armature	
6	1806001M1	1	Kit, Brush	
7	1887952M91	1	Kit, Brush Plate	
8	1806009M1	1	Housing	
	1887965M91	1	Spring	
9	1887956M91	1	Kit, Brake	
10	1887961M91	1	Housing	
11	1806226M1	1	Spring	
	1887960M91	1	Solenoid Switch	COMP. NO. 10, 11
	1806003M1	1	Kit, Seal	
	1888293M1	1	O Ring	
12	1887958M91	1	Fork	
13	1806180M1	1	Bearing Carrier	
	1806002M1	1	Kit, Seal	
	1887955M91	1	Kit, Bush	
	1887967M91	1	Kit, Sundry	

(A)  
NOT ILLUSTRATED

12

DEMARREUR  
 ANLASSER  
 MOTORINO D'AVVIAMENTO

} PARIS-RHONE  
 1 808 449 M1

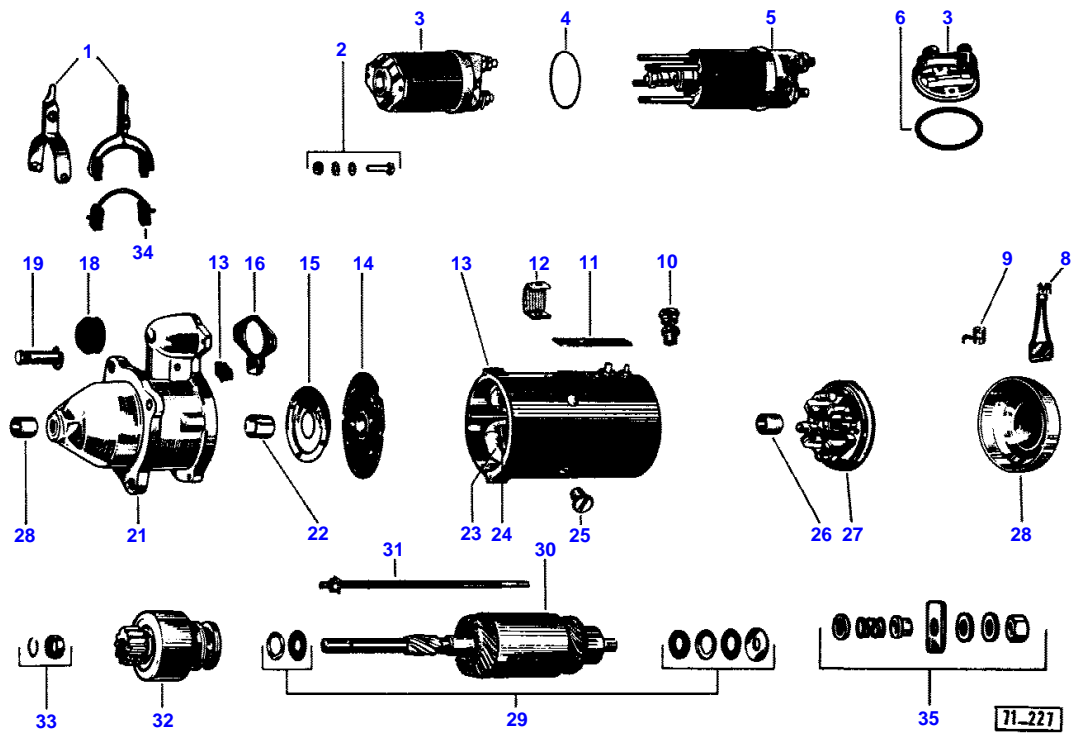

**Buy Now**



Our support email:

[ebooklibonline@outlook.com](mailto:ebooklibonline@outlook.com)