

Page Title	Page Number
ENGINE - T3.152.4 ENGINE	1
SHORT ENGINE- . - TABLE PK ACEC9107- .	2
CYLINDER BLOCK - T3.152.4 ENGINE	3
CRANKSHAFT, PISTONS AND CONNECTING RODS - T3.152.4 ENGINE	7
CYLINDER HEAD - T3.152.4 ENGINE	10
ROCKER SHAFT - T3.152.4 ENGINE	13
TIMING GEAR AND CAMSHAFT - T3.152.4 ENGINE	16
FUEL INJECTION EQUIPMENT (DIESEL) - T3.152.4 ENGINE	19
LUBRICATING OIL SUMP - T3.152.4 ENGINE	21
LUBRICATING OIL FILTER AND INTEGRAL COOLER - T3.152.4 ENGINE	24
WATER PUMP, THERMOSTAT AND HEAT EXCHANGER - T3.152.4 ENGINE	25
LOW PRESSURE FUEL SYSTEM - T3.152.4 ENGINE	27
TURBOCHARGER - T3.152.4 ENGINE	28
TURBOCHARGER-INLET AND EXHAUST MANIFOLD - T3.152.4 ENGINE	30
TURBOCHARGER-PIPES AND HEAT SHIELDS - T3.152.4 ENGINE	31
ALTERNATOR POSITIONER - T3.152.4 ENGINE	33
JOINTS AND GASKETS - T3.152.4 ENGINE	34
HEATER - COLD CLIMATE	35
ALTERNATOR - ISKRA TYPE- .	36
ALTERNATOR - VALEO TYPE	38
ALTERNATOR-LUCAS - LUCAS- .	40
STARTER MOTOR - UP TO SERIAL NUMBER R35158- .	42
STARTER MOTOR - ISKRA TYPE- .	43
STARTER MOTOR - FROM SERIAL NO. R35159- .	45
STARTER MOTOR - FROM SERIAL NO. S12087- .	47
COOLING SYSTEM-ENGINE - FAN AND HOSES	48
EXHAUST SYSTEM-HORIZONTAL	49
EXHAUST SYSTEM-VERTICAL	51
AIR FILTER-DRY - DUAL ELEMENT - DRY AIR CLEANER- .	52
FUEL SYSTEM-FUEL TANK AND ATTACHMENTS	54
FUEL SYSTEM-FUEL FILTER	56
COOLING SYSTEM - RADIATOR AND BRACKET- .	58
THROTTLE CONTROLS	62
INSTRUMENT PANEL AND INSTRUMENTS	64
INSTRUMENT PANEL AND INSTRUMENTS	68
ELECTRICAL WIRING	69
ELECTRONIC HARNESS-INSTRUMENT PANEL	74
SENSORS HARNESS	75
LIGHTING EQUIPMENT-REAR	76
ELECTRICAL WIRING-TRACTOR CAB	77
LIGHTING EQUIPMENT	78
LIGHTING EQUIPMENT	83
BATTERY	84
CLUTCH-DUAL CLUTCH - LUK 11- - UP TO SERIAL NUMBER P50186- .	86
CLUTCH-DUAL CLUTCH - OMG 11- - UP TO SERIAL NUMBER P50186- .	88
CLUTCH-DUAL CLUTCH - O.M.G. FROM SERIAL N.P50187- .	90
CLUTCH-DUAL CLUTCH - LUK 11" FROM SERIAL N.P50187- .	92
CLUTCH PEDAL AND LINKAGE	94
CENTRE AXLE HOUSING AND TRANSMISSION HOUSING	97
CENTRE AXLE HOUSING AND TRANSMISSION HOUSING	98
12 SPEED TRANSMISSION - STANDARD VERSION	100
12 SPEED TRANSMISSION - STANDARD VERSION	103
SHIFT LEVERS-12 SPEED TRANSMISSION	106
SHIFT LEVERS-12 SPEED TRANSMISSION	108
GEAR BOX - FOR SHUTTLE VERSION ONLY.	110
REDUCER - FOR SHUTTLE VERSION ONLY.	111
REDUCER CONTROL - OVERDRIVE AND SHUTTLE VERSION	114
REDUCER - OVERDRIVE AND SHUTTLE VERSION	116
REDUCER CONTROL - OVERDRIVE AND UNDERDRIVE VERSION	120
REDUCER - OVERDRIVE AND UNDERDRIVE VERSION	122
REDUCER CONTROL - OVERDRIVE AND CREEPER VERSION	126
REDUCER - OVERDRIVE AND CREEPER VERSION	128
REDUCER CONTROL - UNDERDRIVE AND SHUTTLE VERSION	131
REDUCER - UNDERDRIVE AND SHUTTLE VERSION	132
REDUCER CONTROL - UNDERDRIVE E CREEPER VERSION	136
REDUCER - UNDERDRIVE E CREEPER VERSION	137

TABLE OF CONTENT

REDUCER CONTROL - SHUTTLE AND CREEPER VERSION	140
REDUCER - SHUTTLE AND CREEPER VERSION	141
PTO SHAFT - 540 R.P.M.- .	144
PTO SHAFT - 540 R.P.M.- .	146
PTO SHAFT - 540/750/1000 R.P.M.- .	148
PTO SHAFT - 540/750/1000 R.P.M.- .	151
PTO-CONTROL - 540 R.P.M.- .	153
PTO-CONTROL - 540/750/1000 R.P.M.- .	154
TRANSFER GEAR BOX-4 WHEEL DRIVE	156
4 WHEEL DRIVE CONTROLS	158
REAR AXLE-DIFFERENTIAL	159
REAR AXLE-HOUSING	161
REAR AXLE-DIFFERENTIAL LOCK MECHANISM - MECHANICAL CONTROL- .	164
BRAKE AND CONTROLS	165
BRAKE AND CONTROLS	167
BRAKES-HANDBRAKE	169
BRAKE CYLINDER	171
BRAKES-MASTER CYLINDER	173
REAR WHEELS	174
FRONT WHEELS	178
FRONT AXLE 2 WHEEL DRIVE-AXLE SUPPORT	182
FRONT AXLE 4 WHEEL DRIVE-DIFFERENTIAL	185
FRONT AXLE 4 WHEEL DRIVE-DIFFERENTIAL	188
FRONT AXLE 4 WHEEL DRIVE-FINAL DRIVE	190
FRONT AXLE 4 WHEEL DRIVE-DIFFERENTIAL	192
FRONT AXLE 4 WHEEL DRIVE-DIFFERENTIAL	195
FRONT AXLE 4 WHEEL DRIVE-FINAL DRIVE	198
STEERING ORBITROL UNIT - 2 WHEEL DRIVE	201
STEERING ORBITROL UNIT - 4 WHEELS DRIVE	203
STEERING HYDRAULIC LINES	205
STEERING HYDRAULIC LINES	207
STEERING CYLINDER-4 WHEEL DRIVE	210
STEERING CYLINDER-4 WHEEL DRIVE	211
STEERING CYLINDER-2 WHEEL DRIVE	212
STEERING-STEERING PUMP - UP TO SERIAL NUMBER R31000- .	214
STEERING-STEERING PUMP - FROM SERIAL NO- R31001.	215
HYDRAULIC LIFT PIPINGS - STANDARD VERSION	216
HYDRAULIC LIFT PIPINGS	218
HYDRAULIC LIFT PIPINGS - SINGLE HYDRAULIC LINES	221
HYDRAULIC PUMP - BOSCH	223
HYDRAULIC PUMP - TUROLLA	224
HYDRAULIC PUMP - CESSNA	225
HYDRAULIC LIFT VALVE	227
HYDRAULIC LIFT-LIFT ARMS	229
HYDRAULIC LIFT-LIFT ARMS	231
REAR CONTROLS-DRAFT AND POSITION	233
REAR CONTROLS-DRAFT AND POSITION	236
HYDRAULIC LIFT CYLINDER - HYDRAULIC LIFT CYLINDER,WITH 1'AND 2'AUXIL.HYDRAUL .VAL	238
AUXILIARY HYDRAULIC VALVE LINES - TILL TYPE	240
AUXILIARY HYDRAULIC VALVE LINES - TILL TYPE	243
AUXILIARY HYDRAULIC VALVE LINES - WITH AUXILIARY HYDRAULIC VALVE CLEARANCE- .	246
AUXILIARY HYDRAULIC VALVE LINES - WITH AUXILIARY HYDRAULIC VALVE CLEARANCE- .	247
AUXILIARY HYDRAULICS VALVE - TILL TYPE STANDARD- .	248
AUXILIARY HYDRAULICS VALVE - TILL TYPE FLOATING- .	250
AUXILIARY HYDRAULIC VALVE LINES- HIDROIRMA - HIDROIRMA TYPE FROM SERIAL N.B08001- .	252
AUXILIARY HYDRAULIC VALVE LINES- HIDROIRMA - HIDROIRMA TYPE FROM SERIAL N.B08001- .	254
AUXILIARY HYDRAULIC VALVE LINES- HIDROIRMA - HIDROIRMA TYPE FROM SERIAL N.B08001- .	255
LINKAGETOP LINK - HIDROIRMA TYPE FROM SERIAL N.B08001- .	257
PLATFORM AUTOMATIC HITCHWITH REMOTE CONTROL - HIDROIRMA TYPE FROM SERIAL N.B08001- .	258
CONTROL VALVE-VALVE - HIDROIRMA TYPE FROM SERIAL N.B08001- .	259
ACCESSORIES HYDRAULIC - ADDITIONAL POWER OUTLET UNIT	260
LINKAGE CAT 2 - UP TP SERIAL NUMBER- .	261
LINKAGE CAT 2 - UP TP SERIAL NUMBER- .	264
LINKAGE CAT 2	267
LINKAGE CAT 2	270
LINKAGE-LINK END	273
SHEET METAL-GRILLE	274
SHEET METAL-HOOD	275

TABLE OF CONTENT

SHEET METAL-PANELS	277
DECALS	278
DECALS	281
DECALS	285
FENDERS - FRONT - 2WHEEL DRIVE	287
FENDERS - FRONT - 4 WHEEL DRIVE	288
FENDERS AND PLATFORM	290
SAFETY FRAME	295
ROTATING LIGHT	296
SEAT-GRAMMER	298
TRACTOR CAB-FRAME	301
TRACTOR CAB-ROOF	304
TRACTOR CAB-CAB DOOR	307
TRACTOR CAB-WINDOWS - FRONT - .	309
TRACTOR CAB-WINDOWS - REAR	311
TRACTOR CAB-CAB INSULATION	314
TRACTOR CAB-CAB INSULATION	315
TRACTOR CAB-ELECTRICAL EQUIPMENT	317
TRACTOR CAB-CAB INSULATION	318
TRAILER BRAKES-PIPES AND FITTINGS	320
WEIGHT FRAME AND WEIGHTS	322
REAR HOOK-ADJUSTABLE	323
DRAWBAR	324
DRAWBAR	325
REAR HOOK-ADJUSTABLE - STANDARD	326
TOOL KIT	327

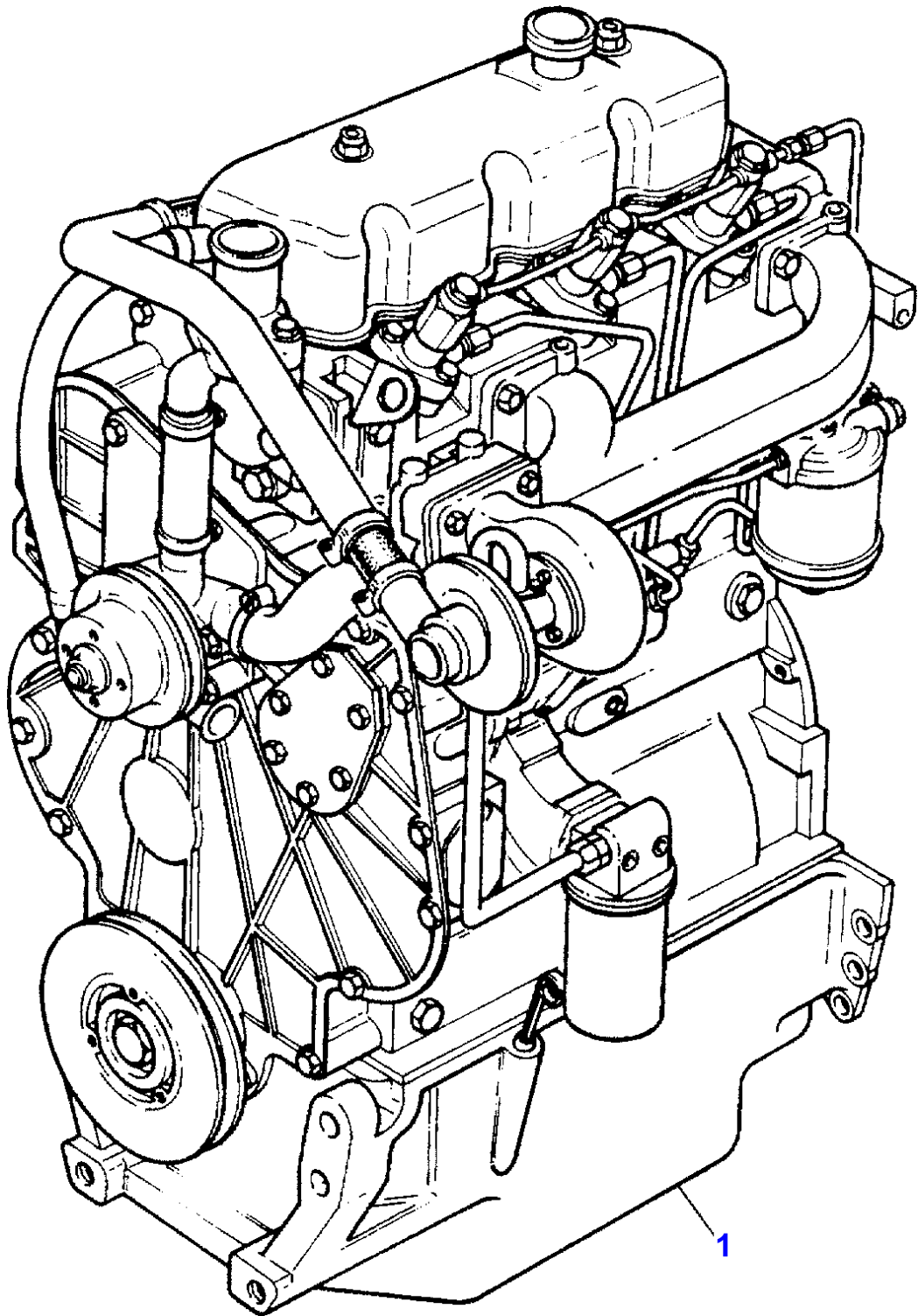

MASSEY FERGUSON

MF 364 F TRACTOR - 3311556

3311556

ENGINE - T3.152.4 ENGINE

1

Item	Part Number	Qty	Description	Comments
				T3.152.4 ENGINE
1	3553117M91	1	Engine	(A) Repairs and replaces CN31198
1	3553116M91	X	Engine	(B) Repairs and replaces CN31225
				(A) SINGLE STANDARD LINES
				(B) SINGLE HYDRAULIC LINES

Thank you so much for reading.
Please click the “Buy Now!”
button below to download the
complete manual.



After you pay.

You can download the most
perfect and complete manual in
the world immediately.

Our support email:

ebooklibonline@outlook.com