

CYLINDER BLOCK-"RP 43405" GREEN ENGINE

Item	Part Number	Qty	Description	Comments
1	ZZ50266	1	CYLINDER BLOCK	[A]
2		1	BLOCK	(1) Not serviced, order REF.N.1
3		5	STIRRUP	(1) Not serviced, order REF.N.1
4	3135X063	4	LINER	(1)
5	0650710	5	Plug	[B] (1)
6	0650713	2	Plug	(1)
7	0650710	1	Plug	[D] (1)
8	0650588	1	Plug	[E] (1)
9	33142111	10	Thimble	(1)
10	32166329	10	Bolt	(1)
12	31134165	1	BUSH	(1)
13	32418122	4	Plug	[E] (1)
14	32416118	4	PLUG	[F] (1)
15	2485A204	1	Plug	[G] (1)
16	32417134	1	Plug	[H] (1)
17	32161114	2	Plug	(1)
18	32418122	2	Plug	[J] (1)
19	32416119	1	PLUG	[K] (1)
20	32168212	1	PLUG	[L] (1)
21	3311R003	1	Washer	[L] (1)
22	4142V066	1	FLANGE	
23		1	COVER	(22) Not serviced, order REF.N.22
24	2418F475	1	Seal	(22)
25	3681T018	1	GASKET	
26	2314H003	12	Screw	
27	3212V002	2	SCREW	
29	0350009	2	Dowel	
30	36171131	1	PLATE	(1)
31	36832144	1	GASKET	(1)
32	2314H032	2	SCREW	(1)
33	2182110	4	SCREW	(1)
34	376616X1	4	Bush	(1)
35	4126X124	4	JET	[M] (1)
36	2116A022	1	DOWEL	[M] (35)
37	4138A017	4	Valve	[M] (1)
38		1	BODY	(37) Not serviced, order REF.N.37
39	2538753	1	BALL	(37)
40	3174A004	1	SPRING	(37)
41	3271A003	1	RETAINER	(37)
42	0650594	1	Plug	
43	0650594	1	Plug	
44	0650588	1	Plug	[N] (1)
47	3686T006	1	GASKET	[X] (1) . 2. 4. 8
48	2314J003	4	SCREW	(1)
49	32418124	1	PLUG	[C] (1)
50	29990001	2	Dowel	[P] (1)
52	0650588	1	Plug	[B] (1)
53	3212T006	2	UNIVERSAL JOINT	(1)
54	32161114	1	Plug	

[M]
PISTON COOLING PRESSURE RAIL
[G]
ROCKER OIL FEED DRILLING, RIGHT HAND SIDE
[H]
ROCKER OIL FEED DRILLING, TOP FACE
[K]
CAMSHAFT CHAMBER, REAR END
[X]
QTY PER TRACTORS SOLD (AA.BBB.CCC.DDD) (AA) FOR 1 ,(BBB) 2-10
(CCC) 11-25 (DDD) 26-50
[A]

MASSEY FERGUSON

MF 374/3220 SP(X)-FP(X)-AP(X)-GE(X) FOOTSTEP TRACTOR - 3653991

3653991

CYLINDER BLOCK-"RP 43405" GREEN ENGINE

3

Item	Part Number	Qty	Description	Comments
				WITH GREEN ENGINE
				[B]
				WATER JACKET LEFT HAND SIDE
				[D]
				WATER JACKET LEFT HAND SIDE TOP CENTRE HOLE
				[E]
				WATER JACKET, RIGHT HAND SIDE
				[F]
				TAPPED CHAMBER
				[J]
				WATER JACKET, REAR FACE
				[L]
				LUBRICATING OIL PRESSURE RAIL, REAR END
				[P]
				LOCATING DOWELS
				[C]
				INNER HOLES
				[N]
				TIMING INSPECTION HOLE

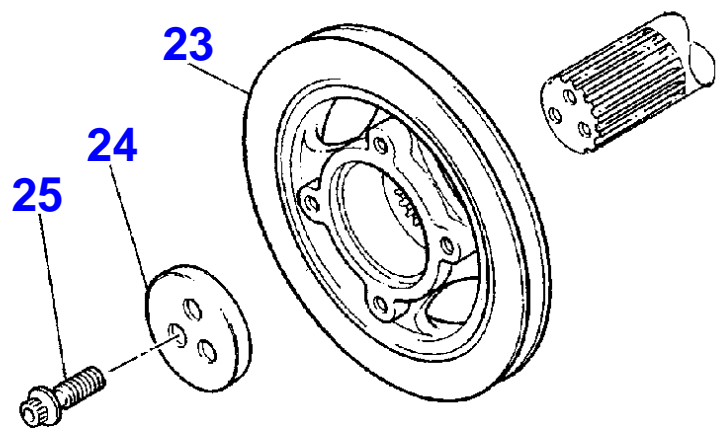
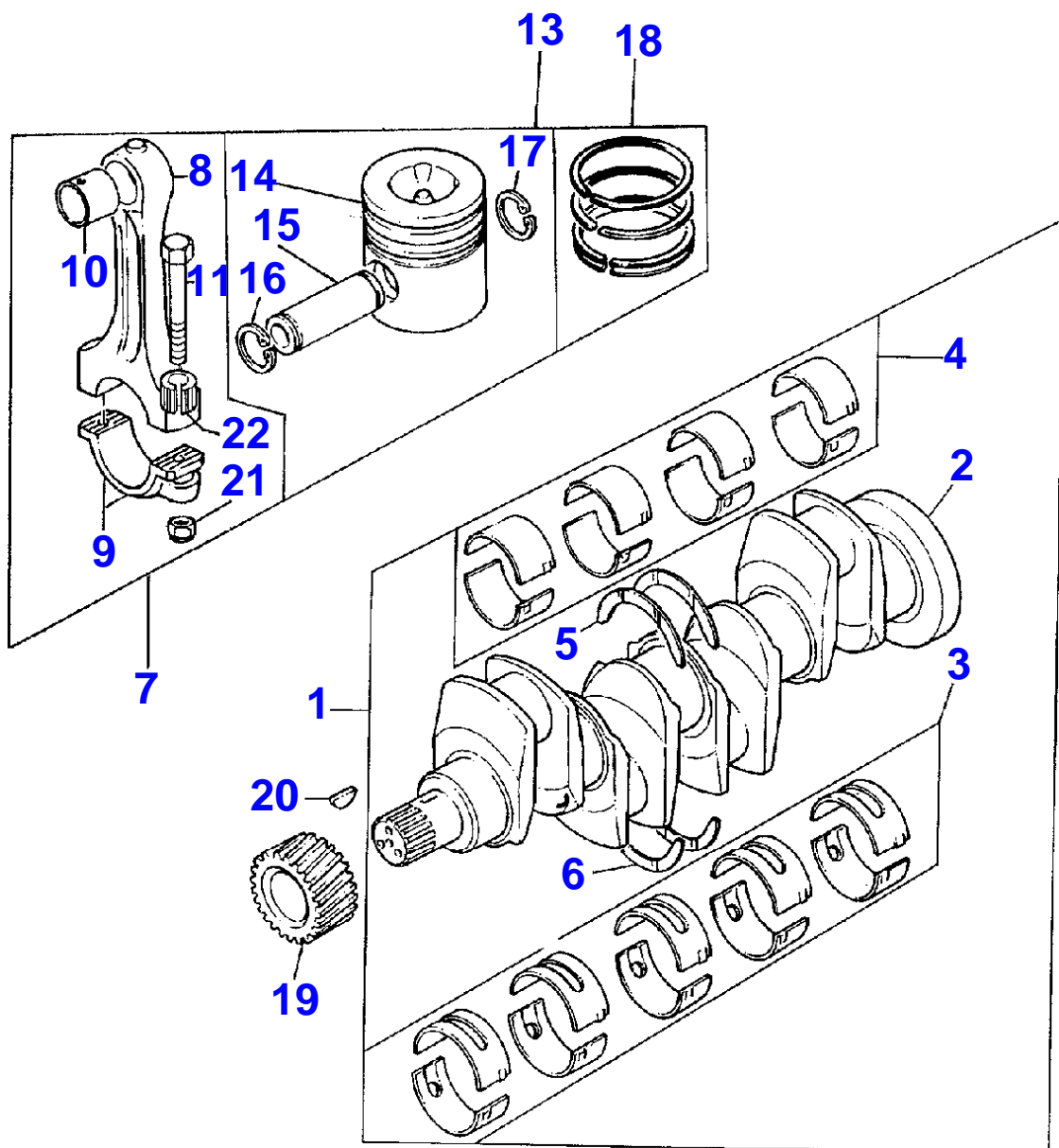

Item	Part Number	Qty	Description	Comments
1	ZZ90145	1	KIT	[A] [X] . 0. 0. 1
2		1	SHAFT	(1) Not serviced, order REF.N.1
3	81558	1	Kit, Bearing	[B, X] (1) . 0. 1. 2
3	81558A	X	Kit, Bearing	[B, X] Thickness (-)0,25MM . 0. 1. 2
3	81558B	X	Kit, Bearing	[B, X] Thickness -0,50MM . 0. 1. 2
3	81558C	X	Kit, Bearing	[B, X] Thickness (-)0,75MM . 0. 1. 2
4	U5ME0006	1	KIT	[B] (1)
	U5ME0006A	X	BEARING	[B] Repairs and replaces (-)0,25MM
4	U5ME0006B	X	KIT	[B] Repairs and replaces (-)0,50MM
4	U5ME0006C	X	BEARING	[B] Repairs and replaces (-)0,75MM
5	31137551	2	Thrust Washer	[X] (1) . 0. 4. 8
5	31137312	X	Thrust Washer	[X] Repairs and replaces (+)0,19MM . 0. 2. 4
6	31137561	2	Thrust Washer	[X] (1) . 0. 2. 4
6	31137322	X	Thrust Washer	[X] Repairs and replaces (+)0,19MM . 0. 2. 4
7	ZZ90188	4	KIT	[C, X] HIGH GRADE . 0. 4. 8
7	ZZ90189	4	KIT	[C] INT.GRADE
7	ZZ90190	4	KIT	[C] INT.GRADE
7	ZZ90191	4	KIT	[C] LOW GRADE
8		1	CONROD	(7) Not serviced, order REF.N.7
9		1	CAP	(7) Not serviced, order REF.N.7
10	3112E011	1	BUSH	[C, X] (7) . 0. 4. 8
11	32762145	2	SCREW	[X] (7) . 0. 8. 16
13	U5LP0057	4	KIT	[C, X] . 0. 4. 8
14		1	PISTON	(13) Not serviced, order REF.N.13
15		1	PIN	[X] (13) Not serviced, order REF.N.13 . 0. 4. 8
16	2721332	1	RING	(13)
17	2721332	1	RING	(13)
18	4181A033	4	KIT	[X] . 0. 4. 8
18				[X] . 0. 4. 8
18				[X] . 0. 4. 8
19	31171681	1	Gear,Crankshaft	[X] . 1. 2. 4
20	0500012	1	Woodruff Key	[X] . 0. 4. 8
21	33221328	2	Nut	[X] (7)

Thank you so much for reading.
Please click the “Buy Now!”
button below to download the
complete manual.



After you pay.

You can download the most
perfect and complete manual in
the world immediately.

Our support email:

ebooklibonline@outlook.com