

m-3490

# NEW HOLLAND

## Vac Bagger

# OPERATOR'S MANUAL

For LS Yard Tractors with  
42" and 48" Mowers  
Model No.  
715703001 – T7N0001 & Up



# Introduction

Thank you for purchasing a New Holland product.

All of us at New Holland want you to be completely satisfied with your new product, so feel free to contact your local Authorized Service Dealer for help with service, genuine replacement parts, or other information you may require.

Whenever you contact your Authorized Service Dealer or the factory, always know the model and serial numbers of your product. These numbers will help the Service Dealer or Service Representative provide exact information about your specific product. You will find the model and serial number plate located in a unique place on the product as shown below.

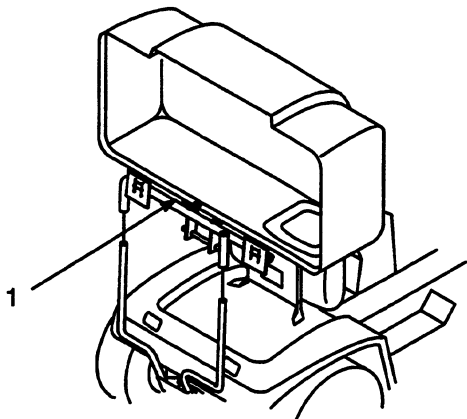

1. Model and Serial Number Plate

For your convenience, write the product model and serial numbers in the space below.

 <b>NEW HOLLAND</b>	
MODEL NO.	SERIAL NO.
COMPONENT	
NEW HOLLAND NORTH AMERICA, INC.	
<small>MADE IN U.S.A.</small>	

The warning system in this manual identifies potential hazards and has special safety messages that help you and others avoid personal injury, even death. **DANGER**, **WARNING** and **CAUTION** are signal words used to identify the level of hazard. However, regardless of the hazard, be extremely careful.

**DANGER** signals an extreme hazard that will cause serious injury or death if the recommended precautions are not followed.

**WARNING** signals a hazard that may cause serious injury or death if the recommended precautions are not followed.

**CAUTION** signals a hazard that may cause minor or moderate injury if the recommended precautions are not followed.

Two other words are also used to highlight information. "Important" calls attention to special mechanical information and "Note" emphasizes general information worthy of special attention.

The left and right side of the machine is determined by sitting on the seat in the normal operator's position.

# Contents

	<b>Page</b>		<b>Page</b>
Safety and Instruction Decals .....	2	Maintenance .....	23
Assembly .....	3	Service Interval Chart .....	23
Loose Parts .....	3	Inspecting the Vac Bagger Attachment ...	24
Preliminary Assembly .....	5	Inspecting the Mower Blades .....	24
Installing Vac-Bagger .....	10	Caring for the Grass Bags .....	24
Remove the Bagger .....	14	Cleaning the Vac Bagger Attachment ....	24
Operation .....	19	Storage .....	25
Using the Full Bag Tester .....	19		
Emptying the Grass Bags .....	19		
Adjusting Height-of-Cut .....	20		
Clearing Obstructions from Bagger .....	20		
Operating and Bagging Tips .....	20		

## Safety and Instruction Decals



Safety decals and instructions are easily visible to the operator and are located near any area of potential danger. Replace any decal that is damaged or lost.

### ON INSIDE BAGGER HINGE FRAME (Part No. TR92D7113)



### MOLDED INTO THE BELT COVER (Part No. TR93D1122)



### MOLDED INTO THE BLOWER HOUSING AND BELT COVER (Part No. TR79D0360)

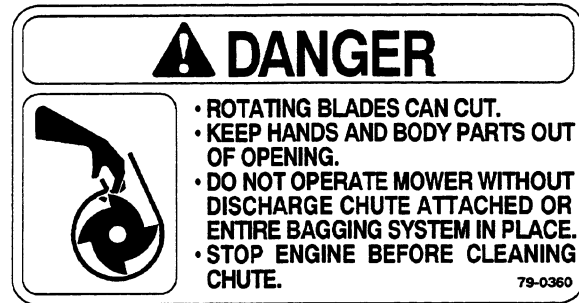

### MOLDED INTO THE BELT COVER (Part No. TR79D0350)



### ON THE INNER COVER (Part No. TR92D7108)

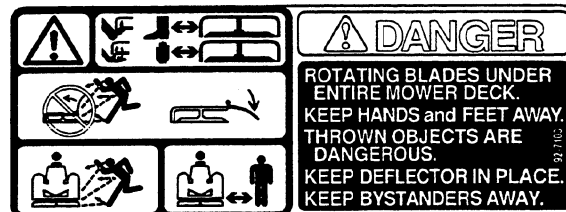

# Assembly

## Loose Parts

**Note:** Use the chart below to identify parts used for assembly.

DESCRIPTION	QTY.	USE
Double Pulley 3-1/4"—4-1/2" (for 42" mower)	1	Install blower drive pulley
Double Pulley 3-3/4"—5-1/4" (for 48" mower)	1	
Grass baffle (1 hole 42" mower only)	1	Install grass baffle 42" mower only
Bolt 3/8-16 x 1"	1	
Lock nut 3/8"	1	
Grass baffle (2 holes 48" mower only)	1	Install grass baffle 48" mower only
Bolt 3/8-16 x 1"	2	
Lock nut 3/8"	2	
Pivot support	1	Install blower pivot support to mower
Jam nut 3/8" (on mower)	1	
Bolt 5/16-18 x 3/4"	1	
Flange nut 5/16"	1	
Blower mounting plate	1	Assemble the blower
Blower assembly	1	
Carriage bolt 5/16-18 x 3/4"	3	
Flange nut 5/16"	3	
L-support bracket	1	
Hex head bolt 5/16-18 x 1"	1	
Washer 5/16"	1	
Flange nut 5/16"	1	
Spring	1	
Screw #10-32 x 3/4"	1	
Washer 7/32"	2	
Nut #10	2	
Latch (long 48" mower only)	1	
Latch (short 42" mower only)	1	
Bolt 1/4-20 x 3/4"	1	
Washer 1/4"	1	
Lock nut 1/4"	1	

DESCRIPTION	QTY.	USE
Spring	1	Install between footrest and mower
Chain	1	
Carriage bolt 5/16-18 x 1-1/4" (32 mm)	1	
Washer 5/16" (19 mm)	3	
Locknut 5/16"	1	
Bagger Cover	1	Assemble the bagger
Indicator rod	1	
Handle	1	
Jam nut 1/4"	1	
Clips	2	
Pan head screw 1/4-20 x 5/8"	2	
Lock nut 1/4"	2	
Frame hinge assembly	1	
Bolt 1/4-20 x 3/4"	2	
Lock nut 1/4"	2	
Belt cover (for 42" mower)	1	Install belt cover
Bracket (for 42" mower)	1	
Belt cover (for 48" mower)	1	
Bolt 1/4-20 x 1/2"	5	
Lock nut 1/4"	7	
Blower Belt Cover	1	
Bolt 1/4-20 x 5/8"	2	
Bagger mount	1	Install bagger mount to tractor
Bolt 3/8-16 x 1-3/4"	2	
Lock nut 3/8"	2	
Spacer	2	
Hairpin cotter	1	
Bag	2	Mount into bagger cover
Discharge tube	1	Assemble knob to discharge chute
Knob	1	
Washer 1/4"	1	
Screw 1/4-20 x 3/4"	1	
Operator's Manual	1	Read before operating

## Preliminary Assembly

### Remove the Discharge Chute

1. Park the machine on a level surface, disengage the blade control (PTO), set the parking brake, and turn the ignition key to "OFF" to stop the engine. Remove the key.
2. Lower the mower to its lowest position and remove mower from tractor. Refer to Mower Operator's Manual for instructions.
3. Thoroughly clean mower deck. All debris must be removed to ensure baffles will fit against mower properly.
4. Remove discharge chute from the mower (Fig. 1).
5. Remove belt cover from right side (Fig. 1).

**Note:** Save all parts and hardware for use when using mower to side discharge.

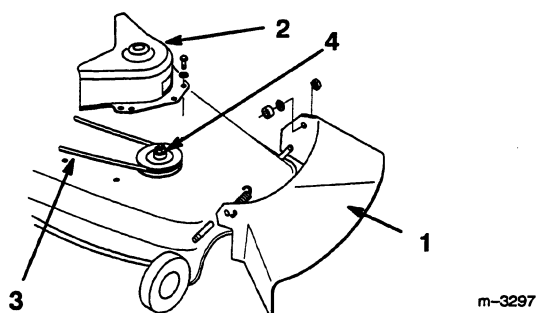

Figure 1

- |                   |                            |
|-------------------|----------------------------|
| 1 Discharge chute | 3 Blade drive belt         |
| 2 Belt cover      | 4 5/8" nut and lock washer |

### Install Blower Drive Pulley

1. Pull on mower idler assembly to release belt tension and remove blade drive belt from right side pulley (Fig. 1).
2. Remove nut and lock washer from right hand blade spindle (Fig. 1). Remove single pulley.

**Note:** Block blade with a piece of wood to stop it from turning while you remove the pulley nut. If blade slips hold hex portion of spindle near the blade with a wrench.

**Note:** When nut is removed the shaft is free to drop out of the spindle.

3. Select the correct double pulley (3-1/4"—4-1/2" outside diameter for 42" mowers and 3-3/4"—5-1/4" outside diameter for 48" mowers) and slide the new double pulley onto the spindle shaft with the word "TOP", stamped into largest pulley, facing up. Secure with previously removed 5/8" lock washer and nut (Fig. 2).
4. Tighten the nut to 70 ft. lb. (95 Nm).
5. Install blower drive belt as shown around bottom mower pulleys (Fig. 2).

**Note:** Use belt part number 79-7480 for 42" mowers and the belt part number 79-7490 for 48" mowers.

6. Install the existing mower belt by rotating it onto the top pulley (Fig. 2).

**Note:** Check that mower belt is properly located on idler and pulleys.

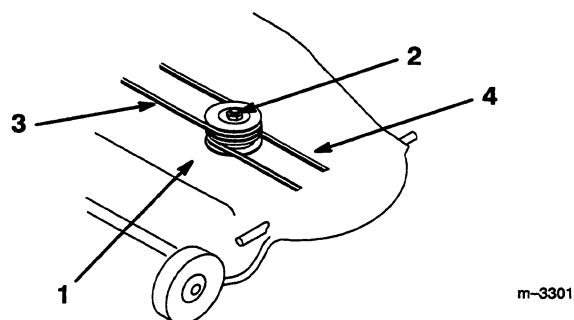

Figure 2

- |                            |               |
|----------------------------|---------------|
| 1 Double Pulley            | 3 Mower belt  |
| 2 5/8" lock washer and nut | 4 Blower belt |

### Install Mower Baffle

**IMPORTANT: Only required for 42" mowers, all models, and 48" mowers, model 98260 with s/n T7L2983 or lower.**

1. Remove the bolt(s) and nut(s) at the end of the grass plate, inside the mower, near the back edge of the discharge opening. Discard the hardware.
2. Select appropriate grass baffle (42" single hole or 48" two holes) Install grass baffle tight against grass plate with top edge up against inside of mower.
3. Secure with new 3/8 x 1" carriage bolt(s) and 3/8" lock nut(s) (Fig. 3-42" or 4-48").
4. Rotate blade and check for clearance with baffle. If necessary adjust baffle so blade does not hit.

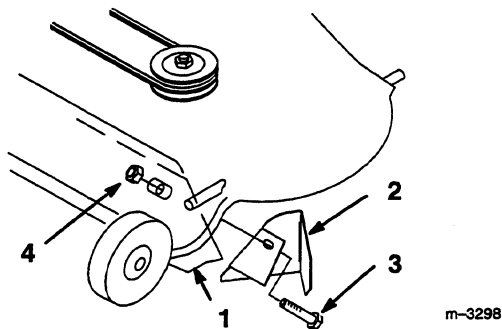

**Figure 3**

- |               |                          |
|---------------|--------------------------|
| 1 Grass plate | 3 Carriage Bolt 3/8 x 1" |
| 2 42" Baffle  | 4 Nut 3/8"               |

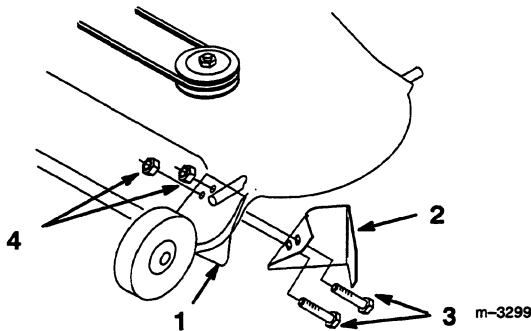

**Figure 4**

- |               |                          |
|---------------|--------------------------|
| 1 Grass plate | 3 Carriage bolt 3/8 x 1" |
| 2 48" Baffle  | 4 Nut 3/8"               |

### Assemble Blower

1. Assemble blower mounting plate to blower with (3) 5/16 x 3/4" carriage bolts and (3) 5/16" flange nuts (Fig. 5).
2. In the front inside hole of the blower insert a 5/16 x 1" hex head bolt item 6 (Fig. 5).

**Note:** This carriage bolt must be installed down thru plate and blower for proper belt clearance.

3. Inside the blower housing slide the L-bracket over the bolt. Hold the L-bracket tight against the blower housing wall and secure with 5/16" washer and 5/16" flange nut (Fig. 5).

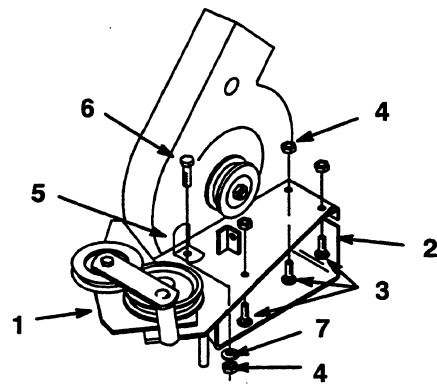

**Figure 5**

- |                             |                  |
|-----------------------------|------------------|
| 1 Blower mounting plate     | 5 L-bracket      |
| 2 Blower assembly           | 6 Bolt 5/16 x 1" |
| 3 Carriage bolt 5/16 x 3/4" | (down from top)  |
| 4 Flange nut 5/16"          | 7 Washer 5/16"   |

1495



Thank you so much for reading.  
Please click the “Buy Now!”  
button below to download the  
complete manual.



After you pay.

You can download the most  
perfect and complete manual in  
the world immediately.

Our support email:

[ebooklibonline@outlook.com](mailto:ebooklibonline@outlook.com)