

| Page Title | Page Number |
|--|-------------|
| TABLE (RIGID CUTTER BAR) (13', 15', 16') | 2 |
| TABLE PLATES, SHIELDS AND DIVIDERS (RIGID CUTTER BAR) | 5 |
| TABLE PLATES, SHIELDS AND DIVIDERS (RIGID CUTTER BAR) | 9 |
| TABLE (RIGID CUTTER BAR)(18', 20', 24') | 6 |
| TABLE (30 FOOT RIGID) | 10 |
| TABLE DIVIDERS AND SHIELDS (30 FOOT RIGID) | 13 |
| TABLE (FLOATING CUTTER BAR) 15', 16' | 14 |
| TABLE (FLOATING CUTTER BAR) 18', 20' | 17 |
| DIVIDERS AND SHIELDS (FLOATING CUTTER BAR) | 18 |
| SHIELDS AND BRACKETS (FLOATING CUTTER BAR) | 21 |
| COUNTER BALANCE, IDLER, SPRING PIVOT ASSEMBLY | 22 |
| FLOATING DIVIDERS - FLOATING CUTTER BAR (LATE PRODUCTION) | 25 |
| FLOATING DIVIDERS (FLOATING CUTTER BAR) (EARLY PRODUCTION) | 26 |
| FLOATING DIVIDER (FLOATING CUTTER BAR) | 29 |
| AUGER (13', 15', 16') | 30 |
| AUGER (18', 20', 20', 24') | 34 |
| AUGER (30' TABLE) | 38 |
| KNIFE (RIGID CUTTER BAR) (13', 15', 16', 18', 20', 24', 30') | 42 |
| KNIFE (FLOATING CUTTER BAR) (GRAIN) (15', 16', 18', 20') | 45 |
| CUTTER BAR - FLOATING CUTTER BAR (GRAIN) | 46 |
| WOBBLE KNIFE DRIVE | 49 |
| DRIVE, TABLE AND REEL - BELT DRIVE (13', 15', 16') | 50 |
| DRIVE, TABLE AND REEL - BELT DRIVE (18', 20', 20', 24') | 54 |
| DRIVE, TABLE AND REEL - CHAIN DRIVE (13' THRU 24' TABLES) | 58 |
| DRIVE, TABLE (30' TABLE) | 62 |
| ELECTRIC VARIABLE SPEED REEL DRIVE (13' THRU 24' TABLES) | 65 |
| ELECTRIC MOTOR AND WIRING | 66 |
| HYDROSTATIC REEL DRIVE HYDRAULICS | 69 |
| HYDROSTATIC REEL DRIVE HYDRAULICS | 70 |
| HYDROSTATIC REEL DRIVE HYDRAULICS | 382 |
| HYDROSTATIC REEL DRIVE AND HYDRAULICS (30' TABLE) | 73 |
| HYDRAULIC PUMP AND RESERVOIR (30' TABLE) | 74 |
| HYDRAULIC MOTOR | 77 |
| HYDRAULIC MOTOR | 78 |
| REEL AND SUPPORTS (15' THRU 24' TABLES) | 81 |
| REEL AND SUPPORTS (30' TABLE) | 82 |
| REEL LIFT (15' THRU 24' TABLES) | 85 |
| REEL LIFT CYLINDERS (15' THRU 24' TABLES) | 86 |
| REEL LIFT HYDRAULICS (30' TABLE) | 89 |
| REEL LIFT CYLINDERS (30' TABLE ONLY) | 90 |
| MF 67 PICK-UP (DRUM) (FRAME, DRUM, GRAIN PAN) (10', 12') | 93 |
| MF 67 PICK-UP (DRUM) (WINDBAR, WHEELS) (10', 12') | 94 |
| MF 67 PICK-UP (DRUM) (DRIVE, DRIVE EXTENSION, GUARDS) | 97 |
| MF 67 PICK - UP (DRAPER) (FRAME, ROLLER, GRAIN PAN, BELTS) | 98 |
| MF 67 PICK - UP (DRAPER) (WINDBAR, WHEELS) (10', 12') | 101 |
| MF 67 PICK - UP (DRAPER) (DRIVE, DRIVE EXTENSION, GUARD) | 102 |
| ELEVATOR TO TABLE DRIVE (PADDLE) | 105 |
| ELEVATOR SHAFTS AND DRIVES (PADDLE) | 106 |
| ELEVATOR, TABLE TO CYLINDER (PADDLE) | 109 |
| ELEVATOR EXTENSION AND DRIVE (PADDLE ELEVATOR) | 110 |
| ELEVATOR EXTENSION (SLAT, WITH 3 ROW CONVEYOR) | 113 |
| ELEVATOR, TABLE TO CYLINDER (SLAT, WITH 2 ROW CONVEYOR) | 114 |
| ELEVATOR TOP SHAFT AND DRIVE | 117 |
| ELEVATOR TOP SHAFT AND DRIVE | 121 |
| ELEVATOR CLUTCH (ELECTRO MAGNETIC HEADER THROW-OUT) | 122 |
| ELEVATOR DRIVE SHIELDS | 125 |
| ELEVATOR DRIVE SHIELDS | 126 |
| CYLINDER HOUSING | 129 |
| CYLINDER DRIVE (TWO SPEED) | 130 |
| CYLINDER DRIVE (TWO SPEED) | 133 |
| VARIABLE SPEED DRIVE CONTROL | 137 |
| CYLINDER, RASP BAR (HIGH INERTIA) | 138 |
| CYLINDER (SPIKE TOOTH) (7 SPIDER) | 141 |
| CONCAVE (RASP BAR) (WIDE, NARR) | 142 |
| CONCAVE (SPIKE TOOTH) | 145 |
| CONCAVE CONTROL | 146 |
| STONE TRAP, FEED PLATE | 149 |
| FRONT BEATER (PADDLE, SLAT) | 150 |

TABLE OF CONTENT

| | |
|--|-----|
| REAR BEATER | 153 |
| WALKER BODY | 154 |
| STRAW WALKERS | 157 |
| STRAW WALKER AND RETURNS ELEVATOR DRIVE | 161 |
| GRAIN PAN AND SHAKER SHAFT | 162 |
| FANNING MILL | 165 |
| SHAKER SHOE | 166 |
| SCREENS (SHAKER SHOE) | 169 |
| HOOD | 170 |
| STRAW SPREADER | 173 |
| STRAW SPREADER DRIVE | 174 |
| LEFT HAND DRIVE | 177 |
| LEFT HAND DRIVE IDLERS | 178 |
| GRAIN TANK | 181 |
| GRAIN ELEVATOR | 182 |
| GRAIN ELEVATOR DRIVE | 185 |
| GRAIN TANK UNLOADER BOTTOM | 186 |
| GRAIN TANK UNLOADER TOP | 189 |
| GRAIN TANK UNLOADER DRIVE | 190 |
| RETURNS ELEVATOR | 194 |
| RETURNS ELEVATOR CARRIERS | 197 |
| MAIN FRAME | 201 |
| FRONT AXLE AND WHEELS, SHAFTS AND COUPLINGS | 202 |
| FRONT AXLE, SHAFTS AND COUPLINGS (HYDROSTATIC TRANSMISSION) | 205 |
| FRONT WHEELS (GRAIN, RICE) | 206 |
| MAIN DRIVE | 209 |
| TRACTION DRIVE (HYDROSTATIC TRANSMISSION) | 210 |
| VARIABLE SPEED TRACTION DRIVE (4 SPEED TRANSMISSION) | 213 |
| TRACTION CLUTCH (4 SPEED TRANSMISSION) | 217 |
| GEAR SHIFT (4 SPEED TRANSMISSION) | 221 |
| GEAR SHIFT (HYDROSTATIC TRANSMISSION) | 222 |
| TRANSMISSION (4 SPEED WITH 2 PINION PLANETARY) | 225 |
| TRANSMISSION (4 SPEED, WITH 4 PINION PLANETARY) | 229 |
| TRANSMISSION (4 SPEED WITH 4 PINION PLANETARY) (EUROPE ONLY) | 233 |
| TRANSMISSION (HYDROSTATIC) | 237 |
| TRANSMISSION (HYDROSTATIC) (EUROPE ONLY) | 241 |
| HYDROSTATIC CONTROLS | 245 |
| HYDROSTATIC CONTROLS | 246 |
| HYDROSTATIC PRESSURE RELEASE CONTROLS | 249 |
| HYDROSTATIC PUMP DRIVE AND MOTOR (SUNSTRAND) | 250 |
| HYDROSTATIC PUMP DRIVE AND MOTOR (SUNSTRAND) | 253 |
| HYDROSTATIC PUMP DRIVE AND MOTOR | 254 |
| HYDROSTATIC PUMP DRIVE AND MOTOR (EATON) | 257 |
| HYDROSTATIC PUMP (SUNDSTRAND) | 258 |
| HYDROSTATIC PUMP (EATON) | 262 |
| CONTROL VALVE, CHARGING PUMP (HYDROSTATIC PUMP) (EATON) | 266 |
| PUMP DRIVE MOTOR (SUNDSTRAND) | 269 |
| PUMP DRIVE MOTOR (EATON) | 270 |
| HYDROSTATIC COOLING SYSTEM | 273 |
| FINAL DRIVE (LEFT, RIGHT) | 274 |
| FINAL DRIVE (RICE TRACK ONLY) (LEFT, RIGHT) | 277 |
| PARKING BRAKE CONTROLS (NORTH AMERICA AND EUROPE) | 278 |
| TURNING BRAKES (NORTH AMERICA AND EUROPE) | 281 |
| TURNING BRAKES (NORTH AMERICA AND EUROPE) | 285 |
| BRAKE CYLINDER, BRAKE ASSEMBLY | 289 |
| TRACK, FRAME AND AXLE (RICE TRACK LEFT, RIGHT) | 290 |
| TRACK, IDLER AND ROLLERS (RICE TRACK LEFT, RIGHT) | 293 |
| "A" FRAME AND REAR WHEELS | 294 |
| ADJUSTABLE REAR AXLE, WHEELS | 297 |
| "A" FRAME, FIXED REAR AXLE, WHEELS (EUROPE ONLY) | 298 |
| REAR WHEEL DRIVE, ADJUSTABLE AXLE (AXLE, TIE ROD, WHEELS) | 301 |
| REAR WHEEL DRIVE HYDRAULICS | 302 |
| REAR WHEEL DRIVE HYDRAULICS | 305 |
| MOTOR ASSEMBLY (MOTOR HOUSING AND AXLE YOKE) | 306 |
| MOTOR ASSEMBLY | 309 |
| MOTOR ASSEMBLY (WHEEL MANIFOLD) | 310 |
| MOTOR ASSEMBLY (PLANET PINION, CARRIER, HOUSING) | 313 |
| REAR WHEEL DRIVE CONTROL VALVE | 314 |
| REAR WHEEL DRIVE WIRING | 317 |
| ----- | --- |

TABLE OF CONTENT

| | |
|--|-----|
| OPERATOR'S PLATFORM AND LADDER | 318 |
| CONTROL BOX (4 SPEED, HYDROSTATIC) | 321 |
| INSTRUMENTS AND SWITCHES | 322 |
| MONITOR SYSTEM (USED COMBINE SERIAL NUMBER 174611176 AND UP) | 325 |
| MONITOR SYSTEM | 326 |
| ELECTRICAL WIRING (AT6-354 ENGINE) (BATTERY AND WIRING) | 329 |
| ELECTRICAL WIRING (AV8-540 ENGINE) | 330 |
| ALTERNATOR | 333 |
| STARTER (AT6 - 354 ENGINE) | 334 |
| SOLENOID (AT6 - 354 ENGINE) | 337 |
| STARTER (W8 - 540 ENGINE) | 338 |
| SOLENOID (AV8 - 540 ENGINE) | 341 |
| LIGHTING | 342 |
| LIGHTING (ROAD LIGHTS, EUROPE ONLY) | 345 |
| FLOODLIGHTS | 346 |
| LIGHTS | 349 |
| LIGHTS (EUROPE ONLY) | 350 |
| ELECTRIC ETHER STARTING KIT | 353 |
| SEAT (WITH CAB, LESS CAB) | 354 |
| STEERING PEDESTAL | 357 |
| STEERING WHEEL, COLUMN AND CONTROL UNIT | 358 |
| ENGINE COVER | 361 |
| ENGINE COVER EXTENSION AND CYCLONE INTAKE (AT6 - 354 ENGINE) | 362 |
| ENGINE COVER EXTENSION AND CYCLONE INTAKE (AT6 - 354 ENGINE) | 365 |
| ENGINE COVER EXTENSION AND CYCLONE INTAKE (AV8 -540) | 366 |
| ENGINE COVER EXTENSION AND CYCLONE INTAKE (AV8 - 540 ENGINE) | 369 |
| FRONT SHIELDS (LEFT SIDE) (RUBBER, TRACK) | 370 |
| REAR SHIELDS (RIGHT SIDE) | 373 |
| FUEL TANK, LINES, SUPPORTS AND TOOL BOX | 374 |
| HYDRAULIC CONTROLS | 377 |
| HYDRAULIC CONTROLS (4 SPEED, HYDROSTATIC) | 378 |
| MAIN HYDRAULIC CONTROL VALVE (3 SPOOL) | 381 |
| HYDRAULIC PRESSURE AND RETURN LINES | 386 |
| HYDRAULIC PUMP | 389 |
| HYDRAULIC TANK (WITH HYDRO, LESS HYDRO) | 390 |
| REEL LIFT HYDRAULICS | 393 |
| HYDRAULIC CONTROL REEL FORE AND AFT (EUROPE ONLY) | 394 |
| TABLE LIFT HYDRAULICS | 397 |
| TABLE LIFT CYLINDER (GRAIN AND RICE RUBBER, RICE TRACK) | 398 |
| TANK UNLOADER SWING CONTROLS | 401 |
| TANK UNLOADER SWING CONTROLS (USED PRIOR TO COMBINE SERIAL | 402 |
| TANK UNLOADER HYDRAULICS | 405 |
| UNLOADER CYLINDER | 406 |
| VARIABLE SPEED HYDRAULICS (4 SPEED) | 409 |
| VARIABLE SPEED CYLINDER | 410 |
| STEERING HYDRAULICS | 413 |
| STEERING HYDRAULICS (EUROPE ONLY) | 414 |
| STEERING CYLINDER | 417 |
| TABLE HEIGHT CONTROL (RIGID CUTTER BAR) | 418 |
| TABLE HEIGHT CONTROL (FLOATING CUTTER BAR) | 421 |
| TABLE HEIGHT CONTROL (FLOATING CUTTER BAR) | 425 |
| TABLE HEIGHT CONTROL (RIGID CUTTER BAR) (15', 16', 18', 20') | 422 |
| CONTROL VALVE (TABLE HEIGHT) | 426 |
| CONTROL VALVE (TABLE HEIGHT, REEL FORE AND AFT (EUROPE ONLY) | 429 |
| CONTROL VALVE SECTION (EUROPE ONLY) | 430 |
| HYDRAULIC PUMP DRIVE AND ENGINE SUPPORTS | 433 |
| GREASE HARNESS | 434 |
| REAR MOTOR HOUSING | 437 |
| REAR MOTOR HOUSING | 438 |
| BELTS (LEFT SIDE) | 441 |
| CHAINS | 442 |
| CHAINS | 445 |
| CHAINS | 446 |
| CHAINS (PADDLE ELEVATOR) (CONVERSION FROM RUBBER TO TRACK) | 449 |
| CHAINS (SLAT ELEVATOR) (W/O EXTENSION, WITH EXTENSION) | 450 |
| ADAPTING PARTS FOR CORN HEAD (RIGHT HAND DRIVE) | 453 |
| CONVEYOR CHAIN | 454 |
| EMBLEMS AND LABELS | 457 |
| EMBLEMS AND LABELS | 461 |
| EMBLEMS AND LABELS (FRENCH CANADIAN) | 458 |

TABLE OF CONTENT

| | |
|--|-----|
| CYLINDER BLOCK (AT6-3544 DIESEL) | 462 |
| CRANKSHAFT FLYWHEEL AND BEARINGS (AT6-3544 DIESEL) | 465 |
| PISTONS, RINGS AND RODS (AT6-3544 DIESEL) | 466 |
| TIMING GEAR AND CAMSHAFT (AT6-3544 DIESEL) | 469 |
| CYLINDER HEAD COVER (AT6-3544 DIESEL) | 470 |
| CYLINDER HEAD (AT6-3544 DIESEL) | 473 |
| OIL PAN, PUMP AND FILTER (AT6-3544 DIESEL) | 474 |
| OIL COOLER AND FILTER (AT6-3544 DIESEL) | 477 |
| GASKET SETS (AT6-3544 DIESEL) | 478 |
| WATER PUMP AND ATTACHING PARTS (AT6-3544 DIESEL) | 481 |
| MANIFOLDS (AT6-3544 DIESEL) | 482 |
| AIR INTAKE AND EXHAUST (AT6-3544 DIESEL ENGINE) | 485 |
| PRE-CLEANER, PRE-SCREENER | 486 |
| THROTTLE CONTROL, FUEL SHUT-OFF | 489 |
| INJECTION SYSTEM (AT6-3544 DIESEL) | 490 |
| INJECTION PUMP AND INJECTOR (AT6-3544 DIESEL) | 493 |
| FUEL FILTERS AND LINES (AT6-3544 DIESEL) | 494 |
| LIFT PUMP AND FUEL FILTER (AT6-3544 DIESEL) | 497 |
| TURBOCHARGER (AT6-3544 DIESEL) | 498 |
| RADIATOR FAN DRIVE (AT6-3544 DIESEL) | 501 |
| CYLINDER BLOCK (AV8-540 DIESEL) | 502 |
| CRANKSHAFT FLYWHEEL AND BEARINGS (AV8-540 DIESEL) | 505 |
| CYLINDER HEAD AND VALVES (AV8-540 DIESEL) | 506 |
| CYLINDER HEAD COVER AND ROCKERSHAFT (AV8-540 DIESEL) | 509 |
| CAMSHAFT AND TIMING GEARS (AV8-540 DIESEL) | 510 |
| OIL PAN, PUMP AND COOLER (AV8-540 DIESEL) | 513 |
| OIL PUMP (AV8-540 DIESEL ENGINE) | 514 |
| LUBRICATION OIL FILTER (AV8-540 DIESEL) | 517 |
| ENGINE GASKET SETS (AV8-540 DIESEL) | 518 |
| WATER PUMP (AV8-540 DIESEL) | 521 |
| THROTTLE CONTROL, FUEL SHUT-OFF (AV8 - 540 DIESEL ENGINE) | 522 |
| FUEL INJECTION LINES (AV8 - 540 DIESEL) | 525 |
| INJECTION PUMP | 529 |
| FUEL FILTER AND INJECTION PUMP | 530 |
| AUXILIARY DRIVE (AV8 540 DIESEL ENGINE) | 533 |
| AIR INTAKE (AV8 - 540 DIESEL ENGINES) | 534 |
| EXHAUST SYSTEM (AV8 - 540 DIESEL ENGINE) | 537 |
| INTAKE AND EXHAUST MANIFOLDS (AV8 - 540 DIESEL ENGINE) | 538 |
| RADIATOR FAN DRIVE (AV8-540 DIESEL) | 541 |
| STRAW CHOPPER (DRIVE ASSEMBLY) | 545 |
| STRAW CHOPPER (DRIVE ASSEMBLY) (EUROPE) | 549 |
| HOUSING, ADAPTER AND ROTOR | 553 |
| HOUSING, ADAPTER AND ROTOR (EUROPE ONLY) | 554 |
| CORN KIT (WITH SLOW DOWN SHEAVE) (1750155) | 557 |
| CHOPPER ALARM SYSTEM | 558 |
| CAB (SHEET METAL, WINDOWS) | 561 |
| CAB (SEALING STRIPS) | 562 |
| COMPRESSOR EVAPORATOR AND CONDENSOR | 565 |
| COMPRESSOR | 566 |
| AIR CONDITIONING AND LINES (AT6 354 ENGINE) (AV8 540 ENGINE) | 569 |
| CAB ELECTRICAL WIRING | 570 |
| PRESSURIZER | 573 |
| HEATER | 574 |
| WINDSHIELD WIPER (EUROPE ONLY) | 577 |
| PICK-UP REEL (GRAIN OR RICE - 6" SPACING - 5 BAT) | 580 |
| PICK-UP REEL (GRAIN - 6" SPACING - 6 BAT) | 583 |
| PICK- UP REEL (GRAIN OR RICE - 4" SPACING - 6 BAT) | 584 |
| PICK- UP REEL (GRAIN - 6" STAGGERED SPACING - 5 BAT) | 587 |
| PICK-UP REEL (EXPORT ONLY) (GRAIN - 6" STAGGERED SPACING - | 591 |
| PICK-UP REEL (GRAIN AND RICE - 4" SPACING - 6 BAT) | 595 |
| CLUTCH AND ANTI-WRAP SHIELD | 599 |
| DRAPER TABLE | 600 |
| TABLE BRACES | 603 |
| AUGER (DRAPER TABLE) | 604 |
| WOBBLE KNIFE DRIVE (DRAPER TABLE) | 607 |
| DRIVES, KNIFE AND AUGER (DRAPER TABLE) | 608 |
| DRAPER AND DRIVE (DRAPER TABLE) | 611 |
| REEL ARMS, DIVIDERS AND SHIELDS (DRAPER TABLE) (L, R) | 612 |
| PICK-UP REEL (DRAPER TABLE) (RICE - 6" SPACING - 6 BAT) | 615 |

TABLE OF CONTENT

| | |
|---|-----|
| PICK-UP REEL (DRAPER TABLE) (1040 629, 631) | 616 |
| CLUTCH - PICK-UP REEL (DRAPER TABLE) | 619 |
| REEL DRIVE HYDRAULICS (DRAPER TABLE) | 620 |
| REEL LIFT, HYDRAULICS (DRAPER TABLE) | 623 |
| HYDRAULIC MOTOR (DRAPER TABLE) | 624 |
| HYDRAULIC CYLINDERS (DRAPER TABLE) | 627 |
| ACCESSORIES | 628 |

TABLE

1746 360-2

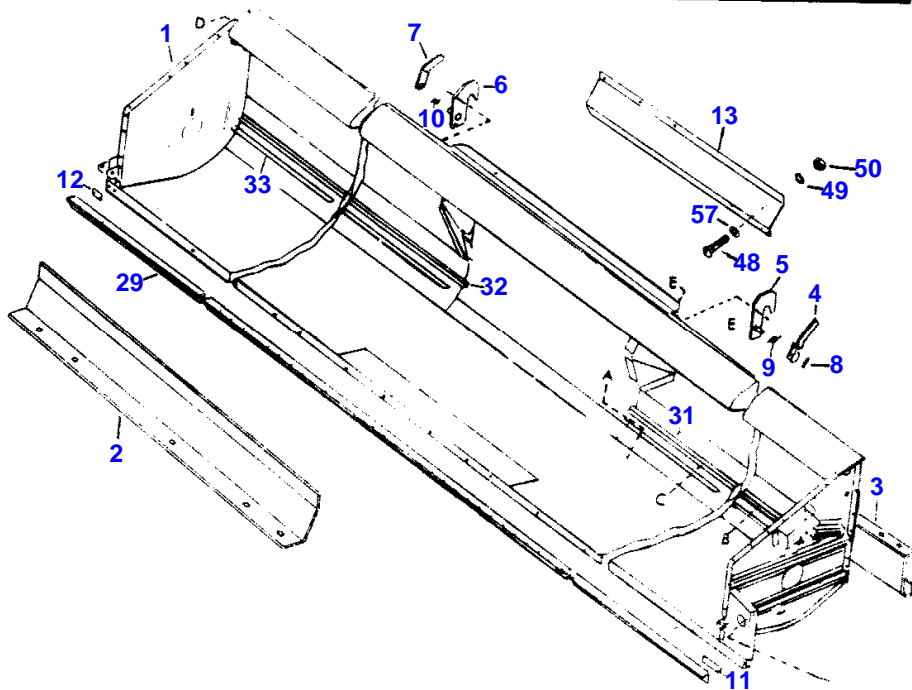
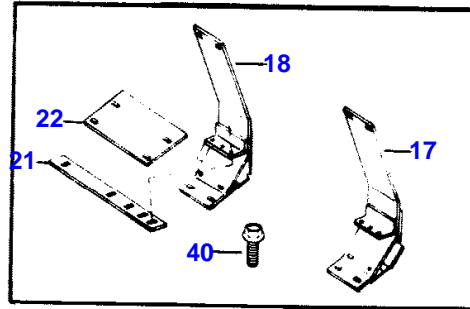
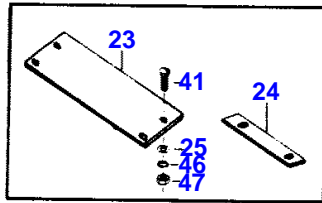

| A | B | C | D | E |
|----|----|----|----|----|
| 41 | 42 | 43 | 44 | 63 |
| 46 | 46 | 46 | 45 | 64 |
| 47 | 47 | 47 | 46 | 65 |
| | | | 47 | |

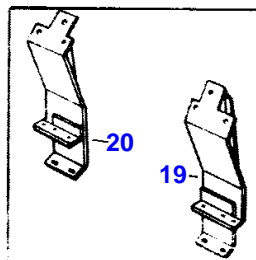

1st Print

651 429 M93 (Issue 1, 10/88)

TABLE (RIGID CUTTER BAR) (13', 15', 16')

| Item | Part Number | Qty | Description |
|------|-------------|-----|---|
| 1 | 264450M92 | 1 | Table Assembly (13') |
| 2 | 261580M1 | 1 | Extension, Bottom (Centered Table) 13' |
| 3 | 261581M2 | 1 | Support, Table (13') |
| 1 | 264454M91 | 1 | Table Assembly (Centered) (15') |
| | 264456M92 | 1 | Table Assembly (16') |
| 4 | 262013M92 | 1 | Cam Assembly, Left |
| 5 | 261516M91 | 1 | Hanger Assembly, Left |
| 6 | 261517M91 | 1 | Hanger Assembly, Right |
| 7 | 262012M92 | 1 | Cam Assembly, Right |
| 8 | 363307X1 | 2 | Pin (3/16 x 1-1/8" Groove) |
| 9 | 261641M1 | 1 | Spring, Left |
| 10 | 261640M1 | 1 | Spring, Right |
| 11 | 369141X1 | 1 | Strap (2-Hole) |
| 12 | 369142X1 | 1 | Strap (2 Hole) |
| 13 | 264022M91 | 1 | Shield Assembly |
| 16 | 264446M91 | 1 | Bracket Assembly (15', 16') |
| 17 | 272131M92 | 1 | Filler Plate (Left)(4-3/16") |
| 18 | 272137M92 | 1 | Filler Plate (Right)(4-3/16") |
| 19 | 281982M91 | 1 | Plate Assembly, Filler (Left) |
| 20 | 281981M91 | 1 | Plate Assembly, Filler (Right) |
| 21 | 272141M1 | 2 | Strap (12-3/16" Long - 5 Holes) |
| 22 | 272142M1 | 2 | Plate (10" Long - 4 Holes)(W/Filler Plates) |
| 23 | 272143M1 | 2 | Plate (14-3/16" Long - 4 Holes) |
| 24 | 272144M1 | 2 | Strip (8" Long - 2 Holes)(W/O Filler Plates) |
| 25 | 353755X1 | 16 | Washer (11/32 x 11/16 x 5/64" Flat) |
| 29 | 260707M1 | 1 | Angle, Table Front (13') |
| | 260802M2 | 1 | Angle, Table Front (15') |
| | 260803M2 | 1 | Angle, Table Front (16') |
| 31 | 261573M1 | 1 | Angle, Left (49-7/16") (13') |
| | 264057M1 | 1 | Angle, Left (61-7/16") (15') |
| | 261534M1 | 1 | Angle, Left (67-7/16") (16') |
| 32 | 261572M1 | 1 | Angle, Right (49-7/16") (13') |
| | 264059M1 | 1 | Angle, Right (61-7/16") (15') |
| | 261535M1 | 1 | Angle, Right (67-7/16") (16') |
| 33 | 261574M1 | 2 | Strap, Support (41-7/16" Long)(4 Holes) (13') |
| | 264058M1 | 2 | Strap(53-7/16" Long) (15') |
| | 261488M1 | 2 | Strap, Support (59-7/16") (16') |
| 40 | 365008X1 | AR | Bolt (5/16 x 5/8" Hex., Washer Hd. Tapping) |
| 41 | 364352X1 | AR | Bolt (5/16 x 3/4" NC, Carr.) |
| 42 | 353677X1 | AR | Bolt (5/16 x 3/4" NC, Hex.) |
| 43 | 353678X1 | AR | Bolt (5/16 x 7/8" NC, Hex.) |
| 44 | 364533X1 | AR | Bolt (5/16 x 1-1/4" NC, Carr.) |
| 45 | 353755X1 | AR | Washer (11/32 x 11/16 x 5/64" Flat) |
| 46 | 353446X1 | AR | Washer (5/16" Lock) |
| 47 | 355565X1 | AR | Nut (5/16" NC, Hex.) |
| 48 | 360513X1 | AR | Bolt (3/8 x 3/4" NC. Carr.) |
| 49 | 353434X1 | AR | Washer (3/8" Lock) |
| 50 | 355566X1 | AR | Nut (3/8" NC, Hex.) |
| 57 | 49307X | AR | Washer (7/16" Sq. Hole Flat) |
| 58 | 353725X1 | AR | Bolt (1/2 x 1-3/4" NC, Hex.) |
| 59 | 353439X1 | AR | Washer (1/2" Lock) |
| 63 | 363423X1 | AR | Bolt (5/8 x 2" NC, Carr.) |
| 64 | 353433X1 | AR | Washer (5/8" Lock) |
| 65 | 375099X1 | AR | Nut (5/8" NC, Hex.) |

TABLE PLATES, SHIELDS AND DIVIDERS

1746 364-2

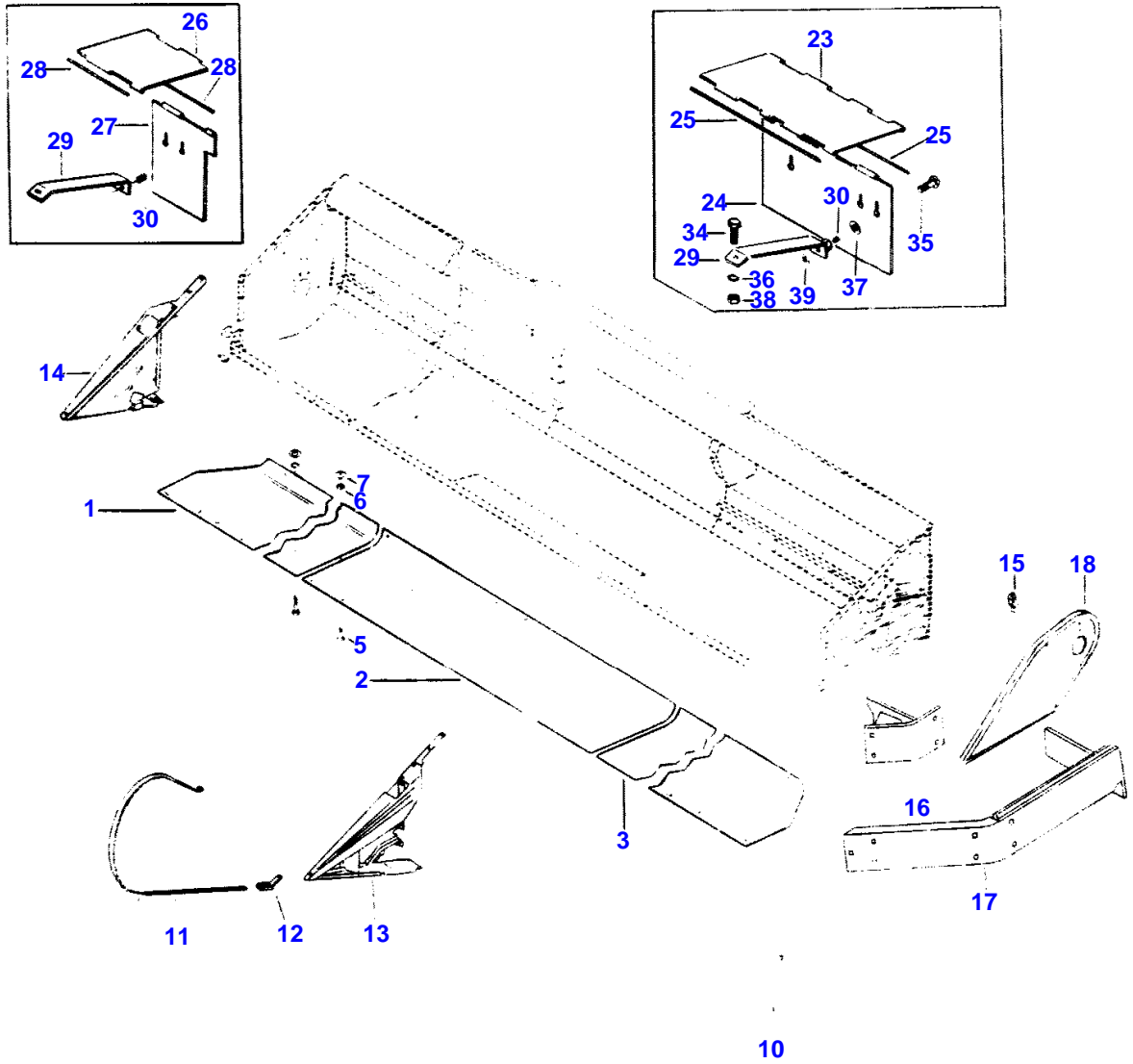

| Item | Part Number | Qty | Description |
|------|-------------|-----|--|
| | | | 13', 15', 16' |
| | | | ***** |
| 1 | 264040M91 | 1 | Plate Assembly, Right (15') |
| 2 | 261564M91 | 1 | Plate Assembly, Right (16') |
| | 261562M91 | 1 | Plate Assembly, Center (15', 16') |
| 3 | 261565M91 | 1 | Plate Assembly, Left (16') |
| | 264038M91 | 1 | Plate Assembly, Left (15') |
| 5 | 353691X1 | AR | Bolt (3/8 x 1" NC, Hex.) (15', 16') |
| 6 | 353434X1 | AR | Washer (3/8" Lock) (15', 16') |
| 7 | 353756X1 | AR | Washer (13/32 x 13/16 x 1/16" Flat) (15', 16') |
| 10 | 261568M1 | 7 | Shoe (15', 16') |
| 11 | 239746M1 | 2 | Guard (15', 16') |
| 12 | 236125M91 | 2 | Bracket Assembly (15', 16') |
| 13 | 260683M95 | 1 | Divider Assembly, Left (15', 16') |
| 14 | 260676M95 | 1 | Divider Assembly, Right (15', 16') |
| 15 | 261408M1 | 1 | Bracket, Lift Arm (15', 16') |
| 16 | 264446M91 | 1 | Bracket Assembly (15', 16') |
| 17 | 261726M91 | 1 | Shield Assembly (15', 16') |
| 18 | 261409M91 | 1 | Shield Assembly (15', 16') |
| 23 | 245924M1 | 1 | (A) Shield, Left |
| 24 | 245925M1 | 1 | (A) Shield, Left |
| 25 | 360985X1 | 2 | (A) Rod (1/4 x 12-1/16") |
| 26 | 261623M1 | 1 | (B) Shield, Right |
| 27 | 261626M1 | 1 | (B) Shield, Right |
| 28 | 365695X1 | 2 | (C) Pin (1/4 x 5-3/4" Headless) |
| 29 | 261624M1 | 3 | (B) Support |
| 30 | 261625M1 | 3 | (B) Spring |
| 34 | 353678X1 | AR | Bolt (5/16 x 7/8" NC, Hex.) |
| 35 | 355156X1 | AR | Bolt (5/16 x 1-1/2" NC, Sltd. Truss Hd.) |
| 36 | 353446X1 | AR | Washer (5/16" Lock) |
| 37 | 355618X1 | AR | Washer (5/16" Flat) |
| 38 | 355565X1 | AR | Nut (5/16" NC, Hex.) |
| 39 | 375108X1 | AR | Nut (5/16" NC, Half Hex.) |

(A) - Used Late Production Tables.
 (B) - Quantity Was 2 On Early Production Tables.
 (C) - Quantity Was 4 On Early Production Tables.

TABLE

1746 362-2

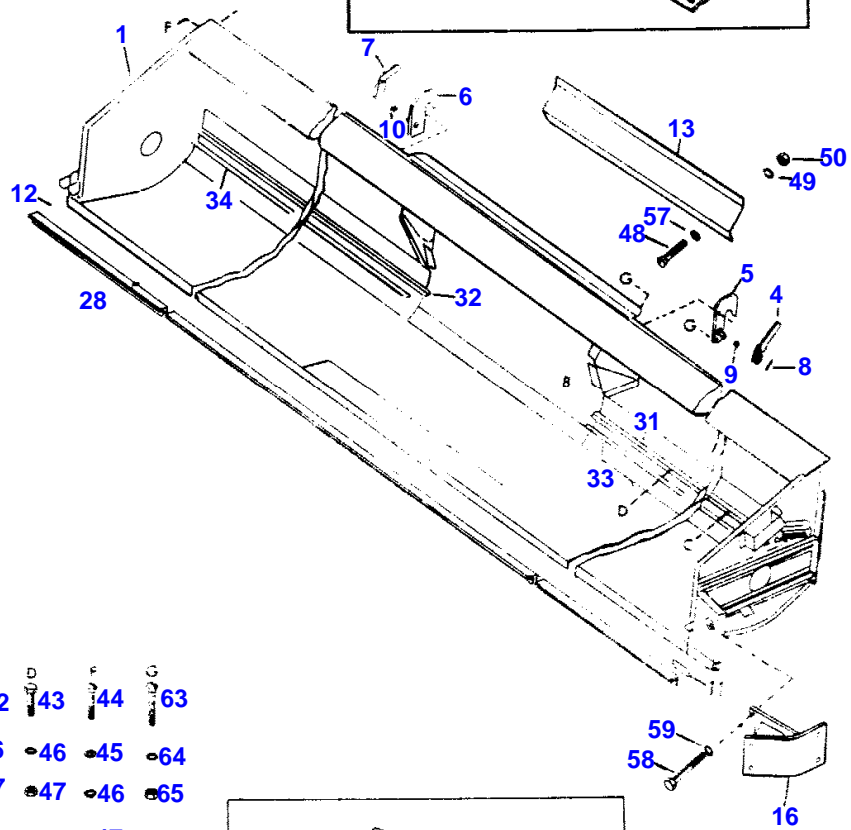
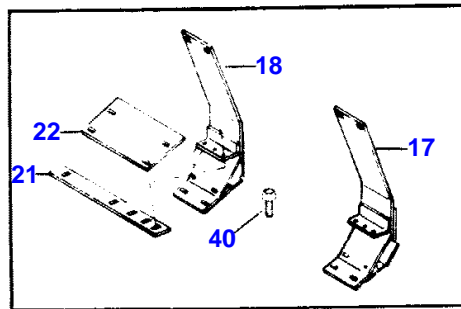
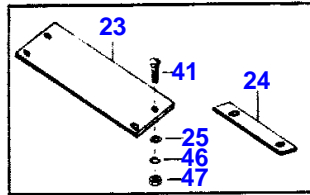

- | | | | | |
|----|----|----|----|----|
| 41 | 42 | 43 | 44 | 63 |
| 46 | 46 | 46 | 45 | 64 |
| 47 | 47 | 47 | 46 | 65 |
| | | | 47 | |

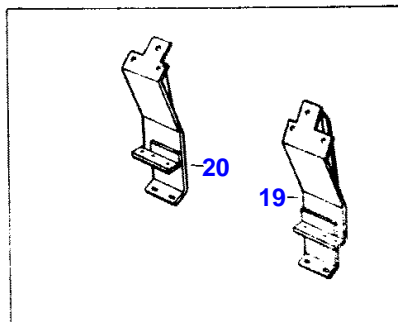

1st Print

651 429 M93 Issue 10 10 99

| Item | Part Number | Qty | Description |
|------|-------------|-----|--|
| 1 | 264458M92 | 1 | Table Assembly (18') |
| | 264459M93 | 1 | Table Assembly (20') |
| | 264460M92 | 1 | Table Assembly (Offset) (20') |
| | 264461M92 | 1 | Table Assembly (24') |
| 4 | 262013M92 | 1 | Cam Assembly, Left |
| 5 | 261516M91 | 1 | Hanger Assembly, Left |
| 6 | 261517M91 | 1 | Hanger Assembly, Right |
| 7 | 262012M92 | 1 | Cam Assembly, Right |
| 8 | 363307X1 | 2 | Pin (3/16 x 1-1/8" Groove) |
| 9 | 261641M1 | 1 | Spring, Left |
| 10 | 261640M1 | 1 | Spring, Right |
| 11 | 369141X1 | 1 | Strap (2-Hole) |
| 12 | 369142X1 | 1 | Strap (2 Hole) |
| 13 | 264022M91 | 1 | Shield Assembly |
| 16 | 264446M91 | 1 | Bracket Assembly |
| 17 | 272131M92 | 1 | Filler Plate (Left)(4-3/16") |
| 18 | 272137M92 | 1 | Filler Plate (Right)(4-3/16") |
| 19 | 281982M91 | 1 | Plate Assembly, Filler (Left) |
| 20 | 281981M91 | 1 | Plate Assembly, Filler (Right) |
| 21 | 272141M1 | 2 | Strap (12-3/16" Long - 5 Holes) |
| 22 | 272142M1 | 2 | Plate (10" Long - 4 Holes)(W/Filler Plates) |
| 23 | 272143M1 | 2 | Plate (14-3/16" Long - 4 Holes) |
| 24 | 272144M1 | 2 | Strip (8" Long - 2 Holes)(W/O Filler Plates) |
| 25 | 353755X1 | 16 | Washer (11/32 x 11/16 x 5/64" Flat) |
| 28 | 260861M2 | 1 | Angle, Table Front (18') |
| | 260862M3 | 1 | Angle, Table Front (20') |
| | 261769M1 | 1 | Bar, Knife (24') |
| 31 | 261674M1 | 1 | Angle, Left (79-7/16") (18') |
| | 261520M1 | 1 | Angle, Left (91-7/16") (20') |
| | 470138M1 | 1 | Angle (Offset)(72-7/16") (20') |
| | 261770M1 | 1 | Angle, Left (24') |
| 32 | 261673M1 | 1 | Angle, Right (79-7/16") (18') |
| | 261518M1 | 1 | Angle, Right (91-7/16") (20') |
| | 470137M1 | 1 | Angle, (Offset) (20') |
| | 261768M1 | 1 | Angle, Right (24') |
| 33 | 261675M1 | 2 | Strap, Support (71-7/16") (18') |
| | 261521M1 | 2 | Strap (83-7/16") (20') |
| | 470136M1 | 1 | Strap (Offset)(64-7/16") (20') |
| 34 | 470135M1 | 1 | Strap, Right (Offset) (20') |
| 33 | 261771M1 | 2 | Strap, Table (24') |
| 40 | 365008X1 | AR | Bolt (5/16 x 5/8" Hex., Washer Hd. Tapping) |
| 41 | 364352X1 | AR | Bolt (5/16 x 3/4" NC, Carr.) |
| 42 | 353677X1 | AR | Bolt (5/16 x 3/4" NC, Hex.) |
| 43 | 353678X1 | AR | Bolt (5/16 x 7/8" NC, Hex.) |
| 44 | 364533X1 | AR | Bolt (5/16 x 1-1/4" NC, Carr.) |
| 45 | 353755X1 | AR | Washer (11/32 x 11/16 x 5/64" Flat) |
| 46 | 353446X1 | AR | Washer (5/16" Lock) |
| 47 | 355565X1 | AR | Nut (5/16" NC, Hex.) |
| 48 | 360513X1 | AR | Bolt (3/8 x 3/4" NC. Carr.) |
| 49 | 353434X1 | AR | Washer (3/8" Lock) |
| 50 | 355566X1 | AR | Nut (3/8" NC, Hex.) |
| 57 | 49307X | AR | Washer (7/16" Sq. Hole Flat) |
| 48 | 353725X1 | AR | Bolt (1/2 x 1-3/4" NC, Hex.) |
| 59 | 353439X1 | AR | Washer (1/2" Lock) |
| 63 | 363423X1 | AR | Bolt (5/8 x 2" NC, Carr.) |
| 64 | 353433X1 | AR | Washer (5/8" Lock) |
| 65 | 375099X1 | AR | Nut (5/8" NC, Hex.) |

TABLE PLATES, SHIELDS AND DIVIDERS

1746 365-2

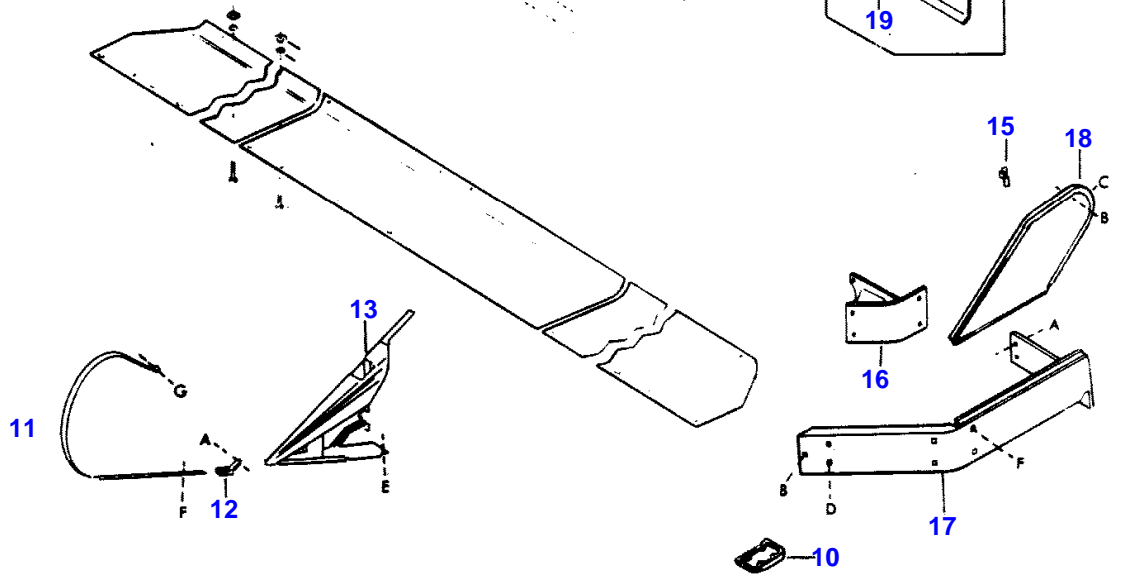
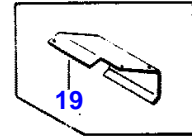
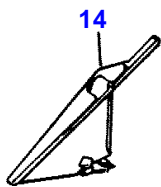
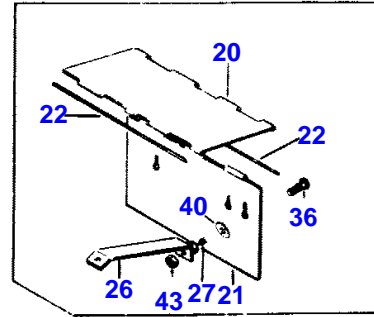
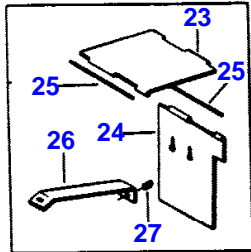

- | | | | | | | | |
|----|----|----|----|----|----|----|----|
| A | B | C | D | E | F | G | G |
| 30 | 31 | 32 | 33 | 34 | 35 | 37 | 37 |
| 41 | 41 | 40 | 41 | 41 | 41 | 41 | 41 |
| | | 42 | 41 | 42 | 42 | 42 | 42 |
| | | | 42 | | | | |

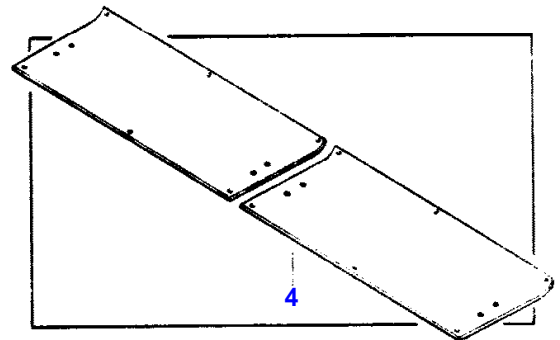

Print

651 429 M93 (Issue 1) 10/80

| Item | Part Number | Qty | Description |
|------|-------------|-----|---|
| | | | 18', 20', 24' |
| | | | ***** |
| 1 | 261668M91 | 1 | Plate Assembly, Right (18', 24') |
| | 261600M91 | 1 | Plate Assembly, Table Bottom, (Right) (20') |
| | 470150M91 | 1 | Plate Assembly, Right (20') |
| 2 | 261562M91 | 1 | Plate Assembly, Center |
| 3 | 261669M91 | 1 | Plate Assembly, Left (18', 24') |
| | 261601M91 | 1 | Plate Assembly, Table Bottom, Left (20') |
| | 470152M91 | 1 | Plate Assembly, Left (Offset) (20') |
| 4 | 261744M91 | 1 | Plate Assembly, Right and Left (20') |
| | 261744M91 | 2 | Plate Assembly, Right and Left (24') |
| 10 | 261568M1 | 7 | Shoe (18', 20') |
| | 261568M1 | 8 | Shoe (20') |
| | 261568M1 | 9 | Shoe (24') |
| 11 | 239746M1 | 2 | Guard |
| 12 | 236125M91 | 2 | Bracket Assembly |
| 13 | 260683M95 | 1 | Divider Assembly, Left |
| 14 | 260676M94 | 1 | Divider Assembly (Right) |
| 15 | 261408M1 | 1 | Bracket, Lift Arm |
| 16 | 264446M91 | 1 | Bracket Assembly |
| 17 | 261726M91 | 1 | Shield Assembly |
| 18 | 261409M91 | 1 | Shield Assembly |
| 19 | 261627M1 | 1 | Shield |
| 20 | 245924M1 | 1 | (A) Shield, Left |
| 21 | 245925M1 | 1 | (A) Shield, Left |
| 22 | 360985X1 | 2 | (A) Rod (1/4 x 12-1/16") |
| 23 | 261623M1 | 1 | (B) Shield, Right |
| 24 | 261626M1 | 1 | (B) Shield, Right |
| 25 | 365695X1 | 2 | (C) Pin (1/4 x 5-3/4" Headless) |
| 26 | 261624M1 | 3 | (B) Support |
| 27 | 261625M1 | 3 | (B) Spring |
| 30 | 353676X1 | AR | Bolt (5/16 x 5/8" NC, Hex.) |
| 31 | 360500X1 | AR | Bolt (5/16 x 5/8" NC, Carr.) |
| 32 | 353677X1 | AR | Bolt (5/16 x 3/4" NC, Hex.) |
| 33 | 364352X1 | AR | Bolt (5/16 x 3/4" NC, Carr.) |
| 34 | 353678X1 | AR | Bolt (5/16 x 7/8" NC, Hex.) |
| 35 | 364954X1 | AR | Bolt (5/16 x 7/8" NC, Carr.) |
| 36 | 355156X1 | AR | Bolt (5/16 x 1-1/2" NC, Sltd. Truss Hd.) |
| 37 | 353685X1 | AR | Bolt (5/16 x 1-3/4" NC, Hex.) |
| | 354613X1 | AR | Bolt (5/16 x 2-1/4" NC, Hex.) |
| 40 | 353755X1 | AR | Washer (11/32 x 11/16 x 5/64" Flat) |
| 41 | 353446X1 | AR | Washer (5/16" Lock) |
| 42 | 355565X1 | AR | Nut (5/16" NC, Hex.) |
| 43 | 375108X1 | AR | Nut (5/16" NC, Half Hex.) |

(A) - Used Late Production Tables.
 (B) - Quantity Was 2 On Early Production Tables.
 (C) - Quantity Was 4 On Early Production Tables.

TABLE

1746 475-1

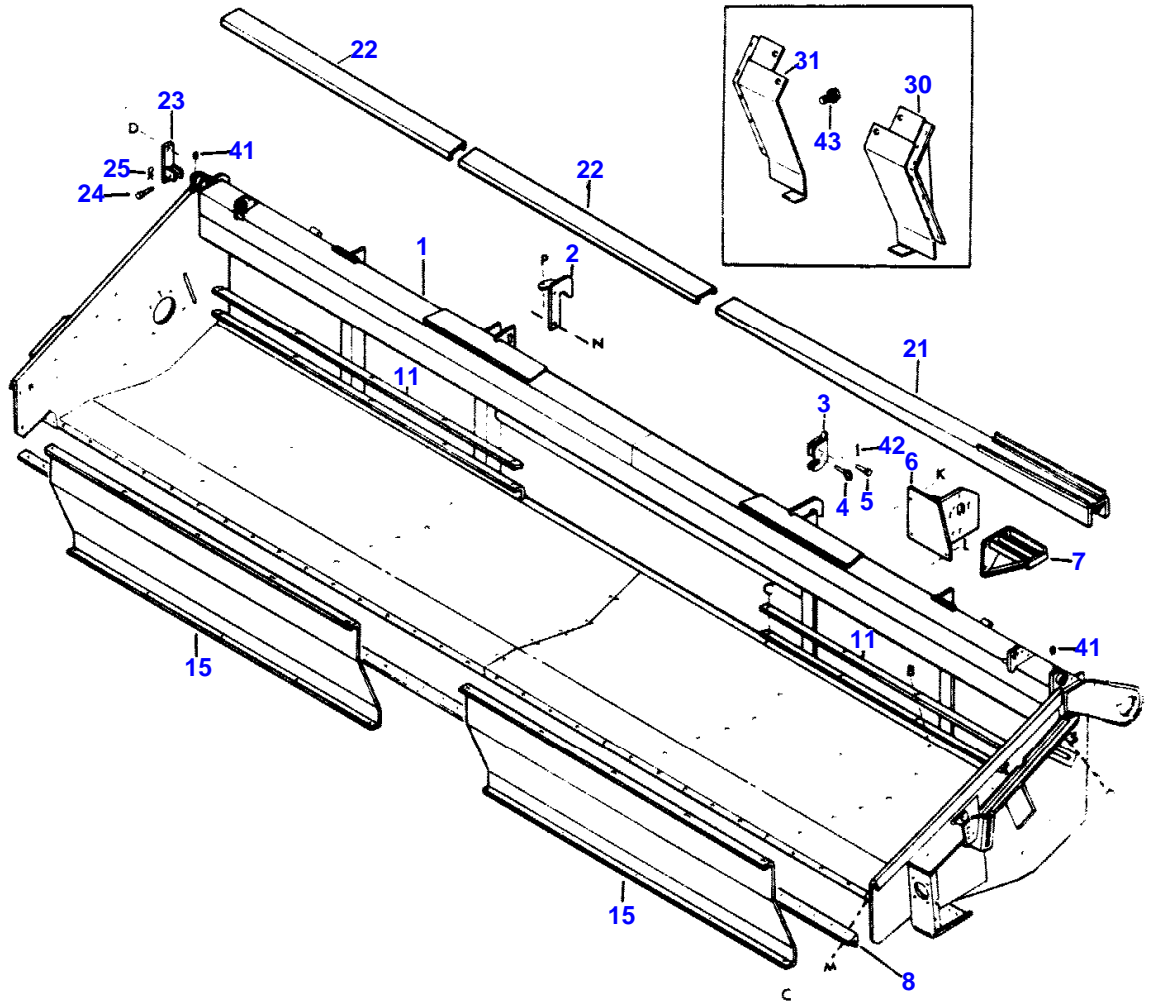

| | | | | | | | | |
|----|----|----|----|----|----|----|----|----|
| A | B | C | D | K | L | M | N | P |
| 45 | 44 | 46 | 51 | 52 | 53 | 54 | 58 | 59 |
| | 47 | 49 | 56 | 57 | 55 | 56 | 61 | |
| | 49 | 50 | | | 56 | 57 | 62 | 60 |
| | 50 | | | | | | | |

1st Print

E51 429 M93 (Issue 1) 1-0-00

Buy Now



Our support email:

ebooklibonline@outlook.com