

m-3614

NEW HOLLAND GT20

OPERATOR'S MANUAL

Garden Tractor
Model No.
716498016—T0AB0001 & Up



Publication Number:
86602567 1/2000

Reprinted

Introduction

Thank you for purchasing a New Holland product.

All of us at New Holland want you to be completely satisfied with your new product, so feel free to contact your local Authorized Service Dealer for help with service, genuine replacement parts, or other information you may require.

Whenever you contact your Authorized Service Dealer or the factory, always know the model and serial numbers of your product. These numbers will help the Service Dealer or Service Representative provide exact information about your specific product. You will find the model and serial number plate located in a unique place on the product as shown below.

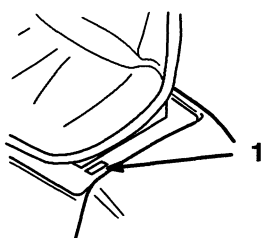

m-3605

1. Model and Serial Number Plate

For your convenience, write the product model and serial numbers in the space below.

 NEW HOLLAND	
MODEL NO.	SERIAL NO.
COMPONENT	
NEW HOLLAND NORTH AMERICA, INC.	
<small>MADE IN U.S.A.</small>	

Read this manual carefully to learn how to operate and maintain your product correctly. Reading this manual will help you and others avoid personal injury and damage to the product. Although we design, produce and market safe, state-of-the-art products, you are responsible for using the product properly and safely. You are also responsible for training persons, who you allow to use the product, about safe operation.

The warning system in this manual identifies potential hazards and has special safety messages that help you and others avoid personal injury, even death. DANGER, WARNING and CAUTION are signal words used to identify the level of hazard. However, regardless of the hazard, be extremely careful.



DANGER signals an extreme hazard that will cause serious injury or death if the recommended precautions are not followed.

WARNING signals a hazard that may cause serious injury or death if the recommended precautions are not followed.

CAUTION signals a hazard that may cause minor or moderate injury if the recommended precautions are not followed.

Two other words are also used to highlight information. "Important" calls attention to special mechanical information and "Note" emphasizes general information worthy of special attention.

The left and right side of the machine is determined by sitting on the seat in the normal operator's position.

	WARNING:	
The engine exhaust from this product contains chemicals known to the State of California to cause cancer, birth defects, or other reproductive harm.		

IMPORTANT: The engine in this product is not equipped with a spark arrester muffler. It is a violation of California Public Resource Code Section 4442 to use or operate this engine on any forest-covered, brush-covered or grass-covered land as defined in CPRC 4126. Other states or federal areas may have similar laws.



GT20 Garden Tractor

Model No. 716498016—T0AB0001 & Up

**Set Up
Instructions**

Loose Parts

Note: Use the chart below to identify parts for assembly.

DESCRIPTION	QTY.	USE
Rear Wheel	2	Installing the rear wheels
Wheel Bolt	10	
R.H. Wheel Spindle	1	Installing the front wheels
L.H. Wheel Spindle	1	
Unplated Thrust Washer - 1.56" O.D x .06" Thick	2	
Plated Wheel Washer -1.50" O.D x .05" Thick	4	
Bolt - 5/16"-18 x 2.25" Long	2	
Hex Nut - 5/16"-18	2	
Spindle Cap	2	
Front Wheel	2	
Hubcap Washer - 2.50" O.D x .05" Thick	2	
Cotter Pin -.156" x 1.50" Long	2	
Shim Washer - 1.50" O.D x .015" Thick	2	
Hubcap	2	
Seat Assembly	1	Installing the seat
Shoulder Bolt - 5/16"	2	
Locknut - 5/16"	2	

Installing the Front Wheels

IMPORTANT: Never raise the front of the tractor by placing a jack under the bumper or front axle because the tractor may be damaged.

1. The front hood support braces have two slots (Fig. 2) that may be used to lift the tractor to install the front wheel spindles. To access these slots, remove the front grill and raise the hood.

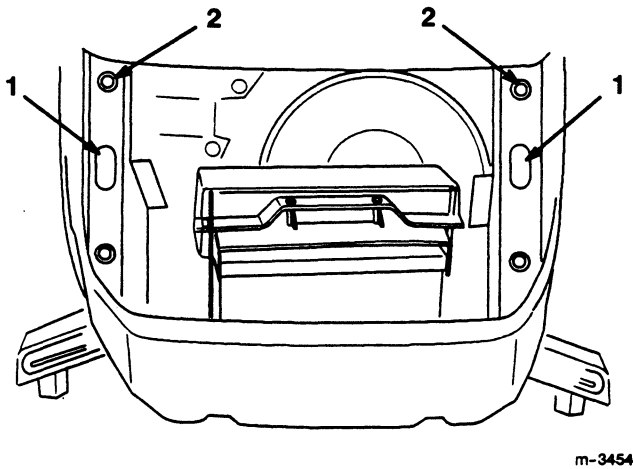

Figure 2

1. Slots
2. Grill Grommets

Note: Remove, or be careful not to damage, the two upper grill grommets (Fig. 2).

2. Using a suitable hoist, raise the front of the tractor only high enough to install the front wheel spindles.

IMPORTANT: Do not pivot the weight of the tractor onto the rear drawbar hitch because the hitch will be damaged.

3. Install a 1.56" O.D. x .06" thick unplated thrust washer onto the splined shaft of the R.H. wheel spindle (Fig. 4).

4. Install the splined end of the R.H. spindle through the R.H. end of the front axle and into the steering arm (Fig. 4).

Note: The L.H. and R.H. spindles are different. Assemble the spindles as shown in figure 3.

Note: The outside edge of the spindle must be parallel to the end of the steering arm (Fig. 3).

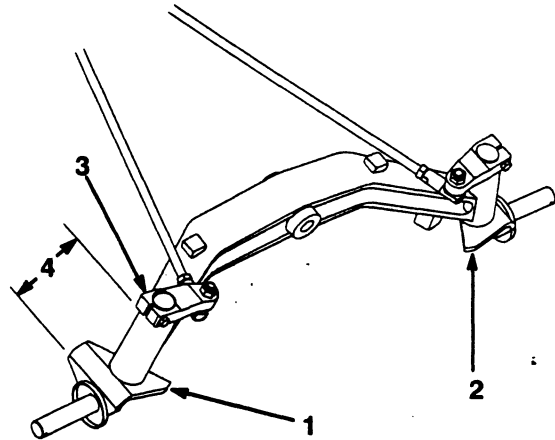

Figure 3

1. R.H. Spindle
2. L.H. Spindle
3. Steering arm
4. Parallel relationship

5. Secure the spindle shaft to the steering arm with a 5/16"-18 x 2.25" bolt and 5/16" nut (Fig. 4). Torque the nut to 230 ± 25 in-lbs.

6. Insert a 1.50" O.D x .05" thick plated wheel washer onto the R.H. spindle (Fig. 4).

7. Install a front wheel onto the R.H. spindle with the valve stem facing inward (Fig. 4).

8. Insert another 1.50" O.D x .05" thick plated wheel washer onto the R.H. spindle (Fig. 4).

9. Install a 2.50" O.D x .05" thick hub cap washer onto the spindle. Now insert a .156 x 1.50" long cotter pin into the hole in the spindle (Fig. 4).

Installing the Seat

1. Mount the seat to the seat base using two 5/16" shoulder bolts and lock nuts (Fig. 6).
2. Insert the seat switch wire through the center opening in the seat base (Fig 6).
3. Push the seat switch wire connector into the wire harness connector.

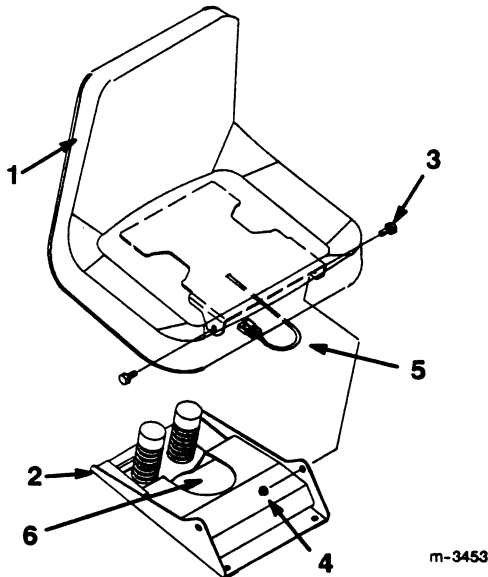

Figure 6

- | | |
|----------------------------|---------------------------------|
| 1. Seat | 5. Seat switch wire connector |
| 2. Seat base | 6. Opening for seat switch wire |
| 3. 5/16" shoulder bolt (2) | |
| 4. 5/16" Locknut (4) | |

Note: There is **no fixed straight ahead position on power steering models.**

4. Secure the steering wheel to the shaft with a lock washer and nut (Fig. 7). Tighten the retaining nut to 45-50 ft-lbs.
5. Install the trim cover on the steering wheel (Fig. 7).
6. Lift up on the spacer until it is tight against the steering wheel and slide the lock ring up tight against the spacer (Fig. 7).
7. Secure the lock ring in place using the set screw (Fig. 7).

Note: Use the notch in the side of the spacer to access the set screw.

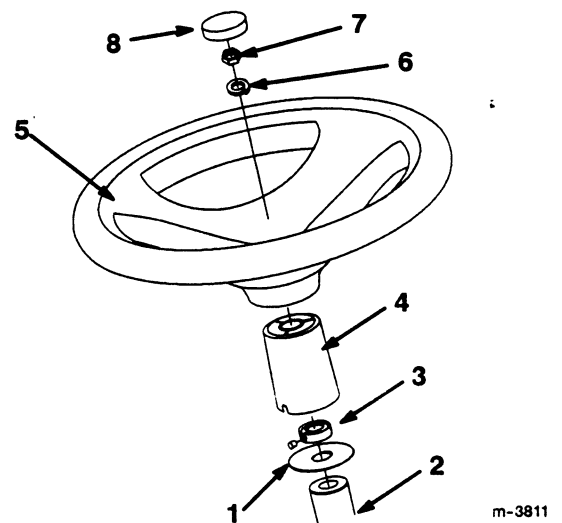

Figure 7

- | | |
|-----------------------------|-------------------|
| 1. Boot washer | 5. Steering wheel |
| 2. Steering shaft | 6. Lock washer |
| 3. Lock ring with set screw | 7. Nut |
| 4. Spacer | 8. Trim cover |

Installing the Steering Wheel

1. Slide the boot washer, lock ring with set screw, and spacer (large end down) onto the steering shaft (Fig. 7).
2. Remove the plastic trim cover from the steering wheel (Fig. 7)
3. Install the steering wheel onto the shaft, carefully aligning the splines (Fig. 7).

Checking Front Wheel Toe-In

With the tractor on a level surface, check to make sure the front wheel toe-in is between 1/8" and 1/4". For instructions on adjusting toe-in, refer to the Maintenance section in Operator's Manual.

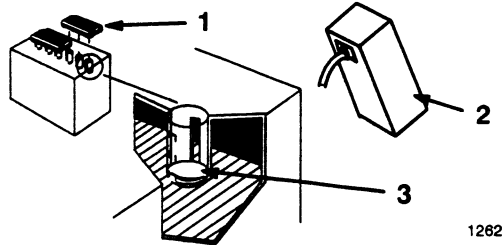

Figure 9

- 1. Filler caps
- 2. Electrolyte
- 3. Lower part of tube

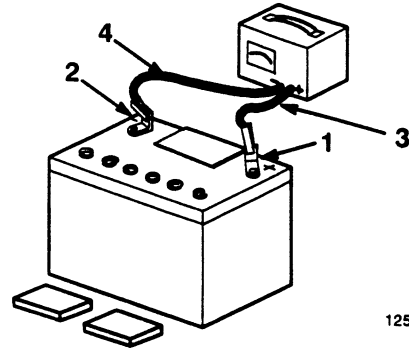

Figure 10

- 1. Positive battery post
- 2. Negative battery post
- 3. Red (+) charger lead
- 4. Black (-) charger lead

! WARNING

POTENTIAL HAZARD

- Charging battery produces gasses.

WHAT CAN HAPPEN

- Battery gasses can explode.

HOW TO AVOID THE HAZARD

- Keep cigarettes, sparks and flames away from battery.

5. Slowly pour electrolyte into each cell until the level is once again up to "UPPER" line on the battery case (Fig. 9), then install the filler caps.
6. Install the battery in the tractor and connect the battery cables (refer to Installing the Battery in your tractor Operator's Manual).

Note: Do not run the tractor with the battery disconnected.

3. Leave the filler caps off and connect a 3-4 amp battery charger to the battery posts (Fig. 10). Charge the battery at a rate of 4 amperes or less for 4 hours (12 volts).
4. When the battery is fully charged, unplug the charger from electrical outlet, then disconnect the charger leads from the battery posts (Fig. 10).

Installing the Hitch Pin

Insert the hitch pin into the drawbar hitch and secure it with a .50" I.D. flat washer and hairpin cotter (Fig. 11).

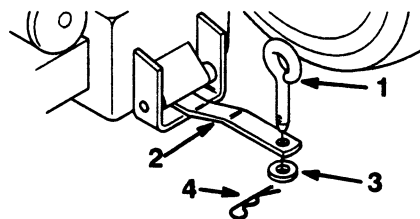

Figure 11

- 1. Hitch pin
- 2. Drawbar hitch
- 3. .50" Flat washer
- 4. Hairpin cotter

m-24R1

Attach-a-Matic® Kit	
Part No. 100-8716 Part No. TR100D8716	INSTALLATION INSTRUCTIONS

Loose Parts

Note: Use the chart below to identify parts for assembly.

DESCRIPTION	QTY.	USE
Attach-a-Matic®	1	Install Attach-a-Matic®
Bolts	4	
Nuts	4	

Installing Attach-a-Matic®

1. Remove the E-ring and all washers from the front axle pivot pin (Fig. 1). Remove muffler shield.
2. Install (4) 3/8 x 1" carriage bolts into the keyhole slots in the axle bracket. (Fig. 1).
3. Install the muffler shield and place the front hitch onto the tractor, securing it with (4) 3/8" locknuts (Fig. 1).
4. Reinstall enough washers to fill the space between hitch and E-ring groove. Install E-ring (Fig. 1).

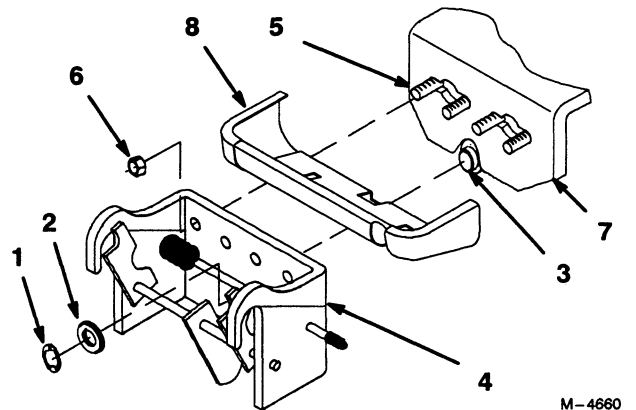

Figure 1

- | | |
|-----------------|---------------------------------------|
| 1. E-ring | 5. Carriage bolt 3/8 x 1" (Installed) |
| 2. Thick Washer | 6. Locknut 3/8" |
| 3. Axle pivot | 7. Front of Tractor |
| 4. Front hitch | 8. Muffler Guard |

Contents

	Page		Page
Safety	2	Attachment Power Lift	22
Safe Operating Practices	2	Positioning the Seat	23
New Holland Riding Mower Safety	4	Headlights and Taillights	23
Slope Chart	5	Positioning the Tilt Steering Wheel	23
Safety and Instruction Decals	7	Using the Cruise Control	24
Check Before Operating	8	The Automatic Speed Reduction Feature ..	24
Opening the Hood	8	Pushing the Machine by Hand	25
Closing the Hood	9	Maintenance	26
Removing the Side Panels	9	Service Interval Chart	26
Adding Fuel	10	Engine Oil	29
Check the Engine Oil Level	11	Changing the Engine Oil Filter	30
Check the Cooling System	12	Changing the Engine Coolant	31
Check for Debris	13	Spark Plugs	32
Check the Safety Interlock System	14	Greasing and Lubrication	33
Check the Brake	14	Tire Pressure	34
Operation	15	Brake	35
Think Safety First	15	Fuel Tank	36
Controls	15	Fuel Filter	37
Parking Brake	15	Front Wheel Toe-In	37
Starting and Stopping the Engine	15	Transaxle Fluid	38
Operating the Power Take Off (PTO)	17	Fuse	40
The Safety Interlock System	17	Headlights	41
Gauges and Indicator Lights	19	Taillights	42
Driving Forward or Backward	20	Battery	42
Stopping the Machine	21	Cleaning and Storage	45
Re-centering the Steering Wheel	22	Wiring Diagram	47
		Wiring Diagram	48
		Troubleshooting	49

The enclosed Engine Owner's Manual is supplied for information regarding The U.S. Environmental Protection Agency (EPA) and the California Emission Control Regulation of emission systems, maintenance and warranty.

Keep this engine Owner's Manual with your unit. Should this engine Owner's Manual become damaged or illegible, replace immediately. Replacements may be ordered through the engine manufacturer.

Thank you so much for reading.
Please click the “Buy Now!”
button below to download the
complete manual.



After you pay.

You can download the most
perfect and complete manual in
the world immediately.

Our support email:

ebooklibonline@outlook.com