

m-4529

NEW HOLLAND 48" Snow Blade

OPERATOR'S MANUAL

For
LS Yard Tractors
Model No.
715648006 – TOS0001 & Up



Introduction

Thank you for purchasing a New Holland product.

All of us at New Holland want you to be completely satisfied with your new product, so feel free to contact your local Authorized Service Dealer for help with service, genuine replacement parts, or other information you may require.

Whenever you contact your Authorized Service Dealer or the factory, always know the model and serial numbers of your product. These numbers will help the Service Dealer or Service Representative provide exact information about your specific product. You will find the model and serial number plate located in a unique place on the product as shown below.

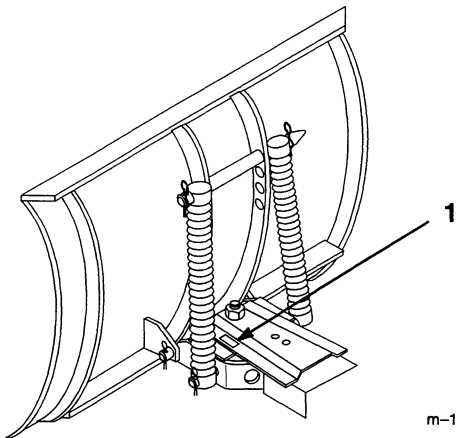

1. Model and Serial Number Plate

The warning system in this manual identifies potential hazards and has special safety messages that help you and others avoid personal injury, even death. **DANGER**, **WARNING** and **CAUTION** are signal words used to identify the level of hazard. However, regardless of the hazard, be extremely careful.

DANGER signals an extreme hazard that will cause serious injury or death if the recommended precautions are not followed.

WARNING signals a hazard that may cause serious injury or death if the recommended precautions are not followed.

CAUTION signals a hazard that may cause minor or moderate injury if the recommended precautions are not followed.

Two other words are also used to highlight information. "Important" calls attention to special mechanical information and "Note" emphasizes general information worthy of special attention.

The left and right side of the machine is determined by sitting on the seat in the normal operator's position.

For your convenience, write the product model and serial numbers in the space below.

 NEW HOLLAND	
MODEL NO.	SERIAL NO.
COMPONENT	
NEW HOLLAND NORTH AMERICA, INC.	
<small>MADE IN U.S.A.</small>	

Contents

	Page		Page
Installation	2	Maintenance	14
Loose Parts	2	Service Interval Chart	14
Assemble Blade	3	Greasing and Lubrication	15
Tractor Set-Up	4	Reversing the Scraper Blade	16
Installing Blade to Tractor	5	Storage	16
Removing the Blade	7		
Operation	9		
Attachment Power Lift	9		
Attachment Lift Lever	10		
Adjusting Dial-A-Height	10		
Adjusting Blade Index	11		
Adjusting Blade Trip Springs	11		
Tips for Using Snow Blade	12		

Installation

Loose Parts

Note: Use the chart below to identify parts used for assembly.

DESCRIPTION	QTY.	USE
Blade assembly	1	Assemble blade to frame
Rod	1	
Control rod	1	
Cotter pin 1/8 x 1" (25 mm)	2	
Frame assembly	1	
Bolt 3/4-16 x 3-3/4" (95 mm)	1	
Locknut 3/4"	1	
Front hitch assembly	1	Install front hitch to tractor
Carriage bolt 3/8-16 x 1" (25 mm)	4	
Locknut 3/8"	4	
Rear hitch assembly	1	Install rear hitch to tractor
Bolt 1/2-13 x 1-1/4" (32 mm)	3	
Locknut 1/2"	3	
Lift plate	1	Install lift plate and lift rod
Trunnion	1	
Lift rod	1	
Washer 9/16"	1	
Hairpin cotter-large	1	
Hairpin cotter-medium	1	
Spindle stop	2	Install steering spindle stop
Self tapping bolt 5/16-18 x 3/4" (19 mm)	2	
Index handle assembly	1	Assemble index handle and control rod to frame
Pivot bolt, 1/2-13 x 1" (25 mm)	1	
Jam nut, 1/2"	1	
Hairpin cotter-large	1	
Operator's Manual	1	Read before operating
Registration Card	1	Fill out and return to Toro

Assemble Blade

1. Lift and rotate channel and trip spring assembly so holes align with lower blade mounts. Slide rod through holes and secure with (2) 1/8 x 1" (25 mm) cotter pins (Fig. 1).

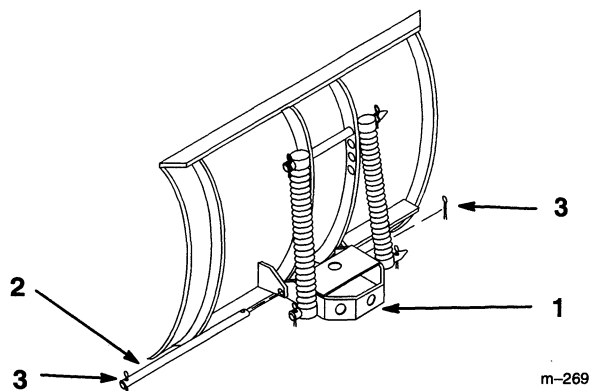

Figure 1

- | | |
|------------|--------------------------------|
| 1. Channel | 3. Cotter pin 1/8 x 1" (25 mm) |
| 2. Rod | |

2. Insert the control rod (end without the washer welded on) in 1/2" (13 mm) hole in bottom plate of channel. Secure control rod with a 1/8 x 1" (25 mm) cotter pin between plates (Fig. 2).

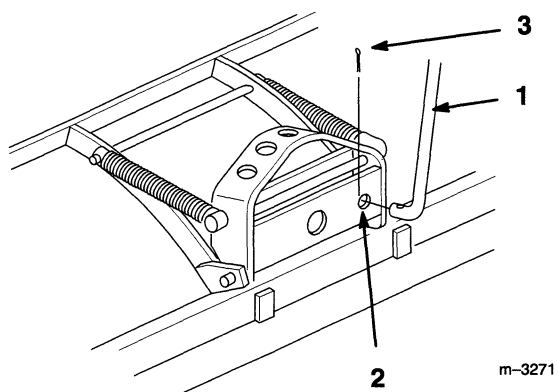

Figure 2

- | | |
|------------------------------|--------------------------|
| 1. Control rod | 3. Cotter pin 1" (25 mm) |
| 2. Channel-1/2" (13 mm) hole | |

3. Apply general purpose grease to the pivot area of frame and channel. Slide channel between frame mount and secure with 3/4-16 x 3-3/4" (95 mm) bolt, up from the bottom, and 3/4" locknut (Fig. 3).

IMPORTANT: Do not tighten nut and bolt excessively to cause binding on channel as it pivots side-to-side.

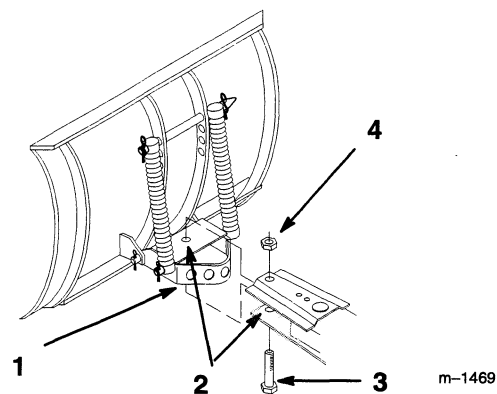

Figure 3

- | | |
|----------------|---------------------------------|
| 1. Channel | 3. Bolt 3/4-16 x 3-3/4" (95 mm) |
| 2. Grease here | 4. Locknut 3/4" |

Thank you so much for reading.
Please click the “Buy Now!”
button below to download the
complete manual.



After you pay.

You can download the most
perfect and complete manual in
the world immediately.

Our support email:

ebooklibonline@outlook.com