

# **NEW HOLLAND**

## **42in, 48in and 52in Mower**

# **OPERATOR'S MANUAL**

For  
MY Series Tractors  
Model No.

715698016—T04MF0001 & Up

715699016—T04MG0001 & Up

715700016—T04MH0001 & Up



**NEW HOLLAND**

**SERVICE**

# Contents

	<b>Page</b>
Introduction .....	2
Safety and Instruction Decals .....	3
Setup .....	4
Loose Parts .....	4
Installing the Grass Deflector on 42 and 48 inch Side Discharge Mowers .....	4
Installing the Grass Deflector on 52 inch Mowers ..	5
Installing the Mower .....	5
Checking the Side-to-Side Blade Cut .....	8
Adjusting the Side-to-Side Blade Cut .....	8
Checking the Front-to-Rear Blade Slope .....	8
Changing the Front-to-Rear Blade Slope .....	9
Transport Height Adjustment .....	9
Operation .....	10
Using the Side Discharge .....	10
Operating the Power Take Off (PTO) .....	10
Using the Attachment Power Lift .....	11
Operating the Attachment Lift Lever .....	11
Adjusting the Height of Cut .....	12
Removing the Mower .....	12
Tips for Mowing Grass .....	13
Maintenance .....	14
Recommended Maintenance Schedule .....	14
Servicing the Cutting Blades .....	14
Greasing and Lubrication .....	16
Removing the Hood .....	17
Servicing the Mower Belt .....	17
Replacing the Power Take Off (PTO) Belt .....	17
Replacing the Mower Drive Belt .....	18
Cleaning and Storage .....	18
Troubleshooting .....	19

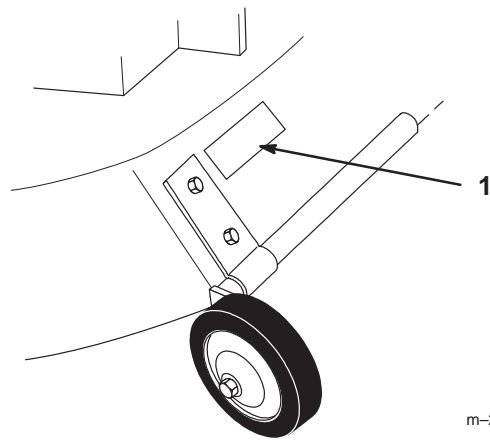

m-2828

**Figure 1**

1. Location of the model and serial numbers

Write the product model and serial numbers in the space below:

<b>Model No.</b> _____
<b>Serial No.</b> _____

This manual identifies potential hazards and has special safety messages that help you and others avoid personal injury and even death. **Danger**, **Warning**, and **Caution** are signal words used to identify the level of hazard. However, regardless of the hazard, be extremely careful.

**Danger** signals an extreme hazard that *will* cause serious injury or death if you do not follow the recommended precautions.

**Warning** signals a hazard that *may* cause serious injury or death if you do not follow the recommended precautions.

**Caution** signals a hazard that may cause minor or moderate injury if you do not follow the recommended precautions.

This manual uses two other words to highlight information.

**Important** calls attention to special mechanical information and **Note:** emphasizes general information worthy of special attention.

## Introduction

Read this manual carefully to learn how to operate and maintain your product properly. The information in this manual can help you and others avoid injury and product damage. Although New Holland designs and produces safe products, you are responsible for operating the product properly and safely.

Whenever you need service, genuine New Holland parts, or additional information, contact an Authorized Service Dealer or New Holland Customer Service and have the model and serial numbers of your product ready. Figure 1 illustrates the location of the model and serial numbers on the product.

# Safety and Instruction Decals



Safety decals and instructions are easily visible to the operator and are located near any area of potential danger. Replace any decal that is damaged or lost.



111655



TR93D1122



TR65D2690

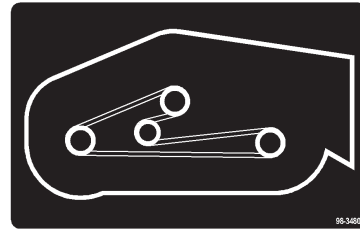

TR98D3480



TR92D7108

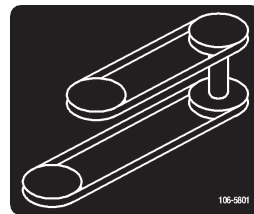

TR106D5801



TR92D7109



TR43D8480



# Setup

**Note:** Determine the left and right sides of the machine from the normal operating position.

## Loose Parts

**Note:** Use the chart below to identify parts used for assembly.

DESCRIPTION	QTY.	USE
Grass deflector	1	Installing the grass deflector on 42 and 48 inch side discharge mowers
Torsion spring	1	
Washer, 1/2 inch	1	
Cotter pin, 3/4 inch	1	
Plastic washer	2	
Rubber bushing	1	
Jam nut, 3/8 inch	1	
Grass deflector	1	Installing the grass deflector on 52 inch mowers
Spring	2	
Bolt, 3/8 x 3-1/2 inch	2	
Locknut, 3/8 inch	2	
Belt, PTO Drive	1	Installing the mower
Belt, Mower Drive	1	
Pulley box assembly	1	
Operator's Manual	1	Read before operating

Warning

An uncovered discharge opening could allow the lawn mower to throw objects in the operator's or bystander's direction and result in serious injury. Also, contact with the blade could occur.

- **Never remove the grass deflector from the mower because the grass deflector routes material down toward the turf. If the grass deflector is ever damaged, replace it immediately.**
- **Never put your hands or feet under the mower.**
- **Never try to clear discharge area or mower blades unless you move the power take off (PTO) to *Off* and rotate the ignition key to *Off*. Also remove the key and pull the wire off the spark plug(s).**

## Installing the Grass Deflector on 42 and 48 inch Side Discharge Mowers

1. Locate items shown in Figure 2.
2. Place the straight end of the spring into the small hole in the discharge chute (Fig. 2).
3. Position the spring and discharge chute over post on rear of deck and secure with a washer (1/2 inch) and a cotter pin (3/4 inch) (Fig. 2).
4. Slide the rubber bushing and plastic washer over the stud at the front of mower.
5. Place the discharge chute over the stud and secure it with a plastic washer and jam nut (3/8 inch) (Fig. 2).

**Important** Grass deflector must be spring loaded in the down position. Lift deflector up to test that it snaps to the full down position.

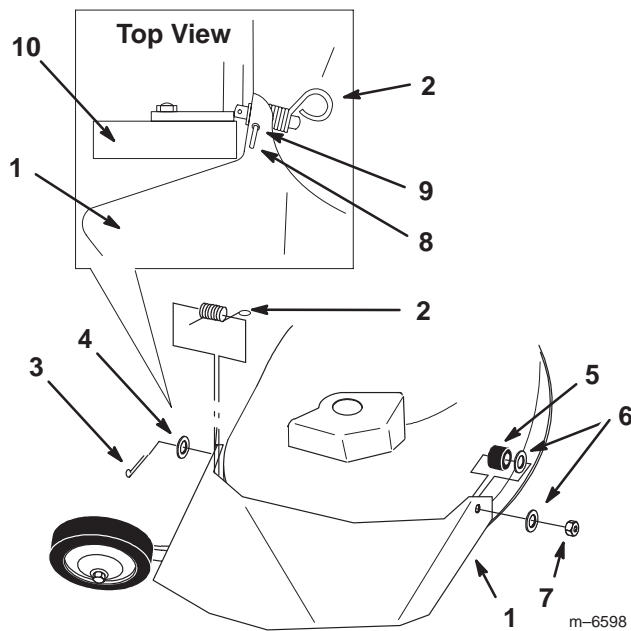

**Figure 2**

- |                         |                                  |
|-------------------------|----------------------------------|
| 1. Discharge chute      | 7. Jam nut, 3/8 inch             |
| 2. Spring               | 8. Straight end of spring        |
| 3. Cotter pin, 3/4 inch | 9. Small hole in discharge chute |
| 4. Washer, 1/2 inch     | 10. Wheel                        |
| 5. Rubber bushing       |                                  |
| 6. Plastic washer       |                                  |

## Installing the Grass Deflector on 52 inch Mowers

1. Place the springs into the brackets on mower with the hooked ends over the raised back (Fig. 3).
2. Align the grass deflector with the holes in the brackets and the spring straight end in the space under the hinge and above the deflector (Fig. 3).
3. Secure the deflector to the bracket with 2 bolts (3/8 x 3-1/2 inch) and 2 locknuts (3/8 inch) (Fig. 3).
4. Lift grass deflector and check that it is spring loaded and pivots freely to the full down position.

**Important** Grass deflector must be spring loaded in the down position. Lift the deflector up to test that it snaps down to the full down position.

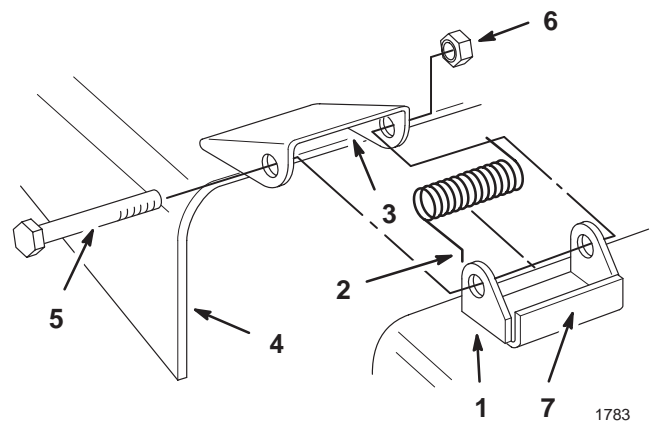
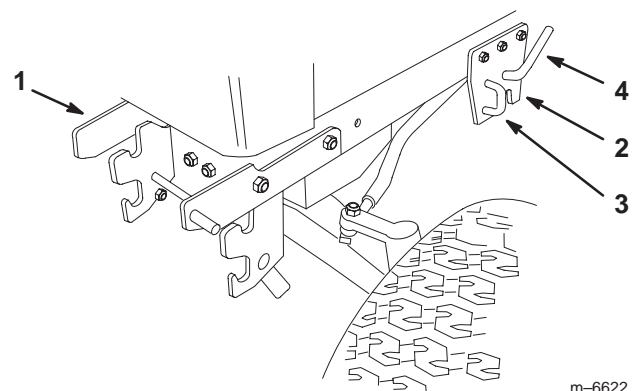

**Figure 3**

- |                     |                         |
|---------------------|-------------------------|
| 1. Bracket          | 5. Bolt, 3/8–3-1/2 inch |
| 2. Spring hook end  | 6. Lock nut, 3/8 inch   |
| 3. space for spring | 7. Raised back          |
| 4. Grass deflector  |                         |

## Installing the Mower

1. Disengage the PTO and set the parking brake.
2. Stop the engine, remove the key, and wait for all moving parts to stop before leaving the operating position.
3. Position the mower on the right side of the tractor.
4. Turn the front wheels fully to the left and raise attachment lift lever or electric lift all the way up. Refer to the tractor *Operator's Manual*.
5. Open the mid-mount hitch by pulling out the J-pin and moving the lock handle rearward (Fig. 4).



**Figure 4**

- |                    |                |
|--------------------|----------------|
| 1. Front hitch     | 3. J-pin       |
| 2. Mid-mount hitch | 4. Lock handle |

Thank you so much for reading.  
Please click the “Buy Now!”  
button below to download the  
complete manual.



After you pay.

You can download the most  
perfect and complete manual in  
the world immediately.

Our support email:

[ebooklibonline@outlook.com](mailto:ebooklibonline@outlook.com)