

# **NEW HOLLAND**

## **48in Snow/Dozer Blade**

# **OPERATOR'S MANUAL**

For MY Series Tractors  
Model No.  
716506016—T04ML0001 & Up



# Contents

	Page
Introduction .....	2
Setup .....	3
Loose Parts .....	3
Assembling the Blade .....	4
Removing the Pulley Box .....	4
Modifying the Front Hitch .....	5
Installing the Rear Hitch .....	5
Installing the Dozer Extension onto the Frame ...	5
Installing the Blade Assembly .....	5
Installing the Anti-sway Bar .....	6
Installing the Control Handle .....	7
Removing the Blade .....	8
Operation .....	8
Operating the Attachment Power Lift .....	8
Operating the Attachment Lift Lever .....	9
Adjusting the Blade Angle .....	9
Adjusting the Blade Trip Springs .....	9
Tips for Using the Blade .....	10
Maintenance .....	10
Recommended Maintenance Schedule .....	10
Greasing and Lubricating the Blade .....	10
Reversing the Scraper .....	11
Cleaning and Storing the Blade .....	11

## Introduction

Read this manual carefully to learn how to operate and maintain your product properly. The information in this manual can help you and others avoid injury and product damage. Although New Holland designs and produces safe products, you are responsible for operating the product properly and safely.

Whenever you need service, genuine New Holland parts, or additional information, contact an Authorized Service Dealer or New Holland Customer Service and have the

model and serial numbers of your product ready. Figure 1 illustrates the location of the model and serial numbers on the product.

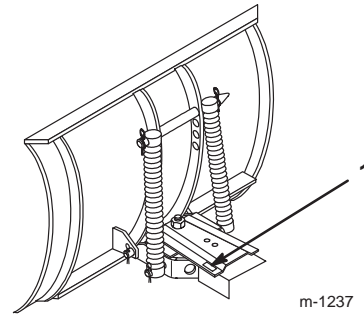

**Figure 1**

1. Model and serial number plate

Write the model and product identification numbers in the space below:

<p><b>Model No.</b> _____</p> <p><b>Product ID No.</b> _____</p>
--

This manual identifies potential hazards and has special safety messages that help you and others avoid personal injury and even death. **Danger**, **Warning**, and **Caution** are signal words used to identify the level of hazard. However, regardless of the hazard, be extremely careful.

**Danger** signals an extreme hazard that **will** cause serious injury or death if you do not follow the recommended precautions.

**Warning** signals a hazard that **may** cause serious injury or death if you do not follow the recommended precautions.

**Caution** signals a hazard that may cause minor or moderate injury if you do not follow the recommended precautions.

This manual uses 2 other words to highlight information.

**Important** calls attention to special mechanical information and **Note:** emphasizes general information worthy of special attention.

# Setup

## Loose Parts

**Note:** Use the chart below to identify parts used for assembly.

Description	Qty.	Use
Blade assembly	1	Assembling the blade
Rod	1	
Control rod	1	
Cotter pins, 1/8 x 1 inch	3	
Frame	1	
Bolt, 3/4 x 3-3/4 inch	1	
Locknut, 3/4 inch	1	
Catch assembly	1	Modifying the front hitch
Stop rod, 5/16 inch	1	
Push nut	1	
Hairpin cotter	1	
Locknuts, 5/16 inch	2	
Dozer extension	1	Installing the dozer extension onto the frame
Shaft	1	
Hairpin cotters	2	
Anti-sway bar assembly	1	Installing the anti-sway bar
Lift channel and channel plate	1	Installing the blade assembly
Lift link	1	
Hairpin cotters	2	
Locknut, 3/8 inch	1	
Bolt, 3/8 x 1 inch	1	
Clevis pins, 3/8 x 7/8 inch	2	
Control handle assembly	1	Installing the control handle
Pivot bolt, 1/2 x 1 inch	1	
Jam nut, 1/2 inch	1	
Hairpin cotter, large	1	
Cable clips	3	
Bolts, 1/4 x 1 inch	3	
Locknuts, 1/4	3	
Cable	1	
Cable bracket	1	
Cotter pin, 1-1/4 inch	1	

# Assembling the Blade

1. Lift and rotate the channel and trip spring assembly so that the holes align with the lower blade mounts (Fig. 2).

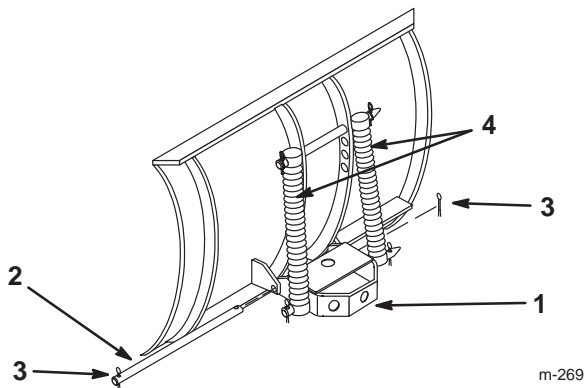

**Figure 2**

- |            |                             |
|------------|-----------------------------|
| 1. Channel | 3. Cotter pin, 1/8 x 1 inch |
| 2. Rod     | 4. Trip spring assembly     |

2. Slide the rod through the holes and secure it with 2 cotter pins (1 inch) as shown in Figure 2.

**Note:** If you have difficulty sliding the rod through the holes, partially remove the upper rod and use a hammer to drive the rod through. Then install the upper rod.

3. Bend the ends of the cotter pins to secure the rod.
4. Insert the end of the control rod without the welded washer through the 1/2-inch hole in the bottom plate of the channel (Fig. 3).

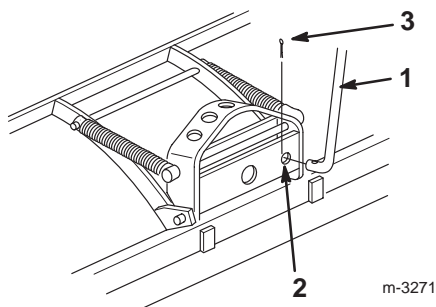
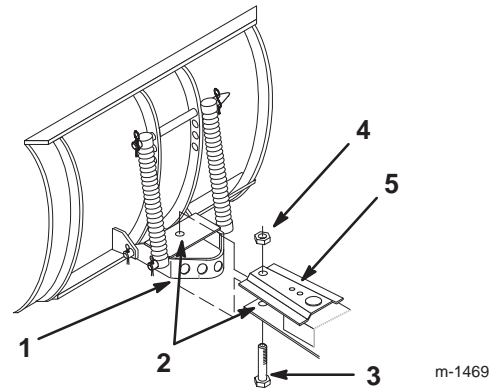

**Figure 3**

- |                  |                             |
|------------------|-----------------------------|
| 1. Control rod   | 3. Cotter pin, 1/8 x 1 inch |
| 2. 1/2-inch hole |                             |

5. Insert a cotter pin (1/8 x 1 inch) through the hole in the rod and bend the ends of the pin (Fig. 3).

6. Apply general-purpose grease to the pivot area of the frame and channel (Fig. 4).



**Figure 4**

- |                           |                      |
|---------------------------|----------------------|
| 1. Channel                | 4. Locknut, 3/4 inch |
| 2. Grease here            | 5. Frame mount       |
| 3. Bolt, 3/4 x 3-3/4 inch |                      |

7. Slide the channel into the frame mount and secure it with a bolt (3/4 x 3-3/4 inch) and a locknut (3/4 inch) as shown in Figure 4.

**Note:** Insert the bolt from the underside of the frame mount as shown in Figure 4.

**Important** Do not tighten the locknut and bolt excessively.

## Removing the Pulley Box

If the pulley box is installed on the tractor, remove it.

1. Turn the knobs to loosen the belts on the idler pulleys (Fig. 5).

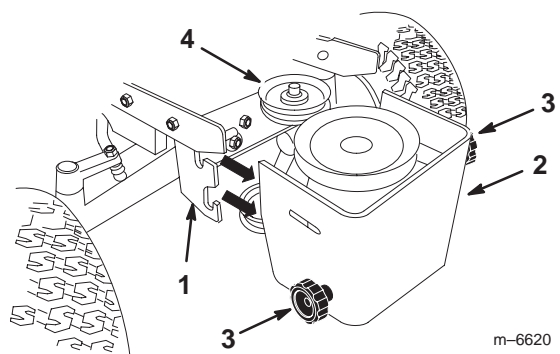

**Figure 5**

- |                |                     |
|----------------|---------------------|
| 1. Front hitch | 3. Knob             |
| 2. Pulley box  | 4. Idler pulley (2) |

2. Remove the PTO belt from the upper pulley and the mower drive belt from the lower pulley.

Thank you so much for reading.  
Please click the “Buy Now!”  
button below to download the  
complete manual.



After you pay.

You can download the most  
perfect and complete manual in  
the world immediately.

Our support email:

[ebooklibonline@outlook.com](mailto:ebooklibonline@outlook.com)