David Brown®

Supplement to Manual
for Operators of
Low Profile Q-Cab
Tractors

Pub 9-5769 March 1979

Written In *Clear
And
Simple
English*

David Brown Tractors Ltd

A Tenneco Company

Affiliate of J I Case

CONTENTS

Page

INTRODUCTION	1
LEVER FOR PTO CLUTCH	1
RANGE LEVER	2
GEAR LEVER	2
THROTTLE PEDAL	2
WINDOWS	3
LEVELLING LEVER	3
CONTROLS IN ROOF PANEL	4
TO REMOVE TOP SECTION OF CAB	5
LIGHTING EQUIPMENT	7
WIRING HARNESS	8

INTRODUCTION

Use this supplement with the Manual for Operators of Q-cab tractors. This supplement gives details of controls and instructions for operating where these are different from the Q-cab. Read this supplement first. See the Q-cab manual for all other information.

Lever for PTO Clutch

1. To disengage the PTO clutch, pull up lever B until release lever C engages.
2. To engage the PTO clutch, pull up lever B, press release lever C and push down lever B.

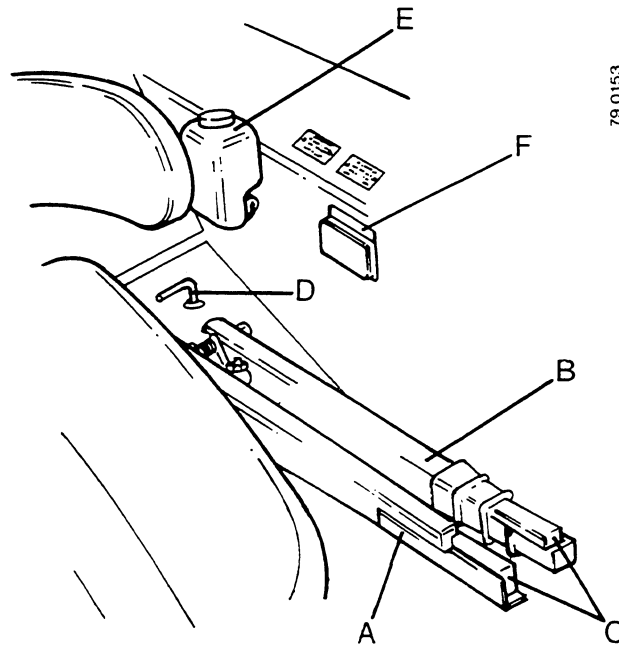

FIGURE 1. PARKING BRAKE AND PTO CLUTCH LEVER

- | | |
|----------------------------|------------------------------------|
| A. Lever for Parking Brake | D. Lift Latch |
| B. Lever for PTO Clutch | E. Reservoir for Windscreen Washer |
| C. Release Lever | F. Ash Tray |

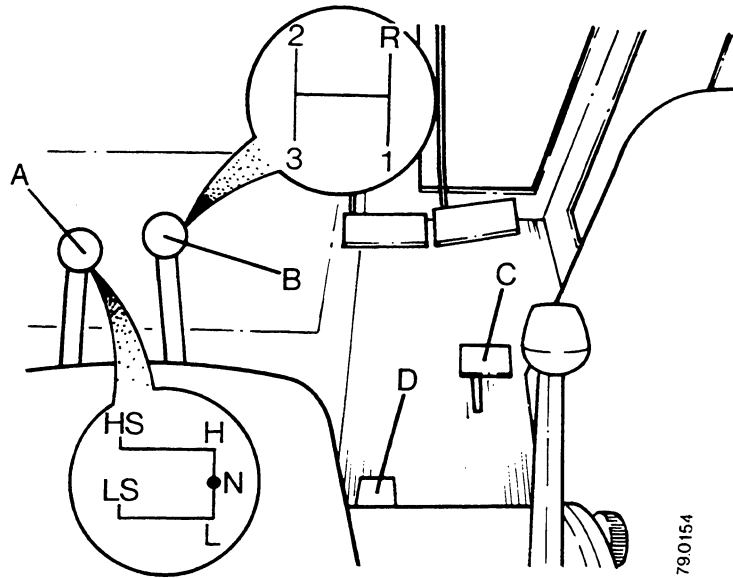

FIGURE 2. GEAR LEVERS AND THROTTLE PEDAL

- | | |
|----------------|--------------------------------|
| A. Range Lever | C. Throttle Pedal |
| B. Gear Lever | D. Pedal for Differential Lock |

A. Range Lever

There are four ranges in the gearbox which can be selected by moving lever A. The ranges are, high (H), low (L), high-slow (HS) and low-slow (LS). The range lever must be in the neutral (N) position when the tractor is stationary for belt pulley or PTO work.

B. Gear Lever

The gear lever B is used to select any one of three forward and one reverse gears. When used with the range lever, you can select any of twelve forward and four reverse gears.

C. Throttle Pedal

The throttle pedal C is used to control engine speed. Before using the throttle pedal on the highway you must put the throttle hand lever to the idling position.

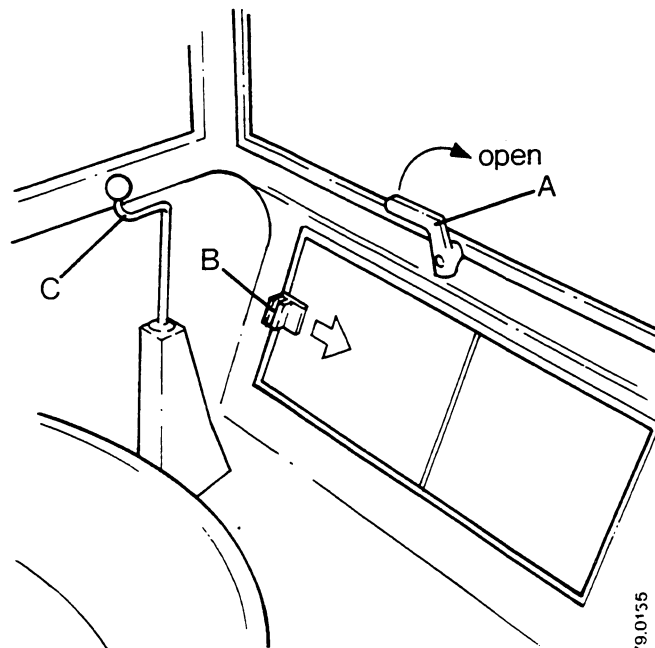

79.0156

FIGURE 3. REAR OF CAB (INTERNAL)

- A. *Handle for Rear Window*
- B. *Sliding Window*
- C. *Levelling Lever*

Windows

Sliding windows are fitted on both sides of the cab and on the rear panel. The rear window has two hinges at the top. To open the window, turn the handle A clockwise. Two damper struts are used as supports for the rear window in any open position.

Levelling Lever

Adjust the levelling lever by turning handle C. Turn the handle clockwise to raise the link.

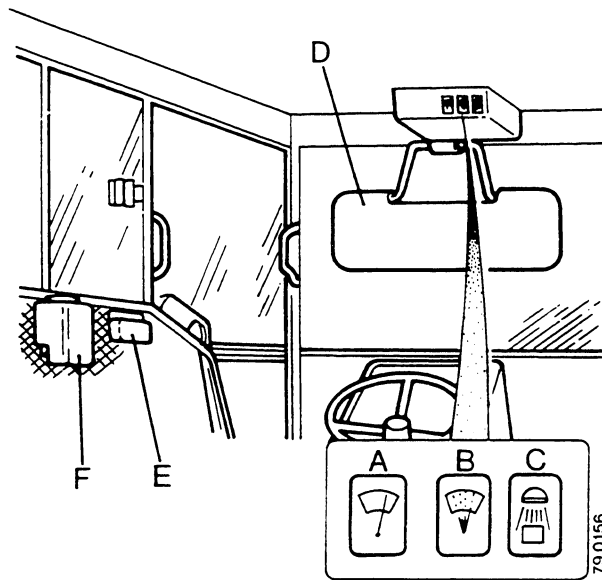

FIGURE 4. CONTROLS AND EQUIPMENT

- | | |
|---------------------------------|------------------------------------|
| A. Switch for Wiper | D. Sun Visor |
| B. Switch for Windscreen Washer | E. Ash Tray |
| C. Switch for Plough Light | F. Reservoir for Windscreen Washer |

CONTROLS IN ROOF PANEL

A. Switch for Windscreen Wiper

Push down the switch A to actuate the windscreen wiper. Push switch A up to stop the windscreen wiper. Do not use the wiper on a dry windscreen.

B. Switch for Windscreen Washer

Push down the switch B to wash the windscreen then actuate the windscreen wiper. Release the switch B to stop the windscreen washer. The reservoir for the windscreen washer is fitted on the left-hand fender inside the cab. Fill the reservoir with clean water.

NOTE: Do not put anti-freeze in the reservoir. Use an approved windscreen additive.

C. Switch for Plough Light

Push down switch C to illuminate the plough light. The switch has an indicator light which illuminates when the plough light is on. Push the switch C up to extinguish the plough light.

D. Sun Visor

The sun visor is fitted on an adjustable hinge. Remove the plastic cover to tighten or loosen the clamp.

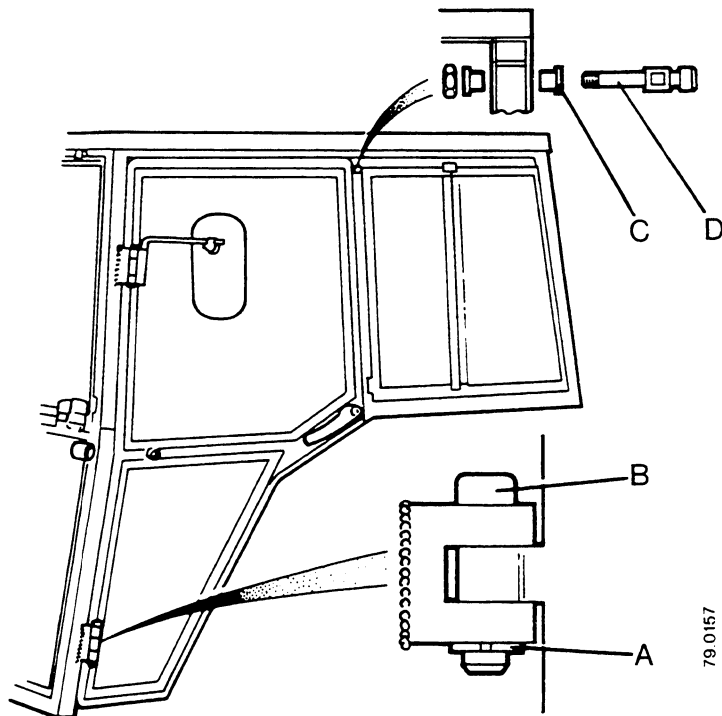

FIGURE 5. REMOVAL OF CAB DOORS

- | | |
|--------------|-----------------|
| A. Circlip | C. Plastic Plug |
| B. Hinge Pin | D. Lifting Bolt |

TO REMOVE TOP SECTION OF THE CAB

1. Remove circlip A from the hinge pin on the top and bottom hinges. (See Figure 5).
2. Pull out the hinge pins B.
3. Remove the door and store in a dry building.
4. Repeat operations 1, 2 and 3 for the other door.
5. Remove the plastic plugs C from the cab frame.
6. Fit the lifting bolts D (one each side) and hold in position with the nuts.
7. Fit a hoist to the lifting bolts.

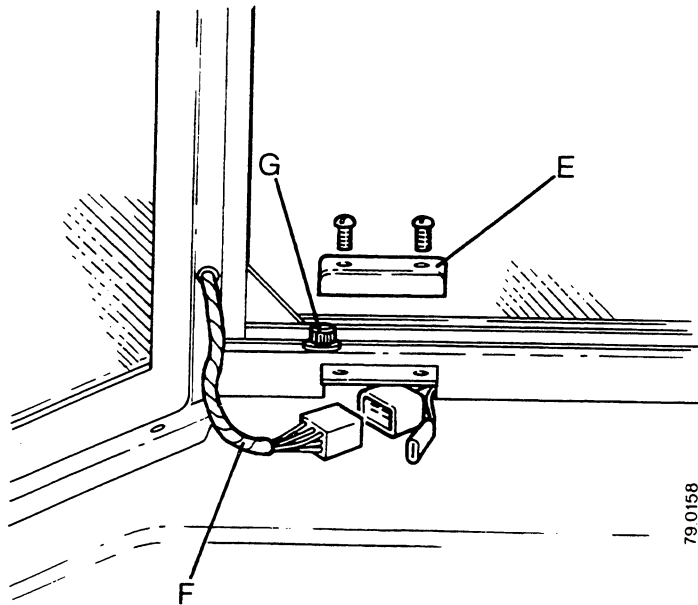

FIGURE 6. ELECTRICAL CONNECTOR

E. Cover
F. Wiring Harness
G. Setscrew

8. Remove the two setscrews and cover E from the housing for the electrical connection on the right-hand fender (See Figure 6).
9. Separate the electrical connection.
10. Pull the wiring harness F clear of the housing then install the cover and setscrews.
11. Remove the eight setscrews G which hold the top section of the cab in position (See Figure 7).
12. Lift top section of the cab clear of the tractor.
13. Move the tractor away.
14. Lower the top section of the cab to the ground and remove the hoist. Store with the cab doors.

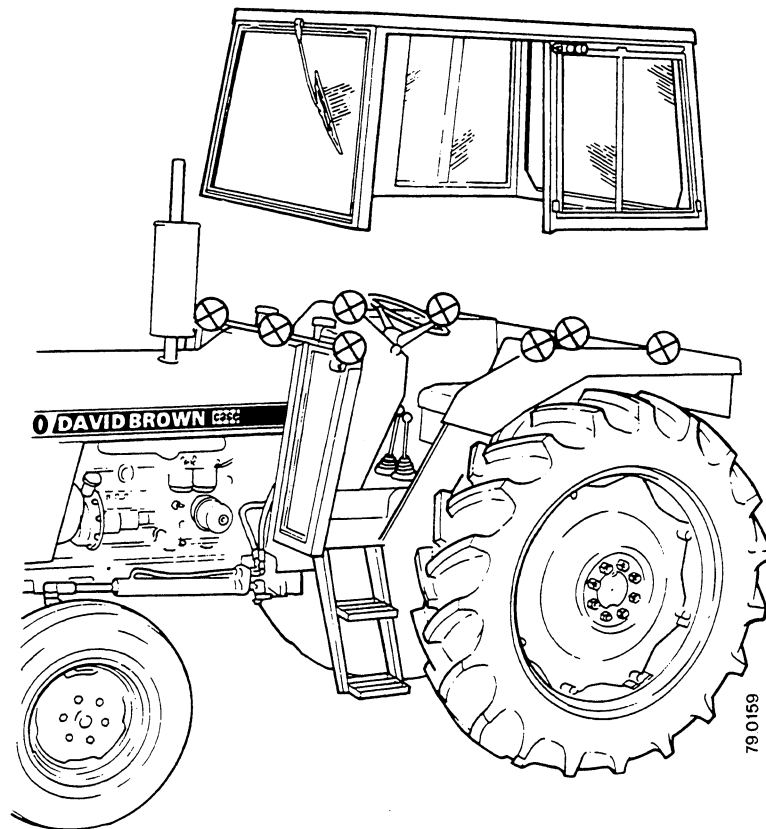

FIGURE 7. TOP SECTION OF CAB REMOVED

⊕ Position of Setscrews

LIGHTING EQUIPMENT

LIGHT	BULB
Plough Light	12V 55W Halogen
Side Light	12V 5W Festoon 11mm
Direction Indicator	12V 12W ASCC 25mm

Buy Now



Our support email:

ebooklibonline@outlook.com