

Page Title	Page Number
ENGINE AND ACCESSORIES	3
ALTERNATOR	7
GENERATOR	8
STARTER	11
STARTER	12
STARTER	16
STARTER	19
	20
	23
TANK	24
FUEL FILTER	27
DRY AIR CLEANER - LAUTRETTE	28
CLUTCH - 10/12	31
CLUTCH - 12	32
TRANSMISSION HOUSING	35
SELECTOR MECHANISM	36
SELECTOR MECHANISM	39
	39D
8 SPEED GEAR BOX	40
TRANSMISSION - MULTI-POWER	44
MULTI-POWER SHIFT CONTROL	48
	51
MULTI - POWER PIPE	51A
	51D
	51E
INDEPENDENT P.T.O., PIPES WITH AUXILIARY HYDRAULIC	51H
INDEPENDENT P.T.O., PIPES, NORMAL CONTROLS AND TRANSMISSION	51I
	51L
MULTI-POWER PUMP AND DRIVE	52
HYDRAULIC PIPE	55
POWER TAKE OFF	56
INDEPENDENT P.T.O.	57B
CLUTCH AND VALVE, INDEPENDENT PTO	59
CENTRE AXLE HOUSING	60
DIFFERENTIAL	63
DIFFERENTIAL LOCK	67
DIFFERENTIAL LOCK	68
REAR AXLE HOUSING	71
REAR AXLE HOUSING	75
REAR AXLE HOUSING	76
BRAKES	79
BRAKE (GERMANY)	80
HANDBRAKE (GERMANY)	83
	87
	91
HYDRAULIC PIPE, TRAILER BRAKING	91A
BRAKE HYDRAULIC CONTROL VALVE	91D
CONTROL CYLINDER	91E
WHEELS	93
POWER ASSISTED VARIABLE TREADWHEELS	93A
FRONT AXLE	95
STEERING	99
HOOD	103

TABLE OF CONTENT

GRILL	104
RADIATOR	108
INSTRUMENT PANEL AND INSTRUMENTS	111
SEAT - SABLE	112
SEAT	113B
FOOTSTEP	115
	116
	119
	119A
	119E
EXHAUST SYSTEM	120
THROTTLE CONTROLS	123
	124
SPEED LIMITATION - GERMANY	127
LIGHTING EQUIPMENT - FRANCE	128
HEAD LAMP - TAIL LAMP - FRANCE	131
LIGHTING EQUIPMENT - GERMANY	135
LIGHTING EQUIPMENT	137B
HEAD LAMP - TAIL LAMP - FRANCE	137F
HEAD LAMP - TAIL LAMP - GERMANY	139
LIGHTING EQUIPMENT	143
HEAD LAMP - TAIL LAMP	144
	148
LIFT ARMS	151
RESPONSE CONTROLS - PRESSURE CONTROL	155
HYDRAULIC PUMP	159
DRAFT CONTROL	164
DRAFT CONTROL	168
LINKAGE	171
LINKAGE	176
- GERMANY	177C
TOWING HOOK	179

MOTEUR ET ACCESSOIRES  
MOTOR UND ZUBEHOER  
MOTOR ED ACCESSORI

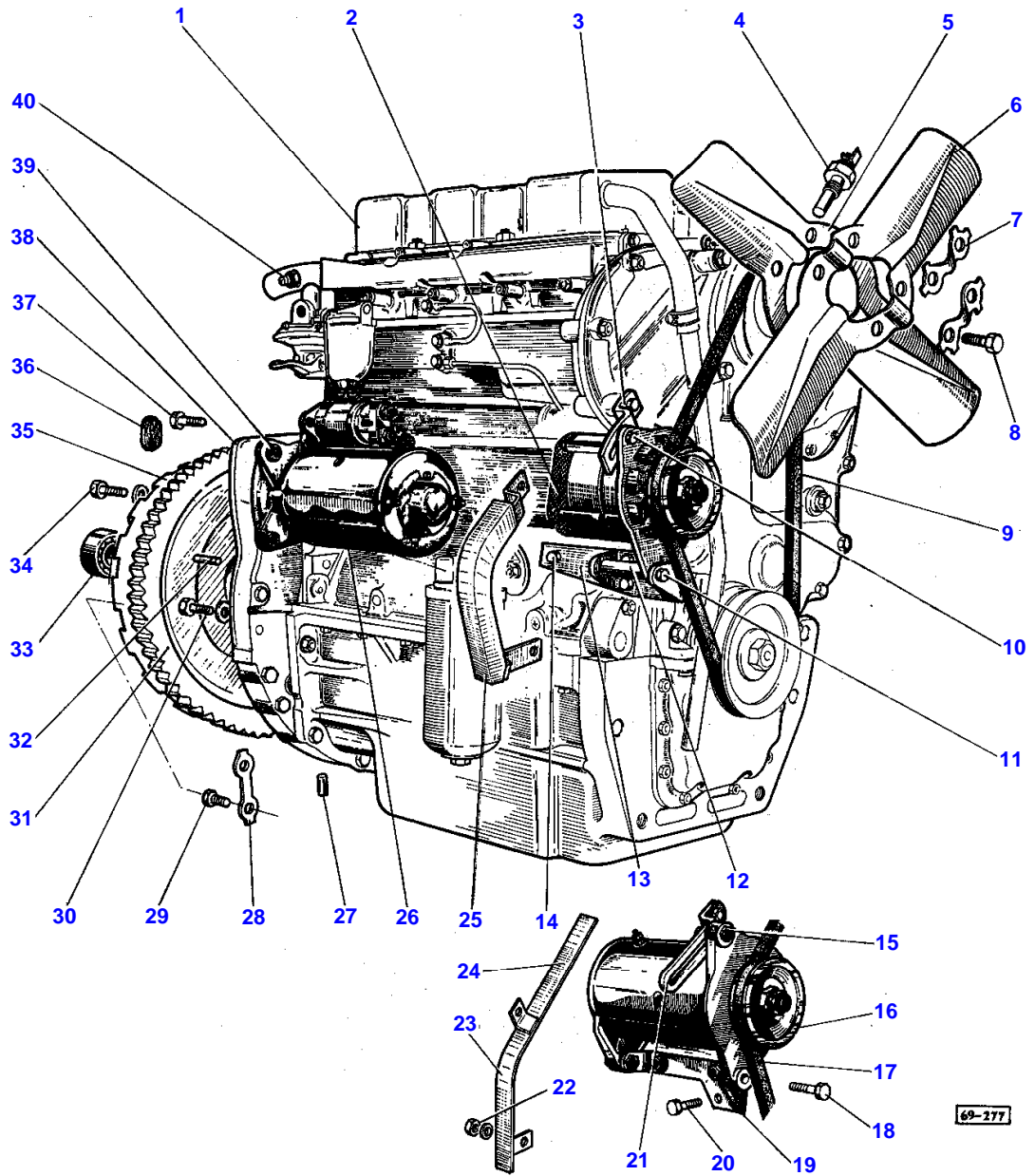

## ENGINE AND ACCESSORIES

Item	Part Number	Qty	Description	Comments
1	906515M1	1	Engine	(A)
	906754M1	1	Engine	(B)
2	906055M2	1	Alternator	(D)
3	906021M1	1	Lever	(M)
	354612X1	1	Screw	
	353755X1	1	Washer	
	960959M1	1	Spacer	
	909316M1	1	Lever	(N)
	354619X1	1	Bolt Unc	
	353755X1	1	Washer	
	909591M1	1	Spacer	
4	963418M1	1	Thermometer	
5	963929M1	1	Blade Fan	
6	963930M1	1	Blade Fan	
7	897057M1	2	Brake	
8	361444X1	4	Screw	
9	960972M1	1	Belt	(M)
	909319M1	1	Belt	(N)
10	353521X1	1	Bolt Unf	
	353755X1	1	Washer	
	353446X1	1	Lock Washer	
	353916X1	1	Nut Unf	
11	339582X1	1	Bolt Metric	
	339376X1	1	Lock Washer	
	339402X1	1	Nut Metric	
12	906513M1	1	Spacer	
13	906497M1	1	Support	(M)
	909640M91	1	Bearer	(N)
	353521X1	1	Bolt Unf	
14	353523X1	1	Bolt Unf	
	353683X1	2	Bolt Unc	
	353446X1	3	Lock Washer	
15	353677X1	1	Screw Unc	(A) (G) (H)
	353681X1	1	Bolt Unc	(B) (G) (H)
	353755X1	1	Washer	(G) (H)
	1650484M1	1	Washer	(G) (H)
16	960028M1	1	Pulley	(G) (H)
17	962184M1	1	Belt	(G) (H)
18	353521X1	2	Bolt Unf	(G) (H)
	353916X1	2	Nut Unf	(G) (H)
	1650484M1	2	Washer	(G) (H)
19	962182M1	1	Bearer	(G) (H)
20	353679X1	2	Screw Unc	(G) (H)
	353518X1	1	Screw Unf	(G) (H)
	375703X1	3	Washer	(G) (H)
	1650484M1	3	Washer	(G)
21	962183M1	1	Lever	(G) (H)
	354122X1	1	Nut	(B) (G) (H)
	1650484M1	1	Washer	(B) (G) (H)
23	907500M91	1	Cowl	(B) (G) (H)
24	897104M92	1	Dynamo	(G) (H) (I)
25	907292M91	1	Cowl	
26	968296M1	1	Startermotor	(C) (E)
	968856M1	1	Startermotor	(C) (F)
	897336M1	1	Startermotor	(G) (K)
	964382M1	1	Startermotor	(J) (H) (L)
27	354074X1	1	Pin	
28	731192M1	3	Tab Washer	
29	375763X1	6	Screw	
30	358005X1	2	Screw	
31	731008M1	1	Annular Gear	
32	731344M1	2	Dowel	
33	828123M1	1	Bearing Assy	
34	353338X1	6	Screw	
	1650486M1	6	Washer	
35	738471M91	1	Handwheel	COMP. NO. 31
36	732902M1	1	Plug	
37	362479X1	2	Screw	
38	733633M1	1	Plate	
39	361773X1	1	Screw	

ENGINE AND ACCESSORIES

Item	Part Number	Qty	Description	Comments
	363625X1	1	Nut	
	376721X1	3	Washer	(C)
	353432X1	3	Lock Washer	(C)
	362501X1	2	Screw	
40	893501M1	1	Intake Heater	(A) WITHOUT SPEED LIMITATION (B) WITH SPEED LIMITATION (C) Alternative (D) See Page - Reference Number 3 (E) See Page - Reference Number 7 (F) See Page - Reference Number 8 (G)  (H)  (I) See Page - Reference Number (J)  (K) See Page - Reference Number (L) See Page - Reference Number

ALTERNATEUR  
DREHSTROMGENERATOR } 75 973 PARIS-RHONE 906 055 M1  
ALTERNATORE

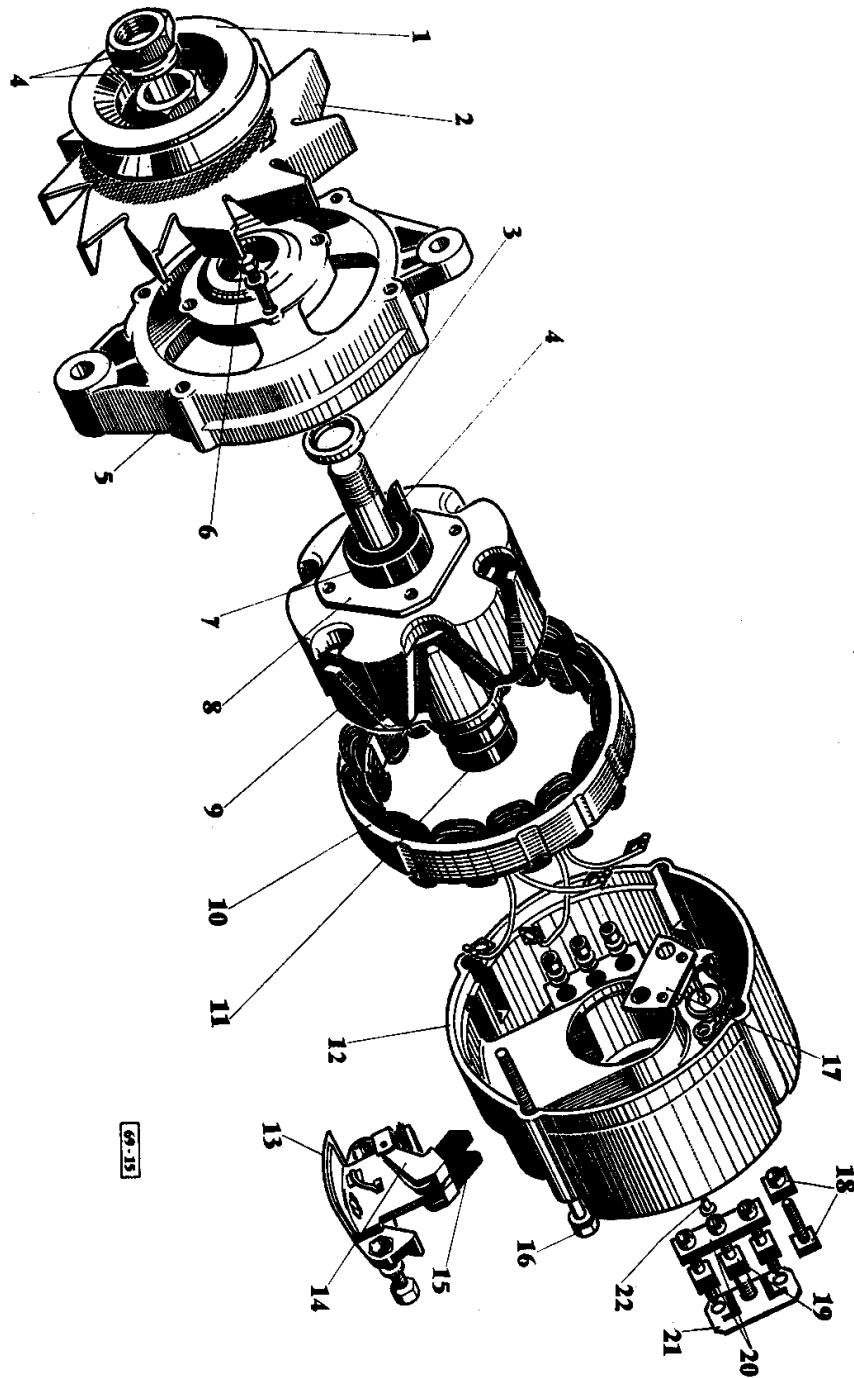

69-15

ALTERNATOR

Item	Part Number	Qty	Description	Comments
1	1805502M1	1	Pulley	
2	1805503M1	1	Fan	
3	1805504M1	1	Spacer	
4	1805505M1	1	Pulley	
5	1805506M1	1	Bearing Carrier	COMP. NO. 6, 7, 8
	1805507M1	1	Bearing Carrier	
6	1805509M1	1	Screw	
7	29963X	1	Bearing	
8	1805508M1	1	Washer	
9	1805511M1	1	Rotor	
10	1805512M1	1	Stator	
11	1805525M1	1	Bearing Assy	
12	1805513M91	1	Bearing Carrier	COMP. NO. 13, 14, 15, 17 A 21
	1805514M1	1	Bearing Carrier	
13	1805515M1	1	Bearer	COMP. NO. 14, 15
14	1805516M1	1	Holder	
15	1805517M1	2	Brush	
	1805518M1	1	Brush	
16	1805510M1	1	Screw	
17	1805519M1	1	Condenser	
18	1805520M1	2	Connection	Diameter 5
19	1805521M1	1	Connection	Diameter 6
20	1805522M1	1	Bearer	
21	1805523M1	1	Fuse	
22	1805524M1	1	Plug	
23	1805526M1	1	Regulator	(N-I) (N-I) NOT ILLUSTRATED

8

DYNAMO  
LICHTMASCHINE  
DINAMO

C 40 A - 22780 A/B "LUCAS"  
897 104 M92

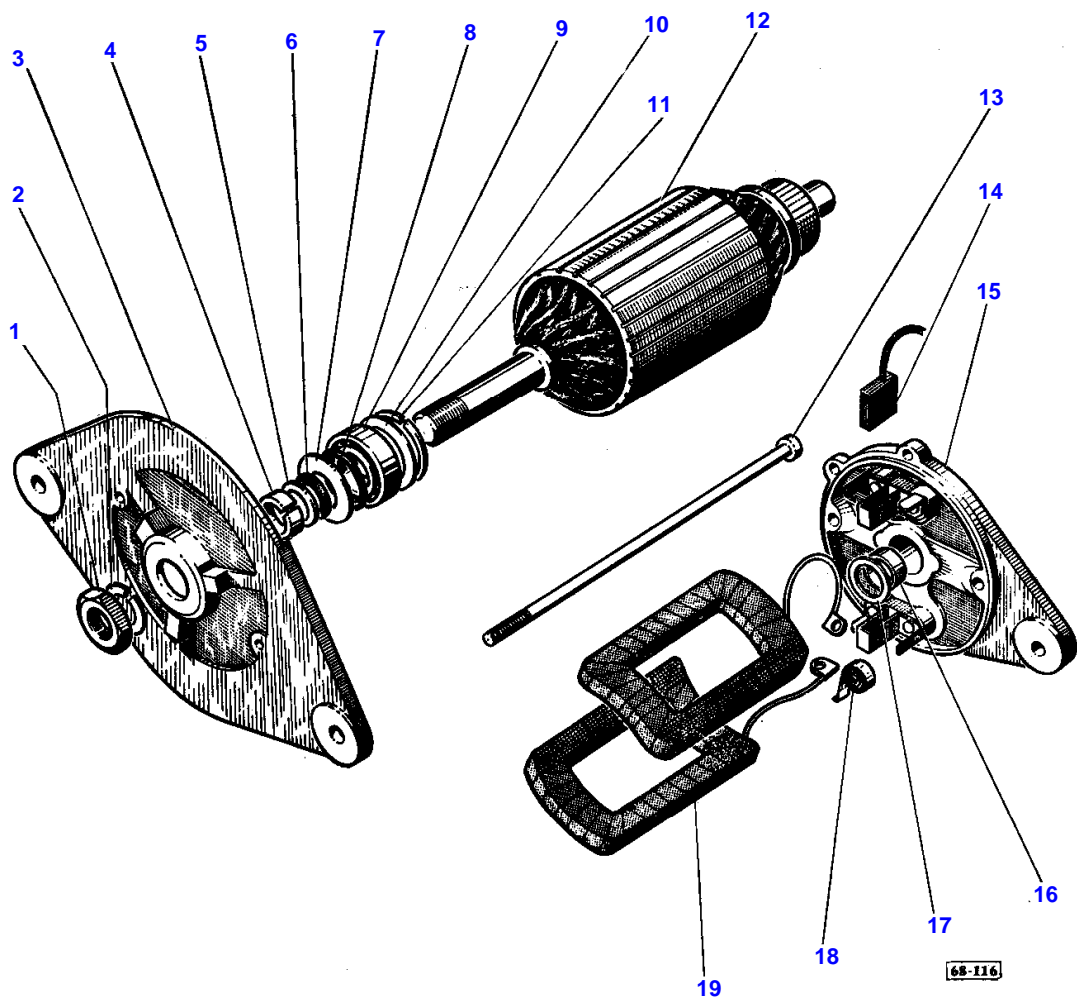



**MASSEY FERGUSON****MF 155 TRACTOR, ->| - 957469**

957469

**GENERATOR**

8

Item	Part Number	Qty	Description	Comments
1	353426X1	1	Nut Unf	
2	353432X1	1	Lock Washer	
3	1635579M91	1	Bearing Carrier	COMP. 6, 7, 8, 10, 11
4	1024389M1	1	Bush	
5	1016011M1	1	Washer	
6	1635583M1	1	Washer	
7	1635580M1	1	Washer	
8	1635584M1	1	Seal	
9	1440485X1	1	Bearing Ball	
10	1635582M1	1	Washer	
11	1635581M1	1	Clip	
12	1024026M1	1	Armature	
13	1016014M1	2	Screw	
14	1024034M1	2	Brush	
15	1806157M91	1	Bearing Carrier	COMP. NO. 16, 18
	1024035M1	1	Greaser	
	1016004M1	1	Plug	
16	829969M1	1	Bush	
17	1016007M1	1	Washer	
18	1024029M91	2	Spring	
19	1024027M91	2	Inductor	COMP. NO. 1024033M91
	1024033M91	2	Terminal	NOT ILLUSTRATED
	1024036M91	1	Parts Pack	

DÉMARREUR  
ANLASSER  
MOTORINO } BOSCH 964 382 M1

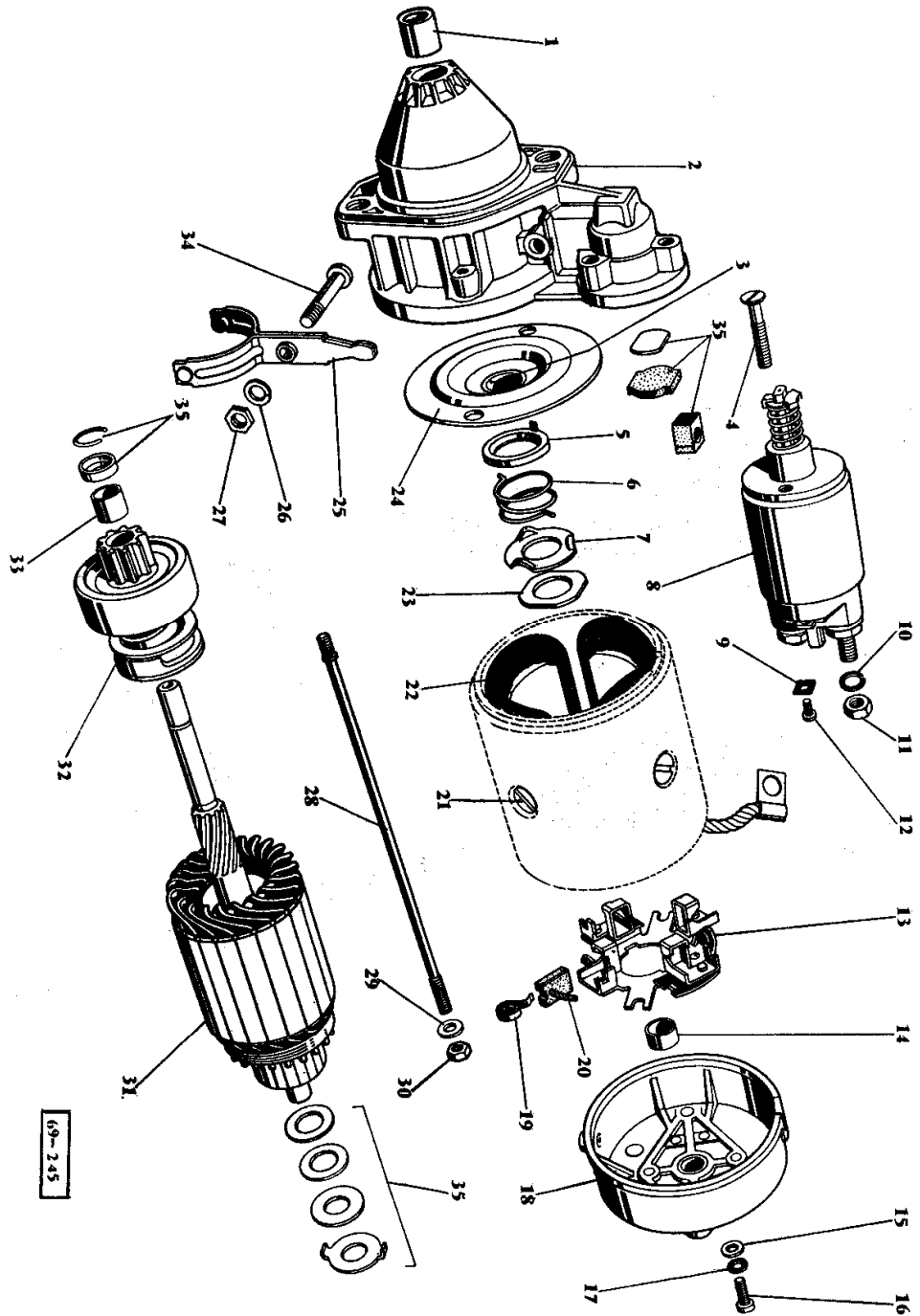

68-245

STARTER

Item	Part Number	Qty	Description
1	1805674M1	1	Bearing
2	1805675M91	1	Bearing Carrier
3	1805681M1	1	Bearing
4	1805697M1	3	Bolt
5	1805686M1	1	F.W.Metric Bulk
6	1805685M1	1	Spring
7	1805684M1	1	F.W.Metric Bulk
8	1805689M91	1	Relay
9	1805672M1	1	Plate
10	339376X1	2	Lock Washer
11	1805465M1	1	Nut
	1805699M1	1	Nut
12	1805671M1	1	Screw
13	1805695M1	1	Brush
14	1805674M1	1	Bearing
15	390469X1	2	Washer Metric
16	1805696M1	2	Screw
17	339381X1	2	Lock Washer
18	1805692M91	1	Bearing Carrier
19	1805694M1	4	Spring
20	1805693M1	1	Brush
21	1805431M1	4	Screw
22	1805673M1	1	Coil
23	1805683M1	1	F.W.Metric Bulk
24	1805680M91	1	Bearing Carrier
25	1805676M1	1	Yoke
26	339374X1	1	Lock Washer
27	1805437M1	1	Nut
28	1805677M1	2	Rod
29	1805678M1	2	F.W.Metric Bulk
30	1805679M1	2	Nut
31	1805682M1	1	Armature
32	1805690M91	1	Flinger
33	1805691M1	2	Bearing
34	1805435M1	1	Bolt
35	1805698M1	1	Parts Pack

12

DÉMARREUR } CA 45 D 12 9 C.A.V.  
 ANLASSER } 897 336 M1  
 MOTORINO D'AVVIAMENTO }

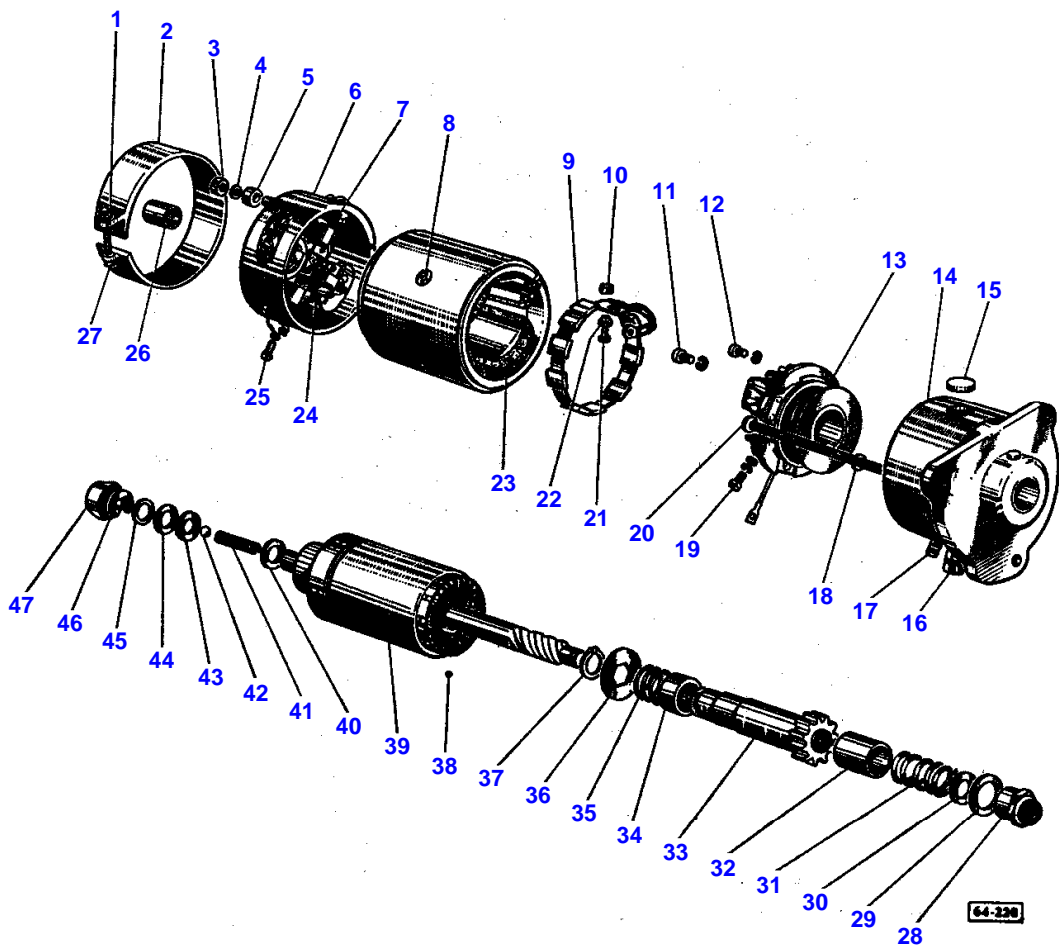

STARTER

Item	Part Number	Qty	Description	Comments
1			Nut	(A)
2			Clamp	(A)
				COMP. NO. 1, 27
3			Nut	(A)
4			Washer	(A)
5	1806176M1	1	Spacer	
6	1806165M1	1	Support	
7			Kit, Brush	(A)
8			Screw	(A)
9	1028539M1	1	Resistor	
10			Spacer	(A)
11			Screw	(A)
			Washer	(A)
12	1713350M1		Screw	
			Washer	(A)
			Washer	(A)
13	1028542M1	1	Solenoid	
14	1866166M1	1	Support	
	1806168M1	1	Support	
	1806169M1	1	Support	
	1852508M1	1	Bumper	
	1028545M1	1	Gasket	
15			Plug	(A)
16			Connector	(A)
			Junction	(A)
17			Connector	(A)
			Insulator	(A)
18			Washer	(A)
19			Screw	(A)
			Washer	(A)
			Washer	(A)
20			Stem	(A)
21	1713347M1	1	Rivet	
22			Bush	(A)
23	1805563M1	1	Inductor	
	1028538M1	4	Isolator	
	1713953M1	4	Isolator	
24			Spring	(A)
25			Screw	(A)
			Washer	(A)
26			Bush	(A)
27			Screw	(A)
28	1028561M1	1	Nut	
29	1713950M1	1	Washer	
30	1805591M1	1	Washer	
31	1805590M1	1	Spring	
32	1806170M1	1	Sleeve	
33	1028558M1	1	Pinion	
34			Clamp	(A)
35			Spring	(A)
36			Washer	(A)
37			Clip	(A)
38			Ball	(A)
39	1805583M1	1	Inductor	
40			Chock	(A)
				0,03
41			Spring	(A)
42			Ball	(A)
43			Washer	(A)
44			Chock	(A)
				0,02
45			Washer	(A)
				0,091
46			Circlip	
47	1028554M1	1	Cap	(A)

16

DÉMARREUR }  
 ANLASSER } PARIS-RHONE 968 296 M1  
 MOTORINO }

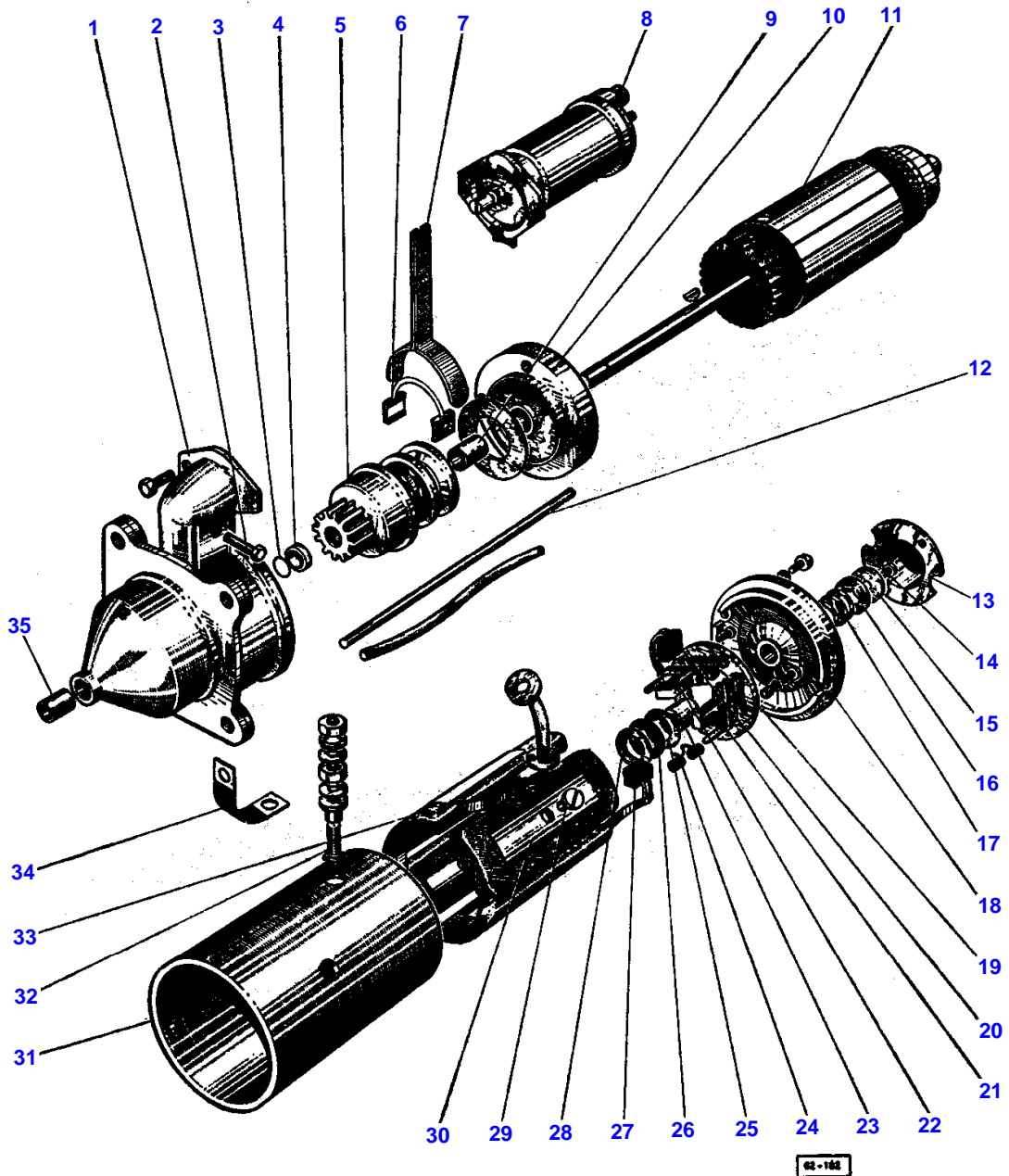

Imprimé en France

TRACTEUR 155

957 469 M2 - Emission 1. - 1/70

**Buy Now**



Our support email:

[ebooklibonline@outlook.com](mailto:ebooklibonline@outlook.com)