

Product: EXCAVATOR

Model: 558 EXCAVATOR LRT

Configuration: 558 Log Loader Forest Machine LRT00001-UP (MACHINE) POWERED BY C7.1 Engine

## Disassembly and Assembly 558 Forestry Machine Machine Systems

Media Number -M0078237-00

Publication Date -01/12/2017

Date Updated -06/12/2017

i01801707

# Swing Drive - Disassemble

SMCS - 5459-015

## Disassembly Procedure

Table 1

Required Tools			
Tool	Part Number	Part Description	Qty
A	1P-2420	Transmission Repair Stand	1
B	138-7574	Link Bracket	2
C	5P-5197	Retaining Ring Pliers	1
	1U-8759	Tip Set	1
D	1P-0510	Driver Gp	1

### Start By:

- A. Remove the swing drive. Refer to Disassembly and Assembly, "Swing Drive - Remove and Install".

**Note:** The disassembly procedure is identical for both swing drives.

---

### NOTICE

Care must be taken to ensure that fluids are contained during performance of inspection, maintenance, testing, adjusting and repair of the product. Be prepared to collect the fluid with suitable containers before opening any compartment or disassembling any component containing fluids.

**Refer to Special Publication, NENG2500, "Caterpillar Tools and Shop Products Guide" for tools and supplies suitable to collect and contain fluids on Caterpillar products.**

**Dispose of all fluids according to local regulations and mandates.**

---

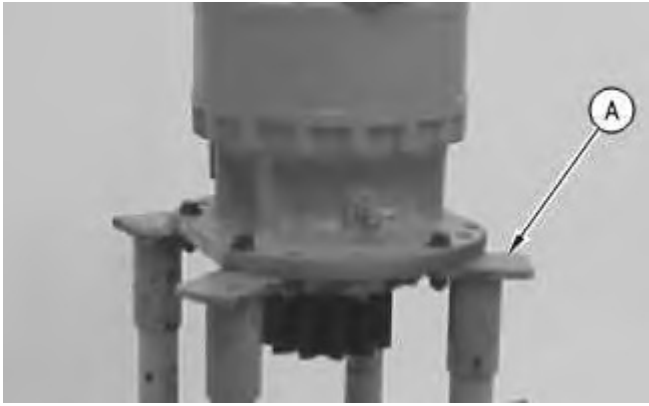

Illustration 1

g00869217

1. Use a suitable device and a hoist to place the swing drive on Tooling (A). The weight of the swing drive is approximately 510 kg (1125 lb).
2. Open the drain valve, and drain the oil from the swing drive into a suitable container for storage or disposal. The capacity of the swing drive is 19 L (5 US gal). If necessary, remove the drain valve from the swing drive housing.



Illustration 2

g00869266

3. Remove bolts (1) from cover (2) .
-



Illustration 3

g00869281

4. Remove sun gear (3) from carrier assembly (4) .

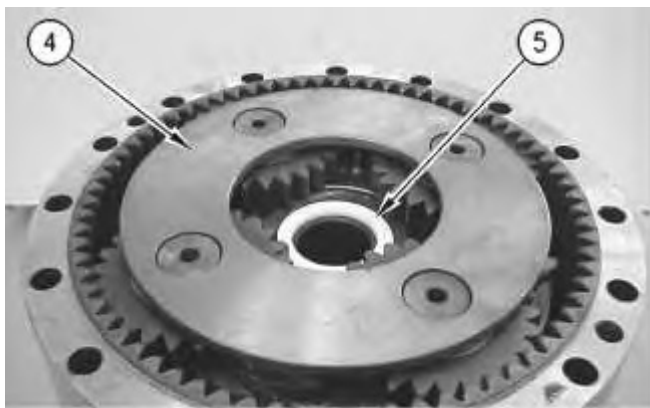
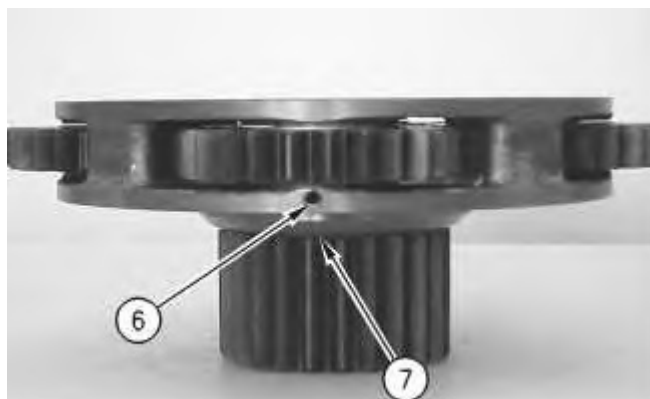

Illustration 4

g00869294

5. Remove spacer (5) from carrier assembly (4) .
6. Use two people to remove carrier assembly (4) from the swing drive. The weight of the carrier assembly is approximately 36 kg (80 lb).
7. Disassemble carrier assembly (4) .



- a. Use a hammer and a punch to drive spring pin (6) into planetary shaft (7) .

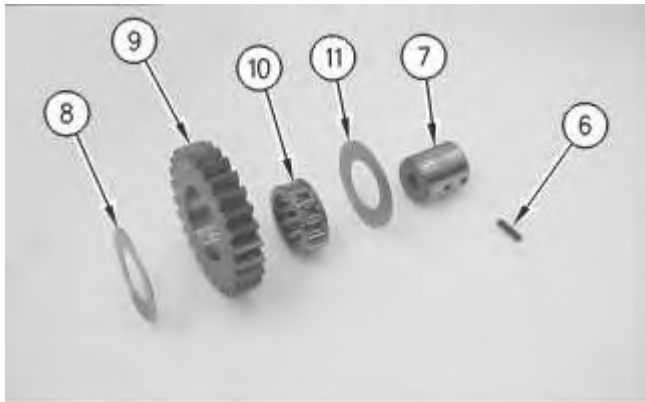

Illustration 6

g00869315

- b. Remove planetary shaft (7), thrust washer (8), thrust washer (11), and planetary gear (9) from the carrier.
- c. Remove bearing (10) from planetary gear (9) .
- d. Use a hammer and a punch in order to remove spring pin (6) from the planetary shaft (7) .
- e. Repeat Steps 7.a through 7.d in order to remove the other three planetary gears from the carrier assembly.

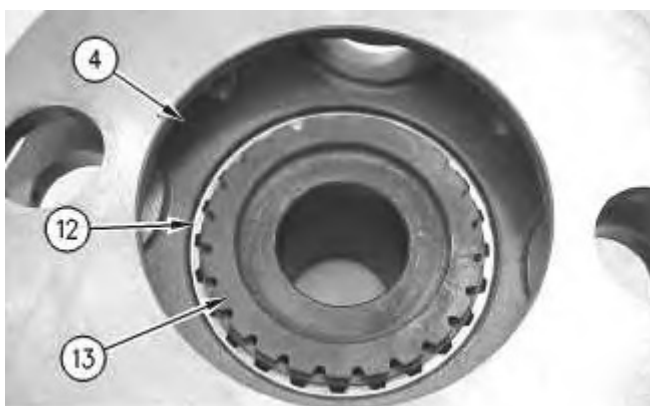

Illustration 7

g00869377

8. Use a screwdriver in order to remove upper retaining ring (12) from sun gear (13) .
9. Remove sun gear (13) from carrier assembly (4) .



Illustration 8

g00869383

10. Remove retaining ring (14) from the sun gear.

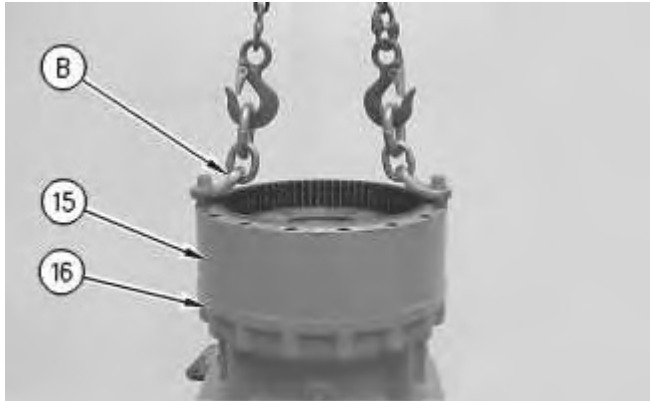

Illustration 9

g00869390

11. Use Tooling (B) and a hoist to remove ring gear (15) from swing drive housing (16). The weight of the ring gear is approximately 80 kg (175 lb).

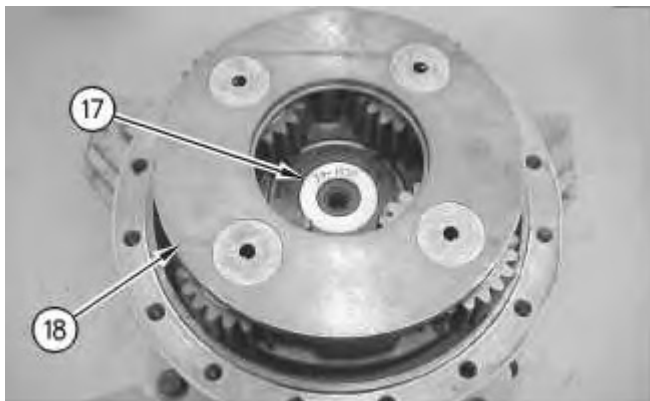

Illustration 10

g00869406

12. Remove spacer (17) from carrier assembly (18) .



Illustration 11

g00869460

13. Use two screwdrivers to remove retaining ring (19) .

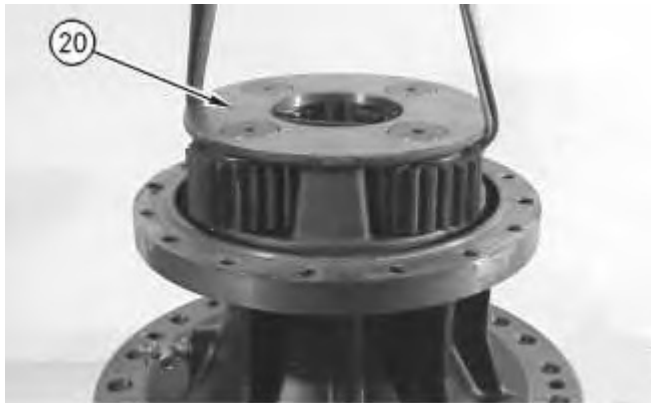

Illustration 12

g00869464

14. Use a hoist and a lifting sling to remove carrier assembly (20). The weight of the carrier assembly is approximately 68 kg (150 lb).
  15. Disassemble carrier assembly (20) .
-



Illustration 13

g00869477

- a. Use a hammer and a punch to drive spring pin (21) into planetary shaft (22) .

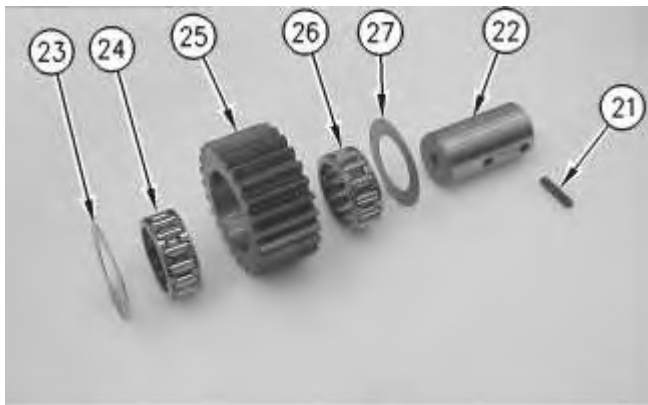

Illustration 14

g00869483

- b. Remove planetary shaft (22), thrust washer (23), thrust washer (27), and planetary gear (25) from the carrier.
  - c. Remove bearing (24) and (26) from planetary gear (25) .
  - d. Use a hammer and a punch to remove spring pin (21) from planetary shaft (22) .
  - e. Repeat Steps 15.a through 15.d in order to remove the other three planetary gears from the carrier assembly.
-

Thank you so much for reading.  
Please click the “Buy Now!”  
button below to download the  
complete manual.



After you pay.

You can download the most  
perfect and complete manual in  
the world immediately.

Our support email:

[ebooklibonline@outlook.com](mailto:ebooklibonline@outlook.com)