

Product: VIBRATORY COMPACTOR

Model: CB-534D VIBRATORY COMPACTOR B5M

Configuration: CB534D CB534D XW Vibratory Compactor B5M00001-UP (MACHINE) POWERED BY 3054C Engine

## **Disassembly and Assembly 3054C Engines for Caterpillar Built Machines**

Media Number -SEN5069-18

Publication Date -01/05/2015

Date Updated -19/09/2018

i02293102

# **Engine Oil Pump - Install - Engines Without a Balancer**

SMCS - 1304-012

## **Installation Procedure**

**Note:** This procedure is for the installation of the engine oil pump on engines that are not equipped with a balancer. Refer to this Disassembly and Assembly Manual, "Balancer Group - Install" for information on the installation of the engine oil pump on engines that are equipped with a balancer.

---

### **NOTICE**

**Keep all parts clean from contaminants.**

**Contaminants may cause rapid wear and shortened component life.**

---

---

### **NOTICE**

**If any of the parts on the engine oil pump are worn or damaged, the entire pump must be replaced.**

---

1. Clean all of the internal components of the oil pump if the front cover of the oil pump was previously removed in order to inspect the internal components. Check the internal components for wear and for other damage. Check the clearance between the outer rotor of the oil pump and the oil pump body. Check the clearance between the outer rotor and the inner rotor. Check the end play movement of the rotor. Refer to the Systems Operation/Testing and Adjusting Manual, "Engine Oil Pump - Inspect". Replace the engine oil pump if any of the components are worn or damaged.

2. Lubricate the inner rotor and the outer rotor of the engine oil pump with clean engine lubricating oil. Install the front cover of the engine oil pump onto the body of the oil pump. Install the setscrews and tighten the setscrews in order to secure the front cover to the body.
- 

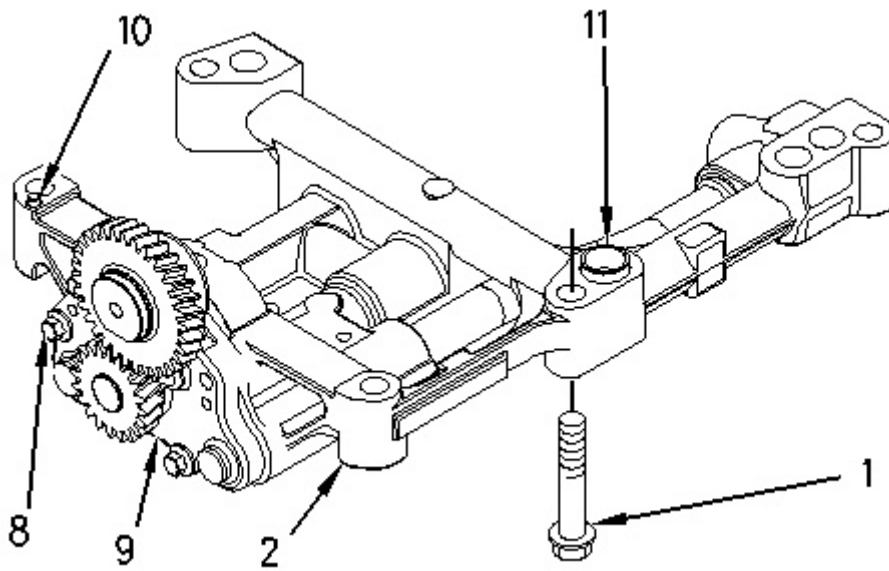
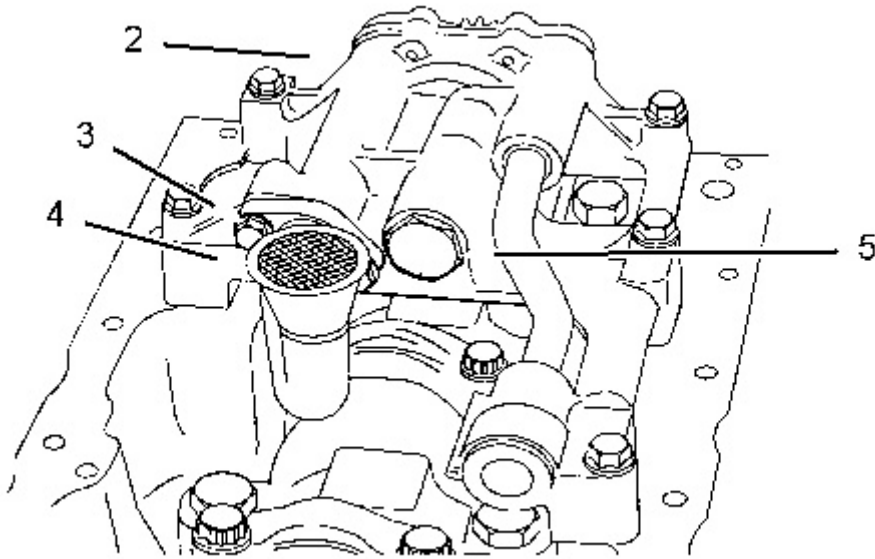

Illustration 1

g00956778

3. Install the engine oil pump (9) into the assembly of the engine oil pump (2). Install the setscrews (8). Tighten the setscrews to a torque of 9 N·m (80 lb in).
  4. Fill engine oil pump (9) with clean engine oil.
  5. Position the assembly of the engine oil pump (2) against the cylinder block. Ensure that dowel pin (10) and hollow dowel (11) are correctly located in the cylinder block.
  6. Install the setscrews (1). Tighten the setscrews to a torque of 44 N·m (32 lb ft).
  7. Check the backlash between the idler gear of the oil pump and the crankshaft gear. Refer to the Specifications Manual, "Gear Group - Front" for further information.
-



---

Illustration 2

g01147909

**⚠ WARNING**

**Improper assembly of parts that are spring loaded can cause bodily injury.**

**To prevent possible injury, follow the established assembly procedure and wear protective equipment.**

---

8. If the pressure relief valve (5) was removed, install the pressure relief valve. Refer to this Disassembly and Assembly Manual, "Engine Oil Relief Valve - Remove and Install" for further information.
9. Position the suction pipe (4) and install the setscrews (3).

**End By:**

- a. Install the oil pan. Refer to Disassembly and Assembly, "Engine Oil Pan - Remove and Install".
-

Product: VIBRATORY COMPACTOR

Model: CB-534D VIBRATORY COMPACTOR B5M

Configuration: CB534D CB534D XW Vibratory Compactor B5M00001-UP (MACHINE) POWERED BY 3054C Engine

## **Disassembly and Assembly 3054C Engines for Caterpillar Built Machines**

Media Number -SEN5069-18

Publication Date -01/05/2015

Date Updated -19/09/2018

i02293115

# **Water Pump - Remove and Install**

SMCS - 1361-011; 1361-012

## **Removal Procedure**

### **Start By:**

- a. Remove the fan. Refer to Disassembly and Assembly, "Fan - Remove and Install".

---

### **NOTICE**

**Keep all parts clean from contaminants.**

**Contaminants may cause rapid wear and shortened component life.**

---

---

### **NOTICE**

**Care must be taken to ensure that fluids are contained during performance of inspection, maintenance, testing, adjusting, and repair of the product. Be prepared to collect the fluid with suitable containers before opening any compartment or disassembling any component containing fluids.**

**Refer to Special Publication, NENG2500, "Dealer Service Tool Catalog" for tools and supplies suitable to collect and contain fluids on Cat products.**

**Dispose of all fluids according to local regulations and mandates.**

---

1. Drain the coolant from the cooling system into a suitable container for storage or disposal.

**Note:** Refer to Operation and Maintenance Manual, "Refill Capacities" for the coolant capacity of the engine.

2. Loosen the clamps and remove the hose from the water pump inlet.

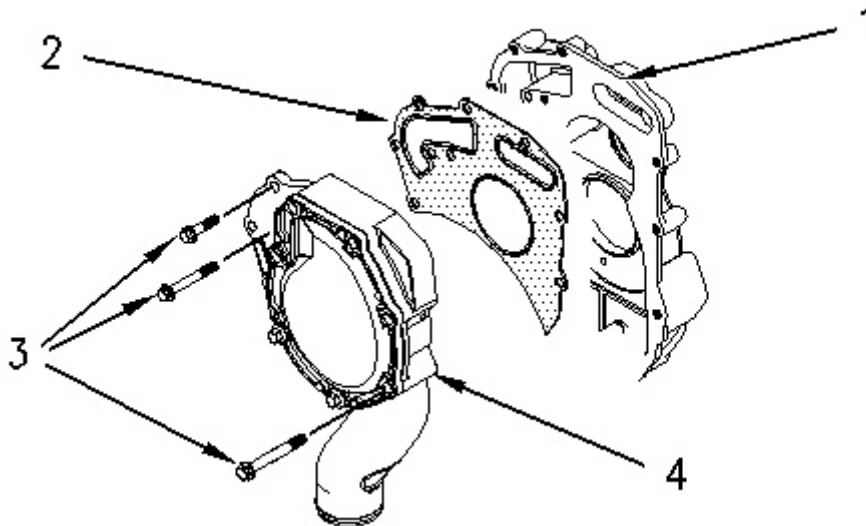

Illustration 1

g00952695

3. Remove the setscrews (3) that fasten the water pump (4) to the front housing (1).

4. If necessary, tap the water pump with a soft hammer in order to loosen the water pump.

5. Remove water pump (4). Remove the gasket (2) from the front housing and the water pump. Discard the gasket (2).

## Installation Procedure

Table 1

Required Tools			
Tool	Part Number	Part Description	Qty
A	9S-3263	Thread Lock	-
B	-	Guide Bolt (M8 X 1.25 by 70 mm)	2

### NOTICE

**Keep all parts clean from contaminants.**

**Contaminants may cause rapid wear and shortened component life.**

- 
1. Inspect the drive gear for the water pump for wear or other damage. If necessary, replace the drive gear.
  2. Clean the joint faces of the water pump and the front housing.

**Note:** Do not use sealant on the gasket for the water pump.

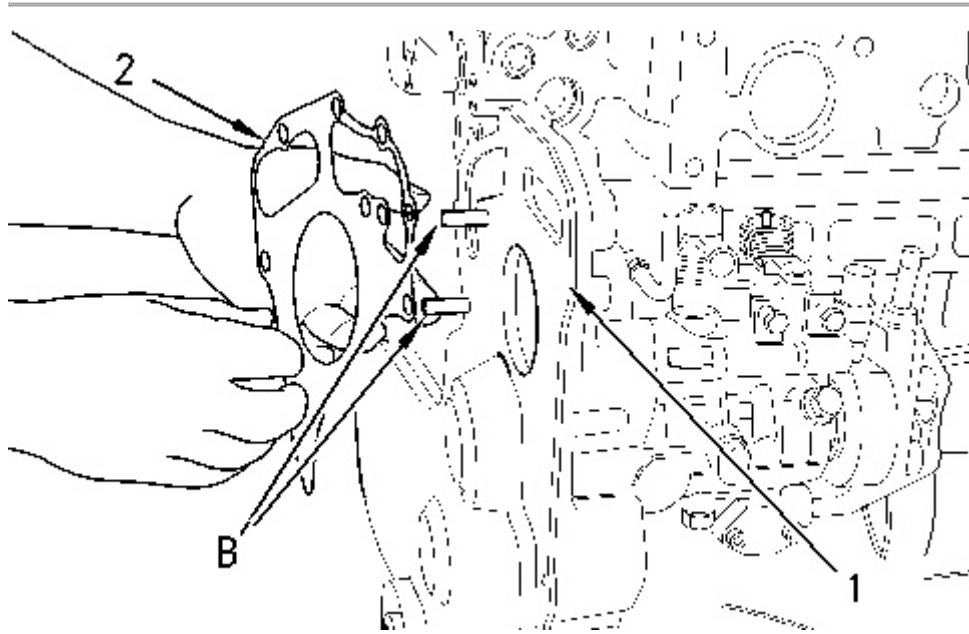
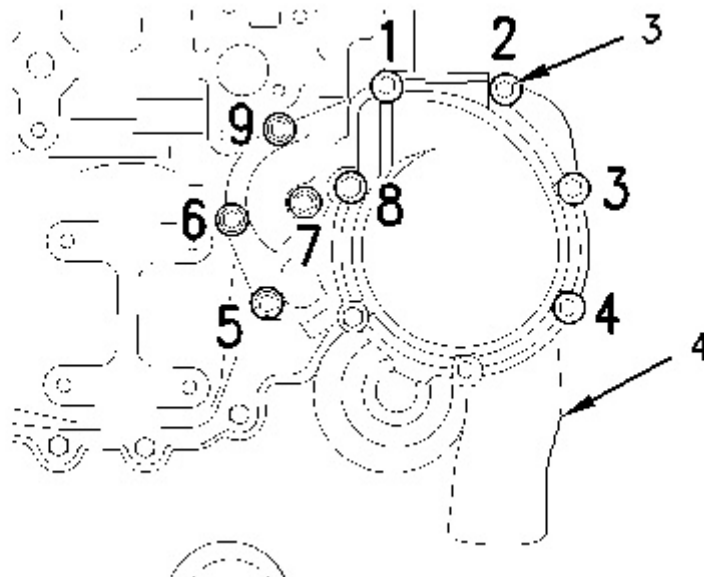

Illustration 2

g00952716

3. Install Tooling (B) in the front housing (1).
4. Install a new gasket (2) on the front housing.



5. Install the water pump (4) on the front housing.

**Note:** New setscrews have sealant on the first 13 mm (0.5 inch) of the threads. In order to reuse the old setscrews, clean the old sealant from the setscrews and apply Tooling (A) to the setscrews.

6. Install the setscrews (3) that fasten the water pump to the front housing. Do not tighten the setscrews at this time.
7. Remove Tooling (B) and install the remaining setscrews in order to secure the water pump to the front housing.

**Note:** Tighten the setscrews evenly in order to pull the water pump into the front housing.

8. Tighten the setscrews (3) to a torque of 22 N·m (16 lb ft). Tighten the setscrews in the sequence that is shown in Illustration 3.
9. Install the hose to the water pump inlet. Tighten the hose clamps.
10. Fill the cooling system with coolant. Refer to Operation and Maintenance, "Refill Capacities" for the cooling system capacity.

**End By:**

- a. Install the fan. Refer to Disassembly and Assembly, "Fan - Remove and Install".
-

Product: VIBRATORY COMPACTOR

Model: CB-534D VIBRATORY COMPACTOR B5M

Configuration: CB534D CB534D XW Vibratory Compactor B5M00001-UP (MACHINE) POWERED BY 3054C Engine

## **Disassembly and Assembly 3054C Engines for Caterpillar Built Machines**

Media Number -SEN5069-18

Publication Date -01/05/2015

Date Updated -19/09/2018

i02293128

# **Water Temperature Regulator - Remove and Install**

SMCS - 1355-010

## **Removal Procedure**

---

### **NOTICE**

**Keep all parts clean from contaminants.**

**Contaminants may cause rapid wear and shortened component life.**

---

---

### **NOTICE**

**Care must be taken to ensure that fluids are contained during performance of inspection, maintenance, testing, adjusting, and repair of the product. Be prepared to collect the fluid with suitable containers before opening any compartment or disassembling any component containing fluids.**

**Refer to Special Publication, NENG2500, "Dealer Service Tool Catalog" for tools and supplies suitable to collect and contain fluids on Cat products.**

**Dispose of all fluids according to local regulations and mandates.**

---

1. Drain the coolant from the cooling system to a level below the water temperature regulator into a suitable container for storage or disposal.



Thank you so much for reading.  
Please click the “Buy Now!”  
button below to download the  
complete manual.



After you pay.

You can download the most  
perfect and complete manual in  
the world immediately.

Our support email:

[ebooklibonline@outlook.com](mailto:ebooklibonline@outlook.com)