

Product: TRACK-TYPE TRACTOR

Model: D6T XW TRACK-TYPE TRACTOR SLJ

Configuration: D6T TRACK-TYPE TRACTOR XL, XW, LGP, Differential Steering SLJ00001-UP (MACHINE) POWERED BY C9.3 Engine

Disassembly and Assembly D6T Track-Type Tractor Power Train

Media Number -KENR8911-03

Publication Date -01/03/2016

Date Updated -07/03/2016

i04242189

Transmission - Disassemble

SMCS - 3030-015

S/N - DTD1-UP

S/N - GMK1-UP

S/N - KSB1-UP

S/N - RCW1-UP

S/N - SLJ1-UP

S/N - ZJB1-UP

Disassembly Procedure

Table 1

Required Tools			
Tool	Part Number	Part Description	Qty
A	1P-2420	Transmission Repair Stand	1
B	138-7575	Link Bracket	3
C	1P-1864	Retaining Ring Pliers As	1
D	136-1452	Internal Tip Pliers	1
E	FT-0947	Spring Compressor	2
F	FT-0833	Spring Compressor	2
G	138-7573	Link Bracket	3
H	3K-4897	Spring Pin	8
J	9U-7479	Compressing Tube	1

Start By:

- a. Separate the transmission and bevel gears.

NOTICE

Care must be taken to ensure that fluids are contained during performance of inspection, maintenance, testing, adjusting, and repair of the product. Be prepared to collect the fluid with suitable containers before opening any compartment or disassembling any component containing fluids.

Refer to Special Publication, NENG2500, "Dealer Service Tool Catalog" for tools and supplies suitable to collect and contain fluids on Cat products.

Dispose of all fluids according to local regulations and mandates.

Note: The transmission modulating valves must be recalibrated if any of the following procedures are performed:

- The transmission modulating valve and/or the solenoid is replaced.
- The transmission is serviced or the transmission is replaced.
- The electronic control module is replaced.

Reference: Refer to Testing and Adjusting, "Calibration".

Note: The friction discs and the clutch plates from the individual clutches must be kept in the correct order. The friction discs and the clutch plates must be kept with the original clutch housings. The different clutches use different friction material. The friction discs and the clutch plates must not be mixed together.

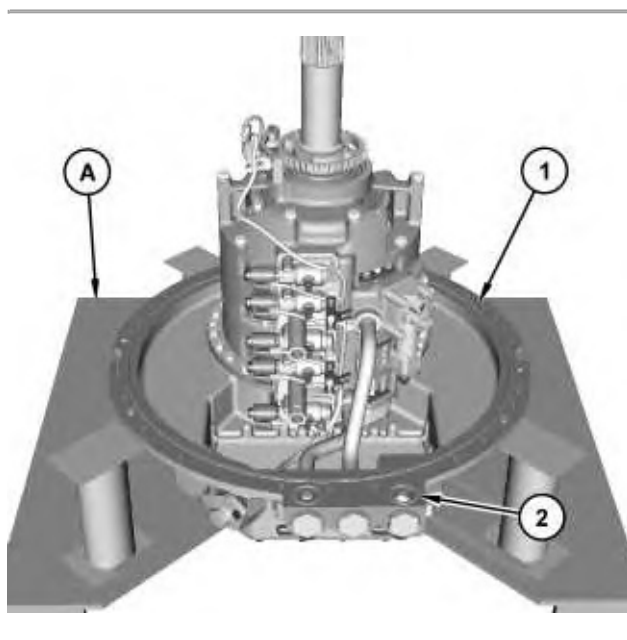

1. Secure the transmission onto Tooling (A). The weight of the transmission is approximately 458 kg (1010 lb). Mark all the housings for alignment during the assembly procedure.
2. Remove O-ring seal (1) and O-ring seals (2) from the transmission cover.

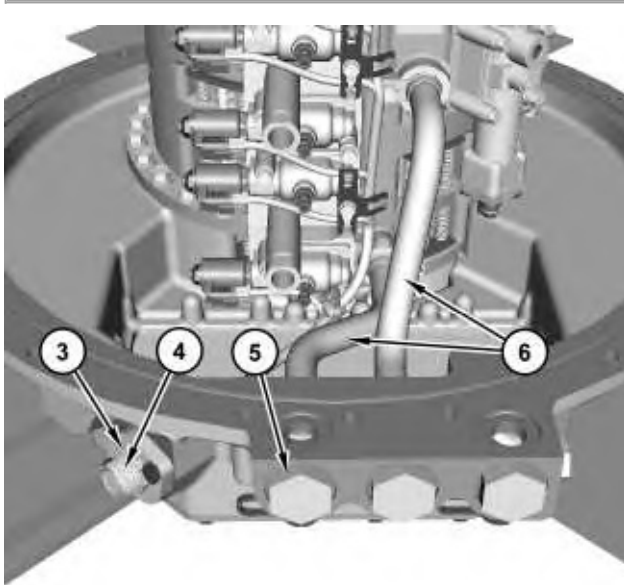

Illustration 2

3. Remove fittings (5) and the O-ring seals.
4. Remove tube assemblies (6) and the O-ring seals.
5. Remove locknut (3). Push connector (4) into the case.

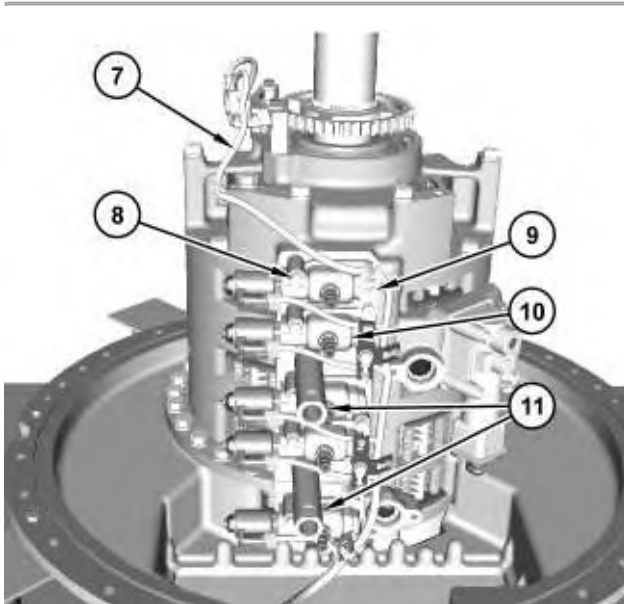

Illustration 3

6. Disconnect and remove harness assembly (7).

7. Remove bolts (8), retainers (9), and valve assemblies (10).
8. Remove drain assemblies (11).

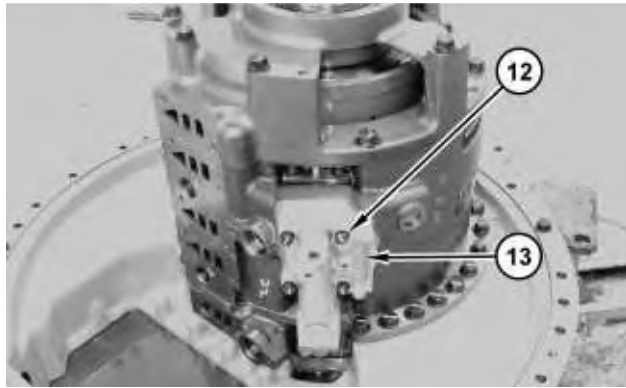

Illustration 4

g02416157

9. Remove bolts (12) and valve assembly (13).

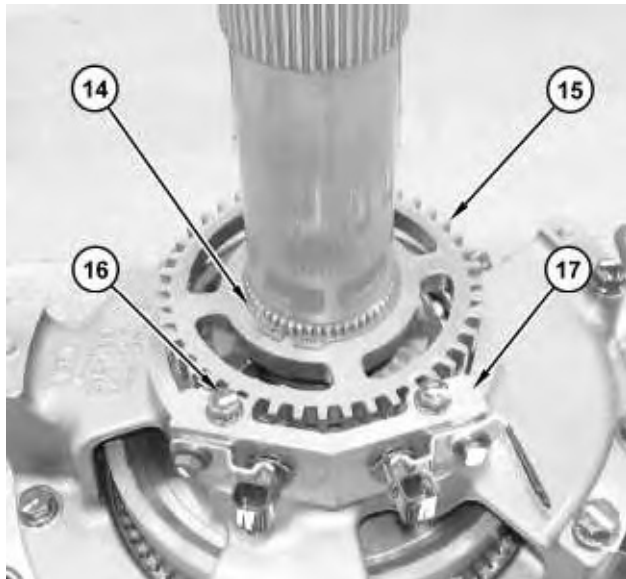

Illustration 5

g02168643

10. Use Tooling (C) in order to remove retaining ring (14). Remove rotor (15).
 11. Remove bolts (16) and bracket assembly (17).
-

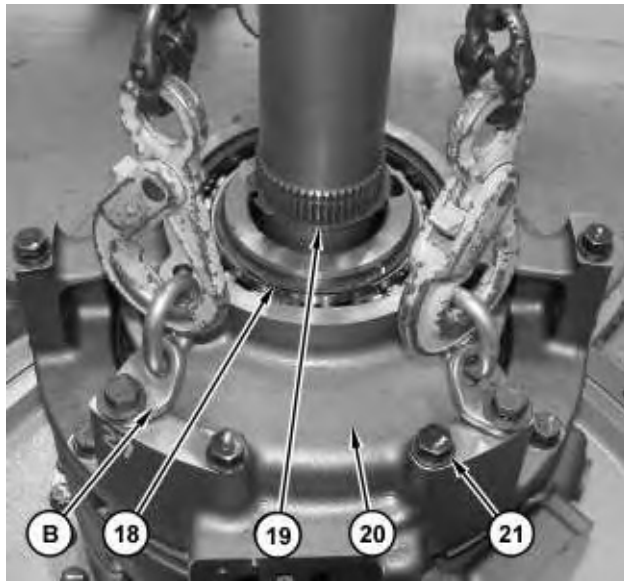

Illustration 6

g02168836

 **WARNING**

Personal injury can result from being struck by parts propelled by a released spring force.

Make sure to wear all necessary protective equipment.

Follow the recommended procedure and use all recommended tooling to release the spring force.

-
12. Remove retaining ring (18) and retaining ring (19).
 13. Attach Tooling (B) and a suitable lifting device to manifold (20). The weight of manifold (20) is approximately 27 kg (60 lb).
 14. Remove bolts (21) and manifold (20).
-



Illustration 7

g02168876

15. Use Tooling (D) in order to remove retaining ring (22) from manifold (20). Remove bearing (23) from manifold (20).

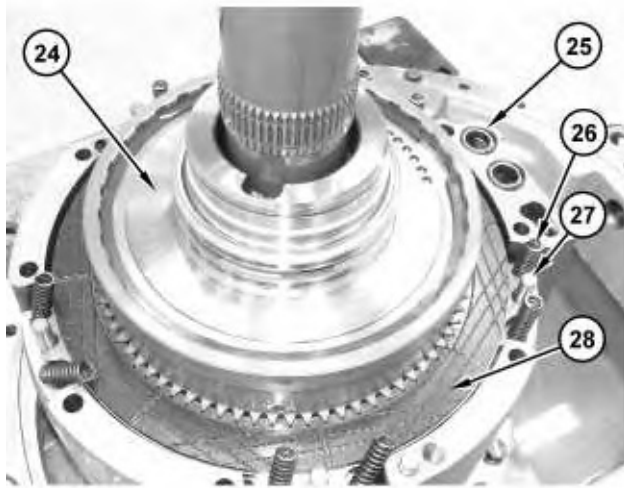

Illustration 8

g02168993

16. Remove O-ring seals (25). Remove dowels (27) and springs (26).
17. Use two people in order to remove housing and ring gear assembly (24). The weight of housing and ring gear assembly (24) is approximately 41 kg (91 lb).
18. Remove friction discs and plates (28).

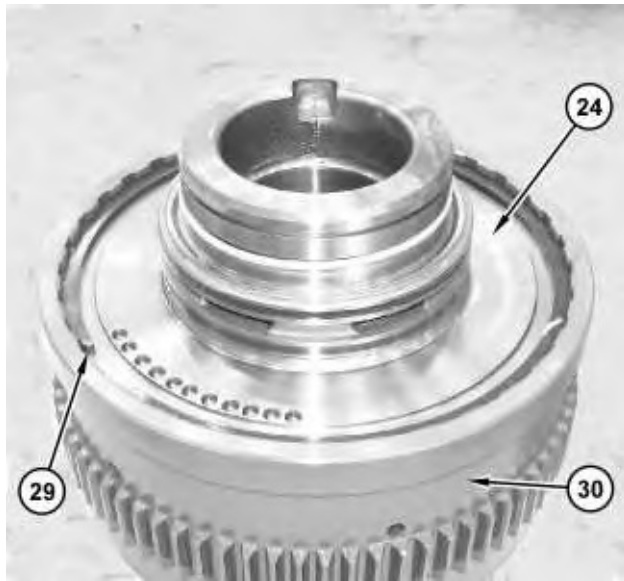

Illustration 9

g02415357

19. Remove retaining ring (29) and housing assembly (24) from ring gear (30).

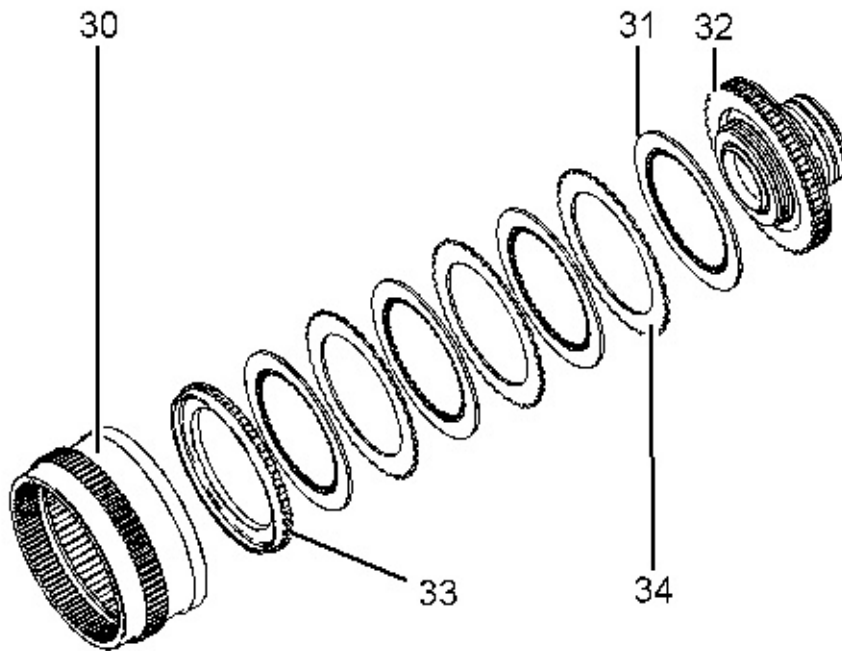

Illustration 10

g02170276

20. Remove housing assembly (32), friction discs (31), clutch plates (34), and reaction plate (33) from ring gear (30).

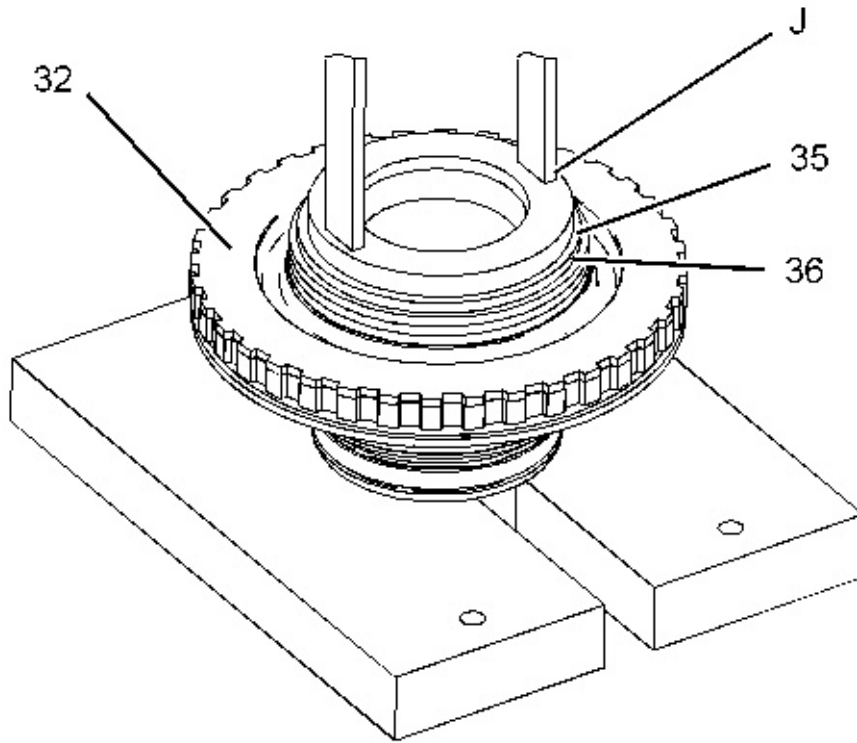
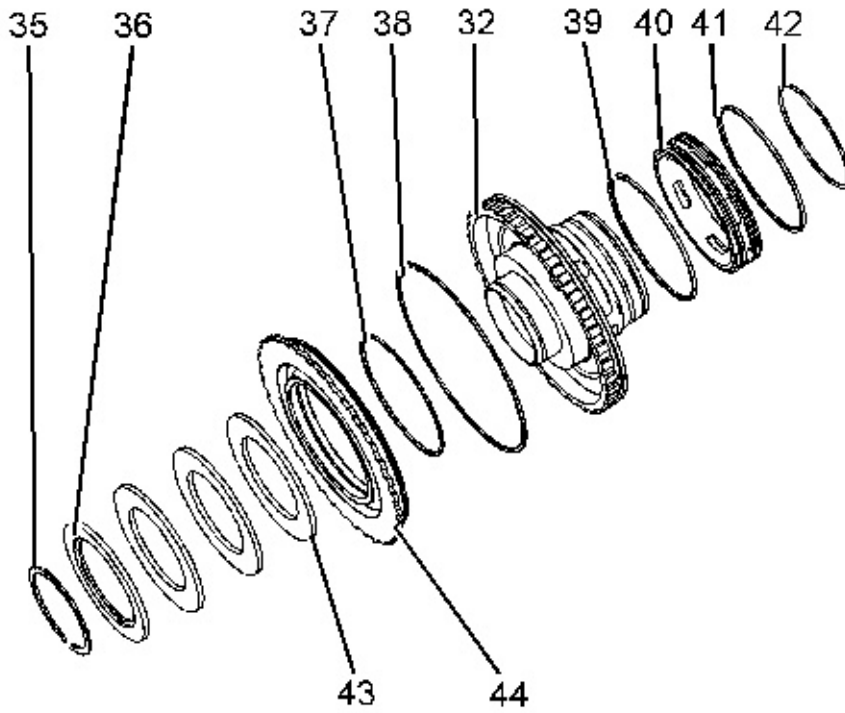

Illustration 11

g02175358



WARNING

Personal injury can result from being struck by parts propelled by a released spring force.

Make sure to wear all necessary protective equipment.

Follow the recommended procedure and use all recommended tooling to release the spring force.

21. Use a suitable press and Tooling (J) in order to compress disc springs (43).
22. Remove retaining ring (35) and retainer plate (36) from housing assembly (32).
23. Remove disc springs (43). Remove piston (44). Remove seal rings (37) and (38) from piston (44).
24. Remove O-ring seal (42). Remove seal rings (41) and (39) from carrier (40).

Note: Carrier (40) will be destroyed if carrier (40) is removed.

25. If carrier (40) must be removed, use a suitable chisel in order to break carrier (40) and remove carrier (40) from housing (32). After carrier (40) is removed, remove the pin that holds carrier (40) in position.

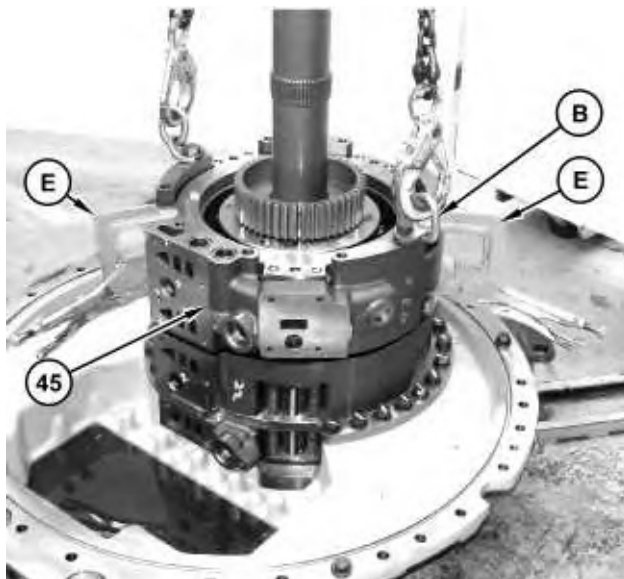

Illustration 13

g02415378

26. Install Tooling (B) and a suitable lifting device to housing assembly (45). The weight of housing assembly (45) is approximately 49 kg (107 lb).
27. Install Tooling (E). Clamp the two pistons inside housing assembly (45).

28. Remove housing assembly (45). Remove Tooling (E).



Illustration 14

g02170933

29. Remove piston (46) from housing assembly (45). Remove seal rings (47) and (48).

30. Remove piston (51) from housing assembly (45). Remove seal rings (49) and (50).

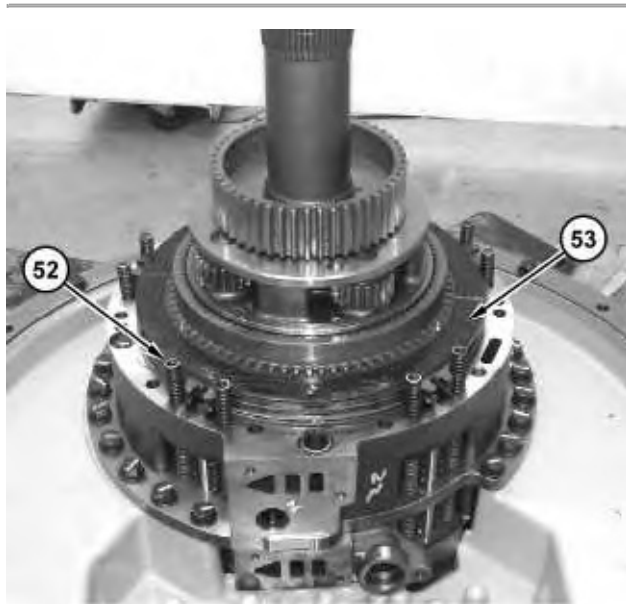

Illustration 15

g02415379

31. Remove springs (52). Remove friction discs and clutch plates (53).

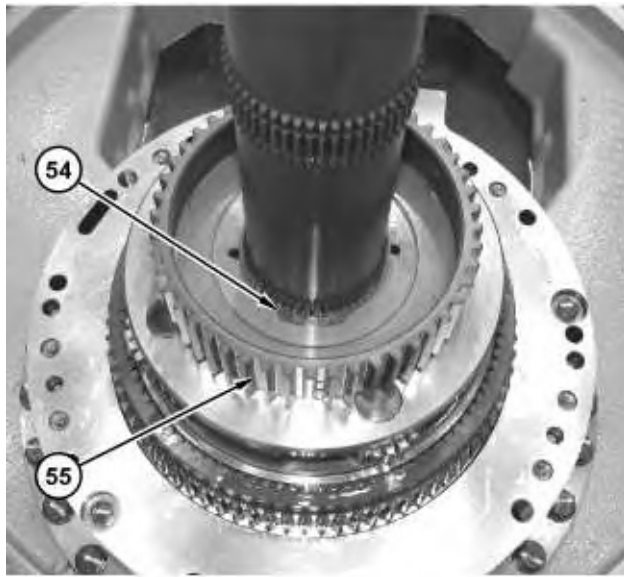

Illustration 16

g02415366

32. Use Tooling (C) in order to remove retaining ring (54). Remove gear (55).

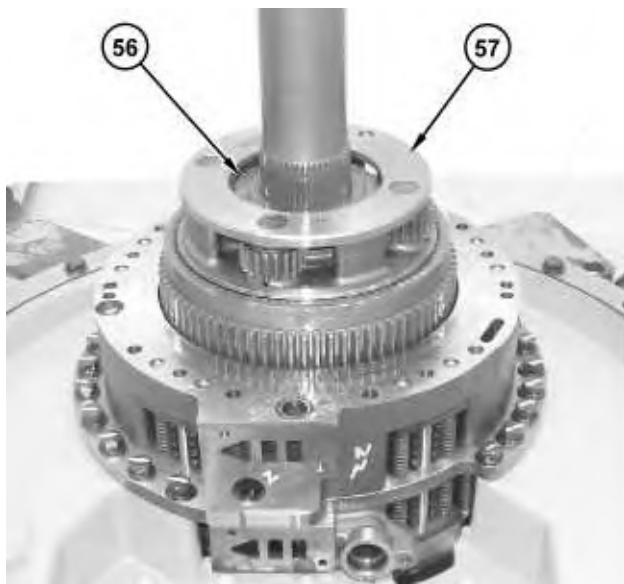

Illustration 17

g02415385

33. Remove sun gear (56) and planetary carrier and ring gear assembly (57).

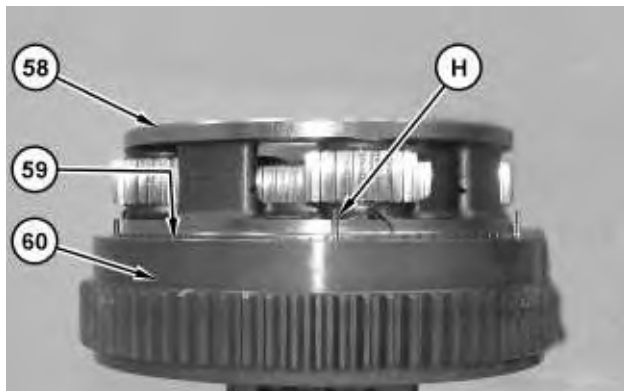

Illustration 18

g02174448

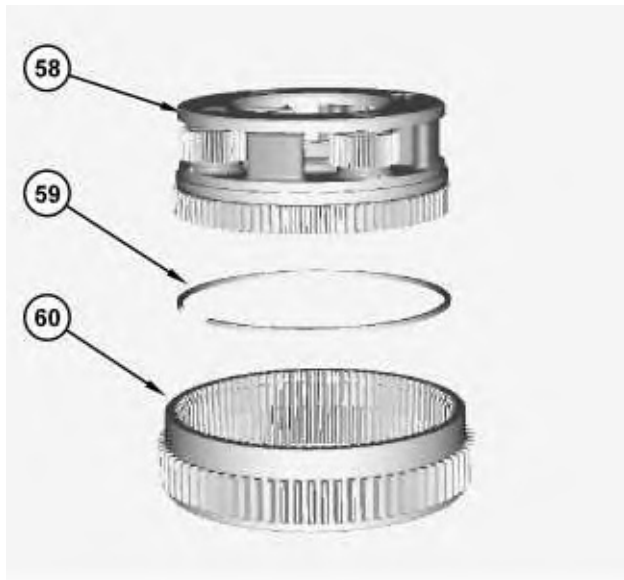
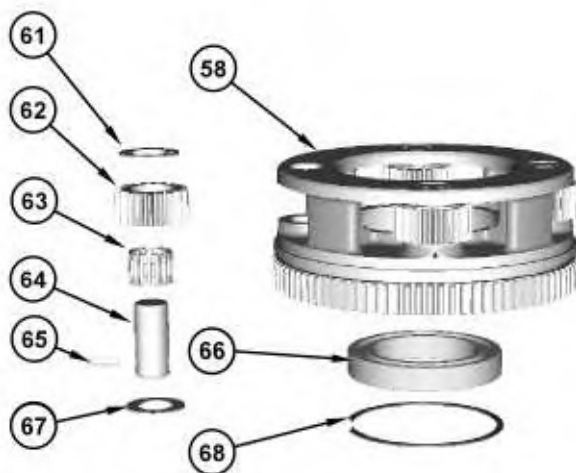

Illustration 19

g02171873

34. Use Tooling (H) to compress retaining ring (59) and remove ring gear (60) from planetary carrier (58).



35. Remove retaining ring (68) and bearing (66) from planetary carrier (58).
36. Use a suitable punch in order to push pin (65) into planetary shaft (64). Remove planetary shaft (64), washers (61) and (67), planetary gear (62), and bearing (63). Remove pin (65) from planetary shaft (64). Repeat for the remaining planetary shafts.

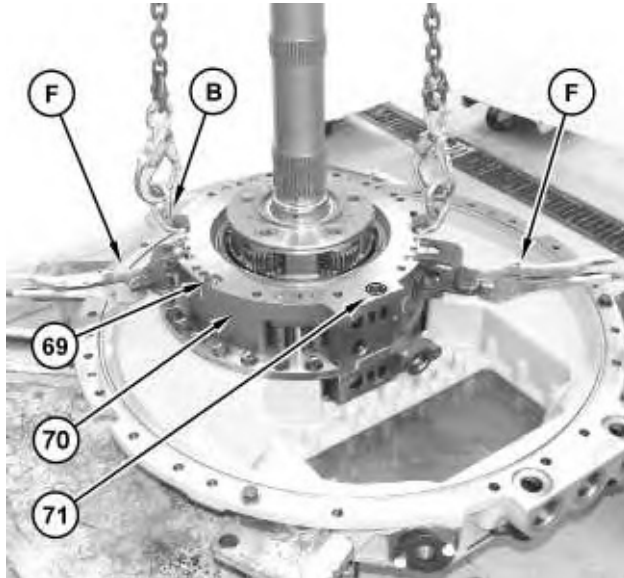

Illustration 21

37. Attach Tooling (B) and a suitable lifting device to housing (70). The weight of housing (70) is approximately 33 kg (72 lb).
38. Install Tooling (F) in order to clamp the piston in housing (70).
39. Remove O-ring seal (71), bolts (69), and remove housing (70). Remove Tooling (F).

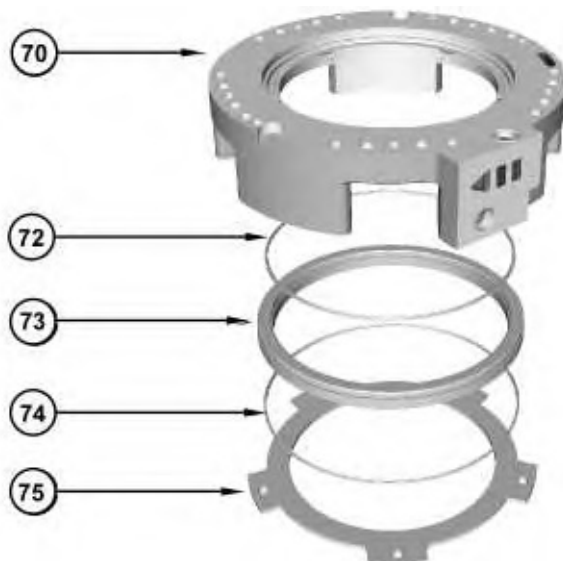

Illustration 22

40. Remove clutch plate (75) and piston (73) from housing (70). Remove seal rings (72) and (74) from piston (73).

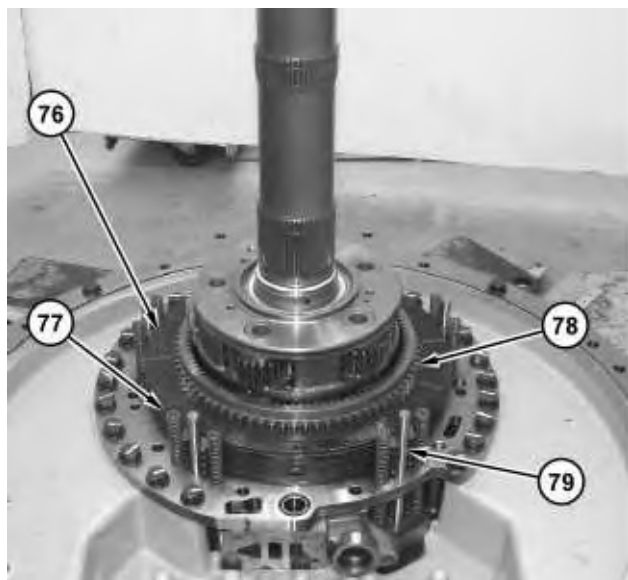

Illustration 23

g02416057

41. Remove friction discs and clutch plates (76). Remove ring gear (78). Remove springs (77) and dowels (79).

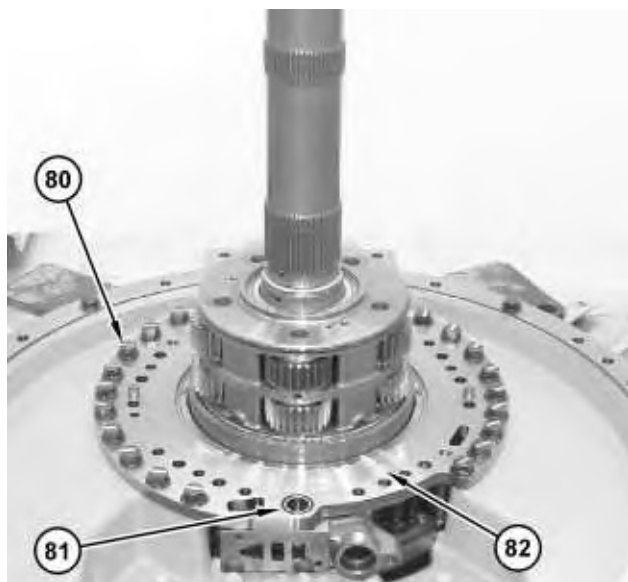

Illustration 24

g02416060

42. Remove bolts (80), O-ring seal (81), and plate (82).
-

Thank you so much for reading.
Please click the “Buy Now!”
button below to download the
complete manual.



After you pay.

You can download the most
perfect and complete manual in
the world immediately.

Our support email:

ebooklibonline@outlook.com