



Bobcat®

Sweeper

Service Manual

(36 Inch) S/N A7P200101 & Above
(44 Inch) S/N A7NW00101 & Above
(48 Inch) S/N A9T600101 & Above
(54 Inch) S/N A7NU00101 & Above
(84 Inch) S/N A00A00101 & Above

Dealer Copy -- Not for Resale

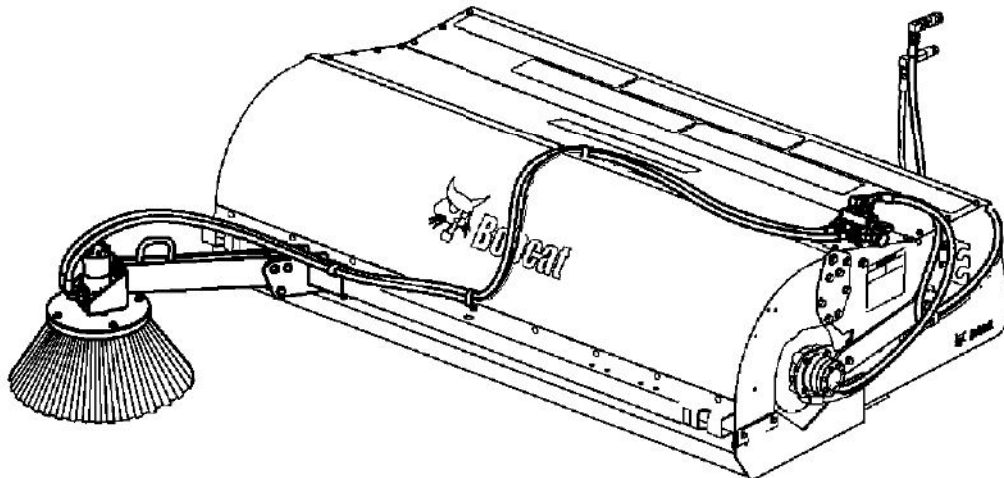

MAINTENANCE SAFETY



WARNING







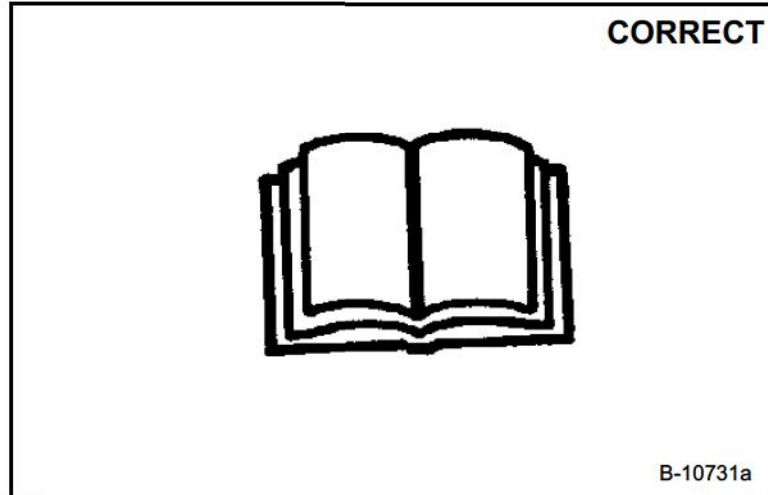

Instructions are necessary before operating or servicing machine. Read and understand the Operation & Maintenance Manual, Operator's Handbook and signs (decals) on machine. Follow warnings and instructions in the manuals when making repairs, adjustments or servicing. Check for correct function after adjustments, repairs or service. Untrained operators and failure to follow instructions can cause injury or death.

W-2003-0903



Safety Alert Symbol: This symbol with a warning statement, means: "Warning, be alert! Your safety is involved!" Carefully read the message that follows.



-  Never service attachments without instructions. See Operation & Maintenance Manual and Attachment Service Manual.
-  Cleaning and maintenance are required daily.
-  Never service or adjust attachment with the engine running unless instructed to do so in manual.
-  Always lower the attachment to the ground before lubricating or servicing.
-  Avoid contact with leaking hydraulic fluid or diesel fuel under pressure. It can penetrate skin or eyes.
-  Stop, cool and clean engine of flammable materials before checking fluids.
-  Keep body, loose objects and clothing away from moving parts, electrical contacts, hot parts and exhaust.
-  Safety glasses are needed for eye protection from electrical arcs, battery acid, compressed springs, fluids under pressure and flying debris or when tools are used. Use eye protection approved for type of welding.

ALPHABETICAL INDEX

ALPHABETICAL INDEX

| | |
|--|---------|
| BRUSH | 10-40-1 |
| BRUSH | 30-10-1 |
| BRUSH ARM..... | 30-20-1 |
| CONTROL VALVE (GUTTER BRUSH)..... | 20-10-1 |
| CUTTING EDGE | 30-30-1 |
| DAILY INSPECTION | 10-20-1 |
| HYDRAULIC MOTOR..... | 20-20-1 |
| HYDRAULIC SCHEMATIC | 40-20-1 |
| GUTTER BRUSH | 30-40-1 |
| LUBRICATING THE ATTACHMENT..... | 10-30-1 |
| RUBBER SHIELD | 30-50-1 |
| SWEEPER ATTACHMENT SPECIFICATIONS..... | 40-10-1 |
| TROUBLESHOOTING | 10-10-1 |
| WHEEL KIT..... | 30-60-1 |

Dealer Copy -- Not for Resale

CONTENTS

ATTACHMENT DELIVERY REPORT III
IDENTIFICATION AND MACHINE SIGNS (DECALS) IV
SERIAL NUMBER LOCATION III
SAFETY AND MAINTENANCE..... 10-01
HYDRAULIC SYSTEM 20-01
MAIN FRAME 30-01
SPECIFICATIONS AND SCHEMATICS 40-01

**SAFETY AND
MAINTENANCE**

**HYDRAULIC
SYSTEM**

**MAIN
FRAME**

**SPECIFICATIONS
AND
SCHEMATICS**

REFERENCE INFORMATION

Write the correct information for YOUR sweeper attachment in the spaces below. Always use these numbers when referring to your sweeper.

Sweeper Serial Number

NOTES:

YOUR BOBCAT® DEALER:

ADDRESS:

PHONE:

Bobcat Company
P.O. Box 128
Gwinner, ND 58040-0128

Bobcat Company Europe
J. Huysmanslaan 59
B-1651 LOT
Belgium

Dealer Copy -- Not for Resale

SERIAL NUMBER LOCATION

Figure 1

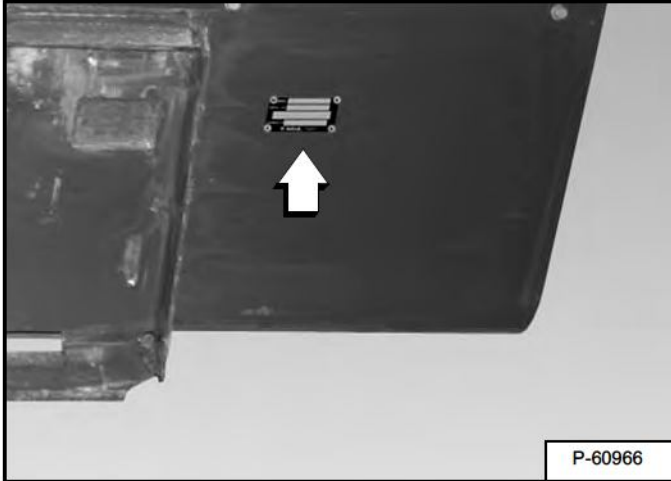

Always use the serial number of the sweeper when requesting service information or when ordering parts. Early or later models (identification made by serial number) may use different parts, or it may be necessary to use a different procedure in doing a specific service operation [Figure 1].

ATTACHMENT DELIVERY REPORT

Figure 2

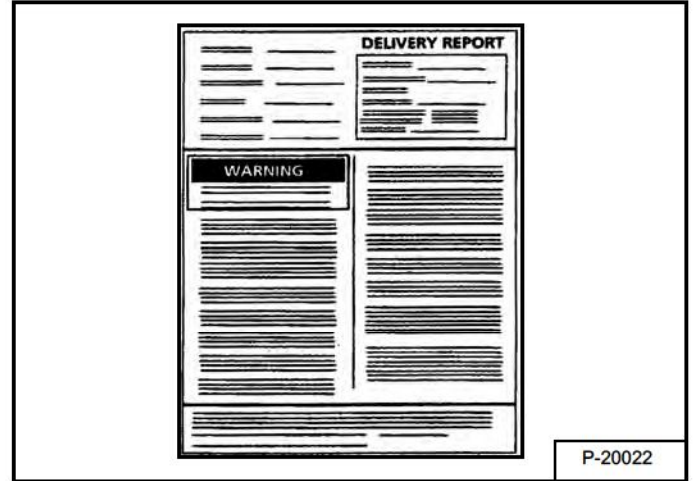

The attachment delivery report must be filled out by the dealer and signed by the owner or operator when the sweeper is delivered. An explanation of the form must be given to the owner. Make sure it is filled out completely [Figure 2].

Dealer Copy -- Not for Resale

IDENTIFICATION AND MACHINE SIGNS (DECALS)

Sweeper

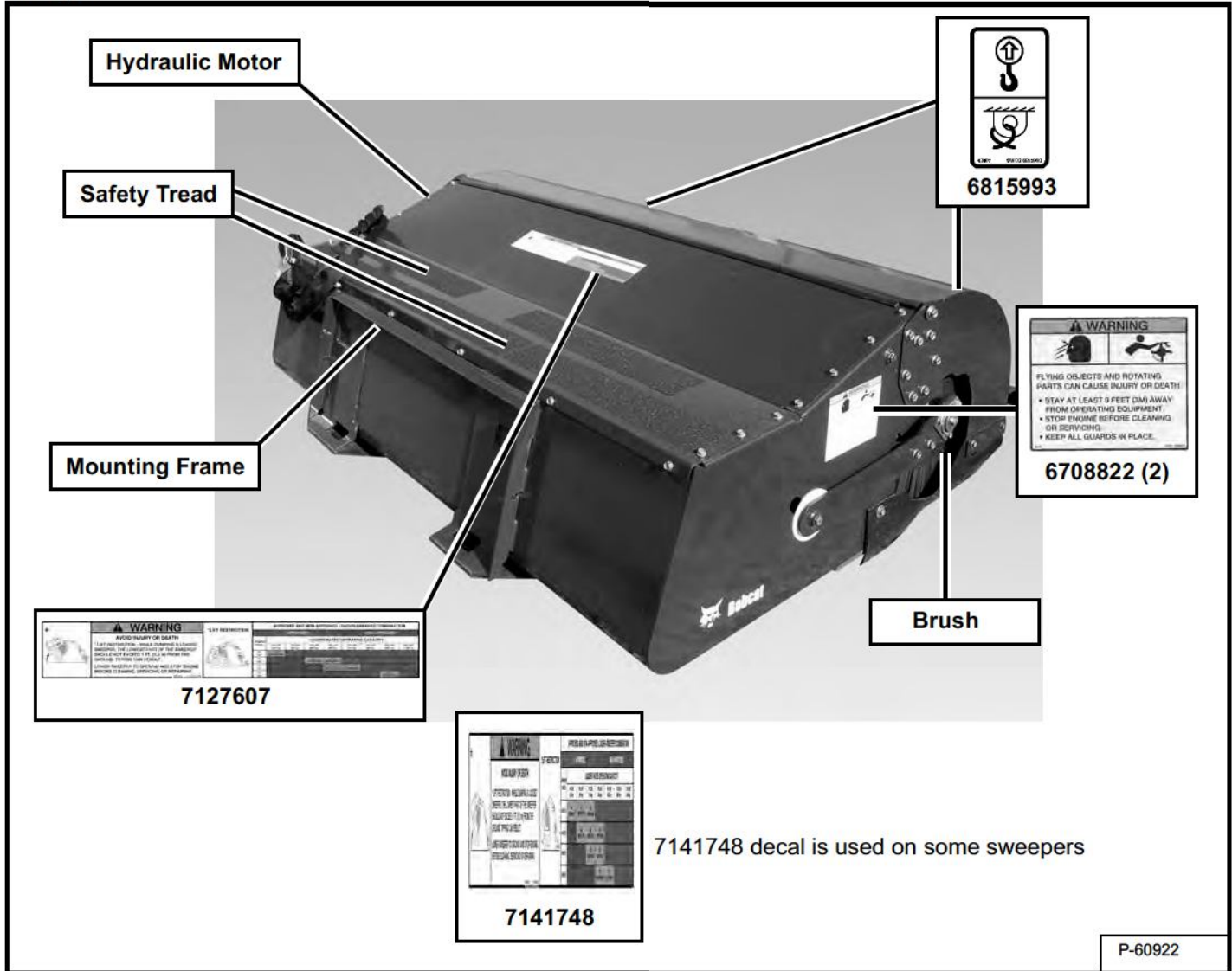

Dealer Copy -- Not for Resale

IDENTIFICATION AND MACHINE SIGNS (DECALS) (CONT'D)

Gutter Brush And Wheel Kit (Optional)

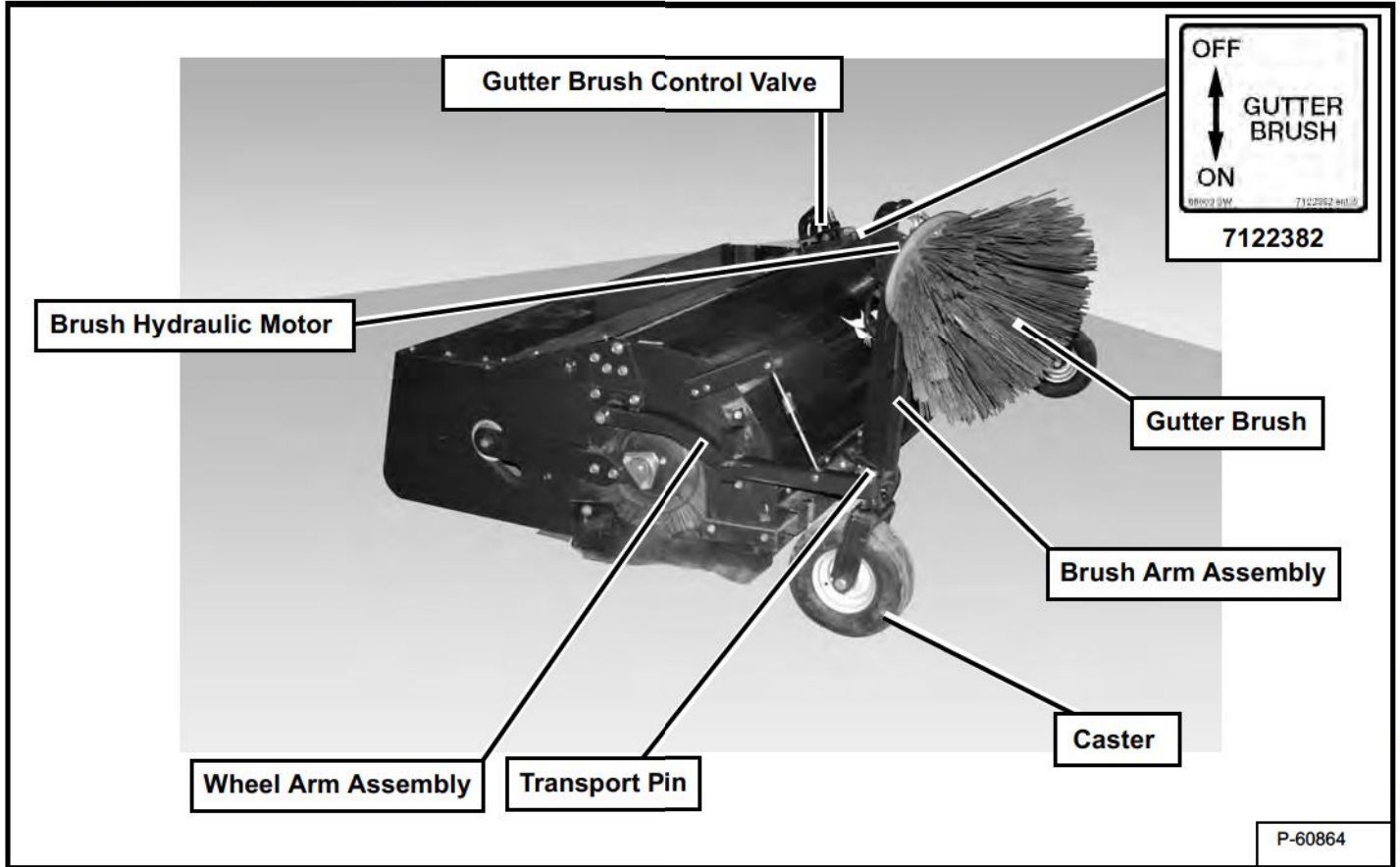

Dealer Copy -- Not for Resale

SAFETY AND MAINTENANCE

SAFETY AND MAINTENANCE

| | |
|-------------------------------------|---------|
| BRUSH | 10-40-1 |
| Adjusting The Brush..... | 10-40-1 |
| DAILY INSPECTION | 10-20-1 |
| Hand Lever Bob-Tach Inspection..... | 10-20-1 |
| Power Bob-Tach Inspection | 10-20-2 |
| Sweeper Inspection | 10-20-1 |
| LUBRICATING THE ATTACHMENT | 10-30-1 |
| Lubrication Locations..... | 10-30-1 |
| TROUBLESHOOTING | 10-10-1 |

Dealer Copy -- Not for Resale

TROUBLESHOOTING



WARNING

Instructions are necessary before operating or servicing machine. Read and understand the Operation & Maintenance Manual, Operator's Handbook and signs (decals) on machine. Follow warnings and instructions in the manuals when making repairs, adjustments or servicing. Check for correct function after adjustments, repairs or service. Untrained operators and failure to follow instructions can cause injury or death.

W-2003-0903

If the Sweeper is not working correctly, check the hydraulic system of the machine thoroughly before making any repairs on the Sweeper. Sweeper problems can be affected by a hydraulic system that is not operating to specifications. Connect a flow meter to the loader to check the hydraulic pump output, relief valve setting and tubelines to check flow and pressure. (See the loader Service Manual for the correct procedure to connect the flow meter.)

Use the following troubleshooting chart to locate and correct problems which most often occur with the sweeper.

| PROBLEM | CAUSE | CORRECTION |
|---------------------------------------|--|---|
| Sweeper will not rotate. | Auxiliary front hydraulics not engaged. | Engage the machine's front auxiliary hydraulics. |
| | Auxiliary hydraulic switch not engaged. | Engage auxiliary hydraulic switch. |
| | Excessive hydraulic leakage. | Check hoses and hydraulic motor. |
| | No hydraulic flow. | Check hydraulic pump flow. |
| Sweeper operation not effective. | Sweeper bristles worn. | Adjust bristle to cutting edge distance. |
| | | Replace sweeper bristle sections. |
| | Sweeper rotating in wrong direction of loader travel. | Reverse sweeper rotation or the direction of loader travel. |
| Gutter brush will not rotate. | Control valve for Gutter Brush not activated. | Move the valve spool to activate Gutter Brush. |
| Gutter brush operation not effective. | Gutter brush not making contact with surface. | Lower gutter brush to sweeping position. |
| | Gutter brush rotating in wrong direction of loader travel. | Change direction of loader travel. |

Dealer Copy -- Not for Resale

DAILY INSPECTION

Sweeper Inspection

Figure 10-20-3

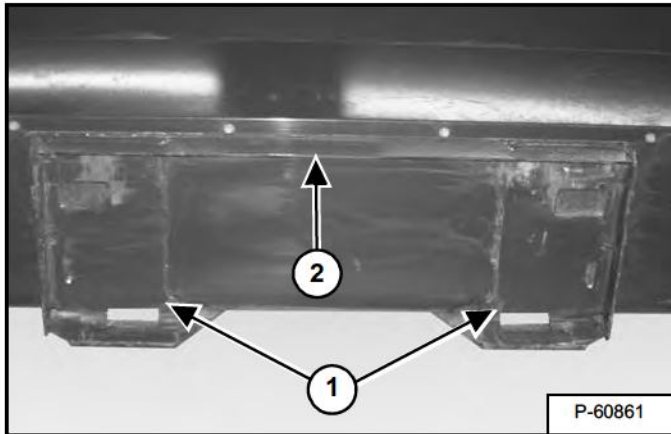

Inspect the Bob-Tach wedge mounts (Item 1), mounting flange (Item 2) and all welds on the sweeper for wear and damage each time the sweeper is removed from the loader [Figure 10-20-3].

Hand Lever Bob-Tach Inspection



Bob-Tach wedges must extend through the holes in attachment. Lever(s) must be fully down and locked. Failure to secure wedges can allow attachment to come off and cause injury or death.

W-2102-0497

Figure 10-20-1

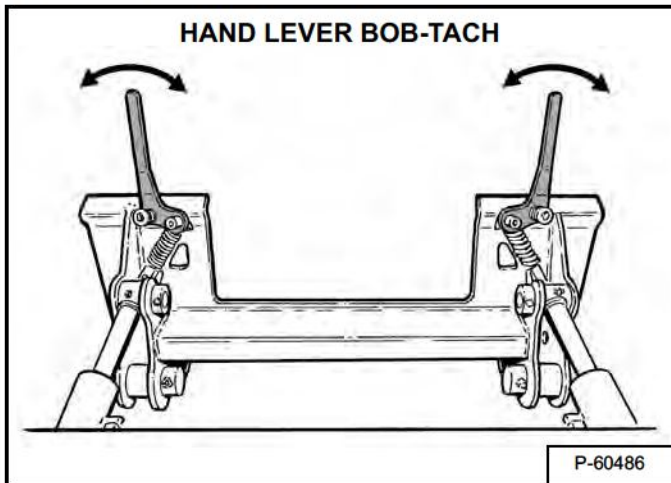

Move the Bob-Tach levers to engage and disengage the wedges [Figure 10-20-1]. The levers and wedges must move freely.

Figure 10-20-2

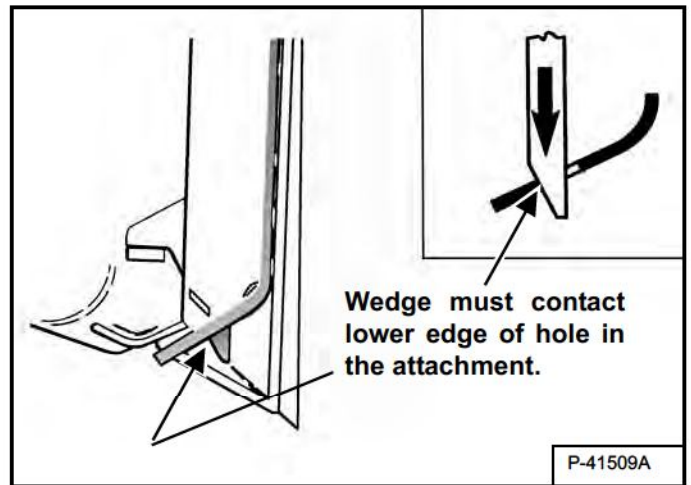

The wedges must extend through the holes in the attachment mounting frame [Figure 10-20-2].

If the wedge does not contact the lower edge of the hole [Figure 10-20-2], the attachment will be loose and can come off the Bob-Tach.

Figure 10-20-3

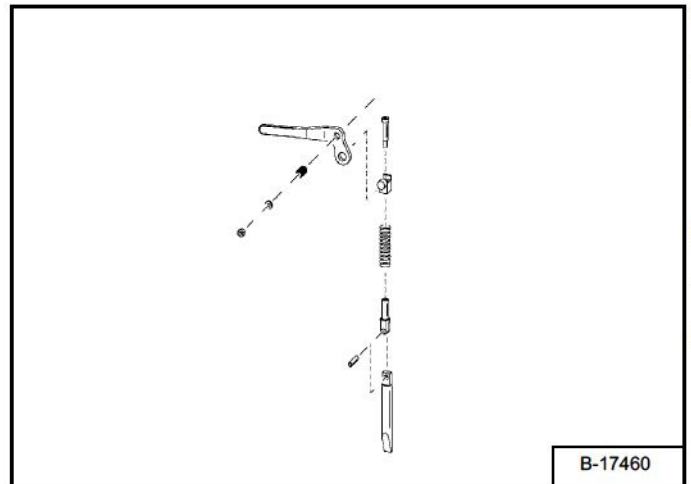

Inspect the mounting frame on the attachment and the Bob-Tach, linkages and wedges for excessive wear or damage [Figure 10-20-3]. Replace any parts that are damaged, bent or missing. Keep all fasteners tight.

Look for cracked welds. Contact your Bobcat dealer for repair or replacement parts.

Lubricate the wedges. (See the machine's Operation & Maintenance Manual for correct lubrication procedures.)

Dealer Copy -- Not for Resale

INSPECTION (CONT'D)

Power Bob-Tach Inspection

! WARNING

Bob-Tach wedges must extend through the holes in attachment. Lever(s) must be fully down and locked. Failure to secure wedges can allow attachment to come off and cause injury or death.

W-2102-0497

Figure 10-20-4

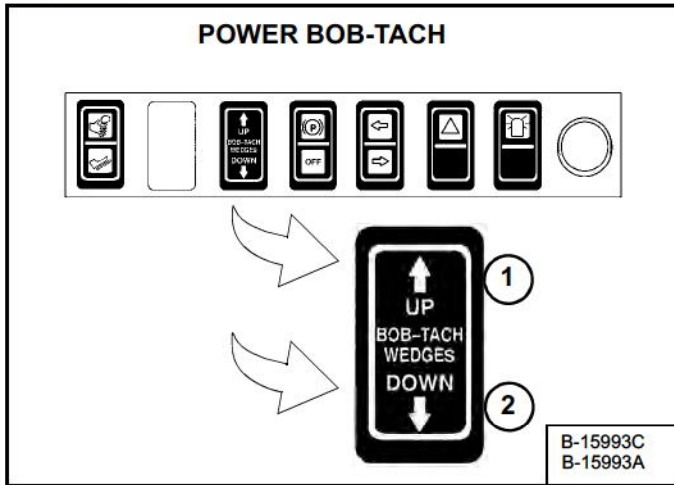
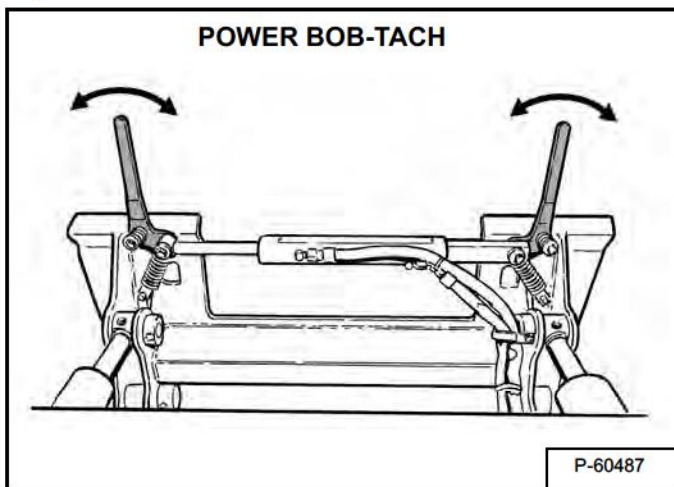

Figure 10-20-5



Push and hold the BOB-TACH WEDGES UP switch (Item 1) until the wedges are fully raised. Push and hold the BOB-TACH WEDGES DOWN switch (Item 2) [Figure 10-20-4] until the wedges are fully lowered.

The levers and wedges must move freely [Figure 10-20-5].

Figure 10-20-6

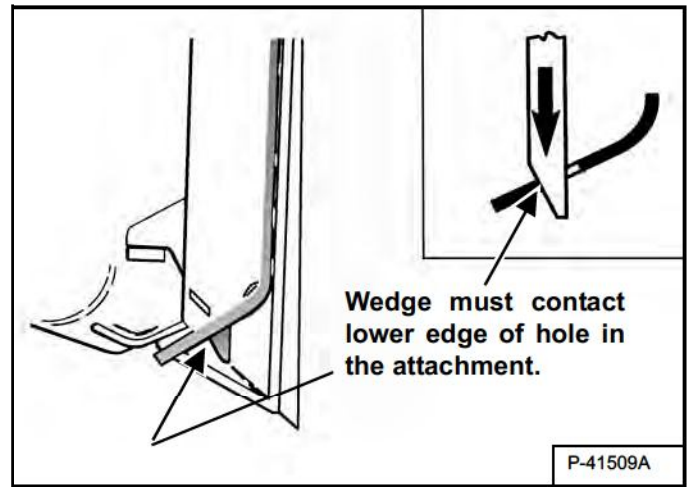

The wedges must extend through the holes in the attachment mounting frame [Figure 10-20-6].

If the wedge does not contact the lower edge of the hole [Figure 10-20-6], the attachment will be loose and can come off the Bob-Tach.

Figure 10-20-7

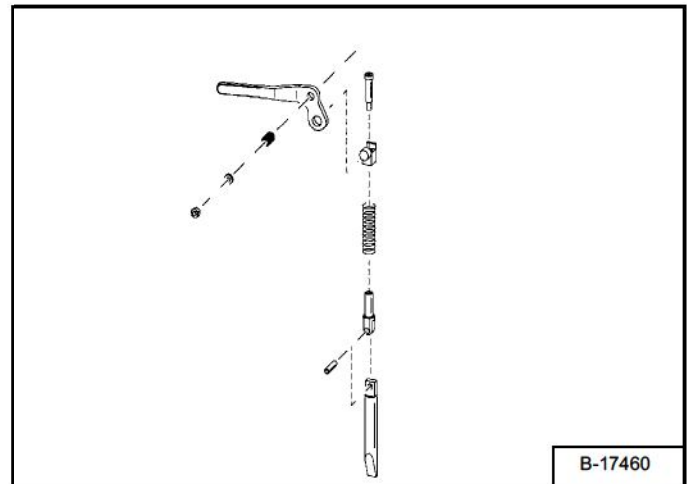

Inspect the mounting frame on the attachment and the Bob-Tach, linkages and wedges for excessive wear or damage [Figure 10-20-7]. Replace any parts that are damaged, bent or missing. Keep all fasteners tight.

Look for cracked welds. Contact your Bobcat dealer for repair or replacement parts.

Lubricate the wedges. (See the machine's Operation & Maintenance Manual for correct lubrication procedures.)

Thank you so much for reading.
Please click the “Buy Now!”
button below to download the
complete manual.



After you pay.

You can download the most
perfect and complete manual in
the world immediately.

Our support email:

ebooklibonline@outlook.com