

1. Trim along dashed line.
2. Slide into pocket on Binder Spine.

TYPE 1-4

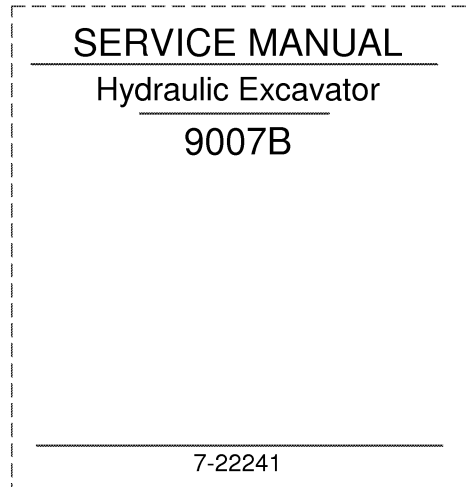

1. Trim along dashed line.
2. Slide into pocket on Binder Spine.

TYPE 1-4

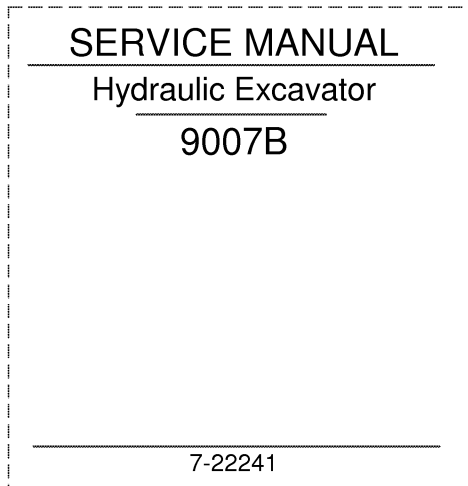

1. Trim along dashed line.
2. Slide into pocket on Binder Spine.

TYPE 1-4

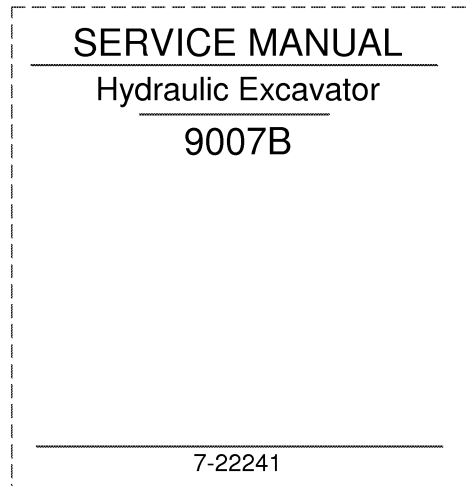

1. Trim along dashed line.
2. Slide into pocket on Binder Spine.

TYPE 1-4

9007B HYDRAULIC EXCAVATOR

Table of contents

DIVISION/SECTION	SECTION N°	REFERENCE N°
1 GENERAL		
Safety, general information and torque specifications	1001	7-21930GB
Specifications	1002	7-23020
2 ENGINE		
Engine removal and installation	2000	7-21950GB
Radiator and oil cooler	2001	7-21960GB
Diesel engine specifications details	2402	
3 FUEL SYSTEM		
4 ELECTRICAL		
Electrical schematics	4001	7-22810
Battery testing, maintenance and booster battery connections	4002	7-22000GB
5 STEERING		
Tracks, rollers and idlers	5002	7-22020GB
6 POWER TRAIN		
Travel motor and travel reduction gear	6002	7-22030GB
Swing motor and swing reduction gear	6003	7-22041GB
7 BRAKES		
8 HYDRAULICS		
Cleaning the hydraulic system	8000	7-22050GB
Hydraulic schematic, inspections, adjustments and troubleshooting	8001	7-22820
Hydraulic pump	8002	7-22070GB
Attachment, swing and travel control valves	8003	7-22081GB
Attachment and dozer blade cylinders	8004	7-22090GB
Hand control valves, foot control valves, shuttle valve, travel shuttle valve and accumulator	8005	7-22100GB
Electro-control valve block	8006	7-22110GB
Cushion valve	8007	7-22120GB
Auxiliary hydraulics	8008	
Hydraulic pilot filter, hydraulic inline filter and bypass oil filter	8011	
Hydraulic swivel	8013	7-22150GB
9 MOUNTED/EQUIPMENT		
Upperstructure and turntable bearing	9002	7-22160GB
Boom, arm, bucket and blade	9003	7-22170GB
Seat mounting and belts	9004	
Cab and cab equipment	9005	7-26100
Air conditioner troubleshooting	9006	
Air conditioner system service	9008	
Air conditioner components service	9009	
Hydraulic and electrical schematics foldout	in rear pocket	7-22611
Hydraulic and electrical schematics foldout (options)	in rear pocket	

Sections to be distributed at a later date

Reprinted

Section

1001

SAFETY, GENERAL INFORMATION AND TORQUE SPECIFICATIONS

GENERAL INFORMATION

Cleaning

Clean all metal parts except bearings, in a suitable cleaning solvent or by steam cleaning. Do not use caustic soda for steam cleaning. After cleaning, dry and put oil on all parts. Clean oil passages with compressed air. Clean bearings in a suitable cleaning solvent, dry the bearings completely and put oil on the bearings.

Inspection

Check all parts when the parts are disassembled. Replace all parts that have wear or damage. Small scoring or grooves can be removed with a hone or crocus cloth. Complete a visual inspection for indications of wear, pitting and the replacement of parts necessary to prevent early failures.

Bearings

Check bearings for easy action. If bearings have a loose fit or rough action replace the bearing. Wash bearings with a suitable cleaning solvent and permit to air dry. DO NOT DRY BEARINGS WITH COMPRESSED AIR.

Needle bearings

Before you press needle bearings in a bore always remove any metal protrusions in the bore or edge of the bore. Before you press bearings into position put petroleum jelly on the inside and outside diameter of the bearings.

Gears

Check all gears for wear and damage. Replace gears that have wear or damage.

Oil seals, O-rings and gaskets

Always install new oil seals, O-rings and gaskets. Put petroleum jelly on seals and O-rings.

Shafts

Check all shafts that have wear or damage. Check the bearing and oil seal surfaces of the shafts for damage.

Service parts

Always install genuine Case service parts. When ordering refer to the Parts Catalog for the correct part number of the genuine Case replacement items. Failures due to the use of other than genuine Case replacement parts are not covered by warranty.

Lubrication

Only use the oils and lubricants specified in the Operator's or Service Manuals. Failures due to the use of non-specified oils and lubricants are not covered by warranty.

SAFETY



This symbol means ATTENTION! BECOME ALERT! YOUR SAFETY IS INVOLVED. The message that follows the symbol contains important information about safety. Carefully read the message. Make sure you fully understand the causes of possible injury or death.

To prevent injury always follow the Warning, Caution and Danger notes in this section and throughout the manual.

Put the warning tag shown below on the key for the keyswitch when servicing or repairing the machine. One warning tag is supplied with each machine. Additional tags Part Number 331-4614 are available from your service parts supplier.

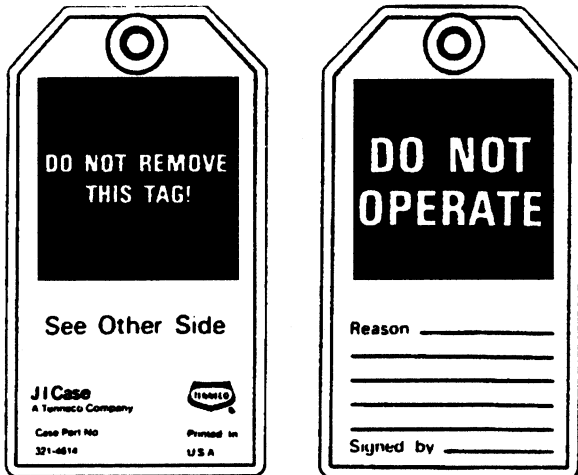

JS00480A



WARNING: Read the operator's manual to familiarize yourself with the correct control functions.



WARNING: Operate the machine and equipment controls from the seat position only. Any other method could result in serious injury.



WARNING: This is a one man machine, no riders allowed.



WARNING: Before starting engine, study Operator's Manual safety messages. Read all safety signs on machine. Clear the area of other persons. Learn and practice safe use of controls before operating.

It is your responsibility to understand and follow manufacturers instructions on machine operation, service and to observe pertinent laws and regulations. Operator's and Service Manuals may be obtained from your Case dealer.



WARNING: If you wear clothing that is too loose or do not use the correct safety equipment for your job, you can be injured. Always wear clothing that will not catch on objects. Extra safety equipment that can be required includes hard hat, safety shoes, ear protection, eye or face protection, heavy gloves and reflector clothing.



WARNING: When working in the area of the fan belt with the engine running, avoid loose clothing if possible, and use extreme caution.



WARNING: When doing checks and tests on the equipment hydraulics, follow the procedures as they are written. DO NOT change the procedure.



WARNING: When putting the hydraulic cylinders on this machine through the necessary cycles to check operation or to remove air from a circuit, make sure all people are out of the way.

Thank you so much for reading.
Please click the “Buy Now!”
button below to download the
complete manual.



After you pay.

You can download the most
perfect and complete manual in
the world immediately.

Our support email:

ebooklibonline@outlook.com