



Service Repair Manual

Model

228 SKID STEER LOADER

Product: SKID STEER LOADER

Model: 228 SKID STEER LOADER 6BZ

Configuration: 216 226 228 Skid Steer Loader 6BZ00001-00699 (MACHINE) POWERED BY 3034 Engine

Disassembly and Assembly 3034 Engine for Caterpillar Built Machines

Media Number -SEN5013-08

Publication Date -01/11/2008

Date Updated -14/11/2008

i01606459

Governor - Assemble

SMCS - 1264-016

Assembly Procedure

Note: The components for the governor assembly are located in the engine front housing.

Assemble the Linkage for the Fuel Injection Pump

Note: The linkage for the fuel injection pump contains two levers. One lever is for the governor control and the other lever is for the fuel control.

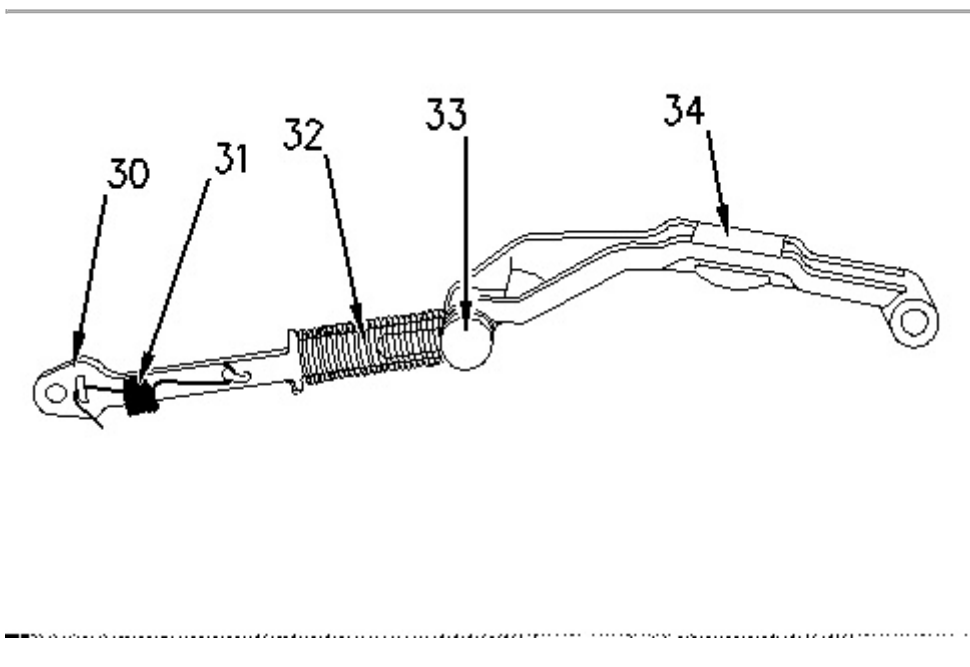

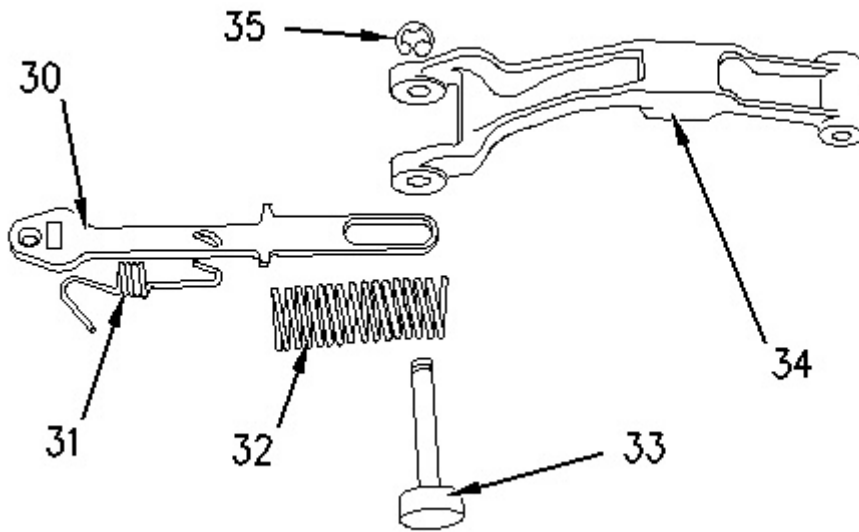

Illustration 2

g00658162

1. If the governor control lever was disassembled, then you must perform the following procedure in order to assemble the governor control lever.
 - a. Install spring (31) onto link (30) .
 - b. Install spring (32) onto link (30) and compress the spring.
 - c. While spring (32) is compressed, pin (33) is installed through link (30) into lever (34). After the pin is installed, release the spring tension.
 - d. Install circlip (35) onto the end of pin (33) .
-

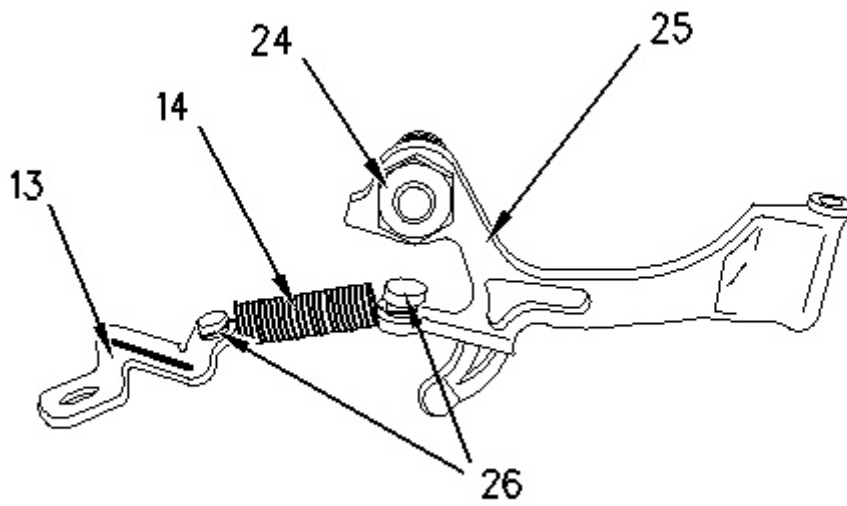

Illustration 3

g00658136

Fuel control lever

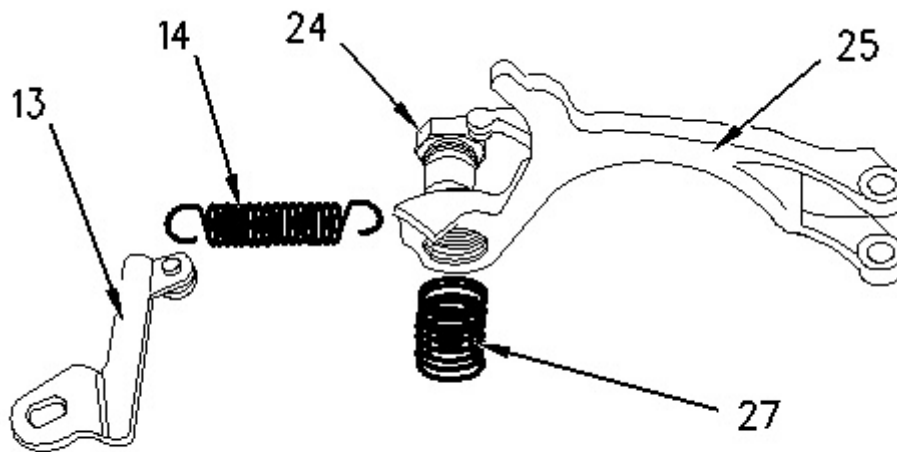

Illustration 4

g00658147

2. If the fuel control lever was disassembled, then you must perform the following procedure in order to assemble the fuel control lever.
-

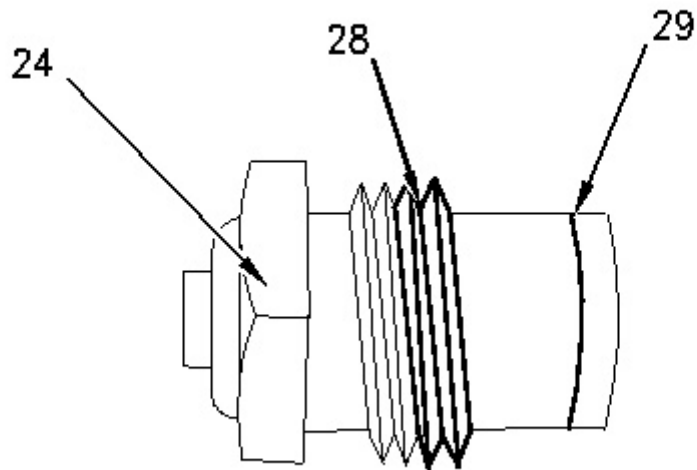
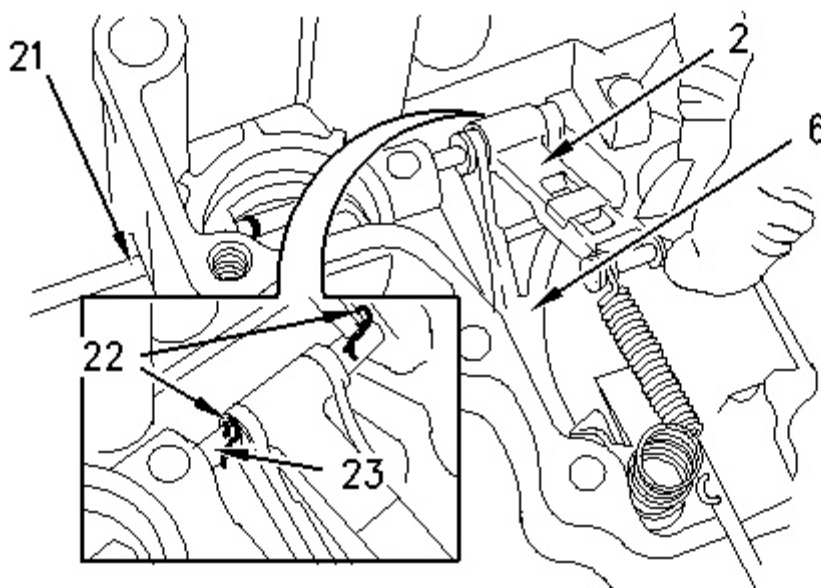

Illustration 5

g00658290

- a. Apply **9S-3263** Thread Lock Compound to the first two threads (28) of the Angleich unit (torque control) (24). Ensure that the thread lock compound does not enter the joint for the spring (29) .
- b. Install the Angleich unit (torque control) (24) into lever (25). Tighten the Angleich unit (torque control) to a torque of 15 N·m (133 lb in).
- c. Carefully install spring (27) on the Angleich unit (torque control) (24) .
Note: Ensure that the closed coils of the spring are installed toward the lever.
- d. Install spring (14) onto pin (26) that is located at the end of lever (25). Install spring (14) onto pin (26) that is located on the end of lever (13) .



Thank you so much for reading.
Please click the “Buy Now!”
button below to download the
complete manual.



After you pay.

You can download the most
perfect and complete manual in
the world immediately.

Our support email:

ebooklibonline@outlook.com