

TM2152 - 317 and 320 Skid Steer Loader CT322 Compact Track Loader Front or Rear Idler Remove and Install

Front or Rear Idler Remove and Install

1. Park machine on a flat level surface.
2. Raise and block compact track loader. [See Raising and Blocking Machine](#) . (Operator's Manual.)
3. Remove rubber track. [See Rubber Track Remove and Install](#) . (Group 0130.)

4.



CAUTION:

Heavy component; use a hoist.

Item	Measurement	Specification
Front or Rear Idler	Weight	33.5 kg (74 lb) approximate



CAUTION:

Support idler (1) before removing cap screws (2). Idler will drop once cap screws have been removed.

Remove cap screws (2) holding idler (1) in place.

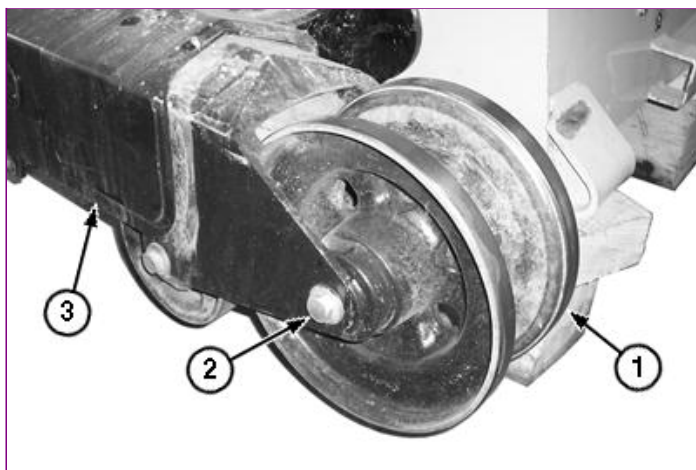

T212588A-UN: Front Idler Remove and Install

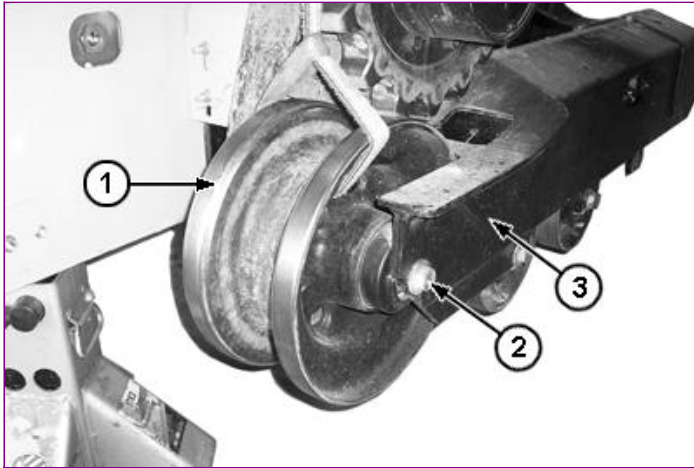

T212249A-UN: Rear Idler Remove and Install

LEGEND:

- 1 - Idler
- 2 - Cap Screw (2 used)
- 3 - Track Frame

5. Using a shop hoist, remove idler from track frame.
6. Repair or replace as necessary. [See Front or Rear Idler Disassemble and Assemble](#) . (Group 0130.)
7. Apply threadlock and sealer (medium strength) to threads of cap screws.
8. Install rear idler into track frame.
9. Tighten cap screws.

Item	Measurement	Specification
Front or Rear Idler		
Cap Screw	Torque	592—696 N·m (437—513 lb-ft)

10. Install rubber track. [See Rubber Track Remove and Install](#) . (Group 0130.)
11. Adjust track sag. [See Check and Adjust Track Sag](#) . (Group 9020-25.)
12. Raise machine and remove blocking. [See Raising and Blocking Machine](#) . (Operator's Manual.)

**TM2152 - 317 and 320 Skid Steer Loader CT322 Compact Track Loader
Front or Rear Idler Disassemble and Assemble**

Front or Rear Idler Disassemble and Assemble

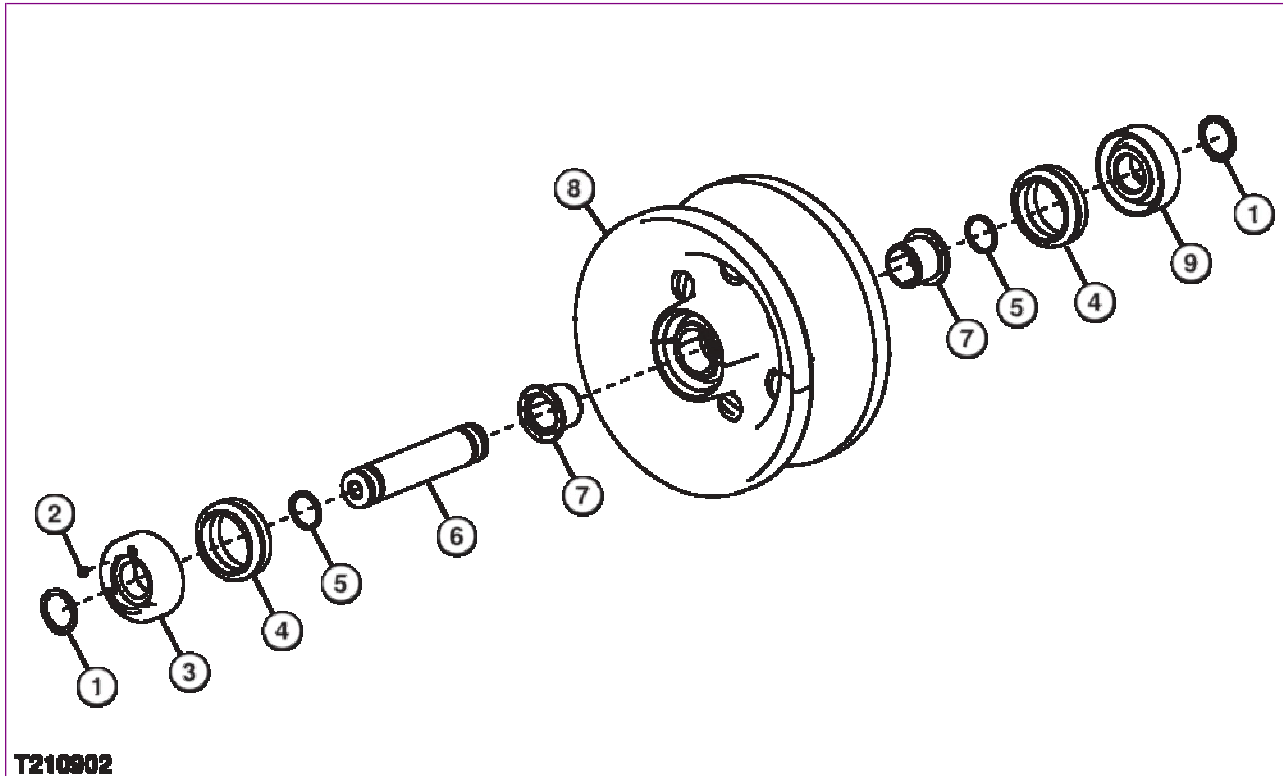

T210902

T210902-UN: Front or Rear Idler

LEGEND:

- 1 - Snap Ring (2 used)
- 2 - Plug
- 3 - Collar (with Plug Hole)
- 4 - Metal Face Seal (2 used)
- 5 - O-Ring (2 used)
- 6 - Axle Shaft
- 7 - Bushing (2 used)
- 8 - Idler
- 9 - Collar

1.



CAUTION:

Heavy component; use a hoist.

Item	Measurement	Specification
Front or Rear Idler	Weight	33.5 kg (74 lb) approximate

Remove plug (2) and drain oil from idler.

2. Remove snap rings (1) from both ends of axle shaft (6).
3. Press axle shaft from idler (8).
4. Press remaining collar (9) from axle shaft.

5. **NOTE:**

If bushings (7) are worn or damaged complete idler must be replaced.

Inspect idler bushings (7) and axle shaft. Replace idler if bushings or axle shaft are worn or damaged.

6. **IMPORTANT:**

Metal face seals can be reused if they are not worn or damaged. A used seal must be kept together as a set because of wear patterns on seal ring face.

Remove metal face seals (4) from idler and collar. Keep seal rings together as a matched set with seal ring faces together to protect surfaces.

7. Inspect metal face seals. [See Inspect Metal Face Seals](#) . (Group 0130.) For seals that will be reused, put a piece of cardboard between seal rings to protect seal face.
8. Remove O-rings (5) from axle shaft.

9. Install new O-rings on axle shaft.

10. Install snap ring on one end of axle shaft.

11. Tap axle shaft into collar (9).

12. **IMPORTANT:**

Metal face seal O-rings and seat surfaces for O-rings must be clean, dry, and oil free so O-rings do not slip when roller is turning.

Thoroughly clean O-ring and seat surfaces using volatile, non-petroleum base solvent and lint-free tissues.

13. Wipe finger prints and foreign material off seal ring face using clean oil and lint-free tissues.

14. Apply a thin film of oil to each seal ring face.

15. Install metal face seals in collars and idler. Apply equal pressure with fingers at four equally spaced points on seal face. Seal must "pop" down into place so O-ring is tight against seal bore. A volatile, non-petroleum base solvent or talcum powder may be used as a lubricant.

16. Tap axle shaft into idler.

17. Install collar (3) on axle shaft.

18. Support axle shaft and press on collar (3) to install snap ring.

19. Fill idler with 225 mL (7.6 oz) of SAE 80W-90 gear oil meeting API Service GL-5. Use graduated beaker or syringe to fill idler housing.

Item	Measurement	Specification
Front or Rear Idler		
Idler Gear Oil	Capacity	225 mL (7.6 oz)

20. Clean threads of plug. Apply cure primer.

21. Apply pipe sealant to plug threads. Install and tighten plug.

Item	Measurement	Specification
Front or Rear Idler		
Plug	Torque	21—26 N·m (16—19 lb-ft.)

TM2152 - 317 and 320 Skid Steer Loader CT322 Compact Track Loader Test Front or Rear Idler for Leakage

Test Front or Rear Idler for Leakage

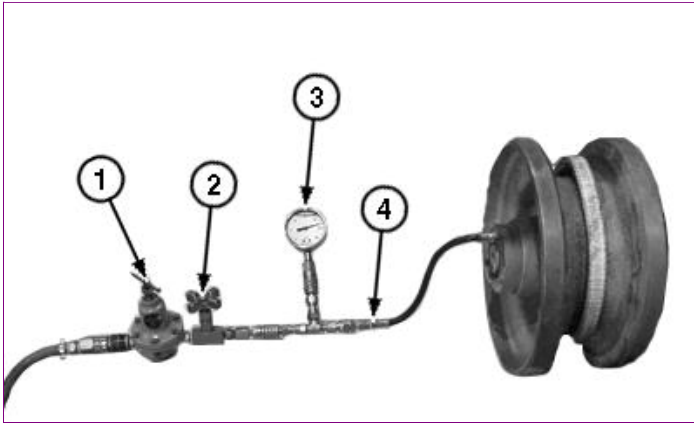

T213175A-UN: Idler Oil Leakage Test Components

LEGEND:

- 1 - Air Pressure Regulator
- 2 - Snubber (Needle) Valve
- 3 - Pressure Gauge
- 4 - Adapter Fittings and Hose to Connect to Track Roller

1.



CAUTION:

Heavy component; use a hoist.

Item	Measurement	Specification
Front or Rear Idler	Weight	33.5 kg (74 lb) approximate

Hold axle assembly and rotate idler several turns to seat metal face seals.

2. Remove plug.
3. Install parts (1—4).
4. Slowly pressurize oil cavity using air.

Item	Measurement	Specification
Front or Rear Idler		
Oil Cavity Air Test	Pressure	160 kPa (1.6 bar) (23 psi)

5. Close valve and wait for a minimum of 30 seconds. Check for oil leakage. Check gauge to see if air pressure has decreased.
6. If there is leakage, disassemble idler and replace parts as necessary. [See Front or Rear Idler Disassemble and Assemble](#) . (Group 0130.)
7. Clean threads of plug. Apply cure primer.
8. Apply pipe sealant to threads. Install plug.

Item	Measurement	Specification
------	-------------	---------------

Thank you so much for reading.
Please click the “Buy Now!”
button below to download the
complete manual.



After you pay.

You can download the most
perfect and complete manual in
the world immediately.

Our support email:

ebooklibonline@outlook.com