

John Deere C381 and C392 Spin Spreaders



OPERATOR'S MANUAL



John Deere Welland Works
OMCC16360 Issue F2
LITHO IN U.S.A. (REVISED)



OPENING REMARKS

You may have purchased a C 381 or C 392 Spin Spreader because it is most suited to your requirements.

Equally you may have chosen this machine for its appearance and its simplicity.

We know that, with careful service, you will wish to clean your Spreader after use. To help you in this essential operation we have designed this machine to be dismantled without a single tool.

Read the Operator's Manual carefully before putting the Spreader to work. Follow the setting instructions and service instructions which are given and you can be certain to get the best results from your machine.

If, in time, you require Spare Parts order them from your Dealer and give him the serial number of your machine, which we advise you to insert in the space below.

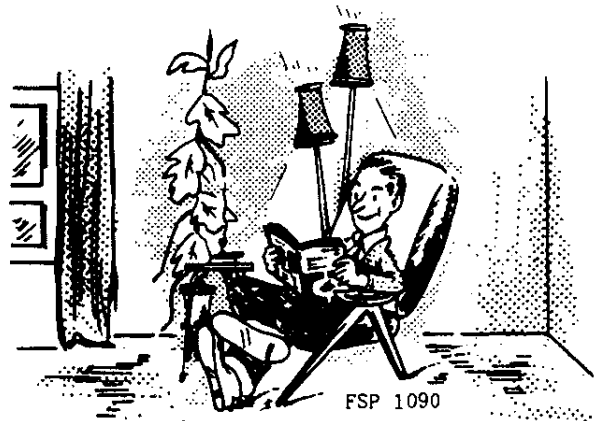

Serial Number: _____
 (situated on the frame cross member)

CONTENTS

	Page		Page
General VIEW	1	SERVICE	7
OPERATION	2	LUBRICATION	8
Before starting work	2	ASSEMBLY INSTRUCTIONS	9
Hitching to the tractor	2	Main frame	9
Drive	2	Gearbox	9
Important checks	3	Hopper	10
Starting work	4	Cover	11
Selection lever	5	Spreading rate control	11
Correction lever	5	SPECIFICATIONS	12
Spreading rate adjustment	5		
Distribution tables	6		

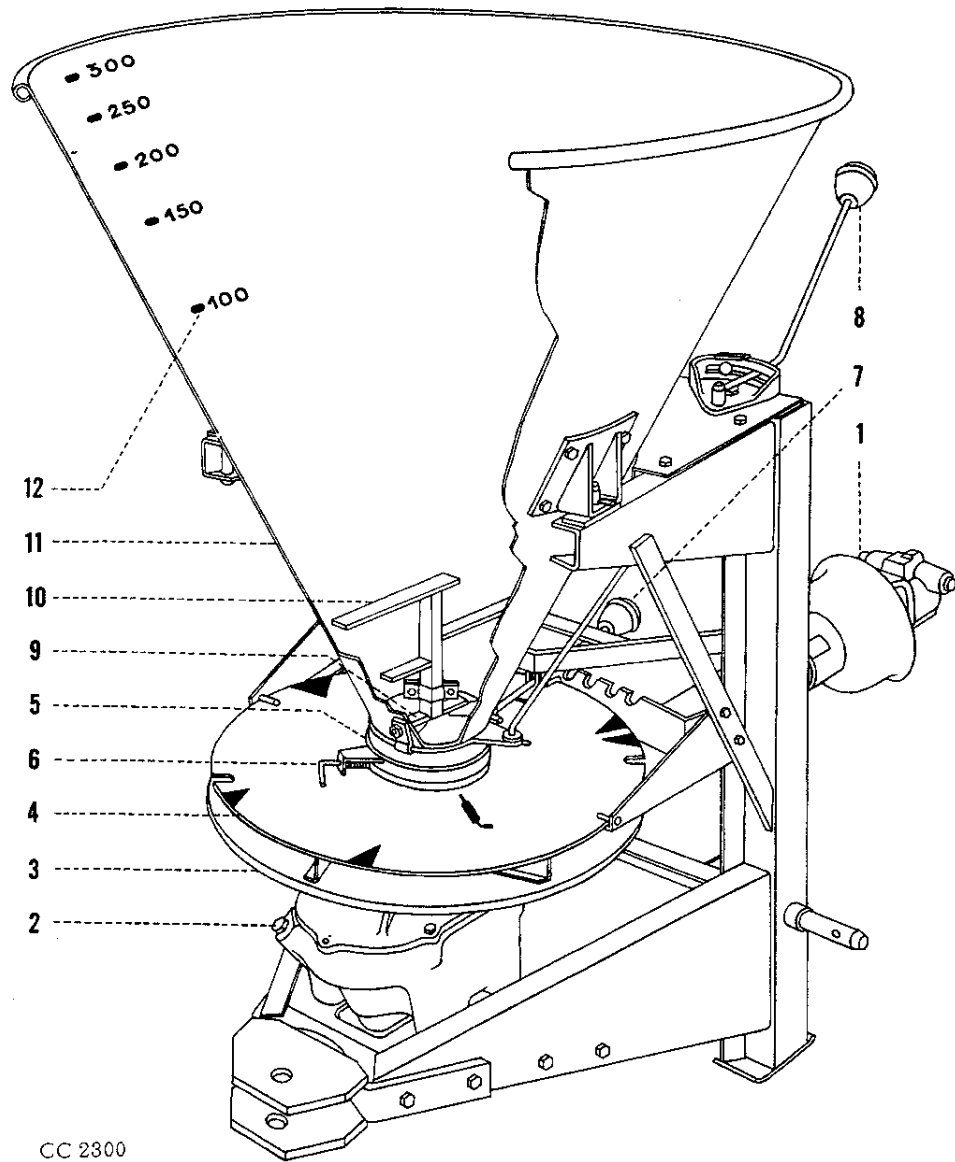

CC 2300

Fig. 1 — Sectioned view of the Spin Spreader

- 1 - Drive
- 2 - Gearbox
- 3 - Spreader disc
- 4 - Disc cover
- 5 - Delivery control
- 6 - Delivery control lever
- 7 - Spread correction lever

- 8 - Operating lever
- 9 - Hopper bottom scraper
- 10 - Agitator
- 11 - Hopper
- 12 - Indication of the maximum load in pounds



OPERATION

Before starting work.

Before putting your spreader to work, give it a general lubrication and check the oil level in the gearbox according to the instructions of the lubrication chart. Check the tightness of all nuts and bolts.

Hitching to the tractor.

A) - C 381.

Your C 381 Spin Spreader is fitted with a 3 point linkage for Cat. I or II.

With a 3 point linkage, Cat. I: hitch the machine directly on the 3 point linkage.

With a 3 point linkage, Cat. II: use the 3 bushings supplied with the machine.

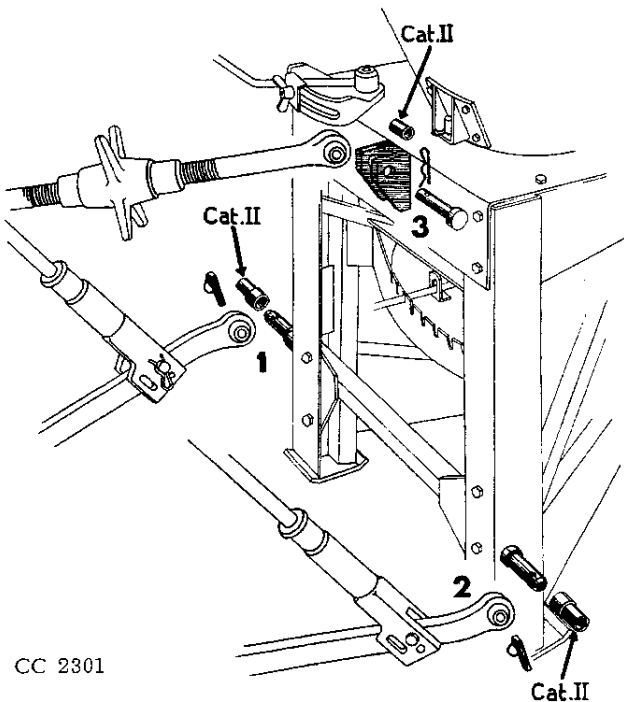

Fig. 2 — Mounting on the three point linkage

B) - C 392.

Your C 392 Spin Spreader can be hitched on a 3 point linkage, Cat. II only.

IMPORTANT:

Do not forget to lock the lift links after hitching the spreader.

Drive.

It is essential to adjust the length of the drive shaft according to the individual tractor to be used. Make sure that the telescopic tubes do not bottom when the linkage is fully raised as this can cause damage to the bearings, the P. T. O. shaft and even to the gearbox.

The minimum distance between the ends of the tubes and the yokes of the universal joint must be $25/32''$ (20 mm).

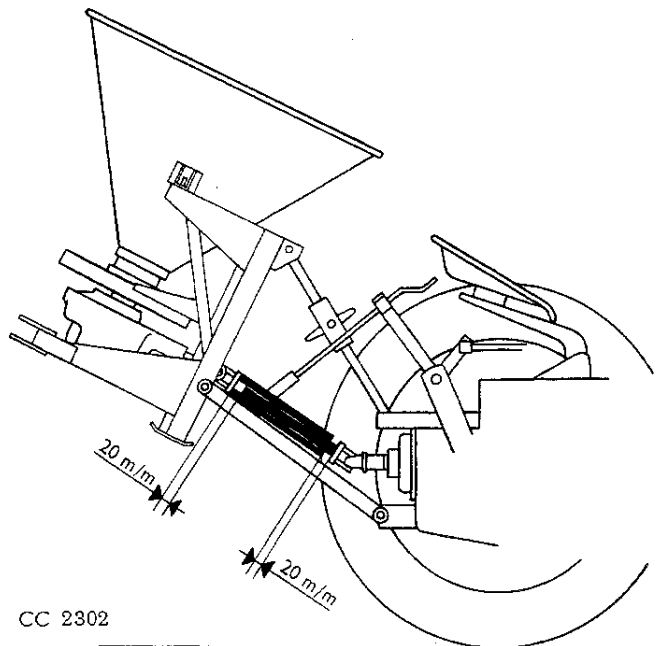

Fig. 3 — Setting the drive 1 : 0,78 in (20 mm)

To shorten the drive shaft, it is essential that you cut the same amount from both inner and outer tubes (L). Clean up the ends of the tubes with a file and grease the working surfaces.

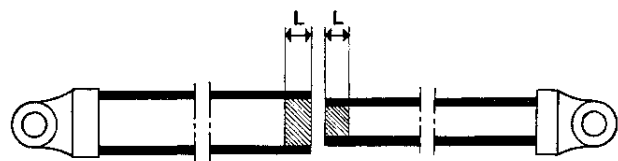

Fig. 4 — Reducing the length of the telescopic shafts

Important Checks.

After attaching the spreader, make sure that the spinner disc is absolutely horizontal when it is at a height of 27 1/2" (0,70 m) above the ground. If necessary, adjust the lift links of the 3 point linkage accordingly.

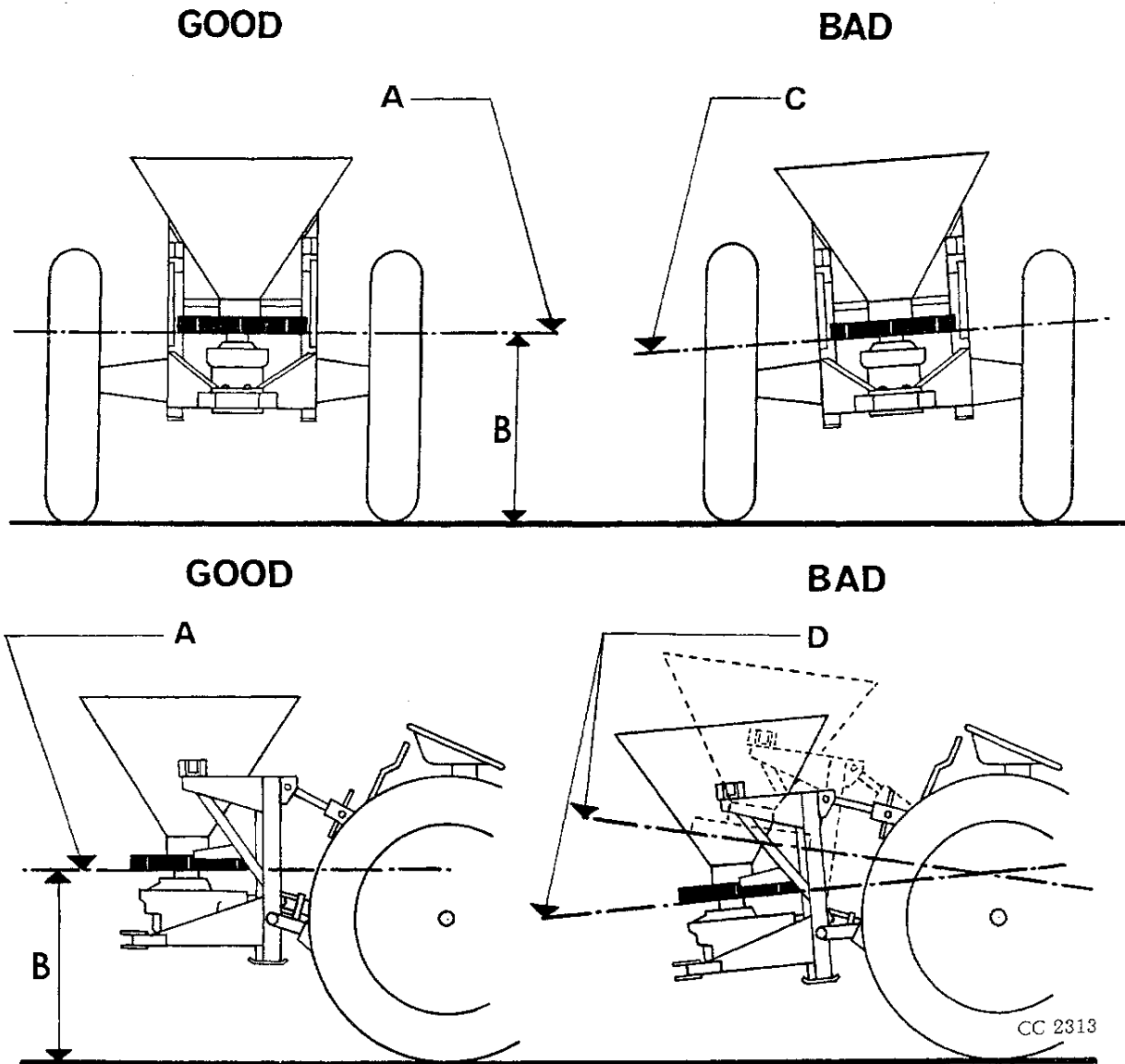

Fig. 5 — Positions in relations to the ground

A = The disc must be horizontal
B = 27 - 1/2" (0,70 m)

C = Disc not horizontal
D = Disc not horizontal

NOTE:

See from the side, the disc must be absolutely horizontal. Otherwise, vibrations may occur which could cause drive or gearbox failures.

Thank you so much for reading.
Please click the “Buy Now!”
button below to download the
complete manual.



After you pay.

You can download the most
perfect and complete manual in
the world immediately.

Our support email:

ebooklibonline@outlook.com