

# FS22 FELLING HEAD OPERATOR'S MANUAL

(Serial No. WCFS22X002066-- )

## OPERATOR'S MANUAL FS22 FELLING HEAD OMF382858 H2 (ENGLISH)

CALIFORNIA  
Proposition 65 Warning

Diesel engine exhaust and some of its constituents are known to the State of California to cause cancer, birth defects, and other reproductive harm.

If this product contains a gasoline engine:

 **WARNING**

The engine exhaust from this product contains chemicals known to the State of California to cause cancer, birth defects or other reproductive harm.

The State of California requires the above two warnings.

**Worldwide Construction  
And Forestry Division**  
(This manual replaces F381472, F381858, F381478)  
LITHO IN U.S.A.

# Introduction

## Foreword

READ THIS MANUAL carefully to learn how to operate and service your machine correctly. Failure to do so could result in personal injury or equipment damage. This manual and safety signs on your machine may also be available in other languages. (See your dealer to order.)

THIS MANUAL SHOULD BE CONSIDERED a permanent part of your machine and should remain with the machine when you sell it.

MEASUREMENTS in this manual are given in both metric and customary U.S. unit equivalents. Use only correct replacement parts and fasteners. Metric and inch fasteners may require a specific metric or inch wrench.

RIGHT-HAND AND LEFT-HAND sides are determined by facing in the direction of forward travel.

WRITE PRODUCT IDENTIFICATION NUMBERS (P.I.N.) in the Machine Numbers section. Accurately record all the numbers to help in tracing the machine

should it be stolen. Your dealer also needs these numbers when you order parts. File the identification numbers in a secure place off the machine.

WARRANTY is provided as part of the manufacturer's support program for customers who operate and maintain their equipment as described in this manual. The warranty is explained on the warranty certificate which you should have received from your dealer.

This warranty provides you the assurance that the manufacturer will back its products where defects appear within the warranty period. In some circumstances, the manufacturer also provides field improvements, often without charge to the customer, even if the product is out of warranty. Should the equipment be abused, or modified to change its performance beyond the original factory specifications, the warranty will become void and field improvements may be denied. Setting fuel delivery above specifications or otherwise overpowering machines will result in such action.

TX,DH2120 -19-11DEC95-1/1

### Technical Information Feedback Form

We need your help to continually improve our technical publications. Please copy this page and FAX or mail your comments, ideas and improvements.

**SEND TO:** Waratah  
P.O. Box 160  
Woodstock, Ontario, Canada, N4S 7X1  
Attn: Supervisor - Technical Manuals

**FAX NUMBER:** 1-519-537-2664

Ideas, Comments (Please State Page Number): \_\_\_\_\_

\_\_\_\_\_

\_\_\_\_\_

\_\_\_\_\_

\_\_\_\_\_

\_\_\_\_\_

\_\_\_\_\_

\_\_\_\_\_

\_\_\_\_\_

\_\_\_\_\_

\_\_\_\_\_

\_\_\_\_\_

\_\_\_\_\_

\_\_\_\_\_

\_\_\_\_\_

\_\_\_\_\_

\_\_\_\_\_

\_\_\_\_\_

\_\_\_\_\_

\_\_\_\_\_

\_\_\_\_\_

\_\_\_\_\_

\_\_\_\_\_

OVERALL, how would you rate the quality of this publication? (Check one)

1	Poor	2	3	Fair	4	5	Good	6	7	Very Good	8	9	Excellent	10
---	------	---	---	------	---	---	------	---	---	-----------	---	---	-----------	----

Company Name: \_\_\_\_\_

Technician Name: \_\_\_\_\_

Address: \_\_\_\_\_

Phone: \_\_\_\_\_

Fax No.: \_\_\_\_\_

Dealer Acct. No.: \_\_\_\_\_

**THANK YOU!**

# Contents

	Page		Page
<b>Safety - Safety Features</b>			
FS Series Felling Head Safety Features . . . . .	1-1-1		
<b>Safety — General Precautions</b>			
Recognize Safety Information . . . . .	1-2-1		
Follow Safety Instructions . . . . .	1-2-1		
Operate Only If Qualified . . . . .	1-2-1		
Wear Protective Equipment . . . . .	1-2-2		
Avoid Unauthorized Attachment			
Modifications . . . . .	1-2-2		
Stay Clear Of Moving Parts . . . . .	1-2-2		
Avoid High-Pressure Fluids . . . . .	1-2-3		
Prepare for Emergencies . . . . .	1-2-3		
Control Pattern . . . . .	1-2-3		
Handle Chemical Products Safely . . . . .	1-2-4		
Dispose Of Waste Properly . . . . .	1-2-4		
<b>Safety — Operating Precautions</b>			
Keep Riders Off Machine . . . . .	1-3-1		
Operate Booms with Care . . . . .	1-3-1		
Add And Operate Attachments Safely . . . . .	1-3-2		
Avoid Power Lines . . . . .	1-3-2		
<b>Safety — Maintenance Precautions</b>			
Park And Prepare For Service Safely . . . . .	1-4-1		
Use Proper Lifting Equipment . . . . .	1-4-1		
Remove Paint Before Welding or Heating . . . . .	1-4-2		
Make Welding Repairs Safely . . . . .	1-4-2		
Drive Metal Pins Safely . . . . .	1-4-2		
<b>Safety Signs - FS22 Felling Head</b>			
FS22 Safety Sign Location . . . . .	1-5-1		
<b>Felling Head Components</b>			
FS22 Series Felling Head Components . . . . .	2-1-1		
<b>Saw Drive — FS Series Felling Head</b>			
Saw Drive Components . . . . .	2-2-1		
Saw Drive Description . . . . .	2-2-2		
Disc Saw Blade Description . . . . .	2-2-3		
Disc Saw Blade and Tooth Data . . . . .	2-2-3		
<b>Operation — FS22 Felling Head</b>			
Basic Operation . . . . .	2-3-1		
Principle of Operation . . . . .	2-3-1		
Blade Feeding Speed . . . . .	2-3-1		
General Method of Operation . . . . .	2-3-2		
Stopping the Disc Saw Blade . . . . .	2-3-3		
Cutting Multiple Trees . . . . .	2-3-3		
Handling The Tree . . . . .	2-3-5		
<b>Periodic Maintenance — FS Head</b>			
Periodic Maintenance Table . . . . .	3-1-1		
Maintenance — General . . . . .	3-1-2		
Tools Required . . . . .	3-1-3		
<b>Maintenance — Every 8 Hours — FS Head</b>			
Locking Bolt Storage . . . . .	3-2-1		
Visually Inspect All Bolts . . . . .	3-2-1		
Check All Hydraulic Hoses and Fittings . . . . .	3-2-2		
Lubricate All Grease Fittings . . . . .	3-2-3		
Check Saw Tooth Bolt Torque . . . . .	3-2-5		
Check Saw Tooth and Disc Saw Blade Condition . . . . .	3-2-6		
Check Driveshaft End Play . . . . .	3-2-10		
Saw Housing Restriction Inspection . . . . .	3-2-11		
<b>Maintenance — Every 125 Hours — FS Head</b>			
Check All Bolt Torques . . . . .	3-3-1		
Check All Hydraulic Hoses and Fittings . . . . .	3-3-4		
Check Disc Saw Blade R.P.M. . . . .	3-3-5		
Check Hydraulic Pressure Setting . . . . .	3-3-6		
Lubricate Driveshaft and Motor Coupling . . . . .	3-3-6		
Clean Saw Motor Area . . . . .	3-3-6		
<b>Maintenance — Every 250 Hours — FS Head</b>			
Perform Overall Visual Inspection . . . . .	3-4-1		
Perform 125 Hour Interval Maintenance Procedures . . . . .	3-4-1		
<b>Maintenance - Unscheduled — FS Head</b>			
Disc Saw Blade Inspection . . . . .	3-5-1		
Saw Tooth Replacement . . . . .	3-5-3		

Continued on next page

*All information, illustrations and specifications in this manual are based on the latest information available at the time of publication. The right is reserved to make changes at any time without notice.*

COPYRIGHT © 2002  
DEERE & COMPANY  
Moline, Illinois  
All rights reserved  
A John Deere ILLUSTRATION® Manual

	<b>Page</b>
Disc Saw Blade Removal . . . . .	3-5-5
Disc Saw Blade Installation . . . . .	3-5-7
Check All Hydraulic Hoses and Fittings . . . . .	3-5-9
Disc Saw Blade Gauge . . . . .	3-5-10
Initial Pump & Motor Startup . . . . .	3-5-13
Initial Saw Speed Adjustment . . . . .	3-5-13
Initial Saw Circuit Begin of Stroke Adjustment and Pressure Setting . . . . .	3-5-13
 <b>Misc. - Saw Speed Sense Equipment</b>	
Saw Speed Sense Equipment . . . . .	4-1-1
Saw Speed Tachometer . . . . .	4-1-2
 <b>Misc. - Troubleshooting — FS20 Felling Head</b>	
Diagnose Disc Saw Blade Stalling . . . . .	4-2-1
 <b>Misc. - Serial Numbers</b>	
Felling Head Serial Numbers . . . . .	4-3-1
Model and Serial Number Record . . . . .	4-3-2
 <b>Misc. - Specifications — FS22 Felling Head</b>	
FS22 Felling Head Dimensions . . . . .	4-3-1
General Specifications — FS22 Felling Head . . . . .	4-3-2
 <b>Misc. — Crime Prevention Tips</b>	
Help Prevent Crime . . . . .	4-4-1
Record Identification Numbers . . . . .	4-4-1
Keep Proof of Ownership . . . . .	4-4-1
Park Indoors Out of Sight . . . . .	4-4-1
When Parking Outdoors . . . . .	4-4-2
Reduce Vandalism . . . . .	4-4-2
Report Thefts Immediately . . . . .	4-4-3

# Safety - Safety Features

## FS Series Felling Head Safety Features

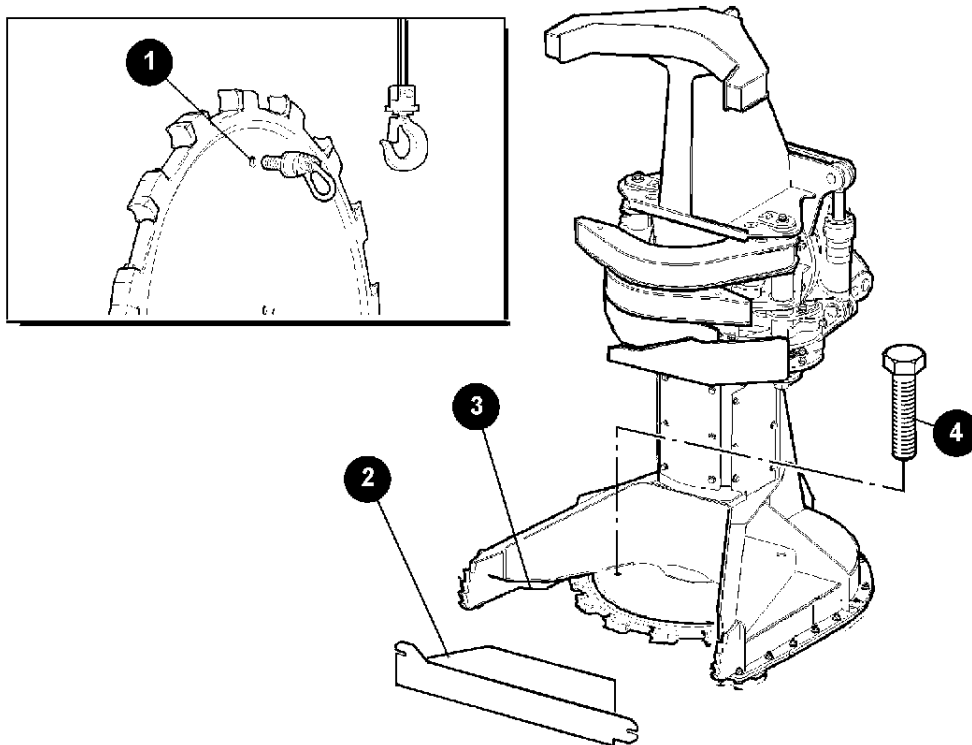

**Please remember, the operator is the key to preventing accidents**

### 1. Disc Saw Blade Lifting Points

Threaded holes in disc saw blade for correct and safe lifting.

### 2. Disc Saw Blade Guard

A disc saw blade guard is easily installed when the unit is not in operation.

### 3. Chip Deflector

Ensures that cutting debris travels in one direction away from the head.

### 4. Disc Saw Rotation Locking Bolt

A disc saw rotation locking bolt is stored on the head.

MR64971,0000003 -19-05DEC01-1/1

T159999 -UN-26APR02

# Safety — General Precautions

## Recognize Safety Information

This is the safety alert symbol. When you see this symbol on your machine or in this manual, be alert for the potential of personal injury.

Follow the precautions and safe operating practices highlighted by this symbol.

A signal word — DANGER, WARNING, or CAUTION — is used with the safety alert symbol. DANGER identifies the most serious hazards.

On your machine, DANGER signs are red in color, WARNING signs are orange, and CAUTION signs are yellow. DANGER and WARNING signs are located near specific hazards. General precautions are on CAUTION labels.



T133555 -UN-28AUG00

T133588 -19-28AUG00

TX03679,00016CC -19-21AUG00-1/1

## Follow Safety Instructions

Read the safety messages in this manual and on the machine. Follow these warnings and instructions carefully. Review them frequently.

Be sure all operators of this machine understand every safety message. Replace operator's manual and safety labels immediately if missing or damaged.

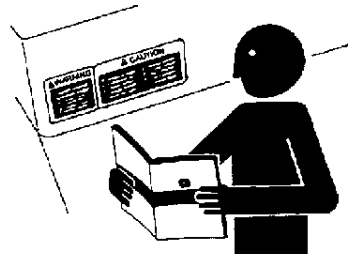

T133556 -UN-24AUG00

TX03679,00016F9 -19-14MAR01-1/1

## Operate Only If Qualified

Do not operate this attachment unless you have read the operator's manual carefully and you have been qualified by supervised training and instruction.

Familiarize yourself with the job site and your surroundings before operating. Try all controls and

attachment functions with the machine in an open area before starting to work.

Know and observe all safety rules that may apply to your work situation and your work site.

TX03679,00016FA -19-30OCT00-1/1

### Wear Protective Equipment

Guard against injury from flying pieces of metal or debris; wear goggles or safety glasses.

Wear close fitting clothing and safety equipment appropriate to the job.

Prolonged exposure to loud noise can cause impairment or loss of hearing. Wear suitable hearing protection such as earmuffs or earplugs to protect against objectionable or uncomfortable loud noises.

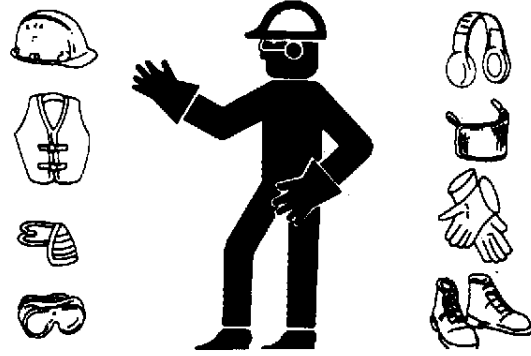

TS206 -UN-23AUG88

TX03679,00016D0 -19-30OCT00-1/1

### Avoid Unauthorized Attachment Modifications

Modifications of this attachment, or addition of unapproved products or attachments, may affect attachment stability or reliability, and may create a hazard for the operator or others near the attachment.

Always contact an authorized dealer before making attachment modifications that change the intended use, weight, or that alter attachment controls, performance or reliability.

TX03679,00016B7 -19-30OCT00-1/1

### Stay Clear Of Moving Parts

Entanglements in moving parts can cause serious injury.

Stop engine before examining, adjusting or maintaining any part of attachment with moving parts.

Keep guards and shields in place. Replace any guard or shield that has been removed for access as soon as service or repair is complete.

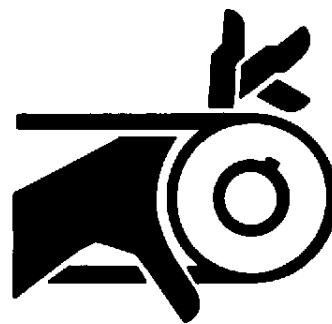

T7279AS -UN-08JUN90

TX03679,00016D2 -19-30OCT00-1/1



**Buy Now**



Our support email:

[ebooklibonline@outlook.com](mailto:ebooklibonline@outlook.com)