

800 REAR MOUNTED TOOLBAR



JOHN DEERE

OPERATORS MANUAL 800 REAR MOUNTED TOOLBAR

OMN159508 I0 English

DES MOINES
OMN159508 I0

LITHO IN THE U.S.A.
ENGLISH

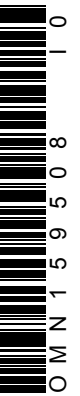

INTRODUCTION



This safety alert symbol identifies important safety messages in this manual. When you see this symbol, be alert to the possibility of personal injury and carefully read the message that follows.

This operator's manual contains both the US customary units of measurement and the SI Metric equivalents.

"Right-hand" and "left-hand" sides are determined by facing in the direction the toolbar will travel when in use.

Your warranty appears on your copy of the purchase order which you should have received from your dealer.

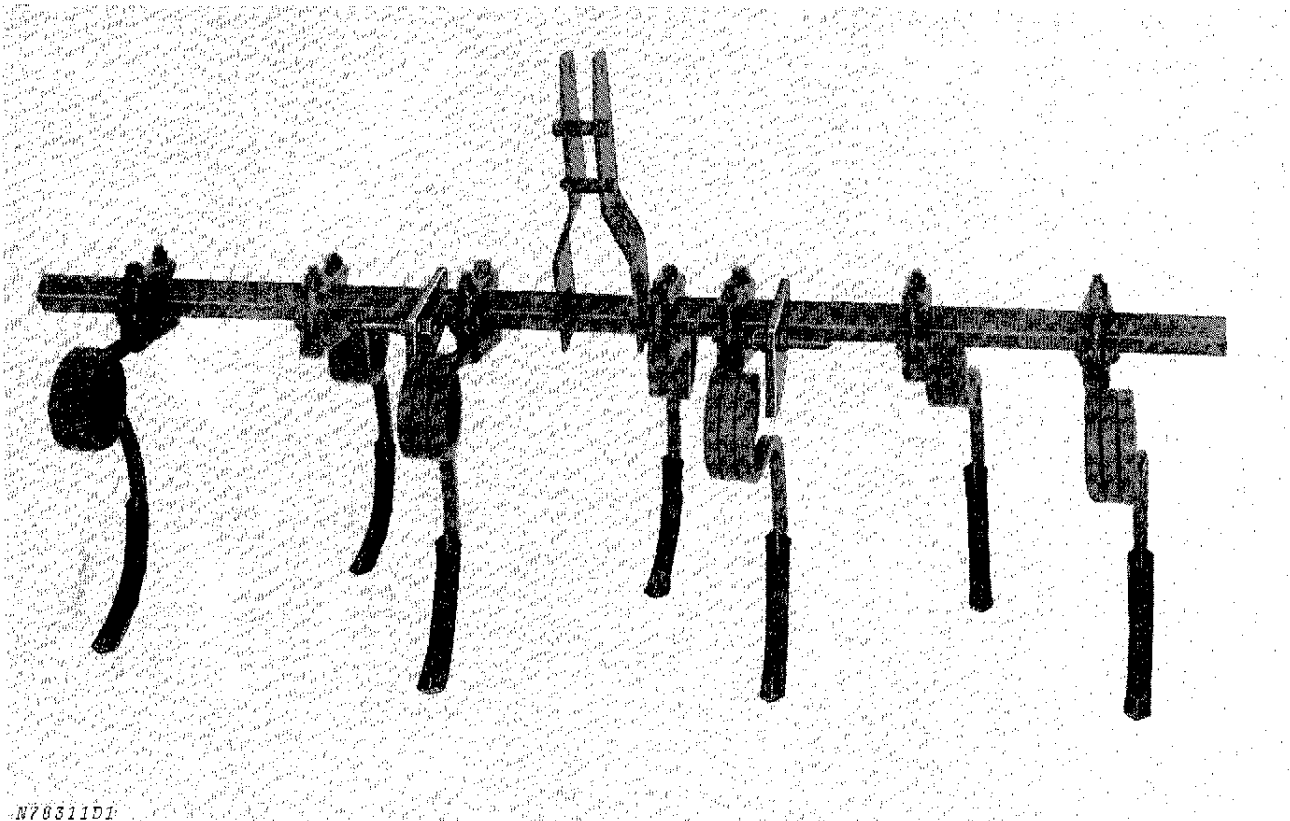

N78311D1

800 Rear Mounted Toolbar

800 REAR MOUNTED TOOLBAR

PREDELIVERY CHECK LIST

- Make sure all customer-ordered attachments are installed on toolbar.
- Make sure standard-spacing is correct for customer.
- Any parts scratched in shipment have been touched-up with paint.
- Toolbar is ready for delivery to customer for immediate use.

Signed _____

Date _____

DELIVERY CHECK LIST

At the time of delivery, important information should be conveyed to the customer. Check off each item below as it is fully explained to the customer.

- Give the operator's manual to the customer and explain all operating adjustments to him.
- Review with the customer the safety instructions in the operator's manual which he must observe when using the machine.

OWNER REGISTER

Toolbar Model _____

Name _____

R.R. or Street _____

City _____

State _____ Zip _____

When the toolbar is transported on a road or highway at night or during the day, accessory lights and devices should be used for adequate warning to operators of other vehicles. In this regard, tell customer to check local governmental regulations.

Signed _____

Date _____

AFTER-SALE CHECK LIST

The following is a suggested list of items to be checked at a dealer-customer mutually agreeable time during the first operating season.

- Check with the customer as to the performance of the toolbar.
- If possible, operate the toolbar to see that it is functioning properly.
- Acquaint the customer with any special attachment which will help him to do a better job.
- Go over entire toolbar for loose or missing bolts.
- Check for broken or damaged parts.
- Review the operator's manual with the customer and stress the importance of safety precautions.

Signed _____

Date _____

CUT HERE



Contents

	Page
SAFETY	2-3
PREPARING TRACTOR	4-7
850 and 950 Tractors	4-5
830, 2040, 1530, 2240, 2030, 2440, 2630, and 2640 Tractors	5-7
ATTACHING AND DETACHING	8-9
Attaching	8
Leveling	9
Detaching	9
TRANSPORTING	10
OPERATING THE TOOLBAR	11
STORAGE	12
ASSEMBLY	13
Standard Spacing Diagrams	14
SPECIFICATIONS	15



Safety

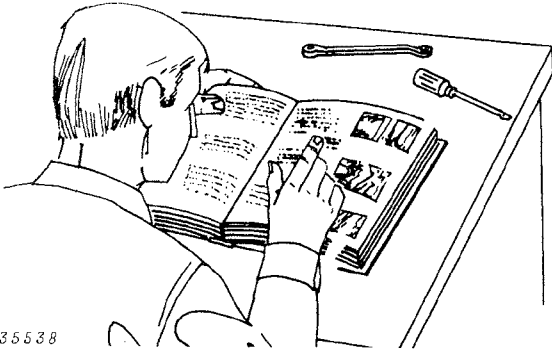

Operate Safely

DO NOT operate toolbar without reading this operator's manual.

DO NOT allow anyone to ride on, walk behind, or near the toolbar when it is in motion. Observe operation only from the tractor platform.

Always shut off tractor engine, shift to "Park", and disengage the PTO when leaving tractor. Remove ignition key when leaving tractor unattended.

Lower the toolbar when not in use.

DO NOT operate close to a ditch or creek.

Slow down when turning.

Drive slowly over rough ground.

Apply both tractor brakes evenly when making emergency stops. Plan ahead.

Wear relatively tight and belted clothing to prevent being caught on some part of the machine.

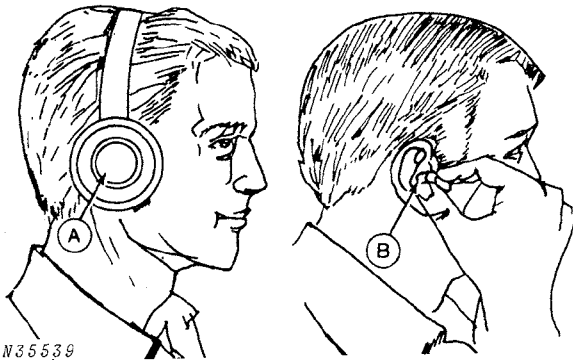

Protect Against Noise

Prolonged exposure to loud noise can cause impairment or loss of hearing.

Wear a suitable hearing protective device such as ear muffs (A) or ear plugs (B) to protect against objectionable or uncomfortable loud noises.

A—Ear Muffs

B—Ear Plugs

Avoid Fires

DO NOT refuel with the tractor engine running.

DO NOT smoke or use a lantern when refueling.

Transport Safely

When transporting the toolbar on a road or highway at night or during the day, use accessory lights and devices for adequate warning to operators of other vehicles. In this regard, check local governmental regulations. Various safety lights and devices are available from your John Deere dealer.

DO NOT fail to latch the tractor brakes together.

Shift the tractor into a lower gear when transporting down steep slopes or hills.

Keep SMV emblem clean.

Stop slowly.

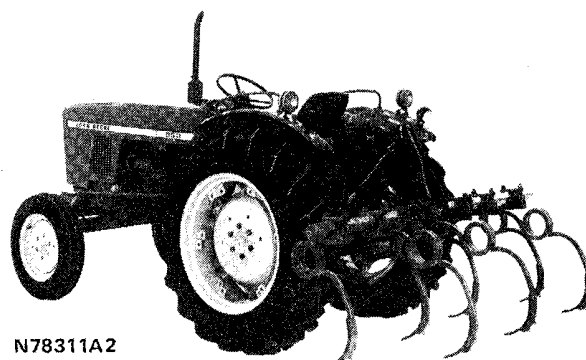

Practice Safe Maintenance

DO NOT adjust or clean the toolbar while it is in motion.

When working on or around the cultivator, support the toolbar frame on stands.

Always shut off the tractor engine when working on or around the toolbar.

Be careful of sharp edges when working around toolbar.

If touch-up spray can paint is used, be careful when discarding empty can. Do not incinerate or puncture can.

Finally, an accident is usually caused by someone's carelessness, neglect, or oversight.

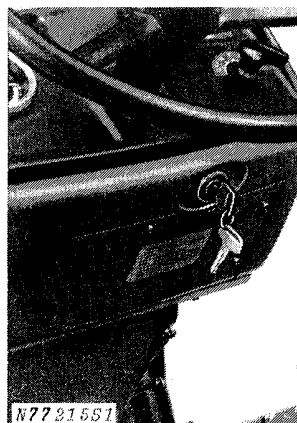



Preparing Tractor

850 AND 950 TRACTORS

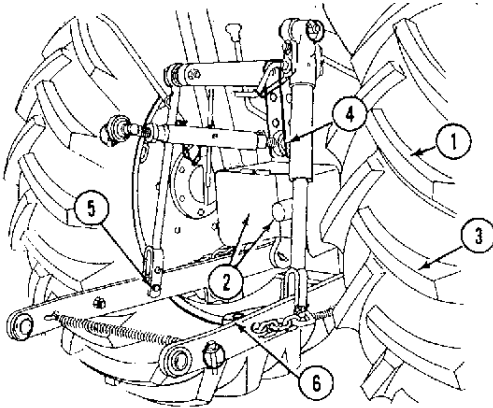

#34588

1. Set the tractor wheels for the desired row spacing. A wider setting provides more stability. See your tractor operator's manual.
2. Make sure the master shield and PTO guard are installed.
3. Make sure tractor tires have correct air pressure, see tractor operator's manual.

NOTE: Tractor ballasting is not required.

4. Position the center link in either one of the two lower holes for maximum sensitivity. Move the link to the upper two holes for the least sensitivity.
5. Use the bottom hole in the left-hand lift link.
6. Place drawbar in short center position or remove it.
7. Turn the hydraulic stop knob (bold arrow) counter-clockwise to open the hydraulic valve.

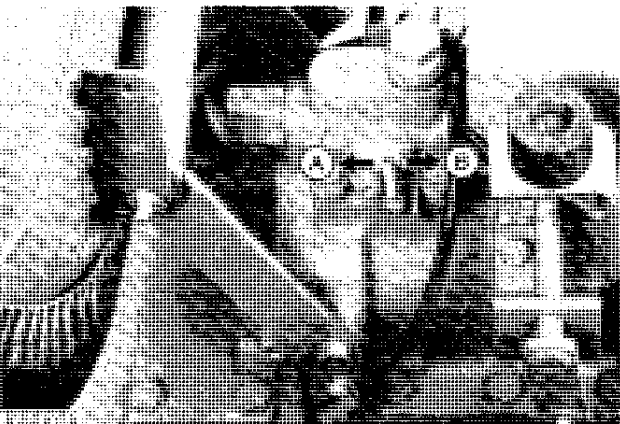

8. Adjust speed of drop.



CAUTION: Excessive speed of drop can cause damage or injury. Fully lowering toolbar should require at least two seconds.

A—Faster
B—Slower

9. The depth of soil penetration by the chisels is operator controlled with the control lever (A). After satisfactory field operation is achieved (a combination of speed and depth), tighten the stop knob (B) so the same depth can be located every time.

Lever Forward	-	Toolbar Down
Lever Rearward	-	Toolbar Up

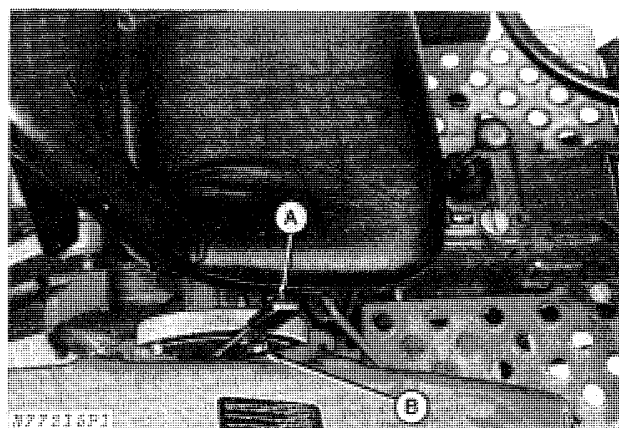

A—Control Lever
B—Stop Knob

830, 2040, 1050, 1530, 1640, 2240, 2030, 2440, 2630, AND 2640 TRACTORS

1. Set the tractor wheels for desired row spacing. A wider spacing provides more stability. See your tractor operator's manual.
2. Make sure the master shield and PTO guard are installed.
3. Make sure tractor tires have correct air pressure. See tractor operator's manual.

NOTE: Tractor ballasting is not required.

4. Place drawbar in short centered position or remove it.
5. Adjust lift links to minimum length. See tractor operator's manual.

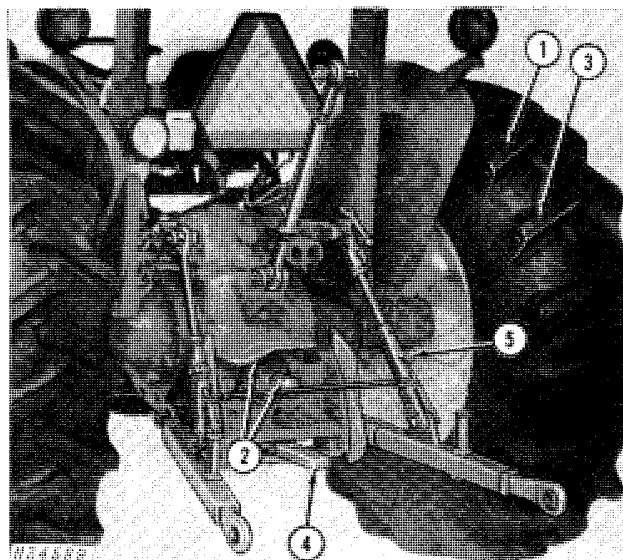

Thank you so much for reading.
Please click the “Buy Now!”
button below to download the
complete manual.



After you pay.

You can download the most
perfect and complete manual in
the world immediately.

Our support email:

ebooklibonline@outlook.com