

Product: MINI HYD EXCAVATOR  
Model: 303.5E MINI HYD EXCAVATOR SFH  
Configuration: 303.5E Mini Hydraulic Excavator SFH00001-UP (MACHINE)

## Disassembly and Assembly 303E CR, 303.5E, 304E, 305.5E and 305E Mini Hydraulic Excavators Machine Systems

Media Number -UENR0148-04

Publication Date -01/10/2016

Date Updated -25/10/2016

i04778099

## Swing Motor and Swing Drive - Disassemble

SMCS - 5058-015-ZW; 5459-015

### Disassembly Procedure

Table 1

Required Tools			
Tool	Part Number	Part Description	Qty
A	9S-9152	Bearing Puller Gp	1
B	126-7183	Crossblock	1
C	1P-1857	Retaining Ring Pliers	1
D	1P-1859	Retaining Ring Pliers	1

#### Start By:

- a. Remove the swing motor and the swing drive.

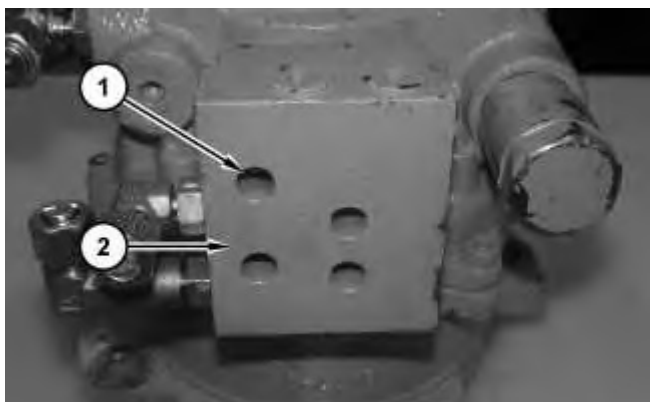

1. Remove bolts (1) and valve assembly (2).

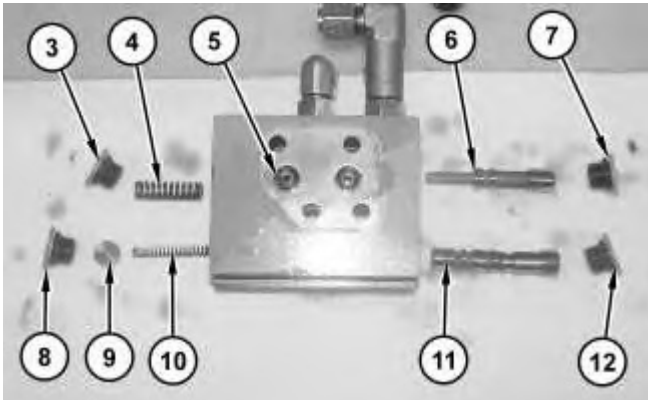

Illustration 2



**Personal injury can result from being struck by parts propelled by a released spring force.**

**Make sure to wear all necessary protective equipment.**

**Follow the recommended procedure and use all recommended tooling to release the spring force.**

2. Remove plug (3), the O-ring seal, and spring (4).
3. Remove plug (8), the O-ring seal, shim (9), and spring (10).
4. Remove plug (7), the O-ring seal, and spool (6).
5. Remove plug (12), the O-ring seal, and spool (11).
6. Remove O-ring seals (5).

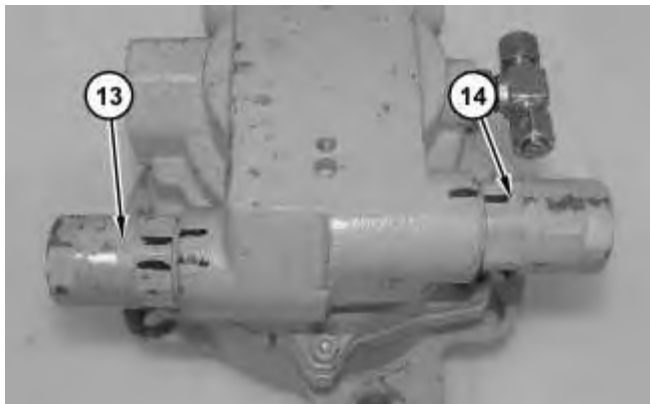

Illustration 3

g01250161

7. Remove check valve (13) and check valve (14).



Illustration 4

g01250163

8. Remove backup ring (15), O-ring seal (16), backup ring (17), and O-ring seal (18) from check valve (13).
9. Repeat Step 8 for check valve (14).

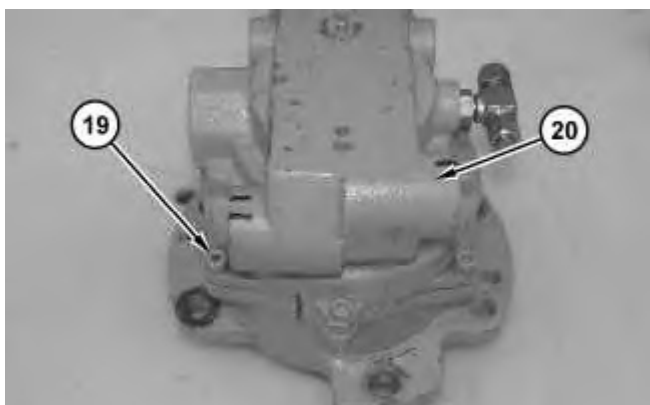

Illustration 5

g01250166

10. Remove bolts (19) and head (20).



Illustration 6

g01250164

**! WARNING**

**Personal injury can result from being struck by parts propelled by a released spring force.**

**Make sure to wear all necessary protective equipment.**

**Follow the recommended procedure and use all recommended tooling to release the spring force.**

- 
11. Remove bolts (21) and plate (22).

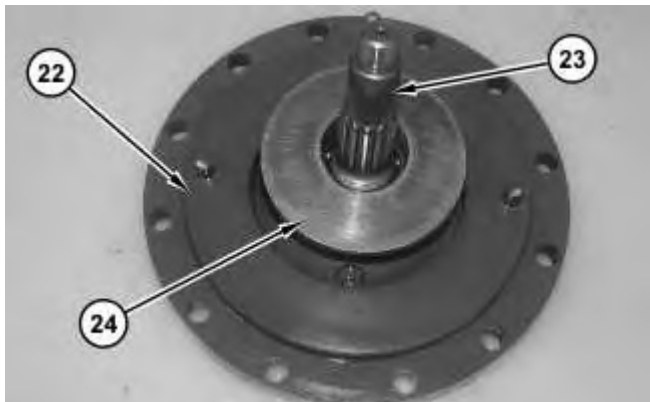

Illustration 7

g01250167

12. Remove swashplate (24) and shaft assembly (23) from plate (22).
-



**Suggest:**

**If the above button click is invalid.**

**Please download this document**

**first, and then click the above link**

**to download the complete manual.**

**Thank you so much for reading**