

Product: TRACK LOADER

Model: 935C II TRACK LOADER 5DJ

Configuration: 935C SERIES II TRACK LOADER / POWER SHIFT / 5DJ00001-UP (MACHINE) POWERED BY 3204 ENGINE

## Disassembly and Assembly D4B TRACTOR & 935B TRACK-TYPE LOADER VEHICLE SYSTEMS

Media Number -SEN3495-00

Publication Date -01/03/1987

Date Updated -11/10/2001

### Hydraulic Control Valves

SMCS - 5054-010; 5054-015; 5054-016

### Remove And Install Hydraulic Control Valves

**NOTE:** The operation is shown on a 931B that has a two valve arrangement with a ROPS. The procedures are the same for the D4B and the 935B.

1. Remove the seat and the seat frame. Drain the oil from the hydraulic tank.

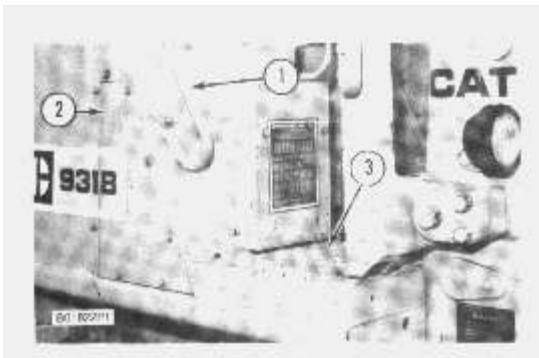

2. Remove handle (1). Remove floor plate (3) and plate assembly (2).

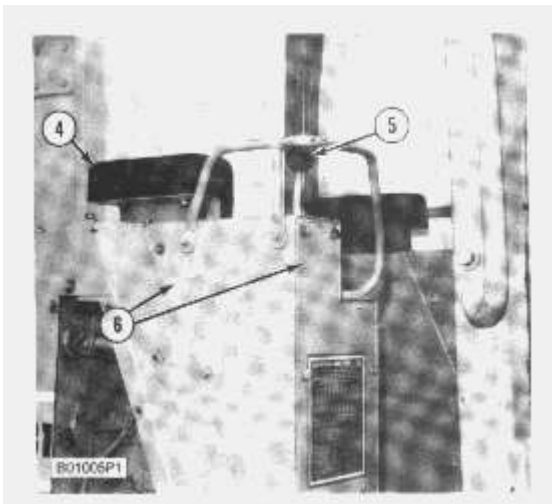

3. Remove knob (5) from the control lever. Remove arm cushion and bracket (4). Remove cover assemblies (6) and the guard as a unit.

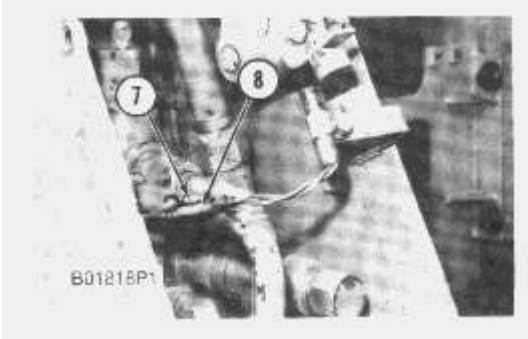

4. Disconnect wires (7) and (8) from the switch.

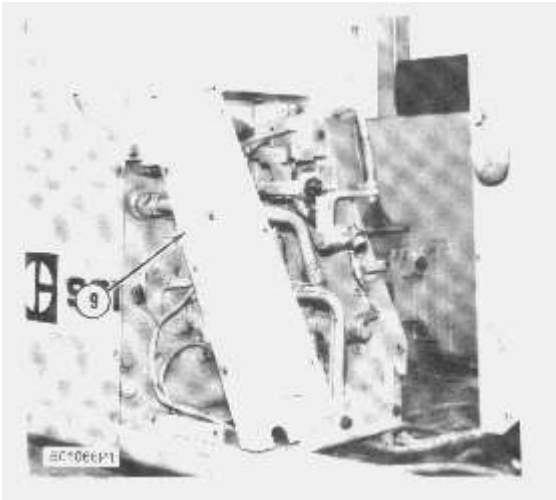

5. Remove cover assembly (9) from the machine.

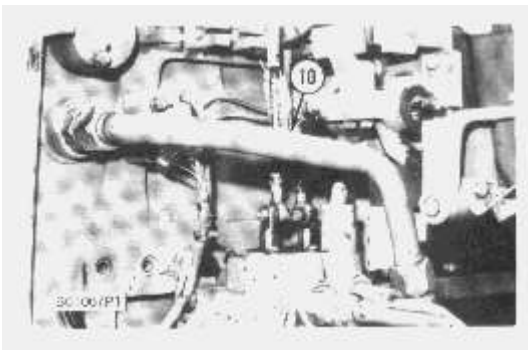

6. Disconnect oil line (10) from the hydraulic tank and the hydraulic control valve and remove it.

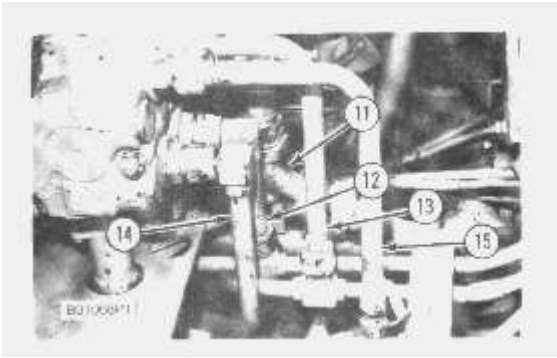

7. Disconnect oil lines (11) and (14) from the hydraulic control valves. Disconnect oil lines (12), (13) and (15) from the tee fittings.

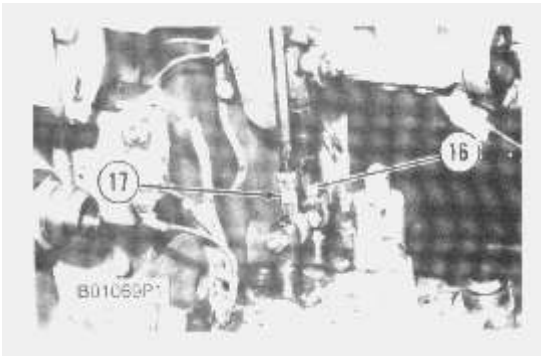

8. Disconnect control linkages (16) and (17) from the hydraulic control valves.

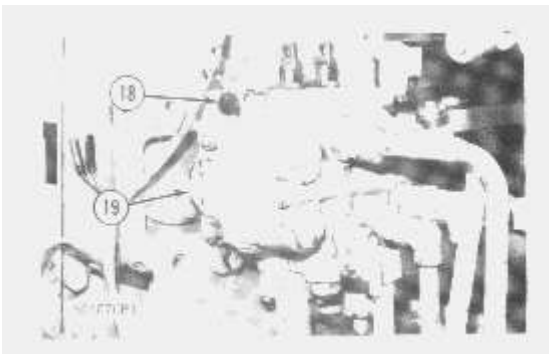

9. Remove bolts (18) that hold the hydraulic control valves in place. Remove hydraulic control valves (19).

**NOTE:** A machine can be equipped with two, three or four valves. The number of valves needed is controlled by the number of attachments that are on the machine.

**NOTE:** The following steps are for installation of the hydraulic control valves.

10. Put hydraulic control valves (19) in position and install the bolts (18) that hold it in place.

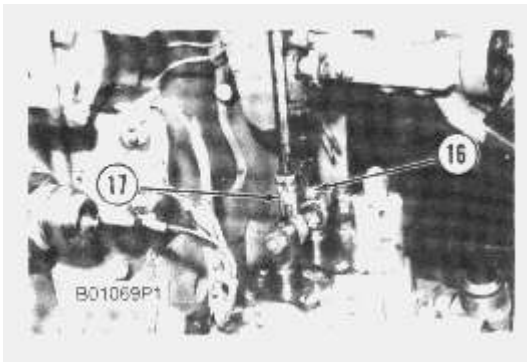

**11.** Connect control linkages (16) and (17) to the hydraulic control valves.

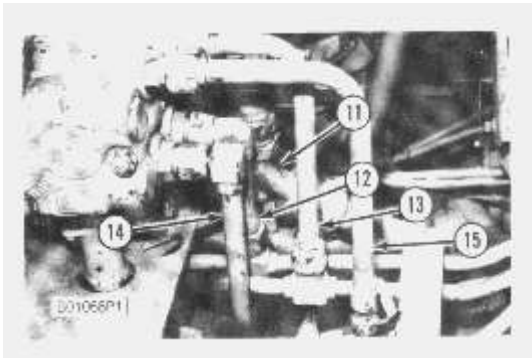

**12.** Connect oil lines (12), (13) and (15) to the tee fittings. Connect oil lines (11) and (14) to the hydraulic control valves.

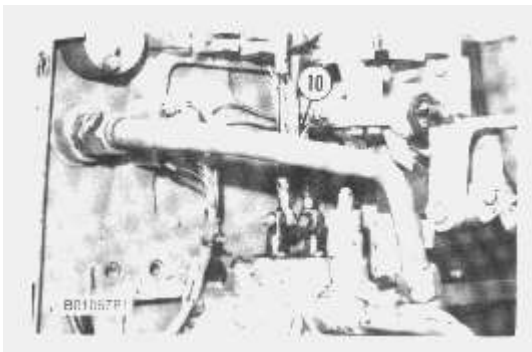

**13.** Put oil line (10) in place and connect it to the hydraulic control valve and the hydraulic tank.

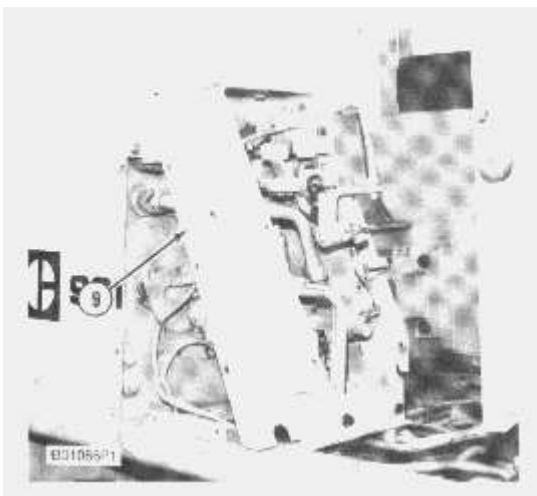

14. Install cover assembly (9).

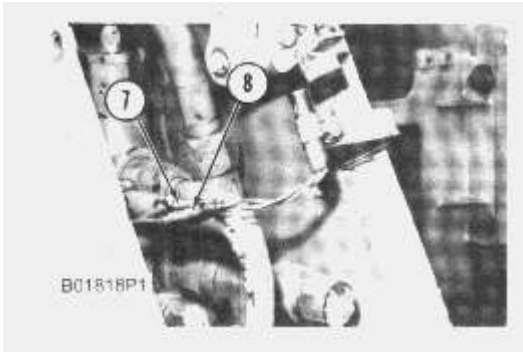

15. Connect wires (7) and (8) to the switch.

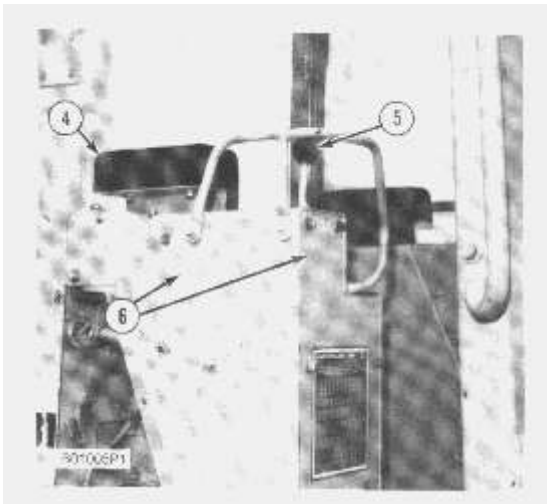

16. Install the guard and cover assemblies (6) as a unit. Install the arm cushion and bracket (4) and knob (5) on the control lever.

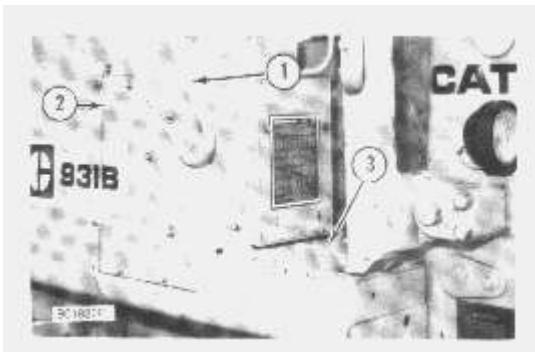

17. Install plate assembly (2). Install the handle (1) and the floor plate (3).

18. Fill the hydraulic tank to the correct level. See the Operation And Maintenance Guide.

## Disassemble Hydraulic Control Valves

Start By:

a. remove hydraulic control valves

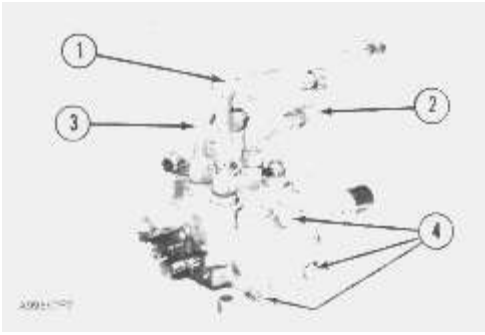

1. Clean the outside of the hydraulic control valve. Put identification on all parts for correct assembly.

**NOTE:** A machine can be equipped with two, three or four valves. The number of valves needed is controlled by the number of attachments that is on a machine.

**NOTE:** The valve shown is for a 935B that has a two valve arrangement.

2. Remove tube assemblies (1), (2) and (3). Remove nuts (4) from the rods that hold the hydraulic control valve together.

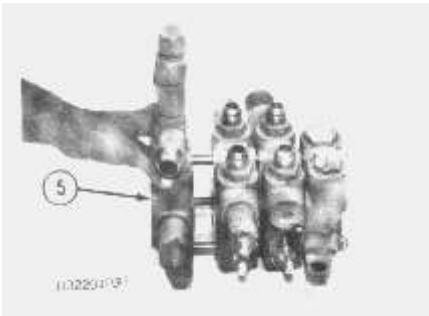

3. Remove inlet oil manifold (5) from the rods.

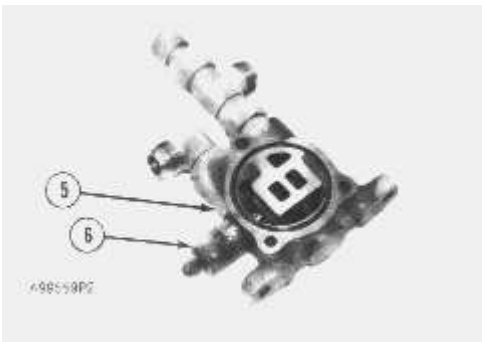

4. Remove O-ring seal from the inlet oil manifold. Remove main relief valve (6) from inlet oil manifold (5).

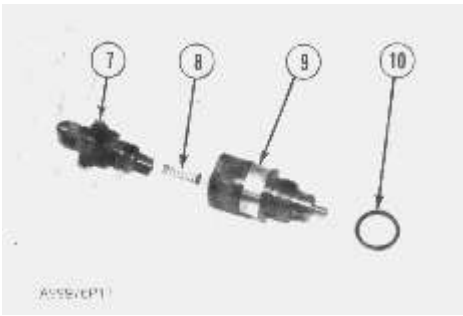

5. Disassemble the main relief valve as follows:

- a. Remove valve body (7) from valve body (9). Remove spring (8).
- b. Remove O-ring seal (10) from valve body (9).

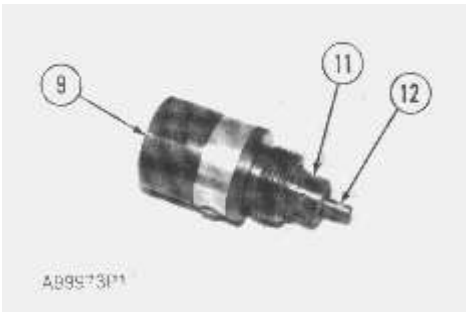

c. Remove plunger (12) and orifice (11) from valve body (9).

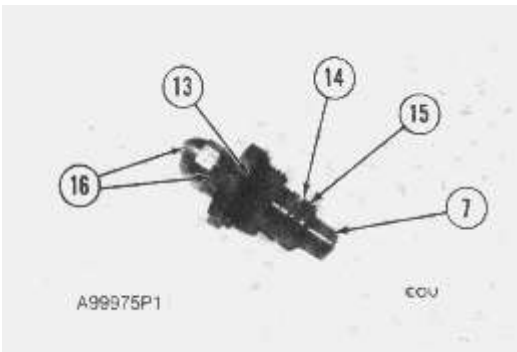

d. Remove O-ring seal (15), ring (14) and O-ring seal (13) from valve body (7).

**NOTE:** Put a mark on the adjustment screw for the location of the adjustment nuts for correct assembly.

e. Remove adjustment nuts (16) and washers from the adjustment screw.

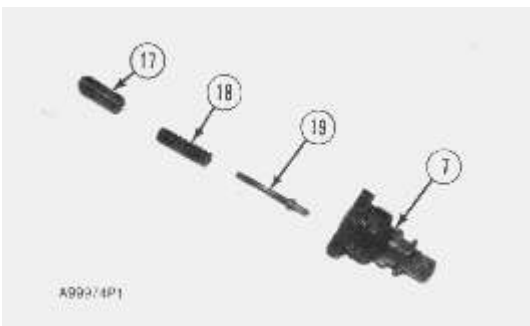

f. Remove adjustment screw (17), spring (18) and plunger (19) from valve body (7).

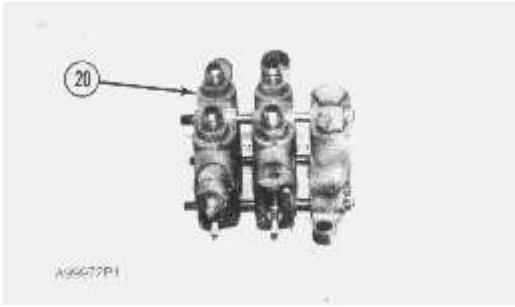

6. Remove tilt control valve (20) from the rods.

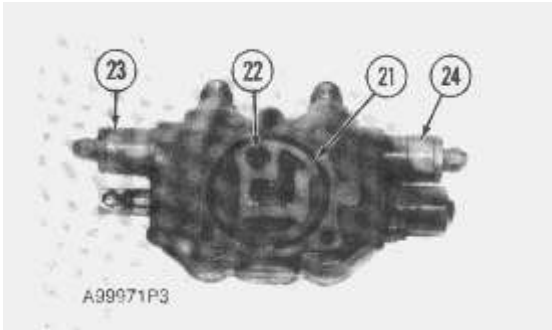

7. Remove O-ring seal (21) from the tilt control valve body. Remove spring (22) and the poppet valve from the tilt control valve body.

---

### NOTICE

**Relief valves (23) and (24) are different. Do not mix the parts.**

---

8. Remove relief valves (23) and (24) from the tilt control valve body.

9. Do Step 5 again and disassemble relief valves (23) and (24).

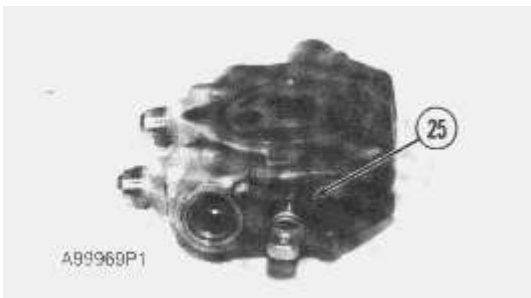

10. Remove plate (25). Remove the wiper seal behind plate (25).



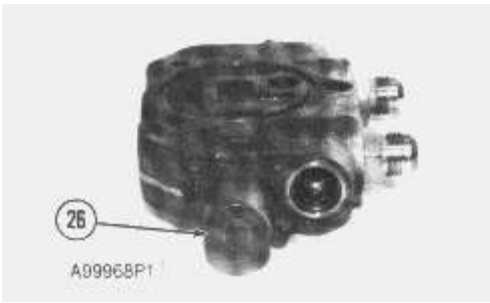

11. Remove cap (26) from the other end of the tilt control valve body.

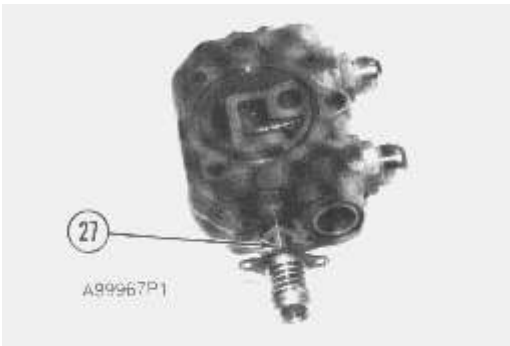

12. Remove tilt control valve spool (27) from the tilt control valve body.

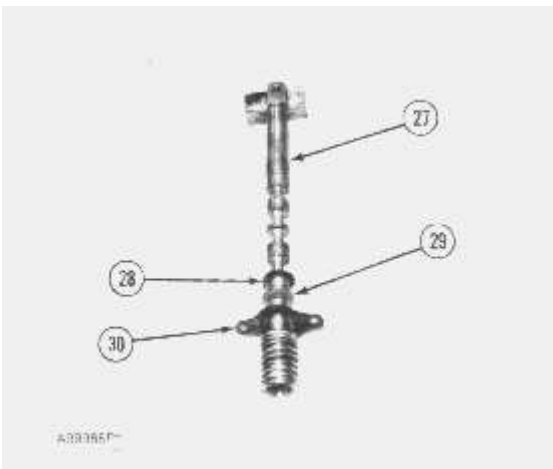

---

### NOTICE

**Be extra careful not to cause damage to the valve spool surface.**

---

13. Remove O-ring seal (28), wiper seal (29) and plate (30) from tilt control valve spool (27).

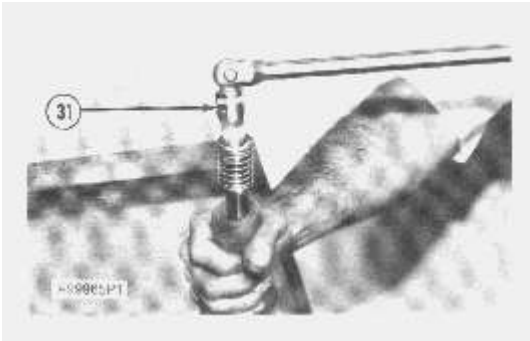

**! WARNING**

**Screw (35) holds spring (33) under compression.**

**14.** Put a piece of rubber hose around the tilt control valve spool and carefully put it in a vise. Loosen the screw on the end of the tilt control valve with a drag link socket (31).

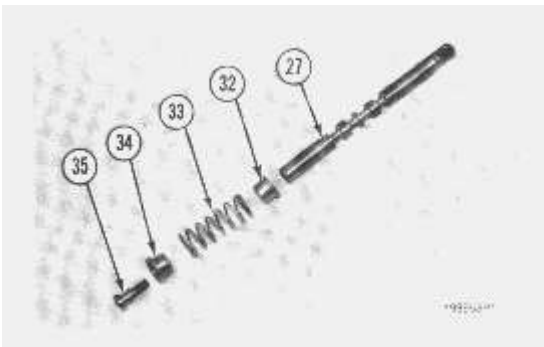

**15.** Remove screw (35), seat (34), spring (33) and seat (32) from tilt control valve spool (27).

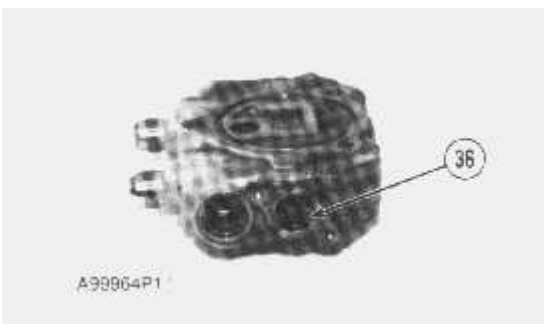

**16.** Remove O-ring seal (36) from the tilt control valve body.

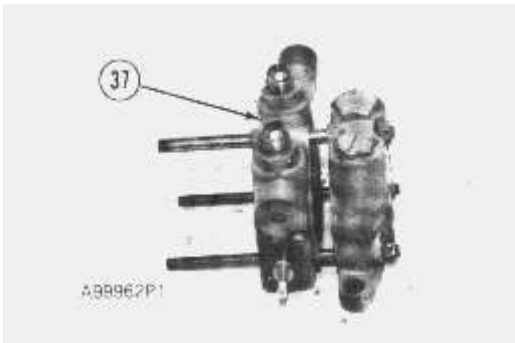

**17.** Remove lift control valve (37) from the rods.

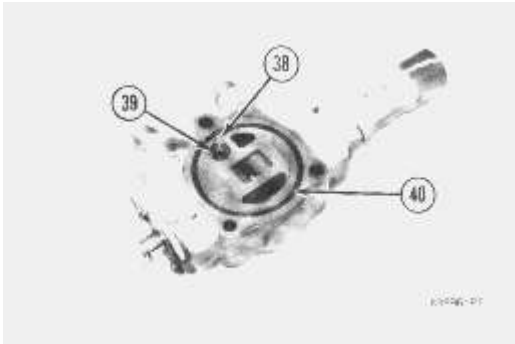

**18.** Remove spring (38) and poppet valve (39) from the lift control valve body. Remove O-ring seal (40).

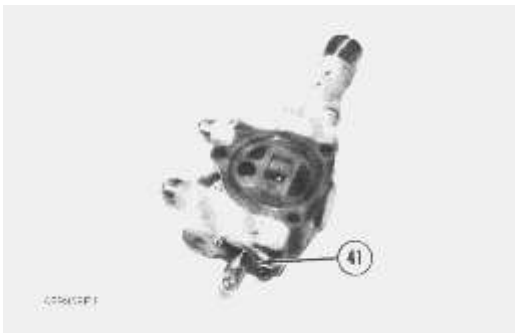

**19.** Remove plate (41) and the wiper seal behind the plate. Remove O-ring behind the wiper seal.

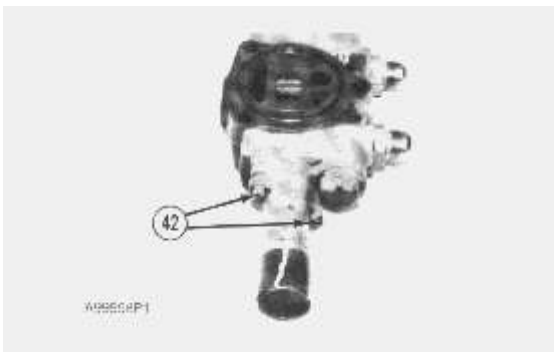

**20.** Remove two bolts (42) that hold the cap in place.

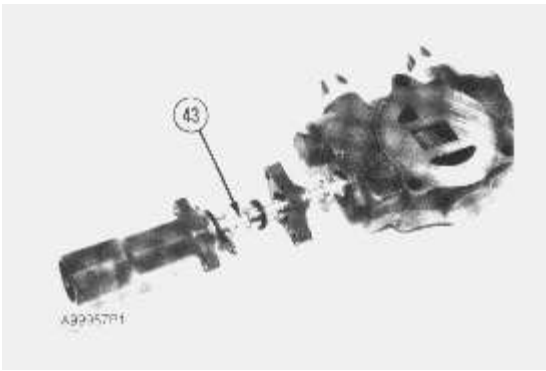

21. Remove lift control valve spool (43) from the lift control valve body.

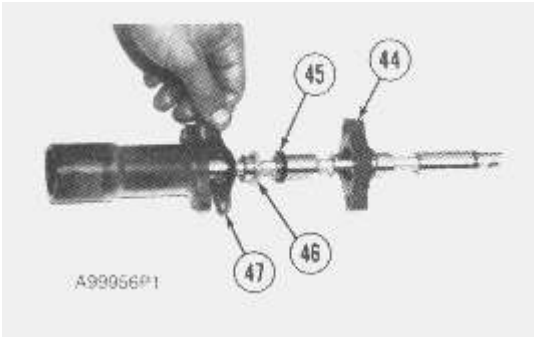

22. Remove spacer (44), O-ring seal (45), wiper seal (46) and plate (47) from the lift control valve spool.

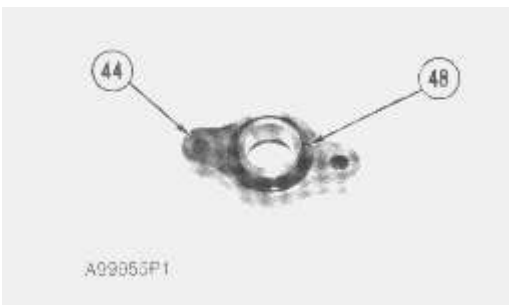

23. Remove O-ring seal (48) from spacer (44).

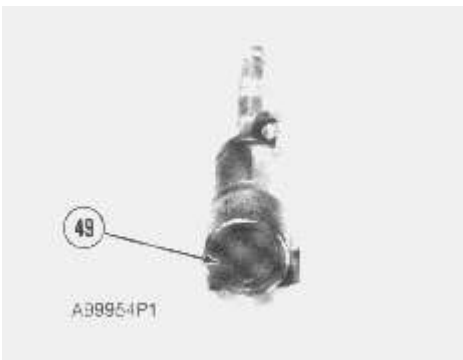

24. Remove ring (49).

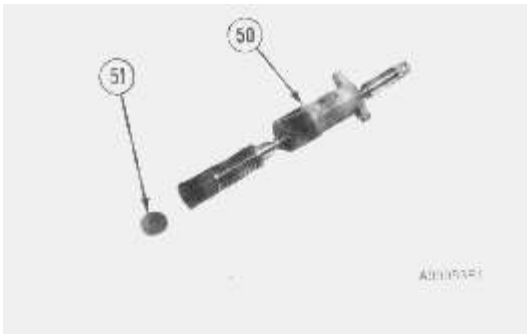

25. Remove plug (51) from cap (50). Remove cap (50) from the lift control valve spool.

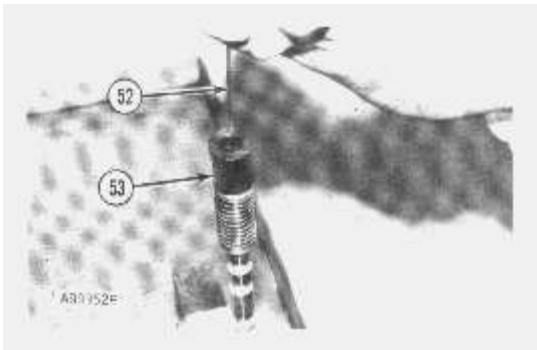

26. Put the flat end of the lift control valve spool in a vise.

**WARNING**

**Sleeve (53) has spring force behind it. Also, be extra careful when sleeve (53) is removed because the balls inside the sleeve are free to fall when the sleeve is removed.**

27. Use a small diameter rod (52) and push the ball in the center down. Move sleeve (53) from side to side until two of the four outside balls fall from the groove in the sleeve. Remove sleeve (53) and the five balls from the lift control valve spool.

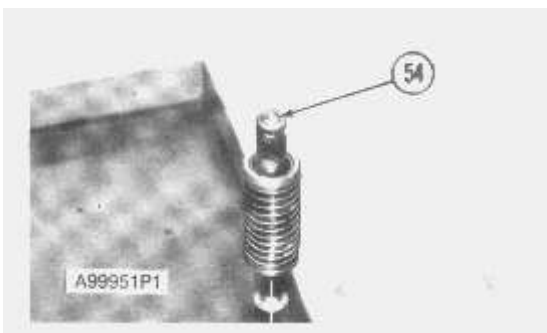

28. Remove spring (54) from the pin.

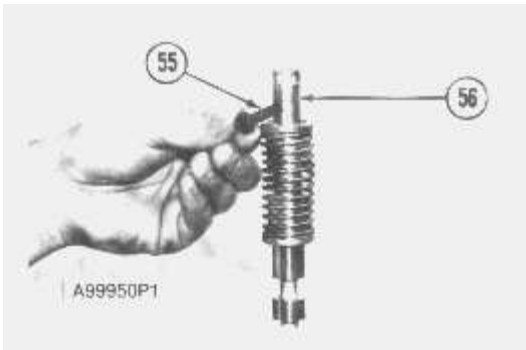

**29.** Install a 1/4 in. by 3/4 in. bolt (55) in the hole in pin (56) in the end of the lift control valve spool. Install a nut on the bolt.

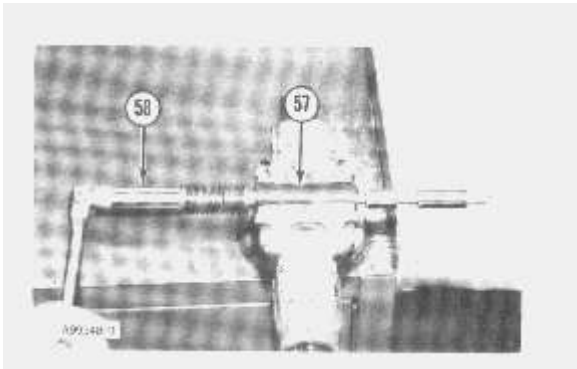

**30.** Put a piece of rubber hose (57) around the lift control valve spool and carefully put it in a vise.

---

### NOTICE

**Be extra careful not to cause damage to the valve spool surface.**

---

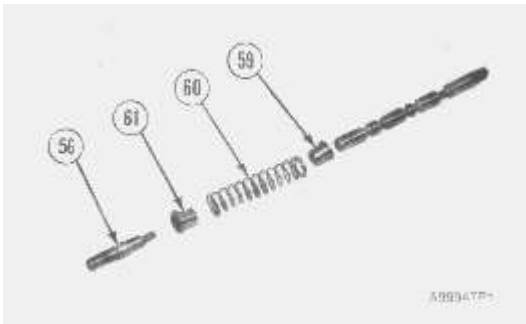

**WARNING**

**Pin (56) holds spring (60) under compression.**

---

**31.** Use a 1" six point, deep well socket (58) as shown, and remove pin (56), retainer (61), spring (60) and retainer (59) from the lift control valve spool. Remove 1/4" x 3/4" bolt (55) from pin (56).

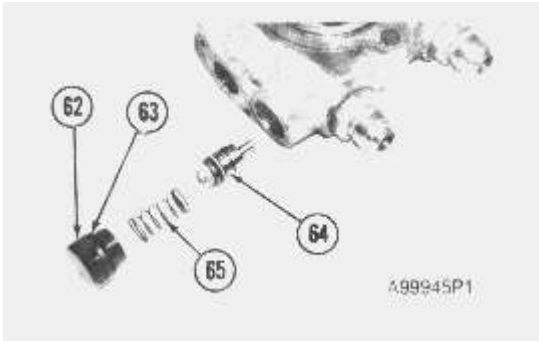

**32.** Remove plug (62), spring (65) and check valve (64) from the lift control valve body. Remove O-ring seal (63).

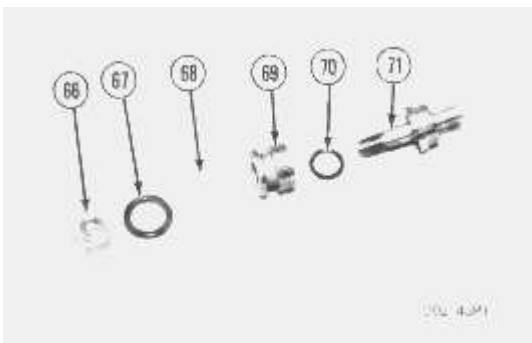

**33.** Disassemble check valve (64) as follows:

- a. Remove nut (66) from shaft (71).
- b. Remove piston (69) from shaft (71).
- c. Remove O-ring seal (67) and ring (68) from piston (69).
- d. Remove O-ring seal (70).

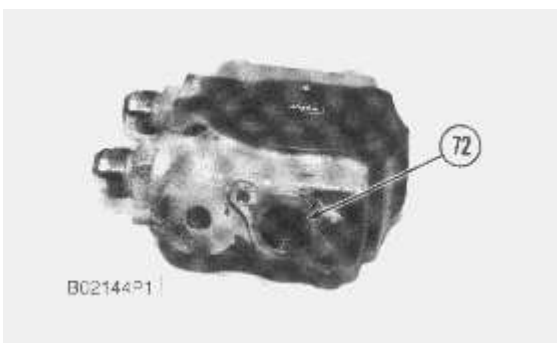

**34.** Remove O-ring seal (72) from the lift control valve body.

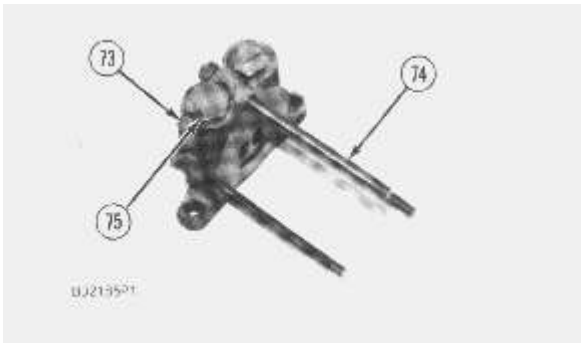

**35.** Remove rods (74) from the outlet manifold (73). Remove plugs (75) and O-ring seals from the outlet manifold.

## Assemble Hydraulic Control Valves

**1.** Make sure all the parts of the hydraulic control valve are clean. Put clean oil on all of the parts of the valve. Inspect all the parts for damage and make replacements if needed.

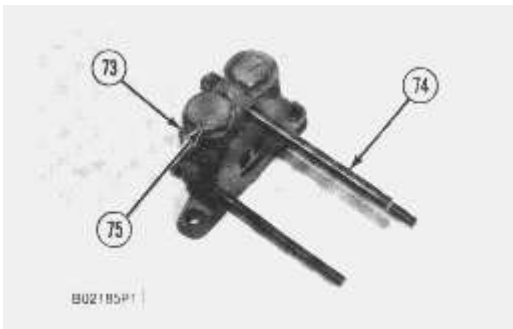

**2.** Install O-ring seals and plugs (75) in outlet manifold (73).

**3.** Install rods (74) in the outlet manifold.

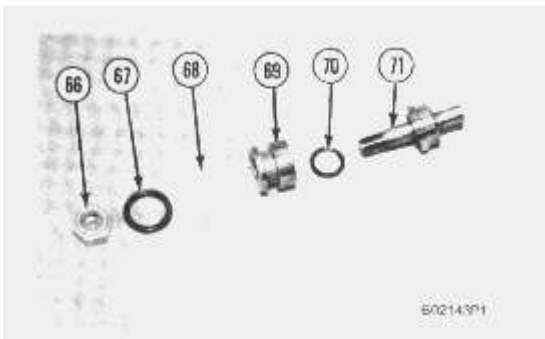

**4.** Assemble the check valve as follows:

**a.** Install O-ring seal (70) and piston (69) on shaft (71).

**b.** Install ring (68) and O-ring seal (67) on piston (69).

**c.** Install nut (66).



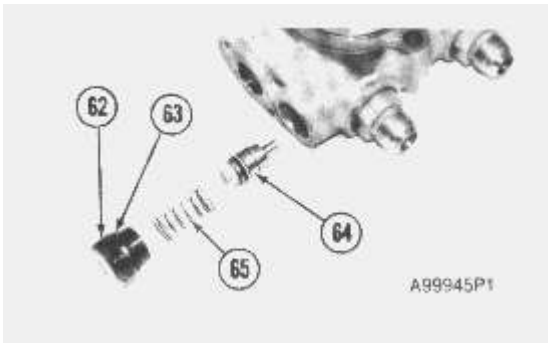

5. Install O-ring seal (63) on plug (62). Install check valve (64), spring (65), and plug (62) in the lift control valve body.

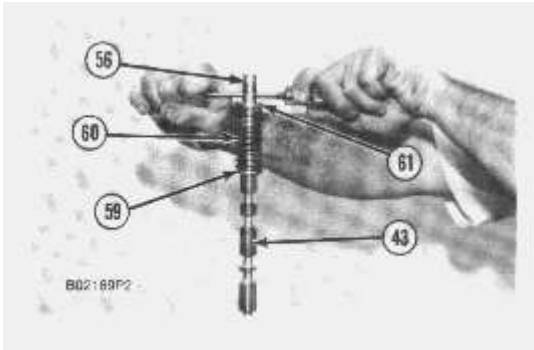

---

## NOTICE

**Be extra careful not to cause damage to the valve spool surface.**

---

6. Put the flat end of the lift control valve spool in a vise. Install retainer (59), spring (60) and retainer (61) on lift control valve spool (43).

7. Use a screwdriver as shown and install pin (56) in the end of the lift control valve spool.

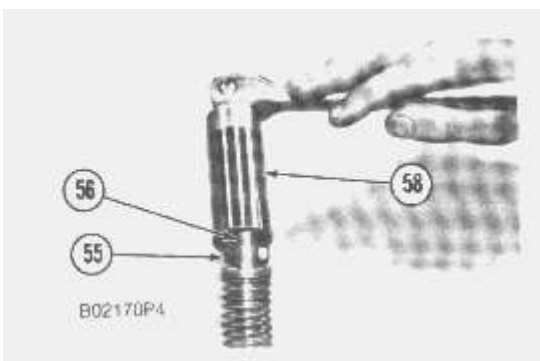

8. Install a 1/4 in. by 3/4 in. bolt (55) and nut in pin (56). Use a 1 in. six point deep-well socket (58) and tighten pin (56). Remove 1/4 in. x 3/4 in. bolt (55).

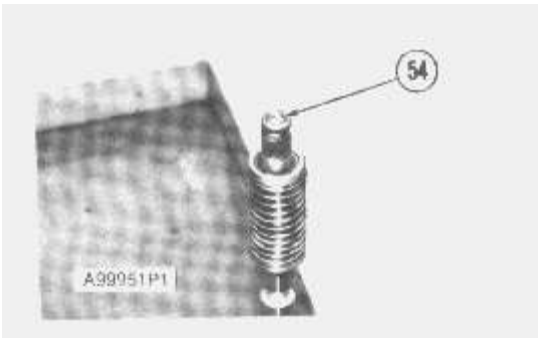

**9.** Install spring (54) in pin.

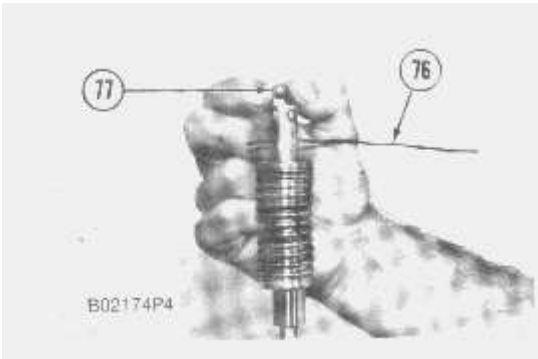

**10.** Push spring (54) down and install a piece of 1.52 mm (.060 in.) wire (76) as shown through the pin to hold the spring in place.

**11.** Install ball (77) in the pin.

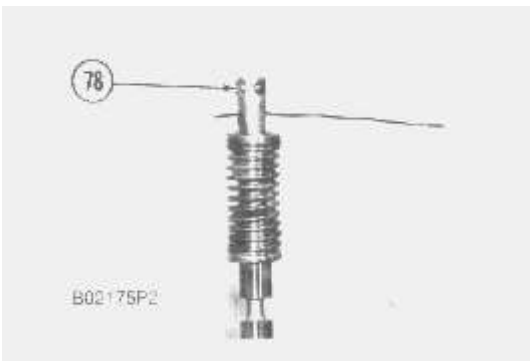

**12.** Put lubricant on four balls (78) to hold the balls in the pin. Install the balls in the pin.

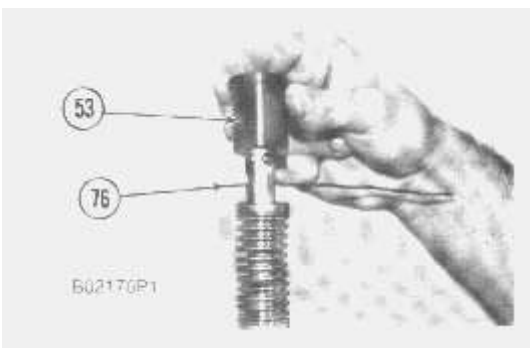

**13.** Install sleeve (53) over the balls in the pin. While the sleeve is installed, remove wire (76).

**NOTE:** If the balls do not hold sleeve (53) in place, it will be necessary to do Steps 10 through 13 again.

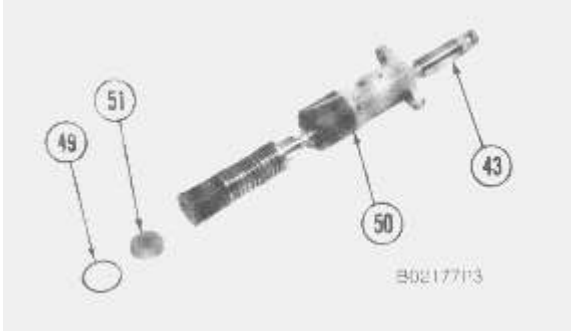

**14.** Slide lift control valve spool (43) into cap (50). Install plug (51) and ring (49) in cap (50).

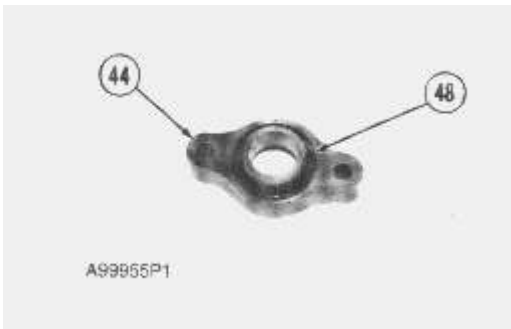

**15.** Install O-ring seal (48) on spacer (44).

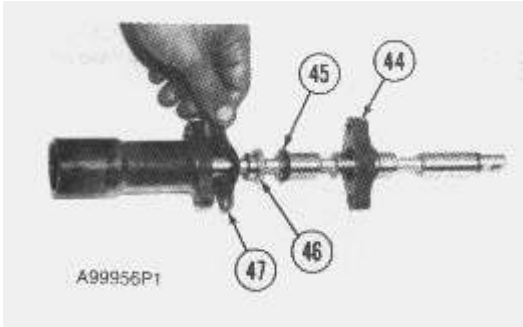

---

### NOTICE

**Install wiper seal (46) with the lip toward spacer (47).**

---

**16.** Install spacer (47), wiper seal (46), O-ring seal (45) and spacer (44).

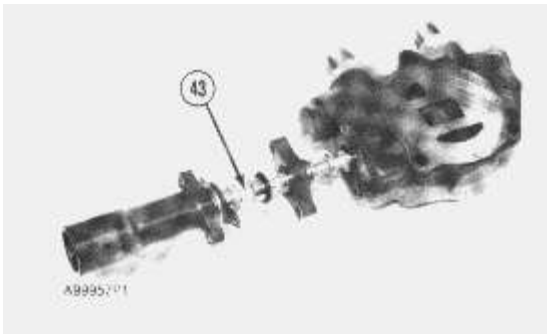

17. Install lift control valve spool (43) into the lift control valve body. Install the two bolts that hold the cap in place.

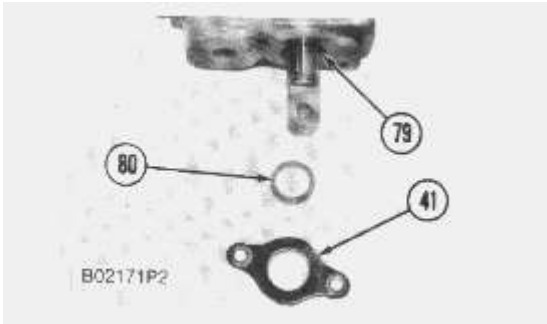

18. Install O-ring seal (79).

---

### NOTICE

**Install wiper seal (80) with the lip toward plate (41).**

---

19. Install wiper seal (80) and plate (41) for the lift control valve spool.

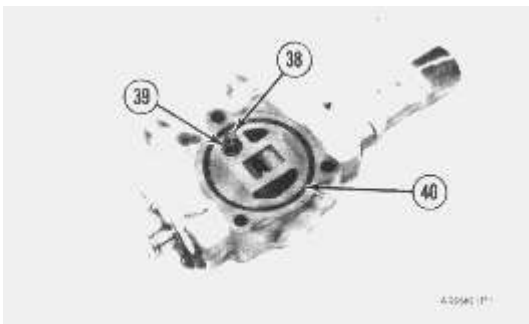

20. Install poppet valve (39) and spring (38) in the lift control valve body. Install O-ring seal (40) in the lift control valve body.

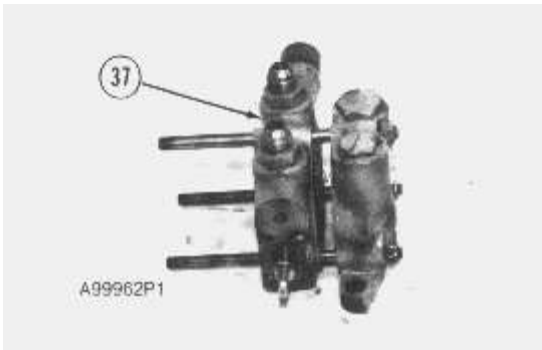

**21.** Install lift control valve (37) on the rods as shown.

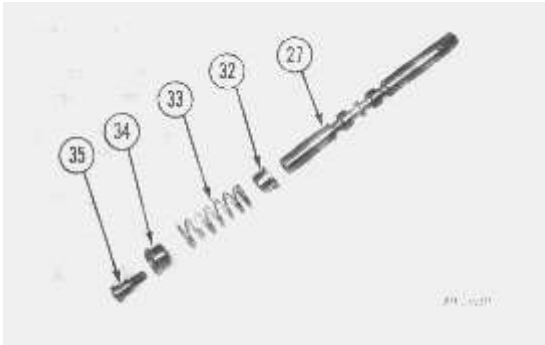

**22.** Install seal (32), spring (33) and seat (34) on tilt control valve spool (27).

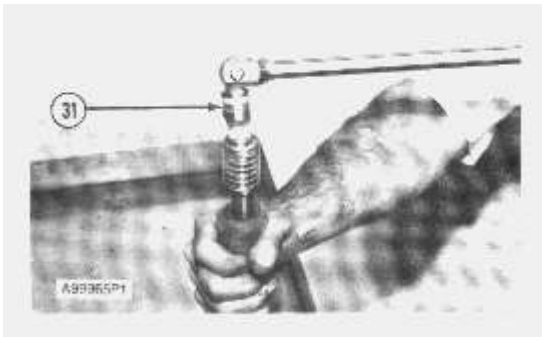

---

## NOTICE

**Be extra careful not to cause damage to the valve spool surface.**

---

**23.** Put the flat end of tilt control valve spool (27) in a vise and install screw (35) with a drag-link socket (31).

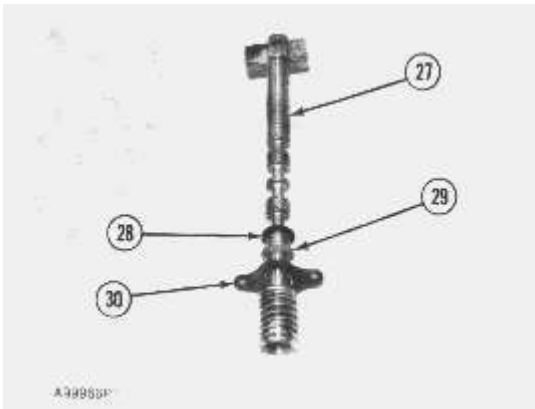

**24.** Install plate (30), wiper seal (29) and O-ring seal (28) on tilt control valve spool (27). Install the wiper seal with the lip toward plate (30).

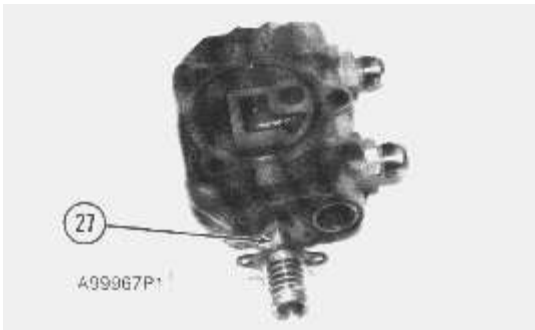

**25.** Install tilt control valve spool (27) into the tilt control valve body.

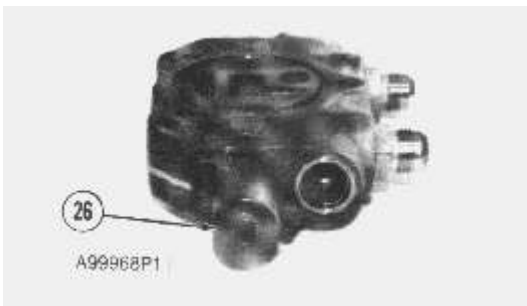

**26.** Put cap (26) in position and install the two bolts that hold it in place.

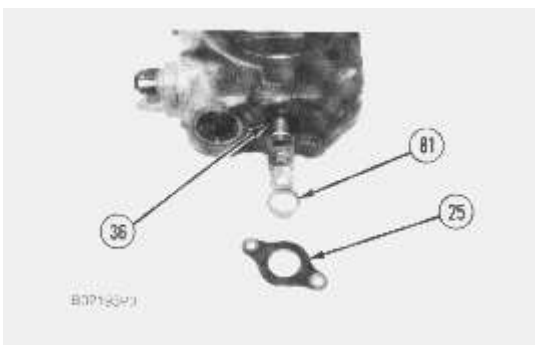

**27.** Install O-ring seal (36). Install wiper seal (81) and plate (25) for the tilt control valve spool. Install wiper seal (81) with the lip toward plate (25).

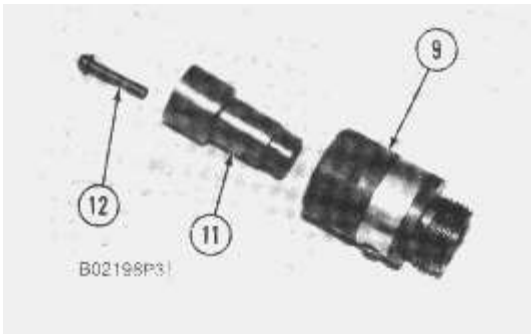

**28. Assemble relief valves as follows:**

**a. Install orifice (11) and plunger (12) in valve body (9).**

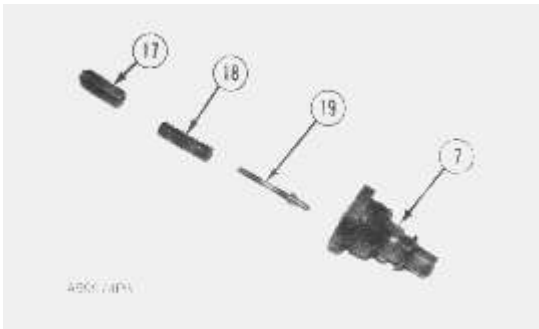

**b. Install plunger (19) spring (18) and adjustment screw (17) in valve body (7).**

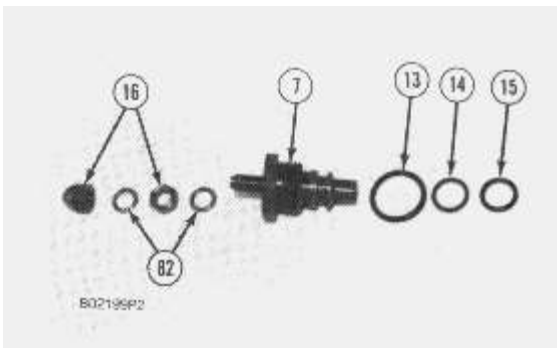

**c. Install O-ring seal (13) on valve body (7). Install ring (14) and O-ring seal (15) on valve body (7).**

**d. Install washer (82), adjustment nut (16) washer (82) and adjustment nut (16) in their original position on the adjustment screw.**

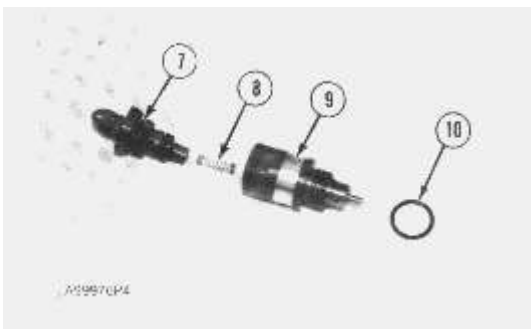

**e. Install O-ring seal (10) on valve body (9).**

f. Install spring (8) and valve body (7) in valve body (9).

g. see the Testing And Adjusting Manual for correct adjustment of the relief valves.

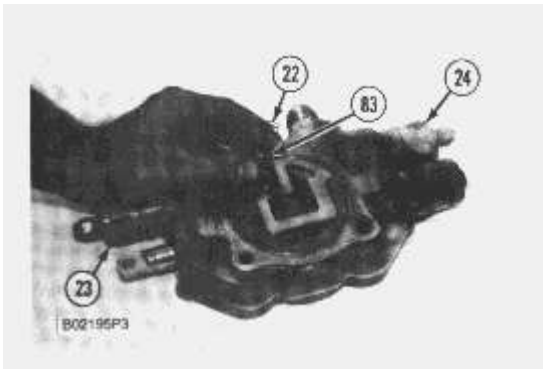

29. Install relief valves (23) and (24) in the tilt control valve body.

30. Install poppet valve (83) and spring (22) in the tilt control valve body.

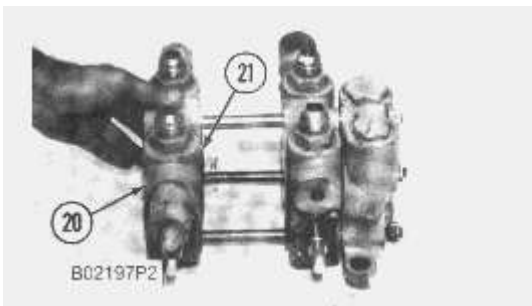

31. Install O-ring seal (21) in the tilt control valve body.

32. Install tilt control valve (20) on the rods as shown.

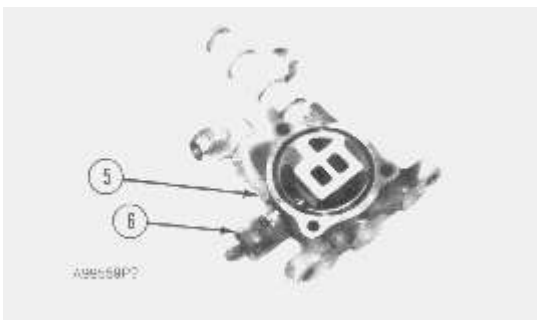

33. To assemble main relief valve (6), repeat Step 28.

34. Install main relief valve (6) in inlet oil manifold (5). Install O-ring seal in the inlet oil manifold.



Thank you so much for reading.  
Please click the “Buy Now!”  
button below to download the  
complete manual.



After you pay.

You can download the most  
perfect and complete manual in  
the world immediately.

Our support email:

[ebooklibonline@outlook.com](mailto:ebooklibonline@outlook.com)