

Product: COMPACTOR

Model: CB10 COMPACTOR NPP

Configuration: CB10 Asphalt Compactor NPP00001-UP (MACHINE) POWERED BY C4.4 Engine

Disassembly and Assembly CB10 Vibratory Asphalt Compactor Machine Systems

Media Number -M0079158-02

Publication Date -01/12/2014

Date Updated -29/11/2017

i04891435

Piston Pump (Vibratory) - Assemble - Split Drum

SMCS - 5070-016; 5652-016

Assembly Procedure

Table 1

Required Tools			
Tool	Part Number	Part Description	Qty
A	1P-1861	Retaining Ring Pliers	1
C	1P-0510	Driver Gp	1
D	1P-1864	Retaining Ring Pliers As	1



Illustration 1

g03025958

1. Install seal (52) and guide rings (53).



Illustration 2

g03025956

2. Position cover (51) and install bolts (50).

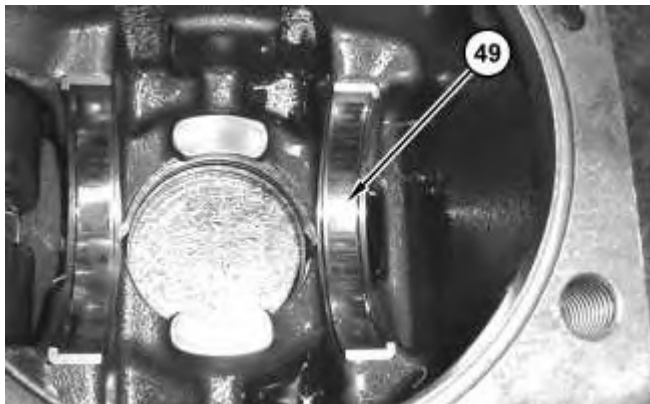

Illustration 3

g03025945

3. Install bearing races (49).

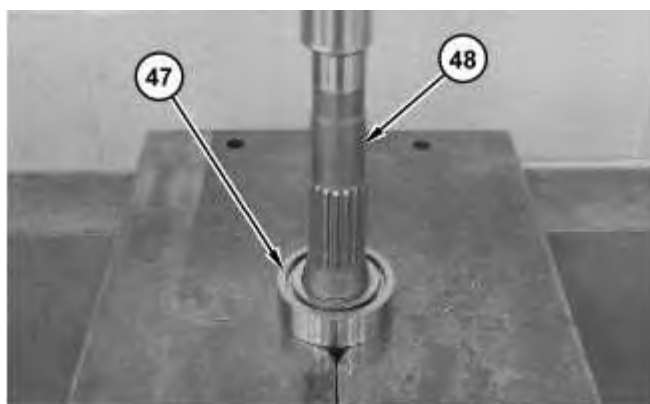

Illustration 4

g03025941

4. Raise the temperature of bearing (47).
5. Install bearing (47) onto shaft (48).

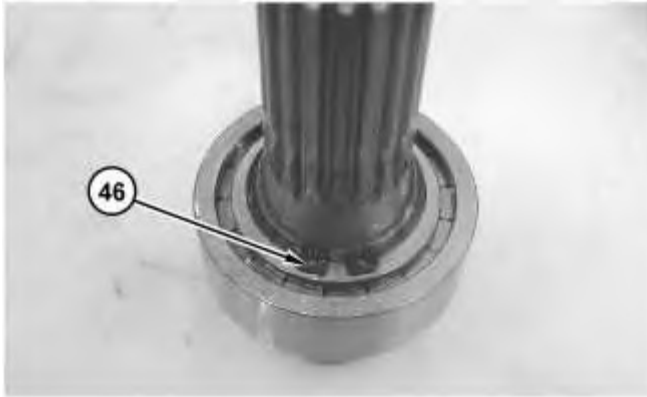

Illustration 5

g03025925

6. Use Tooling (C) in order to install retaining ring (46).

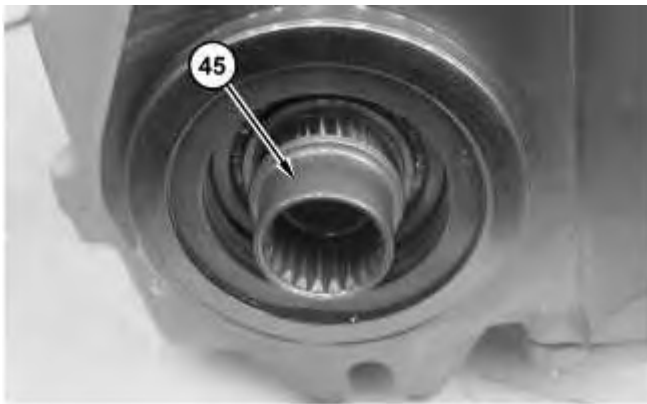

Illustration 6

g03025922

7. Install shaft assembly (45).

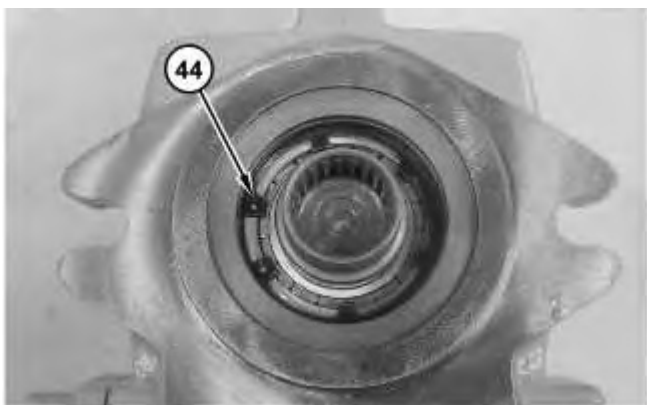

Illustration 7

g03025919

8. Use Tooling (A) in order to install retaining ring (44).
-

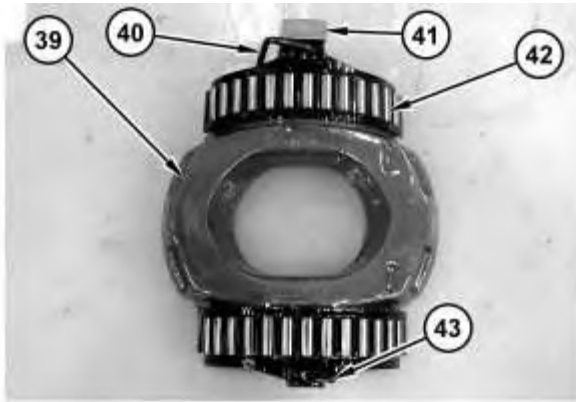

Illustration 8

g03025938

9. Install the following items onto swashplate assembly (39): pin (43), bearings (42), block (41) and pin (40).

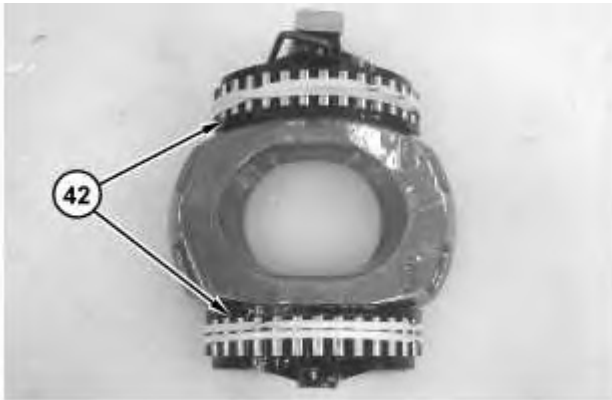

Illustration 9

g03026086

10. Position rubber bands around bearings (42) in order to keep bearings (42) from coming loose during Step 11.

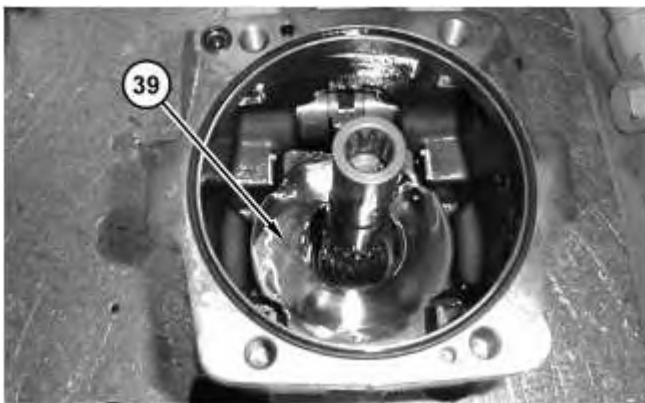

Illustration 10

g03025917

11. Install swashplate assembly (39).

12. Remove the rubber bands.

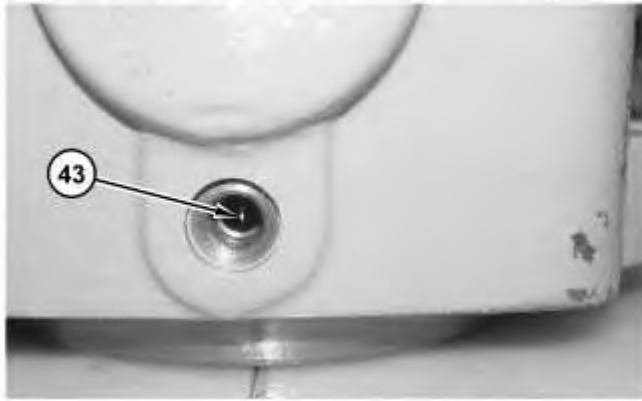

Illustration 11

g03026088

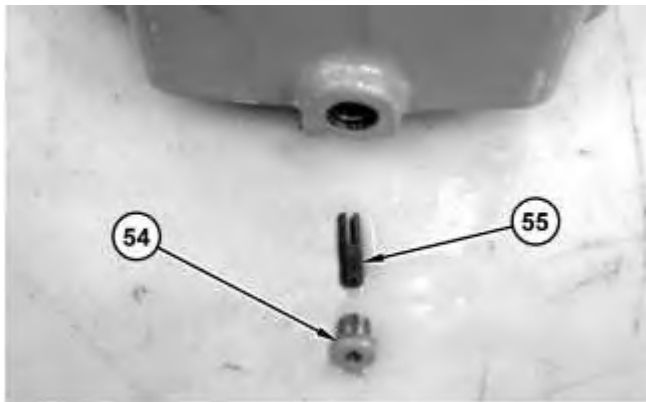

Illustration 12

g03025960

13. Make sure that pin (43) is lined up in the center of the threaded hole for plug (54) and pin retainer (55). Install pin retainer (55) and plug (54).



Illustration 13

g03025916

14. Install O-ring seal (38) and O-ring seal (37).

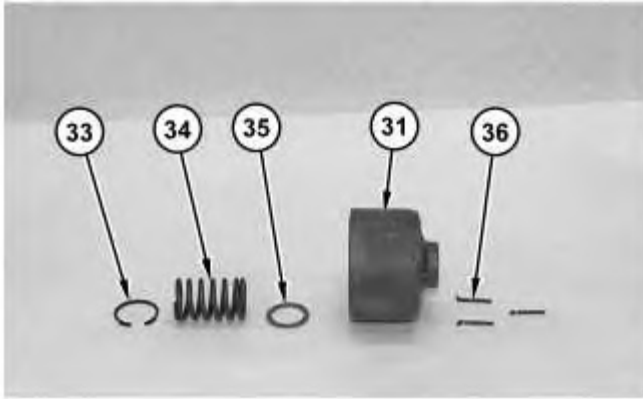

Illustration 14

g03025880

15. Install the following items into barrel assembly (31): pins (36), washer (35), spring (34) and retaining ring (33).



Illustration 15

g03025879

! WARNING

Improper assembly of parts that are spring loaded can cause bodily injury.

To prevent possible injury, follow the established assembly procedure and wear protective equipment.

16. Use Tooling (C) and a suitable press in order to install retaining ring (33) (not shown).

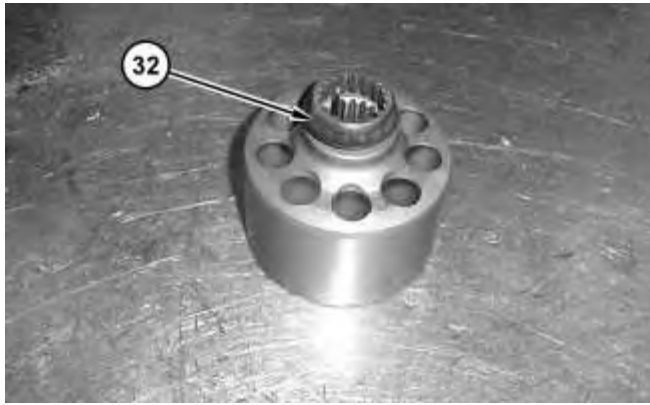

Illustration 16

g03025877

17. Install retainer (32).

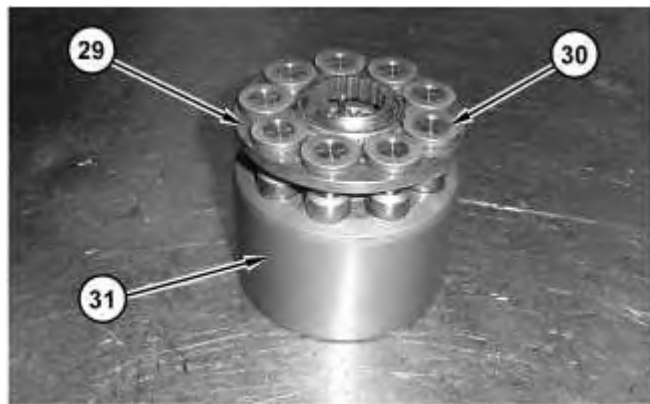

Illustration 17

g03025876

18. Position pistons (30) and retainer plate (29) into barrel assembly (31).

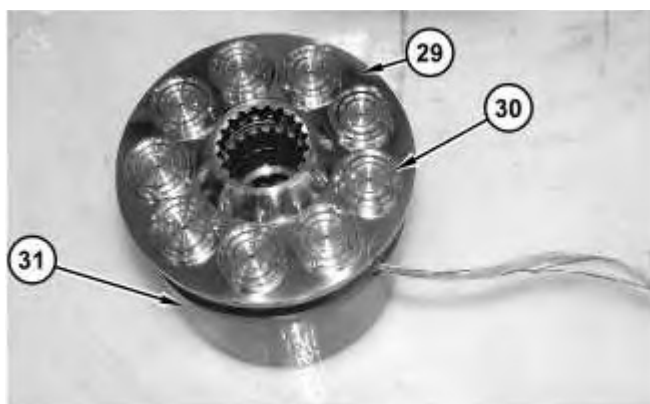

Illustration 18

g03026099

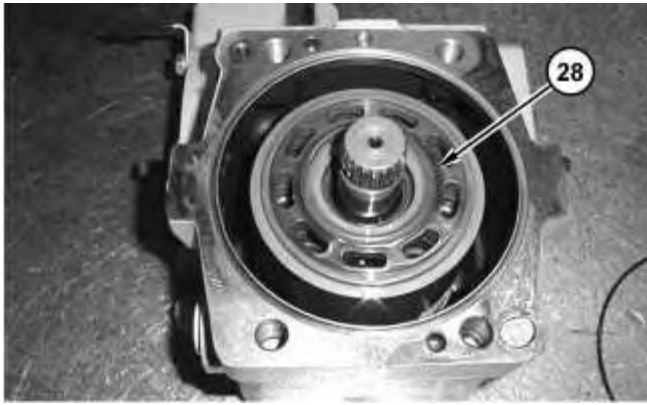

Illustration 19

g03025767

Note: Attach a string or another suitable device around pistons (30) and underneath retainer plate (29) in order to keep everything together during the installation.

19. Install rotating group (28) and remove the string.



Illustration 20

g03025765

20. Install valve (27).

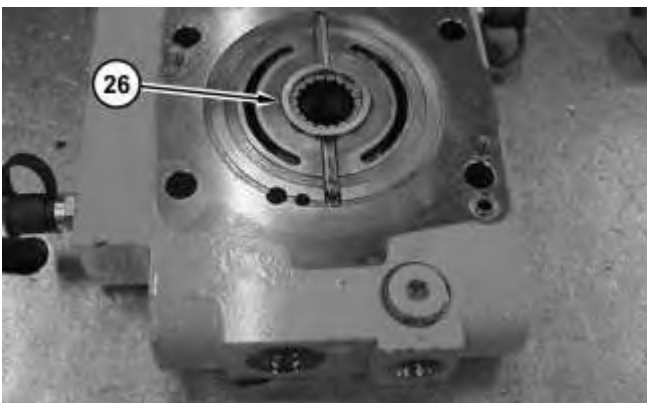

Illustration 21

g03025762

21. Install bearing (26).

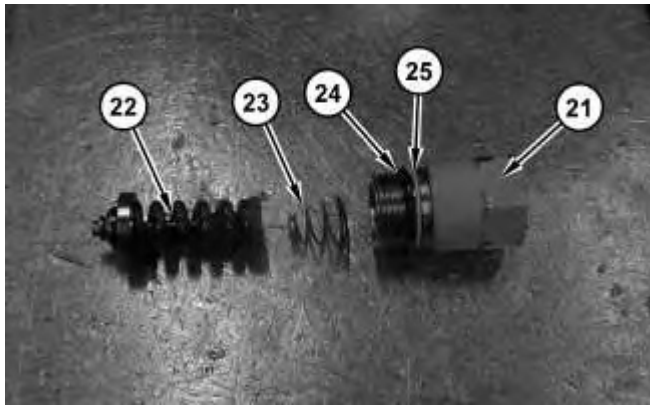

Illustration 22

g03025761

22. Install the following items into plug (21): spring (22), spring (23), backup ring (25) and O-ring seal (24).

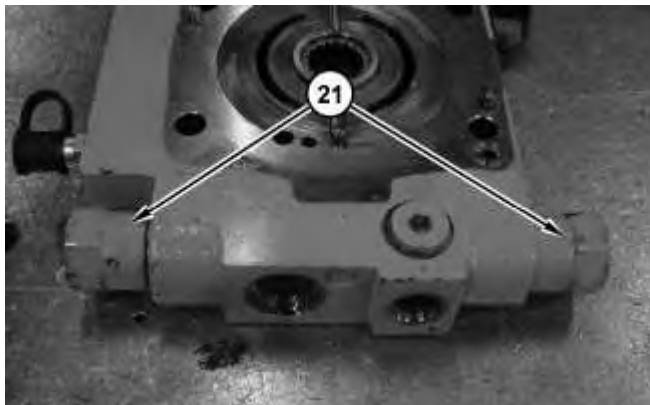

Illustration 23

g03025760



Improper assembly of parts that are spring loaded can cause bodily injury.

To prevent possible injury, follow the established assembly procedure and wear protective equipment.

23. Install plugs (21).

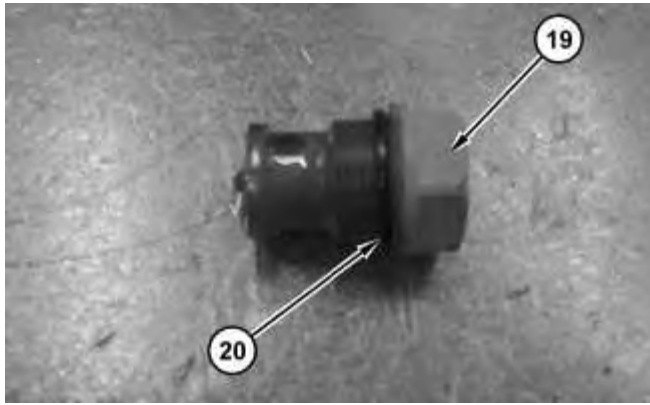

Illustration 24

g03025758

24. Install O-ring seal (20) onto plug (19).



Illustration 25

g03025742

25. Install plug (19).

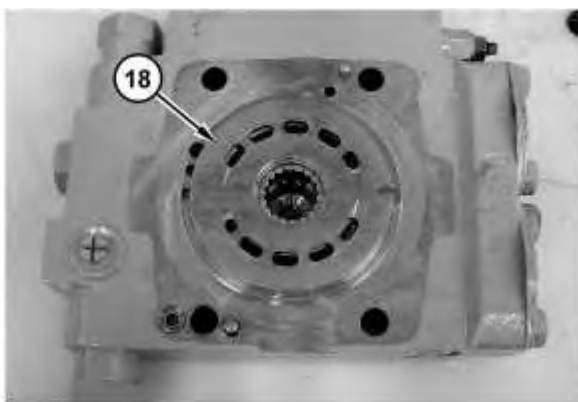

Illustration 26

g03025741

26. Install port plate (18).

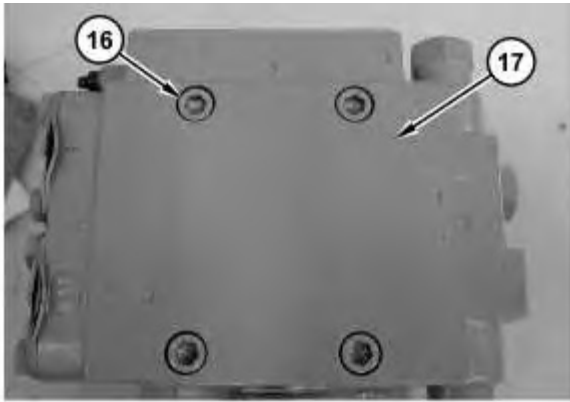

Illustration 27

g03025739

27. Position head (17) and install bolts (16).

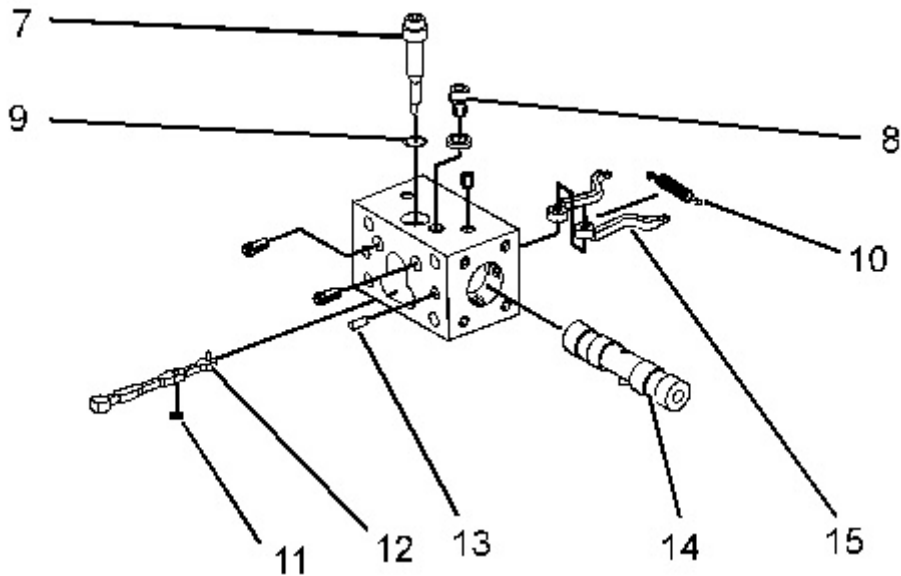
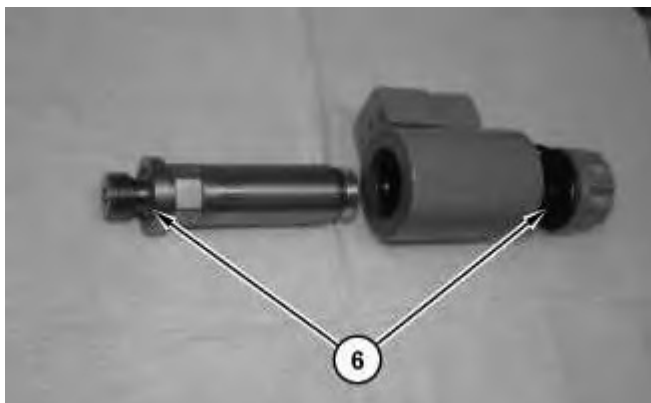

Illustration 28

g03025618

28. Install spool (14).

29. Install shims (11), levers (15) and (12), spring (10), and pins (13).



30. Install O-ring seals (6).

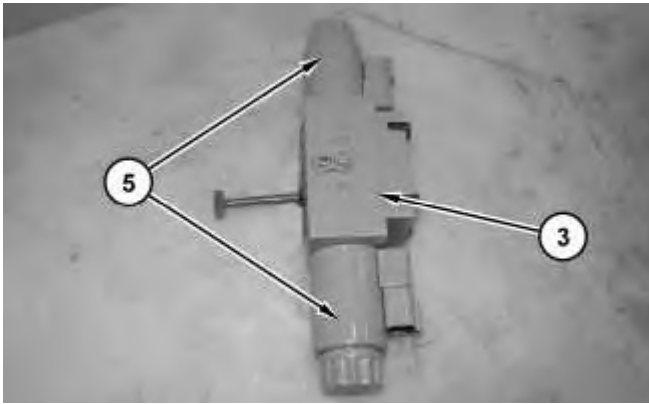

Illustration 30

31. Install solenoid assemblies (5) onto valve assembly (3).

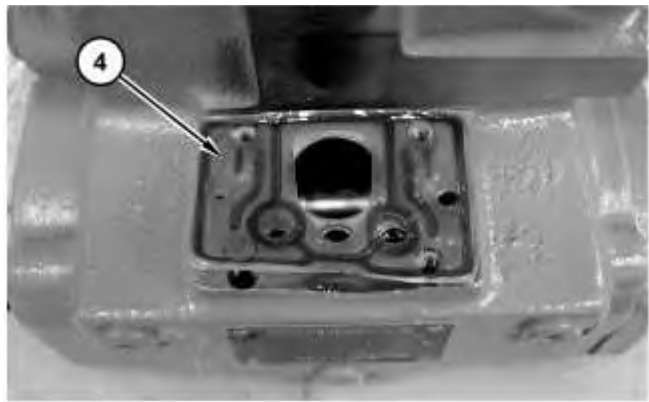

Illustration 31

32. Install gasket (4).

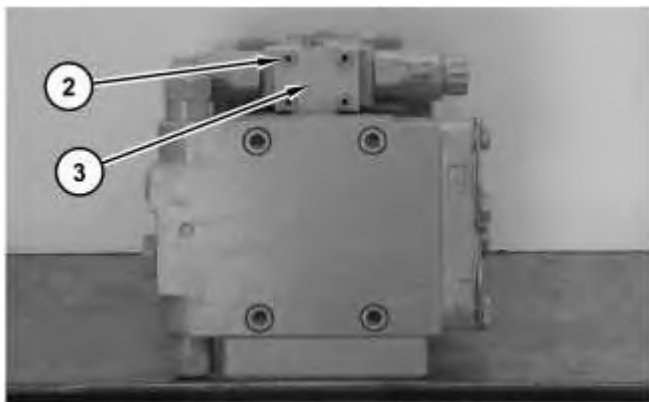

Illustration 32

33. Position valve assembly (3). Install bolts (2).

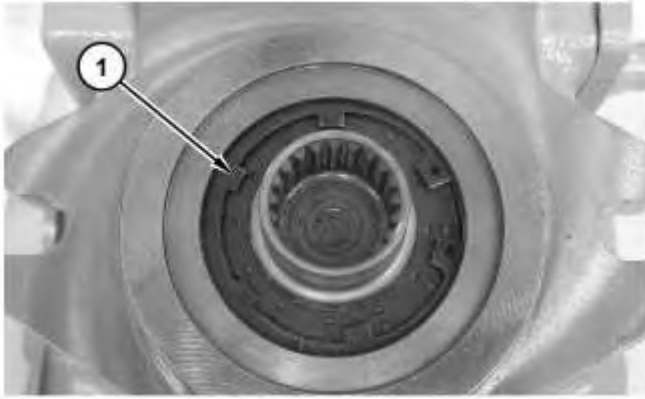

Illustration 33

g01216510

34. Use Tooling (A) in order to install retaining ring (1).

End By:

- a. Install the piston pump. Refer to Disassembly and Assembly, "Piston Pump (Vibratory) - Install".
-

Product: COMPACTOR

Model: CB10 COMPACTOR NPP

Configuration: CB10 Asphalt Compactor NPP00001-UP (MACHINE) POWERED BY C4.4 Engine

Disassembly and Assembly CB10 Vibratory Asphalt Compactor Machine Systems

Media Number -M0079158-02

Publication Date -01/12/2014

Date Updated -29/11/2017

i04788320

Drum - Remove and Install - Split Drum

SMCS - 6605-010

Removal Procedure

Table 1

Required Tools			
Tool	Part Number	Part Description	Qty
A	-	Loctite 242	-

Start By:

- Release system pressure.
- Connect steering frame lock.
- Remove front drum scraper.



WARNING

Personal injury can result from hydraulic oil pressure and hot oil.

Hydraulic oil pressure can remain in the hydraulic system after the engine has been stopped. Serious injury can be caused if this pressure is not released before any service is done on the hydraulic system.

Make sure all of the work tools have been lowered to the ground, and the oil is cool before removing any components or lines. Remove the oil filler cap only when the engine is stopped, and the filler cap is cool enough to touch with your bare hand.

1. Insure machine is on a flat level surface before drum is removed.



Illustration 1

g02992559

2. Use suitable lifting device and place vibratory compactor on suitable cribbing.

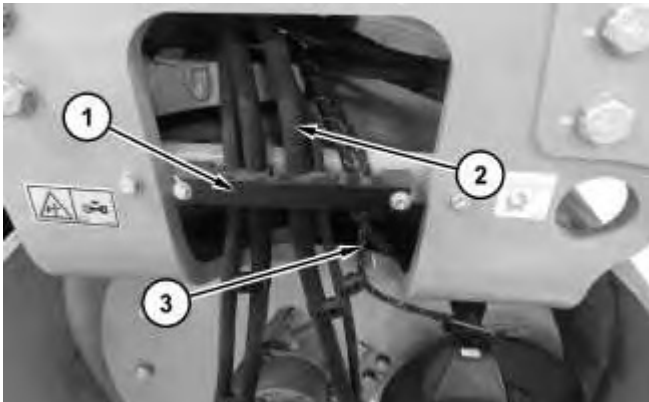

Illustration 2

g02902161

3. Remove clip (1). Disconnect hose assemblies (2) and harness assembly (3). Repeat for opposite side.



Illustration 3

g02902198

4. Remove clip (4). Disconnect harness assembly (5). Repeat for opposite side.

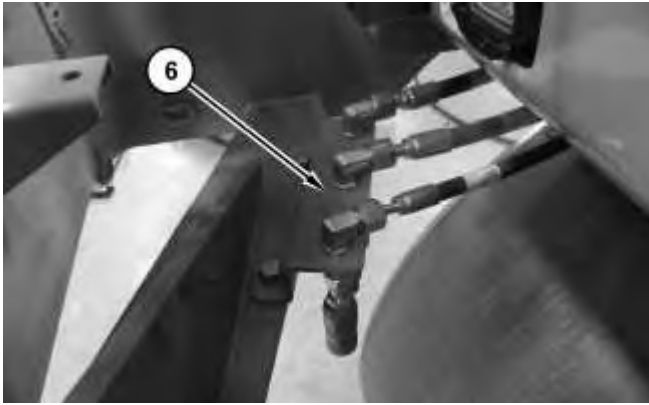

Illustration 4

g02902518

5. Remove bracket (6).

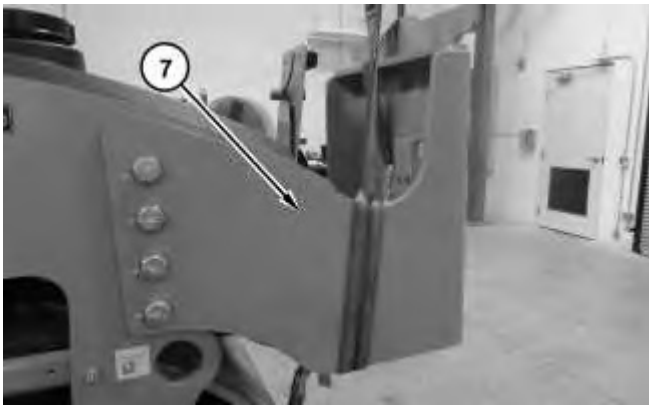
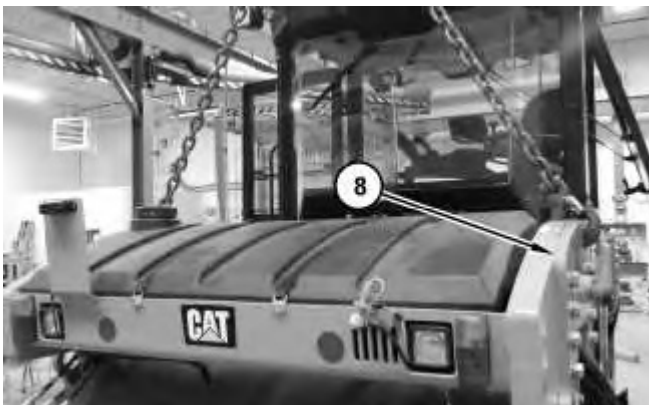

Illustration 5

g02902599

6. Attach a suitable lifting device to bracket (7). The weight of bracket (7) is approximately 200 kg (441 lb). Remove bracket (7). Repeat for opposite side.

Note: Reinstall bolts for safety purposes.



7. Attach a suitable lifting device to drum supports (8). Raise the rear of the machine and place on suitable cribbing under the frame in order to support the weight of the machine. Lower the machine and the drum to the ground.

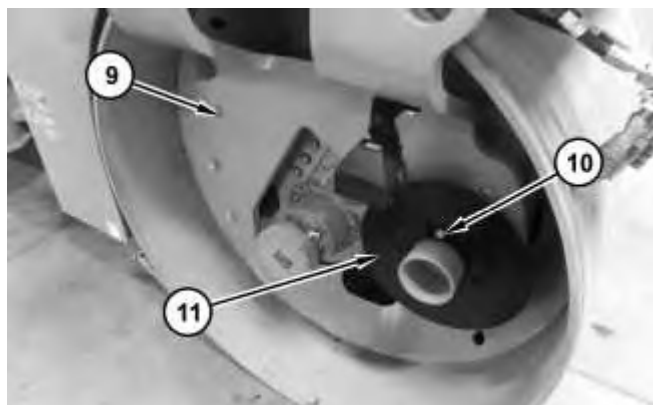

Illustration 7

8. Remove bolts (9), bolts (10), and disk (11).

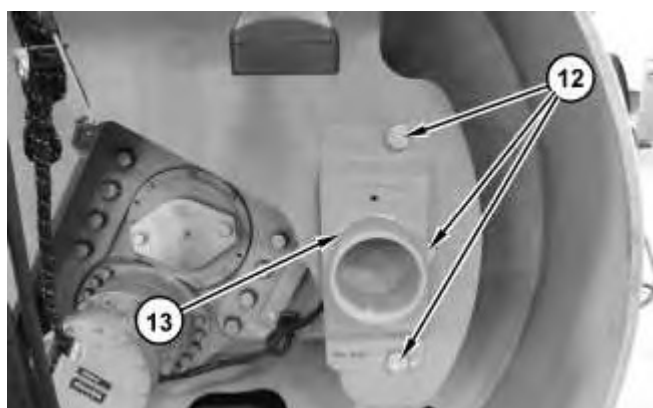
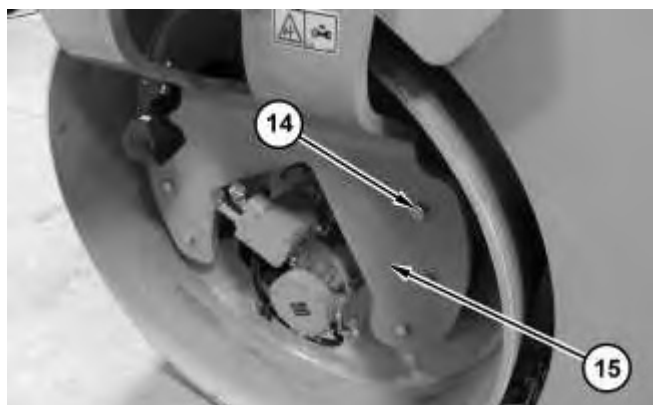

Illustration 8

9. Remove bolts (12) and bracket (13).



10. Remove bolts (14) and support (15).

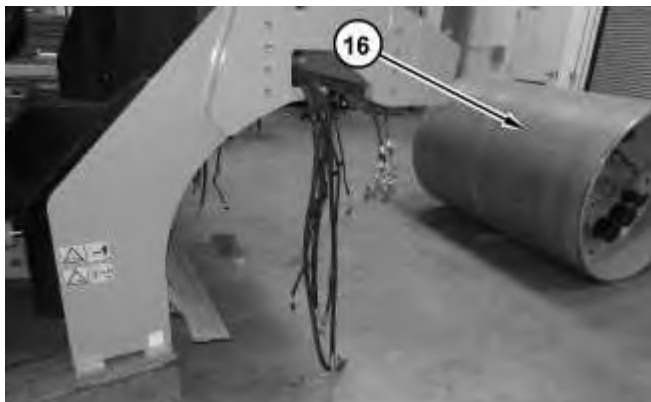

Illustration 10

g02903947

11. Remove drum (16). Chock drum (16).

Installation Procedure

1. Install drum (16) in the reverse order of removal.
 - a. Apply Tooling (A) to bolts (9).
 - b. Apply Tooling (A) to bolts (10).
 - c. Apply Tooling (A) to bolts (12).
 - d. Apply Tooling (A) to bolts (14).
-

Thank you so much for reading.
Please click the “Buy Now!”
button below to download the
complete manual.



After you pay.

You can download the most
perfect and complete manual in
the world immediately.

Our support email:

ebooklibonline@outlook.com