

Product: VIBRATORY COMPACTOR

Model: CP-533E VIBRATORY COMPACTOR BZG

Configuration: CS-533E,CP-533E Vibratory Compactor BZG00001-UP (MACHINE) POWERED BY 3054C Engine

Disassembly and Assembly CP-533E and CS-533E Vibratory Soil Compactors Machine Systems

Media Number -KENR3664-05

Publication Date -01/12/2009

Date Updated -17/12/2009

i01958455

Piston Motor (Axle Propel) - Assemble

SMCS - 4351-016; 5058-016

Assembly Procedure

Table 1

Required Tools			
Tool	Part Number	Part Description	Qty
A	1P-1854	Retaining Ring Pliers	1

Note: Cleanliness is an important factor. Before assembly, thoroughly clean all parts in cleaning fluid. Allow the parts to air dry. Do not use wiping cloths or rags to dry parts. Lint may be deposited on the parts which may cause trouble. Inspect all parts. If any parts are worn or damaged, use new parts for replacement. Dirt and other contaminants can damage the precision component. Perform assembly procedures on a clean work surface. Keep components covered and protected at all times.

Note: Check the O-ring seals, the gaskets, and the seals for wear or for damage. Replace the components, if necessary.

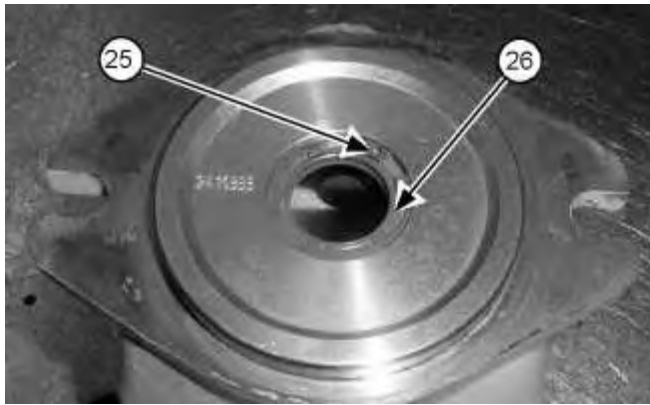

Illustration 1

g01018089

1. Use Tooling (A) in order to install retaining ring (25). Install seal (26) .

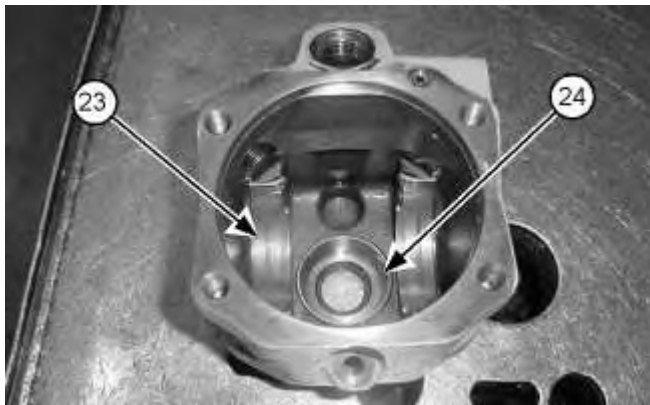

Illustration 2

g01018088

2. Install bearing (23) and bearing cup (24) .

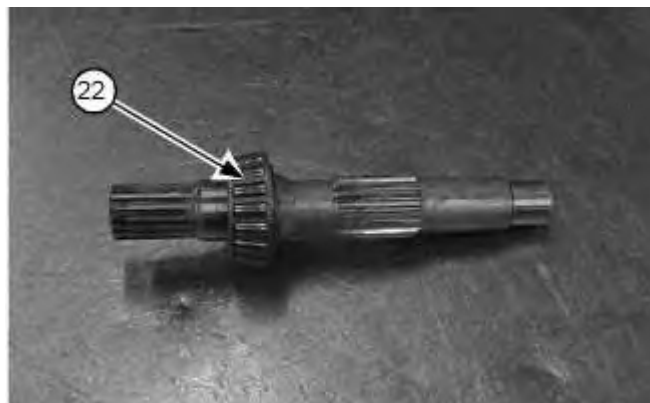

Illustration 3

g01018087

3. Raise the temperature of bearing cone (22) .

4. Install bearing cone (22) .



Illustration 4

g01018086

5. Install shaft (21) .

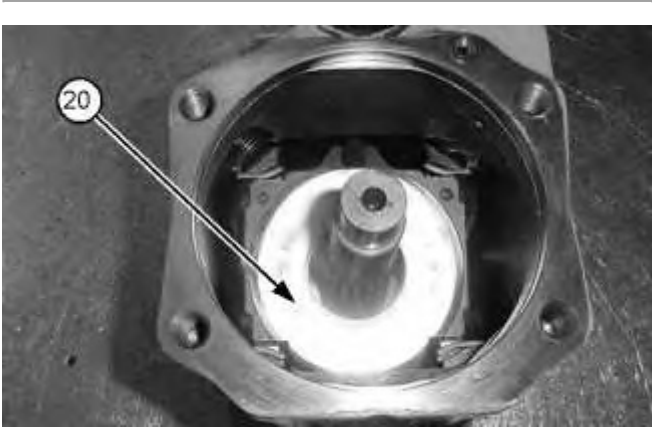
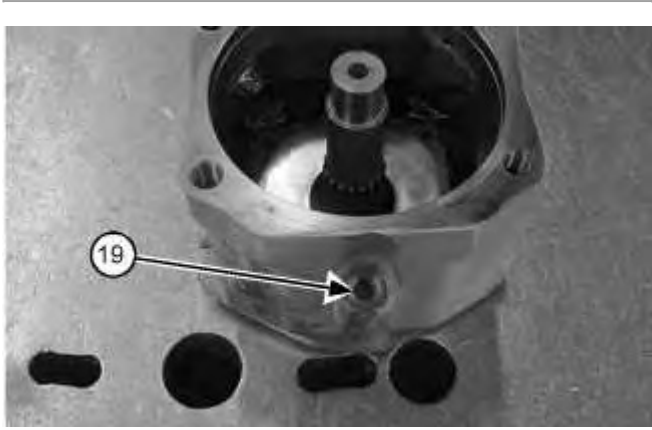

Illustration 5

g01018085

6. Install swashplate (20) .



7. Install plug (19) .

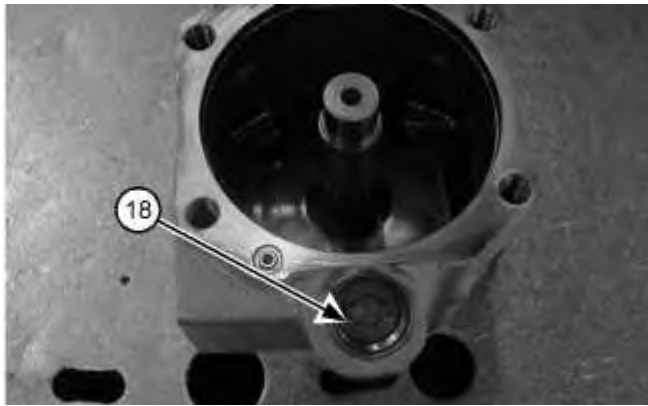

Illustration 7

8. Install plug (18) .

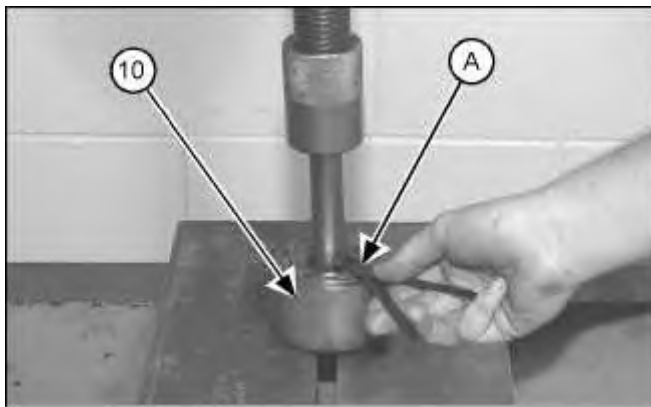
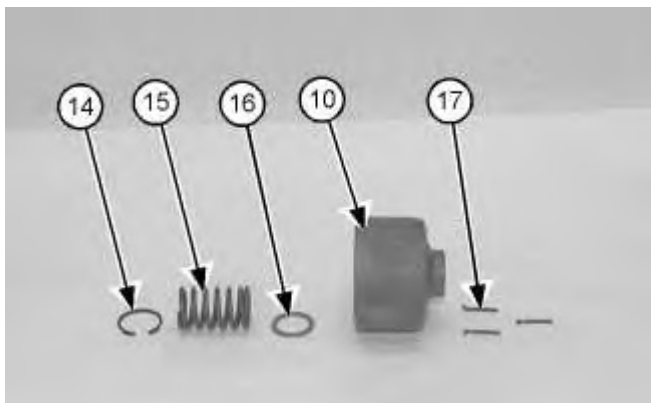

Illustration 8



! WARNING

Improper assembly of parts that are spring loaded can cause bodily injury.

To prevent possible injury, follow the established assembly procedure and wear protective equipment.

9. Use a suitable press and Tooling (A) in order to install retaining ring (14) .
10. Install spring (15), washer (16), and pins (17) into barrel assembly (10) .

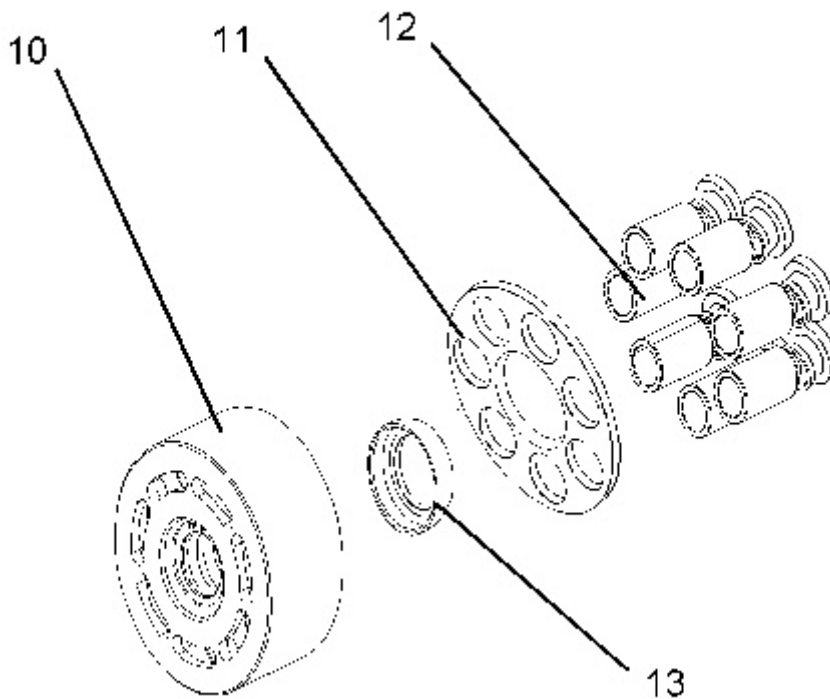

11. Install retaining ball (13) .
12. Install pistons (12) and plate (11) into barrel assembly (10) .

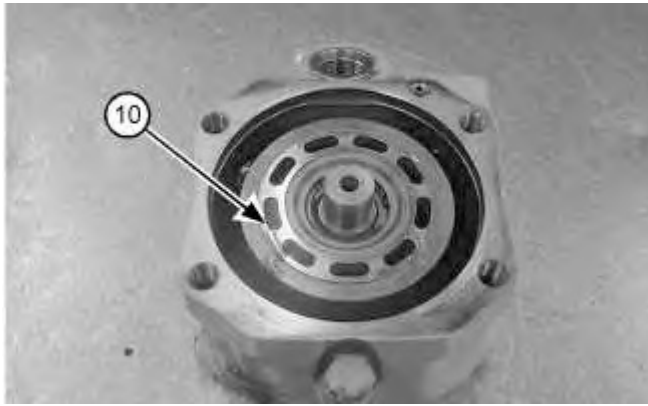

Illustration 11

g01017900

13. Install barrel assembly (10) .

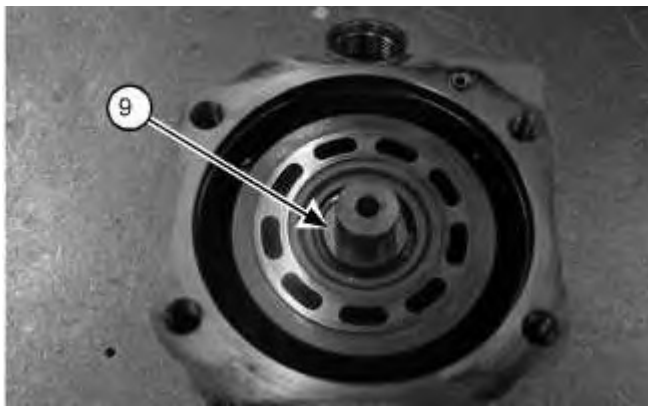
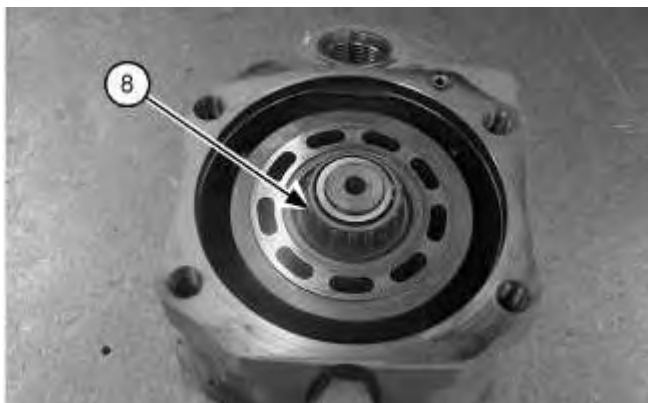

Illustration 12

g01017901

14. Install washer (9) .



15. Install bearing cone (8) .

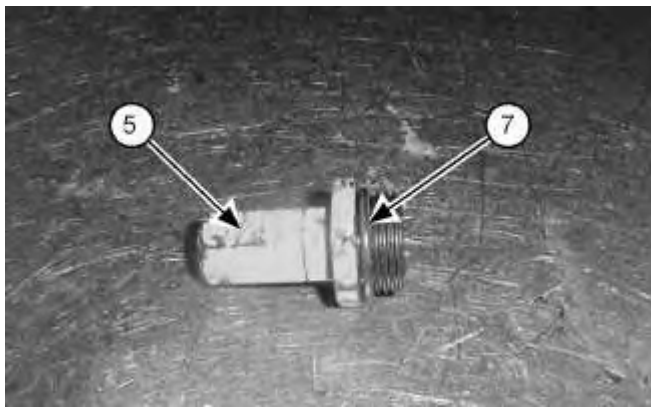

Illustration 14

16. Install O-ring seal (7) from plug (5) .

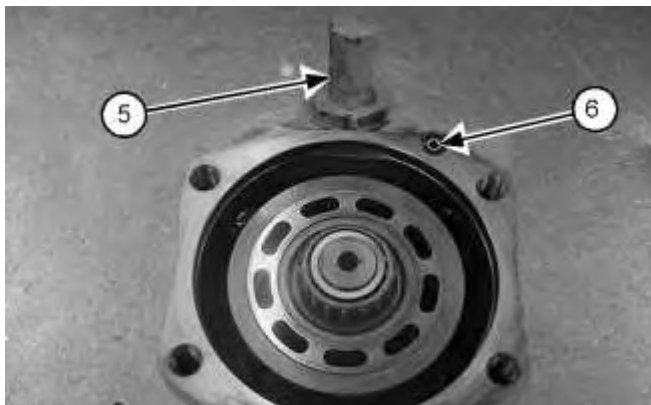

Illustration 15

17. Install O-ring seal (6) .
 18. Install plug (5) .
-

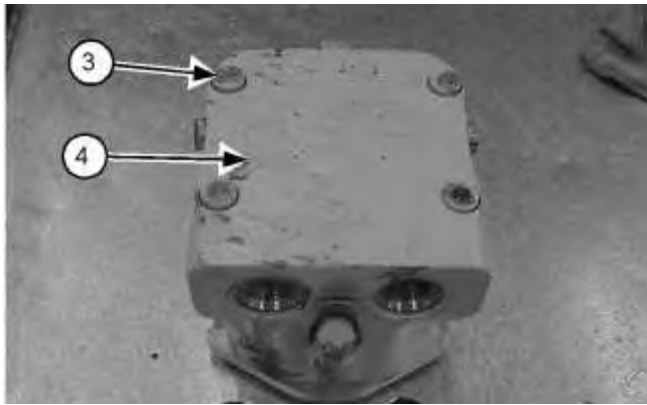

Illustration 16

g01017895

19. Install the bearing cup into cover (4) .
20. Install the bearing cup from cover (4) .

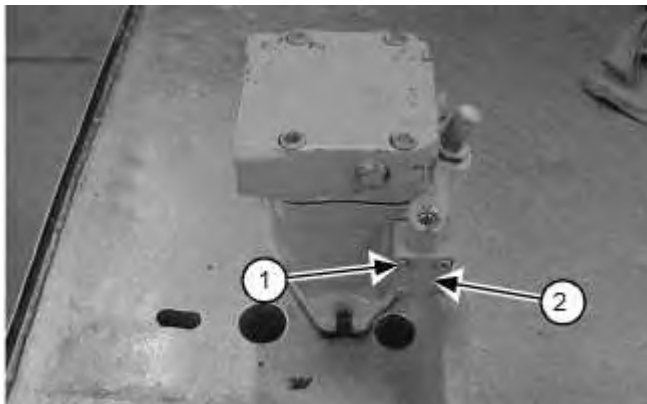

Illustration 17

g01017893

21. Install bolts (1) and valve (2) .

End By: Install the piston motor. Refer to Disassembly and Assembly, "Piston Motor (Axle Propel) - Install".

Product: VIBRATORY COMPACTOR

Model: CP-533E VIBRATORY COMPACTOR BZG

Configuration: CS-533E,CP-533E Vibratory Compactor BZG00001-UP (MACHINE) POWERED BY 3054C Engine

Disassembly and Assembly CP-533E and CS-533E Vibratory Soil Compactors Machine Systems

Media Number -KENR3664-05

Publication Date -01/12/2009

Date Updated -17/12/2009

i01943921

Piston Motor (Axle Propel) - Install

SMCS - 4351-012; 5058-012

Installation Procedure

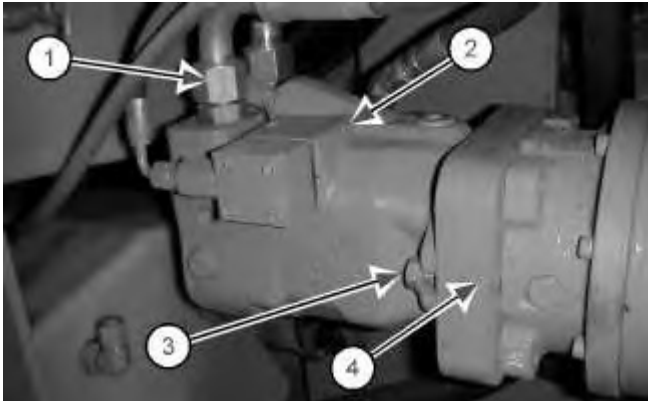

Illustration 1

g01011553

1. Install the O-ring seal on axle propel motor (2). Position axle propel motor (2) on a suitable floor jack. Install the axle propel motor and bolts (3). The weight of the axle propel motor is approximately 36 kg (80 lb).
2. Install four hose assemblies (1) on axle propel motor (2) .
3. Fill housing (4) with oil. The capacity of the housing is approximately 0.5 L (0.13 US gal).
4. Fill the hydraulic oil tank with oil. The capacity of the hydraulic oil tank is approximately 80 L (21 US gal). Refer to Operation and Maintenance Manual, "Hydraulic System Oil - Change".

Product: VIBRATORY COMPACTOR

Model: CP-533E VIBRATORY COMPACTOR BZG

Configuration: CS-533E,CP-533E Vibratory Compactor BZG00001-UP (MACHINE) POWERED BY 3054C Engine

Disassembly and Assembly CP-533E and CS-533E Vibratory Soil Compactors Machine Systems

Media Number -KENR3664-05

Publication Date -01/12/2009

Date Updated -17/12/2009

i01861319

Final Drive Planetary (Axle Propel) - Remove

SMCS - 4050-011

Removal Procedure

Start By:

- a. Remove the axle propel motor. Refer to Disassembly and Assembly, "Piston Motor (Axle Propel) - Remove".



Illustration 1

g00799772

1. Position a suitable lifting device under final drive planetary (1).
2. Remove bolts (2). Remove final drive planetary (1) and the O-ring seal from the axle. The weight of the final drive planetary is approximately 25 kg (55 lb).

Product: VIBRATORY COMPACTOR

Model: CP-533E VIBRATORY COMPACTOR BZG

Configuration: CS-533E,CP-533E Vibratory Compactor BZG00001-UP (MACHINE) POWERED BY 3054C Engine

Disassembly and Assembly CP-533E and CS-533E Vibratory Soil Compactors Machine Systems

Media Number -KENR3664-05

Publication Date -01/12/2009

Date Updated -17/12/2009

i01952143

Final Drive Planetary (Axle Propel) - Disassemble

SMCS - 4050-015

Disassembly Procedure

Start By:

- a. Remove the final drive planetary (axle propel). Refer to Disassembly and Assembly, "Final Drive Planetary (Axle Propel) - Remove".



Illustration 1

g00984154

1. Remove bolts (2) and input flange (1).



Illustration 2

g00984155

2. Remove O-ring seal (3) from input flange (1).



Illustration 3

g00984156

3. Remove sun gear (4).



Illustration 4

g00984157

4. Remove planetary carrier (5).



Illustration 5

g00984210

5. Remove retaining ring (6) and washer (7) from planetary carrier (5).



Illustration 6

g00984211

6. Remove planetary gear (8) from planetary carrier (5).

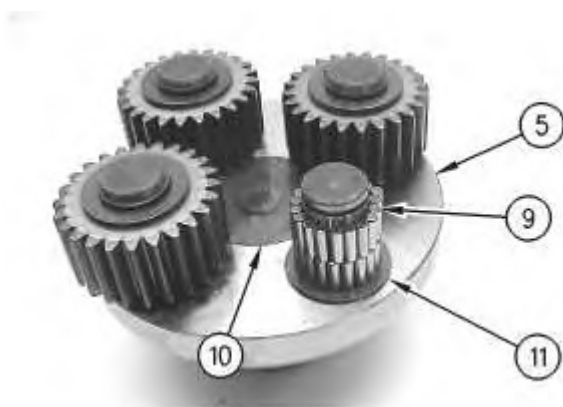

Illustration 7

g00984212

7. Remove 38 needle bearings (9) and washer (11) from planetary carrier (5).
8. Remove cover (10) from planetary carrier (5).
9. Repeat Steps 5 through 7 and remove the remaining three planetary gears.



Illustration 8

g00984219

10. Remove ring gear (12) and the O-ring seal from output flange (14).
 11. Remove spring pins (13) from ring gear (12).
-

Product: VIBRATORY COMPACTOR

Model: CP-533E VIBRATORY COMPACTOR BZG

Configuration: CS-533E,CP-533E Vibratory Compactor BZG00001-UP (MACHINE) POWERED BY 3054C Engine

Disassembly and Assembly CP-533E and CS-533E Vibratory Soil Compactors Machine Systems

Media Number -KENR3664-05

Publication Date -01/12/2009

Date Updated -17/12/2009

i02036591

Final Drive Planetary (Axle Propel) - Assemble

SMCS - 4050-016

Assembly Procedure

Table 1

Required Tools			
Tool	Part Number	Part Description	Qty
A	5P-0960	Molybdenum Grease	1



Illustration 1

g00984219

1. Install spring pins (13) in ring gear (12).
2. Install the O-ring seal and ring gear (12) on output flange (14).

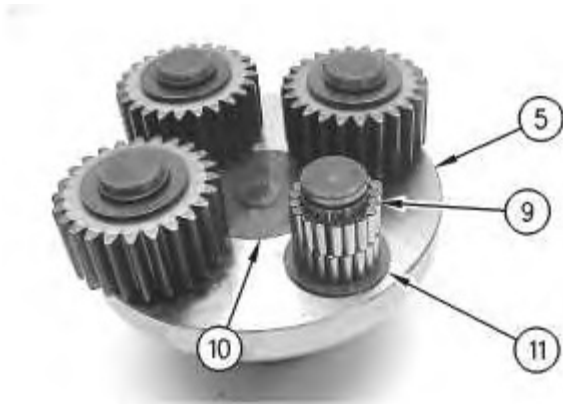

Illustration 2

g00984212

3. Install cover (10) in planetary carrier (5).
4. Install washer (11) on the planetary gear pin.
5. Apply Tooling (A) on needle bearings (9). Install 38 needle bearings (9) on the planetary gear pin. There are two rows of needle bearings (9) on the planetary gear pin. Each row contains 19 needle bearings.

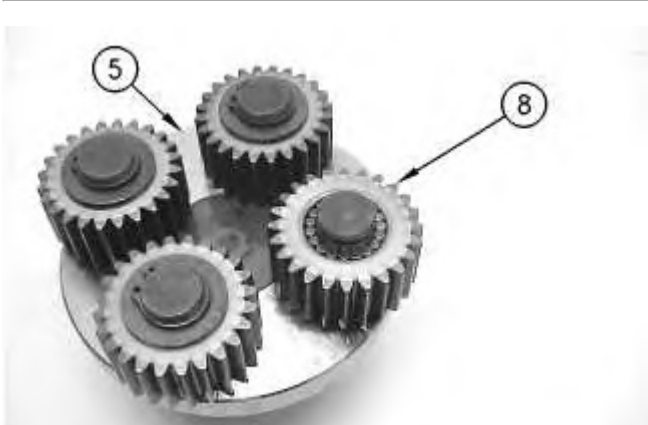

Illustration 3

g00984211

6. Install planetary gear (8) on the needle bearings and planetary carrier (5).



Illustration 4

g00984210

7. Install washer (7) and retaining ring (6) on planetary carrier (5).
8. Repeat Steps 4 through 7 and install the remaining three planetary gears.



Illustration 5

g00984157

9. Install planetary carrier (5).



Illustration 6

g00984156

10. Install sun gear (4).



Illustration 7

g00984155

11. Install O-ring seal (3) in input flange (1).



Illustration 8

g00984154

12. Position input flange (1) on the ring gear and install bolts (2).

End By:

- a. Install the final drive planetary (axle propel). Refer to Disassembly and Assembly, "Final Drive Planetary (Axle Propel) - Install".
-

Product: VIBRATORY COMPACTOR

Model: CP-533E VIBRATORY COMPACTOR BZG

Configuration: CS-533E,CP-533E Vibratory Compactor BZG00001-UP (MACHINE) POWERED BY 3054C Engine

Disassembly and Assembly CP-533E and CS-533E Vibratory Soil Compactors Machine Systems

Media Number -KENR3664-05

Publication Date -01/12/2009

Date Updated -17/12/2009

i02250928

Final Drive Planetary (Axle Propel) - Install

SMCS - 4050-012

Installation Procedure

Table 1

Required Tools			
Tool	Part Number	Part Description	Qty
A	9S-3263	Thread Lock Compound	1



Illustration 1

g00799772

1. Use a suitable lifting device to position the O-ring seal and final drive planetary (1) on the axle. The weight of the final drive planetary is approximately 25 kg (55 lb). Apply Tooling (A) on bolts (2) and install the bolts.

End By: Install the axle propel motor. Refer to Disassembly and Assembly, "Piston Motor (Axle Propel) - Install".

Thank you so much for reading.
Please click the “Buy Now!”
button below to download the
complete manual.



After you pay.

You can download the most
perfect and complete manual in
the world immediately.

Our support email:

ebooklibonline@outlook.com