

Product: TRACK-TYPE TRACTOR

Model: D5N TRACK-TYPE TRACTOR CKT

Configuration: D5N TRACK-TYPE TRACTOR /XL, LGP, POWER SHIFT/ CKT00001-UP (MACHINE) POWERED BY 3126B ENGINE

## Disassembly and Assembly D5N Track-Type Tractor Power Train

Media Number -REN5287-04

Publication Date -01/01/2009

Date Updated -07/01/2009

i01855501

# Transmission and Bevel Gears - Connect

SMCS - 3010-077

## Connection Procedure

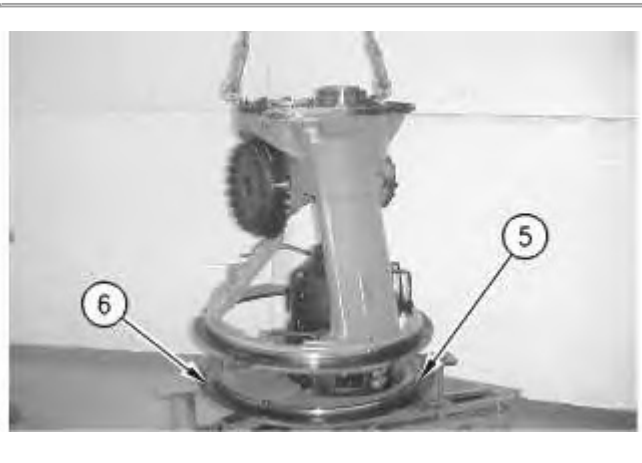

Illustration 1

g00947520

1. Remove bolts (6) that secure the transmission to Tooling (A) .
  2. Install seal (5) to the transmission.
  3. Install the bevel gears to the transmission. The weight of the bevel gears is approximately 245 kg (550 lb).
-

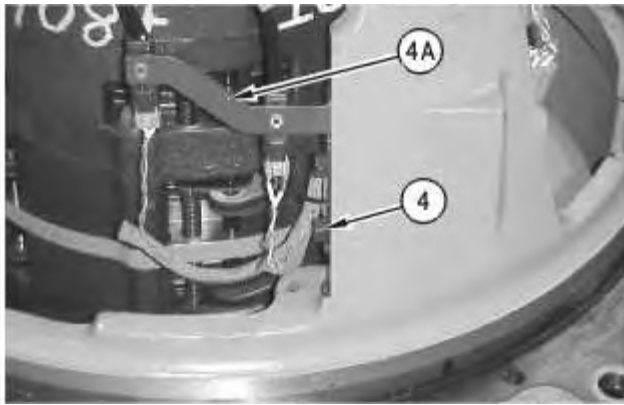

Illustration 2

g00952487

4. Install bracket (4A). Install bolts (4) .

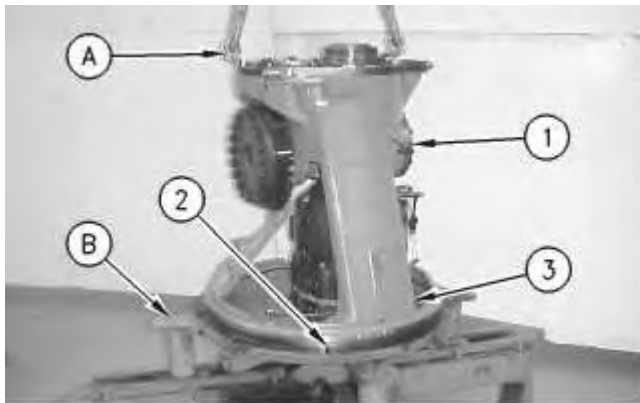

Illustration 3

g00947498

5. Install bolts (2) that connect the transmission to bevel gears (3) .
6. Remove the transmission and bevel gears (1) .

**End By:**

- a. Install the transmission and the bevel gears. Refer to Disassembly and Assembly, "Transmission and Bevel Gears - Install".
  - b. Install the hydraulic control valve. Refer to Disassembly and Assembly, "Hydraulic Control Valve - Install".
-

Product: TRACK-TYPE TRACTOR

Model: D5N TRACK-TYPE TRACTOR CKT

Configuration: D5N TRACK-TYPE TRACTOR /XL, LGP, POWER SHIFT/ CKT00001-UP (MACHINE) POWERED BY 3126B ENGINE

## Disassembly and Assembly D5N Track-Type Tractor Power Train

Media Number -REN5287-04

Publication Date -01/01/2009

Date Updated -07/01/2009

i01876034

# Bevel and Transfer Gears - Disassemble

SMCS - 3011-015

## Disassembly Procedure

Table 1

Required Tools			
Tool	Part Number	Part Description	Qty
A	1P-2420	Transmission Repair Stand	1
B	5F-7343	Bearing Puller Gp	1
C	8T-2839	Spanner Wrench	1

### Start By:

- A. Separate the transmission and the bevel gears. Refer to Disassembly and Assembly, "Transmission and Bevel Gears - Separate".
-

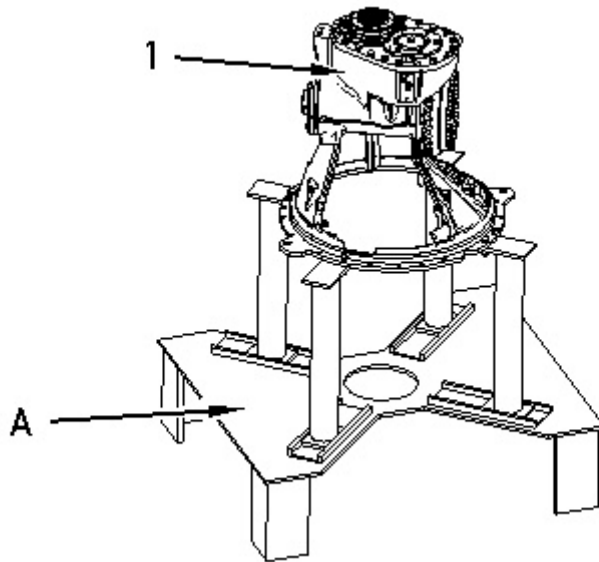

---

Illustration 1

g00959670

1. Mount bevel and transfer gears (1) onto Tooling (A) .

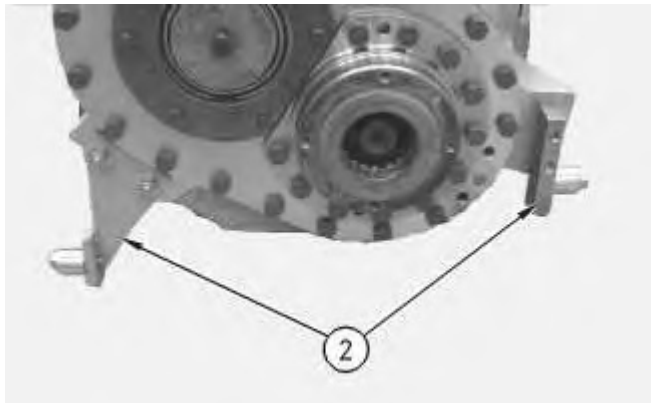

---

Illustration 2

g00954579

2. Remove bracket assemblies (2) .
-

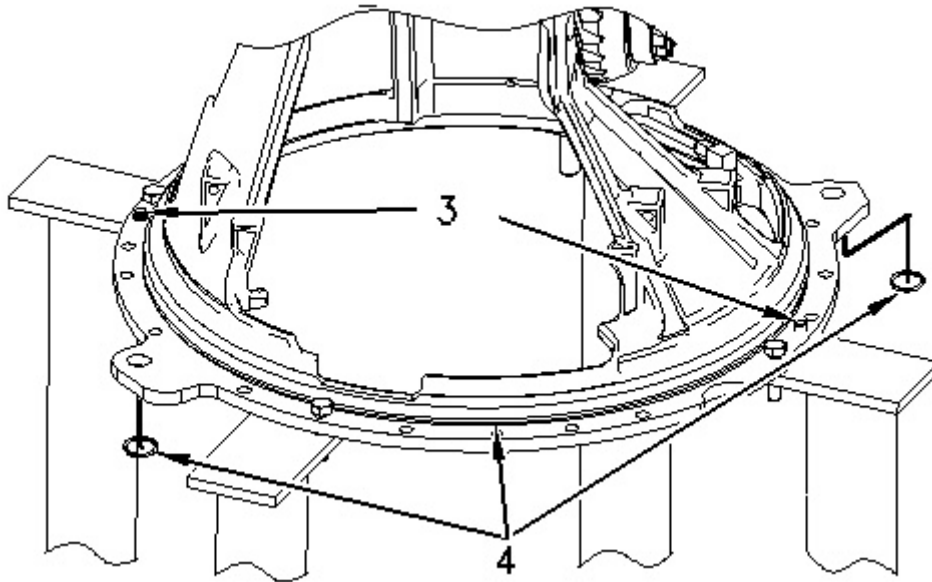

Illustration 3

g00954580

3. Remove O-ring seals (4) .
4. If necessary, remove pins (3) .

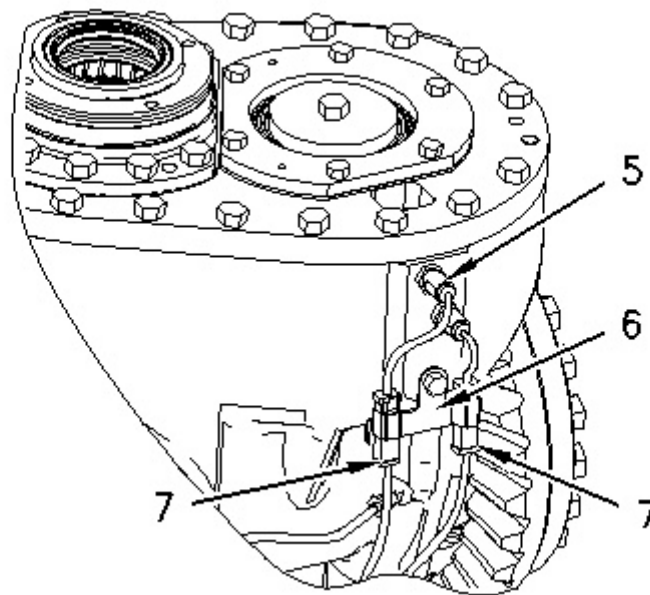
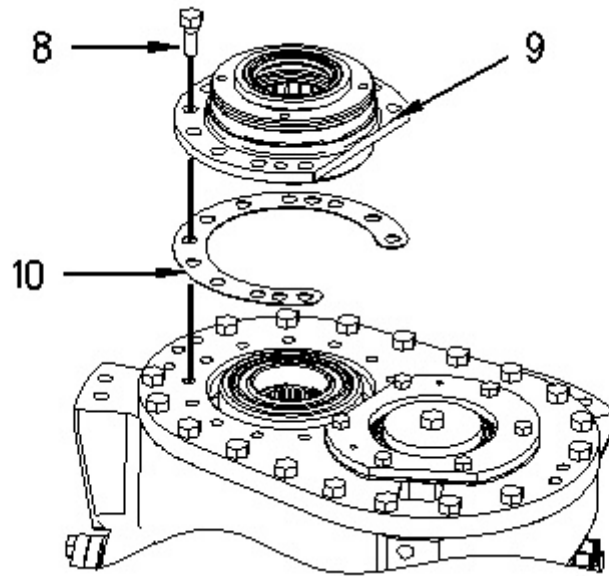

Illustration 4

g00954581

5. Disconnect harness assemblies (7) .
6. Remove sensors (5) .
7. Remove bracket (6) .



---

Illustration 5

g00954584

8. Remove bolts (8) .
9. Use two bolts (8) in order to remove cage (9) .
10. Remove shims (10) .

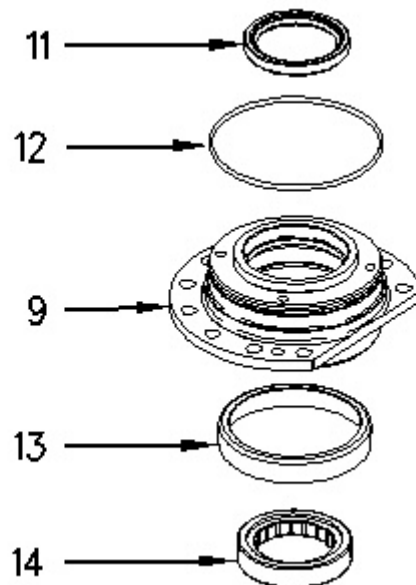

---

Illustration 6

g00954585

11. Remove O-ring seal (12) .
12. Remove seal (11) .

13. Remove bearing (14) .

14. Remove bearing cup (13) .

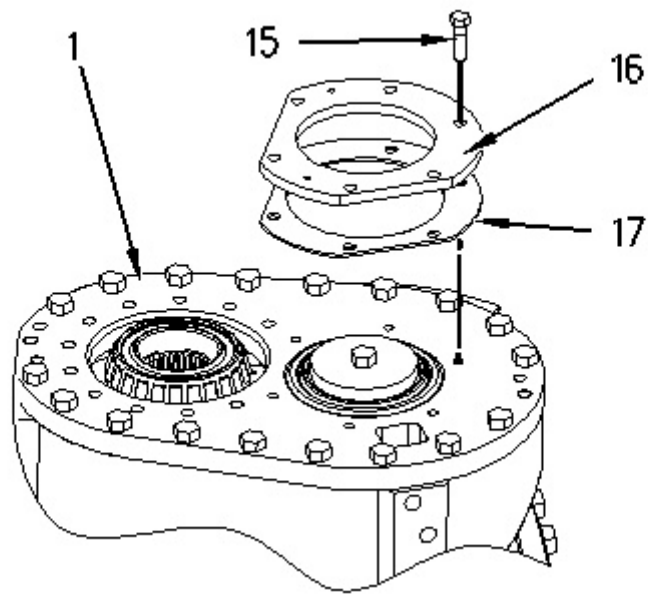

Illustration 7

g00954594

15. Remove bolts (15) .

16. Remove cover (16) .

17. Remove shims (17) .

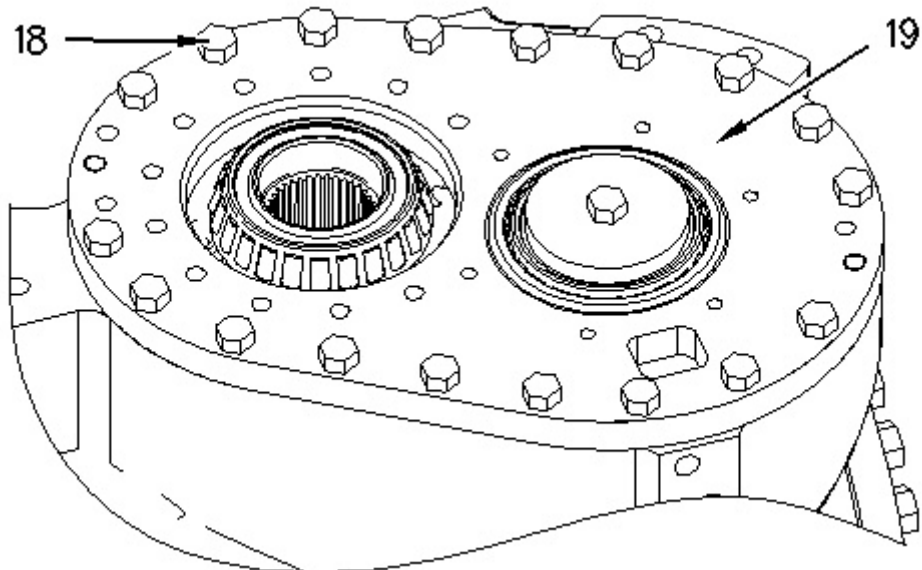
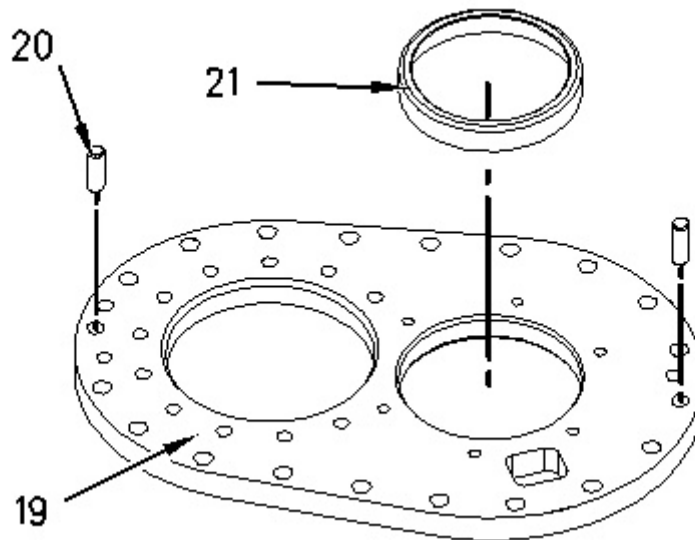

Illustration 8

g00954587

18. Remove bolts (18). Use two bolts 18 in order to remove cover (19). Tighten the two bolts evenly and remove cover (19) .



---

Illustration 9

g00954589

19. If necessary, remove dowels (20) and bearing cup (21) from cover (19) .

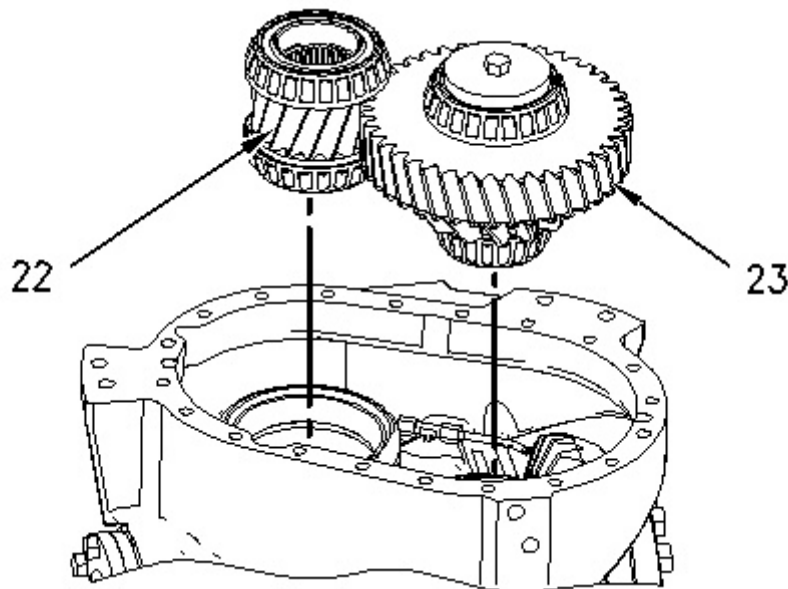

---

Illustration 10

g00954590

**Note:** Gears (22) and (23) must be removed from the case assembly at the same time.

20. Remove gear (22) and gear (23) from the case assembly.



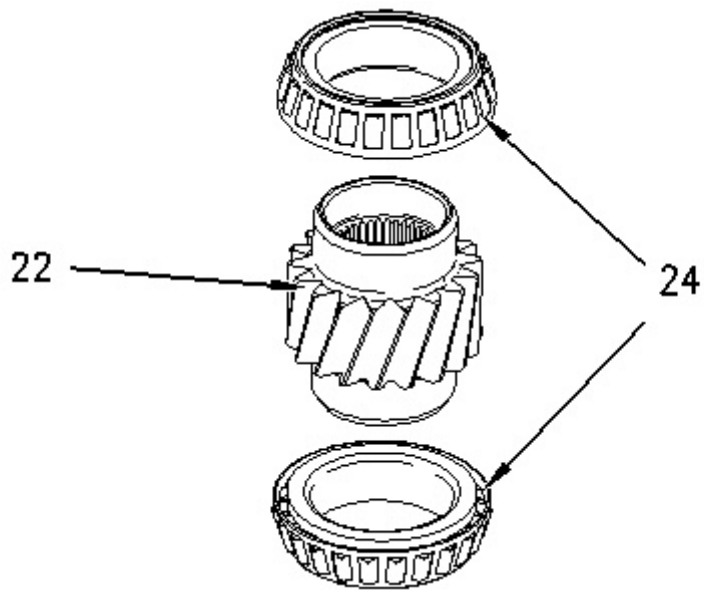

---

Illustration 11

g00954593

**Note:** Bearing cones (24) must be destroyed in order to remove the cones from the gear.

21. Remove bearing cones (24) from gear (22) .

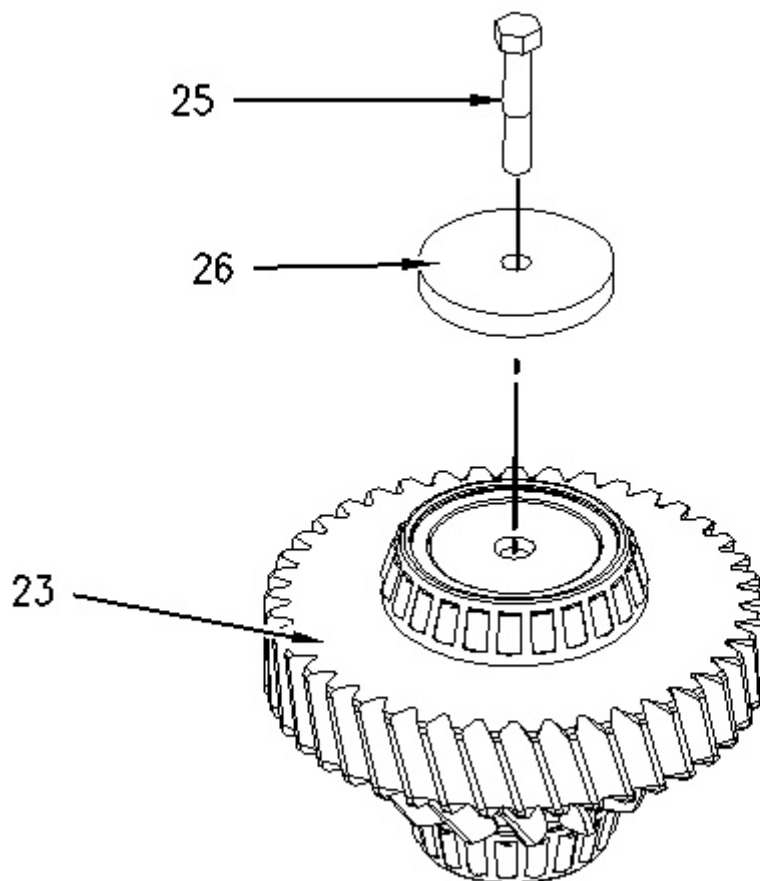

22. Remove bolt (25) and retainer (26) from gear (23) .

---

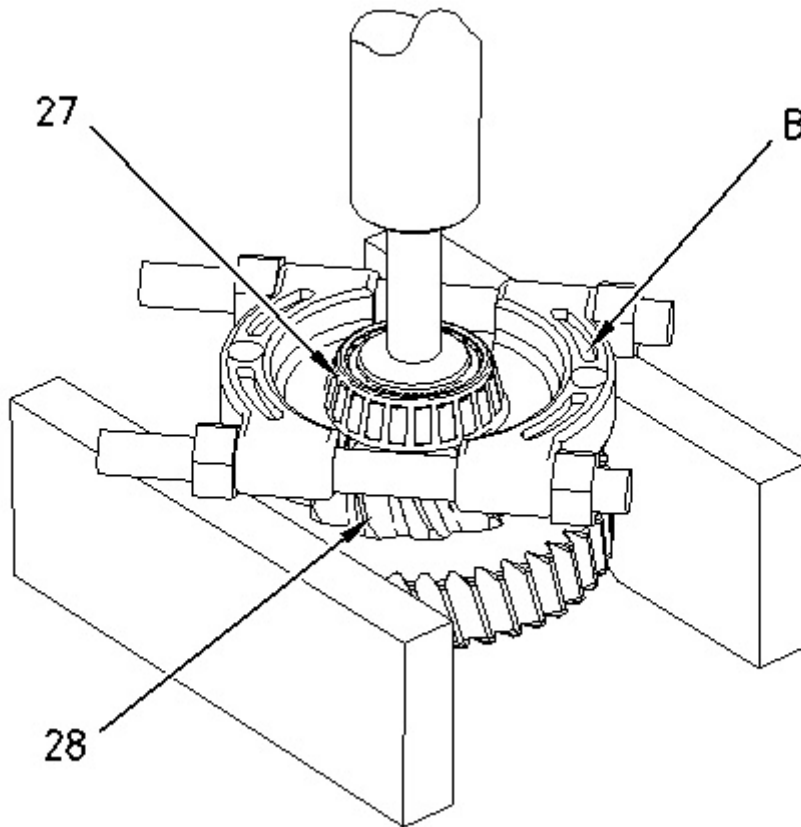

23. Use Tooling (B) and a press in order to remove bearing cone (27) from gear (28) .

---

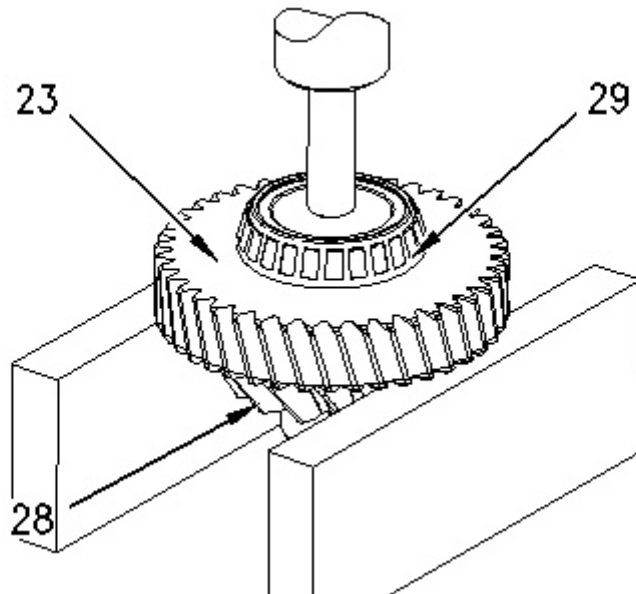

Illustration 14

g00954592

24. Use a suitable press in order to remove bearing cone (29) from gear (28) and from gear (23) .

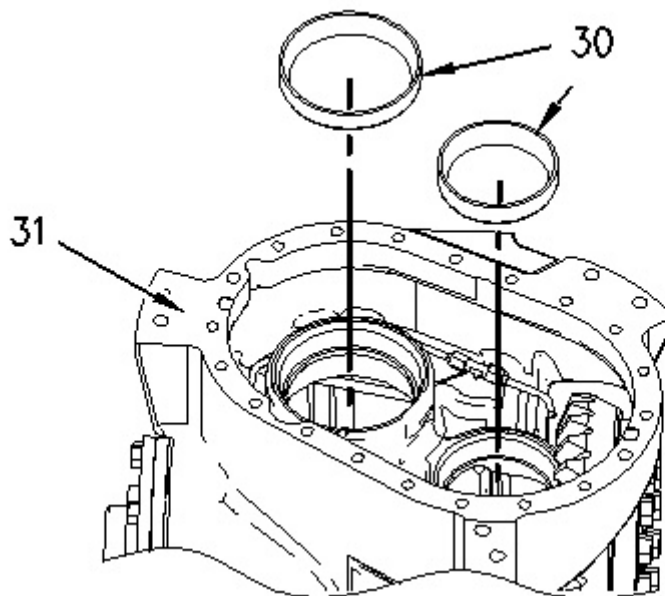
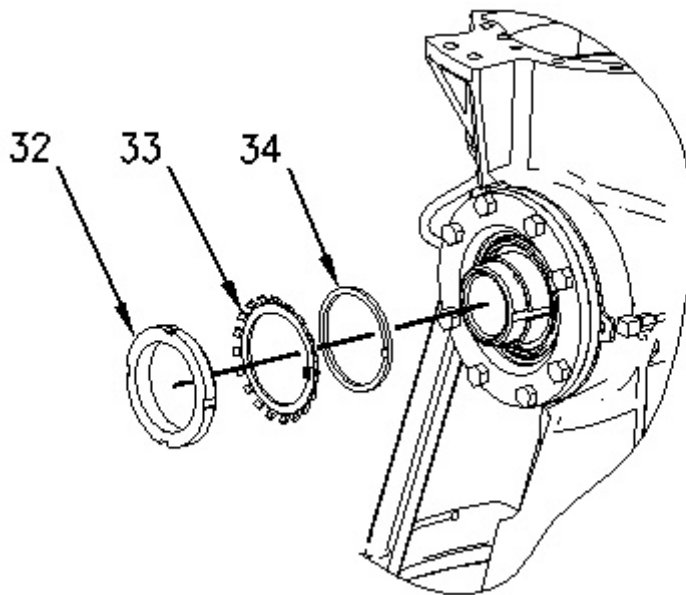

Illustration 15

g00954857

25. Remove bearing cups (30) from case (31) .



---

Illustration 16

g00954859

26. Bend the tab on washer (33) away from nut (32) .

**Note:** Use a new washer (33) during assembly.

27. Use Tooling (C) in order to remove nut (32) .

28. Remove washer (34) .

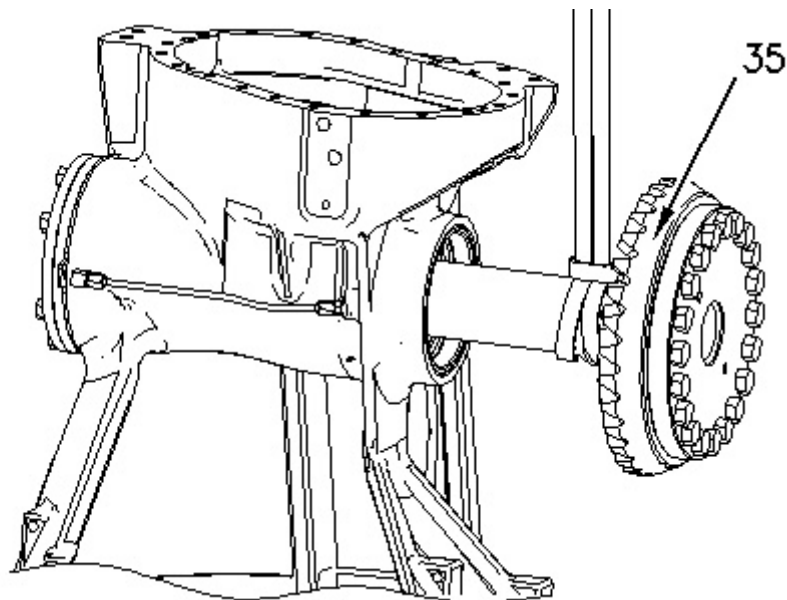

---

Illustration 17

g00954860

29. Attach a suitable lifting device to shaft assembly (35). The weight of the shaft is approximately 39 kg (86 lb).

30. Remove shaft assembly (35) .

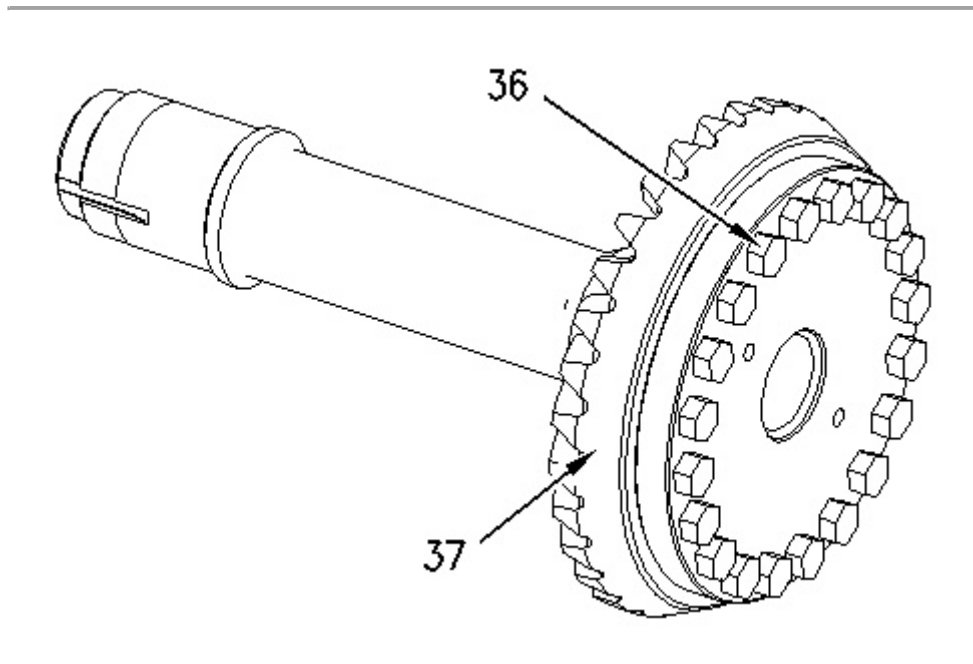

Illustration 18

g00954861

31. Remove bolts (36) .

32. Remove gear (37) .

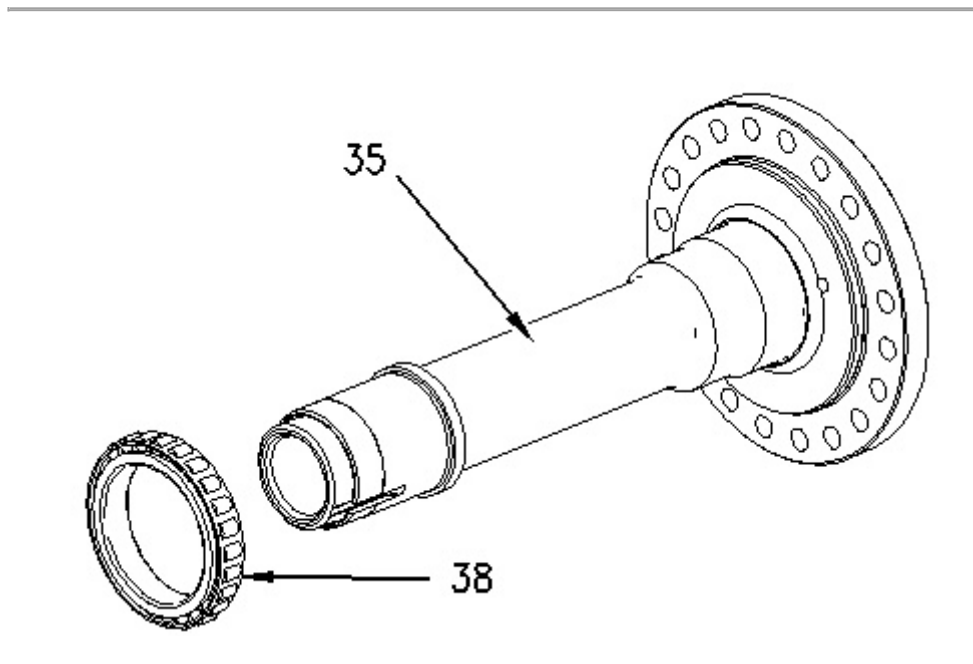
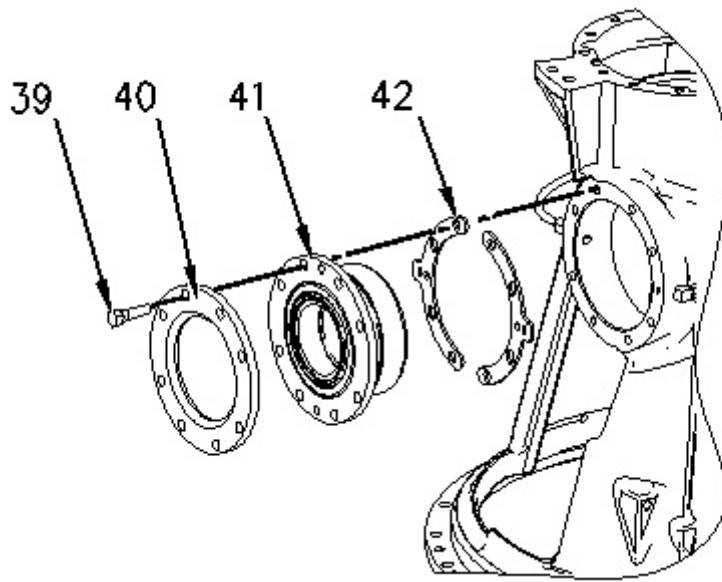

Illustration 19

g00954863

33. Remove the race and roller bearing (38) from shaft assembly (35) .



---

Illustration 20

g00954864

- 34. Remove bolts (39) and retainer (40) .
- 35. Remove cage (41) and shims (42) .

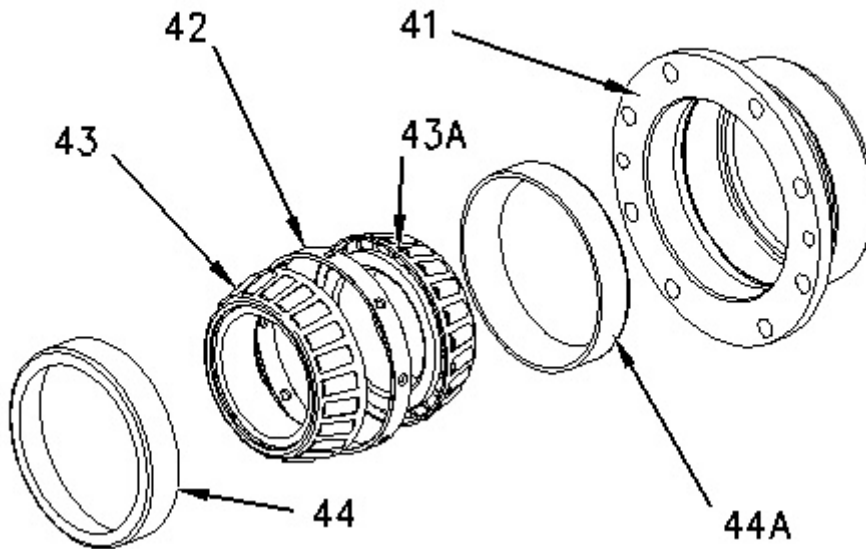

---

Illustration 21

g00954865

- 36. Remove the bearing cone and bearing cup (43) .
- 37. Remove spacer (42) .
- 38. Remove the bearing cone and bearing cup (44) from cage (41) .

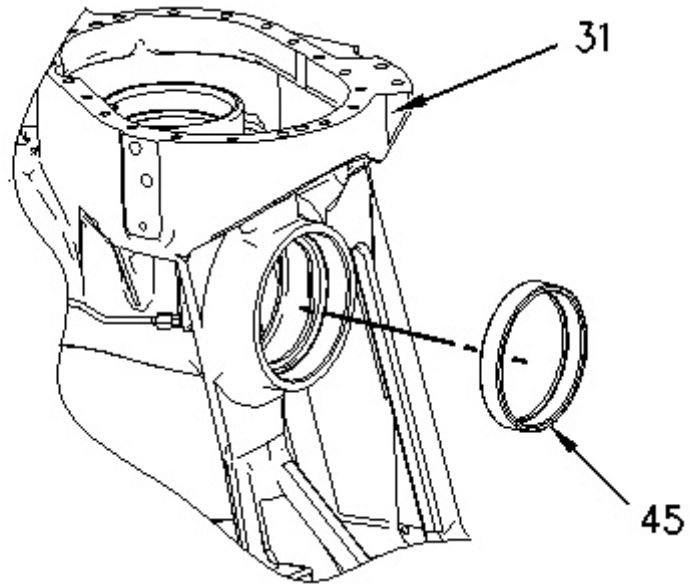

Illustration 22

g00960207

39. Remove bearing cup (45) from case (31) .

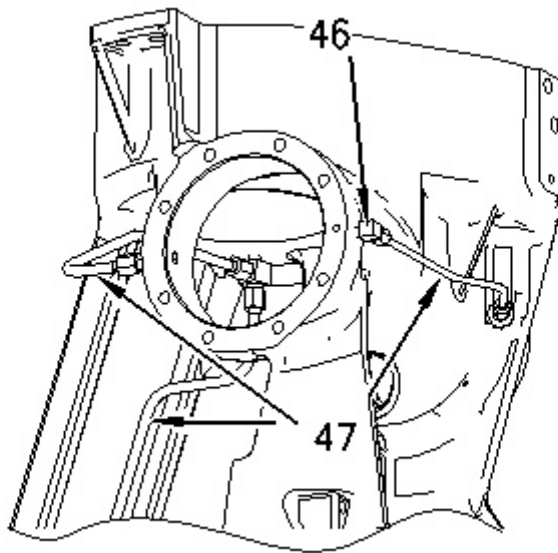

Illustration 23

g00960209

40. Remove tube assemblies (47) and fittings (46), if necessary.

---

Product: TRACK-TYPE TRACTOR

Model: D5N TRACK-TYPE TRACTOR CKT

Configuration: D5N TRACK-TYPE TRACTOR /XL, LGP, POWER SHIFT/ CKT00001-UP (MACHINE) POWERED BY 3126B ENGINE

## Disassembly and Assembly D5N Track-Type Tractor Power Train

Media Number -REN5287-04

Publication Date -01/01/2009

Date Updated -07/01/2009

i01876038

# Bevel and Transfer Gears - Assemble

SMCS - 3011-016

## Assembly Procedure

Table 1

Required Tools			
Tool	Part Number	Part Description	Qty
A	1P-2420	Transmission Repair Stand	1
C	8T-2839	Spanner Wrench	1
E	8T-5096	Dial Indicator Gp	1
	6V-6042	Indicator Point Gp	1
	8T-4122	Hard Washer	1
F	8B-7558	Adapter	1
	1B-3623	Bolt	1
	2P-8260	Cylinder Liner Installer	1
	2P-8260	Cylinder Liner Installer	1
	9U-6207	Plate	1
G	031-9099	Bolt	1
	2J-3506	Full Nut	1
	8T-4994	Hard Washer	1
H	4C-5597	Anti-Seize Compound	1
I	5P-3413	Pipe Sealant	1



J	1U-7234	Feeler Gauge	1
K	1P-0510	Driver Gp	1
L	FT-2973	Holding Plate	1

---

## NOTICE

**Keep all parts clean from contaminants.**

**Contamination of the hydraulic system with foreign material will reduce the service life of the hydraulic system components.**

**To prevent contaminants from entering the hydraulic system, always plug or cap the lines, fittings, or hoses as they are disconnected. Cover any disassembled components and clean them properly before assembly.**

**Clean the hydraulic system properly after any major component exchange or especially after a component failure, to remove any contamination.**

---

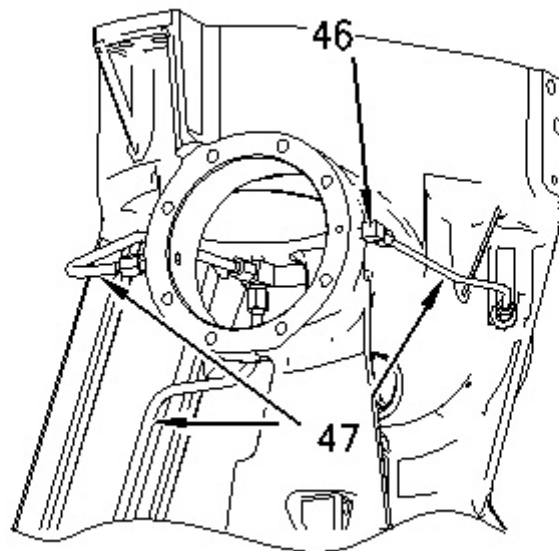

---

Illustration 1

g00960209

1. Install fittings (46) and tube assemblies (47) .
-

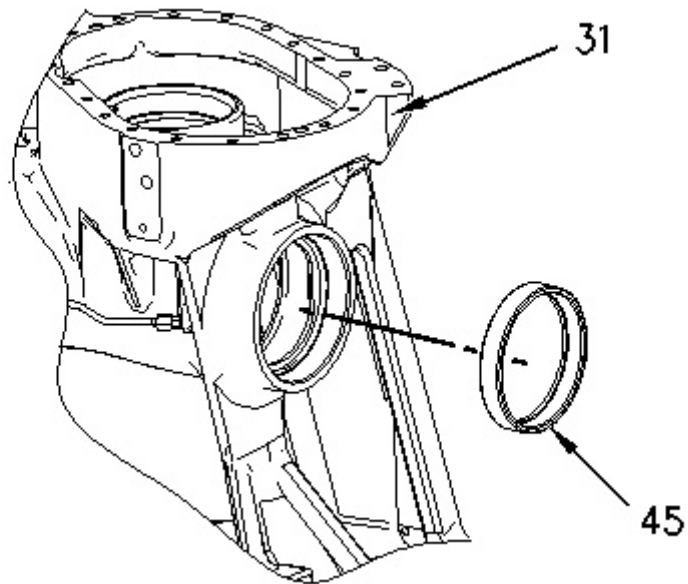

Illustration 2

g00960207

2. Lower the temperature of bearing cup (45) .
3. Install bearing cup (45) into case (31) .

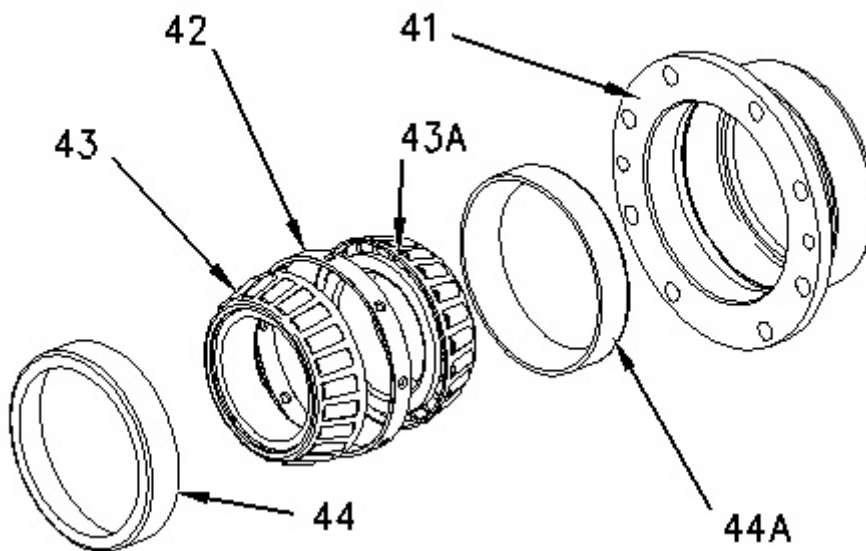
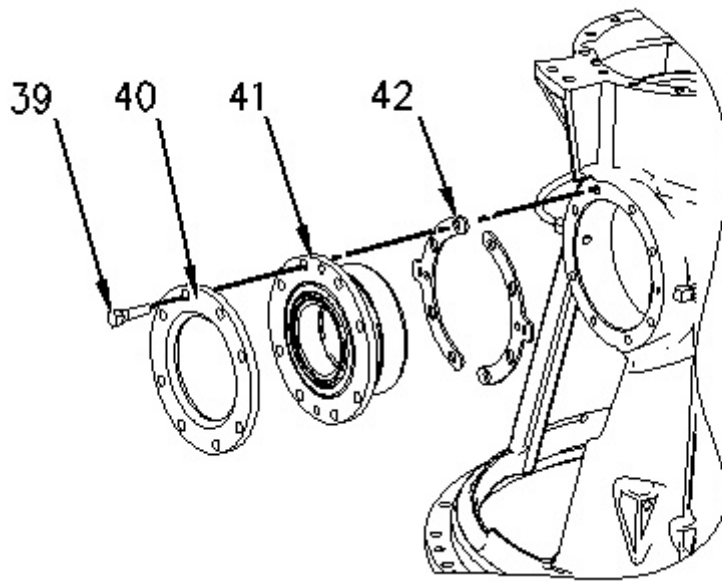

Illustration 3

g00954865

4. Lower the temperature of bearing cup (44) and bearing cup (44A) .
5. Install the bearing cup (44A) and bearing cone (43A) into cage (41) .
6. Install spacer (42) .
7. Install bearing cone (43) and bearing cup (44) .



---

Illustration 4

g00954864

8. Install original shims (42) and cage (41) .
9. Position retainer (40). Install bolts (39) .

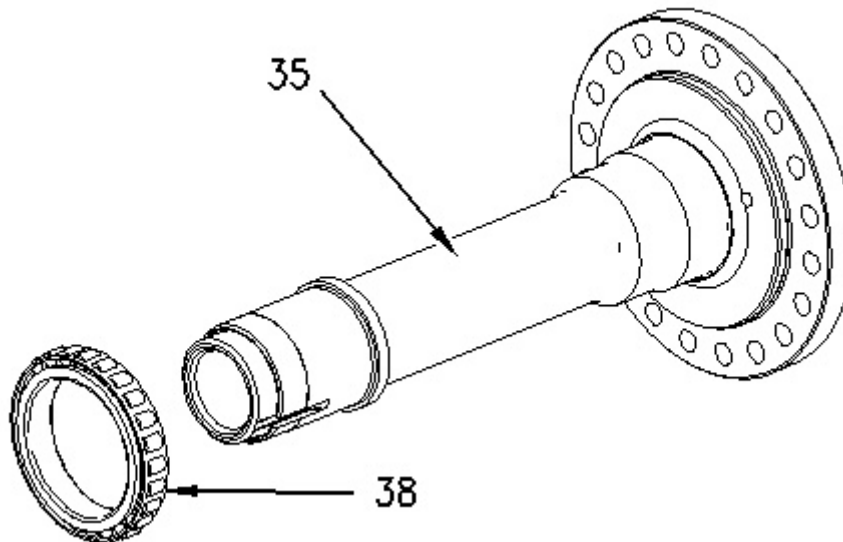

---

Illustration 5

g00954863

10. Raise the temperature of roller bearing (38) .
11. Install roller bearing (38) onto shaft assembly (35) .

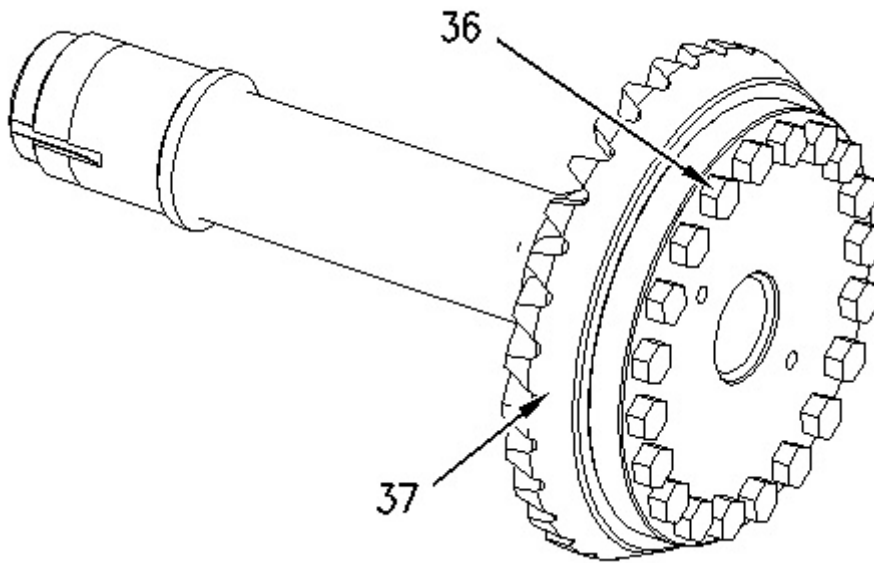

Illustration 6

g00954861

12. Position gear (37) .
13. Install bolts (36) .

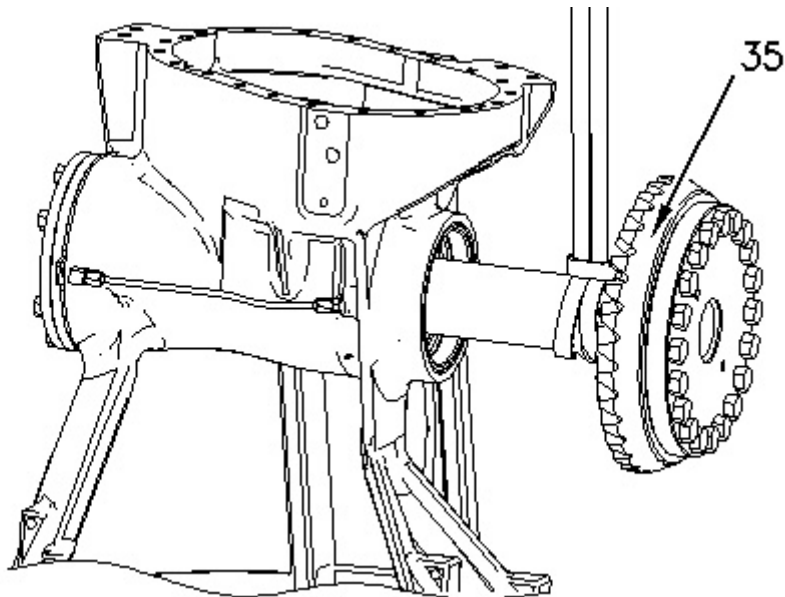
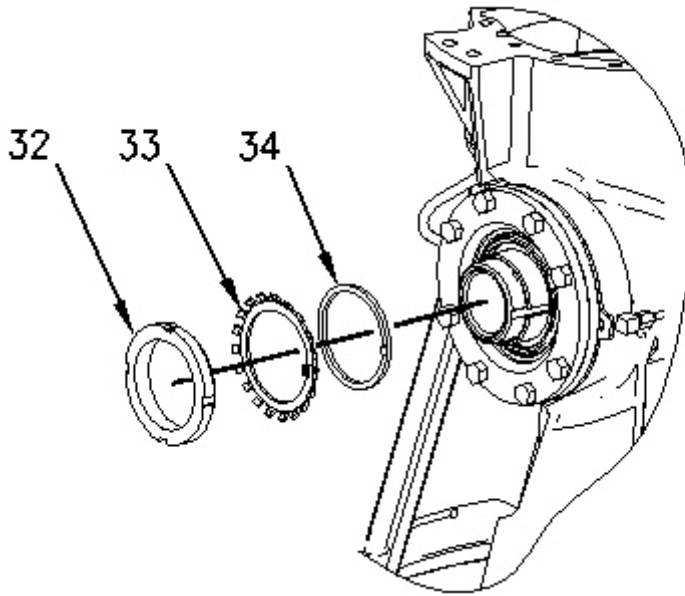

Illustration 7

g00954860

14. Attach a suitable lifting device to shaft assembly (35). The weight of the shaft assembly is approximately 39 kg (86 lb).
15. Install shaft assembly (35) .



---

Illustration 8

g00954859

16. Install washer (34) .

17. Install washer (33) .

**Note:** Use a new washer (33) during assembly.

18. Apply Tooling (H) to the threads and to the face of nut (32) .

19. Install nut (32) .

20. Use Tooling (C) in order to tighten nut (32) to a torque of  $612 \pm 68 \text{ N}\cdot\text{m}$  ( $451 \pm 50 \text{ lb ft}$ ).

21. Bend the tab on washer (33) toward nut (32) .

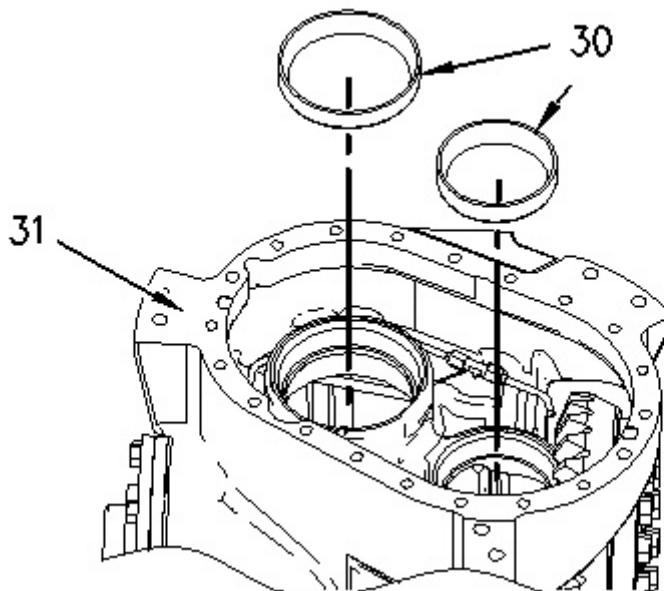

22. Lower the temperature of bearing cups (30) .
23. Install bearing cups (30) into case (31) .

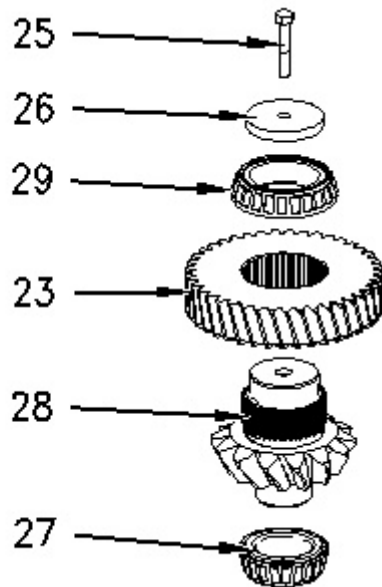

---

Illustration 10

24. Raise the temperature of bearing cone (27) and bearing cone (29) .
  25. Install bearing cone (27) onto gear (28) .
  26. Install gear (28) into gear (23) .
  27. Install bearing cone (29) onto gear (28) .
  28. Position retainer (26).
  29. Install bolt (25) .
-

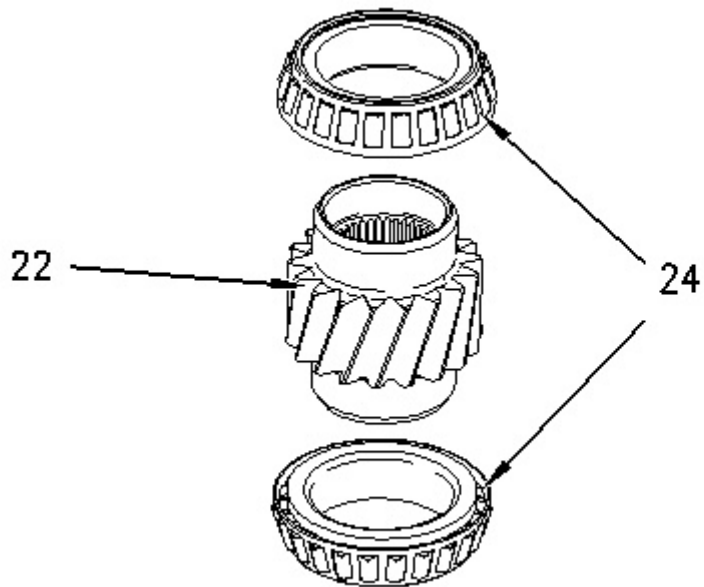

---

Illustration 11

g00954593

30. Raise the temperature of bearing cones (24) .
31. Install bearing cones (24) onto gear (22) .

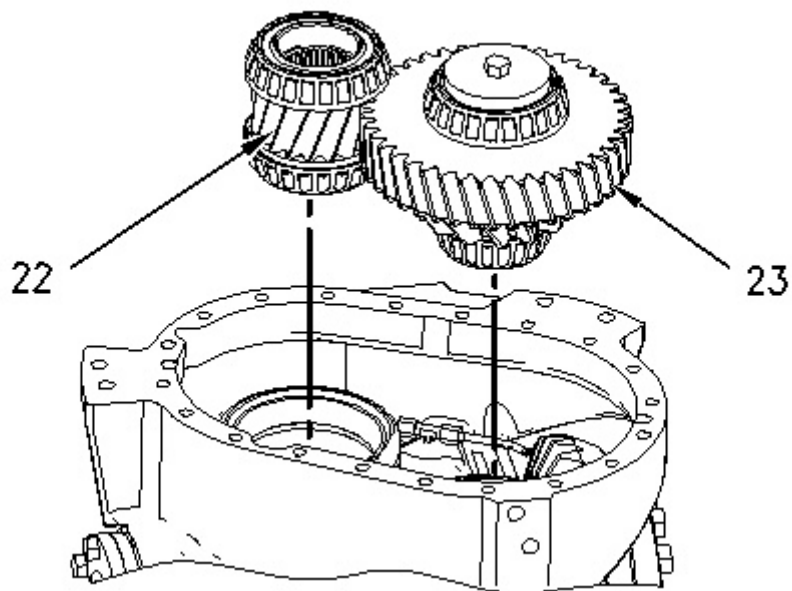

---

Illustration 12

g00954590

**Note:** Gears (22) and (23) must be installed into the case assembly at the same time.

32. Install gear (22) and gear (23) into the case assembly.
-

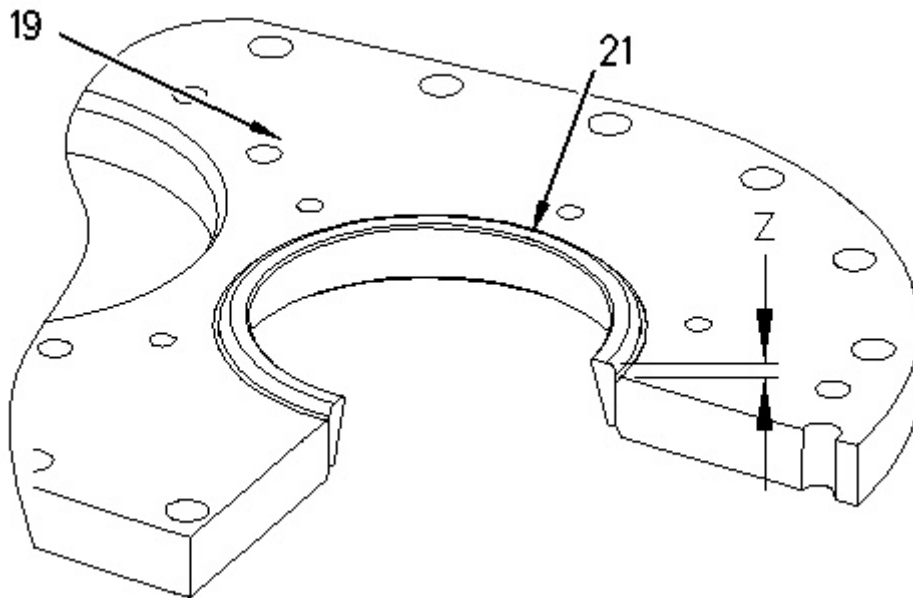

Illustration 13

g00984442

33. Install bearing cup (21) into cover (19). Dimension (Z) is 4.30 mm (0.17 inch).

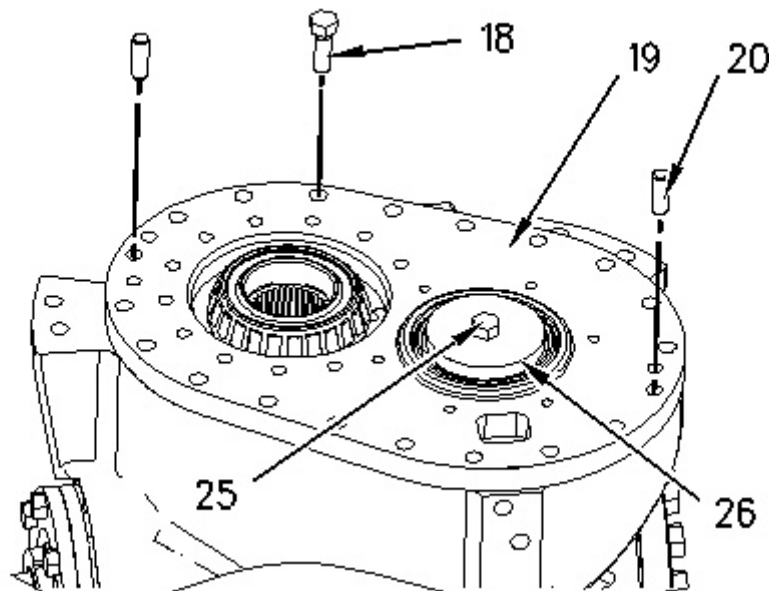

Illustration 14

g00984467

34. Position cover (19) .
35. Install dowels (20), if dowels (20) were removed. Install bolts (18) .
36. Remove bolt (25) and retainer (26) .



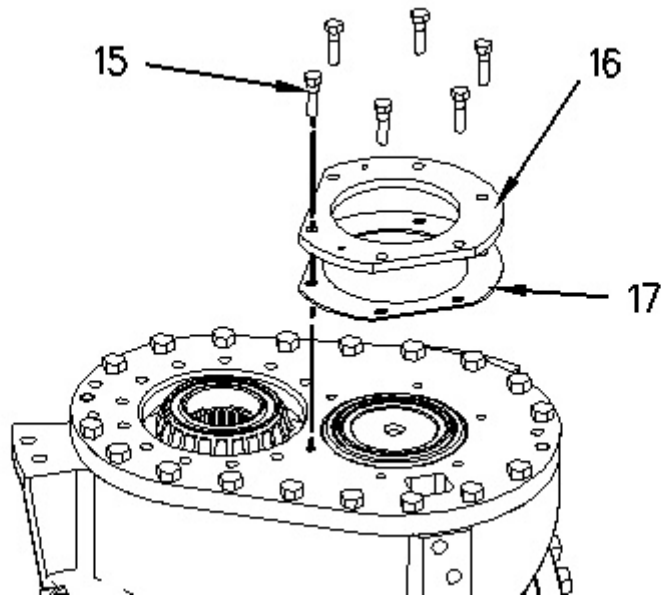

Illustration 15

g00984477

37. Position shim (17) that is equal to 4.30 mm (0.169 inch) onto cover (19) .
38. Install cover (16) and bolts (15) .

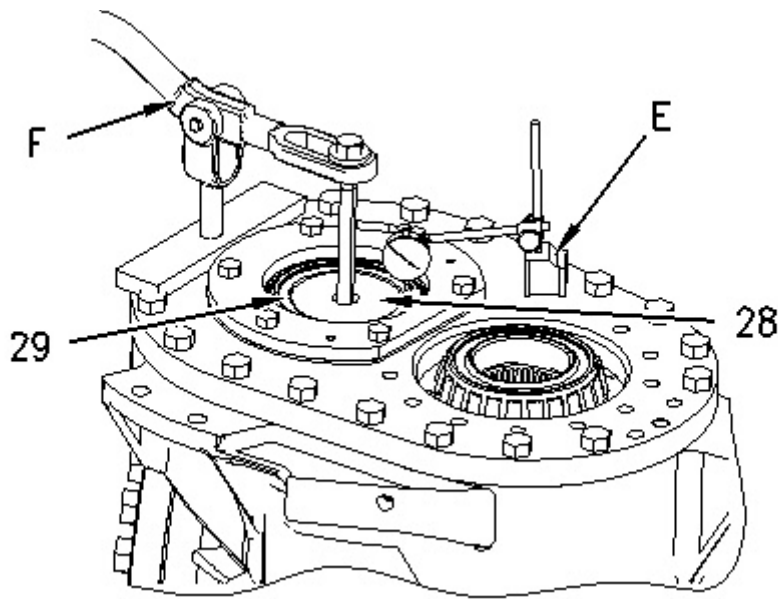

Illustration 16

g00984480

39. Install Tooling (E) and Tooling (F) .
40. Rotate gear (28) in order to find the high spot on bearing face (29) .
41. Zero Tooling (E) .
42. Obtain an end play measurement.

Thank you so much for reading.  
Please click the “Buy Now!”  
button below to download the  
complete manual.



After you pay.

You can download the most  
perfect and complete manual in  
the world immediately.

Our support email:

[ebooklibonline@outlook.com](mailto:ebooklibonline@outlook.com)