



Rear pinion

Previous operations:

1. See para. Rear wheels - S0.02.01
2. See para. Rear fender - G0.04.01
3. See para. Folding ROPS frame - G0.20.01
4. See para. Platform - G0.00.01
5. See para. Covering and platforms - G0.04.02
6. See para. Propeller shaft - Front axle drive shaft - F0.04.01
7. See para. Changing the transmission oil - D0.00.01
8. See para.
9. See para. Mechanical gearbox - Complete assembly - D0.09.03
10. See para. Rear lift - Complete assembly - R0.02.03
11. See para. Rear differential - complete assembly - E0.02.06
12. See para. Checking brake reservoir oil level - E0.03.01

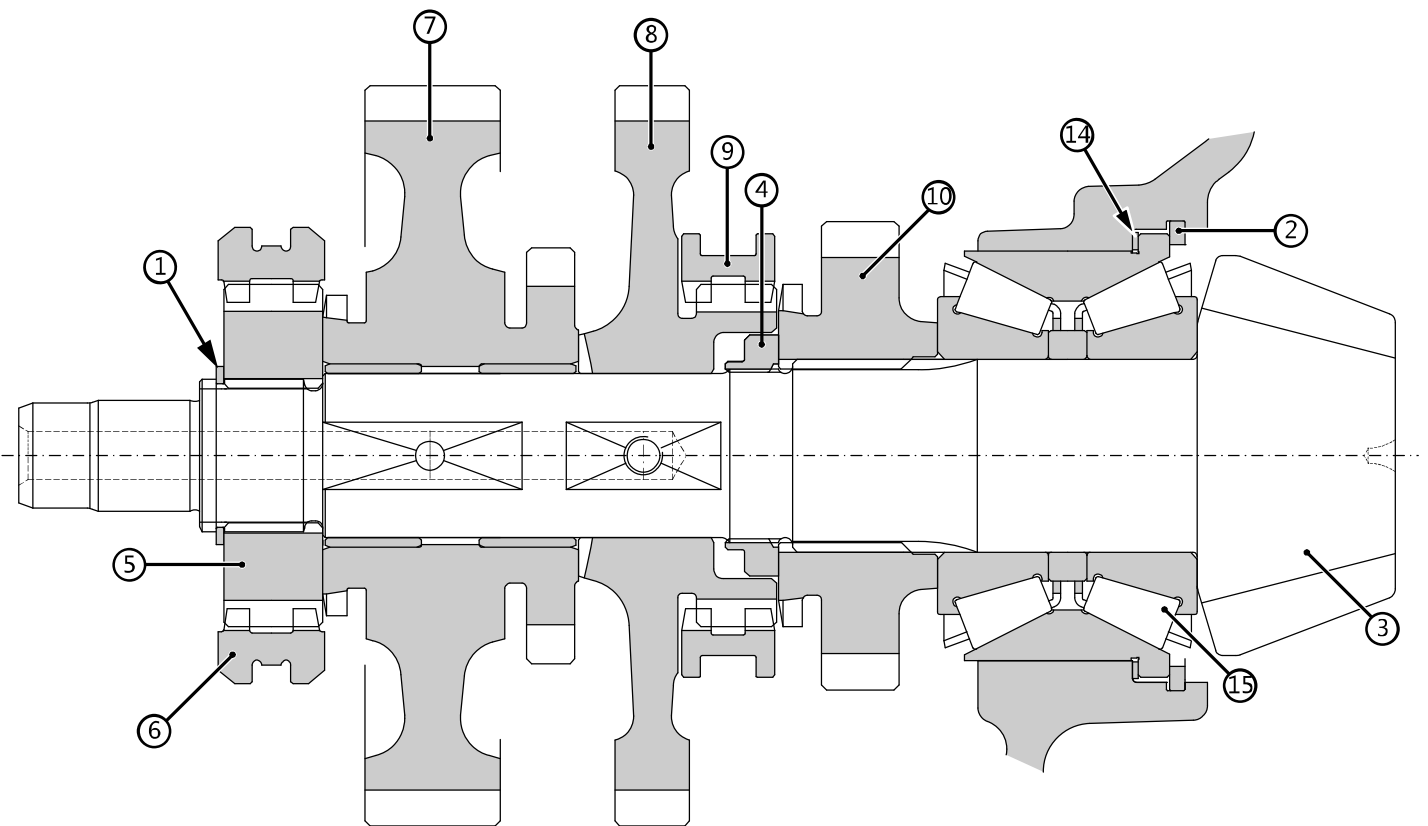

Fig. 3-RANGE VERSION

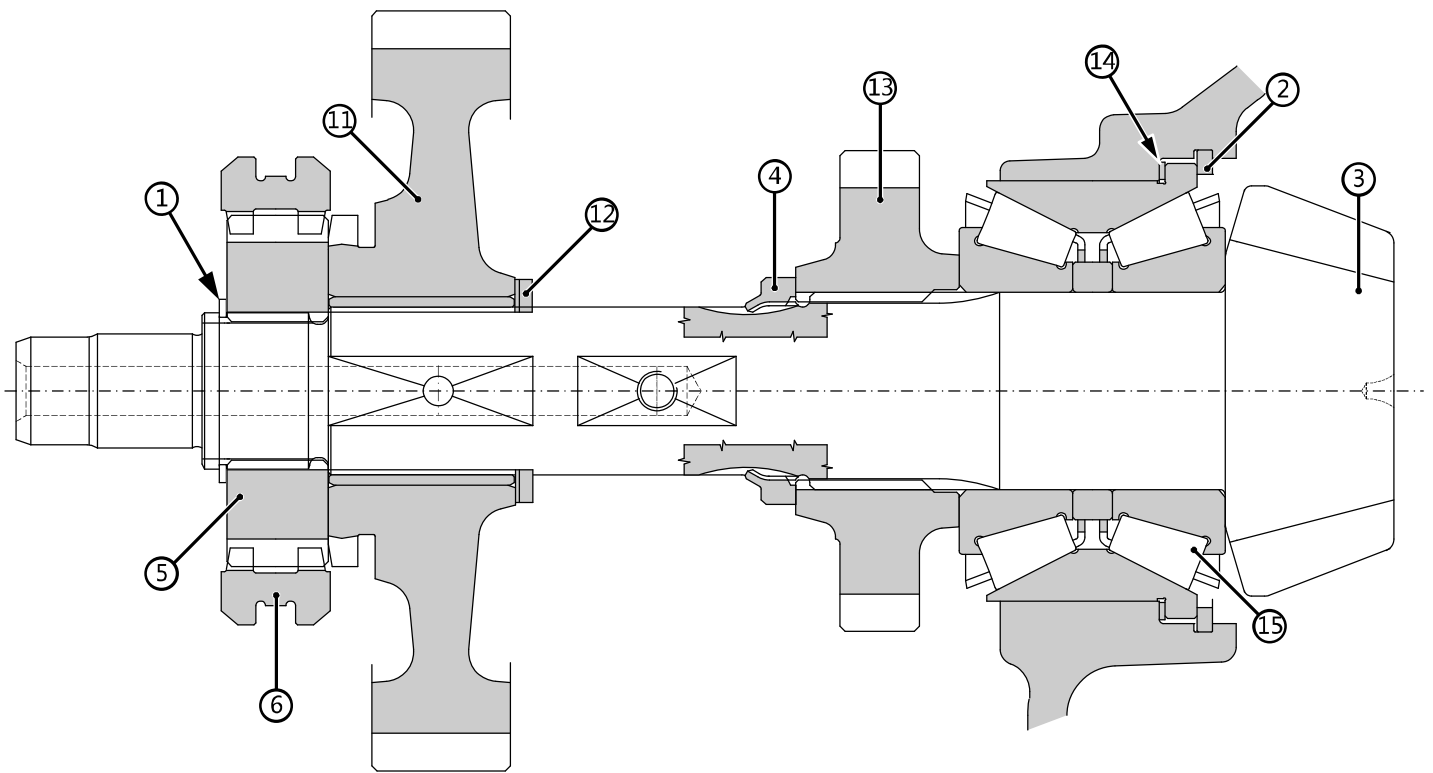



Fig. 2-RANGE VERSION

Removal

DANGER

1.  Disconnect the lead from the battery negative terminal (-) and apply the parking brake

Remove circlips (1) and (2).

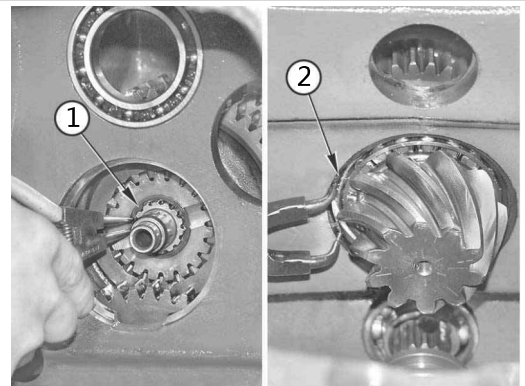

2.

For 3-range versions

Using a copper punch and a mallet, drive out pinion shaft (3) far enough to access ringnut (4).

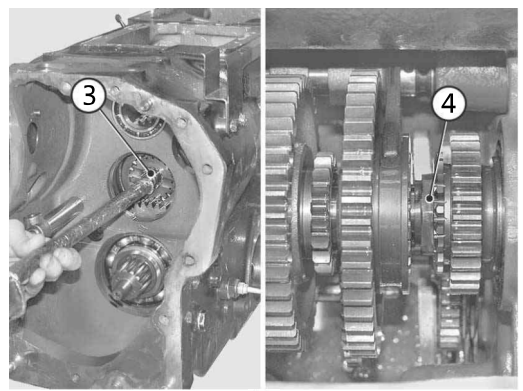

3.

For all versions

Using a bar made of soft material to hold the shaft against rotation, unscrew ringnut (4) until it comes off the thread.

	<p>NOTE</p>
<p>Renew the ringnut (4) on reassembly.</p>	

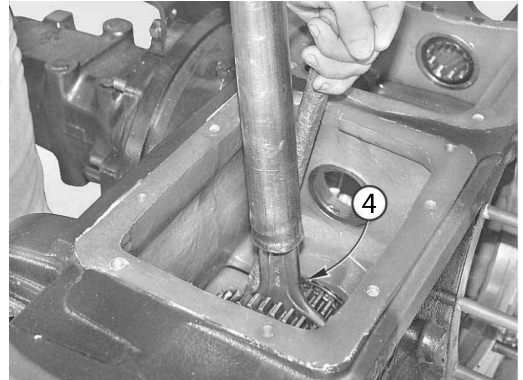

4.

Proceed by withdrawing pinion (3) and remove sleeve (5) and selector (6).

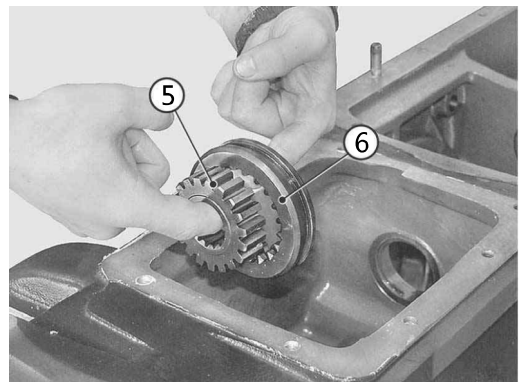

5.

For 3-range versions

Remove gears (7) and (8).

Remove the ringnut (4), selector (9) and gear (10).

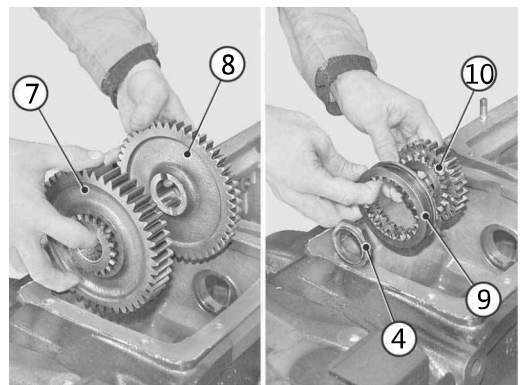

6.

For 2-range versions

Remove gear (11), spacer (12), ringnut (4) and gear (13).

	<p>NOTE</p>
<p>Note which way round spacer (12) is installed.</p>	

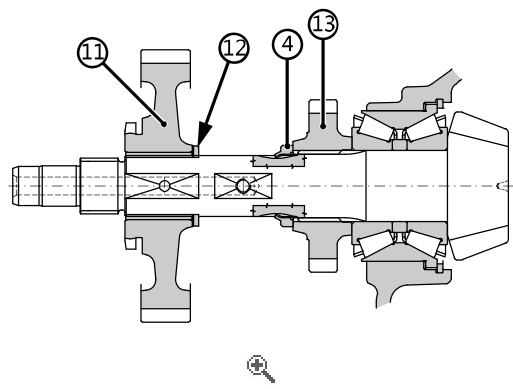

7.

For all versions

Remove pinion shaft (3) and the shims (14).

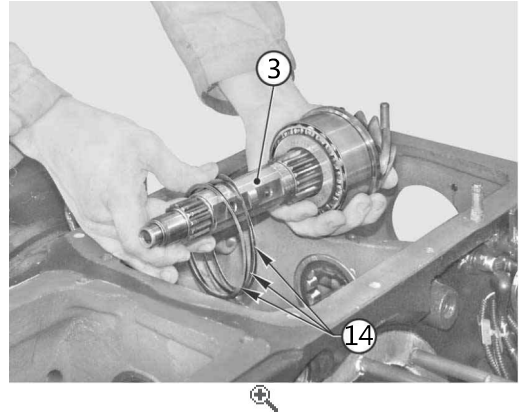

8.

Only if necessary

Using a press and a suitable puller, remove bearing (15) from pinion (3).

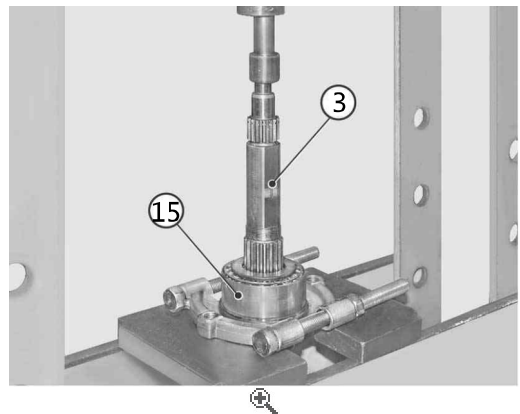

9.

Refitting

1. Refitting is the reverse of removal.

- o Apply thread locking compound Loctite 270 on the ring nut (4) and tighten to the specified torque: 274+294 (202+217.7 lb.ft.)

Before fitting the bearing on the pinion shaft, lubricate the inner rings of the bearing with transmission oil



NOTE

During assembly of the bearing (15), rotate the outer ring to bed in the rollers and ensure smooth rotation.

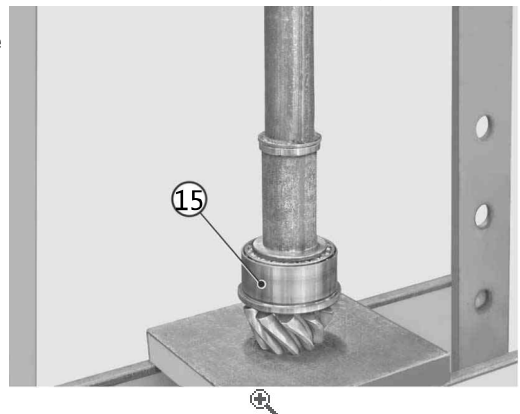

2.



4WD output shaft

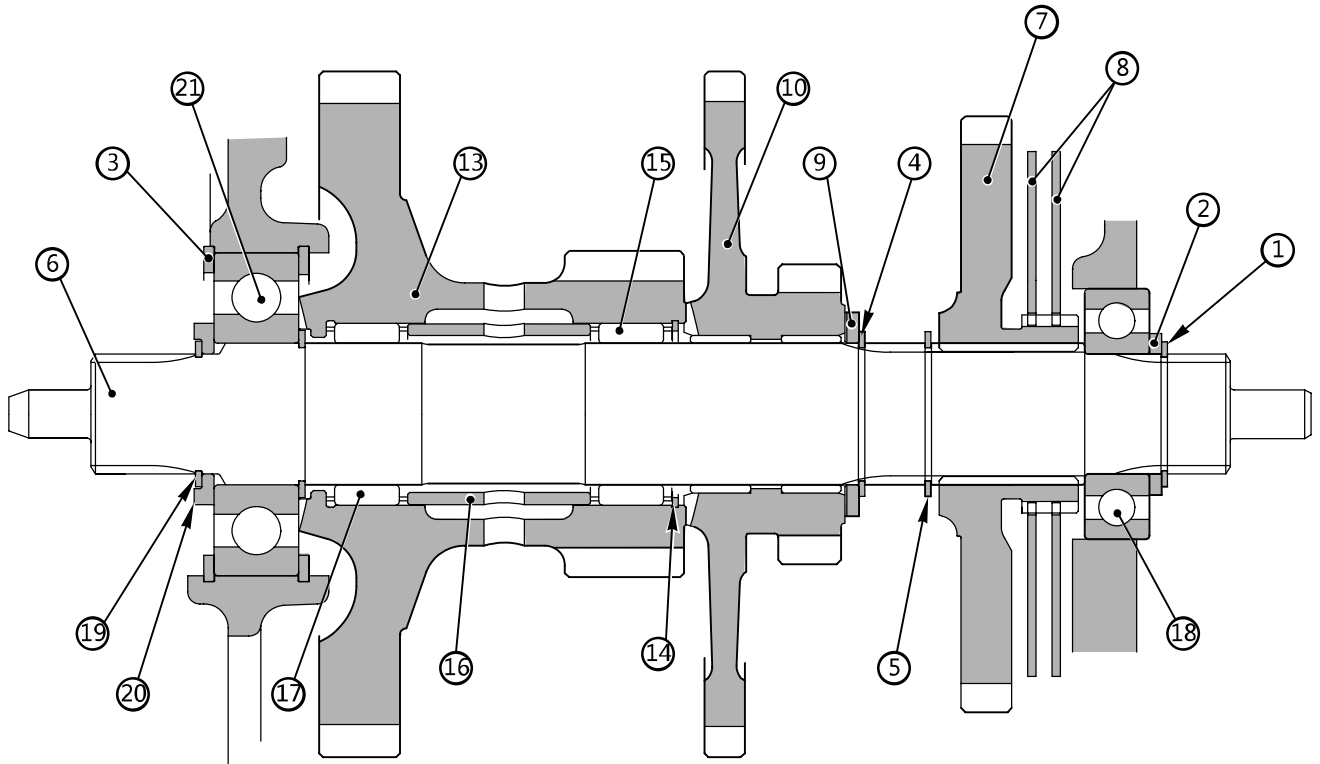

Fig. 3-RANGE VERSION

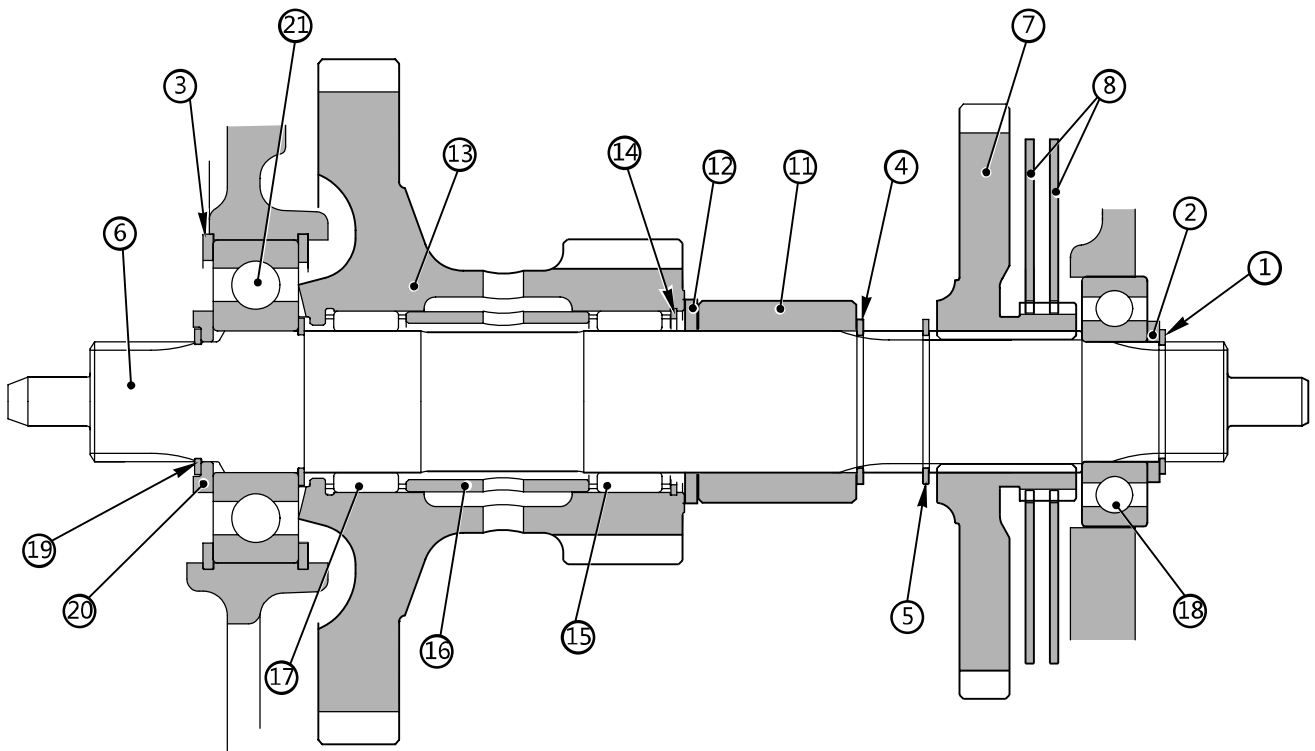

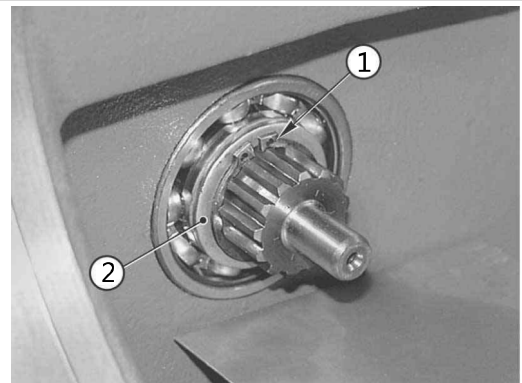

Fig. 2-RANGE VERSION

Removal

	DANGER
1.	Disconnect the lead from the battery negative terminal (-) and apply the parking brake

Remove circlip (1) and spacer (2).



2.

Remove the circlip (3) and move circlips (4) and (5) towards the rear of the tractor

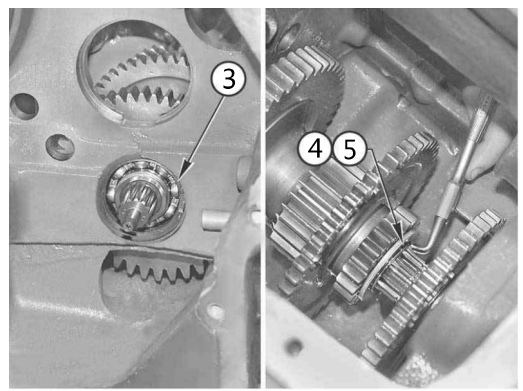

3.

Using a soft metal punch, drive out shaft (6).

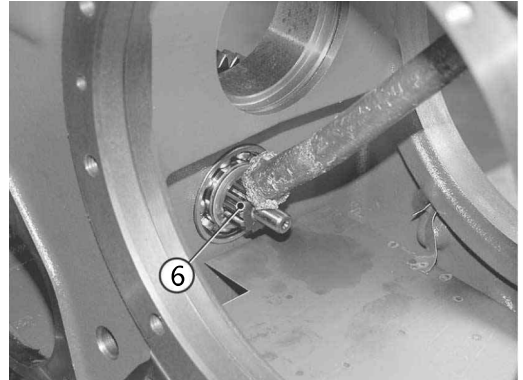

4.

Remove 4WD driven gear (7) and steel plates (8).

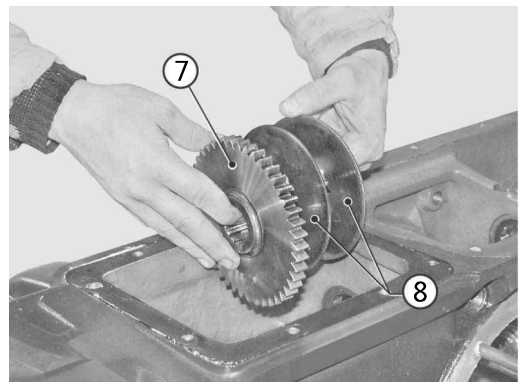

5.

For 3-range versions

Remove circlips (4) and (5), shim (9) and gear (10).



NOTE

Note which way the round the shim is installed.



NOTE

Renew the circlips on reassembly.

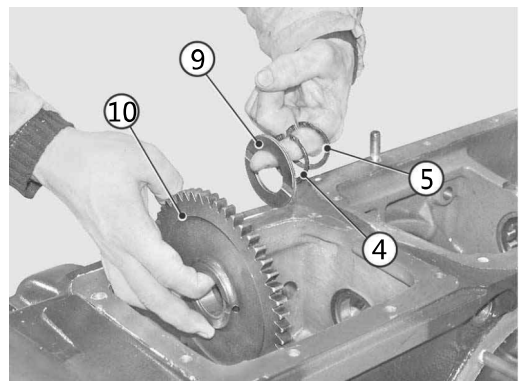

6.

For 2-range versions

Remove circlips (4) and (5), spacer (11) and shim (12).



NOTE

Note which way the round the shim is installed.



NOTE

Renew the circlips on reassembly.

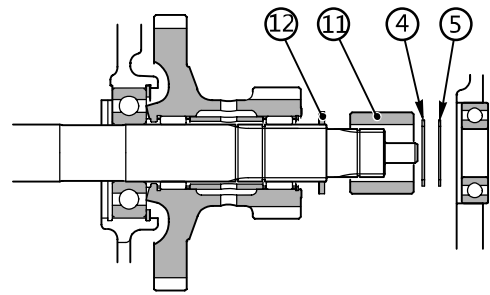

7.

For all versions

Remove gear assembly (13).

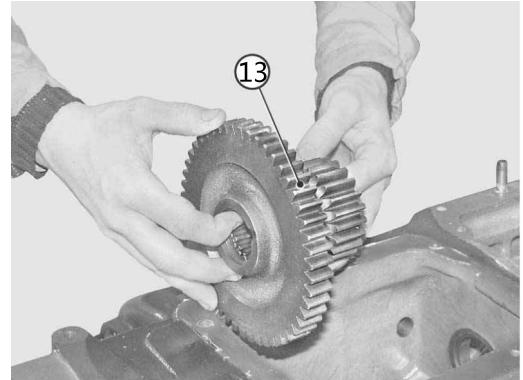

8.

Remove circlip (14) and remove roller cage (15), spacer (16) and roller cage (17).

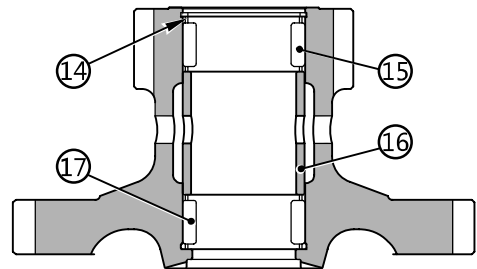

9.

Finally remove shaft (6) and remove bearing (18) from the transmission casing.

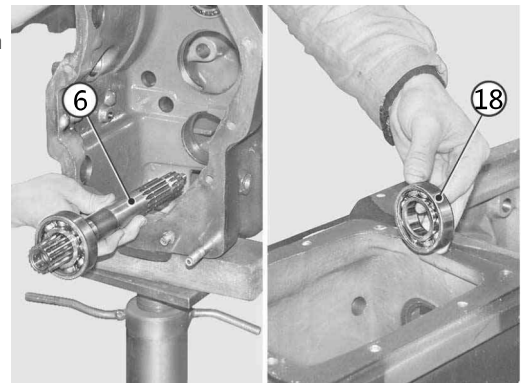

10.

Remove circlip (19) and spacer (20) from shaft (6).

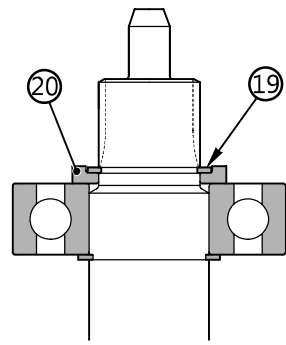

11.

Remove bearing (21) from shaft (6) .

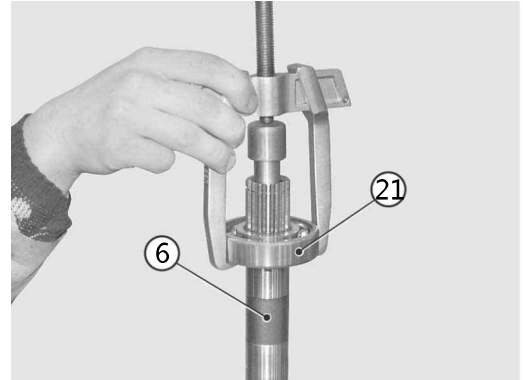

12.

Refitting

Refitting is the reverse of removal.

- Lubricate roller cages (15) and (17) with transmission oil.



PTO output shaft.

Removal



DANGER

1. Disconnect the lead from the battery negative terminal (-) and apply the parking brake

Unscrew the nuts (1) and remove flange (2) complete with oil seal (3).

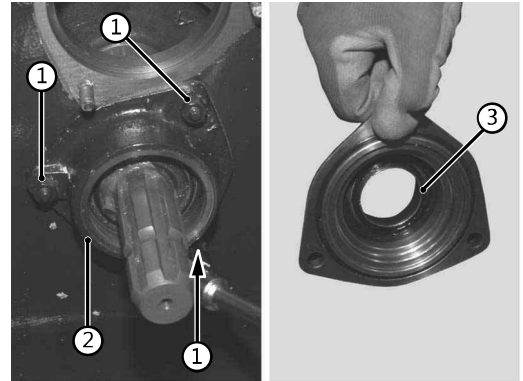

- 2.

Loosen screw (4) retaining the fork (5).

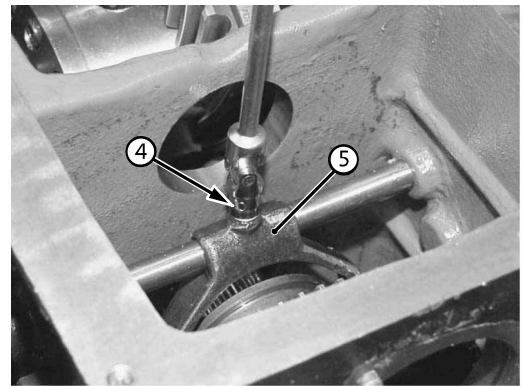

- 3.

Remove drive shaft (6).



NOTE

Renew O-ring (7) after every removal.

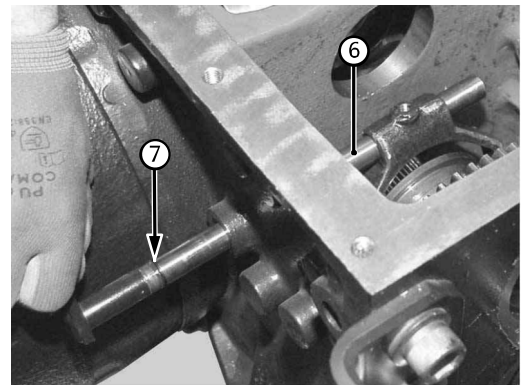

- 4.

Remove fork (5).

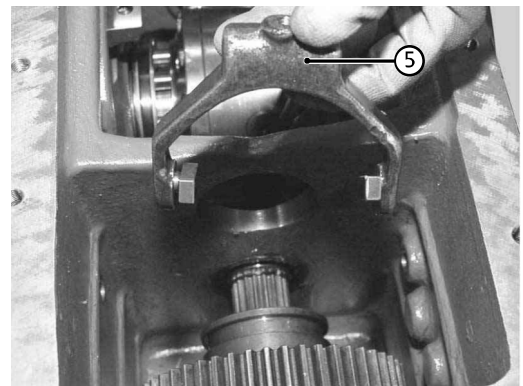

Thank you so much for reading.
Please click the “Buy Now!”
button below to download the
complete manual.



After you pay.

You can download the most
perfect and complete manual in
the world immediately.

Our support email:

ebooklibonline@outlook.com